

Specification for Conversion of storage room into seed store

1. Schematic diagram

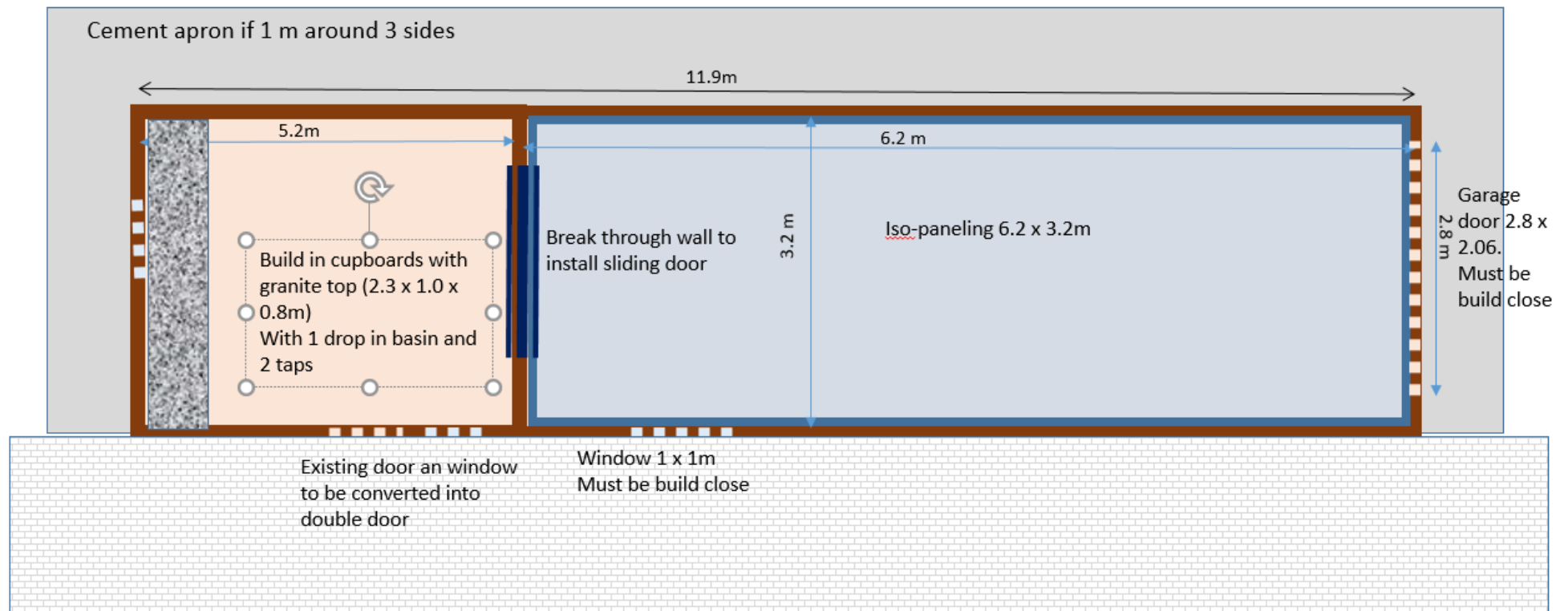

2. Construction

- Build 2.8 x 2.06 m garage door over
- Build 1 x 1 m Window over
- Install double wooden door
- Damp-seal (coprox) and repaint whole building
- Replace roof corrugated iron sheets
- Replace all gutters
- Paint roof and gutters
- Break through between the rooms in order to install the sliding door for the seed store
- Cement apron of 1 meter around the three sides

3: Seed storage room

Panelling

- Panelling of room 6.2m x 3.2m x 2.6m (51.584 cubic meters)
- Virgin Grade Expanded Polystyrene cladded with 0.5mm white Chromadek or polyester coated
 - Density: 20 – 30 kg/m³
 - K value Thermal conductivity: 0.036W/m.K
 - Water Vapour Diffusion Resistance: 30
 - Tensile strength: 280 Kpa
 - Heat Capacity: 1500 J/kg K

Sliding Door Cold Room

- Size: standard size
- Thickness: 100 mm for normal cold room
- Chromadek or polyester coated k or similar sheets filled with 40-42 kg / m³ density polyurethane insulation material.
- Accessories, carrier rails, wheels, handles and plastic parts used in our doors, are manufactured in accordance with international standards.

Cooling Unit

- Refrigeration Unit
- Must maintain $4^{\circ}\text{C} \pm 3^{\circ}\text{C}$ in 55cubic meter area
- For use with: Isowall Freezer kit 6m x 6m – Low Temperature Freezer Room.
- Low Temperature: Suited To Operate at a Minimum Temperature of about 4 Degrees Celsius.
- Unit is housed in a high strength, galvanised, weatherproof steel structure.
- The condenser arrangement allows for indoor use.
- Efficient Micro-Channel Condensers and High Performance Evaporator Coils.
- Liquid Line Drier.
- Integrated Vertical-Discharge Condenser.
- Fully Wired Internally Mounted Electrical Panel with System Controller.
- High Pressure Safety Cut Out as Standard.
- Low Pressure Control with Pump down Cycle as Standard.

Dehumidifier

- Easy to open for cleaning
- Hour counter
- 25 litre large dehumidifier
- 5 Litre Tank Capacity
- Anti-bacterial filter/ Air Purifying
- Low Energy consumption
- Strong, retractable carry handle and castor wheels
- Stops dehumidifying when the tank is full (automatic shut-off when full)
- Simple to use LCD controls

Flooring:

- Polyurethane (PU) Concrete cover (6.2m x 3.2m)

3: Work storage room

- Build in cupboards with granite top (2.3 x 1.0 x 0.8m)
- High traffic ceramic tiles (5.2m x 3.2m)
- Drop in basin with hot and cold water
- Geyser (50 litter)
- Install 5 wall electrical outlets
- Bugler bars in front of Window
- Metal venetian blinds for window
- security burglar gate in front of double door
- Small roof in front of double door
- Air-conditioner for room (5.2m x 3.2m x 2.6m about 45m³)

4: Emergency back-up-generator

- 275kVA standby power at 230/400v @ 50Hz 1500rpm
- High-quality six-cylinder 9.726l turbocharged diesel engine
- Silent canopy which can stand outside with lockable doors
- Automatic changeover (ATS), maintenance free batteries and trickle charger
- With a H-specification insulation, brushless alternator with AVR
- provides stable output
- High-temperature and oil pressure sensor to protect against engine damage
- Easy to use digital controller with auto/manual start options
- Supply must sets undergo a comprehensive testing/pre-delivery inspection prior to delivery
- One year/1000 hour warranty

5: Shelving for cold store

- Mobile tract filing system



- Epoxy coated steel shelves that can be assembled to need



- 10 Heavy Duty Shelf Trolley (lockable)

