

TRANSNET NATIONAL PORTS AUTHORITY
 DESCRIPTION OF THE SERVICE: FOR THE PROVISION SERVICE, INSTALLATION AND REPAIRS TO FENCING, GATES AND STEEL DOORS AROUND THE PORT OF DURBAN FOR A PERIOD OF THIRTY-SIX (36) MONTHS ON AN "AS & WHEN" REQUIRED BASIS

Annexure D: Substation Doors

Drawing No. 1 Single Door (900mm x 2400mm)

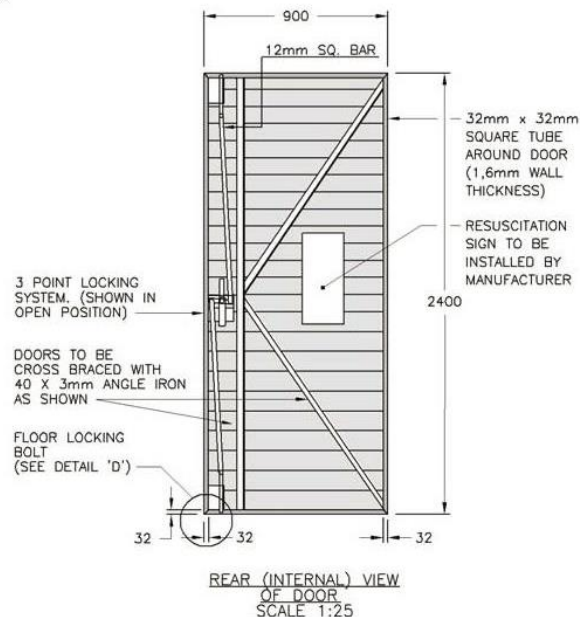
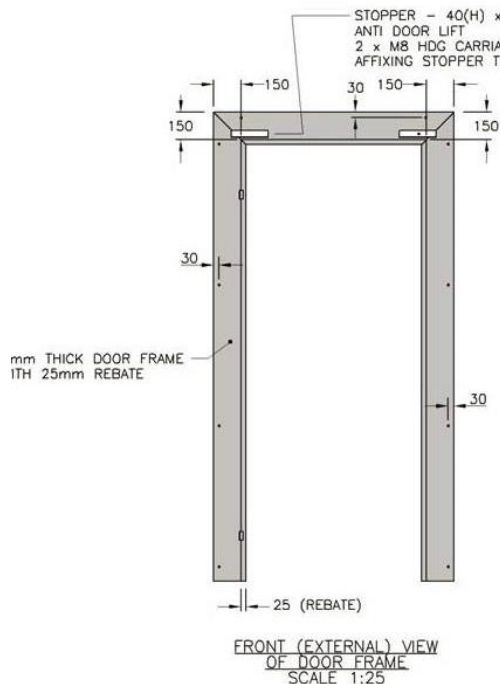
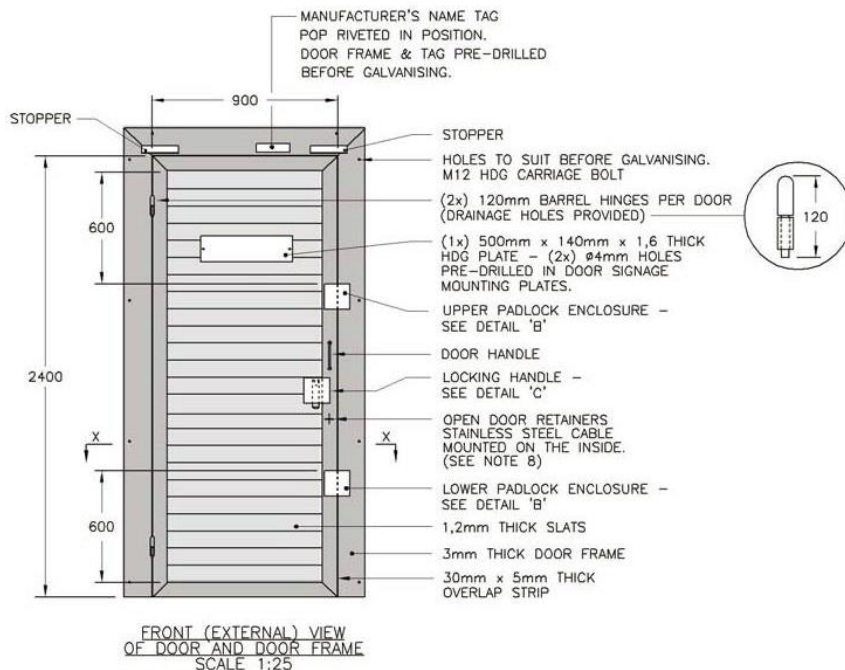

TRANSNET NATIONAL PORTS AUTHORITY
 DESCRIPTION OF THE SERVICE: FOR THE PROVISION SERVICE, INSTALLATION AND REPAIRS TO FENCING, GATES AND STEEL DOORS AROUND THE PORT OF DURBAN FOR A PERIOD OF THIRTY-SIX (36) MONTHS ON AN "AS & WHEN" REQUIRED BASIS

Annexure D: Substation Doors

Drawing No. 2 Double Door (1600mm x 2400mm)

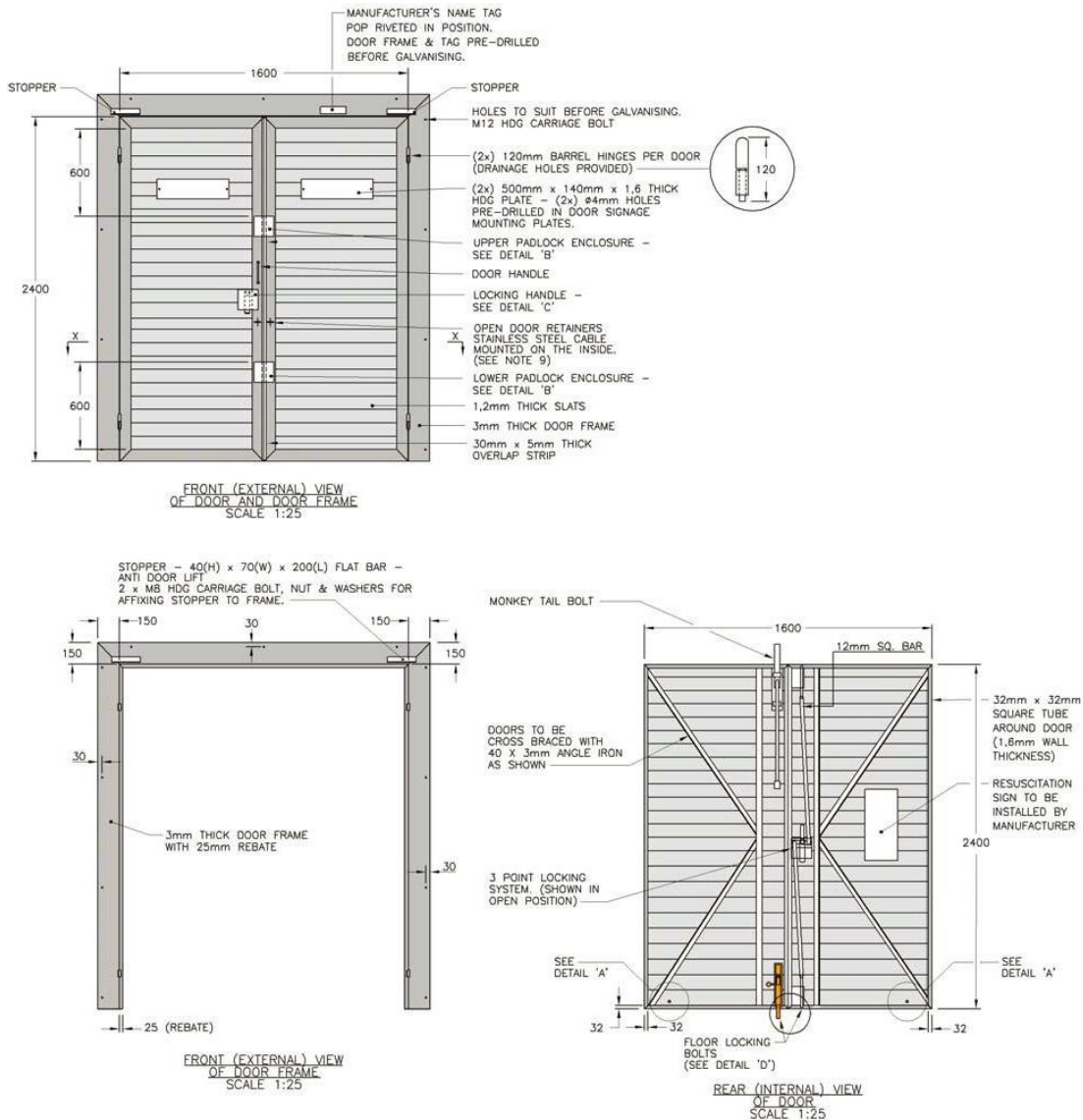

TRANSNET NATIONAL PORTS AUTHORITY
 DESCRIPTION OF THE SERVICE: FOR THE PROVISION SERVICE, INSTALLATION AND REPAIRS TO FENCING, GATES AND STEEL DOORS AROUND THE PORT OF DURBAN FOR A PERIOD OF THIRTY-SIX (36) MONTHS ON AN "AS & WHEN" REQUIRED BASIS

Annexure D: Substation Doors

Drawing No. 3 Double Door (1600mm x 2400mm)

