



Compliance requirements:

CIDB Grade 1GB or higher

Valid SARS PIN

Being registered on Central Supplier Database –CSD

Valid COIDA Letter of good standing from Compensation Commissioner

BUILDING CONSTRUCTION IN THE EXISTING BUILDING A7

Supplier required to provide a sketch/ drawing/ pictures of the layout

Supplier required to provide itemized billing quotes (show labour and material costs)

Supplier required to provide CoC for light switches and electrical connections

Room 13 to be converted into:

- Toilets: male (2 stalls) and female (2 stalls)

Room 5 to be converted into:

- tea room
- lab space

Room 22: add extraction unit

Room 13 Toilet specifications

Dimensions of **room 13**: Length x Width x Height, 5500mm x 4250mm x 3300mm

Build brick walls to separate the male and female toilets.

Paint the walls light grey (water paint, plascon/ dulux)

2 standard doors (1 to enter male toilet, 1 to enter female toilet)

Doors colour: light grey

Tile the floor – light grey matt/ non-gloss (slip resistant when wet)

Tile dimension: 450mm x 450mm

Tile the wall above the basins:

Female toilets – **Maroon/burgundy** colour mosaic tiles (1 sheet row) above the basins

Male toilets – **teal** (dark turquoise) colour mosaic tiles (1 sheet row) above the basins

Add frosted windows

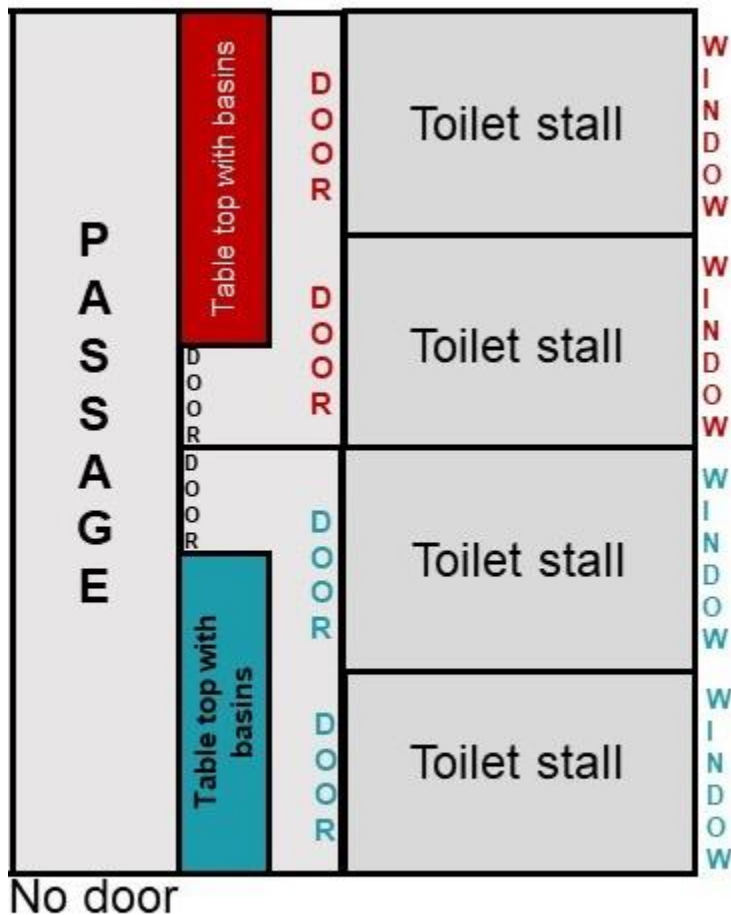

Figure 1: Layout of toilets (not drawn to scale)

Male toilet requirements:

- 2 teal colour painted doors (Interior Door Hollow Core Plain Hardboard) for the stalls
- 2 toilet stalls with full toilet sets (white) consisting of bowl with seat, tanks with all accessories
- 2 toilet roll holders
- 2 frosted windows above the toilets in the stalls, teal 100mm border painted around the windows
- 2 standard basins (side by side) with taps (mixers)
- 1 mirror above the sheets of mosaic tiles above the 2 basins (same length as basins)
- 1 soap dispenser inbetween the basins
- 1 paper towel dispenser on the side wall
- Plumbing for toilet and basins Distance to existing toilet plumbing
- Standard downlights (one inside each stall, 2 outside the stalls)
- Light switch and electrical connections

Female toilet requirements:

- 2 Maroon/burgundy colour painted doors (Interior Door: Hollow Core Plain Hardboard) for the stalls

2 toilet stalls with full toilet sets (white) consisting of bowl with seat, tanks with all accessories
2 toilet roll holders
2 frosted windows above the toilets in the stalls, **Maroon/burgundy 100mm border** painted around the windows
2 standard basins (side by side) with taps (mixers)
1 mirror above the sheets of mosaic tiles above the 2 basins (same length as basins)
1 soap dispenser inbetween the basins
1 paper towel dispenser on the side wall
Plumbing for toilet and basins **Distance to existing toilet plumbing**
Standard downlights (one inside each stall, 2 outside the stalls)
Light switch and electrical connections
2 sanitary bins to be placed in the stalls

Toilet set specifications

Toilet set specification pan width and height: 360x415mm / cistern width and height: 340x415mm - cistern water capacity= 9l - pan flush volume= 4-7l - combined height: 830mm
- installed max length= 670mm.

Grinding room

Extraction unit to be installed in this room.

Room 5 tea room and lab space

Dimensions of the existing room 5: Length x Width x Height, 6100mm x 5450mm x 3300mm
Brick wall to separate the 2 rooms.
New tearoom dimensions: L X W X H, 4100mm x 5450mm x 3300mm
New lab space dimensions: L x W x H, 2000mm x 5450mm x 3300mm

Add standard entrance door (grey colour) on tearoom side to open into the passage.
Add 4 standard downlights in tearoom
Add 2 standard downlights in the lab space
Vinyl flooring, grey colour
Paint walls light grey (plascon/ dulux)

Tearoom specifications

Add wall installed hot water boiler urn (20L)
Move and connect sink and cupboard from old to new kitchen
6 x **Maroon/burgundy** colour blinds for 6 windows
(Window dimensions: 1.46m width, 1.8m length)
12 x **Maroon/burgundy** fabric chairs (high-density foam seat)

Rubble removal (Housekeeping)

Payment will be done after completion of job

Special Condition:

Contractor: OHSE Officer to be provided to oversee health and safety of contractors

Compliance to OHSE Act: Occupational Health and Safety Act No. 85 of 1993 as amended:
construction operations