

**REAR ELEVATION  
JOINT DETAIL (SIGN FACE > 6m IN LENGTH)**

SCALE 1:2.5

NOTES :

**STANDARD SIGN PROFILE**

1. THE STANDARD SIGN PROFILE SHALL BE MADE FROM 1mm THICK PREPAINTED GALVANIZED MILD STEEL PLATE.
2. THE BACK FACE OF THE SIGN PROFILE SHALL BE GRAY IN COLOUR : G29 TO SANS 1091 OR SIMILAR.
3. THE PREPAINTED STEEL SHALL BE CUT TO LENGTH TO A TOLERANCE OF ±2mm PRIOR TO PROFILING.
4. WHERE STANDARD SIGN PROFILES ARE TO BE FACED WITH RETRO-REFLECTIVE BACKGROUND MATERIAL, IT SHALL BE APPLIED IN ADVANCE TO INDIVIDUAL SECTIONS BEFORE ASSEMBLY, WITH THE MATERIAL TAKEN AROUND THE FACE EDGES OF EACH SECTION FOR AT LEAST 10mm.

**JOINT**

1. THE JOINT SHALL BE ACCURATELY ALIGNED PRIOR TO DRILLING RIVET HOLES.
2. THE GAP BETWEEN THE ADJOINING HALVES OF THE SIGN SHALL AT NO POINT EXCEED 2mm.
3. THE COMPLETED SECTION SHALL BE ASSEMBLED IN THE SHOP PRIOR TO DELIVERY TO SITE TO ENSURE THAT ALL SECTIONS FIT TOGETHER PROPERLY AND THAT LEGENDS ARE PROPERLY SPACED AND ALIGNED.
4. ON SITE THE TWO SECTIONS SHALL AGAIN BE ALIGNED AND FASTENED TOGETHER BY MEANS OF RIVETS PLACED IN THE PRE-DRILLED HOLES.

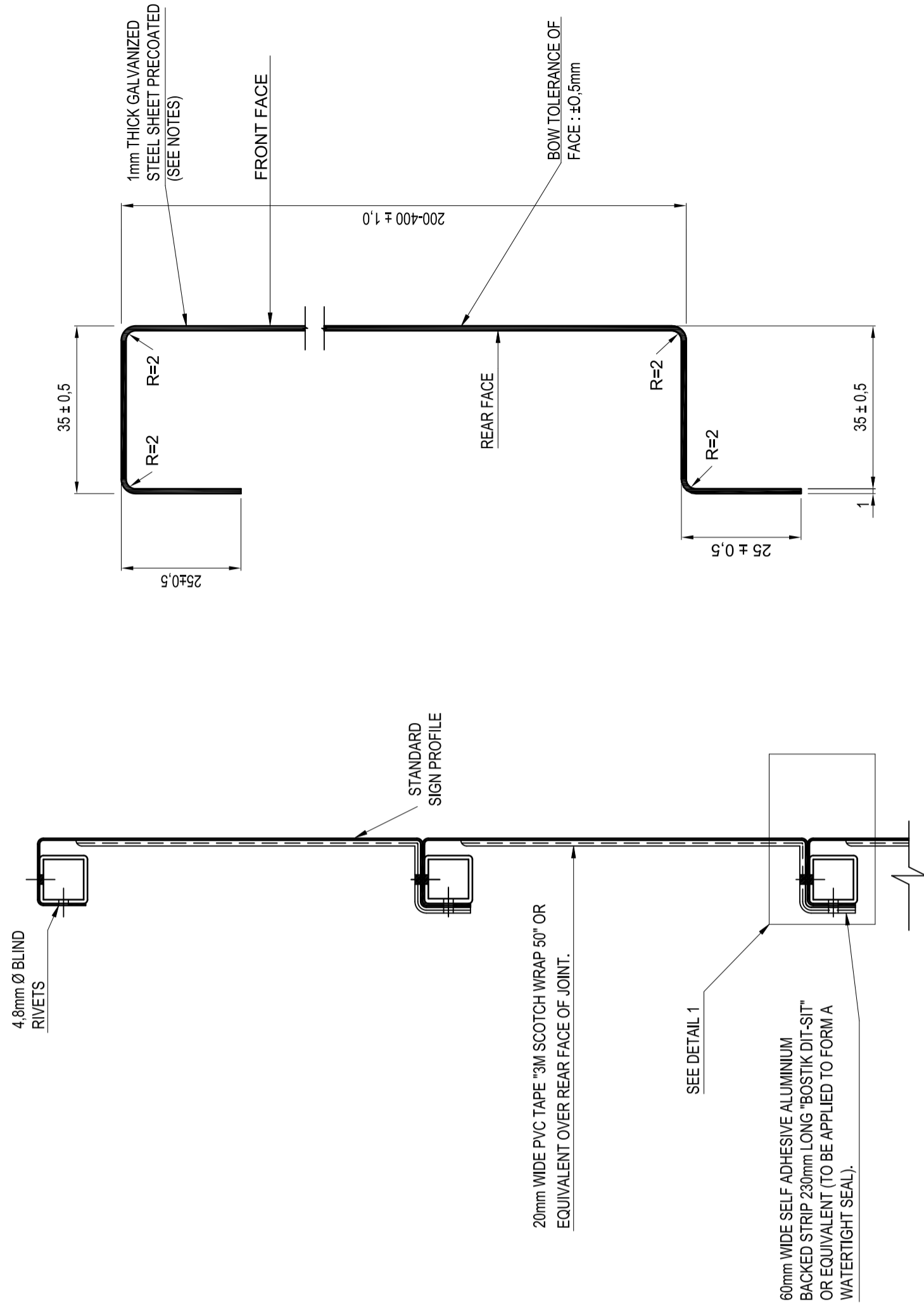

**SECTION A-A**

SCALE 1:2.5

**STANDARD SIGN PROFILE**

SCALE 1:1

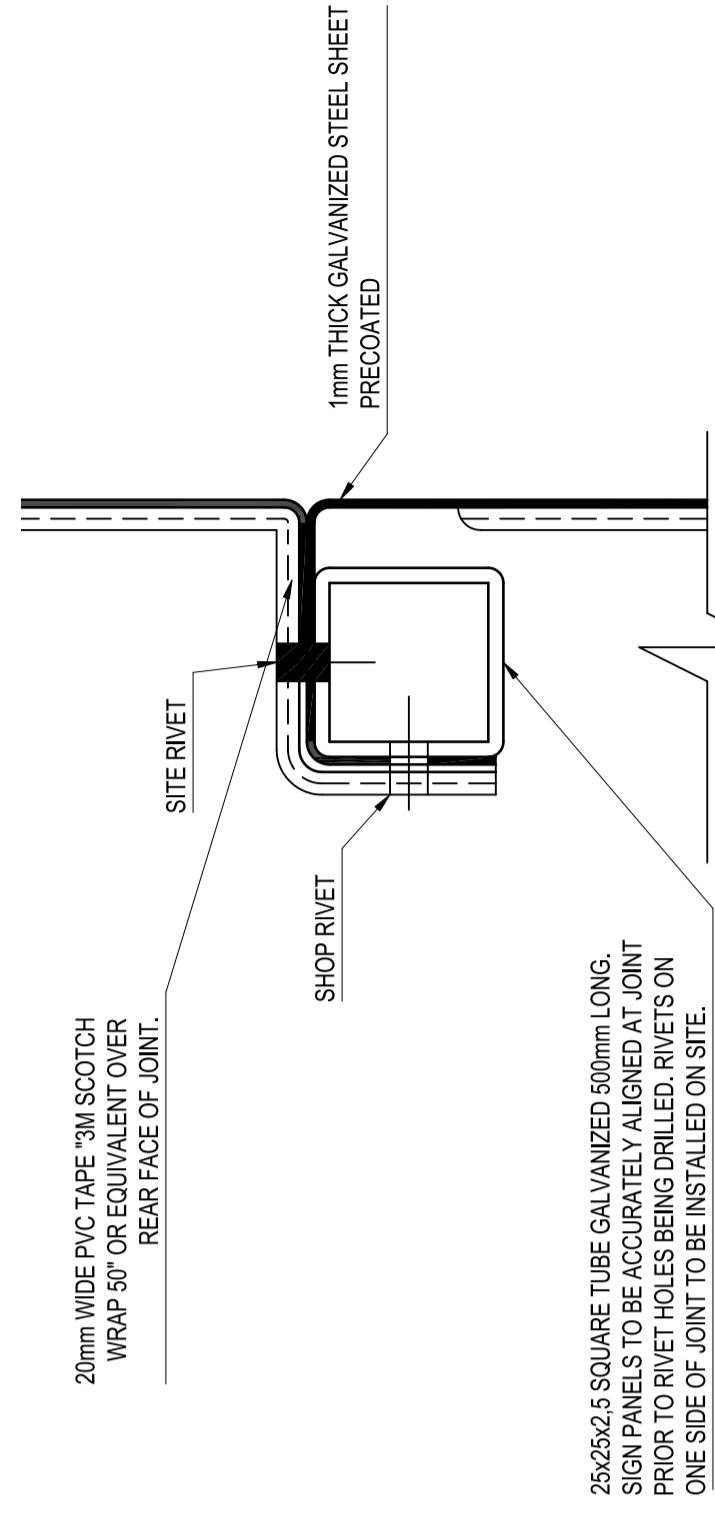

**DETAIL 1**

SCALE 1:1

NO.	DATE	REVISION	ENG.
V1	SEP 2022	ORIGINAL VERSION	

<b>CONSTRUCTION RECORD (AS BUILT)</b>	<b>WORKS CONTRACT ENGINEER</b>
Name: _____	Name: _____
Prof. Reg. No.: _____	Prof. Reg. No.: _____
<b>CONSULTANT APPROVAL</b>	<b>DESIGNED BY</b>
Name: _____	Name: _____
Prof. Reg. No.: _____	Prof. Reg. No.: _____
<b>HEAD OFFICE</b>	<b>CONSULTANT APPROVAL</b>
48 Tumbula Avenue	Name: _____
Vid de Grace	Prof. Reg. No.: _____
Groenh	Name: _____
P.O. Box 415	Prof. Reg. No.: _____
Pretooria 0001	Name: _____
Tel: +27 (0) 15 444 0000	Prof. Reg. No.: _____

<b>SOUTHERN REGION</b>	<b>PROJECT DESCRIPTION</b>
20 Shuterstade Drive	<b>THE SPECIAL MAINTENANCE ON NATIONAL ROUTE 62 SECTION 6 BETWEEN LOUWERWATER (KM 58.60) AND JOUBERTINA (KM 79.00)</b>
Baywest	<b>ROUTE</b>
Port Elizabeth	6
6025	<b>SECTION</b>
P.O. Box 24210	58.60
Port Elizabeth	<b>DRAWING TYPE</b>
P.O. Box 199 2006	ROAD SIGNS
Tel: (041) 599 2006	<b>DRAWING NAME</b>
	<b>DETAIL OF ROAD SIGN PROFILE AND JOINT</b>
	<b>SCALE:</b> N.T.S.
	<b>SHEET</b> 1 OF 1
	<b>PROJECT NUMBER</b>
	SANRAL R.062-060-2021/2F
	<b>DRAWING LOCATION DATA</b>
	<b>START</b>
	<b>END</b>
	<b>R62</b>
	<b>R62</b>
	<b>6</b>
	<b>79.00</b>
	<b>58.60</b>
	<b>ROAD SIGNS</b>
	<b>BRIDGE/STRUCTURE No.</b>
	<b>BRIDGE/STRUCTURE No.</b>
	<b>CONSULTANT DRAWING No.</b>
	<b>ER 2203/21</b>
	<b>VER.</b>
	<b>VI</b>

FOR TENDER PURPOSES ONLY



THE SPECIAL MAINTENANCE ON NATIONAL ROUTE 62 SECTION 6 BETWEEN LOUWERWATER (KM 58.60) AND JOUBERTINA (KM 79.00)

PROJECT NUMBER: SANRAL R.062-060-2021/2F