

NOTE: ALL HVAC UNITS TO SWITCH OFF IN THE EVENT OF FIRE. SINGLE PHASE FANS TO BE INTERCONNECTED TO LIGHTING. WHICH SHALL BE CONTROLLED BY MOTION SENSOR. FANS SHALL HAVE STOP/START BUTTON. ALLOW OVERLOAD PROTECTION ON ALL FANS

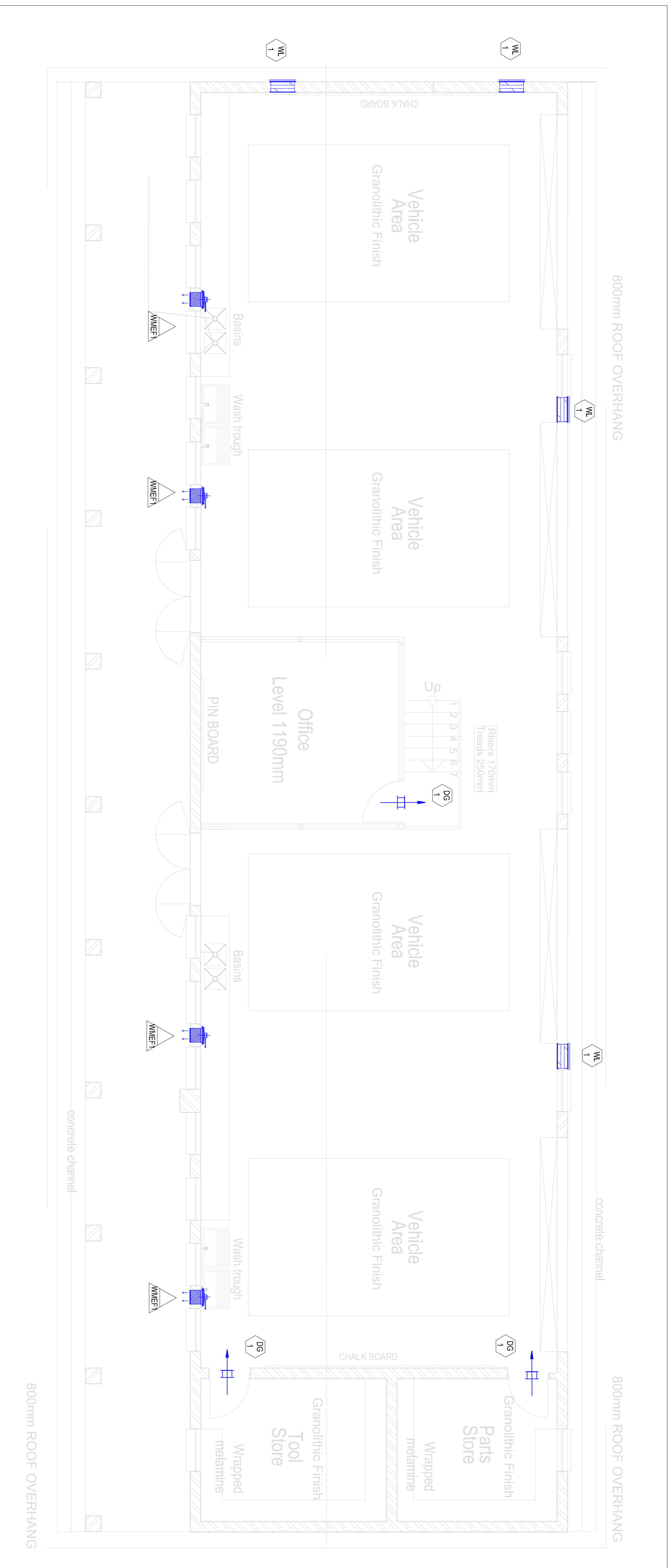

FLOOR PLAN: AUTO BODY WORKS
SCALE 1:50

LEGEND:	
	WMEF WALL MOUNTED EXTRACT FAN
	DG DOOR GRILLE
	WL WEATHER LOUVRE

REV	DATE	DESCRIPTION	ISSUED BY	APPR. BY	SIGNATURE
A	17-07-20	ISSUED MECHANICAL LAYOUT	RB	RB	
B	01-07-21	ISSUED FOR TENDER	RR	RR	

NOTES:

- THIS DRAWING MUST ONLY BE USED FOR THIS MECHANICAL PROJECT. FOR ANY OTHER DETAIL AND BUILDING LAYOUT SEE ARCHITECT'S DRAWING.
- ALL DIMENSIONS MUST BE TAKEN ON SITE.
- THE EXACT POSITION OF EQUIPMENT WILL BE INDICATED ON SITE BY THE MECHANICAL ENGINEER
- DOORS UNDERCUT TO HAVE 25MM UNDERCUT.
- ALLOW 50MM WOODEN SLEEVES ALL ROUND, UNLESS SPECIFIED OTHERWISE.
- ALL FANS SHALL BE INTERCONNECTED WITH FIRE DETECTION SYSTEM AND SHALL SHUT-OFF IN THE EVENT OF FIRE.
- CONTRACTOR TO REPORT UNFORESEEN CLASHES TO THE MECHANICAL ENGINEER.
- THIS DRAWING IS MERELY A GUIDE AND NO DIMENSIONS SHOULD BE TAKEN DIRECTLY FROM IT. ALL DIMENSIONS TO BE VERIFIED ON SITE.
- ALL WORK TO BE DONE IN ACCORDANCE WITH NATIONAL BUILDING REGULATIONS AND BUILDING STANDARDS ACT (ACT 107 OF 1977)
- DUCTING INSTALLATION IN ACCORDANCE TO SANS 1238
- ALL WEATHER LOUVRE OPENINGS COMPLETE WITH 50MM ALL ROUND TIMBER SLEEVE.
- ALL DOOR GRILLES TO BE 305MM ABOVE FFL.
- UNDERSIDE OF ALL TRANSFER GRILLES TO BE 2195MM ABOVE FFL, INCLUDING SLEEVE, UNLESS SPECIFIED OTHERWISE
- HARD-WIRED CONTROLS TO ALL AC UNITS.
- DEDICATED SWITCH FOR EXTRACT FANS AS SPECIFIED BY ELECTRICAL ENGINEER.
- NO GRATING, ANGLE SECTIONS, ETC MAY BE CUT, DRILLED OR WELDED AFTER GALVANIZING
- THE GULLEYS ARE TO BE LINED WITH A SMOOTH EPOXY SUITABLE FOR SERVICE BETWEEN 0° & 90° AND RESISTANT TO IMPACT AND DETERGENTS
- FANS TO BE SWITCHED ON FROM WALL MOUNTED SWITCHES NEXT TO THE LIGHT SWITCHES COORDINATED BY ARCHITECTS AND ELECTRICAL ENGINEER.

CLIENT:



CONSULTANT:



Gauteng Office (Head Office)
GladAfrica House, Herford Office Park
90 Bekker Road, Vorna Valley, Midrand, 1686
P.O. Box 6723, Halfway House, 1685
Tel: +27 11 312 2537/2584
Fax: +27 11 605 1990
www.gladfrica.com

NAME	REG. NO.	SIGNATURE	DATE
DRAWN	C.T.P.K	20140432	
DESIGNED	R.R	20140432	
APPROVED	R.R	20140432	

PROJECT DESCRIPTION
TROMPSBURG SPECIAL SCHOOL : **SCHOOL SECTION**

DRAWING TITLE
AUTOBODY WORKS HVAC LAYOUT

STATUS LEGEND		SHEET SIZE
I	= INFORMATION	A1
CV	= CONCEAL AND VIABILITY	
D	= DESIGN DEVELOPMENT	
T	= TENDER	SCALE
C	= CONSTRUCTION	AS SPECIFIED
AB	= AS BUILT	STATUS
DISCIPLINE	DRAWING NUMBER	REVISION
MECHANICAL	92-ME-AC-005	T B

Air Terminal Schedule				
Mark	Description	Flow(L/S)	Size(WxHxD)	Count
DG 1	Door Grille c/w Vermin Proof Mesh	207.0	425X325	3
WL 1	Weather Louvre Vermin Proof Mesh	450.0	500X600	4

Mechanical Equipment Schedule										
Mark	Description	Cooling Capacity (kw)	Heating Capacity (kw)	Fan Speed (RPM)	Sound (dBA)@3m	Flow (L/s)	Pressure (Pa)	Voltage (V)	Input Current(A)	Count
WMEF 1	Wall Mounted Extract Fan			1400	47	380.0	50.0 Pa	230	0.49	4

FOR TENDER