

TENDERERS CLARIFICATION BRIEFING PRESENTATION

**CONTRACT SANRAL N.001-160-2018/1R
THE UPGRADE OF NATIONAL ROUTE 1 SECTION 16
FROM SCOTTLAND (km 55.7) TO WINBURG SOUTH
(km 78.0)**

&

**CONTRACT SANRAL N.001-160-2025/2R
THE UPGRADE OF NATIONAL ROUTE 1 SECTION 16
FROM ZANDKRAAL (km 33.8) to SCOTTLAND (km
55.7)**

**EASTERN REGION
FEBRUARY 2024**

Tender documents are available at no cost in electronic format downloadable from SANRAL website

Introduction

PLEASE NOTE:

THE CONTENTS OF THE PRESENTATION ARE INTENDED MERELY AS A SUMMARY TO HIGHLIGHT SOME OF THE IMPORTANT ASPECTS OF THE CONTRACT DOCUMENTS.

ANY INCONSISTENCY BETWEEN THE PRESENTATION AND TENDER DOCUMENT, THE TENDER DOCUMENT SHALL PREVAIL UNLESS COMMUNICATED IN AN ADDENDUM

TENDERING PROCEDURES

PART T1: CONDITIONS OF TENDER AND TENDER DATA

TENDERING PROCEDURES

PART T1: CONDITIONS OF TENDER AND TENDER DATA

PREQUALIFICATION REQUIREMENTS

PREQUALIFICATION REQUIREMENTS

CIDB

Estimated 9CE (Refer to 2.1 of Tender Data)

JV: Lead partner at least 8CE, combined JV 9CE

Potential Emerging

NOT Accepted

CIDB REGULATION 25(1B) WILL **NOT** BE APPLICABLE TO THIS CONTRACT

National Treasury Central Supplier Database

CSD registration compulsory

TENDERING PROCEDURES

PART T1: CONDITIONS OF TENDER AND TENDER DATA

Tenderers registered as potentially emerging enterprises but with a CIDB contractor grading designation lower than a contractor grading designation determined in accordance with the sum tendered, or a value determined in accordance with Regulation 25(7A) of the Construction Industry Development Regulations, are not eligible to have their tenders evaluated.

Category of tender	Upper limits per CIDB Regulation 17 (effective 7 October 2019)	Employer's allowable margins
CE 1	R500 000	The Employer will use its discretion in terms of CIDB Practice Note 3 on allowable margins to be accepted
CE 2	R1 000 000	
CE 3	R3 000 000	
CE 4	R6 000 000	
CE 5	R10 000 000	
CE 6	R20 000 000	
CE 7	R60 000 000	
CE 8	R200 000 000	

TENDERING PROCEDURES

PART T1: CONDITIONS OF TENDER AND TENDER DATA

IMPORTANT DATES

SUBMISSION OF FORM A1.1

NB: Failure to submit this certificate would result in the tenderer not receiving addenda or additional issued information and may result in the tenderer being non-responsive.

2 February 2024

SUBMISSION OF QUERIES

**12 working days, 14 February
2024**

TENDER CLOSING DATE

1 March 2024

TENDERING PROCEDURES

PART T1: CONDITIONS OF TENDER AND TENDER DATA

CLAUSE NUMBER	TENDER DATA
2.6	Failure to apply instructions contained in addenda may render a tenderer's offer non-responsive in terms of Condition of Tender C.3.8.
2.8	Request clarifications at least 12 working days before the closing time.

TENDERING PROCEDURES

PART T1: CONDITIONS OF TENDER AND TENDER DATA

CLAUSE NUMBER	TENDER DATA
2.13.5	<p>Only the following needs to be submitted:</p> <p>a) Main Tender Offer The following information to be submitted electronically on flash drive and marked Main Tender Offer followed by the “Tenderer name”, in the following order:</p> <ul style="list-style-type: none">- Form of Offer (signed and scanned as .pdf) and printed hardcopy of Form of Offer- All returnable schedules and attachments and certificates specific to the tender (signed and scanned as .pdf)- Completed pricing schedule (scanned copy in .pdf and copy in Excel) and printed hardcopy of Summary of Pricing Schedule. <p>b) For alternative offers the tenderer shall submit the following additional documentation, in an electronically on a separate flash drive marked Alternative followed by the “Tenderer name”:</p> <ul style="list-style-type: none">- Form of Offer (signed and scanned as .pdf and state “Alternative Form of Offer”) and printed hardcopy of Form of Offer- All returnable schedules and attachments and certificates applicable to the alternative offer (signed and scanned as .pdf)- Alternative Pricing Schedule (scanned copy in .pdf and copy in Excel) and printed hardcopy of Summary of Pricing Schedule.- Other relevant information.

TENDERING PROCEDURES

PART T1: CONDITIONS OF TENDER AND TENDER DATA

CLAUSE NUMBER	TENDER DATA
2.15.1	<p>Location of tender box: Reception</p> <p>Physical address: 58 van Eck Place, Mkondeni, Pietermaritzburg, 3204</p> <p>Identification details: Place the tender offer and flash drive in a package marked with the tenderer's company name, the project number and description: TENDER: CONTRACT NRA N.001-160-20.....<i>(Add project No and description)</i></p> <p>Tenders must be submitted during hours (09:00 to 16:00) Monday to Friday at the Employer's address.</p> <p>It is in the tenderer's interest to ensure that the delivery of the tender offer is recorded in the Employer's tenders received register and deposited in the tender box.</p>

TENDERING PROCEDURES

PART T1: CONDITIONS OF TENDER AND TENDER DATA

CLAUSE NUMBER	TENDER DATA
2.15	Tenders must be submitted during hours (09:00 to 16:00) Monday to Friday at the Employer's address.
2.16.1	The tender offer validity period is: 24 Weeks.
3.4	Opening of tender submissions Opening of tender submissions The time for opening of the tender offer via live streaming are: Time: 11h00 on 1 March 2024. Location: SANRAL Offices, Eastern Region, Pietermaritzburg Refer to opening link in tender documentation

TENDERING PROCEDURES

PART T2: RETURNABLES SCHEDULES

ALL RETURNABLE SCHEDULES

**READ INSTRUCTIONS TO TENDERERS ON
THE RETURNABLE FORMS AND DULY
COMPLETE**

**FOR JOINT VENTURES, READ SPECIFIC
REQUIREMENTS / INSTRUCTION ON
FORMS**

TENDERING PROCEDURES

PART T2: RETURNABLE SCHEDULES

RETURNABLE SCHEDULE FORM A1.1

CERTIFICATE OF INTENTION TO SUBMIT A TENDER

**Complete and submit
FORM A1.1 before 2
February 2024**

N001-160-2018/1R:
Procurement7@sanral.co.za

N001-160-2025/2R:
Procurement2@sanral.co.za

FORM A1.1: CERTIFICATE OF INTENTION TO SUBMIT A TENDER

CONTRACT SANRAL N.001-160-2018/1R
FOR THE UPGRADE OF NATIONAL ROUTE 1 SECTION 16 FROM SCOTTLAND (km 55.7) TO
WINBURG SOUTH (km 78.0)

Notes to Tenderer:

1. The duly completed certificate of intention to submit a tender must be submitted by whoever intends to tender for this particular tender prior to 2 February 2024. Failure to submit the certificate of intention to tender within the required period may render the tenderer non-responsive and SANRAL does not accept responsibility for any communication not received by the tenderer timeously.
2. Failure to submit this certificate would result in the tenderer not receiving addenda or additional issued information and may result in the tenderer being non-responsive if "any material amendment/s" contained in the addenda or additional information is not included in the tender offer/submission.
3. Late notification of intention to tender by a prospective tenderer will not necessarily result in the tender closing date being extended.
4. Should you intend to submit a tender for this particular tender please sign the certificate, scan and email the completed document to the email address indicated in T1.1 of this tender document.
5. The Employer shall send all correspondences, including Addenda, only to the Tenderer's email address as provided herein; in addition, the Employer shall upload all correspondences on SANRAL website and National Treasury eTender Portal.

This is to certify that I,

representative of (insert name of tenderer)

of (address)

telephone number

fax number

e-mail:

intends to submit a tender in response to the tender notice and invitation for tender this contract.

TENDERER'S REPRESENTATIVE (Signature):

DATE:

TENDERING PROCEDURES

PART T2: RETURNABLE SCHEDULES

RETURNABLE SCHEDULE FORM A1

CERTIFICATE CONFIRMING THAT THE
TENDERER READ THE PRESENTATION
BRIEFING ONLINE

FORM A1: CERTIFICATE CONFIRMING THAT THE TENDERER READ THE PRESENTATION BRIEFING

CONTRACT SANRAL N.001-160-2018/1R
FOR THE UPGRADE OF NATIONAL ROUTE 1 SECTION 16 FROM SCOTTLAND (km 55.7) TO
WINBURG SOUTH (km 78.0)

This is to certify that I,

representative of (tenderer)

of (address).....

telephone number

fax number

e-mail

read the clarification presentation presented by the Employer online.

TENDERER'S REPRESENTATIVE (Signature).....

FORM A3.5: DECLARATION CERTIFICATE FOR LOCAL PRODUCTION AND CONTENT FOR DESIGNATED SECTORS (SBD 6.2)

Applicable local content

- Steel – 100%
- Plastic Pipes – 100%
- Textiles – 100%
- Cement – 100%

FORM A3.5: DECLARATION CERTIFICATE FOR LOCAL PRODUCTION AND CONTENT FOR DESIGNATED SECTORS (SBD 6.2)

NB!!!!

- (a) The facts contained herein are within my own personal knowledge.
- (b) I have satisfied myself that the goods/services/works to be delivered in terms of the above-specified bid comply with the minimum local content requirements as specified in the bid, and as measured in terms of SANS 1286:2017; and
- (c) The local content percentage (%) indicated below has been calculated using the formula given in clause 3 of SANS 1286:2017, the rates of exchange indicated in paragraph 3.1 above and the information contained in Declarations D and E which has been consolidated in Declaration C:

Bid price, excluding VAT (y)	R
Imported content (x), as calculated in terms of SATS 1286:2011	R
Stipulated minimum threshold for local content (paragraph 2 above)%
Local content %, as calculated in terms of SATS 1286:2011%

If the bid is for more than one product, the local content percentages for each product contained in Declaration C shall be used instead of the table above.

The local content percentage for each product has been calculated using the formula given in clause 3 of SANS 1286:2017, the rates of exchange indicated in paragraph 3.1 above and the information contained in Declarations D and E.

Complete Form A3.6 for each product

TENDERING PROCEDURES

PART T2: RETURNABLE SCHEDULES

FORM A3.6: LOCAL CONTENT DECLARATION: SUMMARY SCHEDULE (ANNEXURE C) (Separate spreadsheet issued for tenderers use)

FORM A3.6: LOCAL CONTENT DECLARATION: SUMMARY SCHEDULE (ANNEXURE C)

CONTRACT SANRAL N.001-160-2025/2R

FOR THE UPGRADE OF NATIONAL ROUTE 1 SECTION 16 FROM ZANDKRAAL (km 33.8) to SCOTTLAND (km 55.7)

C1	Tender No.:								Note: VAT to be excluded from all calculations
C2	Tender Description:								
C3	Designated Product(s):								
C4	Tender Authority:								
C5	Tendering Entity Name:								
C6	Tender Exchange Rate:	Pula	P	EU	€	GBP	£	OTHER (stipulate)	

Tender Item No.'s	List of Items	Calculation of Local Content						Tender Summary			
		Tender Price Each (Excl. VAT)	Exempted Imported Value	Tender Value Net of Exempted Imported Content	Imported Value	Local Value	Local Content % (Per Item)	Tender Qty	Total Tender Value	Total Exempted Imported Content	Total Imported Content
(C8)	(C9)	(C10)	(C11)	(C12)	(C13)	(C14)	(C15)	(C16)	(C17)	(C18)	(C19)
Tenderer to complete the table in the attached electronic Excel file.											

Signature of tenderer from Annex B (SATS 1286.2011)

Date: _____

(C20) Total Tender Value	R	
(C21) Total Exempt Imported Content	R	
(C22) Total Tender value net of exempt imported content	R	
(C23) Total Imported Content	R	
(C24) Total Local Content	R	
(C25) Average Local Content % of tender	...	%

FORM A8:TENDERER'S REGISTERED FINANCIAL SERVICE PROVIDER LETTER AND BANK DETAILS

Notes to tenderer:

The tenderer **shall attach to this form:**

- **Option 1: a letter (dated less than 3 months prior to the tender closing date) from a registered Financial Service Provider (registered with the FSB), OR**
- **Option 2: a letter (dated less than 3 months prior to the tender closing date) from the tenderer's independent registered accountant, OR**
- **Option 3: a letter (dated less than 3 months prior to the tender closing date) from the tenderer's financial sponsorship.**

Refer to the submission requirements on Form A8 for each of the options above.

The Tenderer (and in the event of a joint venture, the joint venture member's combined) shall have available capital in excess of **R 75 000 000 (N001-160-2018/1R)** or **R 65 000 000 (N001-160-2025/2R)**.

Refer to all requirements on Form A8.

FORM A9.3: COMPLIANCE WITH LABOUR LEGISLATION DECLARATION

Notes to tenderer:

1. Tenderers must be registered with the Bargaining Council for the Civil Engineering Industry (BCCEI) or the relevant Bargaining Council.
2. Tenderers must append a letter of compliance / letter of good standing in terms of the relevant Government Gazette that indicates compliance/validity at the time of tender or obtain such upon being requested to do so in writing and within the period contained in such a request, failing which their tenders will be declared non-responsive.
3. Only those tenders submitted by tenderers who are in good standing with the BCCEI or any relevant applicable legislated bargaining council at the time of the tender award will be declared responsive.
4. Each party to a Consortium/Joint Venture shall append separate certificates for each party in the above regard.
5. The tenderer, by signing this schedule, declares that it will comply with all labour legislation, as may be applicable.

FORM B2: SCHEDULE OF SPECIAL MATERIALS

Only **net bitumen** shall be considered a special material

SPECIAL MATERIAL	UNIT*	RATE OR PRICE FOR THE BASE MONTH
Bitumen (Net bitumen content)	Ton	As stated on supplier's letter attached to this form.

FORM C1.1: TENDERER'S B-BBEE VERIFICATION CERTIFICATE

FORM C1.1: TENDERER'S B-BBEE VERIFICATION CERTIFICATE

Notes to tenderer:

1. The tenderer shall attach to this form a valid B-BBEE verification certificate issued in accordance with:
 - the amended Construction Sector Codes published in Notice 931 of 2017 of Government Gazette No. 41287 on 1 December 2017 by the Department of Trade and Industry.
 - ~~in the event that~~ the Measured Entity operates in more than one sector or sub-sector, the scorecard for the sector or sub-sector in which the majority of its core activities (measured in terms of Annual Revenue) are located will be acceptable. The tenderer must comply with the annual revenue thresholds for EME or QSE or Generic in accordance with the amended Construction Sector Codes.
2. The certificate shall:
 - have been issued by a verification agency accredited by the South African National Accreditation System (SANAS); or
 - be in the form of ~~a sworn affidavit~~ or a certificate issued by the Companies and Intellectual Property Commission in the case of an Exempted Micro Enterprise (EME) with a total annual revenue of less than R3 million if issued in accordance with the amended Construction Sector Codes published in Notice 931 of 2017 of Government Gazette No. 41287 on 1 December 2017 by the Department of Trade and Industry; and
 - be valid at the original advertised tender closing date; and
 - have a date of issue less than 12 (twelve) months prior to the tender closing date (see Tender Data C.2.15).
3. If the B-BBEE Certificate is not valid,
4. A valid BBBEE Certificates shall contain:
 - Name of enterprise as per enterprise registration documents issued by CIPC, and enterprise business address.
 - Value-Added Tax number, where applicable.
 - The B-BBEE Scorecard against which the certificate is issued, indicating all elements and scores achieved for each element. The actual score achieved must be linked to the total points as per the relevant Codes.
 - B-BBEE status with corresponding procurement recognition level.
 - The relevant Codes used to issue the B-BBEE verification certificate.
 - Date of issue and expiry (~~e.g.~~ 9 June 2018 to 8 June 2019). Where a measured entity was subjected to a re-verification process, due to material change, the B-BBEE Verification Certificate must reflect the initial date of issue, date of re-issue and the initial date of expiry. Re-verification does not extend the lifespan of the B-BBEE Verification Certificate.
 - Financial period which was used to issue the B-BBEE Verification Certificate
5. A valid Sworn Affidavit shall contain:
 - Name/s of deponent as they appear in the identity document and the identity number.
 - Designation of the deponent as either the director, owner or member must be indicated ~~in order to know that person is duly authorised to depose of an affidavit.~~
 - Name of enterprise as per enterprise registration documents issued by the CIPC, where applicable, and enterprise business address.
 - Percentage black ownership, black female ownership and whether they fall within a designated group.
 - Indicate total revenue for the year under review and whether it is based on audited financial statements or management accounts.
 - Financial year-end as per the enterprise's registration documents, which was used to determine the total revenue. The valid format of the Financial Year-End is Day/Month/Year
 - B-BBEE status level. An enterprise can only have one status level.
 - Date deponent signed and date of Commissioner of Oath must be the same.
 - Commissioner of Oath cannot be an employee or ex officio of the enterprise because, a person cannot by law, commission a sworn affidavit in which they have an interest, and

6. In the event of a Joint Venture (JV), a project specific (SANRAL project number indicated) consolidated B-BBEE verification certificate in the name of the JV, shall be attached.
7. The attached verification certificate and the associated assessment report shall comply with the requirements of Tender Data clause C.3.11.8 and shall identify:
 - (a) The name and ~~domicilium citandi et executandi~~ of the tenderer.
 - (b) The registration and VAT number of the tenderer.
 - (c) The dates of granting of the B-BBEE score and the period of validity.
 - (d) The expiry date of the verification certificate.
 - (e) A unique identification ~~number~~.
 - (f) The standard and/or normative document, including the issue and/or revision used to evaluate the tenderer.
 - (g) The name and/or mark/logo of the B-BBEE verification agency.
 - (h) The category (Generic, QSE, EME) in which the tenderer has been measured.
 - (i) The B-BBEE status level.
 - (j) The South African National Accreditation System (SANAS) logo on the verification certificate once verification agencies have been accredited.
 - (k) The B-BBEE procurement recognition level.
 - (l) The score achieved per B-BBEE element.
 - (m) The % black shareholding.
 - (n) The % black women shareholding.
 - (o) The % black persons with disabilities shareholding
 - (p) The % black youth shareholding
 - (q) The % black people living in rural or underdeveloped areas or townships shareholding
 - (r) The % black military veterans shareholding
 - (s) The value-added status of the tenderer.
8. The Employer will not be responsible to acquire data that it needs for its own reporting ~~systems~~ and which may not form part of a verification agency's standard certificate format. The tenderer, at its own cost, must acquire any missing specified data listed in 4 above from its selected verification agency and have it recorded on the certificate. Alternatively, such missing data must be supplied separately, but certified as correct by the same verification agency ~~and also~~ attached to this form.

FORM C1.2: PREFERENCE POINTS CLAIM FORM IN TERMS OF THE PREFERENTIAL PROCUREMENT REGULATIONS 2017 (INCORPORATING SBD6.1)

	POINTS
PRICE	90
SPECIFIC GOALS	10
Total points for Price and Specific Goals	100

90/10

$$Ps = 90 \left(1 - \frac{Pt - P_{min}}{P_{min}} \right)$$

The specific goals allocated points in terms of this tender	Criteria	Number of points allocated (90/10 system)	Number of points claimed (90/10 system) (To be completed by the tenderer)
B-BBEE level scorecard of the tendering entity.	B-BBEE Level 1	10.00	
	B-BBEE Level 2	9.00	
	B-BBEE Level 3	6.00	
	B-BBEE Level 4	5.00	
	B-BBEE Level 5	4.00	
	B-BBEE Level 6	3.00	
	B-BBEE Level 7	2.00	
	B-BBEE Level 8	1.00	
	Non-compliant contributor	0.00	

FORM D1: SCHEDULE OF TENDERER'S PLANT AND EQUIPMENT

Notes to tenderer:

The tenderer shall state below the number of each construction plant to be used on this project and what constructional plant will be immediately available for this contract, what constructional plant will become available by virtue of outstanding orders, and what further constructional plant will be acquired or hired for the work should the tenderer be awarded the contract

FORM D2: TENDERER'S METHOD STATEMENT

Notes to tenderer:

The method statement must respond to the Scope of Work and Project Information under Part C4 and outline the proposed approach/methodology. The method statement should articulate what value the Tenderer will add by in achieving the stated objectives for the project.

FORM D3: TENDERER'S ORGANISATION AND STAFFING

Notes to tenderer:

The intention of this form is to demonstrate the tenderer's project structure, as well as the lines of responsibility between members of the project team and between the project team and the overall company structure. Attach own organogram to this form; do not populate the example diagram

FORM D4.1: TENDERER'S KEY PERSONNEL EXPERIENCE (**CONTRACTS DIRECTOR**)

Notes to tenderer:

The Contracts Director must meet the following minimum requirements as stipulated and the tenderer must append proof of registration to this form:

- SACPCMP as PrCM or
- ECSA as PrEng or
- ECSA as PrTechEng

- Minimum 15 years relevant experience

FORM D4.2: TENDERER'S KEY PERSONNEL EXPERIENCE (**CONTRACTS MANAGER**)

Notes to tenderer:

The Contracts Manager must meet the following minimum requirements as stipulated and the tenderer must append proof of registration to this form:

- SACPCMP as PrCM or
- ECSA as PrEng or
- ECSA as PrTechEng

- Minimum 10 years relevant experience

FORM D4.3: TENDERER'S KEY PERSONNEL EXPERIENCE (**CONSTRUCTION MANAGER / CONTRACTOR'S REPRESENTATIVE**)

Notes to tenderer:

The Construction Manager (Contractor's Representative) must meet the following minimum requirements as stipulated and the tenderer must append proof of registration to this form:

- SACPCMP as PrCM or
- ECSA as PrEng or
- ECSA as PrTechEng

- Minimum 10 years relevant experience

FORM D5.1: TENDERER'S EXPERIENCE BASED ON COMPLETED PROJECTS

Notes to tenderer:

1. The tenderer shall provide details of previous experience required for this project and attach contract performance evaluation certificates or reference letters from the previous Employer.
2. The Tenderer must have satisfactorily completed (at least completed as a prime contractor, joint venture member, management contractor or sub-contractor) a minimum number of **3** similar contracts matching the subject project's scope of work, between 1st January 2008 and tender submission deadline. **2 completed contracts must have a minimum value that exceeds R 200 000 000 and 1 exceeding R400 000 000 (incl. VAT)** and have a Performance Rating not less than zero (0) Adequate, as rated in terms of the CIDB Performance Rating system

FORM D5.2: TENDERER'S EXPERIENCE BASED ON PROJECTS IN PROGRESS

Notes to tenderer:

Submission of this form is optional. This form must be submitted if the tenderer does not comply with the requirements of Form D5.1, and elects to list projects that are in progress to comply with afore- mentioned requirements.

Each listed project in progress must have a certified value of work that exceeds **80% of the award value and exceeds the minimum values of Form 5.1 (2 projects > 200 million and 1 project > 400 million)**

FORM D6: TENDERER'S INDICATIVE PROGRAM

Notes to tenderer:

1. The tenderer shall attach an indicative programme, reflecting the:
 - Contract period;
 - proposed sequence or order of execution of the work;
 - Resources anticipated; and
 - tempo of execution of the various activities comprising the work for this contract
2. The programme shall be in accordance with the information provided in Form D1: Schedule of Tenderer's Plant and Equipment, Form D2: Tenderer's Method Statement, Form D7: Schedule of Estimated Monthly Expenditure, Form D8: Schedule of Subcontractors, and with all other aspects of the tender

FORM F1: SCHEDULE OF TENDER COMPLIANCE

Notes to tenderer:

This form has been created as an aid to ensure a tenderer's compliance with the completion of the returnable forms and schedules.

QUERIES

All Queries related to this tender are to be addressed only to the SANRAL Procurement Officer:

N001-160-2018/1R:

E-Mail: Procurement7@sanral.co.za

N001-160-2025/2R:

E-Mail: Procurement2@sanral.co.za

CONDITIONS OF CONTRACT

The Conditions of Contract for Construction (1999 edition) published by the Federation Internationale des Ingenieurs-Conseils (FIDIC), as amended, shall apply to this contract. The amendments are those published by FIDIC and reproduced hereafter, together with additional amendments (particular conditions of contract) as prescribed by the South African National Roads Agency SOC Limited

PART B: PARTICULAR CONDITIONS OF CONTRACT

PART B: PARTICULAR CONDITIONS OF CONTRACT

APPENDIX TO TENDER

Time for Completion	N001-160-2018/1R – 42 months N001-160-2025/2R – 36 months (including 3 months Mobilisation period)
Defects notification period	12 calendar months
Mobilisation Period	3 months
Performance Security	10% Excluding VAT

PART B: PARTICULAR CONDITIONS OF CONTRACT

APPENDIX TO TENDER

Special non-working hours/days

- (a) Public holidays (including foreseeable election days)
- (b) Annual shut-down period December and January
- (c) Day before Easter Weekend as well as Easter weekend
- (d) Other non-working days and restricted working hours specified in clause A1.2.7.1 of the project specifications
- (e) Sundays
- (f) Between sunset and sunrise

SECTION C: Environmental Management Plan

SECTION C: ENVIRONMENTAL MANAGEMENT PLAN

A dedicated DEO will be required.

Refer to Volume 7 for the Environmental Management Plan.

SECTION D: Stakeholder & Community Liaison, and Targeted Labour and Targeted Enterprise Utilisation and Development

The scope of the work described in this Section D of the Specifications shall be based on the Employer's 14 principles for project liaison, sub-contracting and labour sourcing in all SANRAL projects, which are stipulated in Section D

- **CPG Plan to be submitted and approved early in mobilisation period**
- **Tender processes required for TE procurement**
- **Access to site can only be granted after acceptance of CPG plan and appointment of first TE**
- **Allowance in BOQ for training**

SECTION D – CPG goals

CPG for Targeted Labour:	Minimum of 8%
Black people who are youth	30% of targeted labour value
Black people who are persons with disabilities	0.5% of targeted labour value
Black women	30% of targeted labour value

CPG for Targeted Enterprise	Minimum of 30% of the Final Contract Value by the end of the contract to Targeted Enterprises.	Targeted Enterprise minimum contribution by the following Target Groups:	
	The Final Contract Value for purposes of this clause, is defined in clause D1003.04.	Targeted Enterprise with ≥51% ownership by Youth	Minimum of 5% of the Final Contract Value
		Targeted Enterprise with ≥51% ownership by Women	Minimum of 5% of the Final Contract Value
		Targeted Enterprise with ≥51% ownership by Military veterans	Minimum of 1% of the Final Contract Value
		Targeted Enterprise with ≥51% ownership by Disabled persons (Differently abled)	Minimum of 0.5% of the Final Contract Value
		Targeted Enterprise with CIDB 1 or 2 grading	Minimum of 1% of the Final Contract Value
		Targeted Enterprise with CIDB 3 or 4 grading	Minimum of 1% of the Final Contract Value

SECTION E: Requirements of the OHS Act and Regulations

SECTION E: REQUIREMENTS OF THE OCCUPATIONAL HEALTH AND SAFETY ACT AND REGULATIONS

The Base Line Risk Assessment is included in section E, clause E1018 of this document.

Main risks:

- **Traffic accommodation**
- **Construction vehicles operating on the heavily trafficked road**
- **Hot bituminous binder and hot asphalt**
- **COVID 19 transmission**
- **Working at a heights**

SCOPE OF WORKS

LOCALITY PLAN

CONTRACT No. N001-160-2025/2R

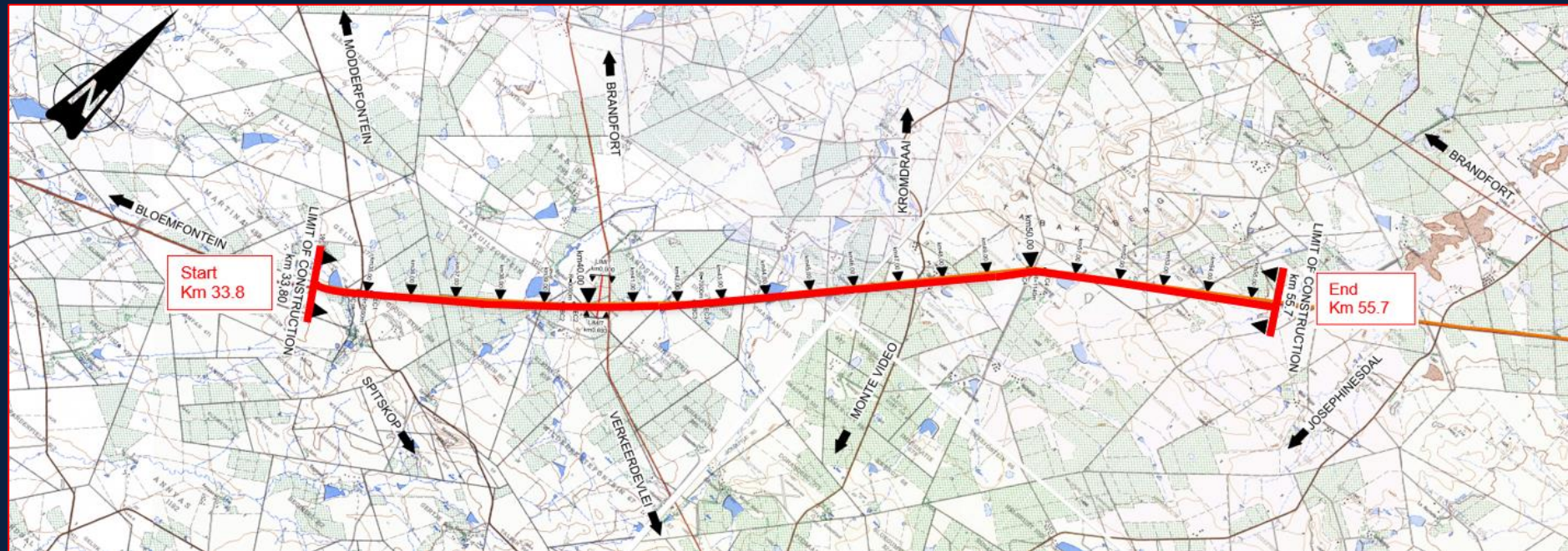

ZANDKRAAL (KM 33.8) TO SCOTTLAND (KM 55.7)

LOCALITY PLAN

CONTRACT No. N001-160-2018/1R



SCOTTLAND (KM 55.7) TO WINBURG SOUTH (KM 78.0)

SCOPE OF WORKS

EXISTING ROAD

The existing road generally comprises a single-carriageway rural freeway consisting of the following:

- Two surfaced lanes - 3,7 m wide each
- Surfaced shoulders – 2,5 m wide each
- Climbing/passing lanes at regular intervals

The following three provincial roads cross the N1-16 between km 33,8 and km 78:

- S496 (Spitskop)
- R703 (Brandfort)
- S502 (Kromdraai)

SCOPE OF WORKS

GEOMETRIC IMPROVEMENTS

- The existing road will be upgraded and rehabilitated to form the new southbound carriageway of the new dual carriageway freeway.
- A completely new northbound carriageway (“greenfields”) will be constructed on the west side of the existing road.
- Major earthworks are required for the new northbound carriageway in order to meet the above requirements.

SCOPE OF WORKS

GEOMETRIC IMPROVEMENTS

The new dual-carriageway road will comprise the following cross-section:

- 2 x 3.7m lanes per carriageway
- 2.5m outer surfaced shoulders
- 1.0m inner surfaced shoulders
- 0.5m outer gravel shoulders in areas of fill lower than 3m
- 1.5m outer gravel shoulders in areas of fill higher than 3m to provide for guardrails
- 0.6m inner gravel shoulders
- 7.4m median

DUAL CARRIAGEWAY 4-LANE DIVIDED

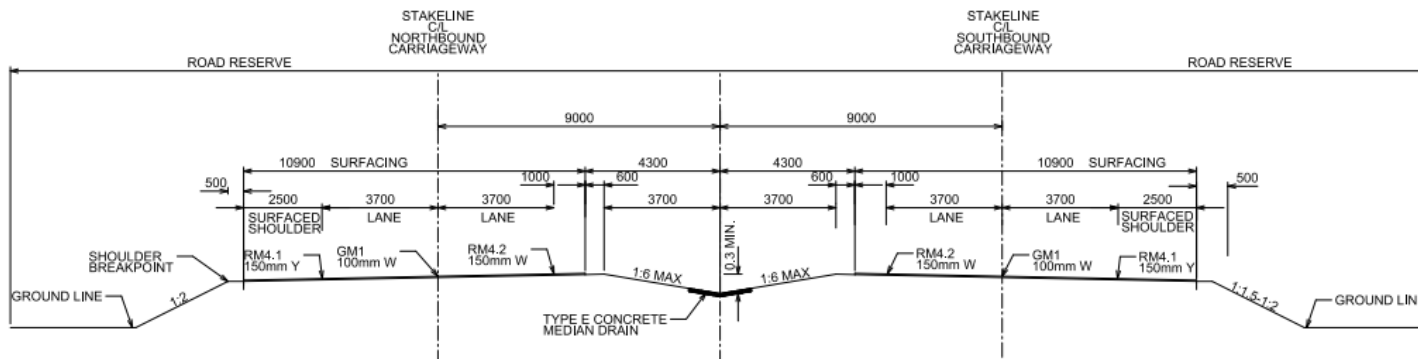

SCOPE OF WORKS

GEOMETRIC IMPROVEMENTS

N.001-160-2025/2R

- The Spitskop and Kromdraai intersections will be upgraded by adding sheltered right turning lanes and by providing a 30m median refuge area.
- The existing Brandfort intersection will be upgraded to a simple diamond interchange which makes provision for future Par-Clo N1 on-ramps.

N.001-160-2018/1R

- The Candy intersection (km 59.0) will be upgraded to an intersection with a 30m median refuge area, providing a sheltered right turn in the median.

SCOPE OF WORKS

EXISTING PAVEMENT

The pavement structure of the existing road generally comprises the following:

- Bitumen rubber double seal
- 40mm Continuously graded asphalt
- 150mm G1 Base
- 300mm C3 Subbase
- 150mm G7 Upper Selected (on previous widenings only)
- 150mm G9 Upper Selected (on previous widenings only)

SCOPE OF WORKS

NEW PAVEMENT DESIGN

The new pavement design for the dual carriageway road is summarised below.

Layer	New Northbound Carriageway	Rehabilitation of existing carriageway (new Southbound Carriageway)
Surfacing	20mm Double seal	
Base	120 mm Asphalt base layer (2 x 60mm)	
Upper sub base	200 mm C3 with imported crushed material	200 mm C3 in-situ recycled
Lower sub base	250mm C3 with imported crushed material	300mm existing C3 subbase layer (remain in place)
Selected layers	Existing pavement layers, or 200mm Upper selected (G7) and 200mm Lower selected (G9) at new road sections	
Lower layers	Existing pavement layers, or Imported fill (G9) at new road sections	
Pioneer layer / Rock fill	Pioneer layer or rockfill where required	

SCOPE OF WORKS

NEW PAVEMENT DESIGN (Cntd...):

- **Contractor shall carry out an additional materials investigation on the roadbed of the northbound carriageway to determine the extent of clay material in the subgrade – See Section A5.1.3.1 of the project specifications**
 - **Where instructed by the Engineer, the selected layers of the northbound carriageway will be stabilized with Nano modified emulsion at areas where swelling clays are present.**
 - **Geogrid to be installed within layerworks at areas with swelling clay.**
- **The Contractor may utilise RA in his new asphalt up to a maximum of 20% binder replacement. Any RA obtained from this project but not used on this project will become the property of the Employer.**

SCOPE OF WORKS

NEW PAVEMENT DESIGN (Ctnd...):

CONTRACT N.001-160-2018/1R

- **The ramps and crossroads of the Kareedam interchange which are not re-aligned shall be overlaid with 45mm asphalt with rolled-in chippings. Construction of re-aligned ramps shall comprise:**
 - **45mm Continuously graded asphalt surfacing with rolled-in chippings**
 - **60mm Asphalt base layer**
 - **200mm C3 Cement stabilized subbase layer**
 - **200mm G7 Upper selected layer**
 - **200mm G9 Lower selected layer**

CONTRACT N.001-160-2025/2R

The pavement design at the Brandfort interchange ramps and crossroad are as follows:

- **45mm Continuously graded asphalt surfacing with rolled-in chippings**
- **60mm Asphalt base layer**
- **200mm C3 Cement stabilized subbase layer**
- **200mm G7 Upper selected layer**
- **200mm G9 Lower selected layer**

SCOPE OF WORKS

NEW PAVEMENT DESIGN (Ctnd...):

CONTRACT N.001-160-2025/2R

A small portion of concrete pavement shall be constructed at the Verkeerdevlei Toll Plaza. The pavement design shall be as follows:

- 200mm Reinforced concrete pavement (doweled jointed)
- 300mm C3 Cement stabilized subbase layer
- 200mm G7 Upper selected layer
- 200mm G9 Lower selected layer

Localised repair work on the existing concrete pavement at the toll plaza to be carried out.

SCOPE OF WORKS

TRAFFIC ACCOMMODATION:

- **Construction of the new northbound carriageway, while traffic is accommodated on the existing road.**
- **The construction of temporary cross-over diversions between the two carriageways will be required after the completion of sections of the northbound carriageway to carry out work on the southbound carriageway.**
- **After the construction of both carriageways, (without the seal, only up to the top of asphalt level), traffic shall be diverted on the southbound carriageway whilst the seal on the entire northbound carriageway is constructed (with final road markings). The seal shall then be constructed in half widths on the southbound carriageway.**
- **One-way (Stop/Go) traffic sections shall only be allowed only for short periods, i.e. for repair works of the existing carriageway, while the northbound carriageway is under construction.**
- **Lane closures on existing and new dual carriageways will sometimes be required, i.e., for tying into the existing dual carriageway and constructing the double seal.**
- **Contractor shall refer to traffic accommodation restrictions listed in A1.2.7.1 should he intend to use RA obtained from this project.**

SCOPE OF WORKS

Drainage Works

- Culvert extensions through northbound carriageway
- Selected culverts to be completely replaced
- Concrete side drains
- Concrete median drains

Ancillary Works

- Guardrails
- Road signs
- Fencing
- Landscaping
- Etc....

SCOPE OF WORKS

QUARRIES

CONTRACT NO - N.001-160-2025/2R

- The Brandkop Quarry is located at Km 50.6 towards the northern end of the contract.



SCOPE OF WORKS

QUARRIES

CONTRACT NO - N.001-160-2018/1R

- The Q1B Quarry is located at Km 78.0 at the Northern end of the contract.



SCOPE OF WORKS

BORROW PITS

The Employer identified the following borrow pits to be utilized:

N.001-160-2025/2R	N.001-160-2018/1R
<ul style="list-style-type: none">• BP 39.6• BP 42.2• BP 42.7• BP 44.5• BP 44.6• BP 51.0• BP 52.8	<ul style="list-style-type: none">• BP 56.3• BP 57.3• BP 64.2• BP 67.3• BP 72.4• BP 72.7• BP 73.8• BP 77.7

- The Contractor is not required to identify borrow pits or quarries
- Refer to Volumes 6 and 7 of the tender document for more information
- Refer to Volume 4 of the tender documents for the borrow pit and quarry drawings

SCOPE OF WORKS

STRUCTURES

CONTRACT SANRAL N.001-160-2025/2R

- **9 Culvert Extensions**
- **Brandfort Interchange B0468 at km 40.28**
- **Helpman Overpass B0416 at km 53.52**

SCOPE OF WORKS

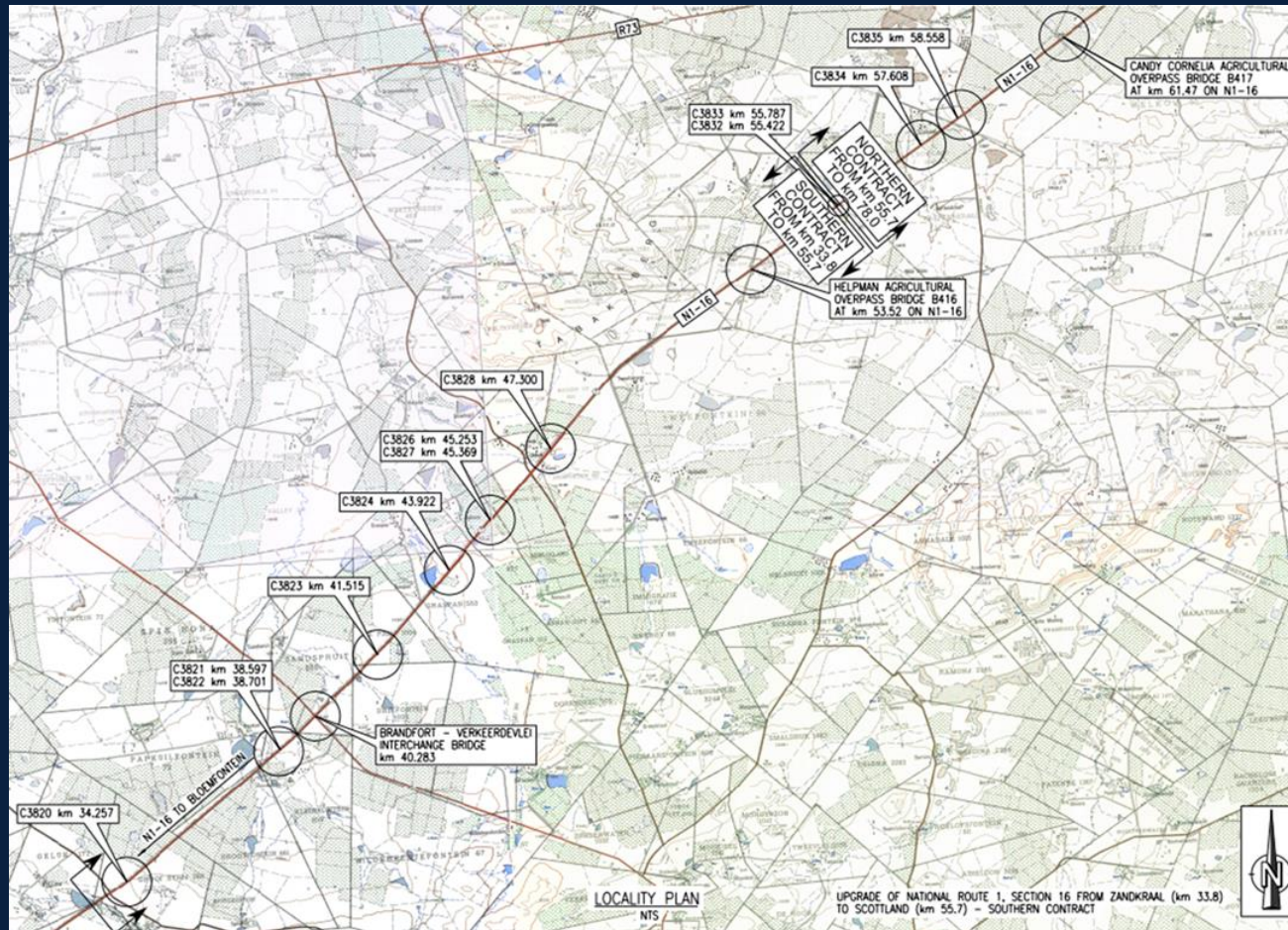

SCOPE OF WORKS

The major culverts structural details

Structure name	SV (km)	No of cells	Barrel size (m)
C3820	34.3	2	3.4 x 2.3
C3821	38.6	2	2.5 x 1.2
C3822	38.7	3	4.0 x 2.0
C3823	41.5	2	3.1 x 1.5
C3824	43.9	2	3.6 x 2.4
C3826	45.2	1	4.0 x 3.6
C3827	45.4	1	2.8 x 1.4
C3828	47.3	3	4.0 x 4.0
C3832	55.4	1	3.8 x 4.0

SCOPE OF WORKS

STRUCTURES (Cntd...):

CONTRACT SANRAL N.001-160-2025/2R

- **Details of the new bridge B0468 Brandfort IC**

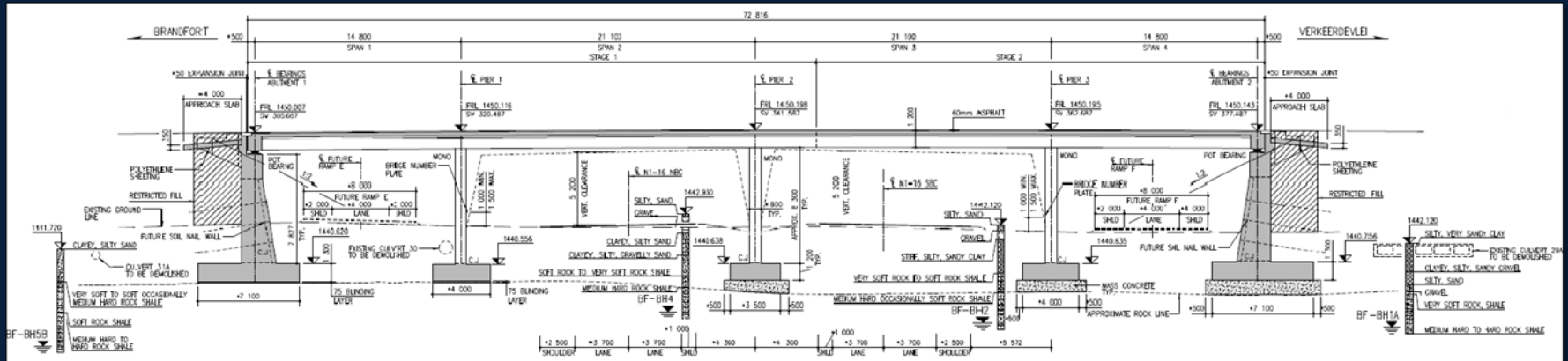

SCOPE OF WORKS

B0468 Brandfort IC

Details:

- **4 spans: 14.8m – 2 x 21m – 14.8m = 73.6m**
- **13 m wide deck**
- **Prestressed cast in-situ twin spine concrete deck**
- **Hexagonal-type piers integral with the deck**
- **Spill through abutments**
- **All supports on spread footings on rock**

SCOPE OF WORKS

B416 Helpman Overpass

Details:

- Existing bridge is a 3 span simply-supported pre-cast beam and slab deck.
- The new bridge will be lengthened to 4 spans: $9.5\text{m} - 2 \times 21\text{m} - 9.5\text{m} = 61\text{m}$
- 4.7 m wide deck
- New span will be a cast in-situ concrete deck
- Hexagonal-type piers
- New abutment is a perched-type on a pad footing

SCOPE OF WORKS

Bridge Rehabilitation:

- Rehabilitation of one (1) bridge
- Main repair activities include:
 - Repairing and reinstating grouted stone pitching
 - Application of protective paint to steel parapet
 - Replacement of asphaltic plug expansion joint with E80 Claw-type joint

SCOPE OF WORKS

CONTRACT SANRAL N.001-160-2018/1R

- **10 Culvert Extensions**
- **Pleasant view Underpass B414A at km 64.81**
- **Harmonia Underpass B415A at km 73.57**
- **Candy Cornelia Overpass B417 at km 61.47**
- **Groot Vet River Bridge B907A at km 65.5**
- **Klein Vet River Bridge B908A at km 74.4**

SCOPE OF WORKS



SCOPE OF WORKS

Culvert structural details

Structure name	SV (km)	No of cells	Barrel size (m)
C3833	55.8	1	3.6 x 1.9
C3834	57.6	2	3.8 x 3.4
C3835	58.6	2	3.0 x 2.1
C3837	68.0	1	2.4 x 2.4
C3839	68.5	1	2.4 x 1.2
C3840	70.4	1	3.8 x 3.8
C3841	75.0	1	3.8 x 3.8
C3842	77.2	1	3.0 x 3.0
C9423	76.8	1	3.8 x 3.8
C9424	77.4	1	3.0 x 3.0

SCOPE OF WORKS

B414A Pleasant view and B415A Harmonia Underpass

Typical longitudinal section:

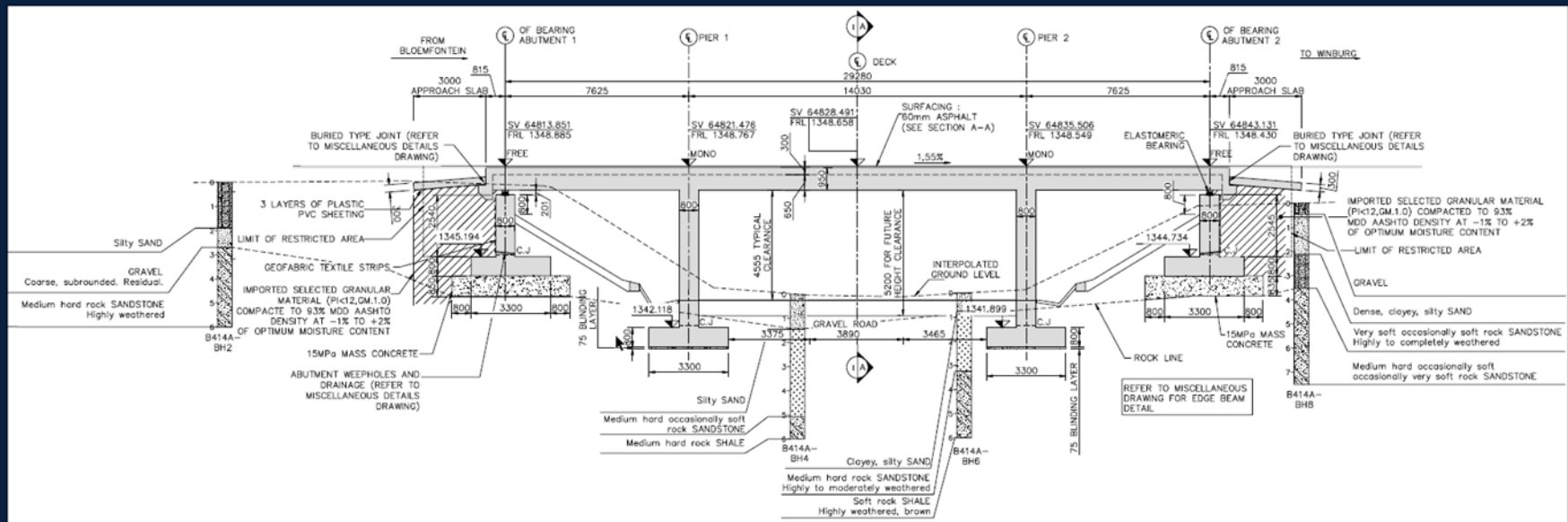

SCOPE OF WORKS

B414A Pleasant view and B415A Harmonia Underpass

Details

- 3 spans : $7.625\text{m} - 14.03\text{m} - 7.625\text{m} = 29.3\text{m}$
- 11.75 m wide deck
- Reinforced concrete deck
- Reinforced concrete piers
- Perched abutments on spread footings founded on rock

SCOPE OF WORKS

B417 Candy Cornelia Overpass

Longitudinal Section:

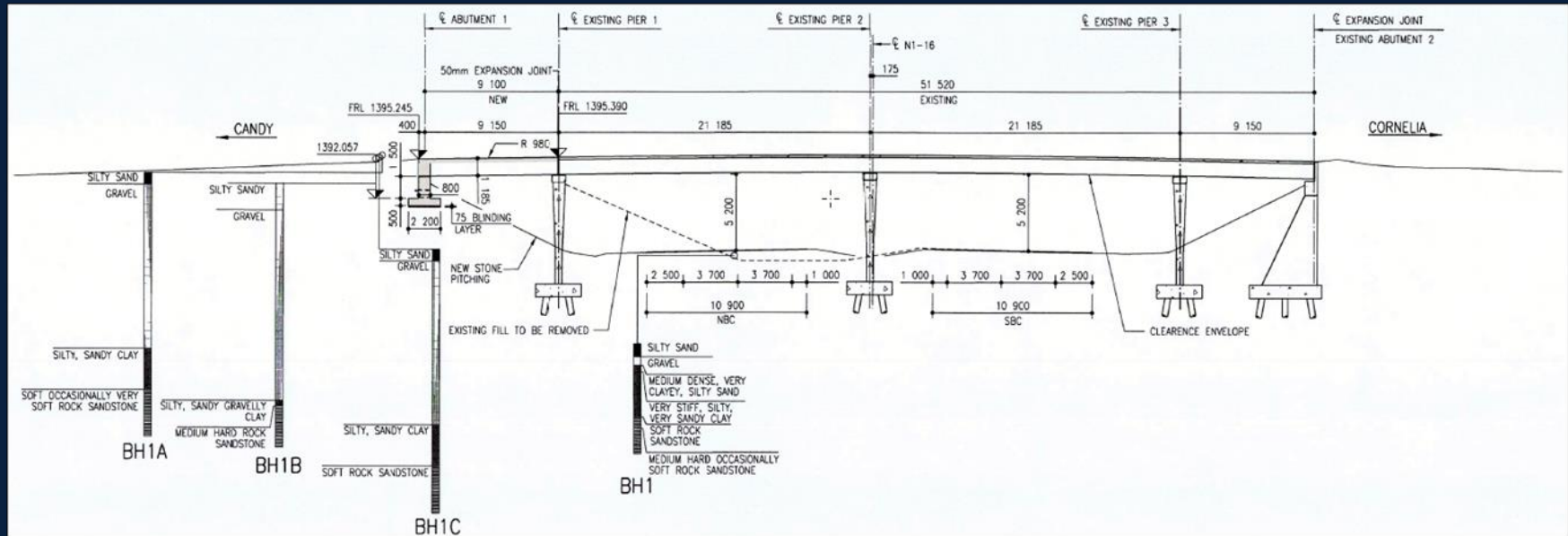

SCOPE OF WORKS

B417 Candy Cornelia Overpass

Details:

- Existing bridge was a 3 span simply-supported pre-cast beam and slab deck
- The new bridge will be lengthened to 4 spans: 9.15m – 2 x 21.19m – 9.15m = 60.7 m
- 6.24 m wide deck
- New span cast in-situ concrete deck
- Hexagonal-type piers
- New abutment is a perched type on a pad footing

SCOPE OF WORKS

B907A Groot Vet River Bridge

Longitudinal Section:

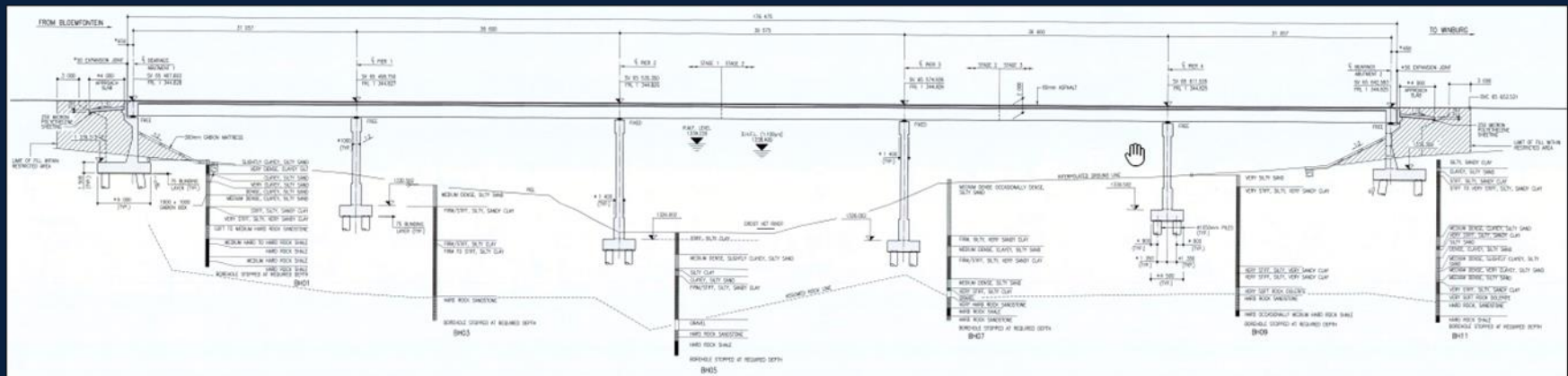

SCOPE OF WORKS

B907A Groot Vet River Bridge

Details

- 5 spans : $31.057\text{m} - 2 \times 36.6\text{m} - 39.575\text{m} - 31.057 = 174.9\text{m}$
- 11.75 m wide deck
- Twin spine prestressed continuous concrete deck
- Wall-type piers and abutments
- Supports founded on 1050 mm diameter piles

Longitudinal Section:



SCOPE OF WORKS

B908A Klein Vet River Bridge

Details

- 7 spans : $17.593\text{m} - 4 \times 24.39\text{m} - 39.62\text{m} - 17.593\text{m} = 172.37\text{m}$
- 11.75 m wide deck
- Twin spine prestressed continuous concrete deck
- Wall-type piers and abutments
- Supports founded on 1050 mm diameter piles

SCOPE OF WORKS

Bridge Rehabilitation

- Rehabilitation of six (6) bridges
- Main repair activities include:
 - Repairing gabion mattresses
 - Replace existing expansion joints
 - Cleaning and refurbishing elastomeric bearings



THANK YOU

SANRAL



BUILDING SOUTH AFRICA
THROUGH BETTER ROADS