

LEASED PREMISES AND OTHER PROPERTY	
LEASED PREMISES	LAND SITUATED ON SUB 21 (OF 8) OF LOT 5333
SURROUNDING PROPERTY	UMHLATUZI LEASE SITES
COMMON AREAS	NEWARK, VENTURA & NORTHMOOR ROADS



LOCALITY PLAN - NTS

LEGEND

- W - WATER ENTRY POINT  
E - ELECTRICAL ENTRY POINT  
S - SEWER ENTRY POINT  
C - COMMUNICATION ENTRY POINT  
SW - STORMWATER ENTRY POINT  
SITE BOUNDARIES PEGS & SERVICE CONNECTIONS TO BE VERIFIED ON SITE BY PORTNET CIVIL ENGINEER

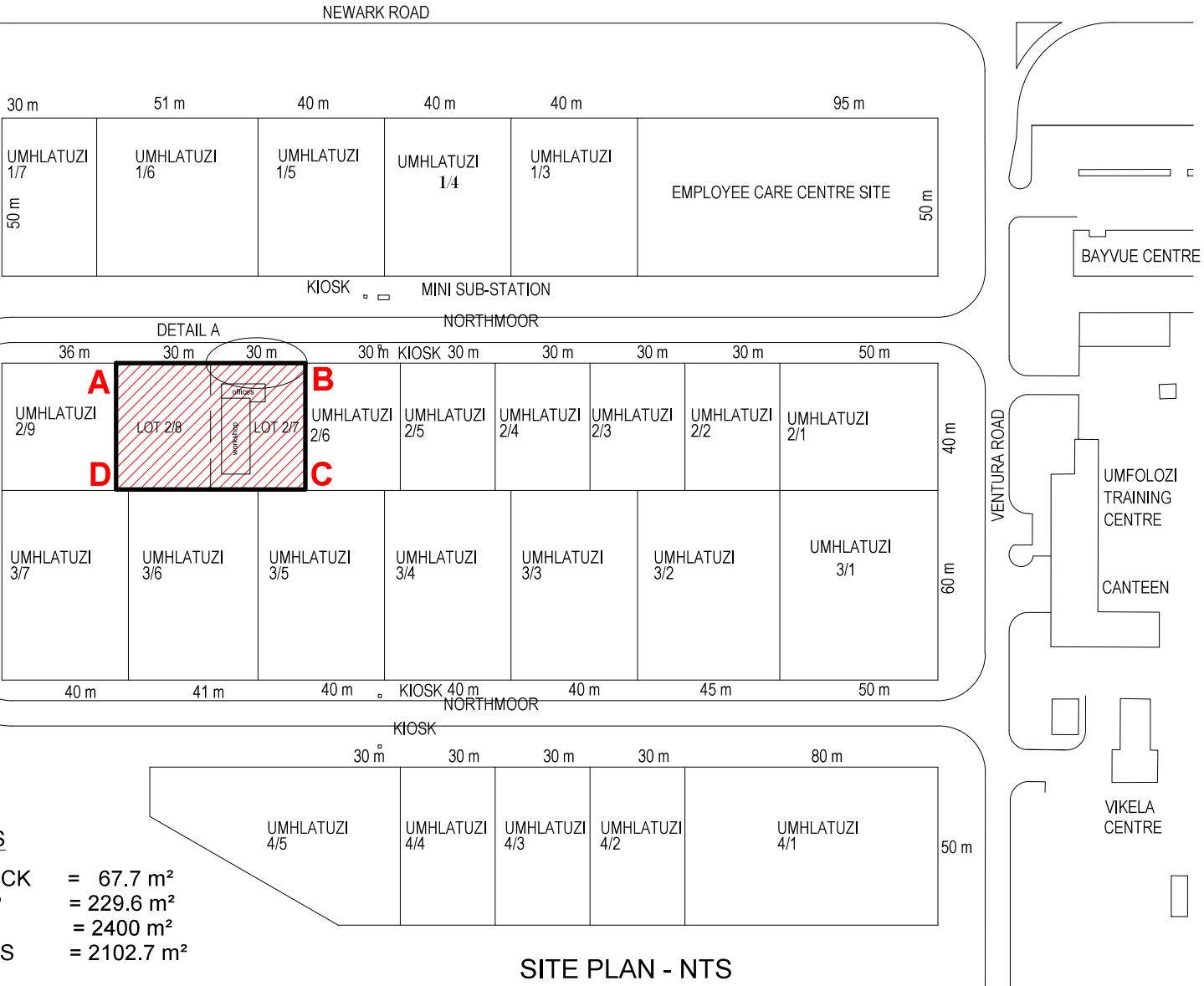

SITE PLAN - NTS

SCHEDULE OF AREAS

AREA OF OFFICE BLOCK	= 67.7 m <sup>2</sup>
AREA OF WORKSHOP	= 229.6 m <sup>2</sup>
AREA OF SITE	= 2400 m <sup>2</sup>
AREA LESS BUILDINGS	= 2102.7 m <sup>2</sup>

SYSTEM Lo 31° EAST

CO-ORDINATE LIST

	Y	X
A	-100 682.52	3 185 707.50
B	-100 742.52	3 185 707.50
C	-100 742.52	3 185 747.50
D	-100 682.52	3 185 747.50

REFERENCE DRAWING :

RBH 86-T-303 - DRIVEWAY DETAIL TYPE A

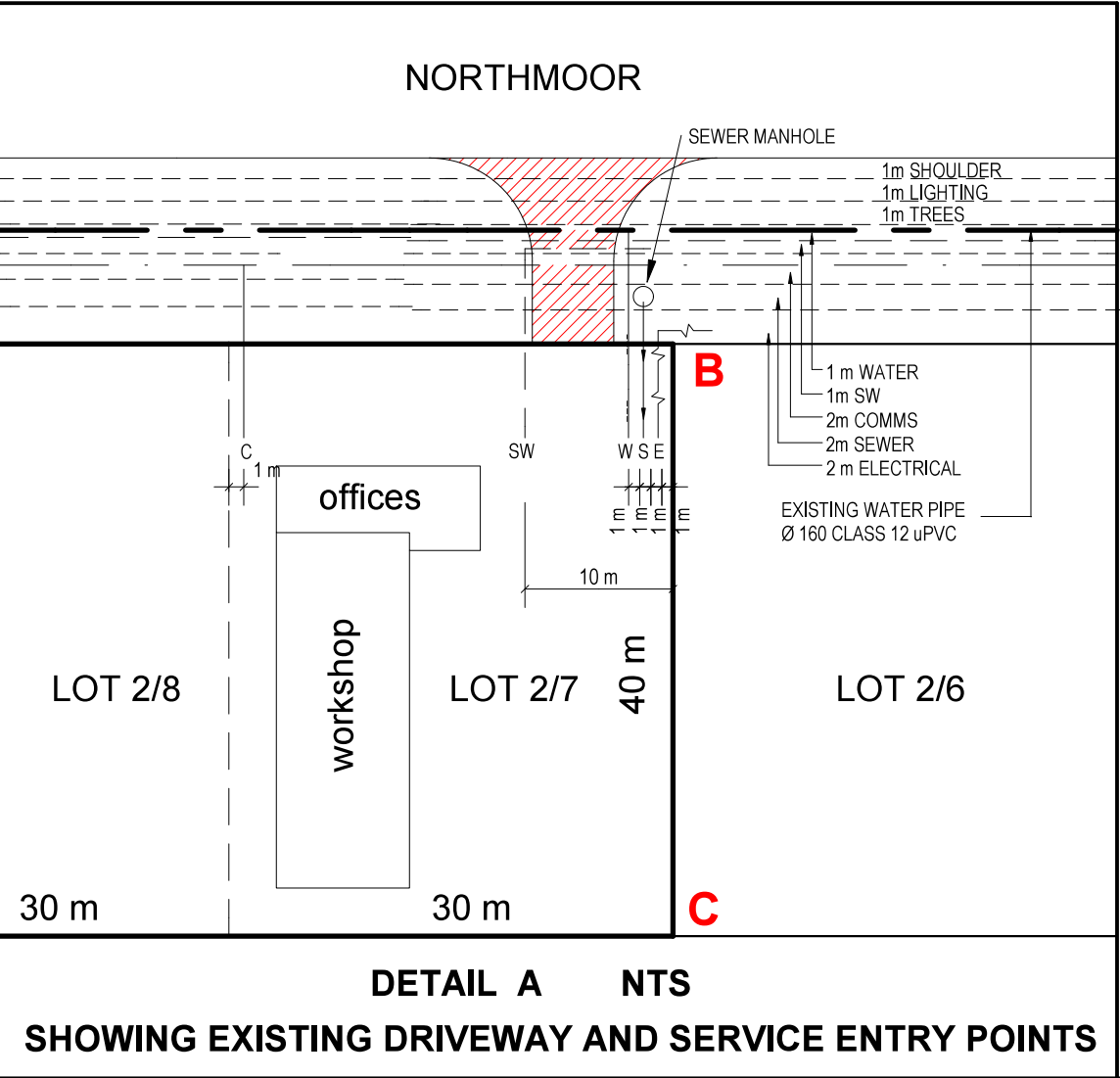

DETAIL A NTS

SHOWING EXISTING DRIVEWAY AND SERVICE ENTRY POINTS

DRAWN	D NAIDOO	CHECKED	
LESSEE		PORT MANAGER	
DATE	DATE	DATE	DATE
<b>TRANSNET</b>			
PORT OF RICHARDS BAY BAYVIEW PRECINCT			
<b>LEASE OF LAND &amp; BUILDING IN EXTENT 2 400 m<sup>2</sup> TO HARBOUR MASTER</b>			
PORT ENGINEER (F W MAGQABI)		AGREEMENT PLAN NOT TO SCALE	
DATE	FILE	DATE	AMEND.
	HPM 2/01/6/3/45	2025-04-15	
0		CAD NO	UMHLATUZI LOT2/7&8 BERTHING
		<b>RBH 86-A-696</b>	