

PLAN OF SEGMENTED PAVING FOR WALKWAY
N.T.S

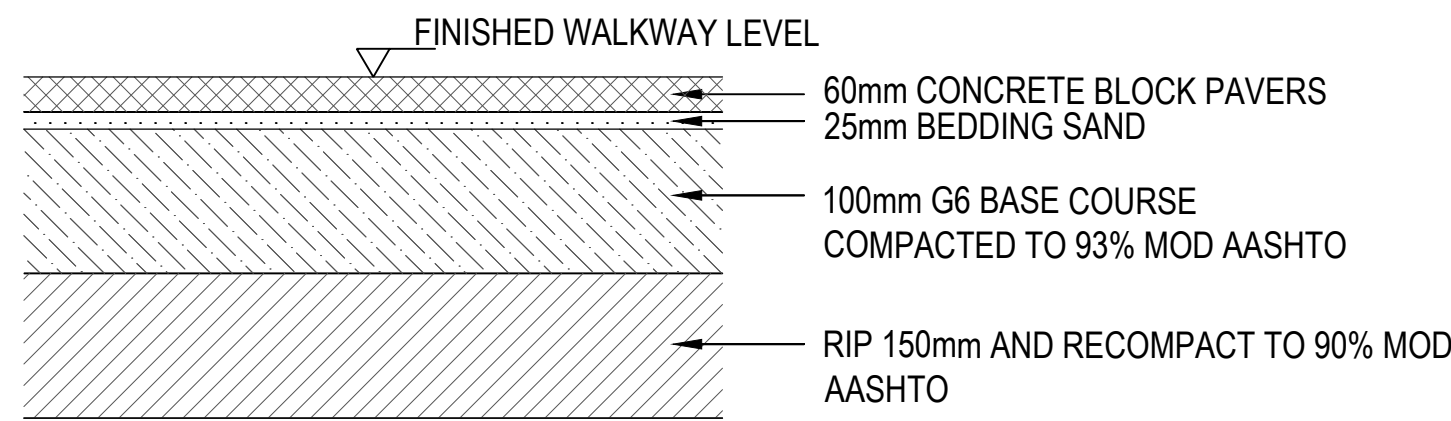

TYPICAL WALKWAY PAVEMENT STRUCTURE
N.T.S

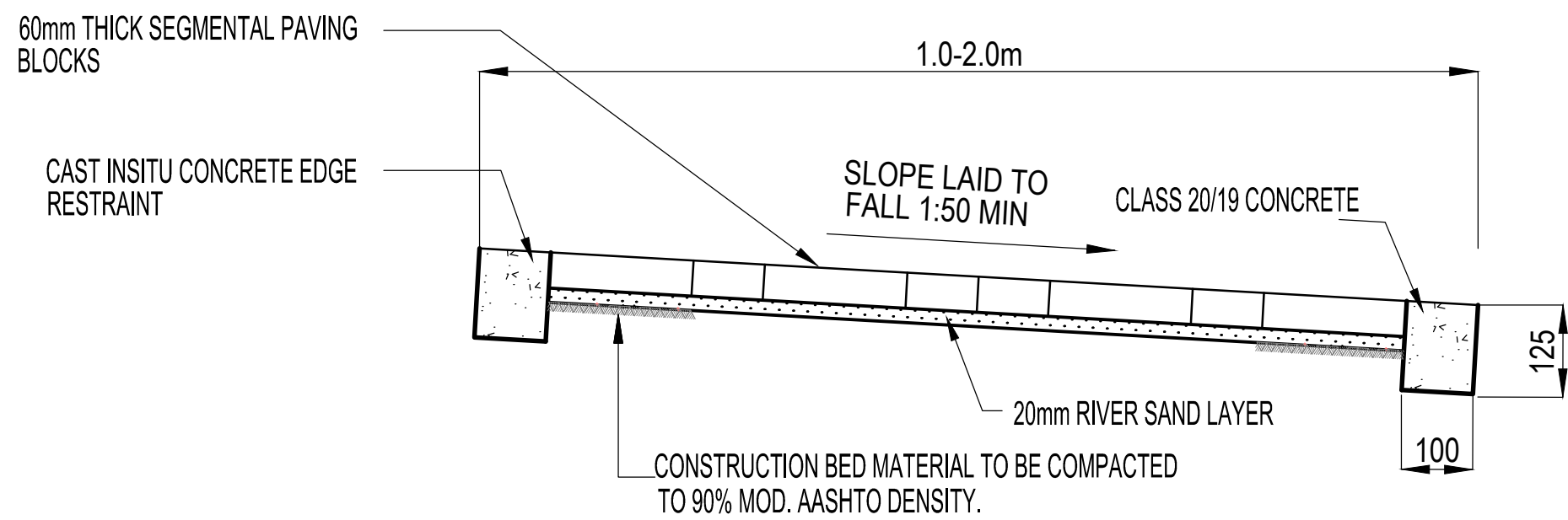

SECTION A-A THOUGH SEGMENTED PAVING
N.T.S

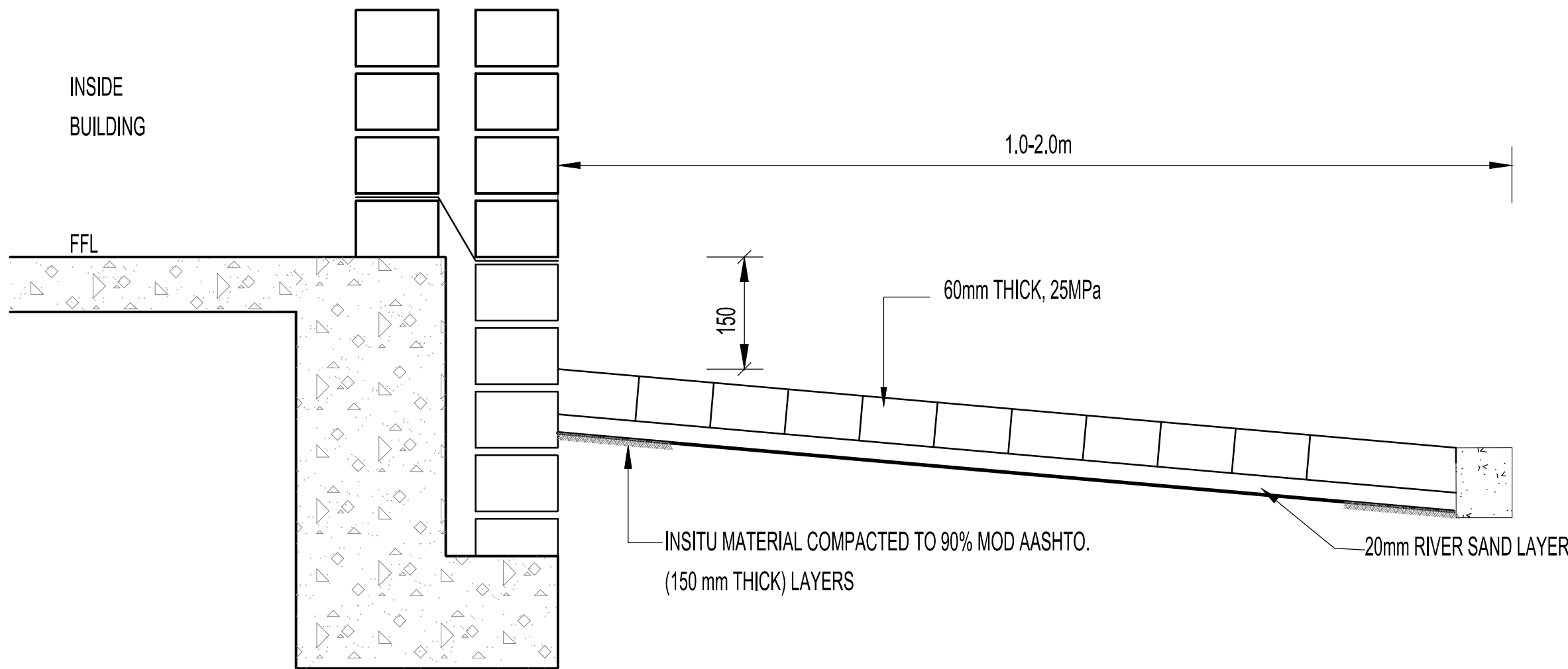

STANDARD PAVING AROUND BUILDINGS
N.T.S

NO.	DATE	REVISION	DRAWN
0	01/11/2018	FOR TENDER	DC
1	27/03/2019	REVISED TO DPW COMMENTS	DC

LEGEND:

NOTES:

IMPLEMENTING AGENT:



CONSULTANT:



Gauteng Office (Head Office)
GladAfrica House, Hertford Office Park
90 Bekker Road, Vorna Valley, Midrand, 1686
P.O. Box 6723 Halfway House 1685
Tel: +27 11 312 2537/2584
Fax: +27 11 805 1950
www.gladAfrica.com

SPECIFIC DISCIPLINES

SHEET SIZE	SCALE	STATUS LEGEND			
A1	AS SHOWN	I = INFORMATION	D = DESIGN DEVELOPMENT	C = CONSTRUCTION	AB = AS BUILT
		CV = CONCEPT AND VIABILITY	T = TENDER		
	NAME	SIGNATURE	PROFESSIONAL REG.NO.	DATE	
DRAWN	D COETZEE		N/A	27/03/2019	
DESIGNED	D COETZEE		N/A	27/03/2019	
VERIFIED	P VAN DER MERWE		201470409	27/03/2019	
VALIDATED	P VAN DER MERWE		201470409	27/03/2019	

PROJECT DESCRIPTION

PROJECT
TROMPSBURG SPECIAL SCHOOL

DRAWING TITLE
TYPICAL WALKWAY DETAILS

DISCIPLINE	DRAWING NUMBER	STATUS	REVISION
CIVIL	CE00092-WAL-003	T	1