

 Eskom	Tender Questions and Answers	Document Identifier	240-7124948	Rev	1
		Effective Date	01 April 2023		
		Review Date	April 2026		

To whom it may concern	Date	14 September 2023
	Enquiries	Fiona Manziya
	E-mail address	manziyfd@eskom.co.za

Dear Sir/Madam

Request for Enquiry Number	WCTX1132FM
Description / Project Title	Procure, transport, delivery, and installation of 3 x mobile office units (Including ablution facilities for electricity, water, and sanitation) to Upington, Aurora and Gourikwa substations
Tender Questions Closing Date	21 September 2023

Item	Questions	Answers	Clarity Published Dates
1.	Site location for Aurora	Vredenburg town	14 September 2023
2.	Do you have a layout drawing	Please see attachment at bottom of page	14 September 2023
3.	Carpets – please clarify - bitumen carpet a. Placement of bitumen carpet b. Placement of laminated floor	a. carpet for office area b. Vinyl floor covering for kitchen and toilets	14 September 2023
4.	Paraplegic/disabled a. You requesting for paraplegic toilets but you have not allowed for a ramp	a. No paraplegic toilets required	14 September 2023
5.	Do you require a geyser / hydroboil in the kitchen	Hydroboil in the kitchen	14 September 2023

### Controlled Disclosure

When downloaded from the document management system, this document is uncontrolled and the responsibility rests with the user to ensure it is in line with the authorized version on the system. No part of this document may be reproduced in any manner or form by third parties without the written consent of Eskom Holdings SOC Ltd, © copyright Eskom Holdings SOC Ltd, Reg No 2002/015527/30

	Tender Questions and Answers	Document Identifier	240-7124948	Rev	1
		Effective Date	01 April 2023		
		Review Date	April 2026		

6.	Underground water pipe from Jojo to parkhome (110mm is a sewer pipe not a water pipe)	Install proper water pipe	14 September 2023
7.	Must the Jojo be placed on a metal or concrete base	Concrete	14 September 2023
8.	Electrical works a. No of plugs required b. Do you require 2 tier trunking c. No of lights required d. What are the sensors for	60 A main power distribution board a. Power skirting on all walls with 2 x 15 A wall sockets at 800mm above floor level and spaced at 2-meter intervals. b. No c. 2 tube fluorescent lights above each desk/office with 2 -way light switches. d. automatic on/off to detect movement for power saving.	14 September 2023
9.	Distance from mains to parkhomes – for each site a. Upington, b. Aurora c. Gourikwa	a. 40 meter b. 200 meter c. 160 meter	14 September 2023
10.	DTI Threshold for designated item to be confirmed Wire products_100% Cables_90% Cement_100%	Wire Products _100% Telecom Cables_90% Cement_100% Concrete_100%	14 September 2023
11.	What type of aircons should be quoted on. Split units or normal window type.	2 x Split unit with isolators 18000btu open plan and 9000btu split unit for offices	14 September 2023
12.	What is the external connection distances for plumbing and electrical. In order to quote correctly.	Upington – 40meter Aurora – 200meter Gourikwa – 160 meter	14 September 2023

### Controlled Disclosure

When downloaded from the document management system, this document is uncontrolled and the responsibility rests with the user to ensure it is in line with the authorized version on the system. No part of this document may be reproduced in any manner or form by third parties without the written consent of Eskom Holdings SOC Ltd, © copyright Eskom Holdings SOC Ltd, Reg No 2002/015527/30

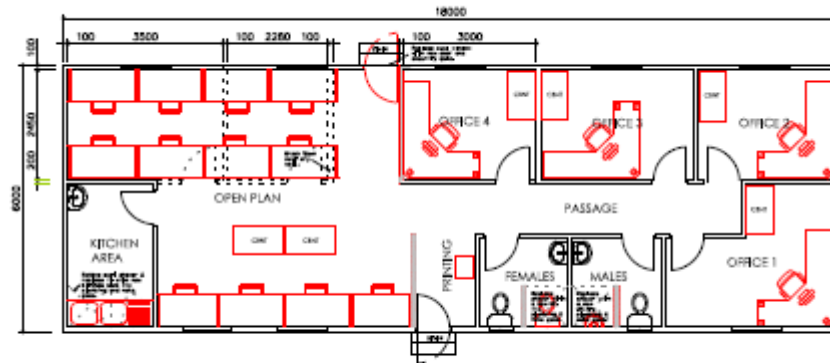

### PARKHOME 3: SECONDARY PLANT

## Controlled Disclosure

When downloaded from the document management system, this document is uncontrolled and the responsibility rests with the user to ensure it is in line with the authorized version on the system. No part of this document may be reproduced in any manner or form by third parties without the written consent of Eskom Holdings SOC Ltd, © copyright Eskom Holdings SOC Ltd, Reg No 2002/015527/30