

GENERAL NOTES

This drawing is issued for Electrical purposes only, and should be read in conjunction with the Electrical Specification. Setting out of Electrical and Electronic accessories are to be as indicated on Architects details.

Refer to Architects and Structural Drawings for all building dimensions, latest building revisions and services.

Do not scale this drawing.

All work to comply with relevant Standards, Codes of Practice, Specification and Regulations.

Notwithstanding anything to the contrary, all rights reserved. No part of this drawing may be reproduced in any material form (including photo copying or storage in any medium or by electronic means and whether or not transiently or incidentally to some other use of this drawing). In addition, this drawing may not be used for any purpose or reason other than for which it was originally issued, without written permission of the author.

DRAWING NOTES

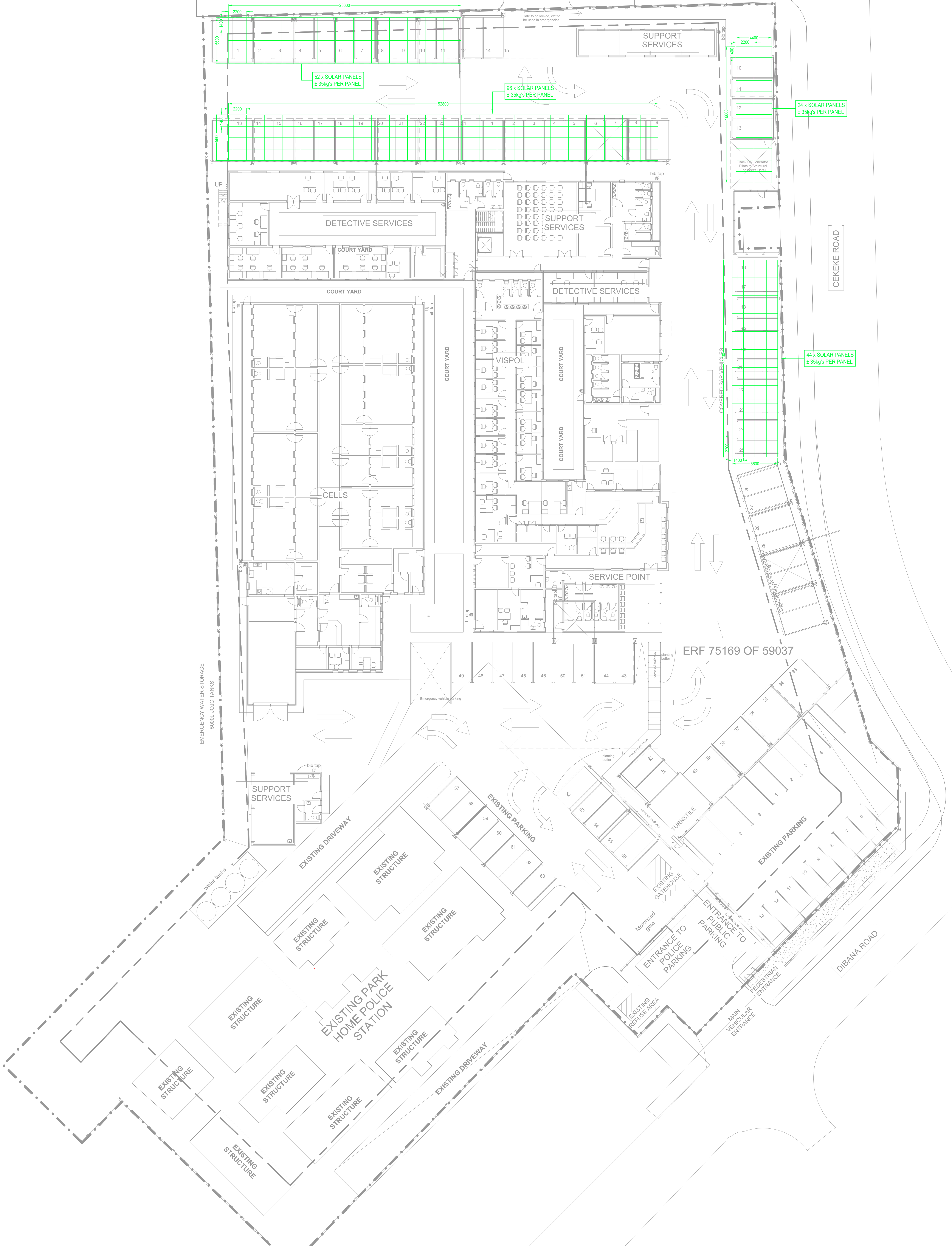

NOTES: (1) – Contractor to ensure max distance between draw boxes 20 metres notwithstanding anything to contrary. (2) – Draw boxes required after every second 90 deg. bend or 180 deg. total of slow bends. (3) – All unwired conduits to be provided with draw wires. These will be withdrawn and checked at random. (4) – Cast in conduits to be spaced 35mm. minimum.

	100x100 CONDUIT BOX.		ROUND DRAW BOX.		100x100 DRAW BOX.		100x50 BOX BEHIND POWER SKIRTING.		CONDUIT TURNED UP (°) FOR DOWN.		DOWN CONDUCTOR TO EARTH OR EARTH TIE.		ROUND CONDUIT BOX FOR: DM - DOOR MONITOR		ROUND CONDUIT BOX FOR: CM - CAMERA		ROUND CONDUIT BOX FOR: AA - ACCESS ALARM		ROUND CONDUIT BOX FOR: AC - ACCESS CONTROL		ROUND CONDUIT BOX FOR: OR - CARD READER		ROUND CONDUIT BOX FOR: COM - COMMUNICATION/INTERCOM		ROUND CONDUIT BOX FOR: BGM - BACK GROUND MUSIC		ROUND CONDUIT BOX FOR: EL - ELECTRIC LOCK/STRIKE		ROUND CONDUIT BOX FOR: SD - SMOKE DETECTOR		ROUND CONDUIT BOX FOR: HD - HEAT DETECTOR		20mm. DIA. CONDUIT.		25mm. DIA. CONDUIT.		32mm. DIA. CONDUIT.		50mm. DIA. CONDUIT.		SECTION OF CONDUIT DRAWN FOR CLARITY.		TWIN AND EARTH CABLE ROUTE.		POWER SKIRTING.		TRUNKING.		CABLE SLEEVE.		CABLE TRAY/LADDER.		DB-1 BOARD DESIGNATION NUMBER.		SQUARE GALV. STEEL DRAW TRAY SIZE AS SHOWN.		TELEPHONE JUNCTION BOX.		INTERCOM JUNCTION BOX.		DATA/COMMS JUNCTION BOX.		SECURITY, ETC. JUNCTION BOX.		DISTRIBUTION BOARD POSITION.		16AMP. SWITCHED SOCKET OUTLET (SSO).		DOUBLE 16AMP. SSO.		16AMP. SSO ON PEDESTAL.		16AMP. CLEAN SSO WITH RED COVER PLATE.		16AMP. CLEAN SSO WITH RED COVER PLATE, SQUARE EARTH AND PLUG TOP ON PEDESTAL.		3 PHASE SSO.		16AMP. SQUARE PIN SSO.		3AMP. 3 PIN UNSWITCHED SOCKET OUTLET.		INTERMEDIATE LIGHT SWITCH.		SINGLE LEVER ONE WAY LIGHT SWITCH.		TWO WAY LIGHT SWITCH.		LIGHT SWITCH WITH MOTION SENSOR.		FLUORESCENT LUMINAIRE.		BLUXHEAD/DOWNLIGHTER, ETC.		WALL MOUNTED LUMINAIRE.		POLE MOUNTED LUMINAIRE.		TWO POLE ISOLATOR.		THREE POLE ISOLATOR.		FOUR POLE ISOLATOR.		HOT WATER CYLINDER.		AIR CONDITIONING.		TELEPHONE POINT.		TELEPHONE POINT ON PEDESTAL.		DIRECT OUTSIDE LINE TELEPHONE POINT (CALL BOX).		TV OUTLET.		DATA/COMMS OUTLET.		INTERCOM REDIFFUSION SPEAKER POSITION.		BELL PUSH.		BELL OUTLET.		SIGN POINT.		CLOCK OUTLET.		PHOTOCELL.		REFERENCE TO QUANTITY i.e. 3No.		REFERENCE TO A DETAIL i.e. DETAIL 2.		REFERENCE TO AN ELECTRICAL NOTE i.e. NOTE 4.		REFERENCE TO A STANDARD DRAWING i.e. STANDARD DRAWING No.34		CABLE NUMBER - REFER CABLE SCHEDULE FOR DETAILS.		LUMINAIRE TYPE i.e. TYPE "B" - REFER LUMINAIRE SCHEDULE.
--	----------------------	--	-----------------	--	-------------------	--	-----------------------------------	--	---------------------------------	--	---------------------------------------	--	---	--	---------------------------------------	--	---	--	---	--	--	--	--	--	---	--	---	--	---	--	--	--	---------------------	--	---------------------	--	---------------------	--	---------------------	--	--	--	--------------------------------	--	-----------------	--	-----------	--	---------------	--	--------------------	--	--------------------------------	--	--	--	-------------------------	--	------------------------	--	--------------------------	--	------------------------------	--	------------------------------	--	--------------------------------------	--	--------------------	--	-------------------------	--	--	--	--	--	--------------	--	------------------------	--	---------------------------------------	--	----------------------------	--	------------------------------------	--	-----------------------	--	----------------------------------	--	------------------------	--	----------------------------	--	-------------------------	--	-------------------------	--	--------------------	--	----------------------	--	---------------------	--	---------------------	--	-------------------	--	------------------	--	------------------------------	--	--	--	------------	--	--------------------	--	--	--	------------	--	--------------	--	-------------	--	---------------	--	------------	--	---------------------------------	--	--------------------------------------	--	---	--	--	--	--	--	--

YMK

Approved in Principle
Justin McKelvie-King
Pr Eng : 20120548



PROJECT/WORKSHEET			
Makhaza Police Station Electrical Installation			
TITLE			
Solar PV Installation			
INDUSTRIAL	DRAWN BY (DATE)	CHECKED	SCALE
MK	CW 27/08/24		1:200
PROJECT No.	DRAWING No.	SHEET	PAPER SIZE
32307	700	1 of 1	A0
FILE 32307_700	LAYERS		REV
			0