

STEELWORK LAYOUT - BUILDING 3
SCALE 1 : 100

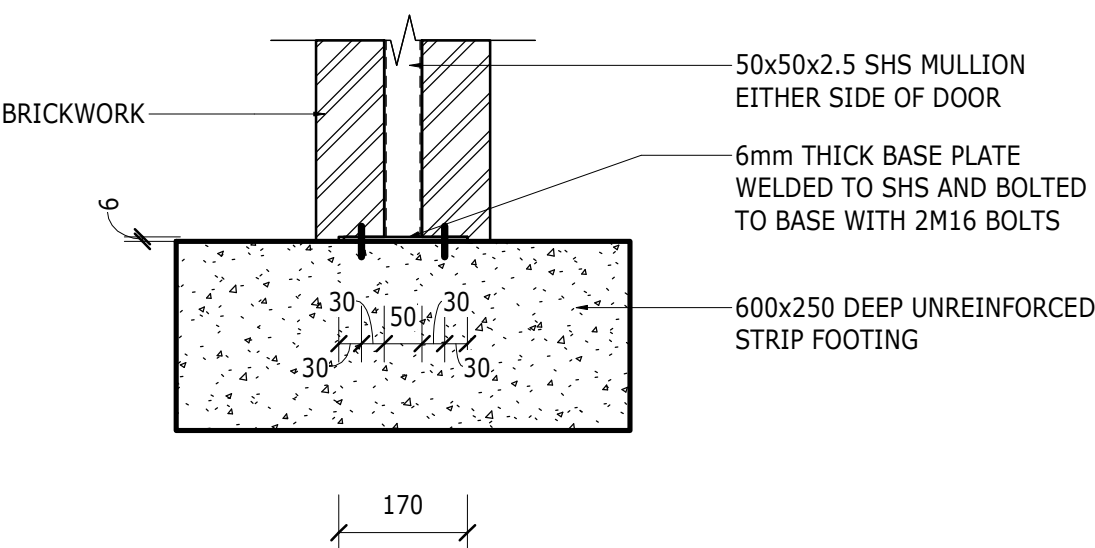

MULLION BASE PLATE DETAIL
SCALE 1 : 10

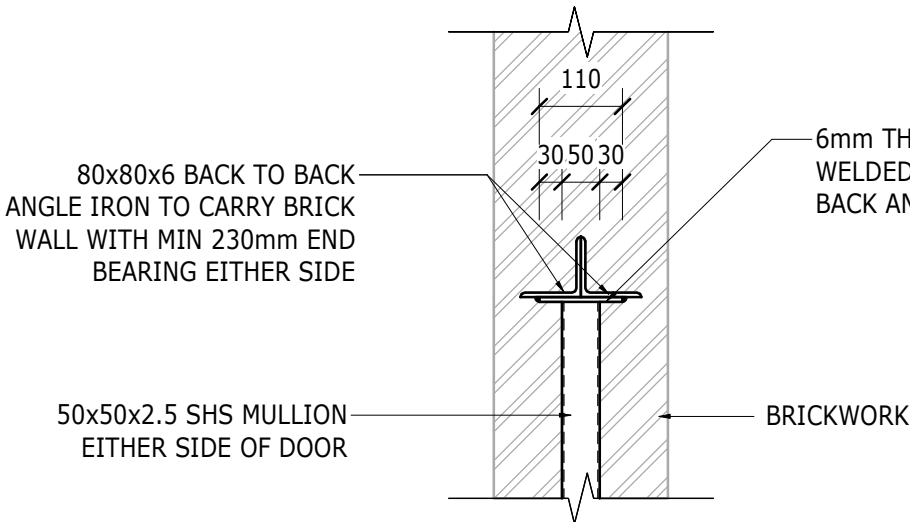

MULLION CAP PLATE DETAIL
SCALE 1 : 10

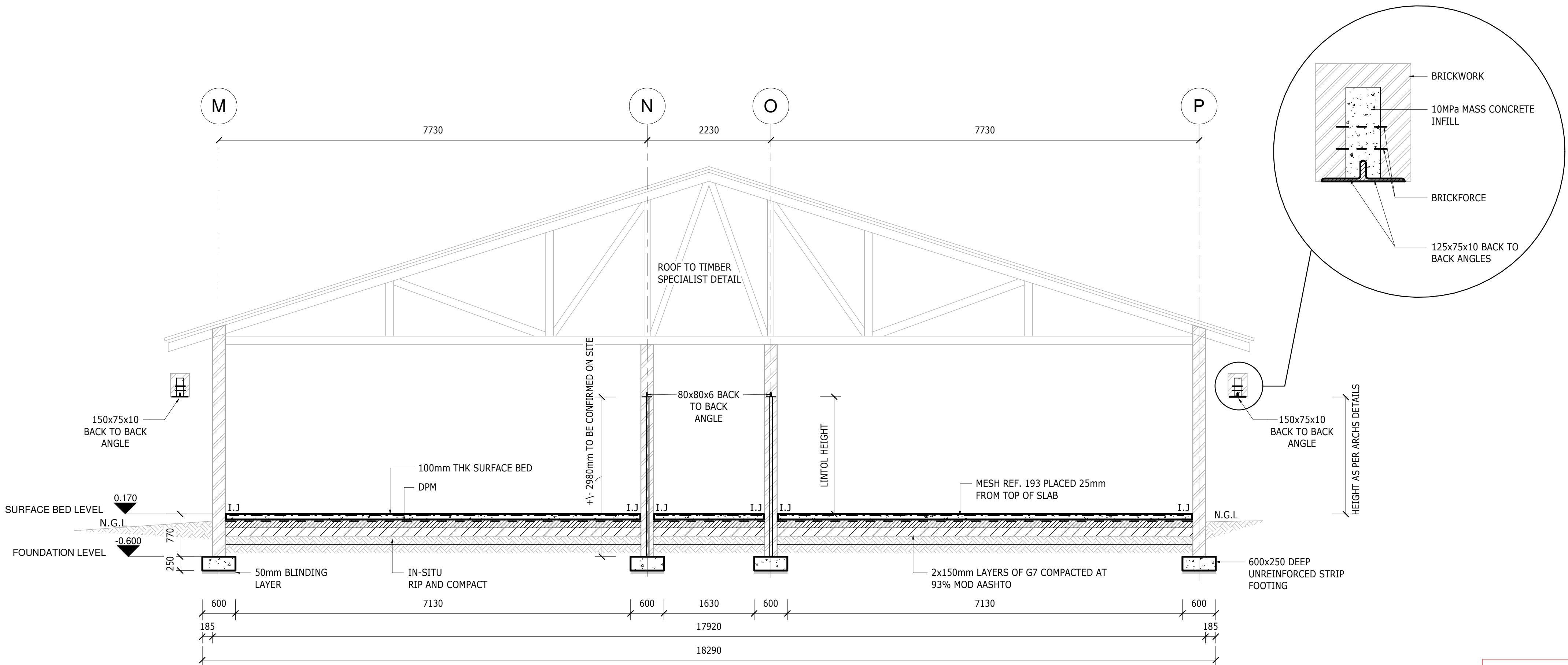

SECTION C-C
SCALE 1 : 50

- NOTES:
- ALL DRAWINGS TO BE READ IN CONJUNCTION WITH THE ARCHITECT DRAWINGS
 - ALL FOUNDATION EXCAVATION TO BE INSPECTED AND APPROVED BY ENGINEER BEFORE FIXING STEEL REINFORCEMENT OR CASTING CONCRETE. WHERE SUITABLE FOUNDING MATERIAL IS NOT ENCOUNTERED AT THE DEPTH SHOWN ON THE FOUNDATION DRAWINGS, EXCAVATION IS TO PROCEED TO A DEPTH AS APPROVED BY THE ENGINEER ON SITE.
- STRIP OR PAD FOOTING TO BE CAST AT A DEPTH MINIMUM 600mm DEEP. BELOW THIS LEVEL, CONSTRUCT A SOIL MATRESS COMPACTED IN 150mm LAYERS OF G7 AT 93% AND 2 G7 LAYERS AT 95% MOD AASHTO AT OMC.
- BELOW SURFACE BED: INSITU SOIL TO RIP AND COMPACT, THEN 2 LAYERS IN 150mm MAXIMUM COMPACTED TO 93% MODIFIED AASHTO DENSITY AT OMC.
 - CONCRETE MIXES:

MASS CONCRETE	10/19
BLINDING	15/19
FOUNDATIONS	20/19
RC PAD FOOTING, SURFACE BED	25/19
SLABS, BEAMS AND COLUMNS	30/19
 - BEARING PRESSURE ON SOIL MATRESS = 150KPa

LEGEND	
ISOLATION JOINT (I.J)	— — — —
SAW CUT JOINT (S.J)	— — — —
EXPANSION JOINT (E.J)	— — — —
CONSTRUCTION JOINT (C.J)	— — — —

REV	DATE	DESCRIPTION	ISSUED BY	APPR BY
0	20-10-23	ISSUED FOR TENDER	AAF	RT



CONSULTANT

GladAfrica
Consulting Engineers

Gauteng Office (Head Office)
GladAfrica House, Hertford Office Park
90 Bekker Road, Vorna Valley, Midrand, 1686
P.O Box 6723 Halfway House 1685
Tel. +27 11 312 2537/2584
Fax +27 11 805 1905
www.gladfrica.com

	NAME	REG. NO.	SIGNATURE
DRAWN	T. MOQOBANE	N/A	N/A
DESIGNED	J MODISE	201470233	<i>J Modise</i>

PROJECT DESCRIPTION	
TROMSBURG SPECIAL NEEDS SCHOOL	
DRAWING TITLE	
HOSTEL - BUILDING 3 STEELWORK LAYOUT, SECTIONS & DETAILS	

STATUS LEGEND			SHEET SIZE	
I	= INFORMATION		A1	
CV	= CONCEPT AND VIABILITY		SCALE	
D	= DESIGN DEVELOPMENT		AS SHOWN	
T	= TENDER			
C	= CONSTRUCTION			
AB	= AS BUILT			
DISCIPLINE	PROJECT NUMBER	STATUS	REVISION	
STRUCTURAL	CE00092-ST-HOS-105	T	0	

TENDER