

TYPICAL LAYOUT OF OFFICES AND LABORATORY UNITS

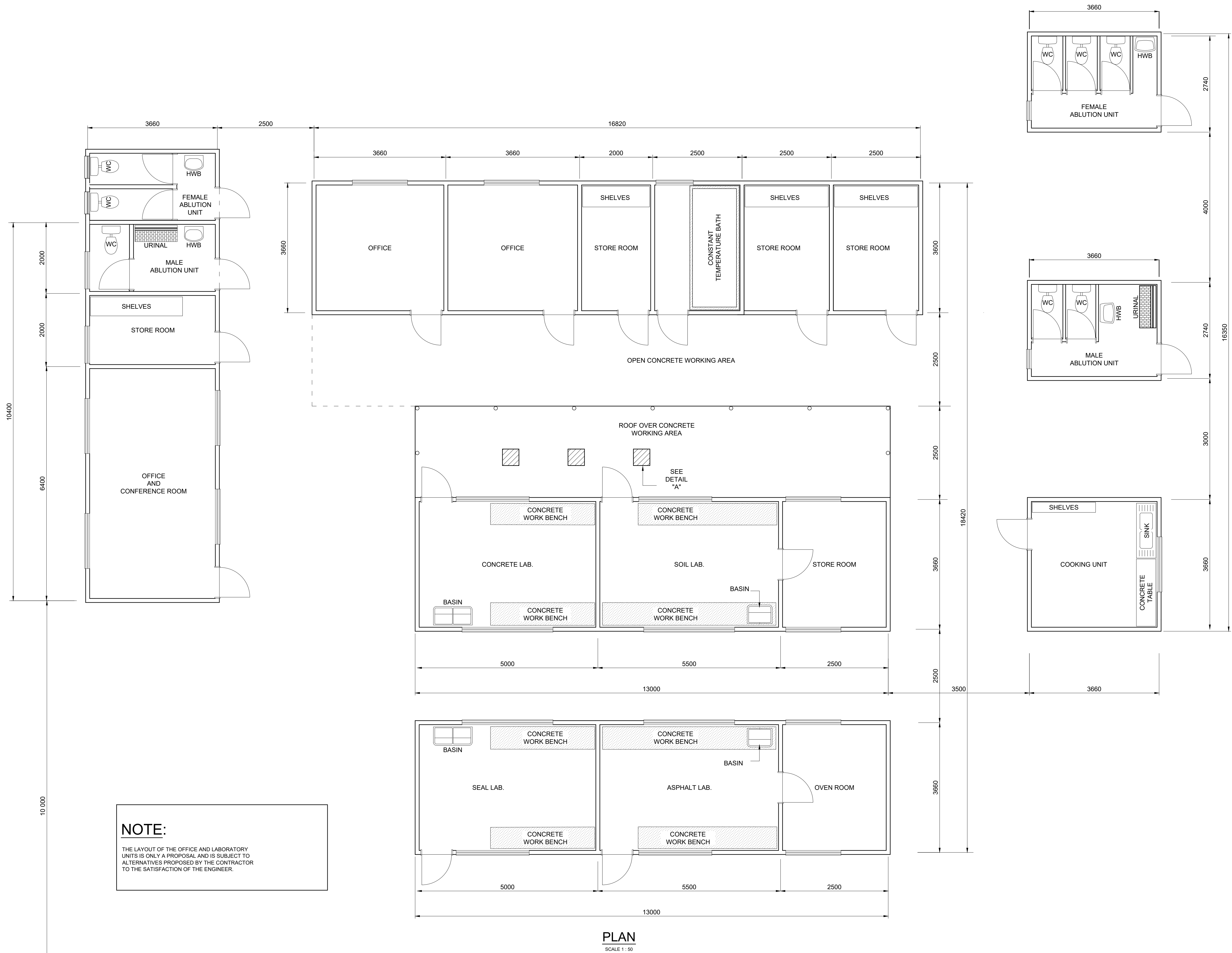

NOTE:

THE LAYOUT OF THE OFFICE AND LABORATORY UNITS IS ONLY A PROPOSAL AND IS SUBJECT TO ALTERNATIVES PROPOSED BY THE CONTRACTOR TO THE SATISFACTION OF THE ENGINEER.

PLAN

SCALE 1:30

DETAIL "A"

SCALE 1:10

DETAIL OF CONCRETE TEMPERATURE BATH

SCALE 1:20

FOR APPROVAL PURPOSES

NOTE : ALL LEVELS AND DIMENSIONS TO BE CHECKED ON SITE PRIOR TO CONSTRUCTION. ALL DISCREPANCIES TO BE BROUGHT IMMEDIATELY TO THE ENGINEER'S ATTENTION.

CONSTRUCTION RECORD (AS-BUILT)				DESIGNED BY				CONSULTANT APPROVAL				HEAD OFFICE				NORTHERN REGION				ACCEPTANCE				PROJECT DESCRIPTION				PROJECT NUMBER			
WORKS CONTRACT ENGINEER				NAME				Name				48 Tambotie Avenue				38 Ida Street				THIS ACCEPTANCE IS FOR PROCEDURAL AND ADMINISTRATIVE REVIEW PURPOSES ONLY AND DOES NOT ATTRACT LEGAL LIABILITY OR LIABILITY OF ANY KIND FROM WHATSOEVER CAUSE OR HOWEVER ARISING				CONTRACT SANRAL N.011-050-2018/1 FOR THE RESURFACING OF NATIONAL ROAD N11 SECTION 5 FROM VOLKSRUST (KM 0.0) TO OUDEHOUTKLOOF (KM 21.0)				J000125			
Name				Prof. Reg. No.				Date				Val de Grace				Menlo Park								DRAWING LOCATION DATA				START			
Date				Date				Date				Pretoria				Private Bag X17								ROUTE				N 11			
SANRAL PROJECT MANAGER				Name				Name				0184				Lynnwood Ridge								SECTION				SECTION 5			
Name				Prof. Reg. No.				Date				PO Box 415				0040								DRAWING km DISTANCE				km 0.000			
Date				Date				Date				Tel: (012) 844 8000				Tel: (012) 426 6200								BRIDGE/STRUCTURE No.				ROADS - ANCILLARY WORKS			
ORIGINAL VERSION				Name				Name				for the SA NATIONAL ROADS AGENCY SOC LTD.												CONSULTANT DRAWING No.				J000125-RD-LA001			
REVISION				Date				Date																SANRAL DOCUMENT #				VER			
V1 04/11/2022				C.J. VAN DER MERWE				C.J. VAN DER MERWE																SCALE :				SHEET			
DATE				CONSULT. ENG.				830600																OF							
								N. STUURMAN																							



INTERNATIONAL BUSINESS  
GATEWAY OFFICE PARK  
CNR PIONEER AVENUE AND ELIZABETH  
MIDRIDGE PARK  
TEL: (011) 466-8576  
FAX: (011) 466-8573  
E-MAIL: info@zimile.co.za



for the SA NATIONAL ROADS AGENCY SOC LTD.

PROJECT DESCRIPTION  
CONTRACT SANRAL N.011-050-2018/1 FOR THE RESURFACING OF NATIONAL ROAD N11 SECTION 5 FROM VOLKSRUST (KM 0.0) TO OUDEHOUTKLOOF (KM 21.0)

DRAWING DESCRIPTION		TYPICAL LAYOUT OF OFFICES AND LABORATORY UNITS	
SCALE :		SHEET	
OF			

SANRAL TITLE BLOCK #F64234(DWG/PDF) VERSION V11.1