

### FINISHING SCHEDULE - WALLS

[Wa-1-1]	600mm x 300mm FULL GLAZED CERAMIC TILES: LIGHT GREY FULL BODIED PORCELAIN TILES, SIZE 600mm x 300mm, FIXED TO INTERNAL WALL PLASTER WITH TILE ADHESIVE WITH JOINTS CONTINUOUS IN BOTH DIRECTIONS AND GROUTED WITH FINE INDUSTRIAL GREY ANTI-BACTERIAL EPOXY TILE GROUT, EXCESS GROUT ON THE SURFACE TO BE CLEANED WITH WATER AS WORK PROCEEDS.
[Wa-4]	PLASCON MISTY DAWN MATT WALL PAINT (GR-G04) (INTERNAL PAINT) SURFACE TO BE DRY, SOUND AND CLEAN AND CURED FOR A MINIMUM OF 14 DAYS, WITH A MOISTURE CONTENT MEASURED WITH A DOSEY HYGROMETER (OR EQUIVALENT), OF BD 2 SCALE - 8% OR LESS, PRIME WITH ONE COAT PROFESSIONAL PLASTER PRIMER WITH AN OVERCOATING TIME OF 16 HOURS AND FINISH WITH TWO COATS PROFESSIONAL SUPER MATT WITH 1 HOUR DRYING TIME BETWEEN COATS.

### CEILING LEGEND - REFER TO CEILING PLAN.

Ce 01	600 x 600mm Concealed Grid Suspended Horizontal Vinyl Faced Gypsum Acoustic Ceiling.
Ce 04	Flush smooth skimmed and painted ceiling.

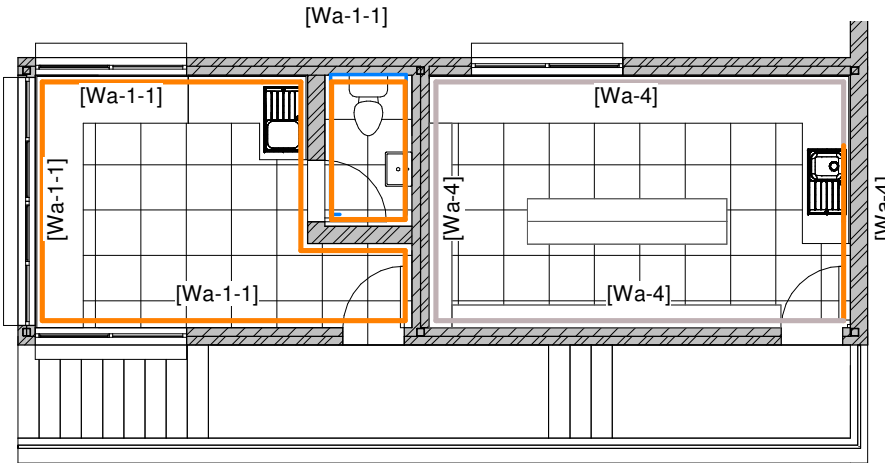

ENTRANCE GATE:  
WALL FINISHING PLAN  
1:100

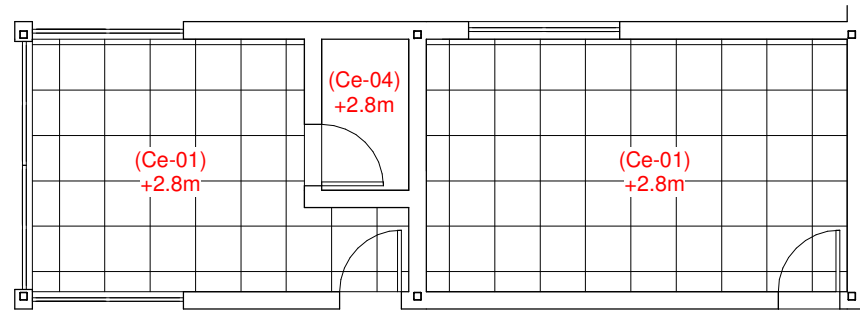

ENTRANCE GATE:  
CEILING PLAN  
1:100

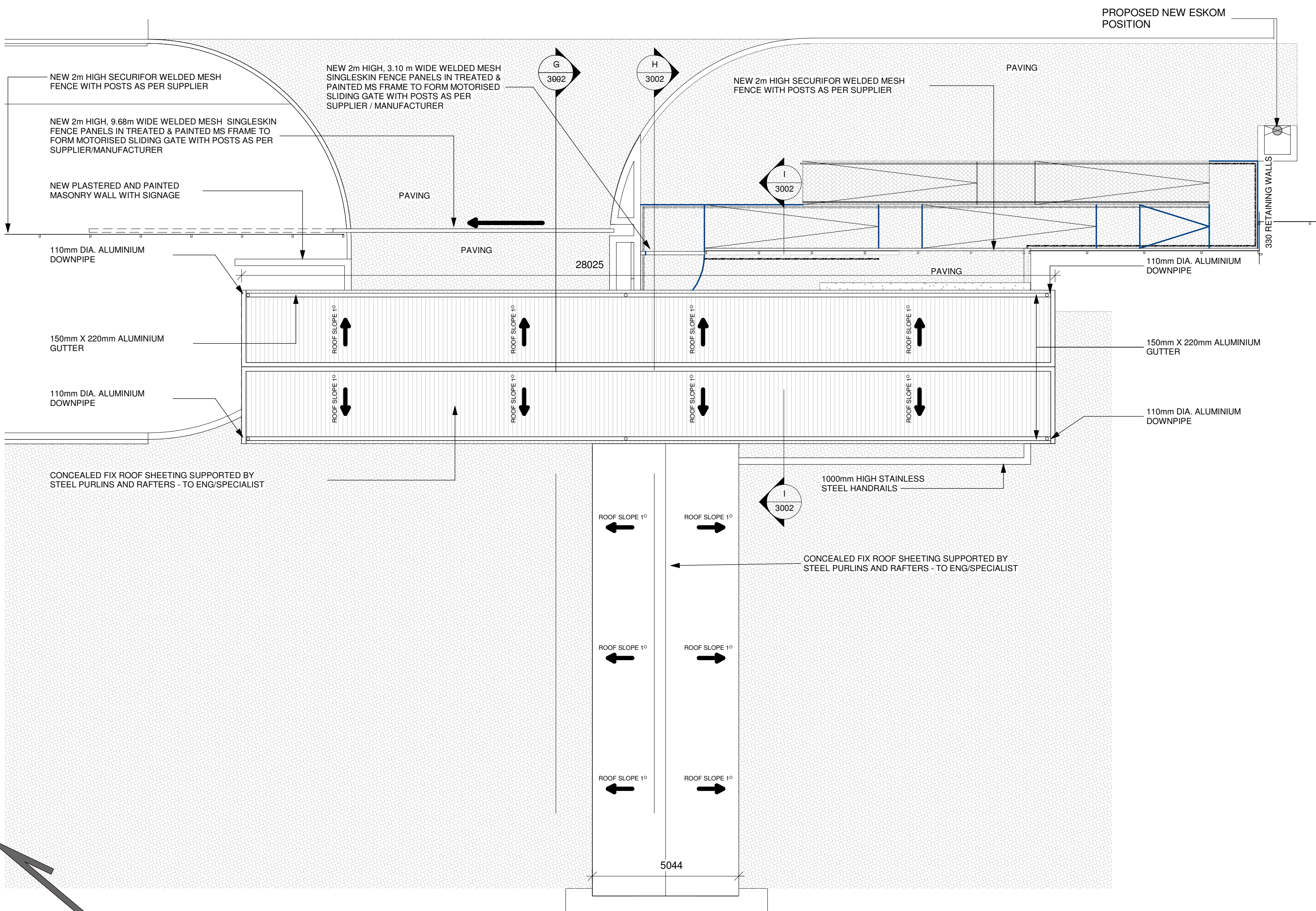

ENTRANCE GATE:  
ROOF PLAN  
1:100

### SANITARY SCHEDULE

ANY DISCREPANCIES, IRREGULARITIES TO BE CHECKED AND VERIFIED WITH ARCHITECT BEFORE PLACING ORDER OR WORK IS CARRIED OUT.

ALL MATERIAL TO BE LOCALLY SOURCED AND OR APPROVED BY ARCHITECTS.

ALL ITEMS ARE PROVISIONAL UNTIL OTHERWISE SPECIFIED IN WRITING BY THE ARCHITECT OR CLIENT.

ALL ITEMS TO BE SUPPLIED AND INSTALLED.

ALL ITEMS TO BE APPROVED OR SIMILAR APPROVED BY ARCHITECT.

IMAGE	DESCRIPTION
	WC: HIBISCUS ELITE CLOSE COUPLE SUITE (643x355x830mm), COLOUR - WHITE, CODE - 772401
	SHUT OFF VALVE: CHROME PLATED BALL TYPE VALVE (COB-832-10)
	TOILET ROLL HOLDER: FRANKIE CHRONOS CHR 672 0,8mm THICK GRADE 304 18/10 SATIN STAINLESS STEEL TOILET ROLL HOLDERS (CODE: 359808), SIZE 295x140x128mm DEEP FOR 2 ROLLS MAXIMUM 108mm DIAMETER, CYLINDER LOCK WITH STANDARD FRANKIE KEY, PLUGGED AND SCREWED TO THE WALL WITH STAINLESS STEEL SCREWS, OR SIMILAR APPROVED BY ARCHITECT. TOILET ROLLS TO SIT HORIZONTALLY IN HOLDER FOR EASY ROLL ACTION.
	WALL HUNG BASIN: 350(d)x450(w) RECTANGULAR VITREOUS CHINA, WALL HUNG BASIN WITH ONE TAP HOLE (CODE: 706601) - OR SIMILAR APPROVED BY ARCHITECT- TO BE WALL MOUNTED USING TWO 10mm BOLTS (CODE: 706601) - STRICTLY ACCORDING TO MANUFACTURER.
	BOTTLE TRAP: DIP TUBE TRAP FOR WASHBASIN, HORIZONTAL OUTLET: D40MM G1 1/4" BRIGHT CHROME-PLATED - PLASTIC
	WASTE: 32mm CHROME PLATED AQUA SLOTTED BASIN CLICK WASTE (302-32) WITH 62mm DIAMETER FLANGE AND 80mm LONG SHANK OR SIMILAR APPROVED BY ARCHITECT
	BASIN MIXER: NOKA CHROME BASIN MIXER WITH PRESSURE-COMPENSATING FLOW RATE OF 6L/MIN, CODE: NA-951
	SHUT OFF VALVE: CHROME PLATED BALL TYPE VALVE (COB-832-10)
	WASTE BIN: 385(h)x340(w)x250(d) GRADE 304 STAINLESS STEEL DISPOSER STANDARD WALL BIN WITH BRUSH STEEL FINISH
	TOWEL DISPENSER: 369(h)x280(w)x120(d) SUPERIOR GRADE 304 FLAT FOLDED PAPER TOWEL DISPENSER IN STAINLESS STEEL WITH A SATIN FINISH, PLUGGED AND SCREWED TO THE WALL WITH 3 X STAINLESS STEEL SCREWS, OR SIMILAR APPROVED BY ARCHITECT
	SOAP DISPENSER: ELBOW ACTION CRADLE SOAP DISPENSER, PLUGGED AND SCREWED TO THE WALL WITH STAINLESS STEEL SCREWS
	COUNTER TOPS: 600mm X 30mm THICK GRANITE TOPS
	KITCHEN TAP: PROFESSIONAL MIXER (303220) WITH OVERARM RETRACTABLE SPOUT AND 15mm FLEXIBLE CONNECTIONS TO BE MOUNTED TO KITCHEN COUNTER TOP ACCORDING TO MANUFACTURER'S SPECIFICATION
	KITCHEN SINK: NOUVEAU (NVN611) GRADE 304 18/10 POLISHED STAINLESS STEEL SINGLE END BOWL INSET SINK (811023), OVERALL SIZE 800X460mm WITH 90mm WASTE FITTING TO LEAD DIRECTLY TO EXTERIOR WALL. TO HAVE STAINLESS STEEL STRAINER WASTES WITH RUBBER WASHERS - ALL ACC. TO MANUFACTURER'S SPECIFICATION
	SHUT OFF VALVE: CHROME PLATED BALL TYPE VALVE (COB-832-10)
	BASIN WASTE: 2mm SLOTTED CHROME WASTE WITH RUBBER PLUG - 62mm x 80mm (COB-301)
	SINK TRAP: 40 x 40mm PLAIN RUBBER P-TRAP - ALL TO ARCHITECT'S APPROVAL, OR SIMILAR APPROVED BY ARCHITECT

80- GUARDHOUSE WC

81 - GUARDHOUSE

83- CCMD

01

01

01

01

01

01

01

01

01

01

01

01

01

01

01

Cad File Name: DBEC-MRPRO-09-06

P17064-TN-01-ARC-1018 Rev A



### LEGEND:

NOTE:

### TENDER

Rev	Date	Description of changes	By
A	2023-06-30	ISSUED FOR TENDER	SBM

### REVISIONS

Client



Consultant



P O BOX 35703  
MENLOPARK  
0102

TEL: (012) 368 1850  
FAX: (012) 348 4738

APPROVED

THE MASTER HELD AT DELTA BUILT ENVIRONMENT CONSULTANTS BEARS THE ORIGINAL SIGNATURE OF APPROVAL

SACAP : 30447969

DocuSigned by:  
Shakira Benadie-Maraais  
Signature:

SHAKIRA BENADIE-MARAIS  
NAME: 2023-06-30  
DATE:

Project

JDA NALEDI CLINIC

Project Description

NEW CLINIC IN NALEDI EXT. 2

Drawing Title

ENTRANCE GATE BUILDING  
ROOF PLAN, FINISHING PLANS &  
SANITARY SCHEDULE

Drawing Units

MILLIMETERS

Date	Scale	Designed By
2023-06-30	As indicated	SBM

Checked By	Drawn By	Approved By
SBM	TJJVR	SBM

Drawing No	Rev
P17064-TN-01-ARC- 1018	A