

FRONT ELEVATION
SCALE 1:20

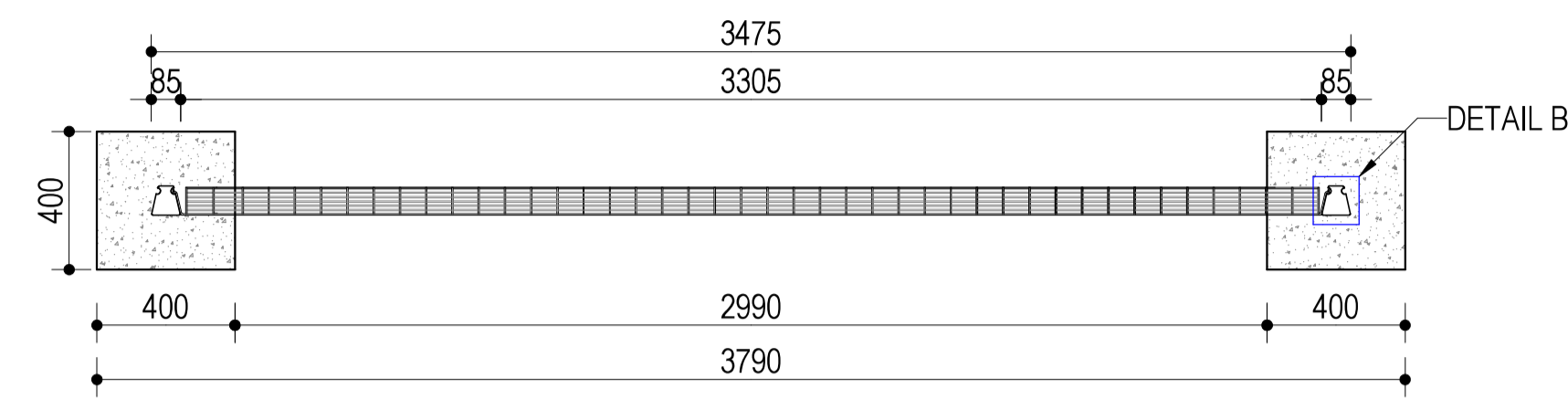

SECTION A-A
SCALE 1:20

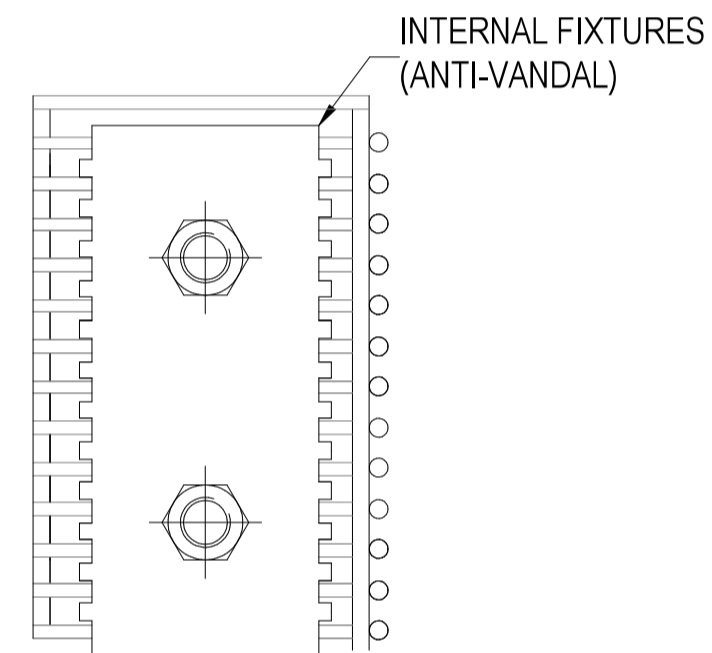

DETAIL A
SCALE 1:2

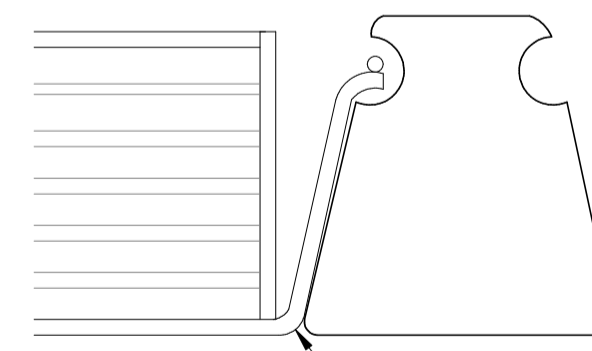

DETAIL B
SCALE 1:2

No.	ITEM	DESCRIPTION
1	PANEL	CLEARVU MESH PANELS 3305mm WIDE x 2100mm HIGH GALVANISED 3mmØ WIRE WITH APERTURE SIZE (CENTERS) @ 76.2mm x 12.7mm. PANEL FORMATION: PANEL REINFORCED WITH 4 x 50mm DEEP "V" FORMATION HORIZONTAL RECESSED BANDS (RIGIDITY), 2 x 75mm 70° FLANGES ALONG SIDES (INTERNAL FIXTURES - ANTI VANDAL, ALLOWING FOR FLUSH POST AND PANEL FINISH, 48 LINE WIRE SECURE CONNECTION, LOCKING RECESS MECHANISM) AND 2 x 30° FLANGES ALONG TOP AND TOE. (ARROW - STRAIGHT EDGES, INTEGRATED ANGLES). COATING: MESH GALVANISED, THEN MARINE FUSION BOND COATED.
2	POST	COCHRANE TAPER LOCKING POST 85mm X 45mm x 85mm, THEN SEALED WITH UV STABILIZED POLYMER CAP. COATING: HOT DIP GALVANISED, THEN MARINE BOND COATED.
3	CLAMPS	8 x SINGLE BOLT COMB CLAMPS. 8 x DOUBLE BOLT COMB CLAMPS. COATING: GALVANISED, THEN MARINE FUSION BOND COATED
4	FOUNDATION	400mm x 400mm x 600mm CONCRETE FOUNDATION

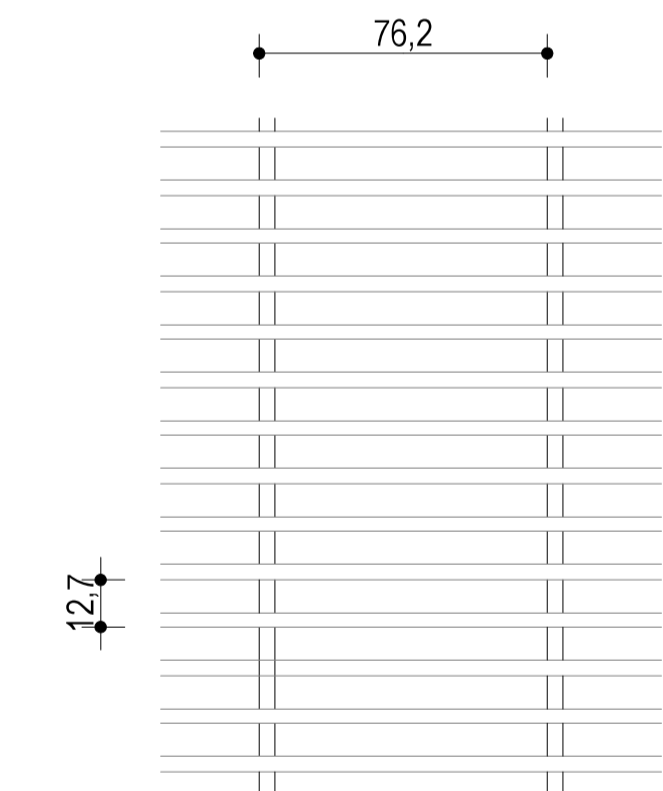

DETAIL C
SCALE 1:2

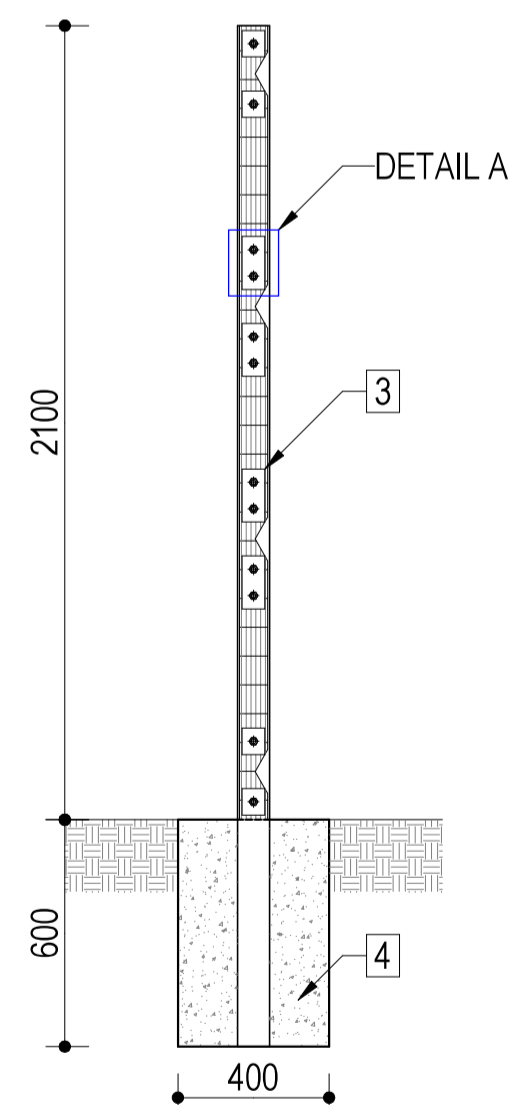

SECTION B-B
SCALE 1:20

FLAGG
Consulting Engineers (Pty) Ltd
FRANKFORT
6 Mark Street
P.O.Box 984, Frankfort 9830
Tel: 068 813 2173
Fax: 068 813 4254
E-Mail: frankfort@flaggconsulting.co.za
OTHER OFFICE:
BLOEMFONTEIN

FLAGG CONSULTING ENGINEERS (Pty) Ltd
Consulting Civil and Structural Engineers
Reg No 2012/130605/07

DESIGNED
NAME: L.B.F. AMBROSE Prof Reg No: 201370161
DATE: JANUARY 2024

DRAWN
NAME: M. GOVENDER DATE: JANUARY 2024

CHECKED
NAME: L.G. MOTSOENENG Prof Reg No: 201470097
SIGNATURE:..... DATE: JANUARY 2024

No.	REVISION	DRAWN	CHECKED	DATE

PROJECT DETAIL

UPGRADING OF THE ZOMBA
SPORTS FACILITIES IN FRANKFORT

SERVICE DETAIL

SPORTS COMPLEX:
FENCING DETAILS

MAFUBE LOCAL MUNICIPALITY

PO BOX 2
FRANKFORT
9830

(058) 813 1081/2
(058) 813 3072

SCALE:
AS SHOWN

PAPER SIZE:
A1: 841 x 594

ENG. DRW NUMBER
F0284-G200

PROJECT STATUS

CONCEPT DRAWING TENDER DRAWING APPROVED CONSTRUCTION DRAWING AS BUILT DRAWINGS