

ANDEON X37

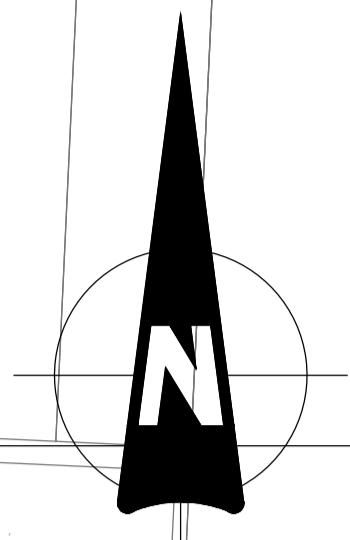

NOTES AND SPECIFICATIONS

- GENERAL**
- ALL MATERIAL AND WORKMANSHIP MUST COMPLY WITH THE REQUIREMENTS OF THE LATEST RELEVANT SABS REQUIREMENTS. ALL DIMENSIONS ARE IN MILLIMETERS (UNLESS OTHERWISE SPECIFIED).
 - DO NOT SCALE FROM THESE DRAWINGS. ALL DIMENSIONS MUST BE CHECKED AND APPROVED ON SITE.
 - ALL CONSTRUCTION TO BE DONE IN ACCORDANCE WITH THE STANDARD SPECIFICATIONS FOR MUNICIPAL CIVIL ENGINEERING WORKS, THIRD EDITION 2005 AND THE STANDARD COT DETAIL DRAWINGS. THESE DRAWINGS MUST BE READ IN CONJUNCTION WITH THE STANDARD DRAWINGS (IF APPLICABLE).
 - THIS DRAWING MUST BE READ IN CONJUNCTION WITH THE STANDARD SPECIFICATIONS FOR MUNICIPAL CIVIL ENGINEERING WORKS, SERIES 4.
 - THE SIGNATURE OR INITIALS ON THIS DRAWING, OF ANY DIRECTOR OF THE WATER AND SANITATION DEPARTMENT, IN NO WAY REMOVES ANY RESPONSIBILITY WHATSOEVER FROM THE CONSULTANT.
 - THE CONSULTANT REMAINS RESPONSIBLE TO ENSURE THAT ALL THE GUIDELINES, STANDARD DRAWINGS, STANDARDS AND SPECIFICATIONS OF WATER AND SANITATION DEPARTMENT HAVE BEEN MET AND ARE COMPLIED WITH.
 - FINAL POSITION OF SERVICES TO BE DETERMINED ON SITE.
 - ALL SEWER LONG HOUSE CONNECTIONS TO BE CONSTRUCTED AS COT STANDARD DRAWING 7515-S209.

- LEGEND**
- SEWER**
- NEW MANHOLE
 - CE / LH
 - EXISTING MANHOLE
 - NEW CCTV INSPECTION
 - EXIST. LINE INSPECTED BY CCTV
 - NEW SEWER LINE
 - EXISTING SEWER LINE
 - HOUSE CONNECTION
 - SUBURB BOUNDARY
 - PIPE NUMBER
 - DIRECTION OF FLOW
 - LENGTH/DIAMETER & MATERIAL/CLASS
 - CROSSCUT

CITY OF TSHWANE
WATER AND SANITATION DEPARTMENT

AMENDMENTS				
NR	DATE	APPROVED	DESCRIPTION	PAR
0	19-Oct-23	APPROVED	FOR CONSTRUCTION	

WATER AND SANITATION				
FOR INTERNAL APPROVAL - RECEIVED SIGN WHEN APPLICABLE				
DIRECTOR: WATER AND SANITATION - PLANNING				
NAME	Prof. Reg. No.	SIGNATURE	DATE	
REGIONAL DIRECTOR: (1,2,3,4,5,6 or 7)				
NAME	Prof. Reg. No.	SIGNATURE	DATE	
DIRECTOR: SYSTEM DEVELOPMENT				
NAME	Prof. Reg. No.	SIGNATURE	DATE	
DIRECTOR: BULK WATER				
NAME	Prof. Reg. No.	SIGNATURE	DATE	
DIRECTOR: INFRASTRUCTURE PROVISION				
NAME	Prof. Reg. No.	SIGNATURE	DATE	
DIRECTOR: WASTE WATER TREATMENT				
NAME	Prof. Reg. No.	SIGNATURE	DATE	

CONSULTANT DETAIL

IMBAWULA CIVIL PROJECTS

Plot 70
1463 Tienie Street
Andon Ab
Zandfontein
Pretoria West
0183
Tel: 012 372 3708

1. **THAMI TOM** Prof. Reg. No. 2018300095
HEREBY CERTIFY THAT THE SERVICES WILL HAVE BEEN INSTALLED ACCORDING TO NOTE 9 OF THE ABOVE NOTES AND TO THE DRAWING.

SIGNATURE: _____ DATE: 19-Oct-23

CONSULTANT DRAWING NUMBER: 2022-AND-S-01U01

DESIGNED	
NAME: SAGWADI RINGANI	Prof. Reg. No. _____
SIGNATURE: _____	DATE: _____
DRAWN	
NAME: MOEMEDI MOTAI	Prof. Reg. No. _____
SIGNATURE: _____	DATE: _____
CHECKED	
NAME: THAMI TOM	Prof. Reg. No. 2018300095
SIGNATURE: _____	DATE: 19-Oct-23
INFORMATION OFFICE CHECKED	
NAME: _____	Prof. Reg. No. _____
SIGNATURE: _____	DATE: _____
DESIGN OFFICE APPROVAL	
NAME: _____	Prof. Reg. No. _____
SIGNATURE: _____	DATE: 19-Oct-23

CONTRACT	
No. HHS01-2018/19	
PROJECT No. _____	
SHEET No. 1 OF 1	
PAPER SIZE: A1	
SCALE: 1:1 000	
DATE: 19-Oct-23	

PROJECT STATUS

RECEIVED SIGN WHEN APPLICABLE

CONCEPT DRAWING

DESIGN DRAWING

APPROVED FOR CONSTRUCTION

AS BUILT DRAWING

PROJECT ENGINEER OF COT: _____

INSPECTOR OF WORKS OF COT: _____

DATE: 2023-10-27

LOCATION OF PROJECT: ANDEON EXT 37 REGION 3 WARD 55
DESCRIPTION OF PROJECT: CONSTRUCTION OF SEWER SERVICES IN ANDEON EXT 37 GENERAL SEWER LAYOUT (1 OF 1)
WBS No. : _____
COT DRAWING NUMBER: _____
DESCRIPTION OF PROJECT: _____

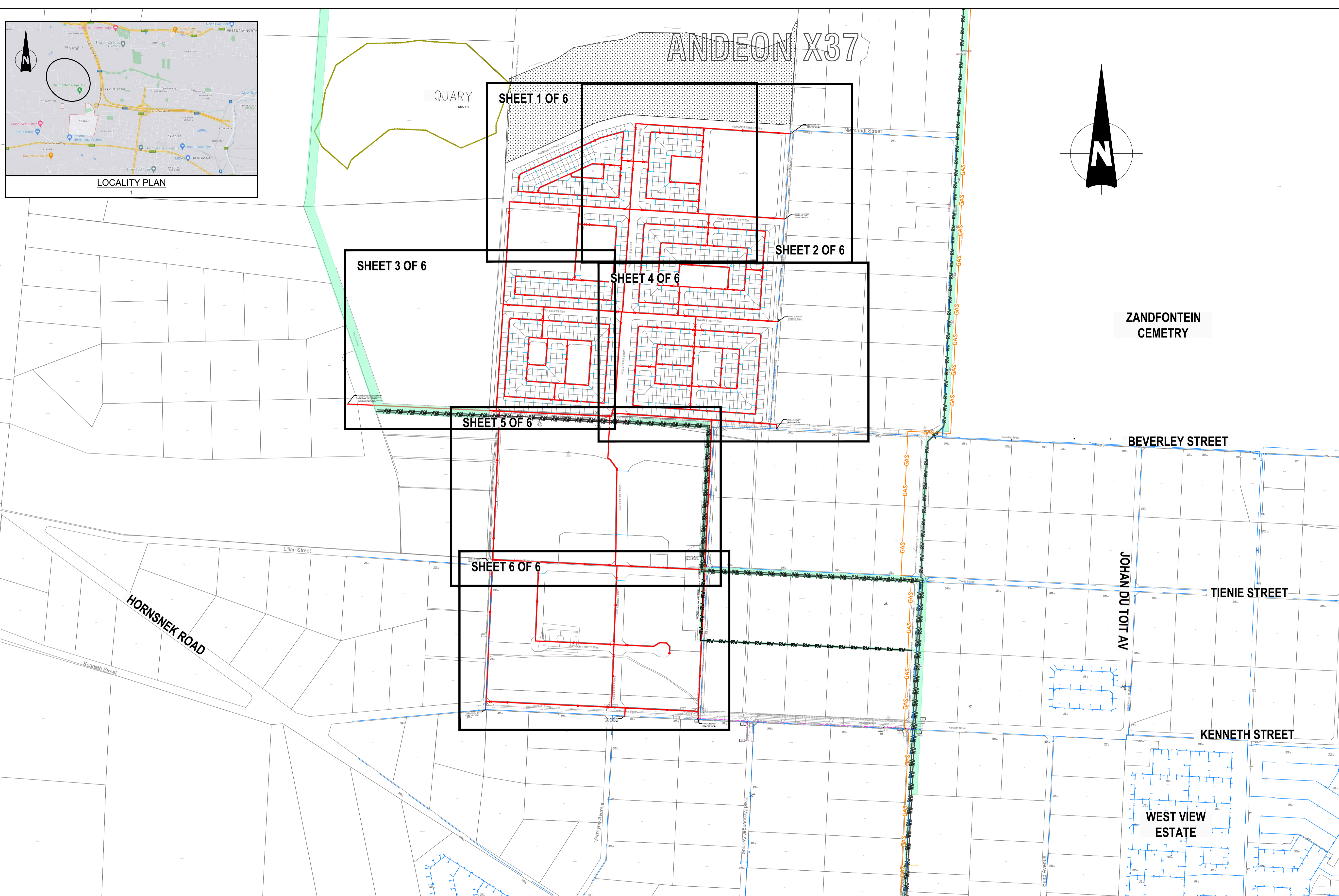
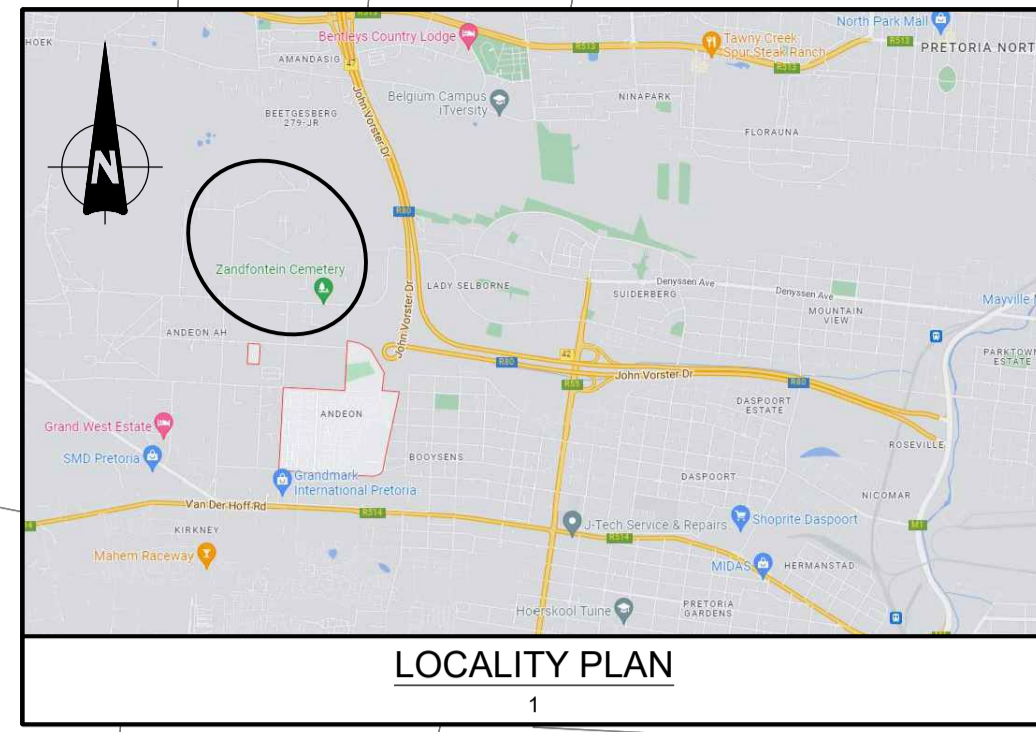

- NOTES AND SPECIFICATIONS**
- GENERAL**
- ALL MATERIAL AND WORKMANSHIP MUST COMPLY WITH THE REQUIREMENTS OF THE LATEST RELEVANT SABS REQUIREMENTS.
 - ALL DIMENSIONS ARE IN MILLIMETERS (UNLESS OTHERWISE SPECIFIED).
 - DO NOT SCALE FROM THESE DRAWINGS.
 - ALL DIMENSIONS MUST BE CHECKED AND APPROVED ON SITE.
 - ALL CONSTRUCTION TO BE DONE IN ACCORDANCE WITH THE STANDARD SPECIFICATIONS FOR MUNICIPAL CIVIL ENGINEERING WORKS, THIRD EDITION 2005 AND THE STANDARD COT DETAIL DRAWINGS.
 - THESE DRAWINGS MUST BE READ IN CONJUNCTION WITH THE STANDARD DRAWINGS (IF APPLICABLE).
 - THIS DRAWING MUST BE READ IN CONJUNCTION WITH THE STANDARD SPECIFICATIONS FOR MUNICIPAL CIVIL ENGINEERING WORKS, SERIES 4.
 - THE SIGNATURE OR INITIALS ON THIS DRAWING, OF ANY DIRECTOR OF THE WATER AND SANITATION DEPARTMENT, IN NO WAY REMOVES ANY RESPONSIBILITY WHATSOEVER FROM THE CONSULTANT.
 - THE CONSULTANT REMAINS RESPONSIBLE TO ENSURE THAT ALL THE GUIDELINES, STANDARD DRAWINGS, STANDARDS AND SPECIFICATIONS OF WATER AND SANITATION DEPARTMENT HAVE BEEN MET AND ARE COMPLIED WITH.
 - FINAL POSITION OF SERVICES TO BE DETERMINED ON SITE.

LEGEND

WATER

- NEW HYDRANT
- PROPOSED / NEW PIPE
- NEW VALVE
- NEW VALVE ON EXISTING PIPE
- NEW HYDRANT ON EXISTING PIPE
- NEW END CAP
- NEW PRV
- NEW AIR VALVE
- NEW WATER METER
- EXISTING PIPE CAPPED
- EXISTING END CAP
- EXISTING NETWORK PIPE
- EXISTING BULK PIPELINE
- EXISTING HYDRANT
- NODE NUMBER
- CLOSED VALVE
- EXISTING VALVE
- EXISTING COMMUNICATION PIPES
- EXISTING AIRVALVE
- EXISTING WATER METER
- EXISTING PRV
- EXISTING PUMP
- PIPE TO BE ABANDONED
- REDUNDANT PIPE
- EXISTING RES DISTRIBUTION ZONE
- PROPOSED RES DISTRIBUTION ZONE
- EXISTING RAND WATER PIPE
- SUBURB BOUNDARY
- SASOL GAS LINE
- PETRONET PIPE
- NEW PIPE IN NEW SLEEVE
- CROSS CUT
- PROPOSED SEWER

CITY OF TSHWANE
WATER AND SANITATION DEPARTMENT

PO BOX 1022
PRETORIA
0001

AMENDMENTS				
NR	DATE	APPROVED	DESCRIPTION	PAR
0	2-Oct-23		FOR CONSTRUCTION	

WATER AND SANITATION				
FOR INTERNAL APPROVAL - RECEIVED SIGN WHEN APPLICABLE				
DIRECTOR: WATER AND SANITATION - PLANNING				
NAME	Prof. Reg. No.	SIGNATURE	DATE	
REGIONAL DIRECTOR: (1,2,3,4,5,6 or 7)				
NAME	Prof. Reg. No.	SIGNATURE	DATE	
DIRECTOR: SYSTEM DEVELOPMENT				
NAME	Prof. Reg. No.	SIGNATURE	DATE	
DIRECTOR: BULK WATER				
NAME	Prof. Reg. No.	SIGNATURE	DATE	
DIRECTOR: INFRASTRUCTURE PROVISION				
NAME	Prof. Reg. No.	SIGNATURE	DATE	
DIRECTOR: WASTE WATER TREATMENT				
NAME	Prof. Reg. No.	SIGNATURE	DATE	

CONSULTANT DETAIL

IMBAWULA
CIVIL PROJECTS

PLOT 70
1463 Tienie Street
Anderson Ah
Zandfontein
Pretoria West
0183
Tel: 012 372 3708

1. **THAMI TOM** Prof. Reg. No. 2018300095
HEREBY CERTIFY THAT THE SERVICES WILL HAVE BEEN INSTALLED ACCORDING TO NOTE 9 OF THE ABOVE NOTES AND TO THE DRAWING.

SIGNATURE: *[Signature]* DATE: 2-Oct-23

CONSULTANT DRAWING NUMBER:
2022-AND-W-01U01

DESIGNED	
NAME: SAGWADI RINGANI	Prof. Reg. No.:
SIGNATURE: <i>[Signature]</i>	DATE:
DRAWN	
NAME: MOEMEDI MQOTAI	Prof. Reg. No.:
SIGNATURE: <i>[Signature]</i>	DATE:
CHECKED	
NAME: THAMI TOM	Prof. Reg. No. 2018300095
SIGNATURE: <i>[Signature]</i>	DATE: 2-Oct-23
INFORMATION OFFICE CHECKED	
NAME:	Prof. Reg. No.:
SIGNATURE:	DATE:
DESIGN OFFICE APPROVAL	
NAME:	Prof. Reg. No.:
SIGNATURE:	DATE: 2-Oct-23

CONTRACT	
No.:	
PROJECT No.	
SHEET No.	
1 OF 1	
PAPER SIZE:	
A1	
SCALE:	
1:1 000	
DATE:	
2-Oct-23	

PROJECT STATUS

RECEIVED SIGN WHEN APPLICABLE

CITY OF TSHWANE
WATER AND SANITATION DEPARTMENT

CONCEPT DRAWING
TENDER DRAWING
CONSTRUCTION DRAWING

PROJECT ENGINEER: **MOEMEDI MQOTAI** (2018300095)
SIGNATURE: *[Signature]* DATE: 2-Oct-23

INSPECTOR OF WORKS OF COT:
NAME: _____ Prof. Reg. No.: _____
SIGNATURE: _____ DATE: _____

LOCATION OF PROJECT:
ANDEON EXT 37
ZANDFONTAIN 317-JR
REGION 3
WARD 55

DESCRIPTION OF PROJECT:
CONSTRUCTION OF WATER SERVICES IN ANDEON EXT 37
GENERAL WATER LAYOUT (1 OF 1)

WBS No. : _____

COT DRAWING NUMBER:
DESCRIPTION OF PROJECT: _____