

SPECIAL NOTES:

MINIMUM REQUIRED LIGHTING LUX LEVELS AS PER PL 682 SPEC

NOTES:

1. RACKING TO COMPLY WITH TPL SPECIFICATION PL727.
2. RACKING MATERIAL: GALVANISED STEEL LADDER RACK.
3. RACKING TO BE INSTALLED 300mm CLEAR OF FLANGES (TO ALLOW FOR FLOGGING ACCESS).
4. INSTRUMENT AND ELECTRICAL RACKS TO CROSS AT 90 DEGREES.
5. DOUBLE BANKING OF CABLES ON RACKS IS PERMITTED.
6. ONLY MAIN RACKING RETICULATION ROUTES ARE SHOWN. SECONDARY RACKING AND ANGLE IRON DROPPERS TO BE SITE RUN.
7. POSITION OF LIGHTS TO BE CONFIRMED ON SITE WITH TPL SITE AGENT AND APPROVED DRAWINGS.

SYMBOL	DESCRIPTION	QTY	MAKE
Z1	SUITABLE ZONE 1 EX LED LUMINAIRE	8	TBC
Z2	SUITABLE ZONE 2 EX LED LUMINAIRE	20	TBC
RM	RAIL MOUNT	26	
BM	BUND MOUNT	2	
(Red line)	PROPOSED CABLE ROUTE		

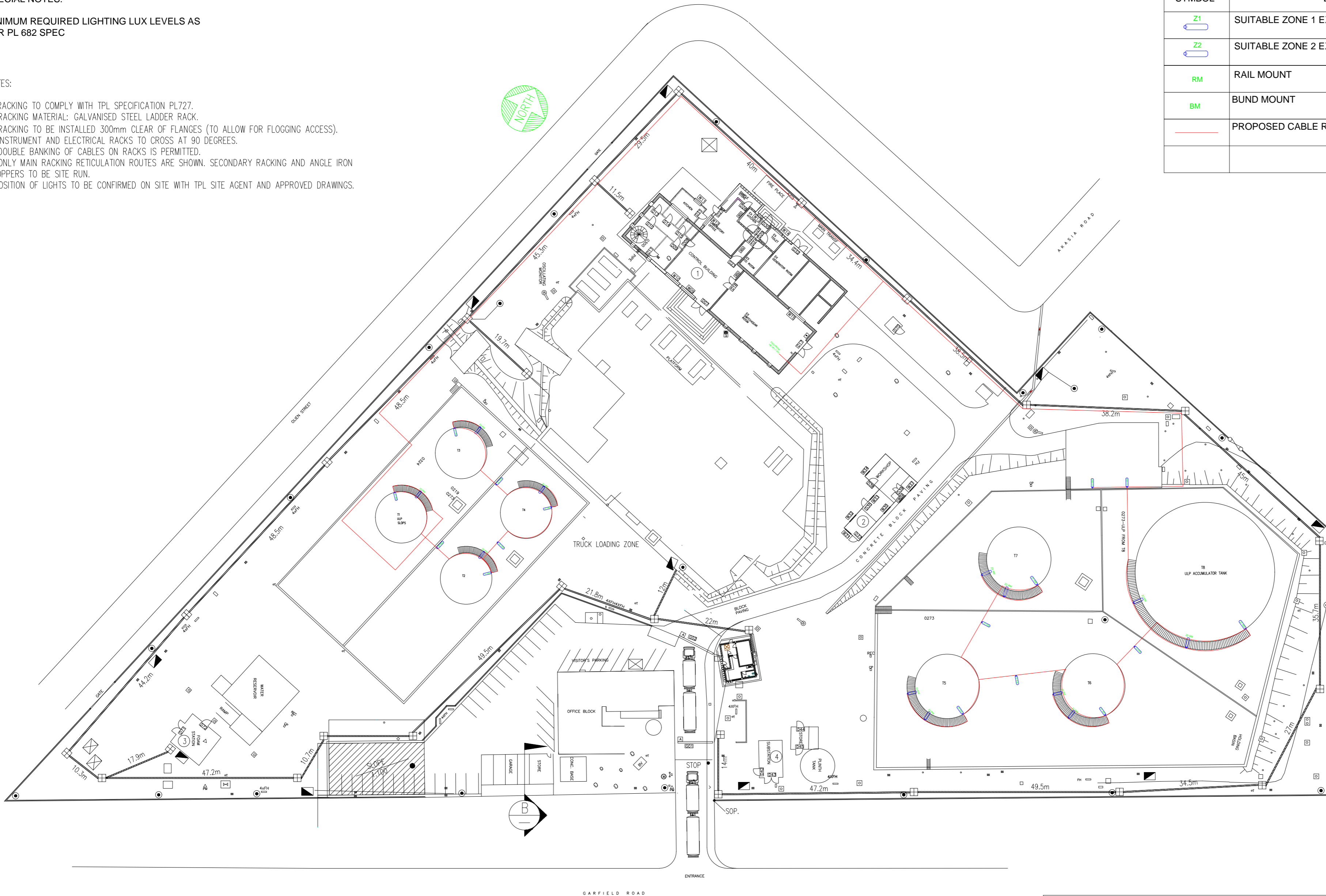

REVISIONS			
PROJECT NAME			
LIGHTING UPGRADE			
DRAWN	W.D	REF.	
TRACED	CAD	DATE	22.09.21
CHECKED	K.N	APPROVED	Z.M
SCALE	NTS		
DRAWING No.	PL 121717		REV

PROPOSAL

TRANSNET
pipelines
TANKS LIGHTING LAYOUT
ALRODE DEPOT