



Tender Clarification Meeting

Tender No. 97Q/2025/26: UPGRADE OF THE NOLUNGILE PUBLIC TRANSPORT INTERCHANGE

DATE: Friday, 14 November 2025

Venue: Existing Nolungile PTI in Ikwezi Park, Khayelitsha, entrance to White Hall from Njongo Avenue, Khayelitsha

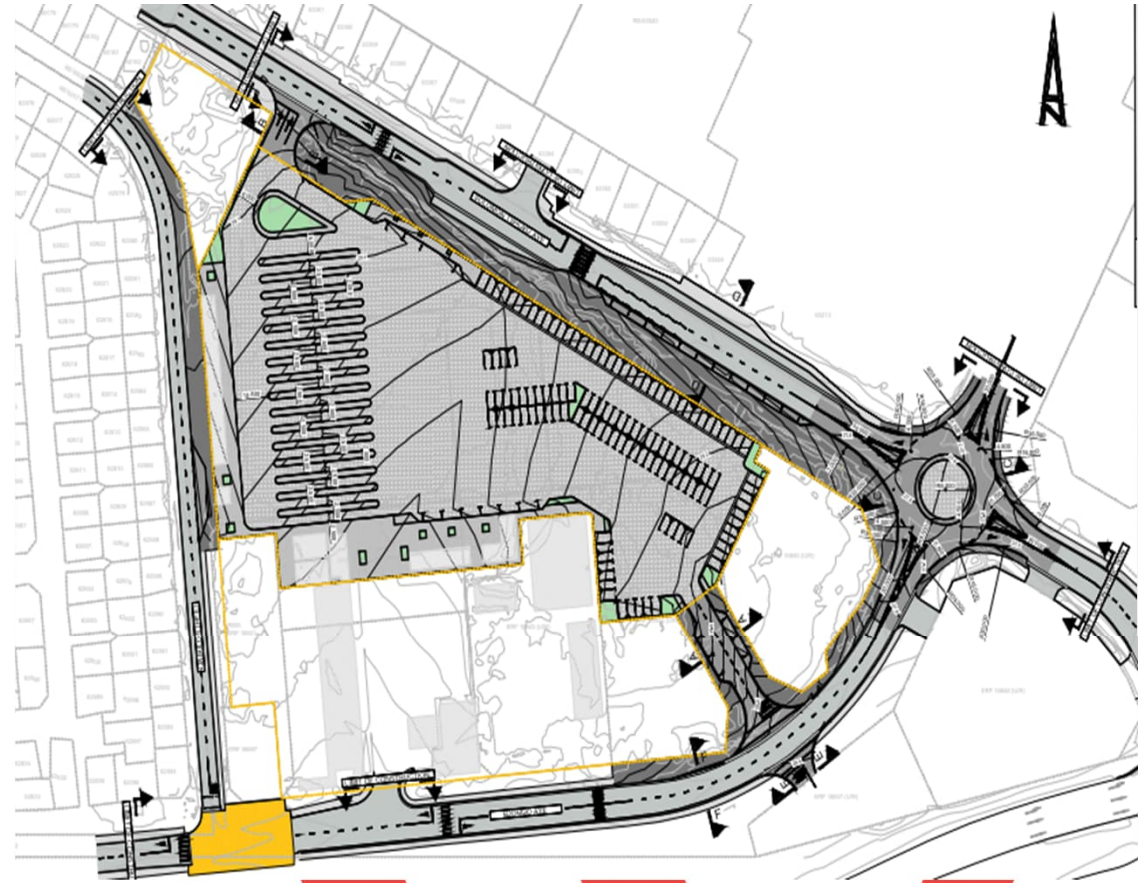

Tender: Upgrade of Nolungile PTI

- | | | | |
|---|------------------------------------|---|-------------------------------|
| 1 | Administrative Matters | 5 | Part C3: Scope of Work |
| 2 | Part T1: Tendering Procedures | 6 | Part C4: Site information |
| 3 | Part C1: Agreement & Contract Data | 7 | Part C5: Returnable documents |
| 4 | Part C2: Pricing data | 8 | Vol. 1 - Drawings |



Section 1

Administrative Matters



Clarification Presentation and Team

- Presentation will be issued to tenderers
- Project Team
 - Employer
City of Cape Town
 - Employer's Project Manager (CCT, Urban Mobility)
Janine Phigeland
 - Employer's Agent
TBC



Important Dates

Deliverable	Date
Non-Compulsory Tender Clarification Meeting	Friday, 14 November 2025 at 10h00
Submission of Queries	10h00 on Monday, 1 December 2025 (Request clarification of the tender documents, if necessary, by notifying the employer at least five (5) working days before the closing time stated in the tender data.)
Closing Date and Time	Monday, 8 December 2025 at 10h00 (Tender Box 220 at the Tender & Quotation Box Office, 2nd Floor (Concourse Level), Civic Centre, 12 Hertzog Boulevard, Cape Town)
Tender Opening	Monday, 8 December 2025 at 10h00 (Tender & Quotation Box Office, 2nd Floor (Concourse Level), Civic Centre, 12 Hertzog Boulevard, Cape Town)



List of Documents

Volume	Description	Obtainable from
Volume 1	Drawings list: p309 3.2.4 drawings)	The Project Document (As per Tender Issued by CCT with USB data stick)
Volume 2	The General Conditions of Contract for Construction Works, Third Edition, 2015 (SAICE)	South African Institution of Civil Engineering (SAICE)
Volume 3	The SANS Standardised Specifications for Civil Engineering Construction	Standards South Africa South African Institution of Civil Engineering (SAICE)
	And The COLTO Standard Specifications for Road and Bridge Works for State Road Authorities prepared by the Committee of Land Transport Officials.	



Conditions of Tender

- The Conditions of Tender are the Standard Conditions of Tender as contained in in Annexure C of the STANDARD FOR UNIFORMITY IN ENGINEERING AND CONSTRUCTION WORKS CONTRACTS AUGUST 2019

[Construction Industry Development Board Act: Standard for uniformity in engineering and construction workers contracts \(www.gov.za\)](#)

or

[Home | cidb](#)



Section 2

Part T1: Tendering Procedures



Part T1.1: Information in Tender Notice

- Tenderers must be registered on Supplier Databases (City of Cape Town, National Treasury Central Supplier Database)
- CIDB contractor grading designation of 8CE or higher
- Preferences are offered to tenderers who tender in accordance with
 - the Preferential Procurement Regulations (points for Specific Goals), and
 - the City of Cape Town's Supply Chain Management Policy (SCM Policy).
- Telegraphic, telephonic, telex, facsimile, e-mail and late tenders will not be accepted
- Queries – SCM.tenders8@capetown.gov.za
- The closing time for receipt of tenders is 10:00 on Monday, 8 December 2025



Part T1.2: Tender Data

Clause Number Tender Data

C.2.1.4.1 Construction Industry Development Board (CIDB) Registration 8CE

C.2.1.4.2 Compliance with requirements of CCT SCM Policy and procedures (subclause C.2.1.4.2)

Minimum score for functionality

C.2.1.4.3	Criterion No.	Description of functionality criteria	Maximum possible score
	1	Demonstrated experience of the tendering entity with respect to relevant construction projects;	50
	2	Demonstrated experience of the key staff in relation to the scope of work;	50
	Maximum possible score for Functionality		100

The minimum score for functionality is 60. Tenderers that fail to achieve the minimum score for functionality will be declared as non-responsive.

C.2.1.4.5 Good standing with Bargaining Council (BCCEI or any other relevant/recognized council)

C.2.8 Seek Clarification – read document and inspected site

C.2.12 Alternative tender offers
Separate offer (sealed envelope on a separate Form of Offer) on a separate set of tender documents.



Part T1.2: Tender Data

Clause Number Tender Data

C.2.13	<ul style="list-style-type: none">• Joint venture - recommend the standard CIDB Joint Venture Agreement• By signing the offer part of C1.1 Form of Offer and Acceptance the tenderer declares that all information provided in the tender submission is true and correct.• Where Addenda have been issued which amend the Bills of Quantities, then the printed Bills of Quantities shall take these into account.• Unauthorised alterations to the tender documents shall render the tender non-responsive.
	C.2.16 The tender offer validity period is 12 weeks (84 days).
	C.2.17 Non-responsive if the tenderer fails to provide any clarification or supporting documents requested by the Employer within the time for submission stated.
	C.2.18.4 Occupational Health and Safety Act, 85 of 1993 and the Construction Regulations, 2014 issued in terms of Section 43 of the Act.
C.2.23.1	Evidence of tax compliance and provide Tax Compliance Status PIN number



Part T1.2: Tender Data

C.3.8.2	Test for responsiveness – can reject a non-responsive offer
C.3.10	Clarification of tender offer - may request additional information
C.3.11	Evaluation of offers Price and Preference – 90/10
C.3.11.4	Risk analysis – necessary technical and professional qualification, competence – ability to fulfil obligation



Section 3

Part C1: Agreement and Contract Data



Contract Specific Data – Information Provided by the Employer

Clause		
1.1.1.13	Defects Liability Period	12 months
1.1.1.14	Time for achieving Practical Completion	32 Months (Incl. 2month Mobilization period)
5.13.1	Penalty for failing to complete the Works	R 10,000 per day
5.16.3	Latent Defects Period	10 Years
6.2.1	Performance Guarantee	7% of Contract Sum
6.10.1.5.1	"MoS"	80%
6.10.3	Retention	5%
8.6.1.3	limit of indemnity for liability insurance for any single claim	R 20 million



Section 4

Part C2: Pricing Data



Pricing Instructions

- Method of measurement – in accordance with SANS 1200
- The prices and rates to be inserted in the Bills of Quantities are to be the full inclusive prices for the work described.
- Bill No 10 and 11 – This is in addition to normal security measures by the contractor



Section 5

Part C3: Scope of Works



Locality



Construction Phasing and trader decanting:

Part C3: Scope of Works

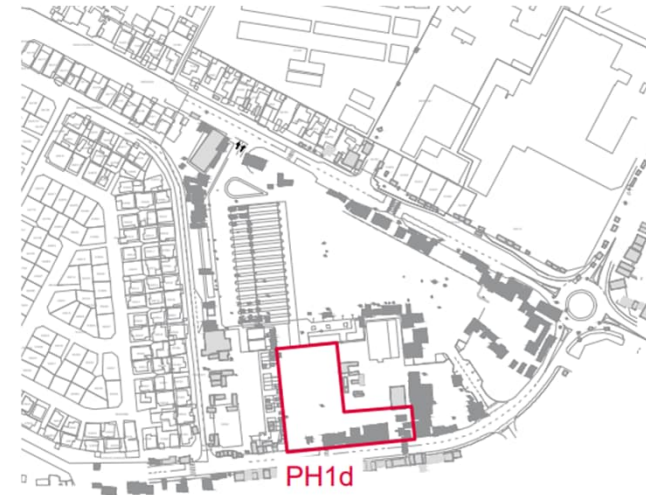
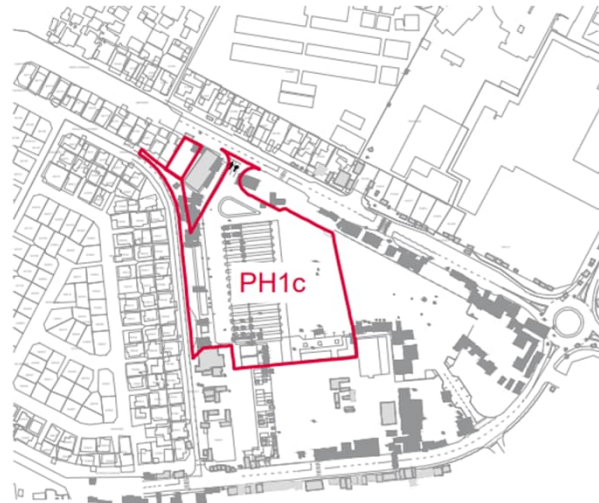
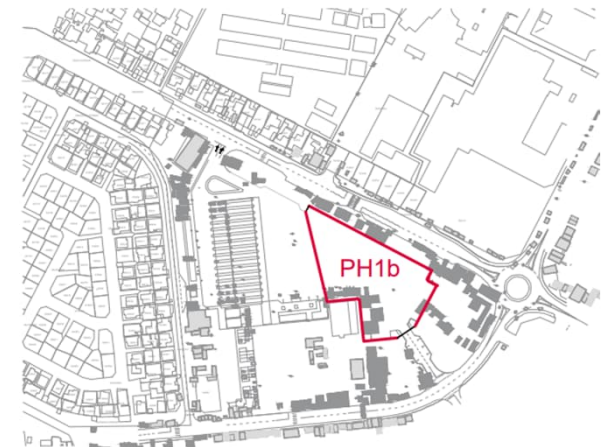
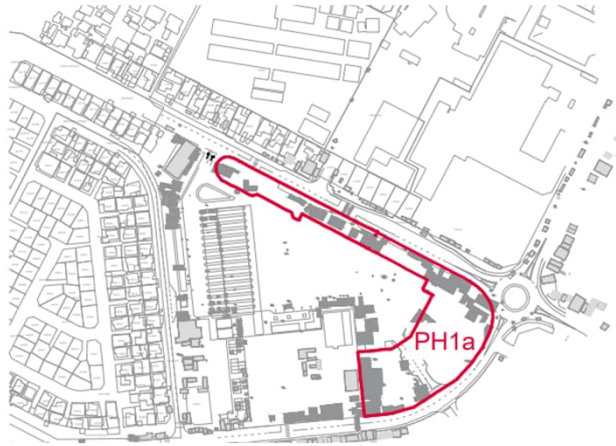

Part C3: Scope of Works



Part C3: Scope of Works

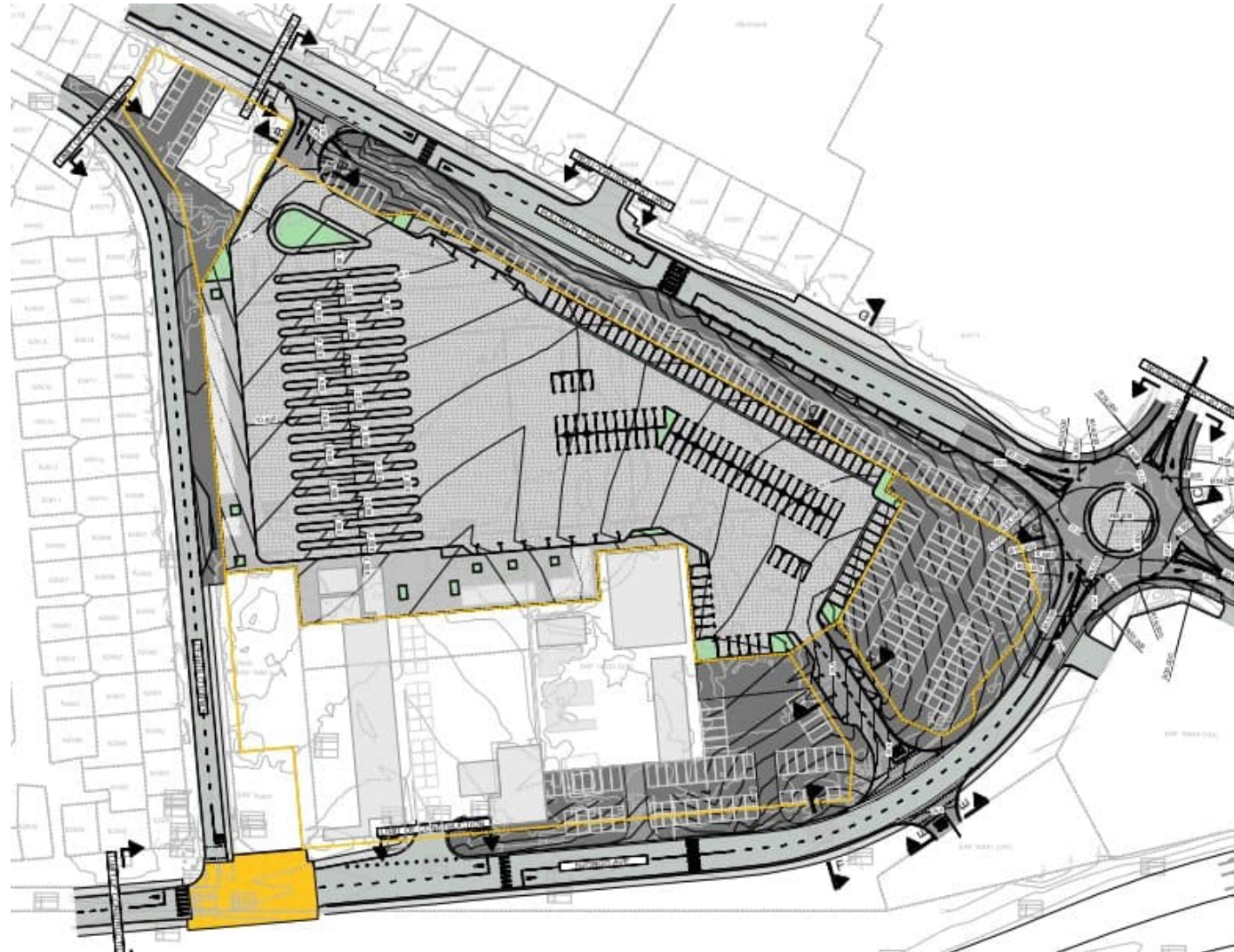

TRADER INFRASTRUCTURE SCOPE

Part C3: Scope of Works

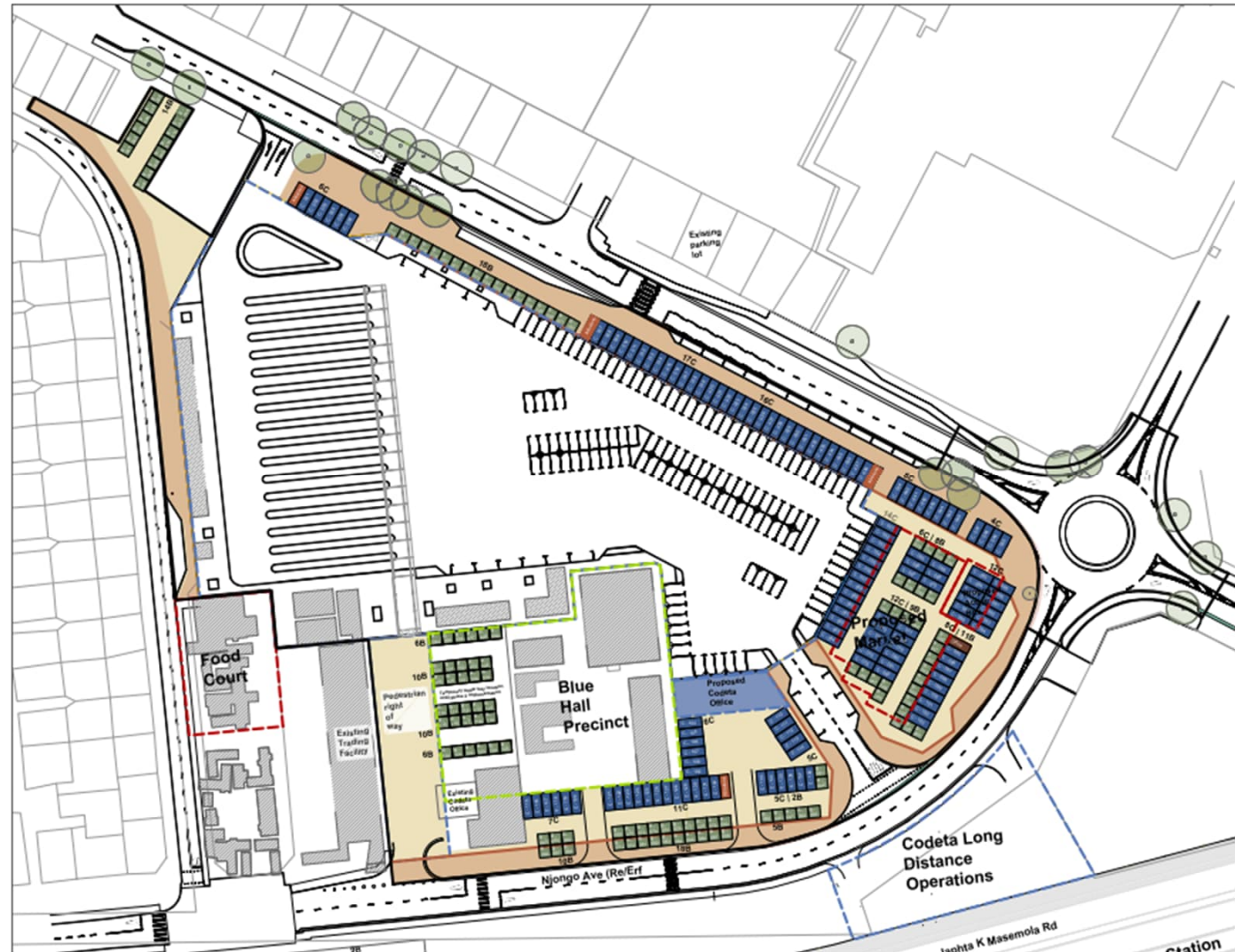

HOLDING SITE FOR TAXIS

Part C3: Scope of Works



C3.5 Management

3.5.1 Forms for contract Administration – Reports on labour,

B-BBEE Sub-contract, targets

3.5.2.2 Targeted Area: Sub-Council 9

3.5.2. : Minimum targeted labour contract participation goal, $CPG_L = 3\%$

3.5.3 CLO

3.5.4 : Minimum targeted enterprises contract participation goal, $CPG_E = 10\%$

Also refer to Annexes C3.6:



Section 6

Part C4: Site Information



Site Information

- Accommodation of traffic important – heavy congestion in area
- Also refer to Annexes C3.6:

C3.6 Annexes

CONTENTS

Annex 1: Monthly Project Labour Report

Annex 2: B-BBEE Sub-contract Expenditure Report

Annex 3: Joint Venture Expenditure Report

Annex 4: Targeted Labour Contract Participation Expenditure Report

Annex 5: Targeted Enterprises Contract Participation Expenditure Report

Annex 6: Site Specific Health & Safety Specification – separate on USB

Annex 7: Construction Environmental Management Plan – separate on USB

Annex 8: Geotechnical Report – separate on USB

Annex 9 GPR & EML Scanning & GPS Coordinating Underground Services - Nolungile PTI – separate on USB

Annex 10: Topographical Survey – separate on USB

Annex 11: KYC for appointed contractor

Annex 12: Trader Report



Section 7

Part C5: Returnable Documents



List of Returnable Documents

- Make sure all Returnables are fully completed and proof attached where required
- Pay attention to notes provided for completion of each form on the first page of each form
- Signatures declares the accuracy and correctness of the information provided.
- Completed in non-erasable ink and any alterations made prior to tender closure countersigned by an authorised signatory.



Section 8

Volume 1 Drawings



List of Drawings

3.2.4 DRAWINGS

The list of drawings which are included in Volume 1

<u>Drawing List</u>	<u>Name</u>	<u>Rev</u>
Civil		
PTI-WSP-NOL-ZZ-DR-CV-GL1001	General Layout	D
PTI-WSP-NOL-ZZ-DR-CV-GL1002	Locality Layout	C
PTI-WSP-NOL-EG-DR-CV-GL1003	Existing Services Layout	B
PTI-WSP-NOL-ZZ-DR-CV-GL1004	Combined Services Layout	D
PTI-WSP-NOL-ZZ-DR-CV-BE1005	Earthworks Layout	D
PTI-WSP-NOL-ZZ-DR-CV-GL1006	Setting out Layout	D
PTI-WSP-NOL-ZZ-DR-CV-GL1007	Setting out Layout	D
PTI-WSP-NOL-ZZ-DR-CV-GL1008	Layerworks	B
Sewer		
PTI-WSP-NOL-ZZ-DR-CV-SE1009	Sewer Layout	E
PTI-WSP-NOL-ZZ-DR-CV-LS1010	Sewer Long Section	E
PTI-WSP-NOL-ZZ-DR-CV-LS1011	Sewer Long Section	A
PTI-WSP-NOL-ZZ-DR-CV-LS1012	Sewer Long Section	A
Water		
PTI-WSP-NOL-ZZ-DR-CV-WA1014	Water Layout	D
PTI-WSP-NOL-ZZ-DR-CV-WA1015	Water Layout	D
PTI-WSP-NOL-ZZ-DR-CV-WA1018	Water Chamber and Twin Booster	B
PTI-WSP-NOL-ZZ-DR-CV-TD 1019	Connection and Water Chamber	C
PTI-WSP-NOL-ZZ-DR-CV-TD 1020	Connection and Water Chamber (75mm)	B
PTI-WSP-NOL-ZZ-DR-CV-TD 1021	Water Chamber and Twin Booster (75mm)	C
Stormwater		
PTI-WSP-NOL-ZZ-DR-CV-SW1022	stormwater Layout	D
PTI-WSP-NOL-ZZ-DR-CV-LS1023	Stormwater Long Section	D
PTI-WSP-NOL-ZZ-DR-CV-LS1024	Stormwater Long Section	D
PTI-WSP-NOL-ZZ-DR-CV-LS1025	Stormwater Long Section	D
PTI-WSP-NOL-ZZ-DR-CV-LS1026	Stormwater Long Section	B



Questions and Answers

- None
- Additional comments by CCT PM:
 - Expect and allow for concurrent works by other contractors on Japhta K Masemola Road.



Thank you



wsp.com



CITY OF CAPE TOWN
ISIXEKO SASEKAPA
STAD KAAPSTAD