

ARCHITECT

- REVISIONS / NOTES**
- 1. ALL DIMENSIONS ARE IN METERS UNLESS OTHERWISE SPECIFIED.
 - 2. ALL DIMENSIONS ARE TO FACE UNLESS OTHERWISE SPECIFIED.
 - 3. ALL DIMENSIONS ARE TO FACE UNLESS OTHERWISE SPECIFIED.
 - 4. ALL DIMENSIONS ARE TO FACE UNLESS OTHERWISE SPECIFIED.
 - 5. ALL DIMENSIONS ARE TO FACE UNLESS OTHERWISE SPECIFIED.
 - 6. ALL DIMENSIONS ARE TO FACE UNLESS OTHERWISE SPECIFIED.
 - 7. ALL DIMENSIONS ARE TO FACE UNLESS OTHERWISE SPECIFIED.
 - 8. ALL DIMENSIONS ARE TO FACE UNLESS OTHERWISE SPECIFIED.
 - 9. ALL DIMENSIONS ARE TO FACE UNLESS OTHERWISE SPECIFIED.
 - 10. ALL DIMENSIONS ARE TO FACE UNLESS OTHERWISE SPECIFIED.

NO.	DATE	DESCRIPTION
1	15/01/2024	ISSUED FOR PERMIT
2	15/01/2024	ISSUED FOR PERMIT
3	15/01/2024	ISSUED FOR PERMIT
4	15/01/2024	ISSUED FOR PERMIT
5	15/01/2024	ISSUED FOR PERMIT
6	15/01/2024	ISSUED FOR PERMIT
7	15/01/2024	ISSUED FOR PERMIT
8	15/01/2024	ISSUED FOR PERMIT
9	15/01/2024	ISSUED FOR PERMIT
10	15/01/2024	ISSUED FOR PERMIT

VHB ASSOCIATES
ARCHITECTURE & PROJECT MANAGEMENT
 100/101/102/103/104/105/106/107/108/109/110/111/112/113/114/115/116/117/118/119/120/121/122/123/124/125/126/127/128/129/130/131/132/133/134/135/136/137/138/139/140/141/142/143/144/145/146/147/148/149/150/151/152/153/154/155/156/157/158/159/160/161/162/163/164/165/166/167/168/169/170/171/172/173/174/175/176/177/178/179/180/181/182/183/184/185/186/187/188/189/190/191/192/193/194/195/196/197/198/199/200/201/202/203/204/205/206/207/208/209/210/211/212/213/214/215/216/217/218/219/220/221/222/223/224/225/226/227/228/229/230/231/232/233/234/235/236/237/238/239/240/241/242/243/244/245/246/247/248/249/250/251/252/253/254/255/256/257/258/259/260/261/262/263/264/265/266/267/268/269/270/271/272/273/274/275/276/277/278/279/280/281/282/283/284/285/286/287/288/289/290/291/292/293/294/295/296/297/298/299/300/301/302/303/304/305/306/307/308/309/310/311/312/313/314/315/316/317/318/319/320/321/322/323/324/325/326/327/328/329/330/331/332/333/334/335/336/337/338/339/340/341/342/343/344/345/346/347/348/349/350/351/352/353/354/355/356/357/358/359/360/361/362/363/364/365/366/367/368/369/370/371/372/373/374/375/376/377/378/379/380/381/382/383/384/385/386/387/388/389/390/391/392/393/394/395/396/397/398/399/400/401/402/403/404/405/406/407/408/409/410/411/412/413/414/415/416/417/418/419/420/421/422/423/424/425/426/427/428/429/430/431/432/433/434/435/436/437/438/439/440/441/442/443/444/445/446/447/448/449/450/451/452/453/454/455/456/457/458/459/460/461/462/463/464/465/466/467/468/469/470/471/472/473/474/475/476/477/478/479/480/481/482/483/484/485/486/487/488/489/490/491/492/493/494/495/496/497/498/499/500/501/502/503/504/505/506/507/508/509/510/511/512/513/514/515/516/517/518/519/520/521/522/523/524/525/526/527/528/529/530/531/532/533/534/535/536/537/538/539/540/541/542/543/544/545/546/547/548/549/550/551/552/553/554/555/556/557/558/559/560/561/562/563/564/565/566/567/568/569/570/571/572/573/574/575/576/577/578/579/580/581/582/583/584/585/586/587/588/589/590/591/592/593/594/595/596/597/598/599/600/601/602/603/604/605/606/607/608/609/610/611/612/613/614/615/616/617/618/619/620/621/622/623/624/625/626/627/628/629/630/631/632/633/634/635/636/637/638/639/640/641/642/643/644/645/646/647/648/649/650/651/652/653/654/655/656/657/658/659/660/661/662/663/664/665/666/667/668/669/670/671/672/673/674/675/676/677/678/679/680/681/682/683/684/685/686/687/688/689/690/691/692/693/694/695/696/697/698/699/700/701/702/703/704/705/706/707/708/709/710/711/712/713/714/715/716/717/718/719/720/721/722/723/724/725/726/727/728/729/730/731/732/733/734/735/736/737/738/739/740/741/742/743/744/745/746/747/748/749/750/751/752/753/754/755/756/757/758/759/760/761/762/763/764/765/766/767/768/769/770/771/772/773/774/775/776/777/778/779/780/781/782/783/784/785/786/787/788/789/790/791/792/793/794/795/796/797/798/799/800/801/802/803/804/805/806/807/808/809/810/811/812/813/814/815/816/817/818/819/820/821/822/823/824/825/826/827/828/829/830/831/832/833/834/835/836/837/838/839/840/841/842/843/844/845/846/847/848/849/850/851/852/853/854/855/856/857/858/859/860/861/862/863/864/865/866/867/868/869/870/871/872/873/874/875/876/877/878/879/880/881/882/883/884/885/886/887/888/889/890/891/892/893/894/895/896/897/898/899/900/901/902/903/904/905/906/907/908/909/910/911/912/913/914/915/916/917/918/919/920/921/922/923/924/925/926/927/928/929/930/931/932/933/934/935/936/937/938/939/940/941/942/943/944/945/946/947/948/949/950/951/952/953/954/955/956/957/958/959/960/961/962/963/964/965/966/967/968/969/970/971/972/973/974/975/976/977/978/979/980/981/982/983/984/985/986/987/988/989/990/991/992/993/994/995/996/997/998/999/1000

CLIENTS & ATTORNEYS TO EX OFFICES -
ARIZONA TRAFFIC DEPARTMENT
MUNICIPALITY OF GUAYMAS
MEXICANA

SITE DEVELOPMENT PLAN
 SCALE: 1:200
 DATE: JANUARY 2024
 DRAWN: A. DANI
 CHECKED: V. BARRON
 PROJECT: V. BARRON

NO.	DATE	DESCRIPTION
1	15/01/2024	ISSUED FOR PERMIT
2	15/01/2024	ISSUED FOR PERMIT
3	15/01/2024	ISSUED FOR PERMIT
4	15/01/2024	ISSUED FOR PERMIT
5	15/01/2024	ISSUED FOR PERMIT
6	15/01/2024	ISSUED FOR PERMIT
7	15/01/2024	ISSUED FOR PERMIT
8	15/01/2024	ISSUED FOR PERMIT
9	15/01/2024	ISSUED FOR PERMIT
10	15/01/2024	ISSUED FOR PERMIT

SCHEDULE OF AREAS:
 AREA: 1000 SQ M
 OCCUPANCY: 1000
 EXISTING BUILDING: 1000 SQ M
 PROPOSED BUILDING: 1000 SQ M
 TOTAL AREA: 1000 SQ M

VHB ASSOCIATES
ARCHITECTURE & PROJECT MANAGEMENT
 100/101/102/103/104/105/106/107/108/109/110/111/112/113/114/115/116/117/118/119/120/121/122/123/124/125/126/127/128/129/130/131/132/133/134/135/136/137/138/139/140/141/142/143/144/145/146/147/148/149/150/151/152/153/154/155/156/157/158/159/160/161/162/163/164/165/166/167/168/169/170/171/172/173/174/175/176/177/178/179/180/181/182/183/184/185/186/187/188/189/190/191/192/193/194/195/196/197/198/199/200/201/202/203/204/205/206/207/208/209/210/211/212/213/214/215/216/217/218/219/220/221/222/223/224/225/226/227/228/229/230/231/232/233/234/235/236/237/238/239/240/241/242/243/244/245/246/247/248/249/250/251/252/253/254/255/256/257/258/259/260/261/262/263/264/265/266/267/268/269/270/271/272/273/274/275/276/277/278/279/280/281/282/283/284/285/286/287/288/289/290/291/292/293/294/295/296/297/298/299/300/301/302/303/304/305/306/307/308/309/310/311/312/313/314/315/316/317/318/319/320/321/322/323/324/325/326/327/328/329/330/331/332/333/334/335/336/337/338/339/340/341/342/343/344/345/346/347/348/349/350/351/352/353/354/355/356/357/358/359/360/361/362/363/364/365/366/367/368/369/370/371/372/373/374/375/376/377/378/379/380/381/382/383/384/385/386/387/388/389/390/391/392/393/394/395/396/397/398/399/400/401/402/403/404/405/406/407/408/409/410/411/412/413/414/415/416/417/418/419/420/421/422/423/424/425/426/427/428/429/430/431/432/433/434/435/436/437/438/439/440/441/442/443/444/445/446/447/448/449/450/451/452/453/454/455/456/457/458/459/460/461/462/463/464/465/466/467/468/469/470/471/472/473/474/475/476/477/478/479/480/481/482/483/484/485/486/487/488/489/490/491/492/493/494/495/496/497/498/499/500/501/502/503/504/505/506/507/508/509/510/511/512/513/514/515/516/517/518/519/520/521/522/523/524/525/526/527/528/529/530/531/532/533/534/535/536/537/538/539/540/541/542/543/544/545/546/547/548/549/550/551/552/553/554/555/556/557/558/559/560/561/562/563/564/565/566/567/568/569/570/571/572/573/574/575/576/577/578/579/580/581/582/583/584/585/586/587/588/589/590/591/592/593/594/595/596/597/598/599/600/601/602/603/604/605/606/607/608/609/610/611/612/613/614/615/616/617/618/619/620/621/622/623/624/625/626/627/628/629/630/631/632/633/634/635/636/637/638/639/640/641/642/643/644/645/646/647/648/649/650/651/652/653/654/655/656/657/658/659/660/661/662/663/664/665/666/667/668/669/670/671/672/673/674/675/676/677/678/679/680/681/682/683/684/685/686/687/688/689/690/691/692/693/694/695/696/697/698/699/700/701/702/703/704/705/706/707/708/709/710/711/712/713/714/715/716/717/718/719/720/721/722/723/724/725/726/727/728/729/730/731/732/733/734/735/736/737/738/739/740/741/742/743/744/745/746/747/748/749/750/751/752/753/754/755/756/757/758/759/760/761/762/763/764/765/766/767/768/769/770/771/772/773/774/775/776/777/778/779/780/781/782/783/784/785/786/787/788/789/790/791/792/793/794/795/796/797/798/799/800/801/802/803/804/805/806/807/808/809/810/811/812/813/814/815/816/817/818/819/820/821/822/823/824/825/826/827/828/829/830/831/832/833/834/835/836/837/838/839/840/841/842/843/844/845/846/847/848/849/850/851/852/853/854/855/856/857/858/859/860/861/862/863/864/865/866/867/868/869/870/871/872/873/874/875/876/877/878/879/880/881/882/883/884/885/886/887/888/889/890/891/892/893/894/895/896/897/898/899/900/901/902/903/904/905/906/907/908/909/910/911/912/913/914/915/916/917/918/919/920/921/922/923/924/925/926/927/928/929/930/931/932/933/934/935/936/937/938/939/940/941/942/943/944/945/946/947/948/949/950/951/952/953/954/955/956/957/958/959/960/961/962/963/964/965/966/967/968/969/970/971/972/973/974/975/976/977/978/979/980/981/982/983/984/985/986/987/988/989/990/991/992/993/994/995/996/997/998/999/1000



FIRE PROTECTION NOTES:

- 1. ALL BUILDINGS SHALL BE CONSTRUCTED TO MEET THE REQUIREMENTS OF THE NATIONAL FIRE PROTECTION ASSOCIATION (NFPA) 101, LIFE SAFETY CODE.
- 2. ALL BUILDINGS SHALL BE CONSTRUCTED TO MEET THE REQUIREMENTS OF THE NATIONAL FIRE PROTECTION ASSOCIATION (NFPA) 101, LIFE SAFETY CODE.
- 3. ALL BUILDINGS SHALL BE CONSTRUCTED TO MEET THE REQUIREMENTS OF THE NATIONAL FIRE PROTECTION ASSOCIATION (NFPA) 101, LIFE SAFETY CODE.
- 4. ALL BUILDINGS SHALL BE CONSTRUCTED TO MEET THE REQUIREMENTS OF THE NATIONAL FIRE PROTECTION ASSOCIATION (NFPA) 101, LIFE SAFETY CODE.
- 5. ALL BUILDINGS SHALL BE CONSTRUCTED TO MEET THE REQUIREMENTS OF THE NATIONAL FIRE PROTECTION ASSOCIATION (NFPA) 101, LIFE SAFETY CODE.

FIRE EQUIPMENT LEGEND:

- 1. FIRE HYDRANT
- 2. 1.5m FIRE HOSE REEL
- 3. 2.5m FIRE HOSE REEL
- 4. 4.5m FIRE HOSE REEL
- 5. 7.5m FIRE HOSE REEL
- 6. 10.5m FIRE HOSE REEL
- 7. 13.5m FIRE HOSE REEL
- 8. 16.5m FIRE HOSE REEL
- 9. 19.5m FIRE HOSE REEL
- 10. 22.5m FIRE HOSE REEL

SEWERAGE LEGEND:

- 1. 150mm
- 2. 200mm
- 3. 250mm
- 4. 300mm
- 5. 350mm
- 6. 400mm
- 7. 450mm
- 8. 500mm
- 9. 550mm
- 10. 600mm

SCALE: 1:200

SITE DEVELOPMENT PLAN

MLM 07 **SDP 01** **C**

GENERAL NOTES:

- NO CONSTRUCTION WORK SHALL COMMENCE ON SITE PRIOR TO THE RECEIPT OF ALL NECESSARY PERMITS FROM THE LOCAL MUNICIPALITY.
- ALL WORK TO COMPLY WITH SANS 10400.
- ALL LEVELS AND DIMENSIONS TO BE CHECKED ON SITE PRIOR TO COMMENCEMENT OF WORK.
- ALL DISCREPANCIES TO BE BROUGHT TO THE IMMEDIATE ATTENTION OF THE AUTHOR.
- ALL PLUMBING BY REGISTERED CONTRACTOR.
- IF ON EXCAVATION IT IS FOUND TO CONTAIN EXPANSIVE CLAY, EXCESSIVE GROUND WATER OR OTHER POOR SOIL CONDITIONS, THE CONTRACTOR SHALL BE RESPONSIBLE TO THE SUITABLE PROFESSIONAL ENGINEER FOR THE DESIGN OF FOUNDATION.
- FACE BRICK FINISH OR 1,000mm WIDE CONCRETE APRON TO BE PROVIDED AROUND BUILDING.
- BOUNDARY WALLS TO BE FINISHED WITH FACE BRICK OR 1,000mm WIDE CONCRETE APRON TO BE PROVIDED IN ACCORDANCE WITH H12.
- SAFETY GLAZING IN ACCORDANCE WITH H12 REQUIRED.
- ONLY FIGURED DIMENSIONS TO BE USED ON ALL DRAWINGS.

No.	BY	DATE	REVISION

COPYRIGHT IS VESTED IN VHB ASSOCIATES IN TERMS OF THE COPYRIGHT ACT, (ACT 98 OF 1978)

CLIENT'S SIGNATURE

VHB ASSOCIATES
ARCHITECTURE & PROJECT MANAGEMENT
 HEAD OFFICE: KWAZULU NATAL
 BRANCH: EASTERN CAPE
 SUITE 1, BESSET HOUSE
 SEAWAY CENTRE
 48 BISSET STREET
 PORT SHEPSTONE 6040
 TEL: 083 032 0003
 TEL: 083 251 8479
 MOBILE : 082 554 3427
 P. O. BOX 455, PORT SHEPSTONE, 4240
 e-mail: vhb@vhbassociates.co.za

PROJECT:
ADDITIONS & ALTERATIONS TO EX. OFFICES - MBIZANA TRAFFIC DEPARTMENT
 MUNICIPALITY
 WUNNIE MADIKIZELA-MANDELA LOCAL
 MUNICIPALITY
 CONTRACT DESCRIPTION:
ERF 3105 (A PORTION OF 110)
 MBIZANA

DRAWING:
ABLUTION BLOCK - SECTION & ELEVATIONS

DESIGNED BY	V. BRIDGLLALL	DATE	JANUARY 2026
DRAWN BY	J. DUKE	SCALE	AS SHOWN
CHECKED BY	V. BRIDGLLALL	SIZE	A2
JOB NO.	MLM 07	SHEET NO.	CW 03
REV.	A		

ROOF: DOUBLE ROMAN CONCRETE ROOF TILES BY MARLEY TO MATCH EXISTING ON 35 x 35 BATTENS ON SERRATED 100mm SPACINGS
 MAX. TRUSS SPACING 750mm
 ROOF PITCH: 22.5° TO MATCH EXISTING
 PVC GUTTERS AND DOWNPIPS BY MARLEY
 SKIMMED 1:2:4 FINE CEMENT CEILING BOARDS ON 32 X 35 S/P BRACKINGS AT MAX. 400mm CENTRES
 FACEBRICK ON EDGE WINDOW CILL
 100mm CONCRETE SLAB ON B.C. MESH ON 40mm S.P.M. ON WELL COMPACTED POSIONED SOIL BY SPECIALISTS
 SOIL POSIONING TO COMPLY WITH SANS 10124
 1,000mm WIDE CONCRETE APRON LAD TO FALL TO PR. ENGS. DETAILS
 WELL COMPACTED POSIONED FILL TO PR. ENGS. DETAILS

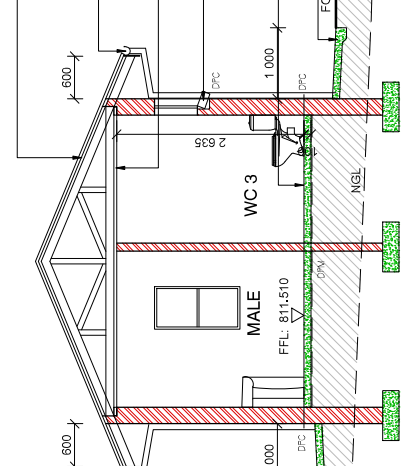

SECTION A - A
 ALL FOUNDATIONS TO PR. ENGS. DETAILS
 SCALE : 1 : 50

FACEBRICK TO MATCH EXISTING
 1:1.2 CONCRETE RAMP TO PR. ENGS DETAILS
 FACE BRICK PLANTER BOX FINISHED WITH BRICK ON EDGE ROLLER COURSE
 1,000mm HIGH GALVANIZED STEEL SAFETY BALUSTRADES TO COMPLY WITH DD 2 OF SANS 10400
 FOUNDATIONS TO PR. ENGS DETAILS

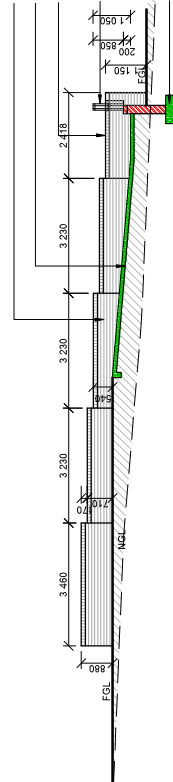

SECTION D - D
 ALL FOUNDATIONS TO PR. ENGS. DETAILS
 SCALE : 1 : 100

AUTEC BUILDING PLANKS LAPPED TO FORM DUTCH GABLE TO MATCH EXISTING
 PVC GUTTERS AND DOWNPIPS BY MARLEY
 ALUMINUM FRAMED WINDOWS TO MATCH EXISTING
 FACEBRICK ON EDGE WINDOW CILL
 FACEBRICK TO MATCH EXISTING GOLDEN WHITE
 FACEBRICK TO MATCH EXISTING GOLDEN WHITE
 1,000mm WIDE CONCRETE APRON LAD TO FALL TO PR. ENGS. DETAILS
 1,000mm WIDE CONCRETE APRON LAD TO FALL TO PR. ENGS. DETAILS

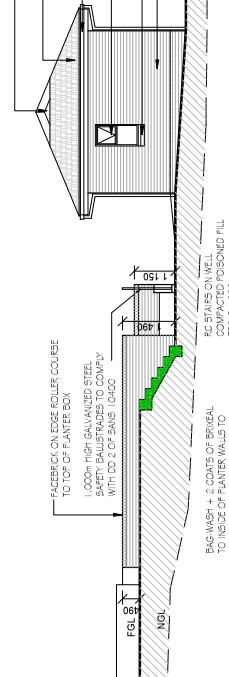

SOUTH WEST ELEVATION
 SCALE : 1 : 100

NORTH WEST ELEVATION
 SCALE : 1 : 100

AUTEC BUILDING PLANKS LAPPED TO FORM DUTCH GABLE TO MATCH EXISTING
 PVC GUTTERS AND DOWNPIPS BY MARLEY
 ALUMINUM FRAMED WINDOWS TO MATCH EXISTING
 FACEBRICK TO MATCH EXISTING GOLDEN WHITE
 FACEBRICK TO MATCH EXISTING GOLDEN WHITE
 1,000mm WIDE CONCRETE APRON LAD TO FALL TO PR. ENGS. DETAILS
 1,000mm WIDE CONCRETE APRON LAD TO FALL TO PR. ENGS. DETAILS

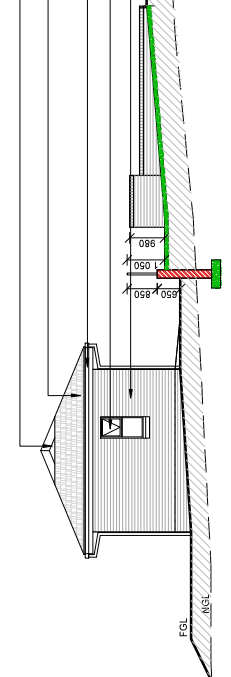

NORTH EAST ELEVATION
 SCALE : 1 : 100

SOUTH EAST ELEVATION
 SCALE : 1 : 100

GENERAL NOTES:

- NO CONSTRUCTION WORK SHALL COMMENCE ON SITE PRIOR TO OBTAINING ALL NECESSARY APPROVALS FROM THE LOCAL MUNICIPALITY.
- ALL WORK TO COMPLY WITH SANS 10100.
- ALL LEVELS AND DIMENSIONS TO BE CHECKED ON SITE PRIOR TO COMMENCEMENT OF WORK.
- ALL DISCREPANCIES TO BE BROUGHT TO THE IMMEDIATE ATTENTION OF THE AUTHOR.
- ALL PLUMBING BY REGISTERED CONTRACTOR.
- ALL ELECTRICAL BY REGISTERED CONTRACTOR.
- IF ON EXCAVATION IT IS FOUND TO CONTAIN EXPANSIVE CLAY, EXCESSIVE GROUND WATER OR OTHER POOR SOIL CONDITIONS, THE CONTRACTOR SHALL BE RESPONSIBLE TO OBTAIN PROFESSIONAL ENGINEER'S OPINION AND TO BE BOUND BY HIS RECOMMENDATIONS.
- FACE BRICK FINISH OR 1,000mm WIDE CONCRETE APRON TO BE PROVIDED AROUND BUILDING.
- ALL ROOFING TO BE PROVIDED ON SITE.
- BOUNDARY BLOCKS TO BE EXPOSED AND DEMARCATED.
- GLASS THICKNESS TO COMPLY WITH IN12.
- SAFETY GLAZING IN ACCORDANCE WITH IN13 REQUIRED.
- ONLY FIGURED DIMENSIONS TO BE USED ON ALL DRAWINGS.

No.	BY	DATE	REVISION

COPYRIGHT IS VESTED IN VHB ASSOCIATES IN TERMS OF THE COPYRIGHT ACT, (ACT 98 OF 1978)

CLIENT'S SIGNATURE

VHB ASSOCIATES
ARCHITECTURE & PROJECT MANAGEMENT
 HEAD OFFICE: KWAZULU NATAL
 SUITE 1, BESSET HOUSE
 48 BESSET STREET 4240
 PORT SHEPSTONE 4240
 TEL: 086 551 8476
 MOBILE : 082 554 3427
 P. O. BOX 455, PORT SHEPSTONE, 4240
 e-mail: vhbassociates.co.za

PROJECT:
ADDITIONS & ALTERATIONS TO EX. OFFICES - MBIZANA TRAFFIC DEPARTMENT FOR: WINNIE MADIKIZELA-MANDELA LOCAL MUNICIPALITY
 COASTAL DESCRIPTION:
ERF 3105 (A PORTION OF 110) MBIZANA

DRAWING:
TILING LAYOUT

DESIGNED BY	V. BRIDGLALL	DATE	JANUARY 2025
DRAWN BY	J. DUKE	SCALE	AS SHOWN
CHECKED BY	V. BRIDGLALL	SIZE	A2

JOB No.	MLM 07	SHEET No.	CW 06	REV.	A
---------	--------	-----------	-------	------	---

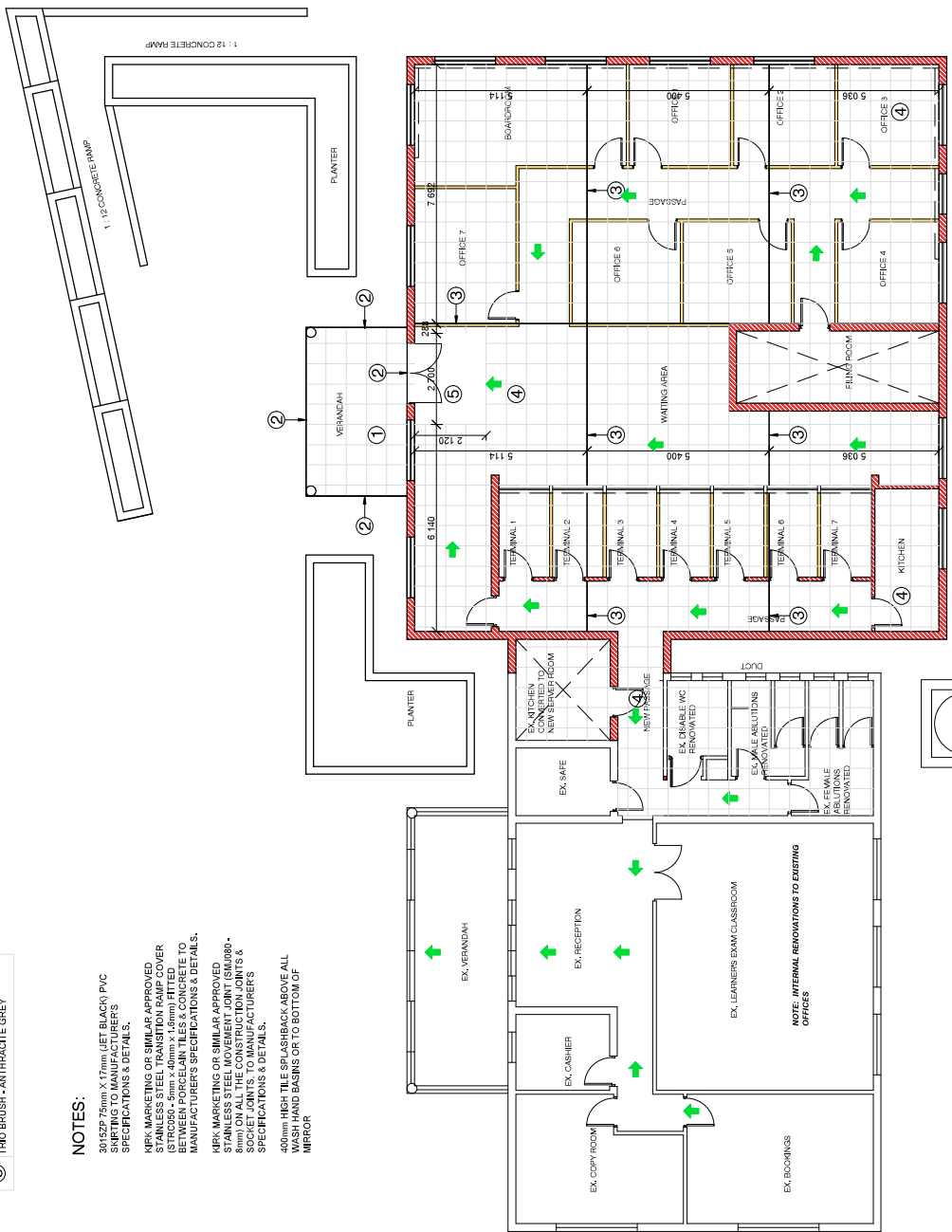
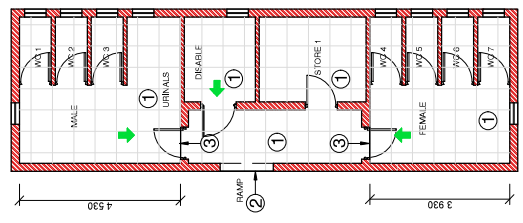

FLOOR FINISHES

- ① 600 X 600 SALT & PEPPER PORCELAIN FLOOR TILE
- ② ALUMINIUM SQUARE EDGE TRIM
- ③ KERI MARKETING OR SIMILAR APPROVED 10mm M-TFM MOVEMENT JOINT
- ④ 600 X 600 MATT PORCELAIN FLOOR TILE
- ⑤ ENTRANCE MAT - TRIO BRUSH - ANTHRACITE GREY

NOTES:

- 30152P 75mm X 17mm (JET BLACK) PVC SKirting TO MANUFACTURERS SPECIFICATIONS & DETAILS.
- KERI MARKETING OR SIMILAR APPROVED STAINLESS STEEL TRANSITION RAMP COVER TO BE PROVIDED TO ALL MOVEMENT JOINTS BETWEEN PORCELAIN TILES & CONCRETE TO MANUFACTURERS SPECIFICATIONS & DETAILS.
- KERI MARKETING OR SIMILAR APPROVED STAINLESS STEEL MOVEMENT JOINT (SILURO-8mm) ON ALL THE CONSTRUCTION JOINTS & SOCKET JOINTS TO MANUFACTURERS SPECIFICATIONS & DETAILS.
- 400mm HIGH TILE SPLASHBACK ABOVE ALL WASH HAND BASINS OR TO BOTTOM OF MIRROR

SCALE : 1 : 100

TILING LAYOUT

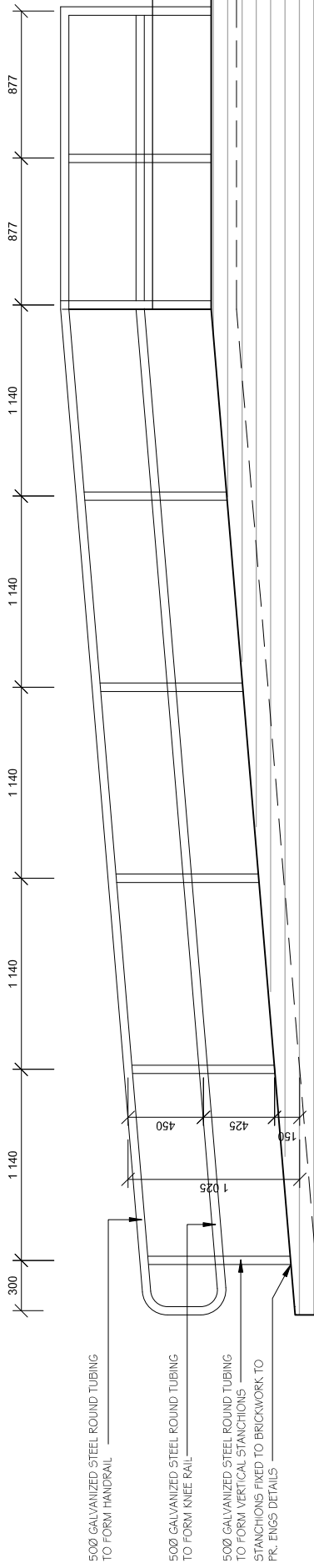

500 GALVANIZED STEEL ROUND TUBING
TO FORM HANDRAIL

500 GALVANIZED STEEL ROUND TUBING
TO FORM KNEE RAIL

500 GALVANIZED STEEL ROUND TUBING
TO FORM VERTICAL STANCHIONS
STANCHIONS FIXED TO BRICKWORK TO
PER ENGS DETAILS

BALUSTRADE DETAIL

SCALE : 1 : 25

CLIENT'S SIGNATURE

VHB ASSOCIATES

ARCHITECTURE & PROJECT MANAGEMENT

HEAD OFFICE: KWA-ZULU NATAL
SEAVIEW CENTRE
SUITE 1, BISSET HOUSE
48 BISSET STREET
PORT SHEPSTONE, 4240
TEL : 039 032 0003
MOBILE : 082 554 3427

BRANCH: EASTERN CAPE
R61 MAIN ROAD
BIZANA, 4800
TEL: 039 251 0476
FAX: 086 577 7713

P. O. BOX 455, PORT SHEPSTONE, 4240
e-mail: vhb@vhbassociates.co.za

PROJECT:
ADDITIONS & ALTERATIONS TO EX. OFFICES -
MBIZANA TRAFFIC DEPARTMENT
FOR: WINNIE MADIKIZELA-MANDELA LOCAL
MUNICIPALITY
CADASTRAL DESCRIPTION:
ERF 3105 (A PORTION OF 110)
MBIZANA

DRAWING:
BALUSTRADE DETAIL

CHECKED	V. BRIDGLALL	DATE	FEBRUARY 2026
DRAWN	J. DUKI	SCALE	AS SHOWN
JOB No.	MLM 07	SHEET No.	CW 08
REV.			A

No. BY DATE REVISION

COPYRIGHT IS VESTED IN VHB ASSOCIATES IN TERMS OF THE
COPYRIGHT ACT. (ACT 98 OF 1978)

CIVIL & STRUCTURAL

MATERIALS TESTING AND COMPLETION

1. CONCRETE CUBE TESTS TO BE TAKEN AND REPORTED AT 7 & 28 DAYS. TEST RESULTS TO BE FORWARDED TO THE ENGINEER FOR APPROVAL. APPROVAL CAN ONLY BE GRANTED ON THE BASIS OF THE RESULTS OF THE TESTS. APPROVAL CAN ONLY BE GRANTED ON THE BASIS OF THE RESULTS OF THE TESTS. APPROVAL CAN ONLY BE GRANTED ON THE BASIS OF THE RESULTS OF THE TESTS.

2. SCAFFOLDING PROPS TO REMAIN IN PLACE UNTIL CONCRETE HAS GAINED SUFFICIENT STRENGTH TO SUPPORT ITSELF AND THE FORMWORK. APPROVAL CAN ONLY BE GRANTED ON THE BASIS OF THE RESULTS OF THE TESTS. APPROVAL CAN ONLY BE GRANTED ON THE BASIS OF THE RESULTS OF THE TESTS.

3. ALL CONCRETE WORK SHALL BE IN ACCORDANCE WITH SANS 10162-1 & 10162-2.

4. COMPACTION TEST RESULTS TO BE FORWARDED TO THE ENGINEER FOR APPROVAL. APPROVAL CAN ONLY BE GRANTED ON THE BASIS OF THE RESULTS OF THE TESTS. APPROVAL CAN ONLY BE GRANTED ON THE BASIS OF THE RESULTS OF THE TESTS.

5. ALL CONCRETE WORK SHALL BE IN ACCORDANCE WITH SANS 10162-1 & 10162-2.

6. ALL CONCRETE WORK SHALL BE IN ACCORDANCE WITH SANS 10162-1 & 10162-2.

7. ALL CONCRETE WORK SHALL BE IN ACCORDANCE WITH SANS 10162-1 & 10162-2.

8. ALL CONCRETE WORK SHALL BE IN ACCORDANCE WITH SANS 10162-1 & 10162-2.

9. ALL CONCRETE WORK SHALL BE IN ACCORDANCE WITH SANS 10162-1 & 10162-2.

10. ALL CONCRETE WORK SHALL BE IN ACCORDANCE WITH SANS 10162-1 & 10162-2.

CONCRETE NOTES

1. THE DRAWING PROVIDES INFORMATION RELATED TO THE CONSTRUCTION OF THE FOUNDATION. THE CONTRACTOR SHALL BE RESPONSIBLE FOR THE PROVISION OF ALL MATERIALS AND LABOUR REQUIRED FOR THE CONSTRUCTION OF THE FOUNDATION. THE CONTRACTOR SHALL BE RESPONSIBLE FOR THE PROVISION OF ALL MATERIALS AND LABOUR REQUIRED FOR THE CONSTRUCTION OF THE FOUNDATION.

2. ALL WORK SHALL BE IN ACCORDANCE WITH SANS 10162-1 & 10162-2.

3. ALL CONCRETE WORK SHALL BE IN ACCORDANCE WITH SANS 10162-1 & 10162-2.

4. ALL CONCRETE WORK SHALL BE IN ACCORDANCE WITH SANS 10162-1 & 10162-2.

5. ALL CONCRETE WORK SHALL BE IN ACCORDANCE WITH SANS 10162-1 & 10162-2.

6. ALL CONCRETE WORK SHALL BE IN ACCORDANCE WITH SANS 10162-1 & 10162-2.

7. ALL CONCRETE WORK SHALL BE IN ACCORDANCE WITH SANS 10162-1 & 10162-2.

8. ALL CONCRETE WORK SHALL BE IN ACCORDANCE WITH SANS 10162-1 & 10162-2.

9. ALL CONCRETE WORK SHALL BE IN ACCORDANCE WITH SANS 10162-1 & 10162-2.

10. ALL CONCRETE WORK SHALL BE IN ACCORDANCE WITH SANS 10162-1 & 10162-2.

FOUNDATION NOTES

1. FOUNDATION SHALL BE IN ACCORDANCE WITH SANS 10162-1 & 10162-2.

2. FOUNDATION SHALL BE IN ACCORDANCE WITH SANS 10162-1 & 10162-2.

3. FOUNDATION SHALL BE IN ACCORDANCE WITH SANS 10162-1 & 10162-2.

4. FOUNDATION SHALL BE IN ACCORDANCE WITH SANS 10162-1 & 10162-2.

5. FOUNDATION SHALL BE IN ACCORDANCE WITH SANS 10162-1 & 10162-2.

6. FOUNDATION SHALL BE IN ACCORDANCE WITH SANS 10162-1 & 10162-2.

7. FOUNDATION SHALL BE IN ACCORDANCE WITH SANS 10162-1 & 10162-2.

8. FOUNDATION SHALL BE IN ACCORDANCE WITH SANS 10162-1 & 10162-2.

9. FOUNDATION SHALL BE IN ACCORDANCE WITH SANS 10162-1 & 10162-2.

10. FOUNDATION SHALL BE IN ACCORDANCE WITH SANS 10162-1 & 10162-2.

GENERAL NOTES

1. ALL WORK SHALL BE IN ACCORDANCE WITH SANS 10162-1 & 10162-2.

2. ALL WORK SHALL BE IN ACCORDANCE WITH SANS 10162-1 & 10162-2.

3. ALL WORK SHALL BE IN ACCORDANCE WITH SANS 10162-1 & 10162-2.

4. ALL WORK SHALL BE IN ACCORDANCE WITH SANS 10162-1 & 10162-2.

5. ALL WORK SHALL BE IN ACCORDANCE WITH SANS 10162-1 & 10162-2.

6. ALL WORK SHALL BE IN ACCORDANCE WITH SANS 10162-1 & 10162-2.

7. ALL WORK SHALL BE IN ACCORDANCE WITH SANS 10162-1 & 10162-2.

8. ALL WORK SHALL BE IN ACCORDANCE WITH SANS 10162-1 & 10162-2.

9. ALL WORK SHALL BE IN ACCORDANCE WITH SANS 10162-1 & 10162-2.

10. ALL WORK SHALL BE IN ACCORDANCE WITH SANS 10162-1 & 10162-2.

NO.	DATE	BY	DESCRIPTION
1	15/01/2018	...	ISSUED FOR TENDER
2
3
4
5
6
7
8
9
10

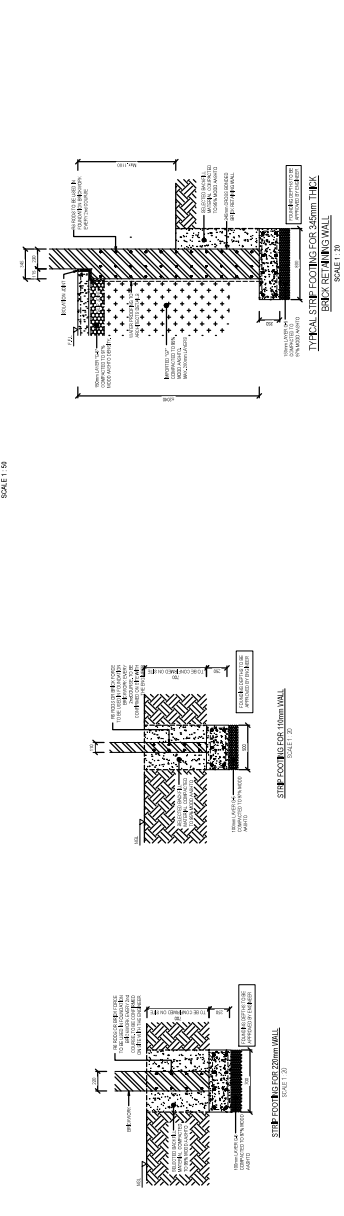
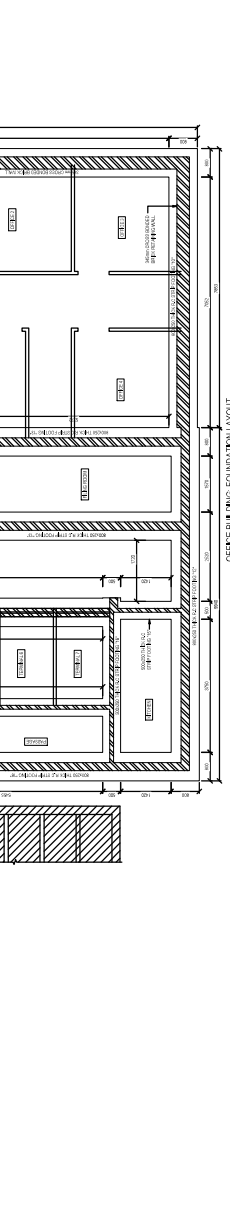
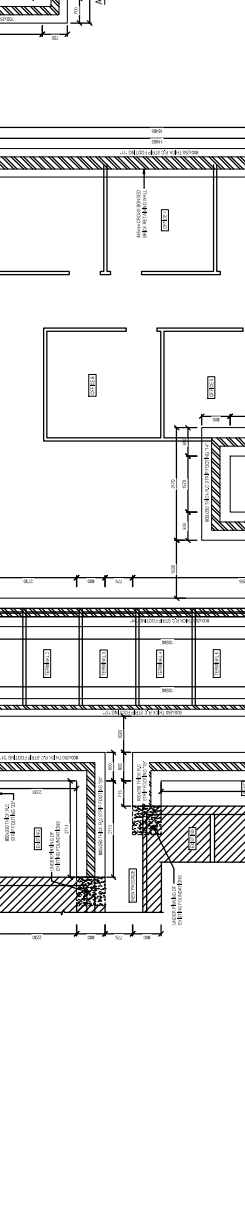
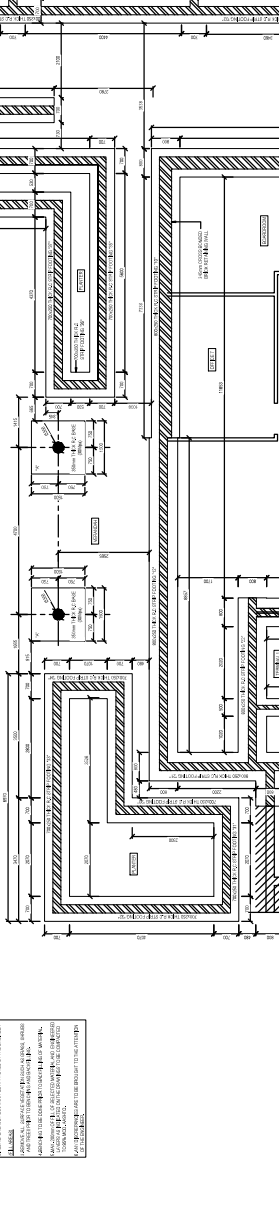
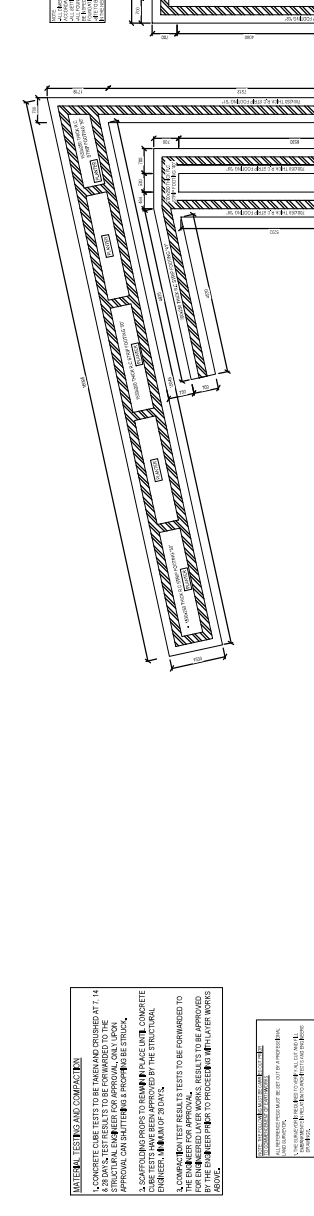
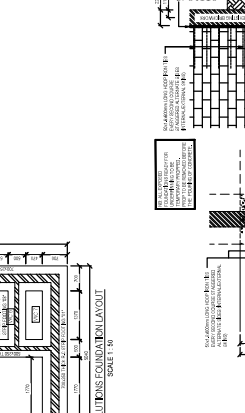
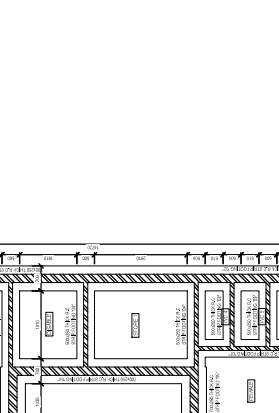
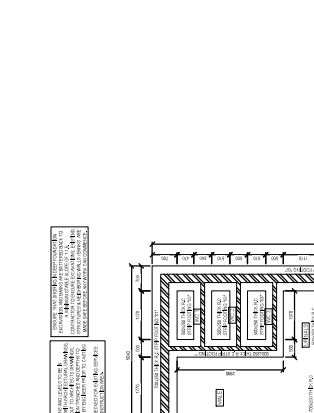
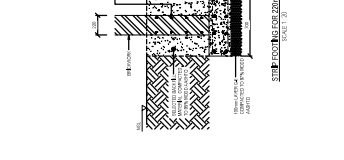
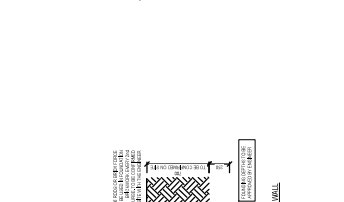
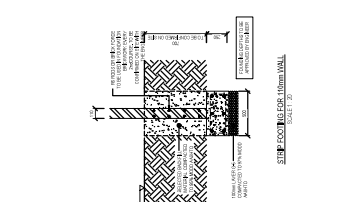
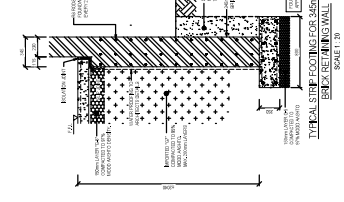
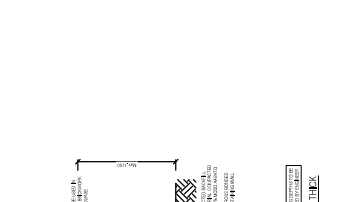
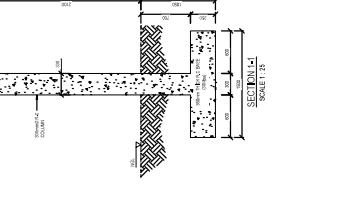
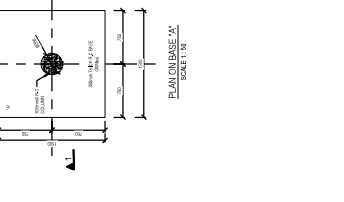

ISSUED FOR TENDER

CONSULTANT

SCALE: AS SHOWN

CLIENT

SCALE: AS SHOWN

PROJECT

SCALE: AS SHOWN

FOUNDATION LAYOUT, SECTIONS AND DETAILS

SCALE: AS SHOWN

FOUNDATION LAYOUT, SECTIONS AND DETAILS

SCALE: AS SHOWN

FOUNDATION LAYOUT, SECTIONS AND DETAILS

SCALE: AS SHOWN

FOUNDATION LAYOUT, SECTIONS AND DETAILS

SCALE: AS SHOWN

FOUNDATION LAYOUT, SECTIONS AND DETAILS

SCALE: AS SHOWN

LOAD BEARING BRICKWORK / BLOCKWORK:

- ALL LOAD BEARING BRICKWORK TO BE FROM MINIMUM 10MPa BRICKS. ALL LOAD BEARING BRICKWORK TO BE FROM MINIMUM 7.5MPa BLOCKS.
- SAMPLES OF BRICKS TO BE TAKEN FROM SITE FOR STRENGTH TESTING BY APPROVED LABORATORY.
- SUP JOINTS TO BE PROVIDED AT TOP OF ALL NEW LOAD BEARING WALLS.
- BLOCKS TO BE FILL WITH CONCRETE FROM FOUNDATION TO UNDER SIDE OF FIRST FLOOR SLAB.
- BRICKS TO BE AD IN STRETCHER BOND WITH CLASS 2 MOTOR (MIN. STRENGTH 10MPa).
- BRICK FORCE
- EVERY COURSE IN ALL FOUNDATION BRICK / BLOCK WORK.
- IN-TWO COURSES IMMEDIATELY ABOVE FLOOR SLAB.
- IN-TWO COURSES IMMEDIATELY BELOW WINDOWS.
- IN-EVERY COURSE ABOVE INTELS EXTENDING 600mm BEYOND OPENING.
- IN-EVERY FOURTH COURSE AND A MAXIMUM OF 1700mm CENTERS IN SUPER STRUCTURE.

TIMBER ROOF NOTES:

- ROOF TRUSSES TO BE DESIGNED BY APPROVED ENGINEER ON BEHALF OF THE TRUSS FABRICATOR.
- WORKSHOP DRAWINGS & CALCULATIONS ARE REQUIRED FOR APPROVAL.
- ALL TIMBER TO BE AT LEAST S4 SFT WOOD GRADE 5 ACCORDING TO SABS 598.
- ALL TIMBER TO BE PRE-TREATED FOR INSECT PROTECTION.
- DESIGN & ERECTION CERTIFICATE TO BE SUPPLIED BY THE CONTRACTOR ON COMPLETION.
- TR1 & TR2 CERTIFICATE ROOF LOADING REQUIRED FROM ROOF SUPPLIER.
- ROOF SHAPE COVER STORM WATER GOODS. TRUSSES AND WATER PROOFING TO ARCHITECTS DETAILS.

GENERAL NOTES:

- THIS DRAWING PROVIDES INFORMATION RELATED TO THE FORM OF WORKS WHEN COMPLETED TOGETHER WITH GUIDANCE WHERE FUNDAMENTAL TO THE DESIGN. FOR THE SEQUENCE OF CONSTRUCTION, THIS DRAWING DOES NOT PURPORT TO INCLUDE ANY NECESSARY PRECAUTIONS ITEMS OR COMPONENTS REQUIRED TO BE TAKEN AND ITEMS OR COMPONENTS SUPPLIED BY THE CONTRACTOR.
- ALL WORK SHALL BE IN ACCORDANCE WITH SABS 1020 G CONCRETE & SABS 1040 IN CONJUNCTION WITH NHRC STANDARDS.
- NO CONSTRUCTION TO COMMENCE UNTIL THE MUNICIPALITY / RELEVANT AUTHORITY / PROPERTY OWNER / MAIN LEASE HAS GRANTED APPROVAL OF THE DRAWINGS.
- READ THE DRAWINGS IN CONJUNCTION WITH THE ARCHITECTURAL DRAWINGS AND ALL RELEVANT SPECIFICATIONS AND SERVICE DRAWINGS AND BE AWARE OF THE REQUIREMENTS OR ON POSSIBLE ANY DISCREPANCIES BETWEEN THE SPECIFICATIONS AND THE DRAWING MUST BE REPORTED TO THE ENGINEER.
- THESE DRAWINGS MAY NOT BE COPIED OR REUSED WITHOUT THE WRITTEN CONSENT OF THE ENGINEER.
- ALL DIMENSION, LEVELS AND EXISTING SERVICES TO BE PROVEN AND CLEARLY MARKED BEFORE AND WORK CAN BEGIN.

NATIONAL BUILDING REGULATIONS:

ALL WORK TO BE CARRIED OUT IN ACCORDANCE WITH THE NATIONAL BUILDING REGULATIONS, ENVIRONMENTAL AND OCCUPATIONAL HEALTH AND SAFETY ACT, AND THE CONSTRUCTION REGULATIONS.

THE MAIN CONTRACTOR IS TO ENSURE THAT A COMPETENT PERSON IS IN CHARGE OF THE WORK AND THAT ALL REQUIREMENTS OF THE OCCUPATIONAL HEALTH AND SAFETY ACT, ALL TO COMPLY WITH THE LATEST REVISION.

ISSUED FOR TENDER

CONSULTANT

KDA
Kwana Development Authority
Consulting Engineers
Professional Address: P.O. Box 10000, Windhoek, Namibia
Registration No. 10000/2011
Copyright reserved. No part of this publication may be reproduced without prior written permission of the copyright owner.

215, 5th FLOOR, SPRINGFIELD BUREAU, 4001 10th AVENUE, WINDHOEK, NAMIBIA

PROJECT: MBIZANA TRAFFIC DEPARTMENT OFFICES

DRAWING DESCRIPTION: PART BLOCK AND LINTEL & PART EAVES BEAMS LAYOUTS, SECTIONS AND DETAILS

DRAWING NUMBER: 28018

DRAWING NUMBER: 303

DATE: 20-02-2026

REVISION: A

GENERAL NOTES:

- THIS DRAWING PROVIDES INFORMATION RELATED TO THE FORM OF WORKS WHEN COMPLETED TOGETHER WITH GUIDANCE WHERE FUNDAMENTAL TO THE DESIGN. FOR THE SEQUENCE OF CONSTRUCTION, THIS DRAWING DOES NOT PURPORT TO INCLUDE ANY NECESSARY PRECAUTIONS ITEMS OR COMPONENTS REQUIRED TO BE TAKEN AND ITEMS OR COMPONENTS SUPPLIED BY THE CONTRACTOR.
- ALL WORK SHALL BE IN ACCORDANCE WITH SABS 1020 G CONCRETE & SABS 1040 IN CONJUNCTION WITH NHRC STANDARDS.
- NO CONSTRUCTION TO COMMENCE UNTIL THE MUNICIPALITY / RELEVANT AUTHORITY / PROPERTY OWNER / MAIN LEASE HAS GRANTED APPROVAL OF THE DRAWINGS.
- READ THE DRAWINGS IN CONJUNCTION WITH THE ARCHITECTURAL DRAWINGS AND ALL RELEVANT SPECIFICATIONS AND SERVICE DRAWINGS AND BE AWARE OF THE REQUIREMENTS OR ON POSSIBLE ANY DISCREPANCIES BETWEEN THE SPECIFICATIONS AND THE DRAWING MUST BE REPORTED TO THE ENGINEER.
- THESE DRAWINGS MAY NOT BE COPIED OR REUSED WITHOUT THE WRITTEN CONSENT OF THE ENGINEER.
- ALL DIMENSION, LEVELS AND EXISTING SERVICES TO BE PROVEN AND CLEARLY MARKED BEFORE AND WORK CAN BEGIN.

NATIONAL BUILDING REGULATIONS:

ALL WORK TO BE CARRIED OUT IN ACCORDANCE WITH THE NATIONAL BUILDING REGULATIONS, ENVIRONMENTAL AND OCCUPATIONAL HEALTH AND SAFETY ACT, AND THE CONSTRUCTION REGULATIONS.

THE MAIN CONTRACTOR IS TO ENSURE THAT A COMPETENT PERSON IS IN CHARGE OF THE WORK AND THAT ALL REQUIREMENTS OF THE OCCUPATIONAL HEALTH AND SAFETY ACT, ALL TO COMPLY WITH THE LATEST REVISION.

ISSUED FOR TENDER

CONSULTANT

KDA
Kwana Development Authority
Consulting Engineers
Professional Address: P.O. Box 10000, Windhoek, Namibia
Registration No. 10000/2011
Copyright reserved. No part of this publication may be reproduced without prior written permission of the copyright owner.

215, 5th FLOOR, SPRINGFIELD BUREAU, 4001 10th AVENUE, WINDHOEK, NAMIBIA

PROJECT: MBIZANA TRAFFIC DEPARTMENT OFFICES

DRAWING DESCRIPTION: PART BLOCK AND LINTEL & PART EAVES BEAMS LAYOUTS, SECTIONS AND DETAILS

DRAWING NUMBER: 28018

DRAWING NUMBER: 303

DATE: 20-02-2026

REVISION: A

GENERAL NOTES:

- THIS DRAWING PROVIDES INFORMATION RELATED TO THE FORM OF WORKS WHEN COMPLETED TOGETHER WITH GUIDANCE WHERE FUNDAMENTAL TO THE DESIGN. FOR THE SEQUENCE OF CONSTRUCTION, THIS DRAWING DOES NOT PURPORT TO INCLUDE ANY NECESSARY PRECAUTIONS ITEMS OR COMPONENTS REQUIRED TO BE TAKEN AND ITEMS OR COMPONENTS SUPPLIED BY THE CONTRACTOR.
- ALL WORK SHALL BE IN ACCORDANCE WITH SABS 1020 G CONCRETE & SABS 1040 IN CONJUNCTION WITH NHRC STANDARDS.
- NO CONSTRUCTION TO COMMENCE UNTIL THE MUNICIPALITY / RELEVANT AUTHORITY / PROPERTY OWNER / MAIN LEASE HAS GRANTED APPROVAL OF THE DRAWINGS.
- READ THE DRAWINGS IN CONJUNCTION WITH THE ARCHITECTURAL DRAWINGS AND ALL RELEVANT SPECIFICATIONS AND SERVICE DRAWINGS AND BE AWARE OF THE REQUIREMENTS OR ON POSSIBLE ANY DISCREPANCIES BETWEEN THE SPECIFICATIONS AND THE DRAWING MUST BE REPORTED TO THE ENGINEER.
- THESE DRAWINGS MAY NOT BE COPIED OR REUSED WITHOUT THE WRITTEN CONSENT OF THE ENGINEER.
- ALL DIMENSION, LEVELS AND EXISTING SERVICES TO BE PROVEN AND CLEARLY MARKED BEFORE AND WORK CAN BEGIN.

NATIONAL BUILDING REGULATIONS:

ALL WORK TO BE CARRIED OUT IN ACCORDANCE WITH THE NATIONAL BUILDING REGULATIONS, ENVIRONMENTAL AND OCCUPATIONAL HEALTH AND SAFETY ACT, AND THE CONSTRUCTION REGULATIONS.

THE MAIN CONTRACTOR IS TO ENSURE THAT A COMPETENT PERSON IS IN CHARGE OF THE WORK AND THAT ALL REQUIREMENTS OF THE OCCUPATIONAL HEALTH AND SAFETY ACT, ALL TO COMPLY WITH THE LATEST REVISION.

ISSUED FOR TENDER

CONSULTANT

KDA
Kwana Development Authority
Consulting Engineers
Professional Address: P.O. Box 10000, Windhoek, Namibia
Registration No. 10000/2011
Copyright reserved. No part of this publication may be reproduced without prior written permission of the copyright owner.

215, 5th FLOOR, SPRINGFIELD BUREAU, 4001 10th AVENUE, WINDHOEK, NAMIBIA

PROJECT: MBIZANA TRAFFIC DEPARTMENT OFFICES

DRAWING DESCRIPTION: PART BLOCK AND LINTEL & PART EAVES BEAMS LAYOUTS, SECTIONS AND DETAILS

DRAWING NUMBER: 28018

DRAWING NUMBER: 303

DATE: 20-02-2026

REVISION: A

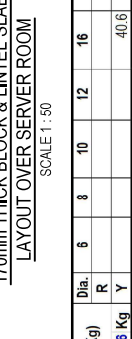
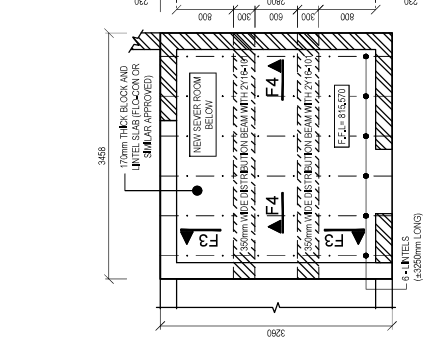

Total Mass (Kg)	Dia.	R	Y	No. per Unit	Bar Type & Mark	Unit Dia.	Total Number	Shape Code	Bending Dimensions to SABS 282				TOTAL	
									A	B	C	D		E/R
40.6 Kg				2	Y 16	100	2	6150	20	6150	20	3350	20	40.6
				4	Y 16	101	4	3350	20	3350	20	3350	20	40.6

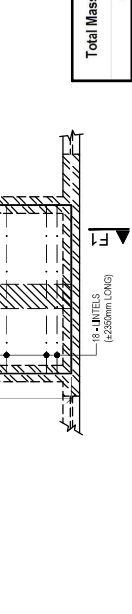
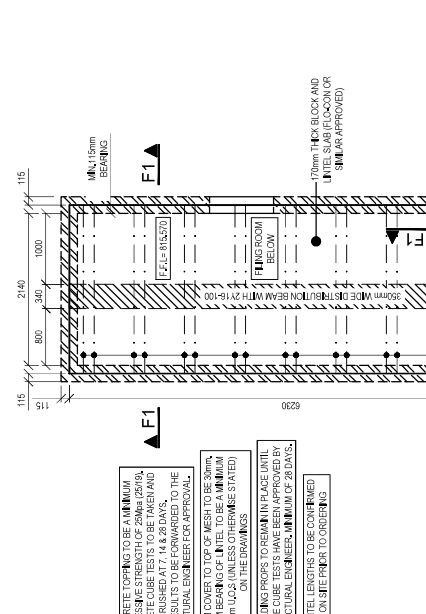
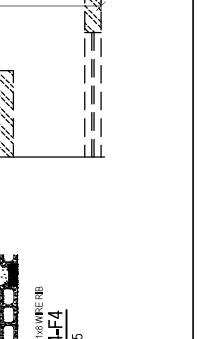
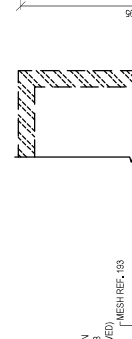

Total Mass (Kg)	Dia.	R	Y	No. per Unit	Bar Type & Mark	Unit Dia.	Total Number	Shape Code	Bending Dimensions to SABS 282				TOTAL	
									A	B	C	D		E/R
40.6 Kg				2	Y 16	100	2	6150	20	6150	20	3350	20	40.6
				4	Y 16	101	4	3350	20	3350	20	3350	20	40.6

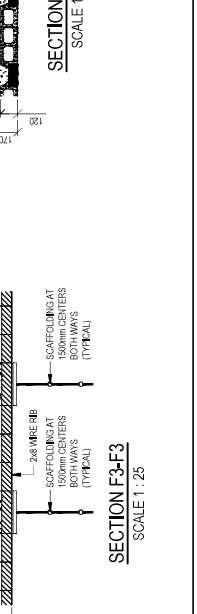
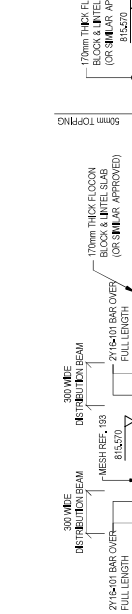
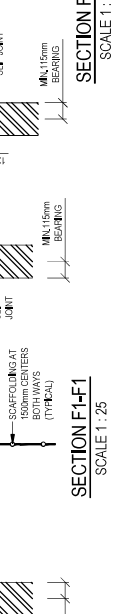
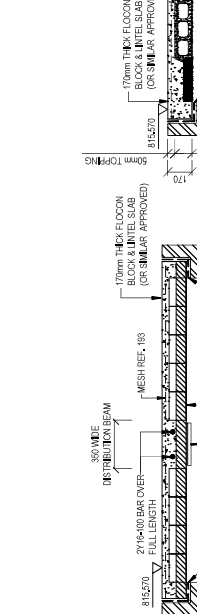

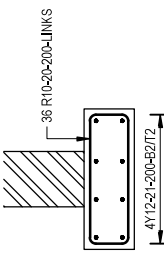

SECTION THROUGH STRIP FOOTING "10"

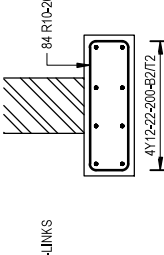

SECTION THROUGH STRIP FOOTING "11"

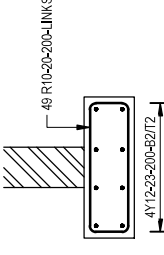

SECTION THROUGH STRIP FOOTING "12"

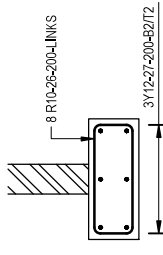

SECTION THROUGH STRIP FOOTING "15"

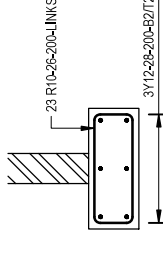

SECTION THROUGH STRIP FOOTING "16"

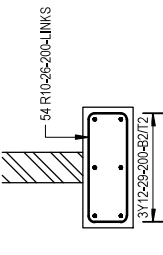

SECTION THROUGH STRIP FOOTING "17"

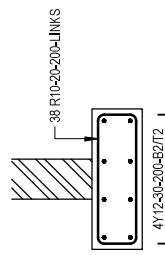

SECTION THROUGH STRIP FOOTING "18"

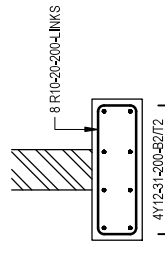

SECTION THROUGH STRIP FOOTING "19"

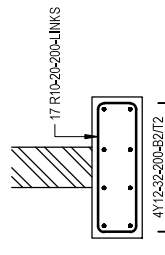

SECTION THROUGH STRIP FOOTING "20"

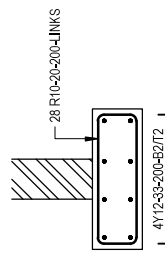

SECTION THROUGH STRIP FOOTING "21"

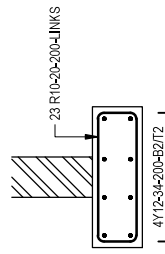

SECTION THROUGH STRIP FOOTING "22"

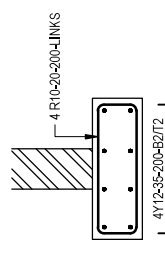

SECTION THROUGH STRIP FOOTING "23"

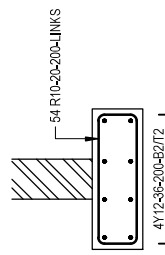

SECTION THROUGH STRIP FOOTING "24"

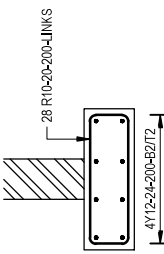

SECTION THROUGH STRIP FOOTING "13"

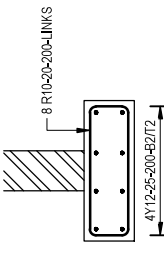

SECTION THROUGH STRIP FOOTING "14"

Unit, Size & No. Required	Bar Dia.	Bar Type & Mark.	Bar No.	Total Number	Lengths mm	Shape Code	Bending Dimensions to SANS 202	TOTAL
							A B C D	
1 498.4 Kg	R		853.3					642.8
	Y		853.3					853.8
2 39 R 10	10	20	72	1800	60	60	70 70	
2 8 Y 12	12	21	16	7850	20	20	7850	
1 84 R 10	10	20	84	1600	60	60	70 70	
1 24 Y 12	12	22	24	5900	20	20	5900	
2 49 R 10	10	20	98	1900	60	60	70 70	
2 16 Y 12	12	23	32	5250	20	20	5250	
2 28 R 10	10	20	56	1900	60	60	70 70	
2 8 Y 12	12	24	16	6250	20	20	6250	
1 8 R 10	10	20	8	1900	60	60	70 70	
1 8 Y 12	12	25	8	3950	20	20	3950	
1 8 R 10	10	20	8	1900	60	60	70 420	
1 6 Y 12	12	27	6	2100	20	20	2100	
1 24 R 10	10	20	24	1500	60	60	70 420	
1 6 Y 12	12	28	6	4150	20	20	4150	
1 54 R 10	10	20	54	1900	60	60	70 420	
1 12 Y 12	12	29	12	5900	20	20	5900	
1 38 R 10	10	20	38	1900	60	60	70 70	
1 16 Y 12	12	30	16	4400	20	20	4400	
1 8 R 10	10	20	8	1900	60	60	70 70	
1 8 Y 12	12	31	8	1400	20	20	1400	
1 17 R 10	10	20	17	1600	60	60	70 70	
1 8 Y 12	12	32	8	3400	20	20	3400	
1 28 R 10	10	20	28	1900	60	60	70 70	
1 8 Y 12	12	33	8	6950	20	20	6950	
1 23 R 10	10	20	23	1900	60	60	70 70	
1 8 Y 12	12	34	8	4150	20	20	4150	
1 4 R 10	10	20	4	1900	60	60	70 70	
1 8 Y 12	12	35	8	1100	20	20	1100	
1 54 R 10	10	20	54	1900	60	60	70 70	
1 16 Y 12	12	36	16	5900	20	20	5900	

TYPICAL SPLICE DETAILS:

Y10- MIN. LAP = 500

Y12- MIN. LAP = 600

Y16- MIN. LAP = 800

Y20- MIN. LAP = 1000

Y25- MIN. LAP = 1250

Y32- MIN. LAP = 1600

ISSUED FOR TENDER

REINFORCING NOTES

- FOR RC PAD FOUNDATION LAYOUT REFER TO DRAWINGS.
- THIS DRAWING IS TO BE READ IN CONJUNCTION WITH THE REINFORCEMENT SCHEDULE.
- ALL CONCRETE TO: FOUNDATIONS TO BE:
- GRADE 30/19
50mm BLINDING LAYER
- COVER TO REINFORCEMENT = 30mm

B1 - BOTTOM ONE
B2 - BOTTOM TWO
T1 - TOP ONE
T2 - TOP TWO
EF - EACH FACE
IF - INSIDE FACE
OF - OUTSIDE FACE
SF - SOIL FACE
BF - BACK FACE
FF - FRONT FACE
ABR - ALTERNATE BAR REVERSE

6. ALL LAP LENGTHS FOR BARS TO BE MINIMUM 50x ϕ .

GB - GROUND BEAM
FFB - FIRST FLOOR BEAM
SFB - SECOND FLOOR BEAM
TFB - THIRD FLOOR BEAM
EB - EAVES BEAM

20-02-2026	ISSUED FOR TENDER	V.K. A
DATE	DESCRIPTION	BY / REV
DESIGN	V.K	
DRAWN	A.H.	
CHECKED	D.N.	
DATE ISSUED	20-02-2026	SHEET SIZE A3
CONSULTANT		SCALE (AS SHOWN)
<p>KDA Consulting Engineers Pty (Ltd) 215 ALPINE ROAD SPRINGSFIELD DURBAN, 4091 031 207 2926 082 468 6381 Vernah@kda.co.za dhanash@kda.co.za</p> <p>54 WOODPECKER ROAD, MOUNTVIEW, PRETORIA 013 387 1730 084 688 4681 dhanash@kda.co.za</p> <p>COVER THIS DRAWING IN THE EVENT OF ANY CONSULTING ENGINEERS AND CAN NOT BE CORRECT, DUPLICATED OR REPRODUCED WITHOUT THEIR CONSENT.</p>		
CLIENT: WINNIE MADIKIZELA MANDELA LOCAL MUNICIPALITY		
PROJECT: ERF 3105 (A PORTION OF 110 MBIZANA)		
DRAWING DESCRIPTION: OFFICE BUILDING: FOUNDATION REINFORCING DETAILS		
PROJECT NUMBER	DRAWING NUMBER	DATE
26018	402	20-02-2026
REVISION		A

REINFORCING NOTES

- FOR RC PAD FOUNDATION LAYOUT REFER TO DRAWINGS.
 - THIS DRAWING IS TO BE READ IN CONJUNCTION WITH THE REINFORCEMENT SCHEDULE.
 - ALL CONCRETE TO FOUNDATIONS TO BE:
 - GRADE 30/19
50mm BLINDING LAYER
 - COVER TO REINFORCEMENT = 30mm
- B1 - BOTTOM ONE
 B2 - BOTTOM TWO
 T1 - TOP ONE
 T2 - TOP TWO
 EF - EACH FACE
 IF - INSIDE FACE
 OF - OUTSIDE FACE
 SF - SOIL FACE
 BF - BACK FACE
 FF - FRONT FACE
 ABR - ALTERNATE BAR REVERSE
- ALL LAP LENGTHS FOR BARS TO BE MINIMUM 50xØ.
- GB - GROUND BEAM
 FF - FIRST FLOOR BEAM
 SF - SECOND FLOOR BEAM
 TF - THIRD FLOOR BEAM
 EB - EAVES BEAM

Total Mass (Kg)	Dia.	No. per Unit	Bar Type & Dia	Bar Mark	Total Number	Length mm	Shape Code	Bending Dimensions to SANS 282				TOTAL
								A	B	C	D	
1 188.8 Kg	R	Y				680.5						476.3
												680.5
700x250mm "F30"	13 R 10	40	13 R 10 40	13	1700	60	60	170	620			
700x250mm "F31"	18 R 10	40	18 R 10 40	18	1700	60	60	170	620			
700x250mm "F32"	21 R 10	40	21 R 10 40	21	1700	60	60	170	620			
700x250mm "F33"	36 R 10	40	36 R 10 40	36	1700	60	60	170	620			
700x250mm "F34"	6 R 10	40	6 R 10 40	6	1700	60	60	170	620			
700x250mm "F35"	36 R 10	40	36 R 10 40	36	1700	60	60	170	620			
700x250mm "F36"	2 R 10	40	2 R 10 40	2	1700	60	60	170	620			
700x250mm "F37"	30 R 10	40	30 R 10 40	30	1700	60	60	170	620			
700x250mm "F38"	27 R 10	40	27 R 10 40	27	1700	60	60	170	620			
700x250mm "F39"	9 R 10	40	9 R 10 40	9	1700	60	60	170	620			
700x250mm "F40"	34 R 10	40	34 R 10 40	34	1700	60	60	170	620			
700x250mm "F41"	23 R 10	40	23 R 10 40	23	1700	60	60	170	620			
1530x250mm "F50"	81 R 10	60	81 R 10 60	81	3360	60	60	170	1450			
700x250mm "F51"	39 R 10	62	39 R 10 62	39	1700	60	60	170	620			

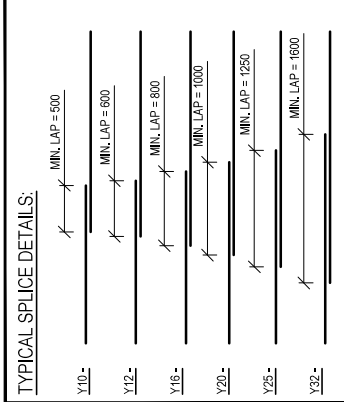
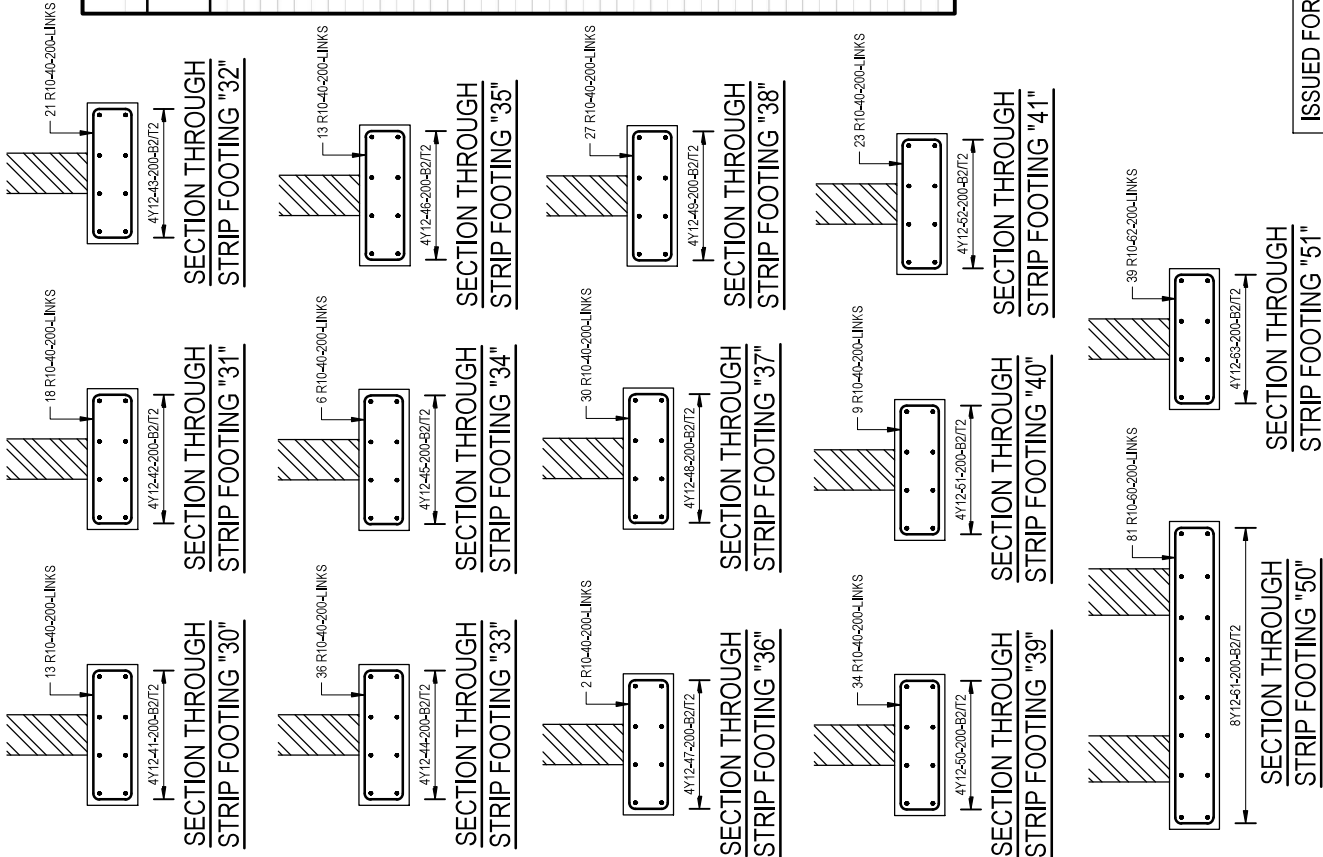

ISSUED FOR TENDER

DATE	ISSUED FOR TENDER	V.K.	A
20-02-2026			

DESIGN	V.K.	BY	REV
DRAWN	A.H.		
CHECKED	D.N.		

DATE ISSUED	20-02-2026	SHEET SIZE	A3
SCALE: AS SHOWN			

CONSULTANT

KDA Consulting Engineers Pty (Ltd)
 215 ALPINE ROAD
 SPRINGFIELD, DURBAN, 4091
 031 207 2951 | 031 488 6381 |
 Veehalk@kda.co.za

54 WOODPECKER ROAD,
 MOUNTAIN VIEW,
 PRETORIA, 0001
 011 387 1730 | 011 488 4691 |
 chane@kda.co.za

COPYRIGHT: THIS DRAWING IS THE PROPERTY OF KDA CONSULTING ENGINEERS AND CAN NOT BE COPIED, DUPLICATED OR REPRODUCED WITHOUT THEIR CONSENT.

CLIENT:
 WINNIE MADIKIZELA MANDELA LOCAL MUNICIPALITY

PROJECT:
 ERF 3105 (A PORTION OF 110 MBIZANA)

DRAWING DESCRIPTION:
 PLANTERS: FOUNDATION REINFORCING DETAILS

PROJECT NUMBER	DRAWING NUMBER	DATE	REVISION
26018	403	20-02-2026	A

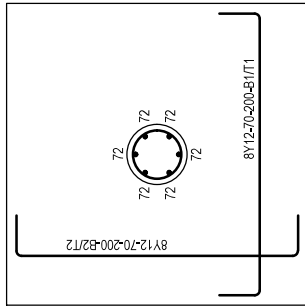

BASE "A" REINFORCING LAYOUT

No. OFF = 02

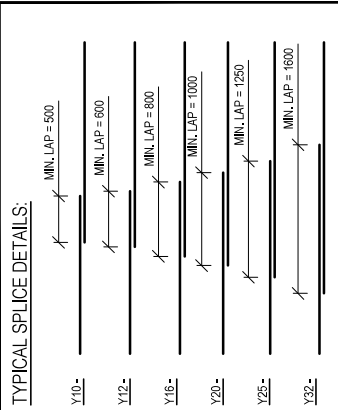

TYPICAL SPLICE DETAILS:

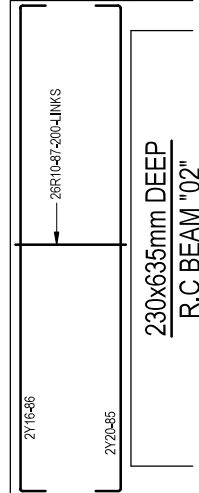
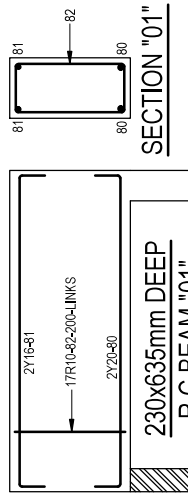
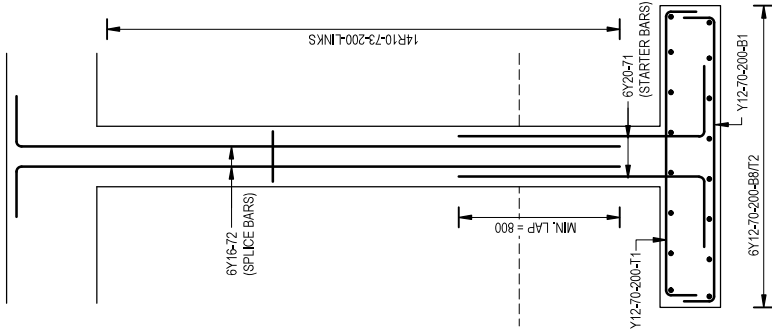

Total Mass (Kg)	6	8	10	12	16	20	25	32	40	TOTAL
226.7 Kg			16.4	102.3	60.6	47.3				16.4
Unit, Size & No. Required	No. per Unit	Bar Type & Mark	Total Number	Length mm	Shape Code	Bending Dimensions to SANS 282				
BASE "A" REINFORCING	2	32 Y 12	70	64	1800	38	200	1400	200	
	6	Y 20	71	12	1600	37	350	1250		
	6	Y 16	72	12	3200	37	200	3000		
	14	R 10	73	28	950	99	240			A = Ø

REINFORCING NOTES

- FOR RC PAD FOUNDATION LAYOUT REFER TO DRAWINGS.
- THIS DRAWING IS TO BE READ IN CONJUNCTION WITH THE REINFORCEMENT SCHEDULE.
- ALL CONCRETE TO: FOUNDATIONS TO BE:
 - GRADE 30/19
 - 50mm BLINDING LAYER
 - COVER TO REINFORCEMENT = 30mm
- B1 - BOTTOM ONE
 B2 - BOTTOM TWO
 T1 - TOP ONE
 T2 - TOP TWO
 EF - EACH FACE
 IF - INSIDE FACE
 OF - OUTSIDE FACE
 SF - SOIL FACE
 BF - BACK FACE
 FF - FRONT FACE
 ABR - ALTERNATE BAR REVERSE
- ALL LAP LENGTHS FOR BARS TO BE MINIMUM 50xØ.

ISSUED FOR TENDER

DATE	DESCRIPTION	BY	REV
20-02-2026	ISSUED FOR TENDER	V.K.	0
	DESIGN	V.K	
	DRAWN	A.H.	
	CHECKED	D.N.	
DATE ISSUED	20-02-2026	SHEET SIZE	A3
SCALE		AS SHOWN	

CONSULTANT

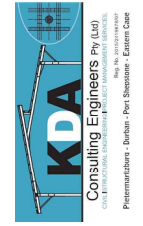

215 ALPINE ROAD
 SPRINGFIELD, DURBAN, 4091
 031 207 2926 | 082 468 6381 |
 Venshall@kda.org.za

54 WOODPECKER ROAD,
 MOUNTVIEW,
 PRETORIA, 0151
 011 387 1730 | 084 688 4691 |
 shanisha@kda.org.za

Total Mass (Kg)	6	8	10	12	16	20	25	32	40	TOTAL
181.1 Kg			59.6		39.6	61.9				59.6
Unit, Size & No. Required	No. per Unit	Bar Type & Mark	Total Number	Length mm	Shape Code	Bending Dimensions to SANS 282				
230x635mm DEEP R.C BEAM "01"	2	Y 20	80	4	3600	38	250	3100	250	
	2	Y 16	81	4	3600	38	250	3100	250	
	2	R 10	82	34	1610	60	170	575		
230x635mm DEEP R.C BEAM "02"	1	Y 20	85	2	5350	38	250	4850	250	
	1	Y 16	86	2	5350	38	250	4850	250	
	1	R 10	87	26	1610	60	170	575		

COPY RIGHT IN THIS DRAWING IS THE PROPERTY OF KDA CONSULTING ENGINEERS AND CAN NOT BE COPIED, DUPLICATED OR REPRODUCED WITHOUT THEIR CONSENT.

CLIENT:
 WINNIE MADIKIZELA MANDELA LOCAL MUNICIPALITY

PROJECT:
 ERF 3105 (A PORTION OF 110 MBIZANA)

DRAWING DESCRIPTION:
 BASE "A" & EAVES BEAMS REINFORCING DETAILS

PROJECT NUMBER: 26018
 DRAWING NUMBER: 404
 DATE: 20-02-2026
 REVISION: 0

