

**FLOOR LAYOUT**

1:25

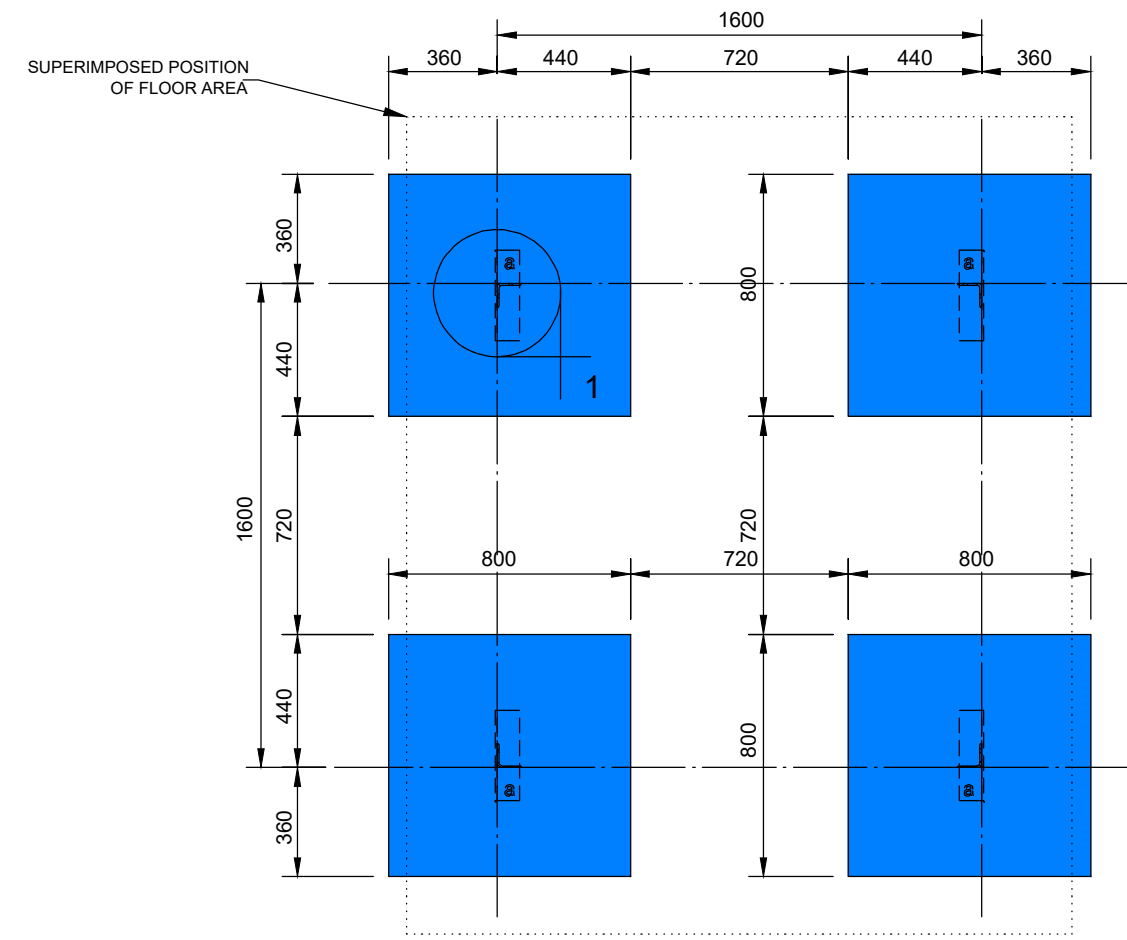

**FOUNDATION LAYOUT FOR SINGLE ELEVATED TANK**

1:25

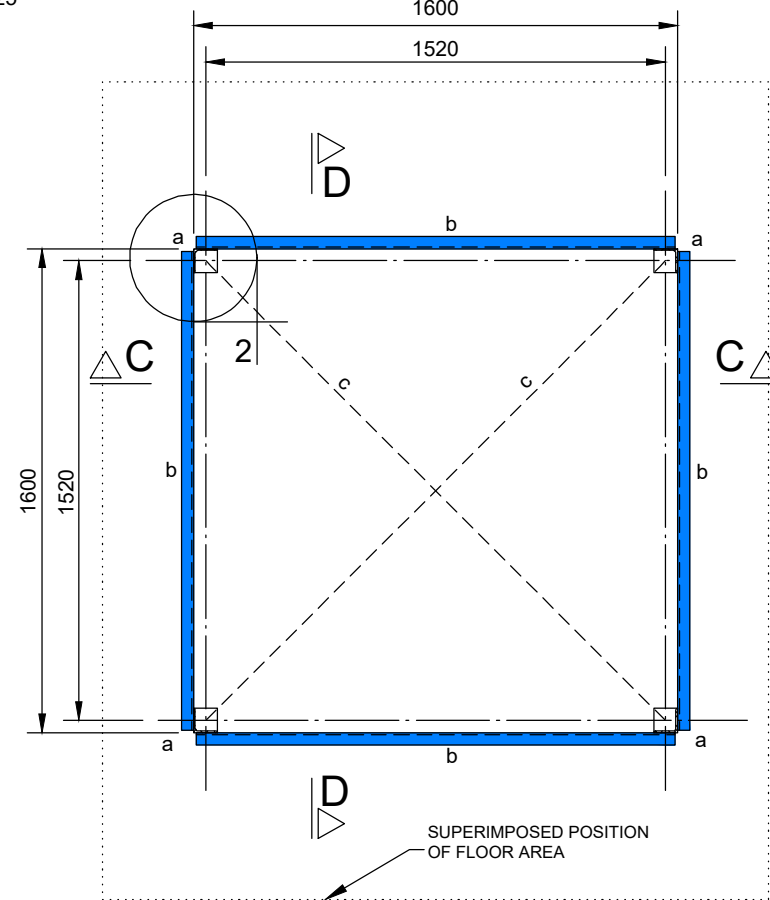

**LAYOUT PLAN E-E**

1:25

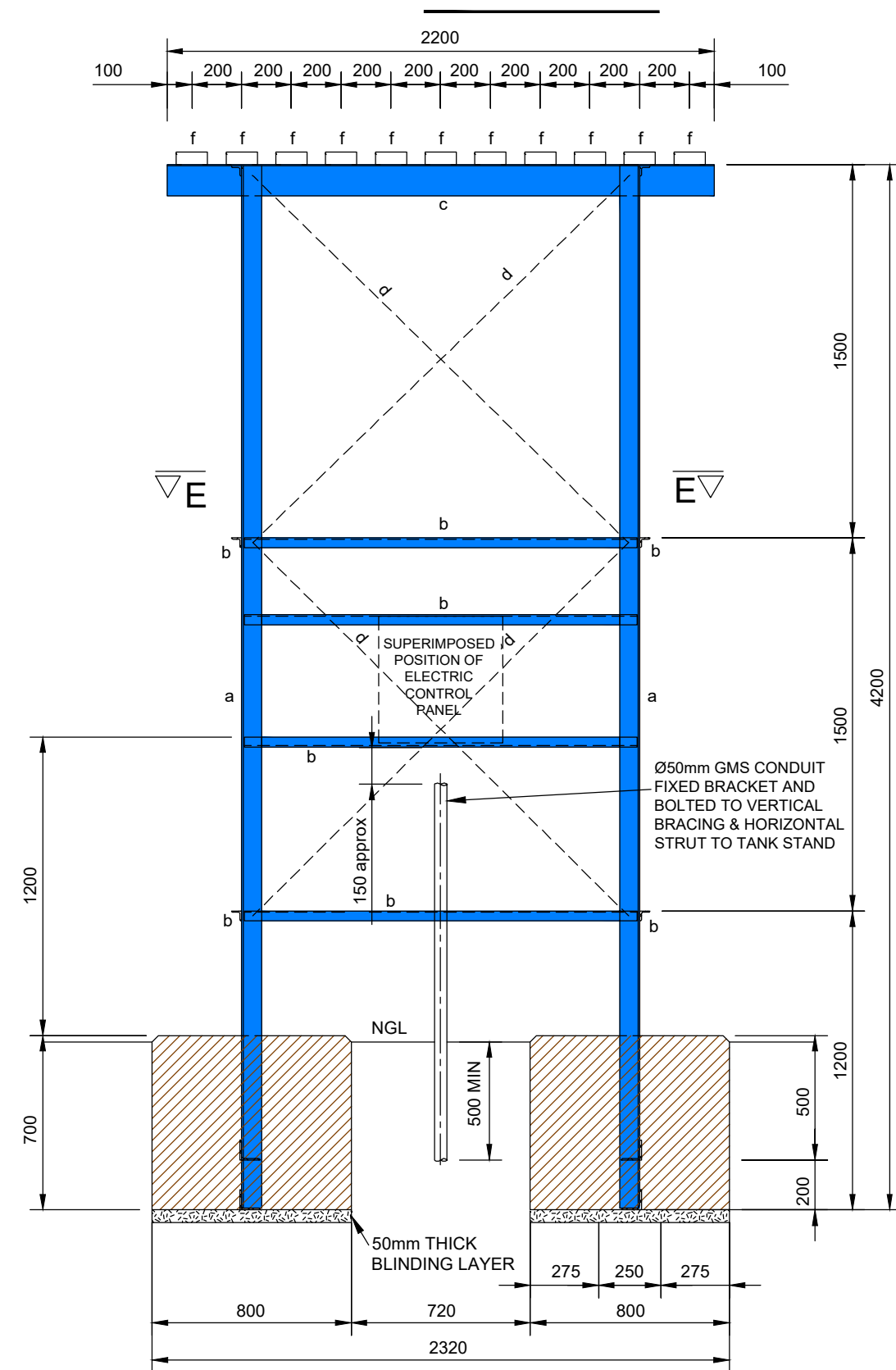

**SECTION C-C**

1:25

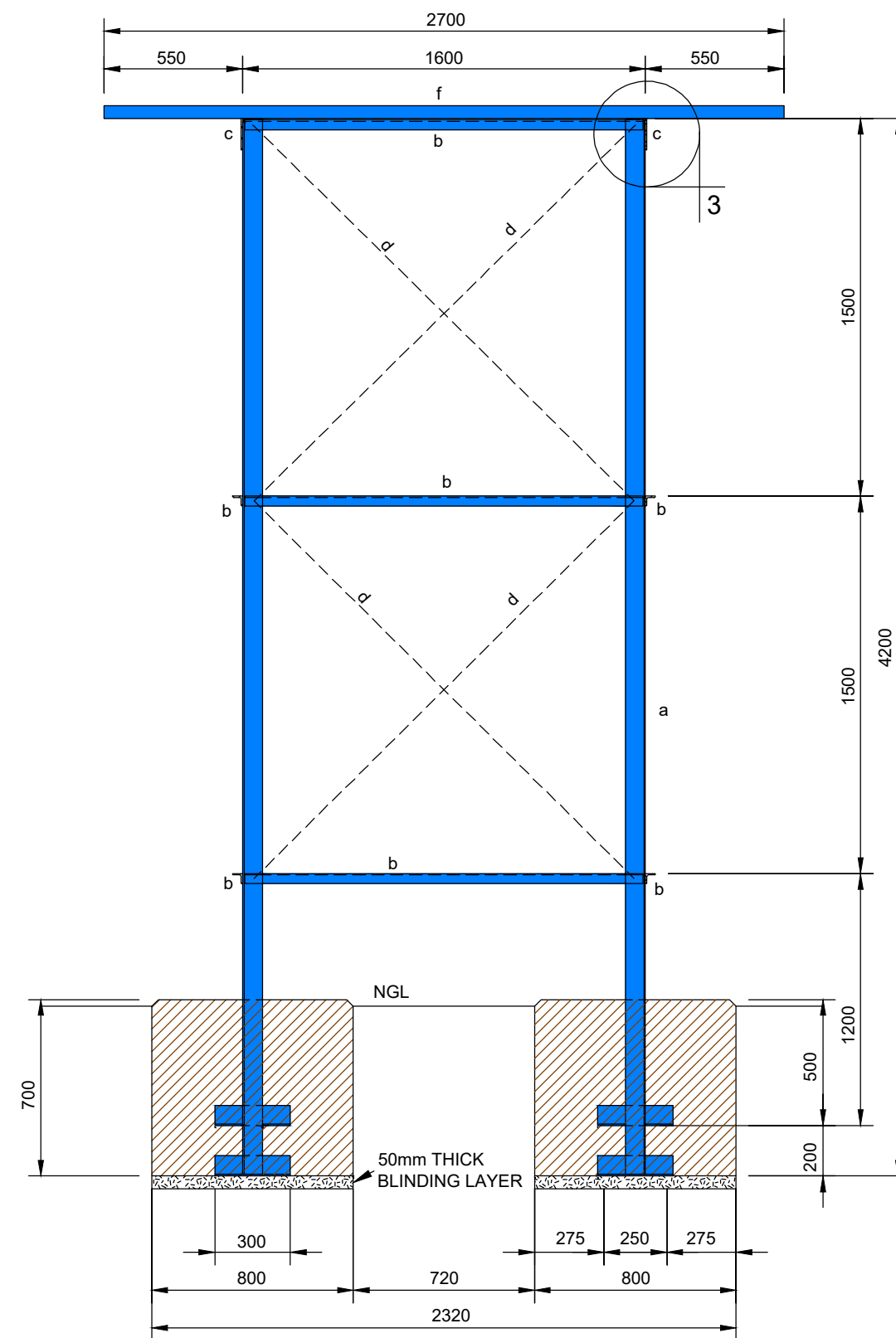

**SECTION D-D**

1:25

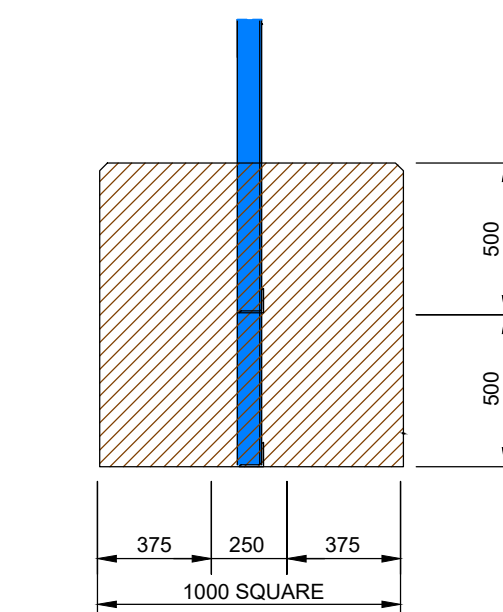

**FOOTING DETAIL FOR SANDY CONDITIONS**

1:25

NOTES:

LEGEND:

08.11.22	1	ISSUED FOR TENDER	BS
DATE	NO.	REVISION / VARIATIONS	KUT

CLIENT:

**LIMPOPO**  
PROVINCIAL GOVERNMENT  
REPUBLIC OF SOUTH AFRICA  
  
DEPARTMENT OF  
**EDUCATION**  
CNR 113 BILLARD & 24 EXCELSIOR STREET  
POLOKWANE  
0700

IMPLEMENTING AGENT:

**THE MVULA TRUST**  
A leading developmental NGO  
  
ROP 6 RHODES DRIFT OFFICE PARK  
RHODES DRIFT STREET  
BENDOR , POLOKWANE  
0689  
Tel No.: (015) 291 2405

PROJECT ENGINEERS:

**KUTLO**  
CONSULTING ENGINEERS

2 HEUWELKRUIN  
THABAZIMBI EXT 1  
THABAZIMBI  
0380  
Tel No.: 079 978 4501  
Fax No.: 086 674 3237  
E-mail: admin@kutloconsulting.co.za

PROJECT:

LIMPOPO DEPARTMENT OF EDUCATION

WATER , SANITATION AND FENCING  
PROGRAMME

TITLE:

**LOBOLI**  
**SECONDARY SCHOOL**  
NEW ELEVATED WATER TANK

DRAWING No.: **K1000-LS-007**

SCALE:	1 : 25	DESIGNED:	BS
		DRAWN:	KN
DATE:	NOVEMBER 2022	APPROVED:	BS
REV. NO.	1		