

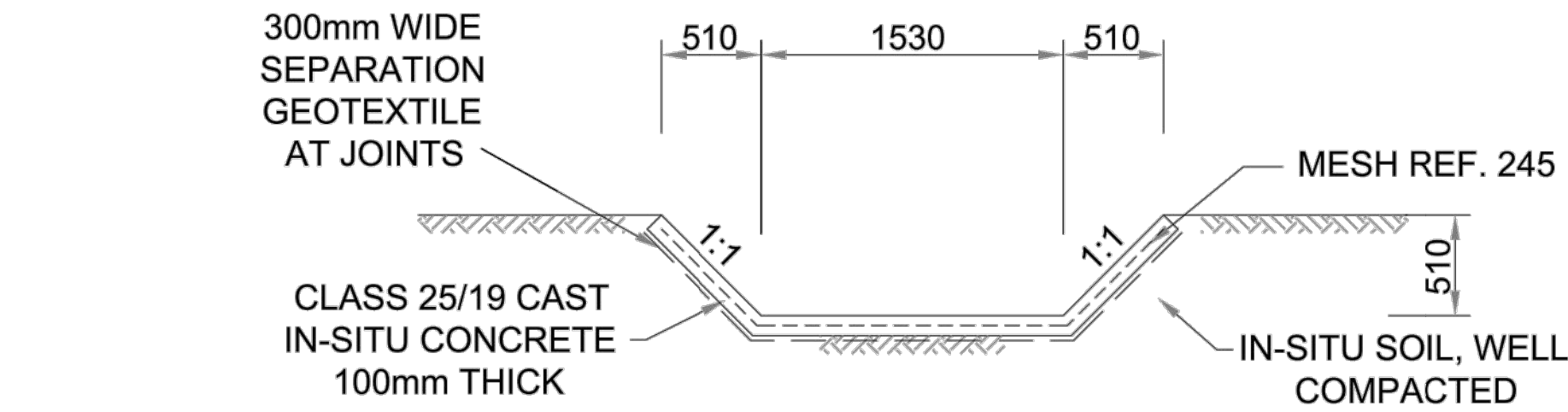

CONTAMINATED WATER
DRAIN - TYPE D1

SCALE: 1:50



CONTAMINATED WATER
DRAIN - TYPE D2

SCALE: 1:50

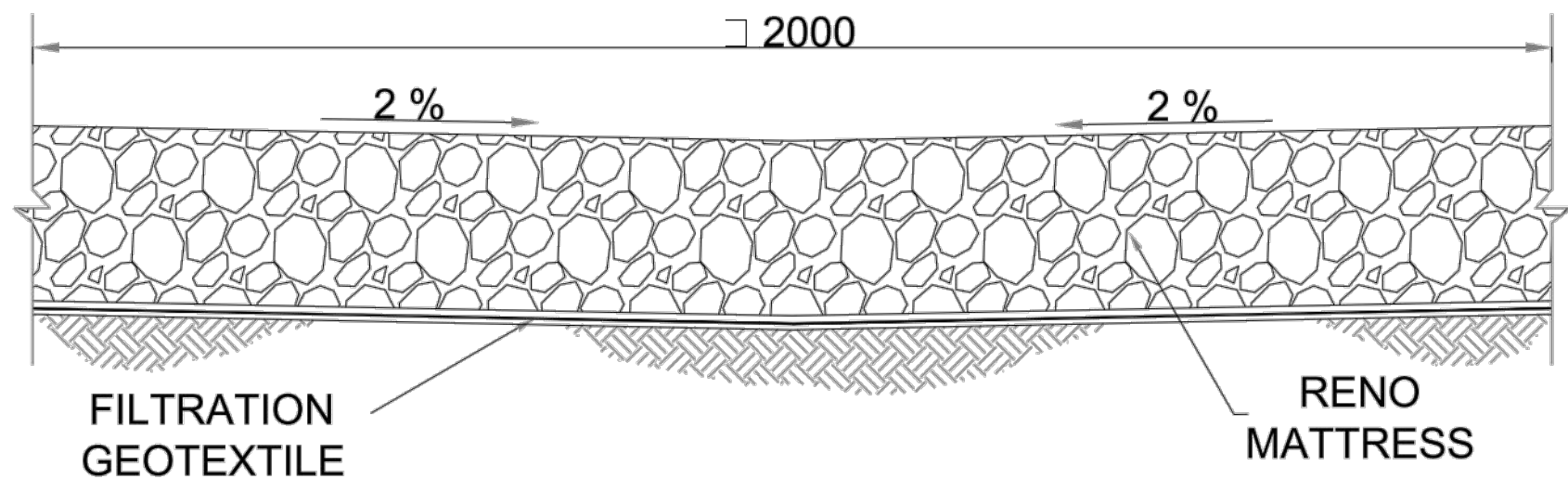

SECTION CC

NOTES:

- 1.) PROVIDE DEBONDED CONSTRUCTION JOINTS AT 2.5m c/c.
- 2.) PROVIDE 300mm WIDE STRIP OF SEPARATION GEOTEXTILE AT EACH JOINT.
- 3.) PANELS TO BE REINFORCED WITH REF. 245 MESH AT TOP.
- 4.) 300mm LAP LENGTH, 40mm CONCRETE COVER.

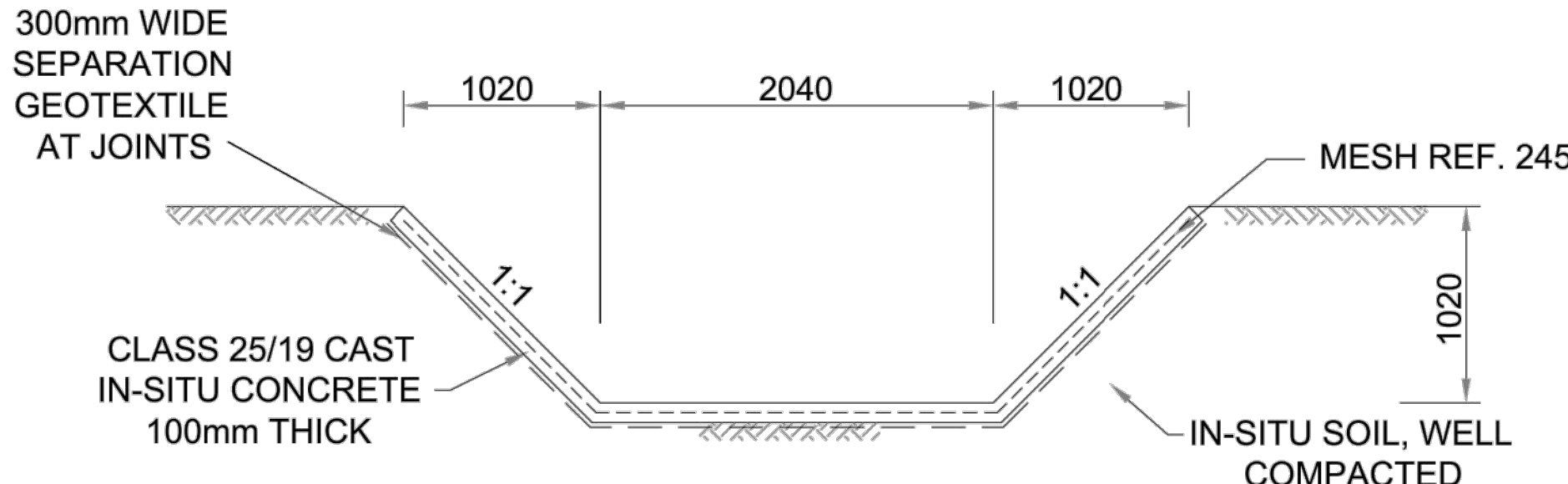

CONTAMINATED WATER
DRAIN - TYPE D3

SCALE: 1:50

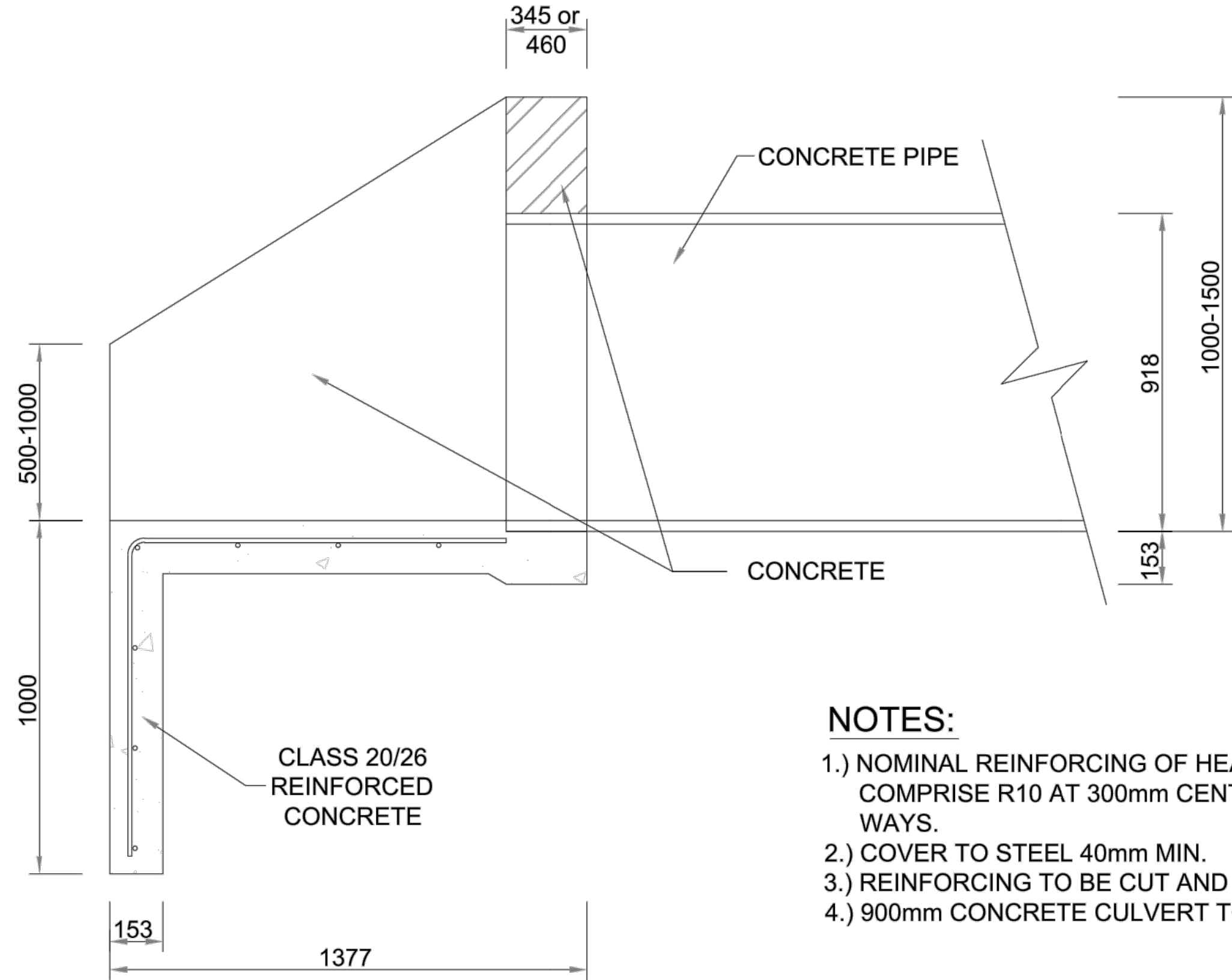

HEADWALL SECTION SHOWING
REINFORCING DETAIL

SCALE: 1:20

NOTES:

- 1.) NOMINAL REINFORCING OF HEADWALL TO COMPRISE R10 AT 300mm CENTRES BOTH WAYS.
- 2.) COVER TO STEEL 40mm MIN.
- 3.) REINFORCING TO BE CUT AND BENT ON SITE.
- 4.) 900mm CONCRETE CULVERT TO BE CLASS 50D.

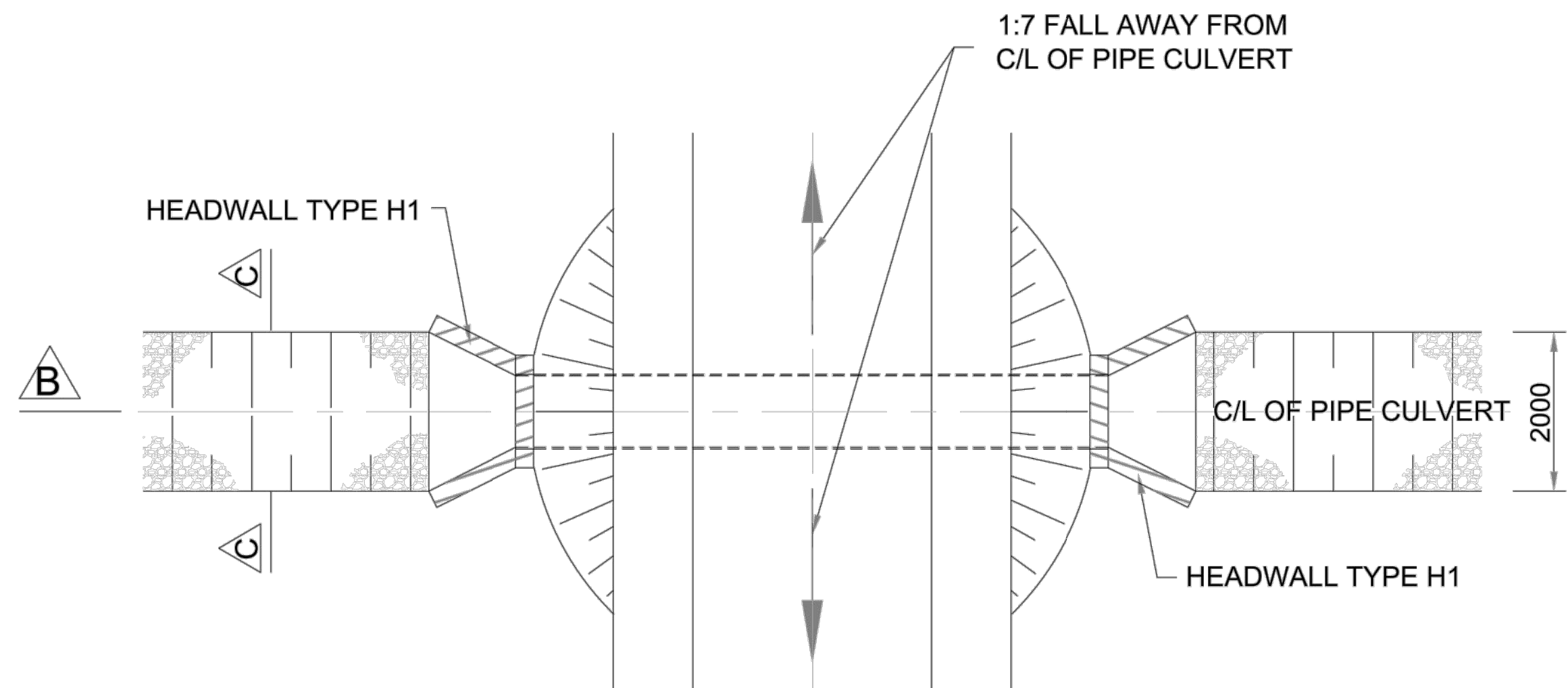

PLAN

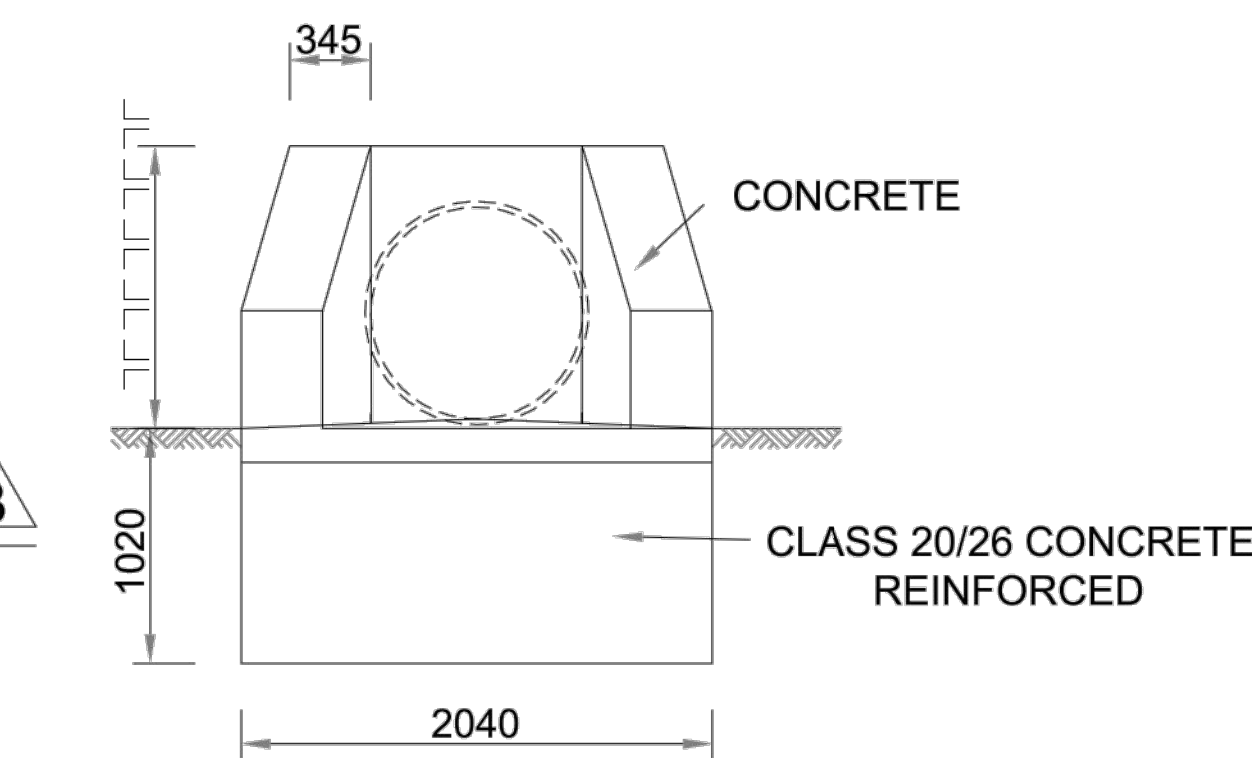

TYPICAL HEADWALL -
TYPE H1 (ELEVATION)

SCALE: 1:50

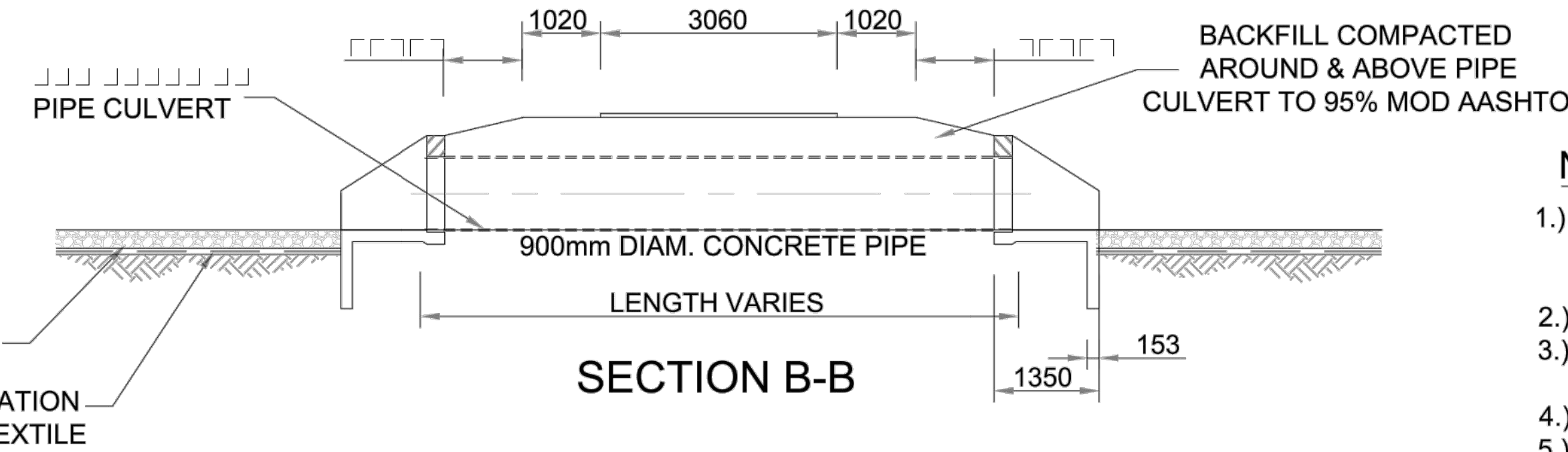

ROAD CROSSING OVER EMERGENCY
OVERFLOW DISCHARGE

SCALE: 1:100

NOTES:

- 1.) NOMINAL REINFORCING OF HEADWALL TO COMPRISE R10 AT 300mm CENTRES BOTH WAYS.
- 2.) COVER TO STEEL 40mm MIN.
- 3.) REINFORCING TO BE CUT AND BENT ON SITE.
- 4.) 900mm CONCRETE CULVERT TO BE CLASS 50D.
- 5.) RENO MATTRESS TO BE 230mm DEEP.
- 6.) RENO MATTRESS TO SLOPE FROM EITHER SIDE TOWARDS THE CENTRE LINE AT 2% (REFER TO DETAIL A ABOVE)
- 7.) RENO MATTRESS WIRE TENSILE STRENGTH COATED (CLASS A AS PER SANS 675:1997)
- 8.) ROCK FILL MUST BE BETWEEN 75mm AND 150mm IN SIZE.
- 9.) FILTRATION GEOTEXTILE TO BE NONWOVEN, NEEDLE PUNCHED POLYESTER MIN. 600N TEAR STRENGTH & 4MPa BURST STRENGTH.

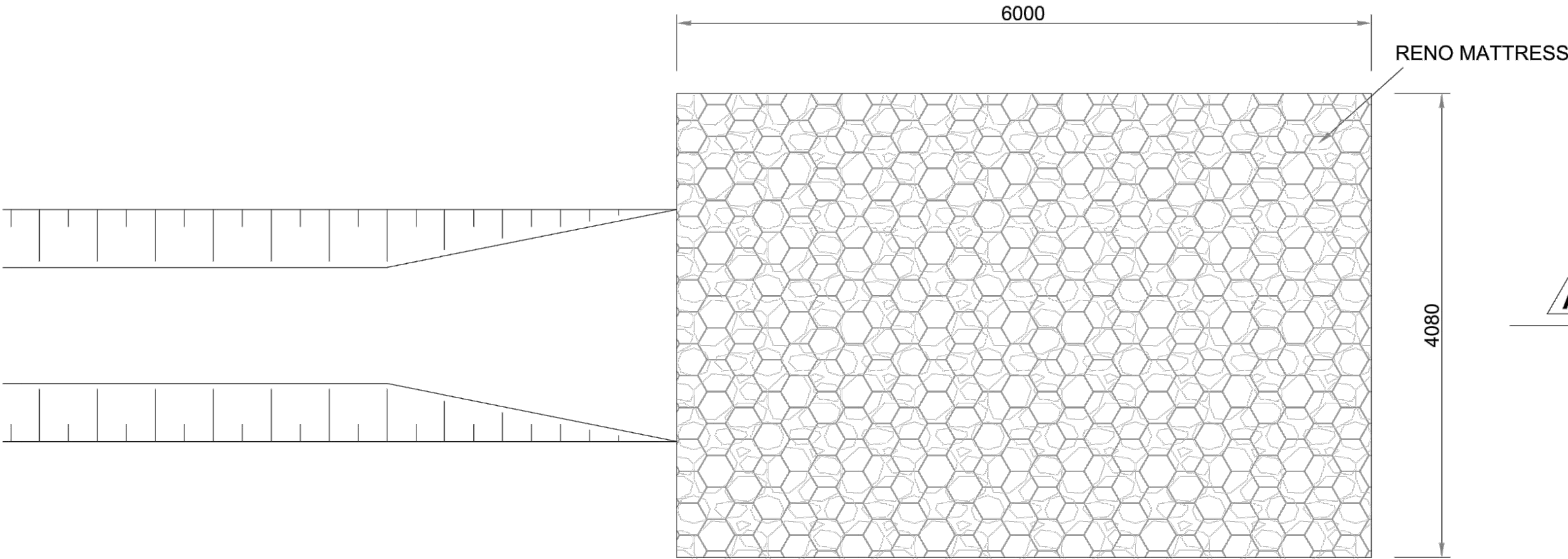

DISCHARGE POINT FROM CLEAN WATER
DRAIN (PLAN)

SCALE: 1:50

NOTES:

- 1.) FILTRATION GEOTEXTILE TO BE NONWOVEN, NEEDLE PUNCHED POLYESTER MIN. 600N TEAR STRENGTH & 4MPa BURST STRENGTH.
- 2.) RENO MATTRESS TO BE 170mm HEIGHT.
- 3.) RENO MATTRESS WIRE TENSILE STRENGTH COATED (CLASS A AS PER SANS 675:1997)
- 4.) ROCK FILL MUST BE BETWEEN 75mm AND 150mm IN SIZE.

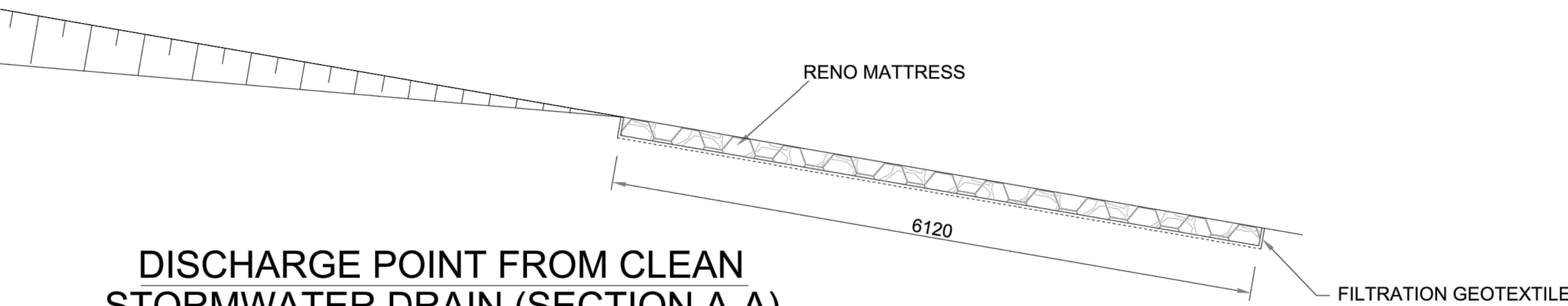

DISCHARGE POINT FROM CLEAN
STORMWATER DRAIN (SECTION A-A)

SCALE: 1:50

FOR TENDER
NOT FOR CONSTRUCTION

				DESIGN APPROVED		DRAWN BY _____		CONSULTANTS:		CLIENT:		GOUDKOPIES LANDFILL SITE PROJECT		FILE No		TYPE OF PLANNING	
								MAVIMBELA QUANTITY SURVEYORS		PIKITUP JOHANNESBURG SOC LTD				-		TENDER DRAWING	
				_____		DRAWING CHECKED _____		15 FIDDES STREET BRONKHORSTSPRUIT 1020		46 JORISSEN STREET BRAAMFONTEIN				AGREEMENT No		CONTRACT No	
				for CONSULTANT _____ DATE _____				DESIGNED BY: _____		a world class African city				-		SCMP/PIK 61/2021-22	
				APPROVED BY _____		DESIGNED CHECKED BY: _____		Tel: (013) 913 0144		a world class African city				ROAD No.s		SCALE	
						Prof. Reg. No: _____		Fax: _____		a world class African city				-		AS SHOWN	
						DESIGNED CHECKED BY: _____		Tel: (011) 712 5300		a world class African city				DISTRICT		DWG No	
						Prof. Reg. No: _____		Fax: (011) 712 5322		a world class African city				JOHANNESBURG		20700-S0-07	
												</					