

W100_0 GROUND FLOOR
1 : 100

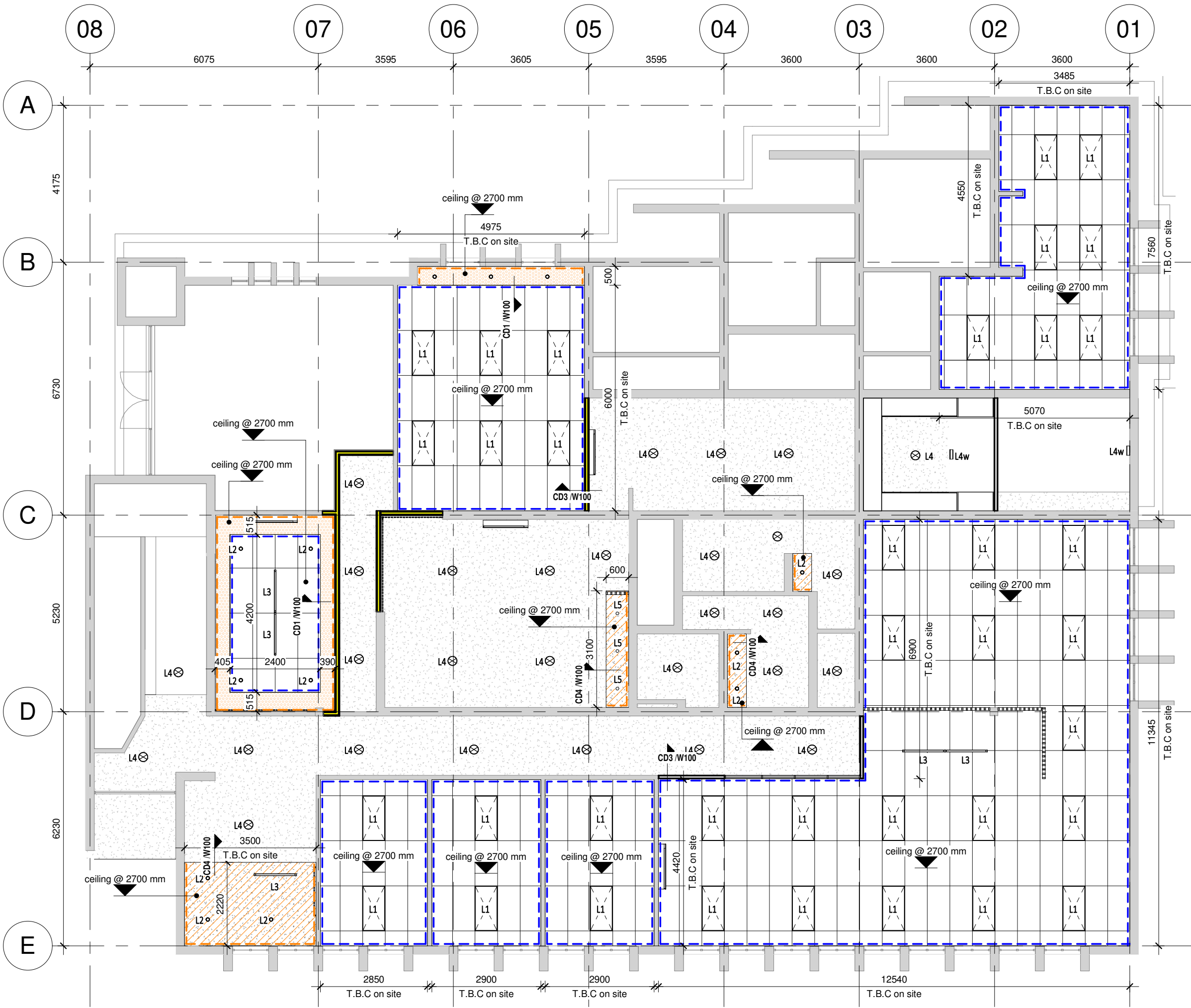

W100_0 GROUND FLOOR (REFLECTED CEILING)
1 : 100

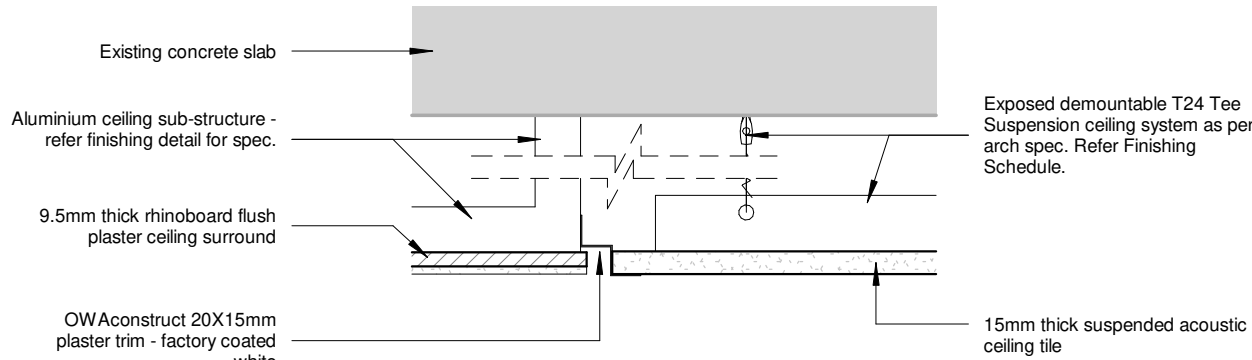

CD1_FLUSH PLASTER TO CEILING TILE
1 : 5

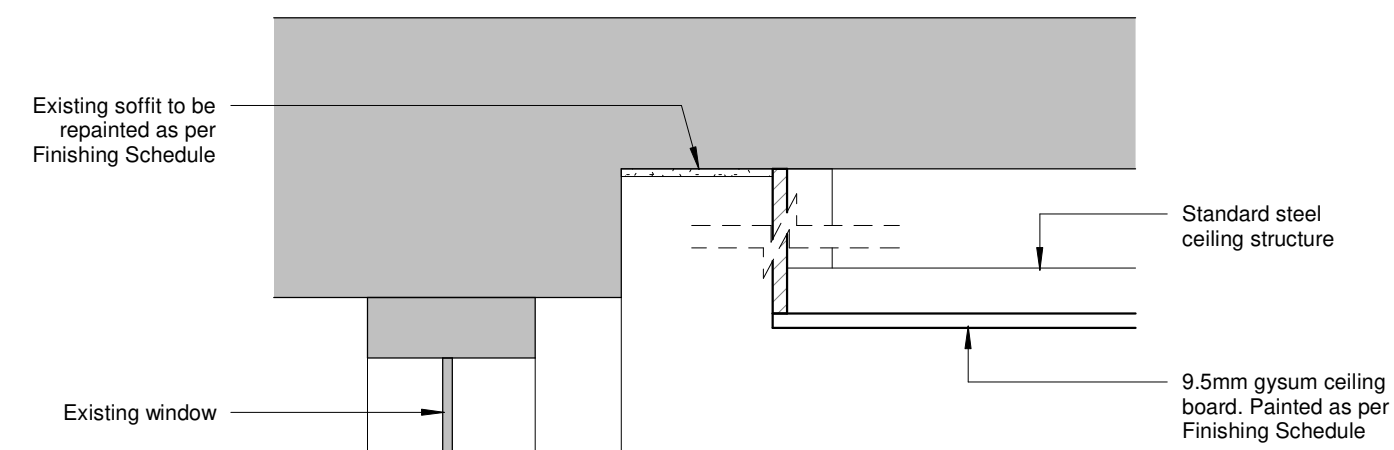

CD2_CEILING TO WALL GAP
1 : 5

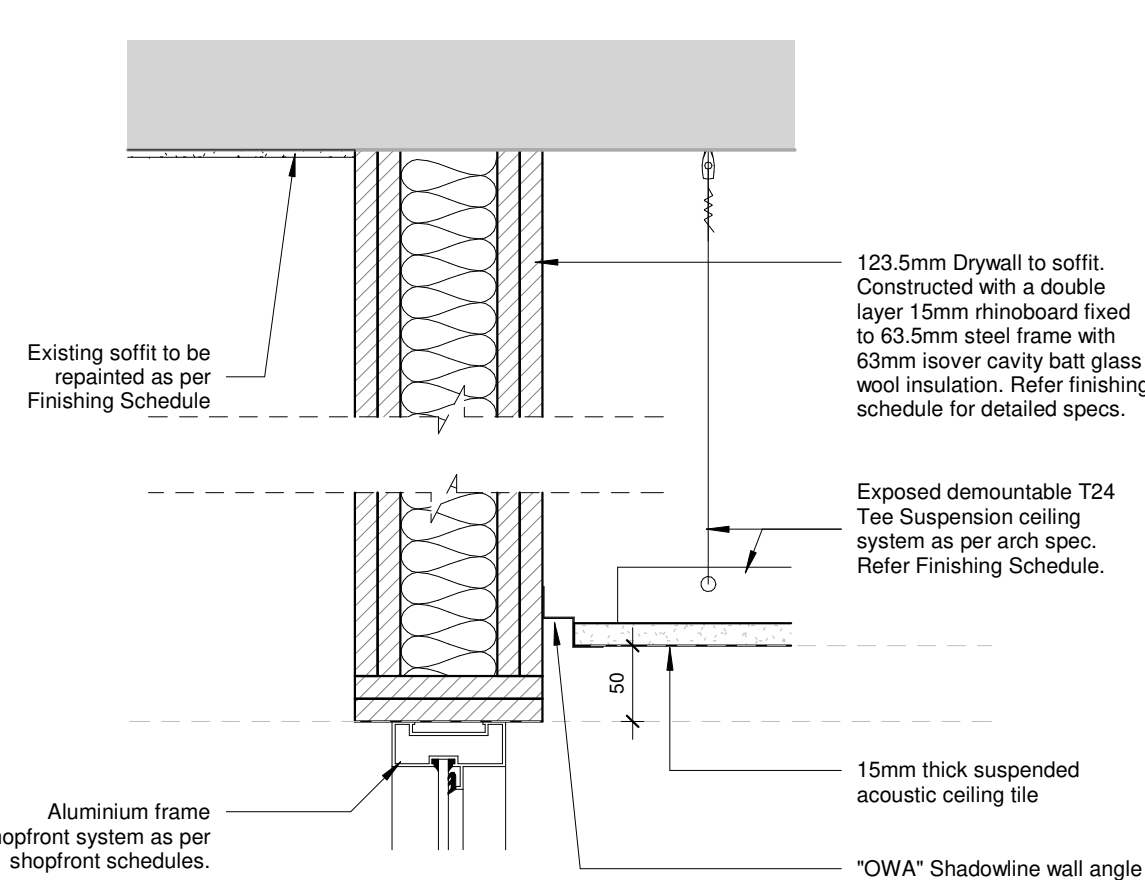

CD3_SHADOWLINE (W TRIM + 20X15 TRIM)
1 : 5

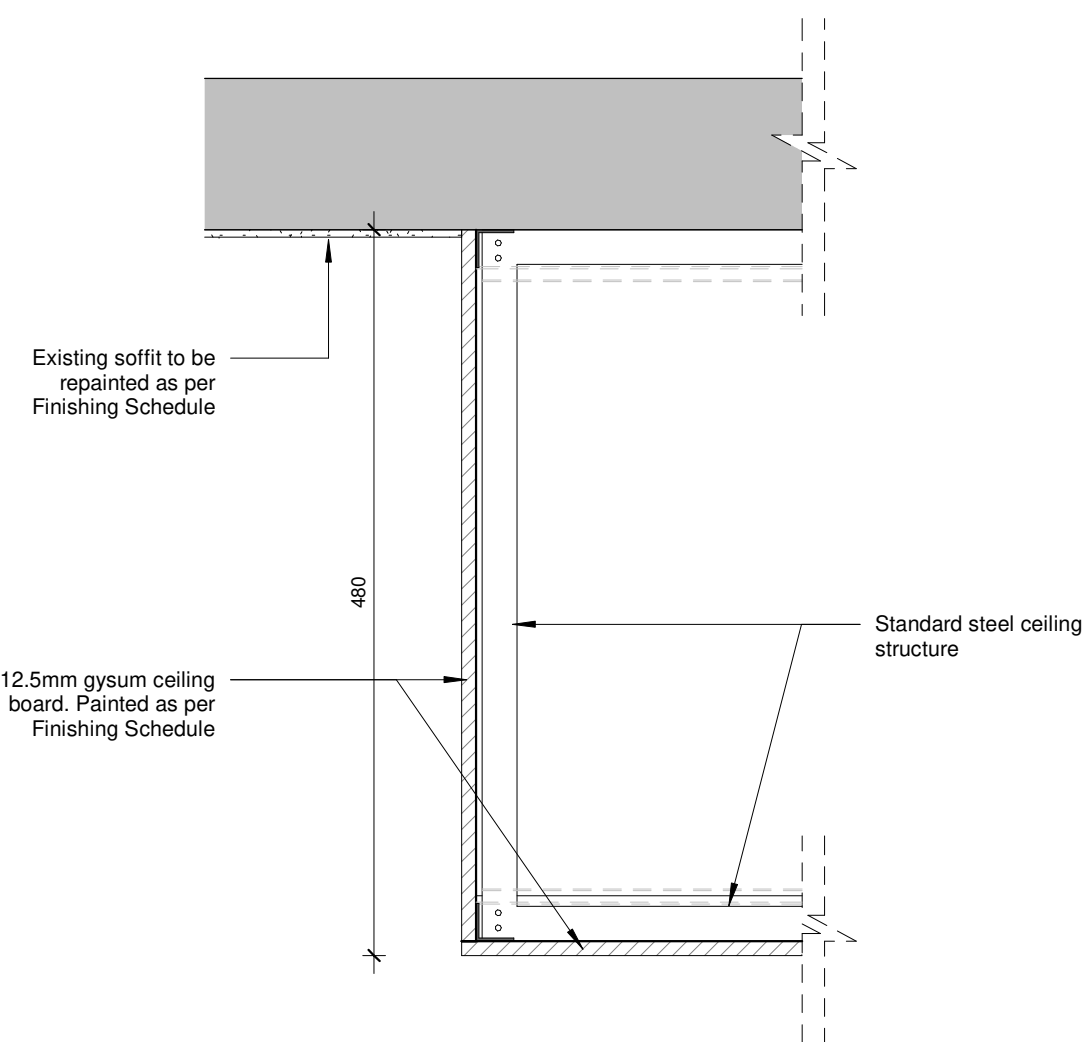

CD4_BULKHEAD CEILING
1 : 5

GENERAL CONSTRUCTION NOTES:

- This drawing is not to be scaled, all figured dimensions to be used.
- All dimensions, heights, and angles to be checked and verified before any work commences on site or in contractors workshop and any discrepancies must be reported to the Designer immediately.
- All work is to comply with the NATIONAL BUILDING REGULATIONS (NBR) AND BUILDING STANDARDS act 103 of 1977 as amended and all relevant specifications and codes of practice of the SOUTH AFRICAN BUREAU OF STANDARDS (SABS) SOUTH AFRICAN NATIONAL STANDARDS (SANS) and amendments thereto.
- All materials and workmanship to be as per the MODEL PREAMBLES FOR TRADES 2008, and further additional premises as noted in the Bill of Materials.
- Any errors, discrepancies, omissions or queries arising from this documentation to be reported to the Designer immediately, for clarification before each work is put in hand.
- ELECTRICAL Engineer: All materials and workmanship to be as specified on the Consultants drawings.
- STRUCTURAL Engineer: All materials and workmanship to be as specified on the Consultants drawings.
- HVAC Engineer: All materials and workmanship to be as specified on the Consultants drawings.
- RATIONAL FIRE Engineer: All materials and workmanship to be as specified on the Consultants drawings.
- WET SERVICES Engineer: All materials and workmanship to be as specified on the Consultants drawings.
- HEALTH AND SAFETY: All construction activities to conform to the OCCUPATIONAL HEALTH AND SAFETY ACT 1993 (Act No 95 of 1993).
- COPYRIGHT: This drawing remains solely vested in FLUID SPACE DESIGN STUDIO in terms of COPYRIGHT ACT NO. 98 OF 1978, Amendment Act, no. 9 of 2002. Any reproduction in and to the drawing and the use of intellectual property contained herein is an infringement of the act.

CEILING TYPE LEGEND

	New 1200 x 600 x 15mm Thick Owacoustic Brillanto A acoustic ceiling tiles on exposed suspension type S3 grid system as per Finishing Schedule [FCE01]
	9.5mm thick "Gyproc RhinoBoard" flush plastered ceiling. Skimmed & painted as per Finishing Schedule [FCE02]
	9.5mm thick "Gyproc RhinoBoard" flush plastered bulkhead ceiling. Skimmed & painted as per Finishing Schedule [FCE03]
	Existing concrete soffits. Exposed soffits to be rubbed down, cleaned, patched and painted as per Finishing Schedule [FCE01]
	Shadowline: "OWA" 20X15mm Plaster trim (see detail: CD2)
	Shadowline: "OWA" Shadowline W-trim wall angle (see detail: CD1, CD2)
	Perimeter Bulkhead wall/window offset edge (see detail: CD3)

NEW WORK NOTES:

- POWERSKIRTING: Re-use existing power skirting where possible. Damaged sections to be replaced. Colour to match existing.
- WINDOW FRAMES: All existing window frames to be repainted as per Finishing Schedule
- HVAC: Existing HVAC units to be inspected for damage and replaced where necessary
- STAIRS: Existing stairs to be re-tiled as per Finishing Schedule (FF02)
- BALUSTRADES: Existing balustrades to be repainted as per Finishing Schedule. Existing handrails to be stripped, sanded smooth and re-varnished as per Finishing Schedule.

DEMOLITION NOTES:

- CONCRETE SOFFIT: Existing soffit to be inspected for damage, make good where necessary.
- LIGHTING: All existing light fittings to be removed

No.	Description	Date

FLUIDspace
DESIGN STUDIO

99 Conrad Drive,
Blairgowrie, 2194

Tel: 094 832 1115
retha@fluidspacea.com

CLIENT

necsa
We're in your world

PROJECT TITLE
P1000 REFURBISHMENT

Elias Motsoaledi St,
Hartbeespoort, 0216,
South Africa

CLIENT
NECSA SOC Ltd

Author	Checker	REG. #
DRAWN BY	CHECKED BY	

DRAWING TITLE
GA LAYOUTS - GROUND FLOOR

ISSUED FOR FOR TENDER	SCALE As indicated	FORMAT A1
DRAWING CODE 08/14/25	INT056	W100
ISSUE DATE	PROJECT	DRAWING NUMBER
		REV

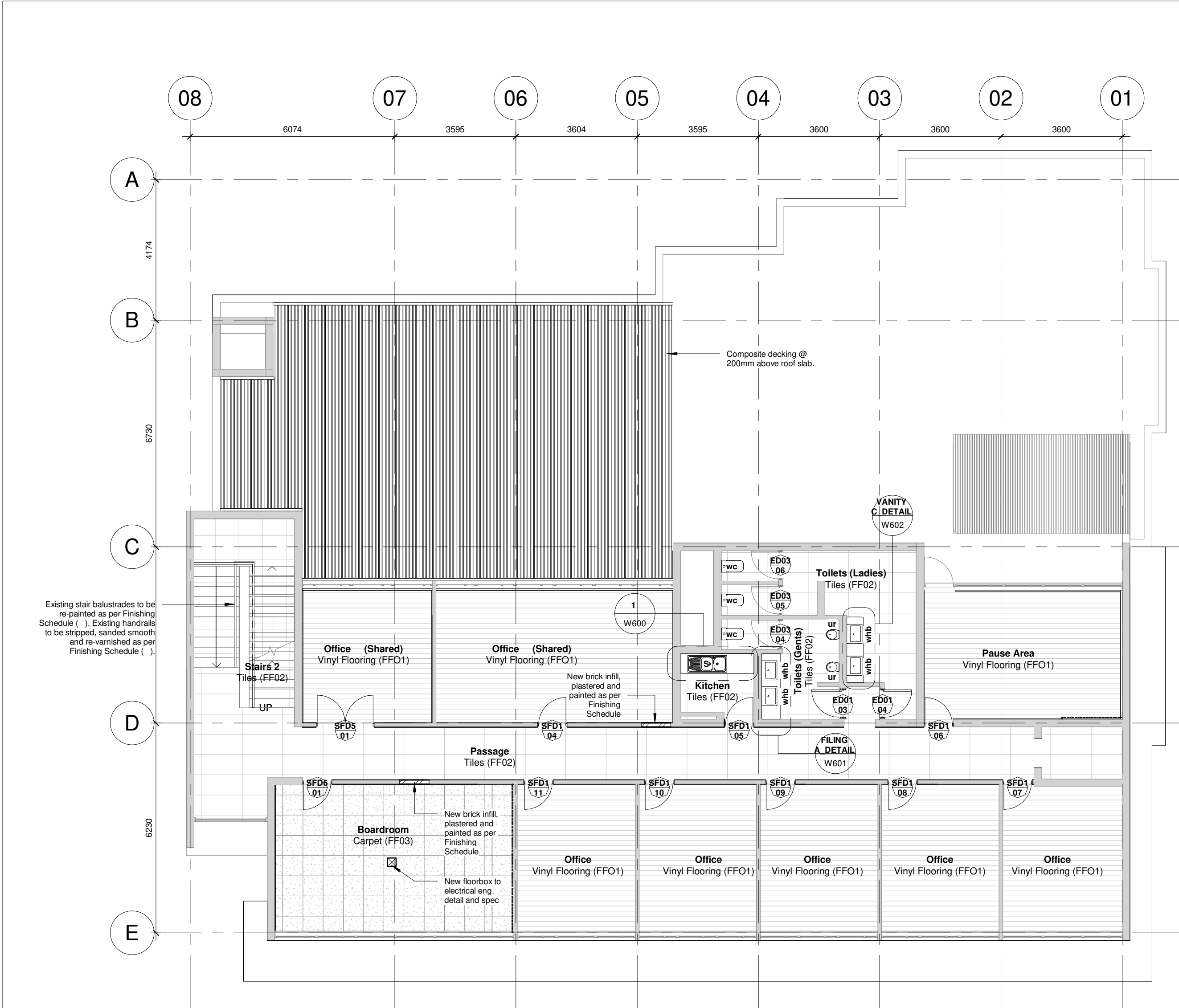

W101_1 FIRST FLOOR
1 : 100

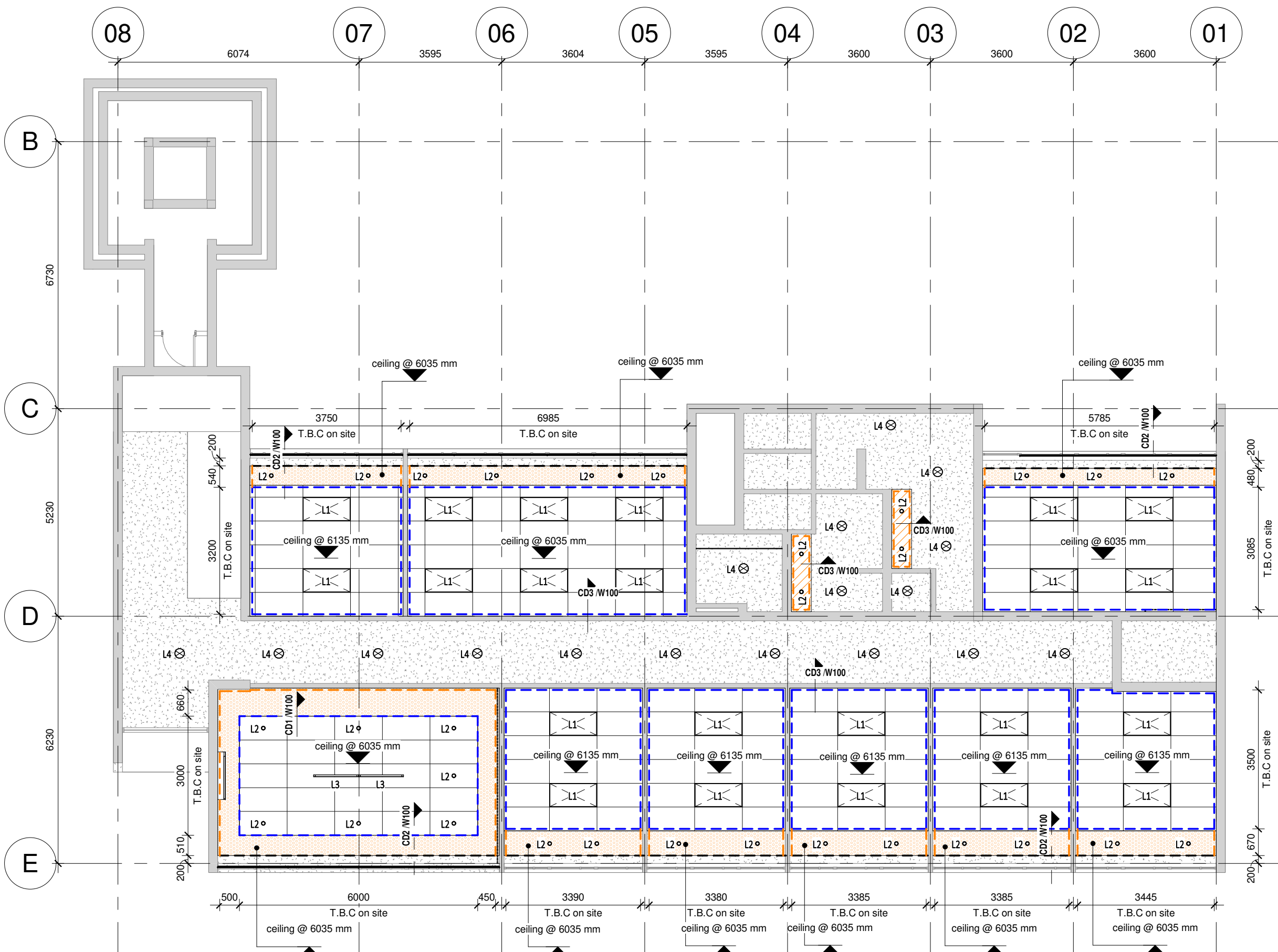

W101_1 FIRST FLOOR (REFLECTED CEILING)
1 : 100

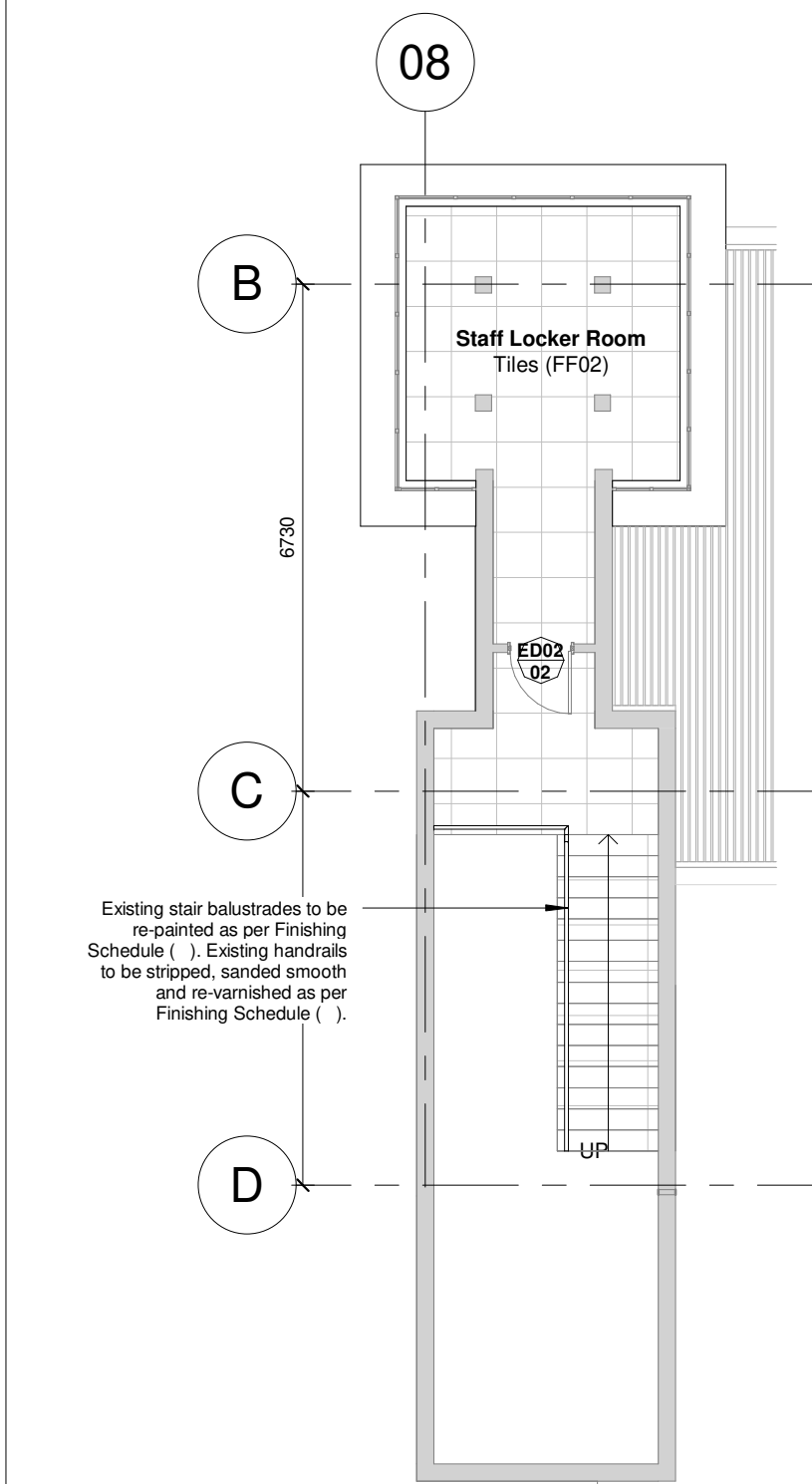

W101_02 SECOND FLOOR
1 : 100

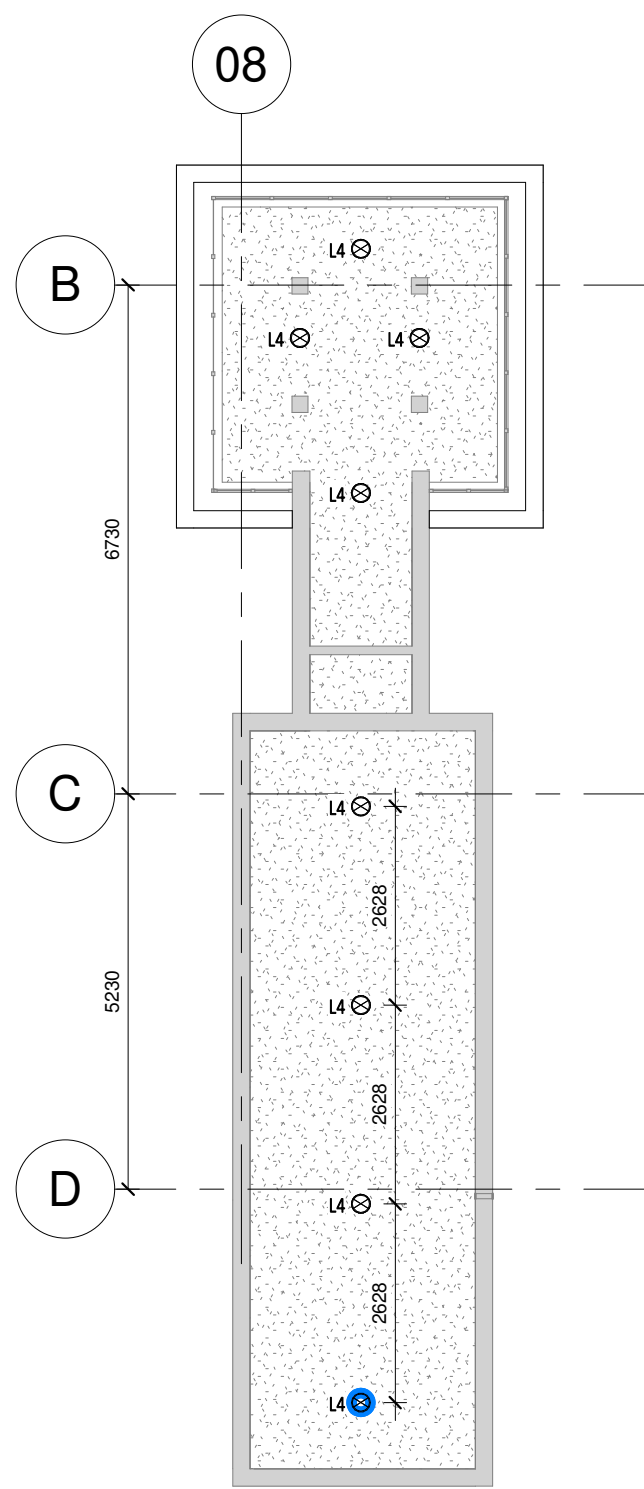

W101_02 SECOND FLOOR (REFLECTED CEILING)
1 : 100

- GENERAL CONSTRUCTION NOTES:
- This drawing is not to be scaled, all figured dimensions to be used.
 - All dimensions, heights, and angles to be checked and verified before any work commences on site or in contractors workshop and any discrepancies must be reported to the Designer immediately.
 - All work is to comply with the NATIONAL BUILDING REGULATIONS (NBR) AND BUILDING STANDARDS as per 103 of 1977 as amended and all relevant specifications and codes of practice of the SOUTH AFRICAN BUREAU OF STANDARDS (SABS) SOUTH AFRICAN NATIONAL STANDARDS (SANS) and amendments thereto.
 - All materials and workmanship to be as per the MODEL PREAMBLES FOR TRADES 2008, and further additional premises as noted in the Bill of Materials.
 - Any errors, discrepancies, omissions or queries arising from this documentation to be reported to the Designer immediately, for clarification before each work is put in hand.
 - ELECTRICAL Engineer: All materials and workmanship to be as specified on the Consultants drawings.
 - STRUCTURAL Engineer: All materials and workmanship to be as specified on the Consultants drawings.
 - HVAC Engineer: All materials and workmanship to be as specified on the Consultants drawings.
 - RATIONAL FIRE Engineer: All materials and workmanship to be as specified on the Consultants drawings.
 - WET SERVICES Engineer: All construction activities to conform to the OCCUPATIONAL HEALTH AND SAFETY ACT 1993 (Act No 85 of 1993).
 - HEALTH AND SAFETY: All construction activities to conform to the OCCUPATIONAL HEALTH AND SAFETY ACT 1993 (Act No 85 of 1993).
 - COPYRIGHT: This drawing remains solely vested in FLUID SPACE DESIGN STUDIO in terms of COPYRIGHT ACT NO. 98 OF 1978, Amendment Act, no. 9 of 2002. Any reproduction in and to this drawing and the use of intellectual property contained herewith is an infringement of the act.

- CEILING TYPE LEGEND
- New 1200 x 600 x 15mm Thick Owacoustic Brilliant A acoustic ceiling tiles on exposed suspension type S3 grid system as per Finishing Schedule [FCE01]
 - 9.5mm thick "Gyproc RhinoBoard" flush plastered ceiling. Skimmed & painted as per Finishing Schedule [FCE02]
 - 9.5mm thick "Gyproc RhinoBoard" flush plastered bulkhead ceiling. Skimmed & painted as per Finishing Schedule [FCE03]
 - Existing concrete soffits. Exposed soffits to be rubbed down, cleaned, patched and painted as per Finishing Schedule [FCE01]
 - Shadowline: "OWA" 20X15mm Plaster trim (see detail: CD2)
 - Shadowline: "OWA" Shadowline W-trim wall angle (see detail: CD1, CD2)
 - Perimeter Bulkhead wall/window offset edge (see detail: CD3)

- NEW WORK NOTES:
- POWERSKIRTING: Re-use existing power skirting where possible. Damaged sections to be replaced. Colour to match existing.
 - WINDOW FRAMES: All existing window frames to be repainted as per Finishing Schedule.
 - HVAC: Existing HVAC units to be inspected for damage and replaced where necessary.
 - STAIRS: Existing stairs to be re-tiled as per Finishing Schedule (FF02).
 - BALUSTRADES: Existing balustrades to be repainted as per Finishing Schedule. Existing handrails to be stripped, sanded smooth and re-varnished as per Finishing Schedule.

- DEMOLITION NOTES:
- CONCRETE SOFFIT: Existing soffit to be inspected for damage, make good where necessary.
 - LIGHTING: All existing light fittings to be removed.

No.	Description	Date

fluidspace
DESIGN STUDIO

99 Conrad Drive,
Blairgowrie, 2194

Tel: 084 832 1115
retha@fluidspacedesign.com

CLIENT

necsa
We're in your world

PROJECT TITLE
P1000 REFURBISHMENT

Elias Motsoaledi St,
Hartbeespoort, 0216,
South Africa

CLIENT
NECSA SOC Ltd

Author	Checker	REG. #
DRAWN BY	CHECKED BY	

DRAWING TITLE

GA LAYOUTS - FIRST FLOOR

ISSUED FOR FOR TENDER	SCALE 1 : 100	FORMAT A1
DRAWING CODE 08/16/25	INT056	W101
ISSUE DATE	PROJECT	DRAWING NUMBER

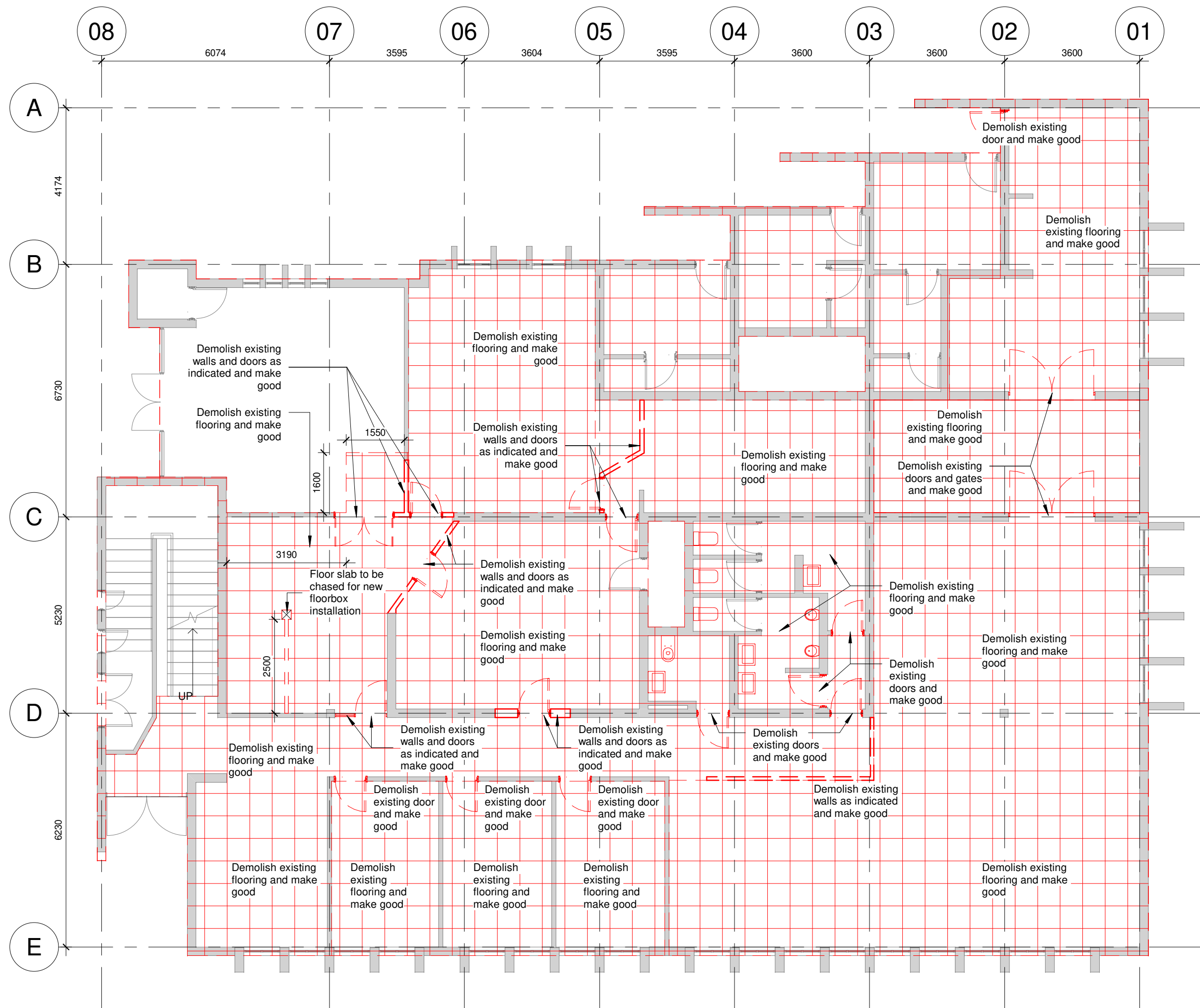

W110_0 GROUND FLOOR (DEMOLITION)

1 : 100

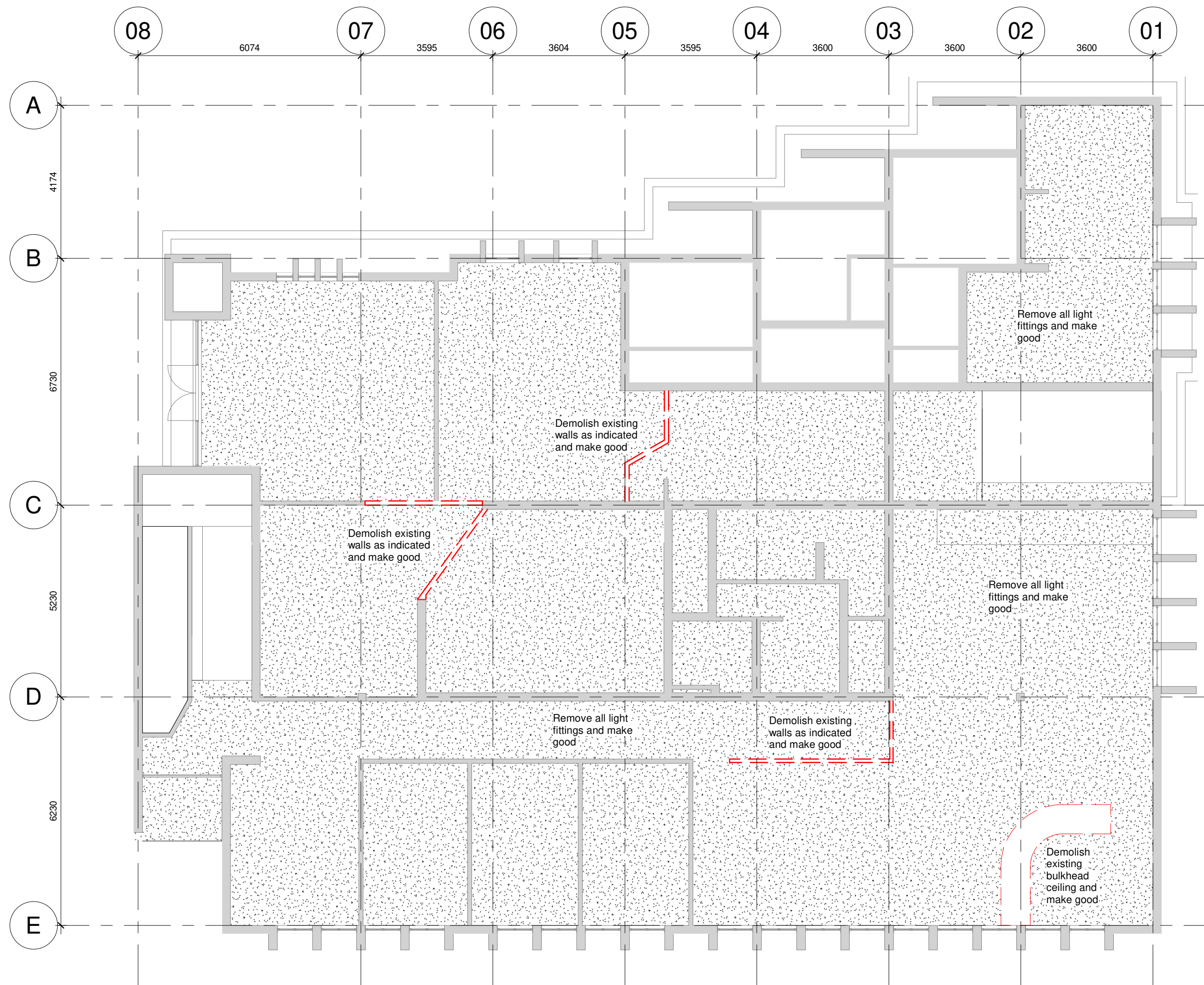

W110_0 GROUND FLOOR (REFLECTED CEILING - DEMO)

1 : 100

GENERAL CONSTRUCTION NOTES:

1. This drawing is not to be scaled, all figured dimensions to be used.
2. All dimensions, heights, and angles to be checked and verified before any work commences on site or in contractors workshop and any discrepancies must be reported to the Designer immediately.
3. All work is to comply with the NATIONAL BUILDING REGULATIONS (NBR) AND BUILDING STANDARDS Act 103 of 1977 as amended and all relevant specifications and codes of practice of the SOUTH AFRICAN BUREAU OF STANDARDS (SABS) SOUTH AFRICAN NATIONAL STANDARDS (SANS) and amendments thereto.
4. All materials and workmanship to be as per the MODEL PREAMBLES FOR TRADES 2008, and further additional premises as noted in the Bill of Materials.
5. Any errors, discrepancies, omissions or queries arising from this documentation to be reported to the Designer immediately, for clarification before such work is put in hand.
6. ELECTRICAL Engineer: All materials and workmanship to be as specified on the Consultants drawings.
7. STRUCTURAL Engineer: All materials and workmanship to be as specified on the Consultants drawings.
8. HVAC Engineer: All materials and workmanship to be as specified on the Consultants drawings.
9. RATIONAL FIRE Engineer: All materials and workmanship to be as specified on the Consultants drawings.
10. WET SERVICES Engineer: All construction activities to conform to the OCCUPATIONAL HEALTH AND SAFETY ACT 1993 (Act No 85 of 1993).
11. HEALTH AND SAFETY: All construction activities to conform to the OCCUPATIONAL HEALTH AND SAFETY ACT 1993 (Act No 85 of 1993).
12. COPYRIGHT: This drawing remains solely vested in FLUID SPACE DESIGN STUDIO in terms of COPYRIGHT ACT NO. 98 OF 1978, Amendment Act, no. 9 of 2002. Any reproduction in and to this drawing and the use of intellectual property contained herewith is an infringement of the act.

No.	Description	Date

FLUIDspace
DESIGN STUDIO

99 Conrad Drive,
Blairgowrie, 2194

Tel: 084 832 1115
retha@fluidspacesa.com

CLIENT

necsa
We're in your world

PROJECT TITLE
P1000 REFURBISHMENT

Elias Motsoaledi St,
Hartbeespoort, 0216,
South Africa

CLIENT
NECSA SOC Ltd

Author	Checker	REG. #
DRAWN BY	CHECKED BY	

DRAWING TITLE
DEMOLITION LAYOUTS - GROUND FLOOR

ISSUED FOR FOR TENDER	SCALE 1 : 100	FORMAT A1
DRAWING CODE		
08/29/25	INT056	W110
ISSUE DATE	PROJECT	DRAWING NUMBER
		REV

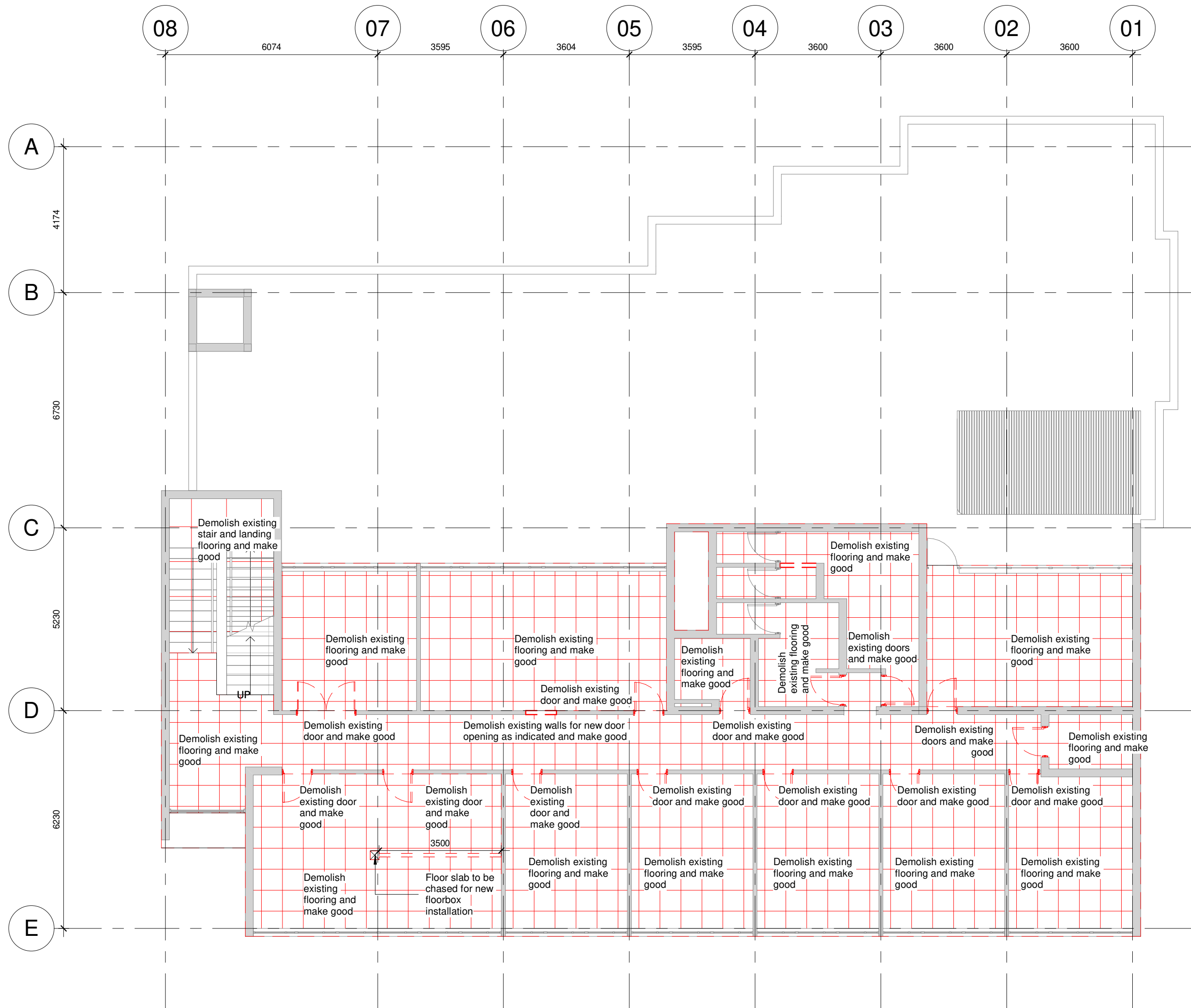

W111_1 FIRST FLOOR (DEMOLITION)
1 : 100

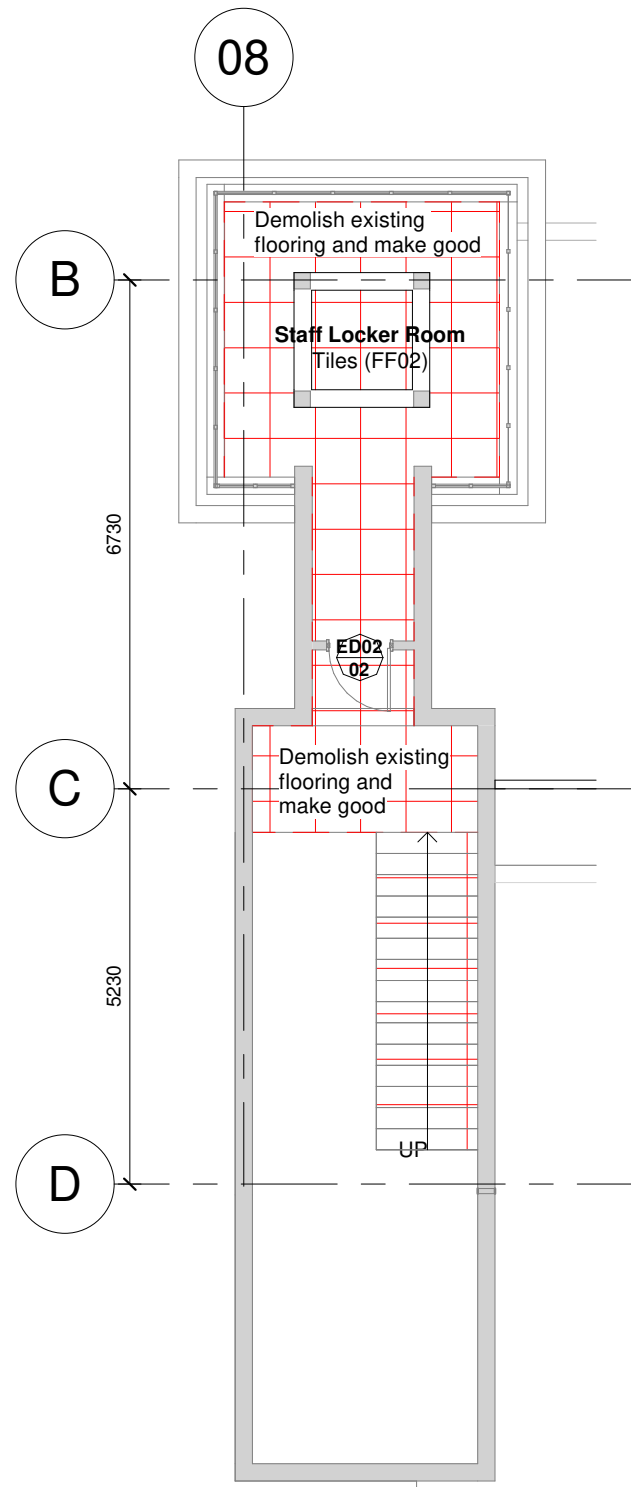

W111_2 SECOND FLOOR (DEMOLITION)
1 : 100



W101_1 FIRST FLOOR (REFLECTED CEILING) Copy 1
1 : 100

- GENERAL CONSTRUCTION NOTES:
- This drawing is not to be scaled, all figured dimensions to be used.
 - All dimensions, heights, and angles to be checked and verified before any work commences on site or in contractors workshop and any discrepancies must be reported to the Designer immediately.
 - All work is to comply with the NATIONAL BUILDING REGULATIONS (NBR) AND BUILDING STANDARDS act 103 of 1977 as amended and all relevant specifications and codes of practice of the SOUTH AFRICAN BUREAU OF STANDARDS (SABS) SOUTH AFRICAN NATIONAL STANDARDS (SANS) and amendments thereto.
 - All materials and workmanship to be as per the MODEL PREAMBLES FOR TRADES 2008, and further additional premises as noted in the Bills of Materials.
 - Any errors, discrepancies, omissions or queries arising from this documentation to be reported to the Designer immediately, for clarification before such work is put in hand.
 - ELECTRICAL Engineer: All materials and workmanship to be as specified on the Consultants drawings.
 - STRUCTURAL Engineer: All materials and workmanship to be as specified on the Consultants drawings.
 - HVAC Engineer: All materials and workmanship to be as specified on the Consultants drawings.
 - RATIONAL FIRE Engineer: All materials and workmanship to be as specified on the Consultants drawings.
 - WET SERVICES Engineer: All construction activities to conform to the OCCUPATIONAL HEALTH AND SAFETY ACT 1993 (Act No 85 of 1993).
 - HEALTH AND SAFETY: All construction activities to conform to the OCCUPATIONAL HEALTH AND SAFETY ACT 1993 (Act No 85 of 1993).
 - COPYRIGHT: This drawing remains solely vested in FLUID SPACE DESIGN STUDIO in terms of COPYRIGHT ACT NO. 98 OF 1978, Amendment Act, no. 9 of 2002. Any reproduction in and to this drawing and the use of intellectual property contained herewith is an infringement of the act.

No.	Description	Date

FLUIDspace
DESIGN STUDIO

99 Conrad Drive,
Blairgowrie, 2194

Tel: 094 832 1115
retha@fluidspace.com

CLIENT

necsa
We're in your world

PROJECT TITLE
P1000 REFURBISHMENT

Elias Motsoaledi St,
Hartbeespoort, 0216,
South Africa

CLIENT
NECSA SOC Ltd

Author	Checker	REG. #
DRAWN BY	CHECKED BY	

DRAWING TITLE
DEMOLITION LAYOUTS - FIRST + SECOND FLOOR

ISSUED FOR FOR TENDER	SCALE 1 : 100	FORMAT A1
---------------------------------	-------------------------	---------------------

DRAWING CODE

08/29/25	INT056	W111
ISSUE DATE	PROJECT	DRAWING NUMBER
		REV



DRAWING TITLE			
WALL FINISHES			
ISSUED FOR FOR TENDER	SCALE 1 : 100	FORMAT A1	
DRAWING CODE			
09/07/17	INT056	W140	
ISSUE DATE	PROJECT	DRAWING NUMBER	REV

KITCHEN A - DETAILS



1 : 25

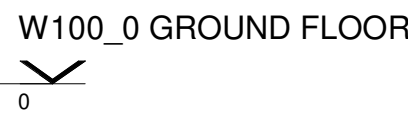

1 : 25

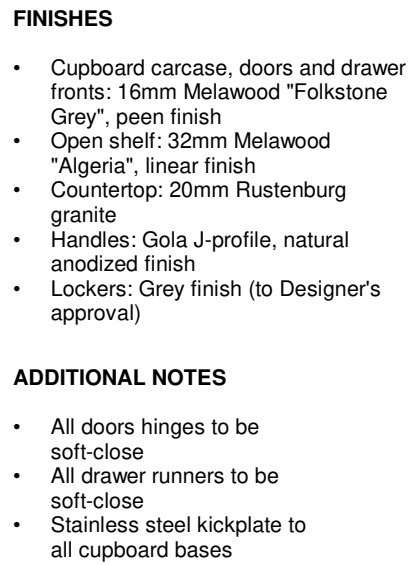

1 : 25

KITCHEN B - DETAILS

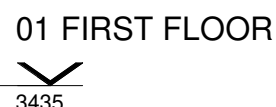
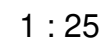

1 : 25

- ADDITIONAL NOTES**
- All doors hinges to be soft-close
 - All drawer runners to be soft-close
 - Stainless steel kickplate to all cupboard bases

[illegible][illegible]

FLUIDspace
DESIGN STUDIO

99 Conrad Drive,
Blairgowrie, 2194
Tel: 084 832 1115
retha@fluidspacesa.com

necsa
We're in your world

PROJECT TITLE
P1000 REFURBISHMENT

Elias Motsoaledi St,
Hartbeespoort, 0216
South Africa

CLIENT
NECSA SOC Ltd

Author	Checker		
DRAWN BY	CHECKED BY	REG. #	

DRAWING TITLE

JOINERY DETAILS

ISSUED FOR FOR TENDER	SCALE 1 : 25	FORMAT A1
---------------------------------	------------------------	---------------------

DRAWING CODE			
13/08/2025	INT056	W600	
ISSUE DATE	PROJECT	DRAWING NUMBER	REV

FILING A - DETAILS

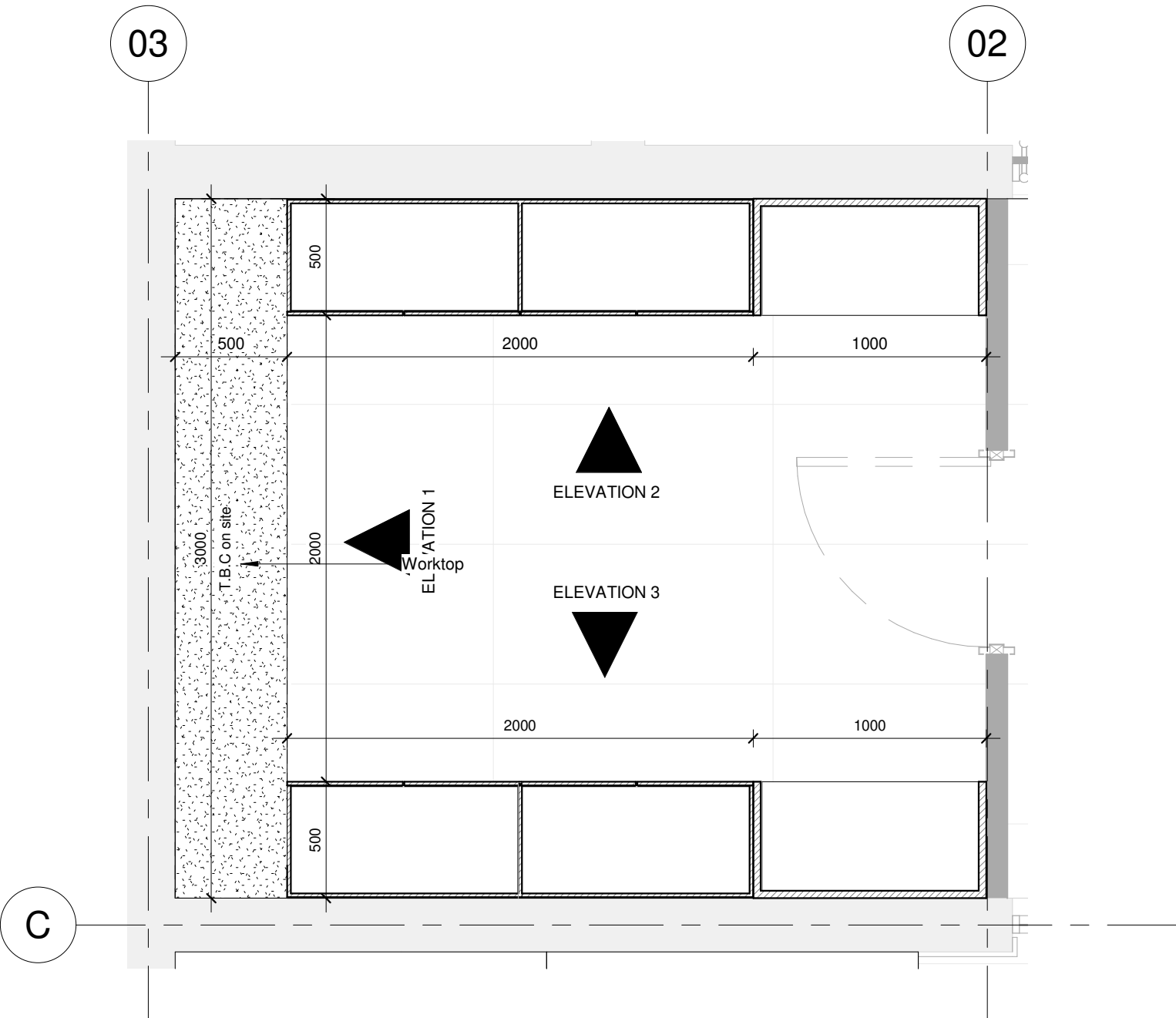

W601_FILING A - PLAN

1 : 25

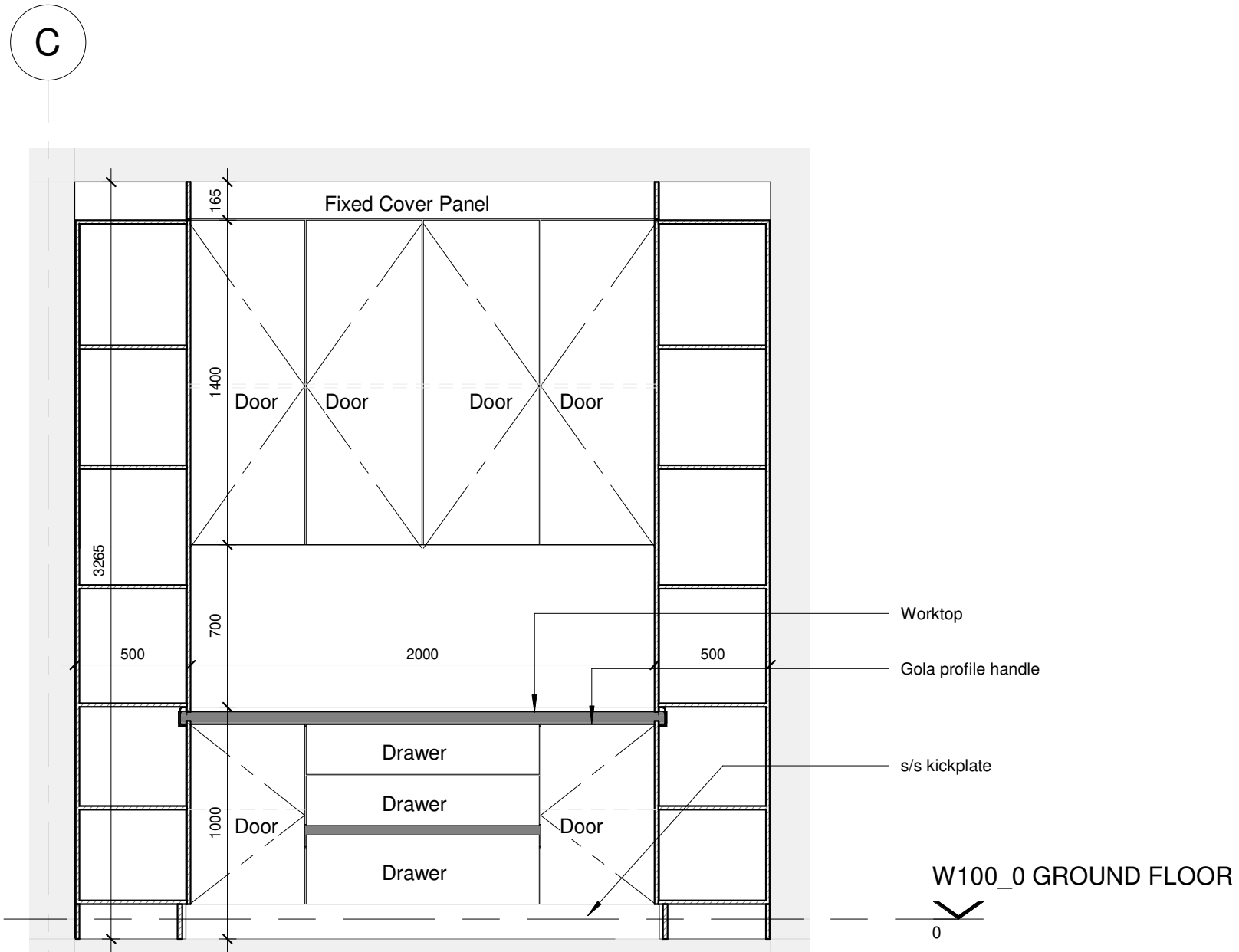

W601_FILING A - ELEVATION 1

1 : 25

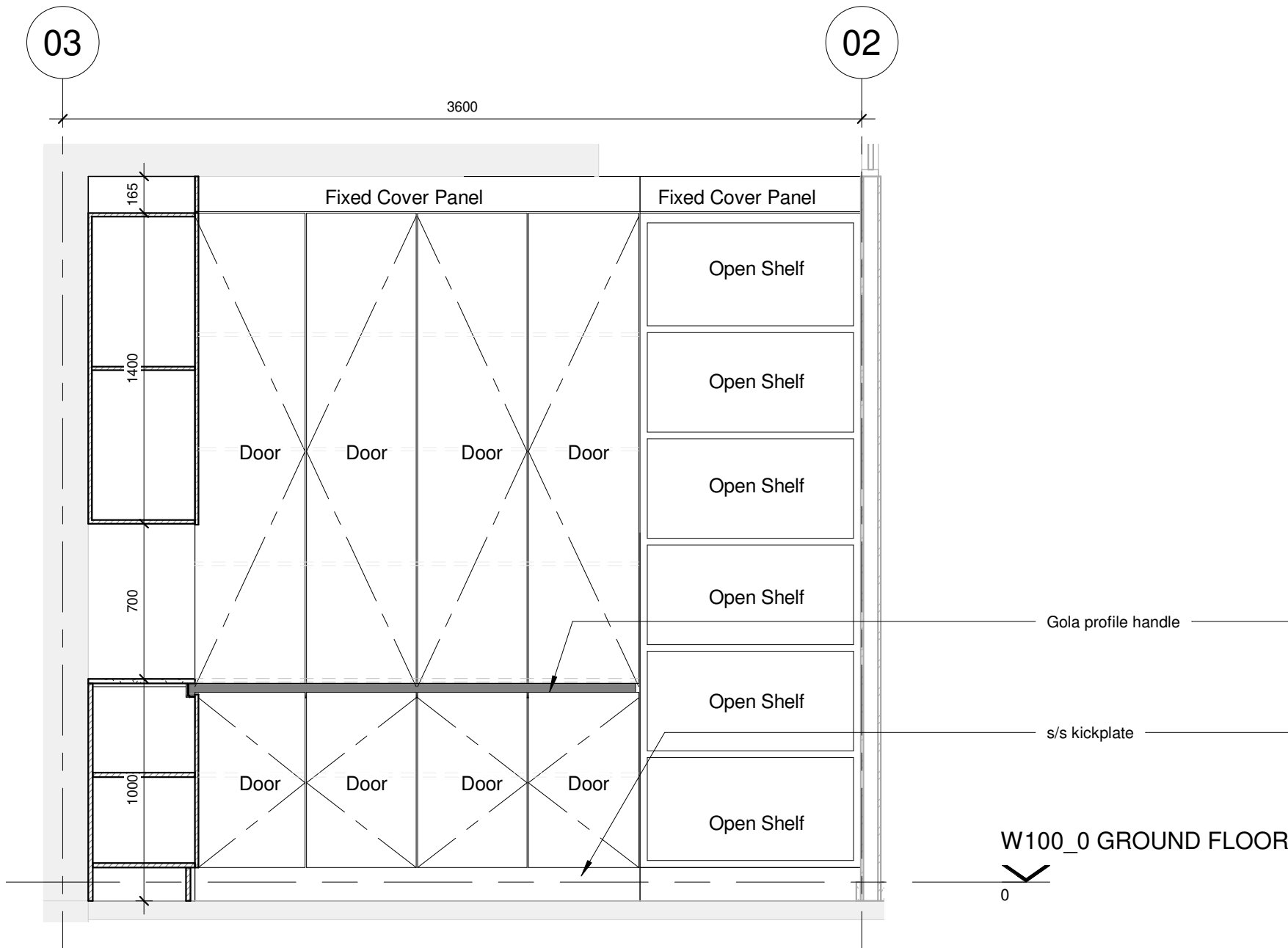

W601_FILING A - ELEVATION 2

1 : 25

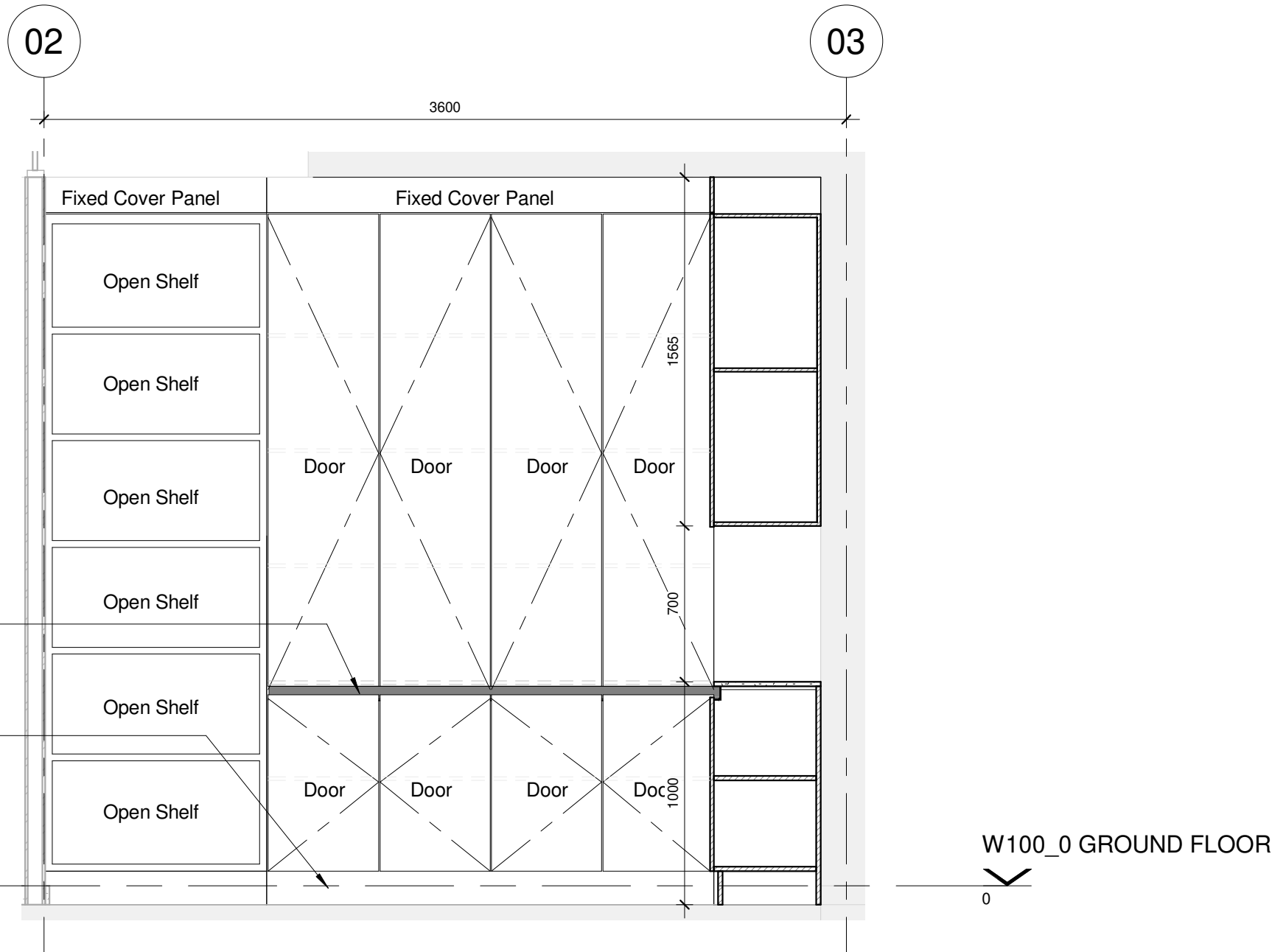

W601_FILING A - ELEVATION 3

1 : 25

- FINISHES**
- Cabinet carcass, doors and drawer fronts: Melawood "Folkstone Grey", peen finish
 - Worktop: Rustenburg granite
 - Handles: Gola J-profile and U-profile, black finish

- ADDITIONAL NOTES**
- All doors hinges to be soft-close
 - All drawer runners to be soft-close
 - Stainless steel kickplate to all cabinet bases

FILING B - DETAILS

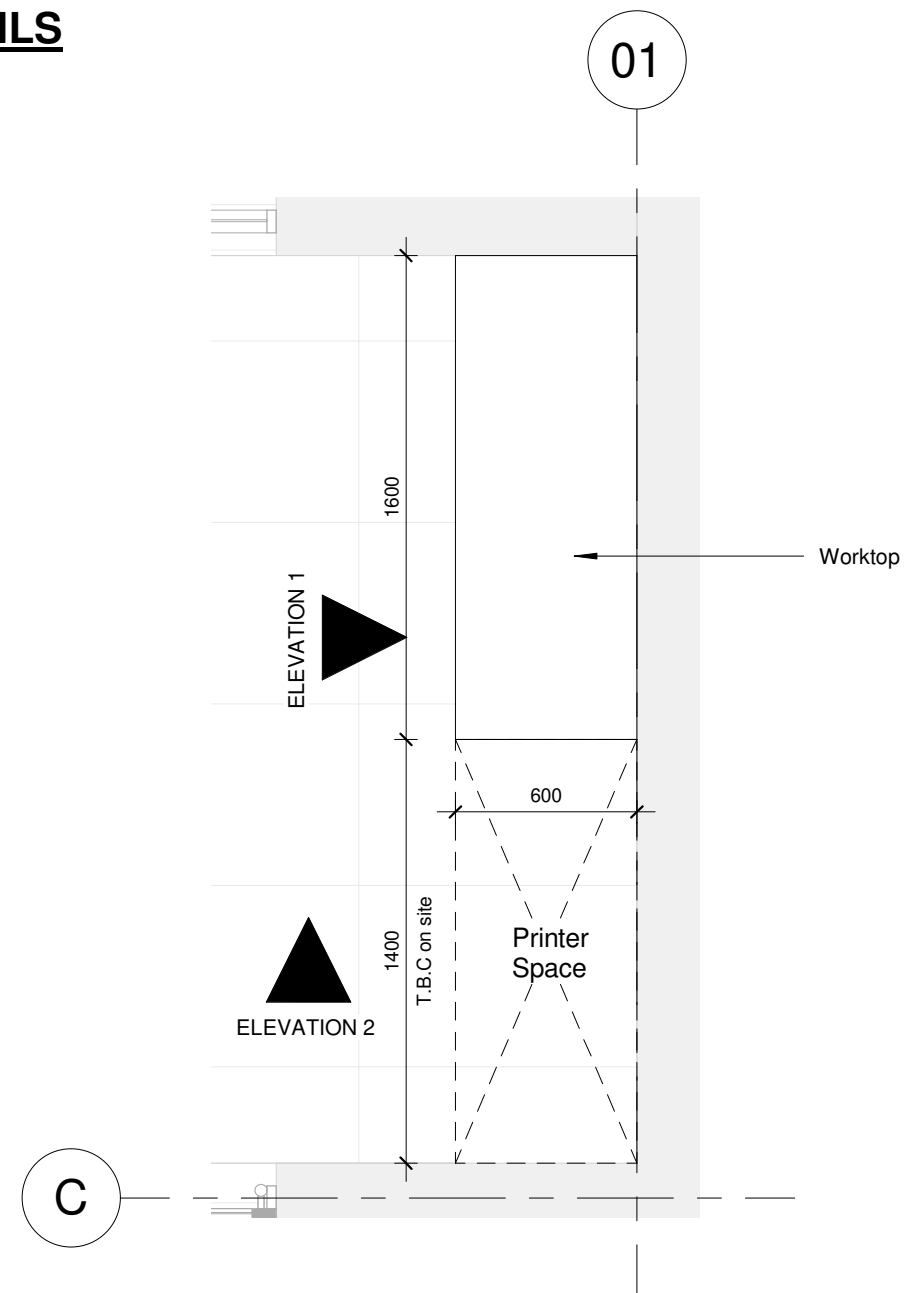

W602_FILING B - PLAN

1 : 25

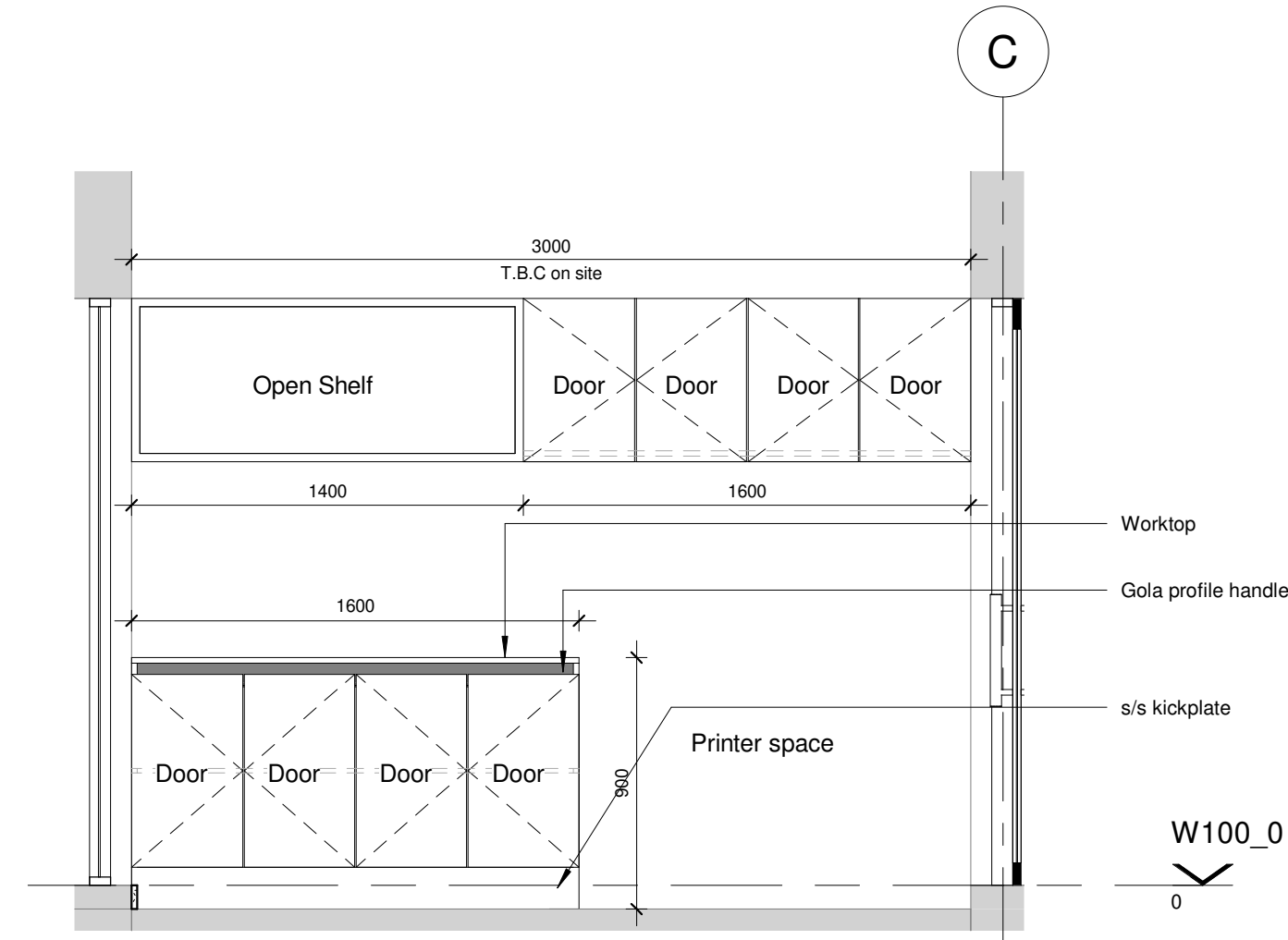

W601_FILING B - ELEVATION 1

1 : 25

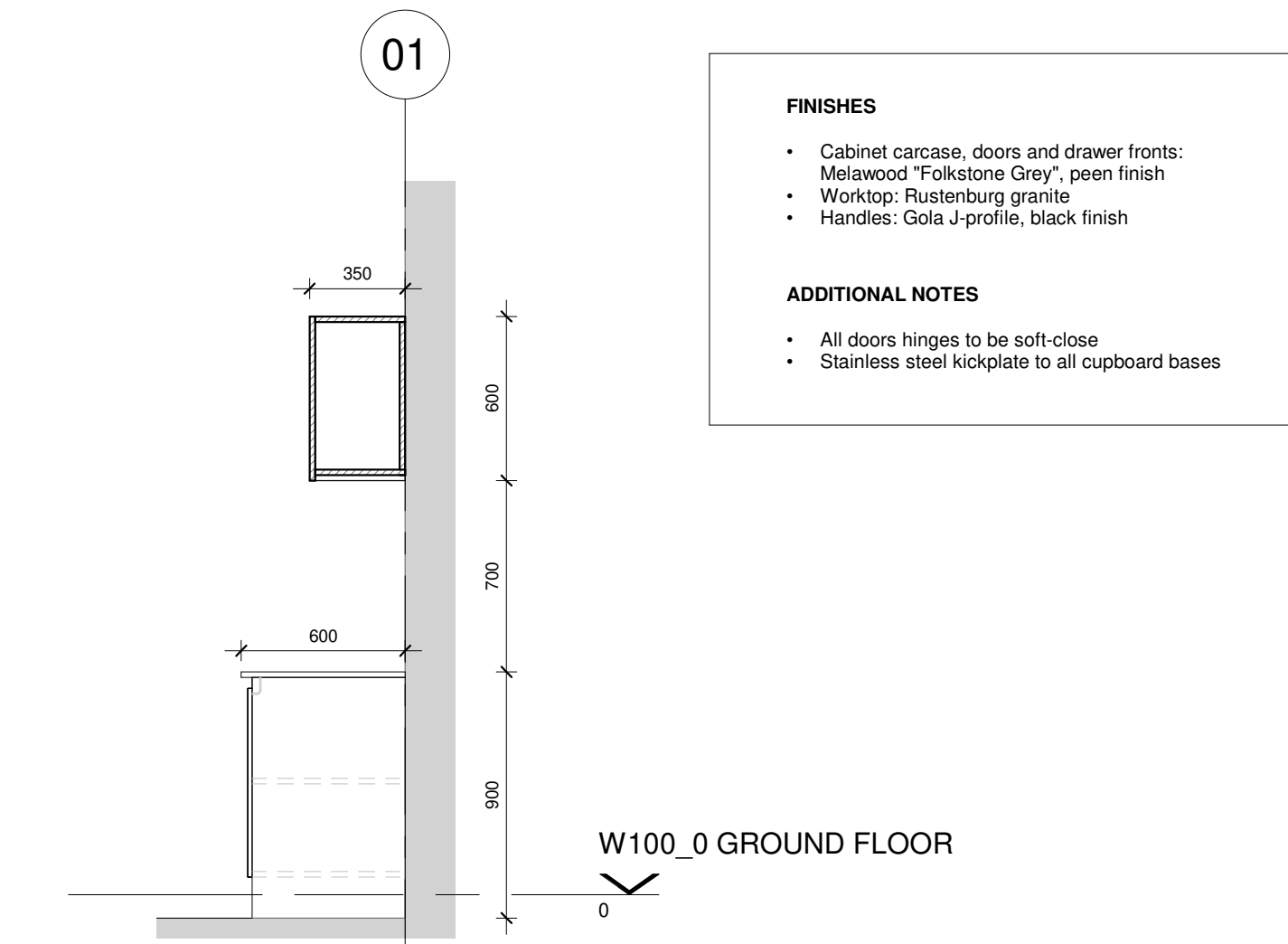

W601_FILING B - ELEVATION 2

1 : 25

FINISHES

- Cabinet carcass, doors and drawer fronts: Melawood "Folkstone Grey", peen finish
- Worktop: Rustenburg granite
- Handles: Gola J-profile, black finish

ADDITIONAL NOTES

- All doors hinges to be soft-close
- Stainless steel kickplate to all cupboard bases

GENERAL CONSTRUCTION NOTES:

- This drawing is not to be scaled, all figured dimensions to be used.
- All dimensions, heights, and angles to be checked and verified before any work commences on site or in contractors workshop and any discrepancies must be reported to the Designer immediately.
- All work is to comply with the NATIONAL BUILDING REGULATIONS (NBR) AND BUILDING STANDARDS act 103 of 1977 as amended and all relevant specifications and codes of practice of the SOUTH AFRICAN BUREAU OF STANDARDS (SABS) SOUTH AFRICAN NATIONAL STANDARDS (SANS) and amendments thereto.
- All materials and workmanship to be as per the MODEL PREAMBLES FOR TRADES 2008, and further additional premises as noted in the Bill of Materials.
- Any errors, discrepancies, omissions or queries arising from this documentation to be reported to the Designer immediately, for clarification before such work is put in hand.
- ELECTRICAL Engineer: All materials and workmanship to be as specified on the Consultants drawings.
- STRUCTURAL Engineer: All materials and workmanship to be as specified on the Consultants drawings.
- HVAC Engineer: All materials and workmanship to be as specified on the Consultants drawings.
- RATIONAL FIRE Engineer: All materials and workmanship to be as specified on the Consultants drawings.
- WEI SERVICES Engineer: All construction activities to conform to the OCCUPATIONAL HEALTH AND SAFETY ACT 1993 (Act No 95 of 1993).
- HEALTH AND SAFETY ACT 1993 (Act No 95 of 1993).
- COPYRIGHT: This drawing remains solely vested in FLUID SPACE DESIGN STUDIO in terms of COPYRIGHT ACT NO. 98 OF 1978, Amendment Act, no. 9 of 2002. Any reproduction in and to this drawing and the use of intellectual property contained herewith is an infringement of the act.

No.	Description	Date

FLUIDspace
DESIGN STUDIO

99 Conrad Drive,
Blairgowrie, 2194
Tel: 094 832 1115
retha@fluidspacedesa.com

CLIENT

necsa
We're in your world

PROJECT TITLE
P1000 REFURBISHMENT

Elias Motsoaledi St,
Hartbeespoort, 0216,
South Africa

CLIENT
NECSA SOC Ltd

Author	Checker	REG. #
DRAWN BY	CHECKED BY	

DRAWING TITLE

JOINERY DETAILS

ISSUED FOR FOR TENDER	SCALE 1 : 25	FORMAT A1
DRAWING CODE 13/08/2025	INT056	W601
ISSUE DATE	PROJECT	DRAWING NUMBER
		REV

SCREEN A - DETAILS

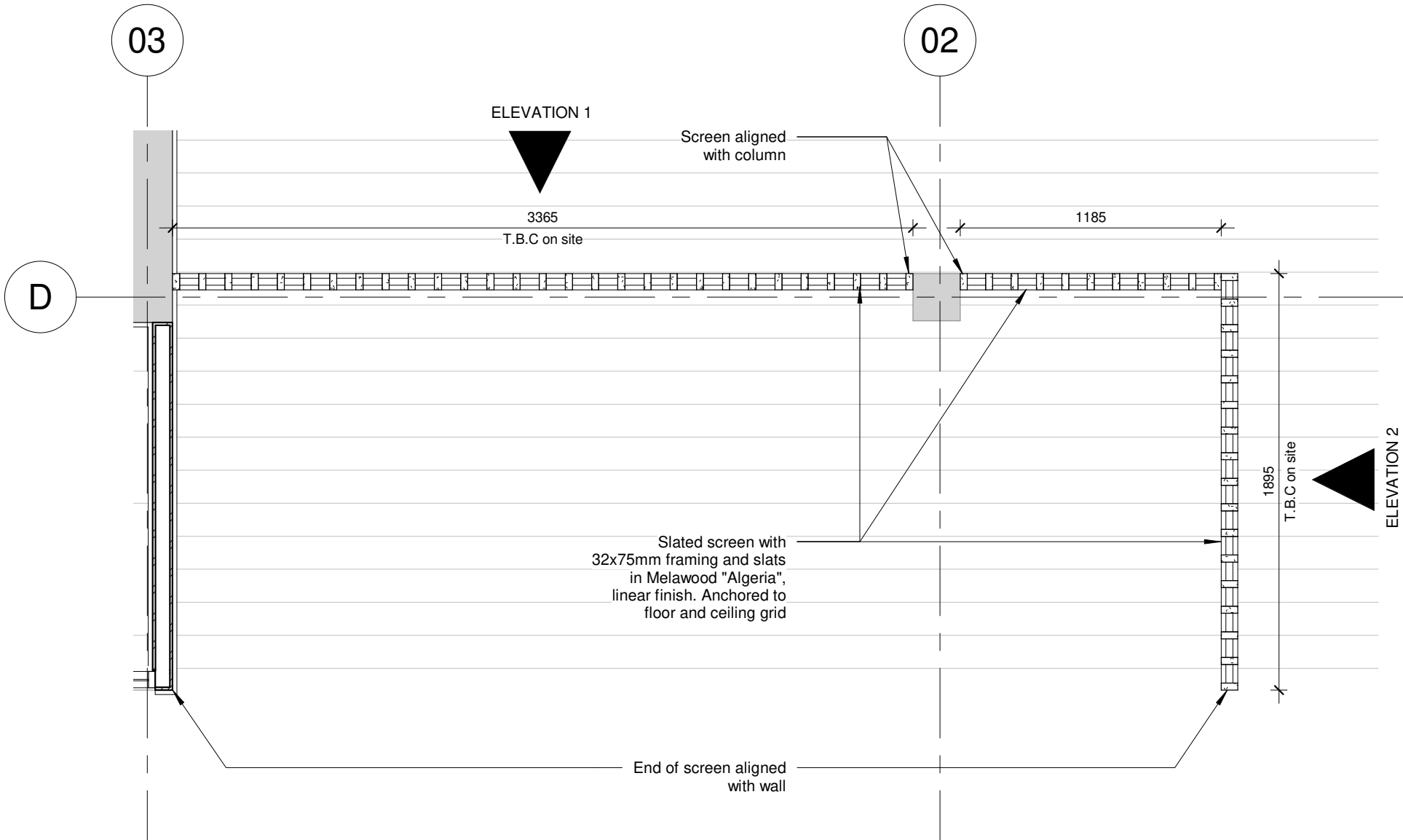

SCREEN B - DETAILS

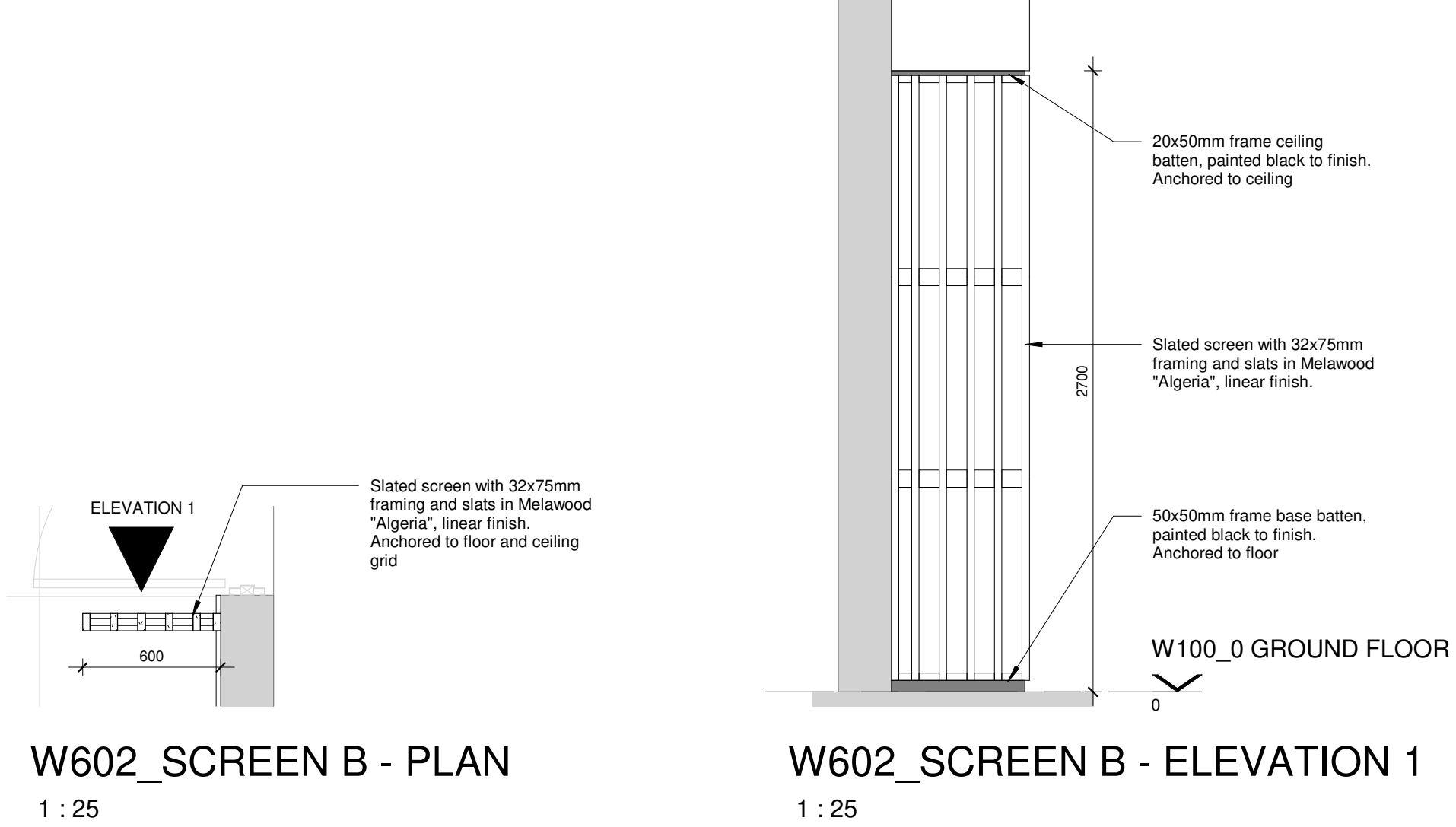

VANITY A, B + C - DETAILS

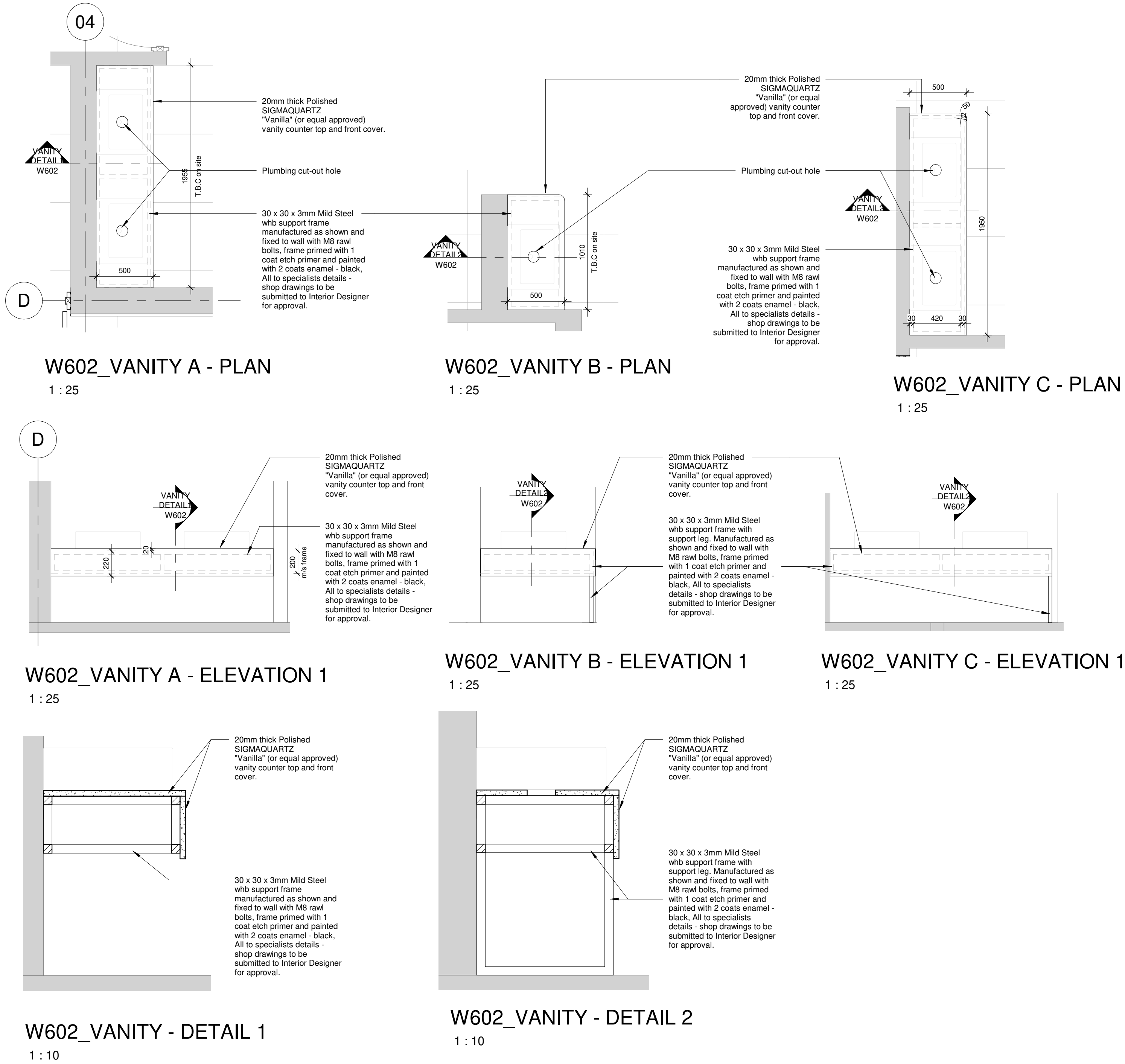

GENERAL CONSTRUCTION NOTES:

1. This drawing is not to be scaled, all figured dimensions to be used.
2. All dimensions, heights, and angles to be checked and verified before any work commences on site or in contractors workshop and any discrepancies must be reported to the Designer immediately.
3. All work is to comply with the NATIONAL BUILDING REGULATIONS (NBR) AND BUILDING STANDARDS act 103 of 1977 as amended and all relevant specifications and codes of practice of the SOUTH AFRICAN BUREAU OF STANDARDS (SABS) SOUTH AFRICAN NATIONAL STANDARDS (SANS).
4. All materials and workmanship to be as per the MODEL PREAMBLES FOR TRADES 2008, and further additional premises as noted in the Bills of Materials.
5. Any errors, discrepancies, omissions or queries arising from this documentation to be reported to the Designer immediately, for clarification before such work is put in hand.
6. ELECTRICAL Engineer: All materials and workmanship to be as specified on the Consultants drawings.
7. STRUCTURAL Engineer: All materials and workmanship to be as specified on the Consultants drawings.
8. HVAC Engineer: All materials and workmanship to be as specified on the Consultants drawings.
9. RATIONAL FIRE Engineer: All materials and workmanship to be as specified on the Consultants drawings.
10. WET SERVICES Engineer: All construction activities to conform to the OCCUPATIONAL HEALTH AND SAFETY ACT 1993 (Act No 95 of 1993).
11. HEALTH AND SAFETY ACT 1993 (Act No 95 of 1993).
12. COPYRIGHT: This drawing remains solely vested in FLUID SPACE DESIGN STUDIO in terms of COPYRIGHT ACT NO. 98 OF 1978, Amendment Act, no. 9 of 2002. Any reproduction in and to this drawing and the use of intellectual property contained herewith is an infringement of the act.

No.	Description	Date

fluidspace
DESIGN STUDIO

99 Conrad Drive,
Blairgowrie, 2194

Tel: 084 832 1115
retha@fluidspace.co.za

CLIENT

necsa
We're in your world

PROJECT TITLE

P1000 REFURBISHMENT

Elias Motsoaledi St,
Hartbeespoort, 0216,
South Africa

CLIENT

NECSA SOC Ltd

Author	Checker	REG. #
DRAWN BY	CHECKED BY	

DRAWING TITLE

JOINERY DETAILS

ISSUED FOR	SCALE	FORMAT
FOR TENDER	As indicated	A1

DRAWING CODE	INT056	W602
ISSUE DATE	PROJECT	DRAWING NUMBER
08/11/25		
ISSUE DATE	PROJECT	DRAWING NUMBER
		REV

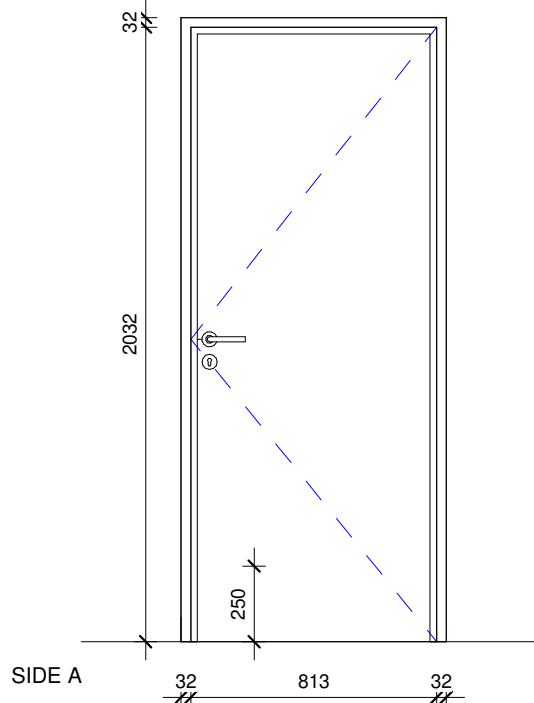

SIDE B

D01

1 : 25

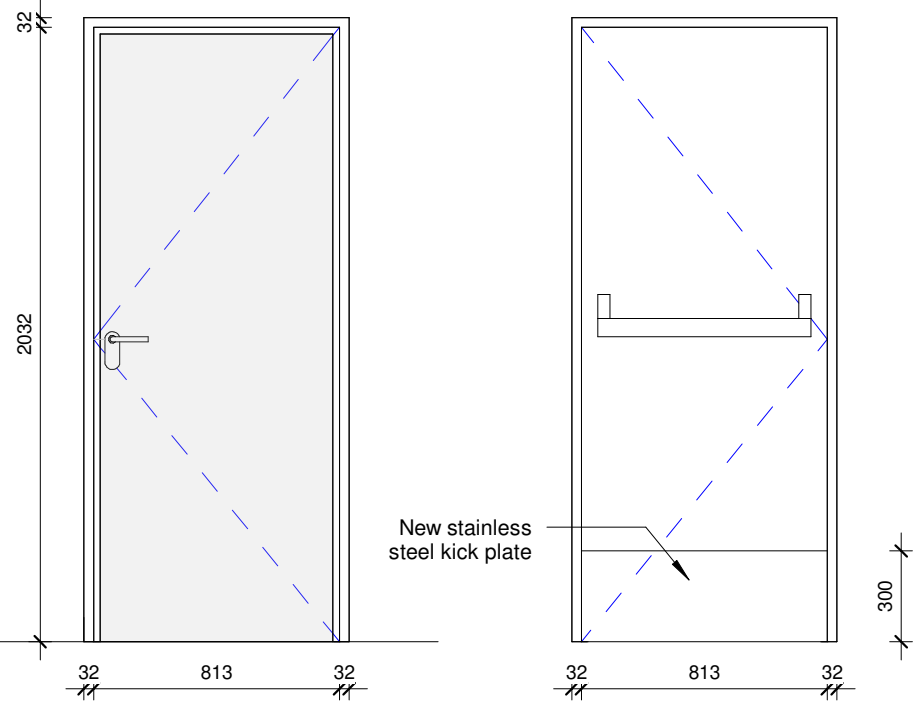

EXTERIOR

INTERIOR

FD01

1 : 25

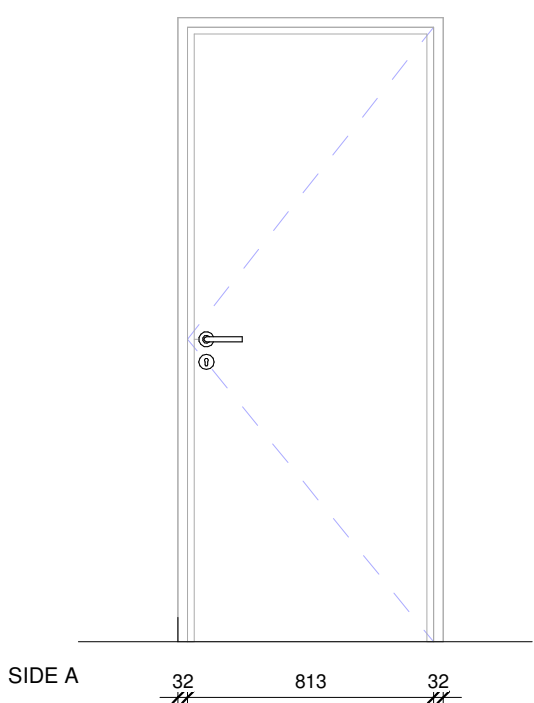

SIDE B

ED02

1 : 25

D01						
HEIGHT	WIDTH	FRAME DESCRIPTION	FRAME FINISH	PANEL DESCRIPTION	PANEL FINISH	IRONMONGERY
2032	813	76mm or 90mm Thick Aluminium Frame For Drywall	Painted, as per Finishing Schedule	Flush panel solid core timber door, masonite	Painted, as per Finishing Schedule	Black Series - Bontebok Black Lever Handle on Rose, Matte Black finish (UNION - 6272-05SSBLK) Black Series Euro Profile Single Cylinder, grand master keyed, Matte Black finish (UNION-2X20BL) Black Series Euro profile Round Escutcheon, Matte Black finish (UNION-SS5305-05SSBLK)

FD01						
HEIGHT	WIDTH	FRAME DESCRIPTION	FRAME FINISH	PANEL DESCRIPTION	PANEL FINISH	IRONMONGERY
2032	813	Pressed mild steel single rebated frame 1.6mm thick, with one shop coat red oxide. To suit left / right hand as per plan, for wall width as per plan.	Painted, as per Finishing Schedule	30 Minute fire rated flush panel solid core timber door, masonite.	Painted, as per Finishing Schedule. Cladded with galvanized metal sheeting to exterior and full surround channel to edges	S/S emergency exit push bar with vertical bolts for single door S/S emergency exit outside access device with single euro profile cylinder S/S EN1154 fire rated door closer All to designer's approval

ED02						
HEIGHT	WIDTH	FRAME DESCRIPTION	FRAME FINISH	PANEL DESCRIPTION	PANEL FINISH	IRONMONGERY
2032	813	Re-use existing frame	Painted, as per Finishing Schedule	Re-use existing door panel	Painted, as per Finishing Schedule	Black Series - Bontebok Black Lever Handle on Rose, Matte Black finish (UNION - 6272-05SSBLK) Black Series Euro Profile Double Cylinder, grand master keyed, Matte Black finish (UNION-2X18BL) Black Series Euro profile Round Escutcheon, Matte Black finish (UNION-SS5305-05SSBLK)

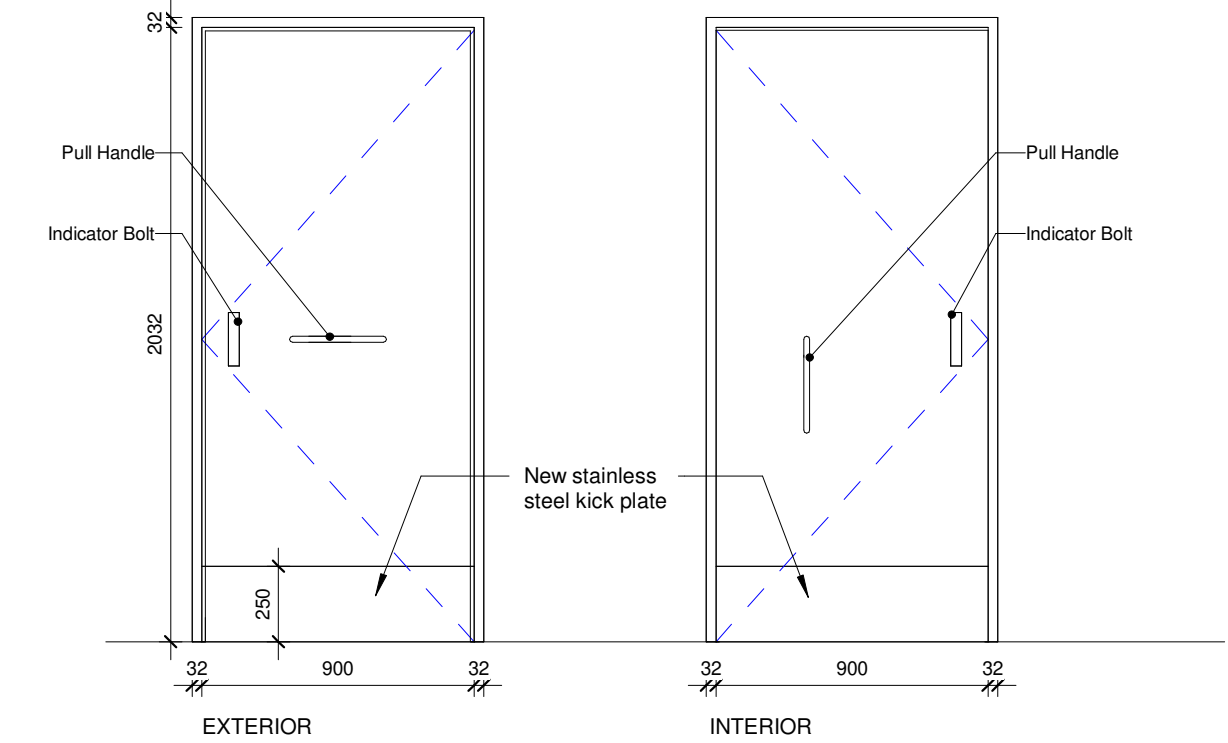

D01-P

1 : 25

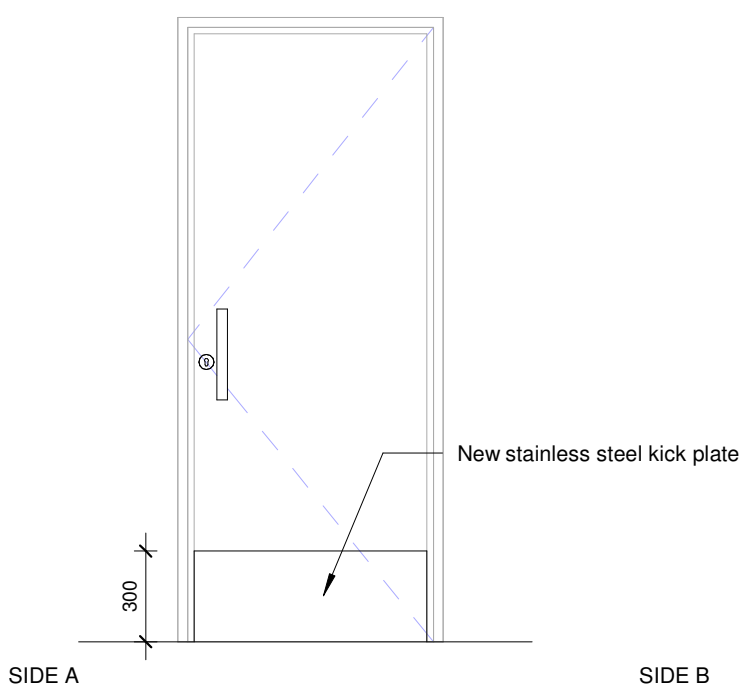

SIDE B

ED01

1 : 25

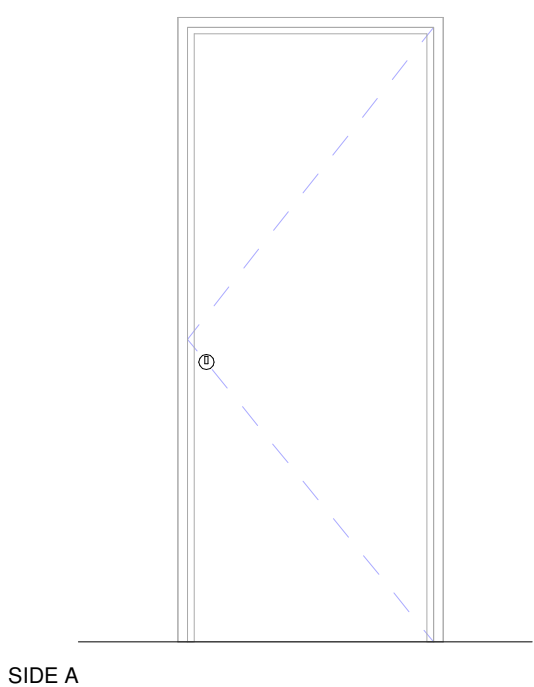

SIDE B

ED03

1 : 25

D01-P						
HEIGHT	WIDTH	FRAME DESCRIPTION	FRAME FINISH	PANEL DESCRIPTION	PANEL FINISH	IRONMONGERY
2032	900	Pressed mild steel single rebated frame 1.6mm thick, with one shop coat red oxide. To suit left / right hand as per plan, for wall width as per plan.	Painted, as per Finishing Schedule	Flush panel solid core timber door, masonite	Painted, as per Finishing Schedule	Black Series 350mm Pull Handle, back-to-back, Matte Black finish (UNION-5206BSSBLK) Black Series Euro Profile Single Cylinder, grand master keyed, Matte Black finish (UNION-2X20BL) Black Series Euro profile Round Escutcheon, Matte Black finish (UNION-SS5305-05SSBLK) Black rack and pinion door closer with guide rail (ASSA ABLOY-DC135BLK)

ED01						
HEIGHT	WIDTH	FRAME DESCRIPTION	FRAME FINISH	PANEL DESCRIPTION	PANEL FINISH	IRONMONGERY
2032	813	Re-use existing frame	Painted, as per Finishing Schedule	Re-use existing door panel	Painted, as per Finishing Schedule	Black Series 350mm Pull Handle, back-to-back, Matte Black finish (UNION-5206BSSBLK) Black Series Euro Profile Single Cylinder, grand master keyed, Matte Black finish (UNION-2X20BL) Black Series Euro profile Round Escutcheon, Matte Black finish (UNION-SS5305-05SSBLK) Black rack and pinion door closer with guide rail (ASSA ABLOY-DC135BLK)

ED03						
HEIGHT	WIDTH	FRAME DESCRIPTION	FRAME FINISH	PANEL DESCRIPTION	PANEL FINISH	IRONMONGERY
2032	813	Re-use existing frame	Painted, as per Finishing Schedule	Re-use existing door panel	Painted, as per Finishing Schedule	Bathroom Escutcheon, stainless steel finish (SS5305-73 W/C)

GENERAL CONSTRUCTION NOTES:

- This drawing is not to be scaled, all figured dimensions to be used.
- All dimensions, heights, and angles to be checked and verified before any work commences on site or in contractors workshop and any discrepancies must be reported to the Designer immediately.
- All work is to comply with the **NATIONAL BUILDING REGULATIONS (NBRI) AND BUILDING STANDARDS** act 103 of 1977 as amended and all relevant specifications and codes of practice of the **SOUTH AFRICAN BUREAU OF STANDARDS (SABS) SOUTH AFRICAN NATIONAL STANDARDS (SANS)** and amendments thereto.
- All materials and workmanship to be as per the **MODEL PREAMBLES FOR TRADES 2008**, and further additional premises as noted in the Bill of Materials.
- Any errors, discrepancies, omissions or queries arising from this documentation to be reported to the Designer immediately, for clarification before such work is put in hand.
- ELECTRICAL Engineer:** All materials and workmanship to be as specified on the Consultants drawings.
- STRUCTURAL Engineer:** All materials and workmanship to be as specified on the Consultants drawings.
- HVAC Engineer:** All materials and workmanship to be as specified on the Consultants drawings.
- RATIONAL FIRE Engineer:** All materials and workmanship to be as specified on the Consultants drawings.
- WET SERVICES Engineer:** All materials and workmanship to be as specified on the Consultants drawings.
- HEALTH AND SAFETY:** All construction activities to conform to the **OCCUPATIONAL HEALTH AND SAFETY ACT 1993 (Act No 85 of 1993)**.
- COPYRIGHT:** This drawing remains solely vested in **FLUID SPACE DESIGN STUDIO** in terms of **COPYRIGHT ACT NO. 98 OF 1978, Amendment Act, no. 9 of 2002**. Any reproduction in and to this drawing and the use of intellectual property contained herewith is an infringement of the act.

No.	Description	Date

FLUIDspace
DESIGN STUDIO

99 Conrad Drive,
Blairgowrie, 2194

Tel: 084 832 1115
retha@fluidspacea.com

CLIENT

necsa
We're in your world

PROJECT TITLE
P1000 REFURBISHMENT

Elias Motsoaledi St,
Hartbeespoort, 0216,
South Africa

CLIENT
NECSA SOC Ltd

DRAWN BY	CHECKED BY	REG. #
----------	------------	--------

DRAWING TITLE

DOOR SCHEDULE

ISSUED FOR FOR TENDER	SCALE 1 : 25	FORMAT A1
---------------------------------	------------------------	---------------------

DRAWING CODE

09/27/16	INT056	W800
----------	--------	------

ISSUE DATE	PROJECT	DRAWING NUMBER	REV
------------	---------	----------------	-----

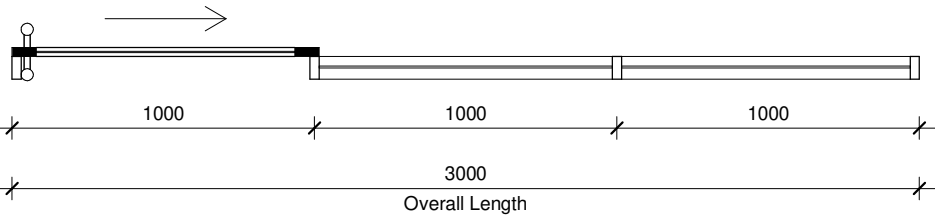

W810_SF01 - PLAN
1 : 25

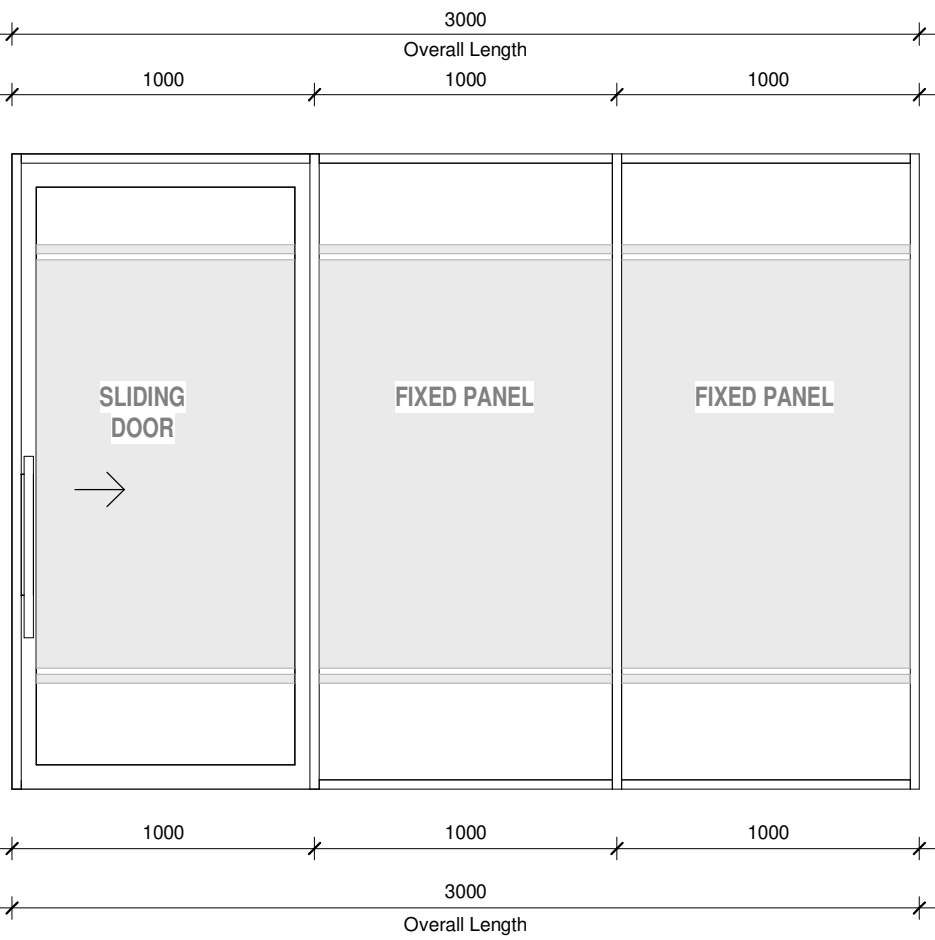

W810_SF01 - ELEVATION
1 : 25

LENGTH	HEIGHT	FRAME DESCRIPTION	FRAME FINISH	GLASS DESCRIPTION	DOOR/WINDOW	NO.
3000	2100	Clip44 Aluminium shopfront system	Powdercoated black	8.76mm *PG Smart Glass - Soundprufe* clear acoustic glass	Sliding door – frame and glass to match shopfront. Ironmongery: Euro Cylinder Hook Lock (QH50X85MM-SS) Black Series Euro Profile Double Cylinder, grand master keyed, Matte Black finish (UNION-2X18BL) Black Series Euro profile Round Escutcheon, Matte Black finish (UNION-SS5305-05SSBLK) Black Series 350mm Pull Handle, back to back, Matte Black finish (UNION-S209BSSBLK)	1

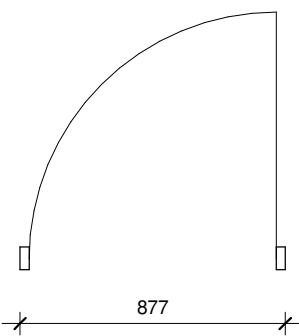

W810_SFD1 - PLAN
1 : 25

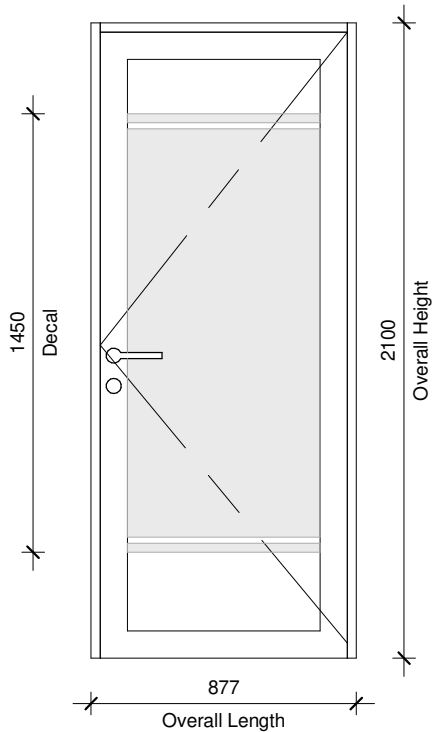

W810_SFD1 - ELEVATION
1 : 25

LENGTH	HEIGHT	FRAME DESCRIPTION	FRAME FINISH	GLASS DESCRIPTION	DOOR/WINDOW	NO.
877	2100	Clip44 Aluminium shopfront system	Powdercoated black	6.38mm Clear laminated safety glass	Single hinged door - frame and glass to match shopfront. Ironmongery: Bontebok Black Lever Handle on Rose, Matte Black finish (UNION - 6272-06SSBLK) Euro Spring Cylinder Latch and Dead Lock, s/s finish (UNION-Q60X85MM-SS) Black Series Euro Profile Double Cylinder, grand master keyed, Matte Black finish (UNION-2X18BL) Black Series Euro profile Round Escutcheon, Matte Black finish (UNION-SS5305-05SSBLK)	11

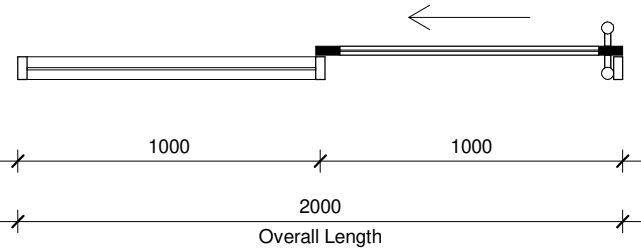

W810_SFD3 - PLAN
1 : 25

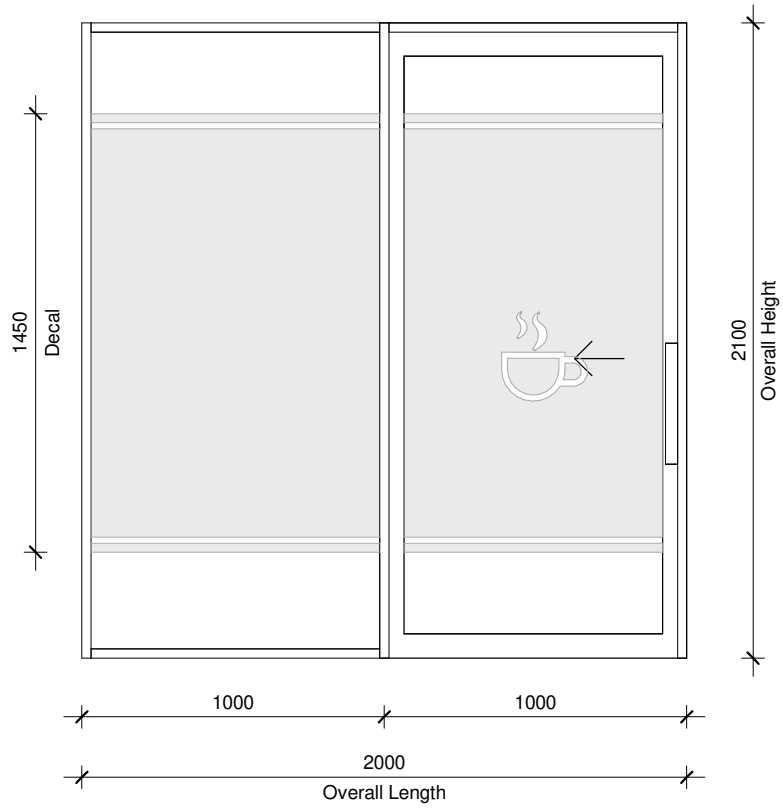

W810_SFD3 - ELEVATION
1 : 25

LENGTH	HEIGHT	FRAME DESCRIPTION	FRAME FINISH	GLASS DESCRIPTION	DOOR/WINDOW	NO.
2000	2100	CLASS B (120 min.) Double hinged FIRE door Steel frame - as per manufacturer spec.	Powdercoated black	8mm Clear toughened Pyran glass	Sliding door – frame and glass to match shopfront. Ironmongery: Euro Cylinder Hook Lock (QH50X85MM-SS) Black Series Euro Profile Double Cylinder, grand master keyed, Matte Black finish (UNION-2X18BL) Black Series Euro profile Round Escutcheon, Matte Black finish (UNION-SS5305-05SSBLK) Black Series 350mm Pull Handle, back to back, Matte Black finish (UNION-S209BSSBLK)	1

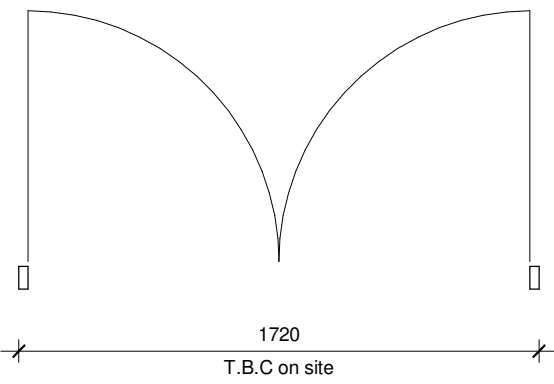

W810_SFD5 - PLAN
1 : 25

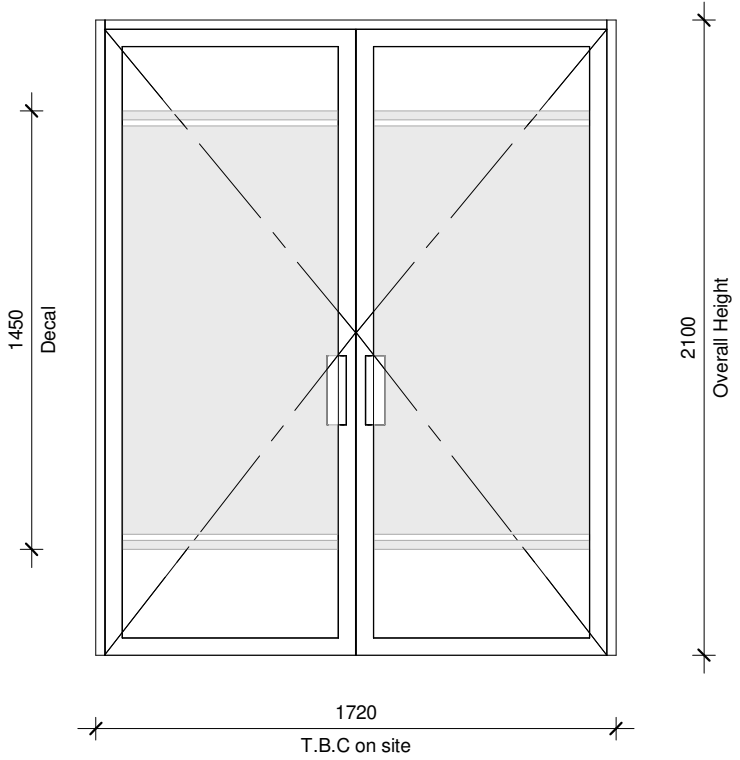

W810_SFD5 - ELEVATION
1 : 25

LENGTH	HEIGHT	FRAME DESCRIPTION	FRAME FINISH	GLASS DESCRIPTION	DOOR/WINDOW	NO.
1720	2100	Clip44 Aluminium shopfront system	Powdercoated black	6.38mm Clear laminated safety glass	Double hinged doors - frame and glass to match shopfront. Ironmongery: Bontebok Black Lever Handle on Rose, Matte Black finish (UNION - 6272-06SSBLK) Euro Spring Cylinder Latch and Dead Lock, s/s finish (UNION-Q60X85MM-SS) Black Series Euro Profile Double Cylinder, grand master keyed, Matte Black finish (UNION-2X18BL) Black Series Euro profile Round Escutcheon, Matte Black finish (UNION-SS5305-05SSBLK)	1

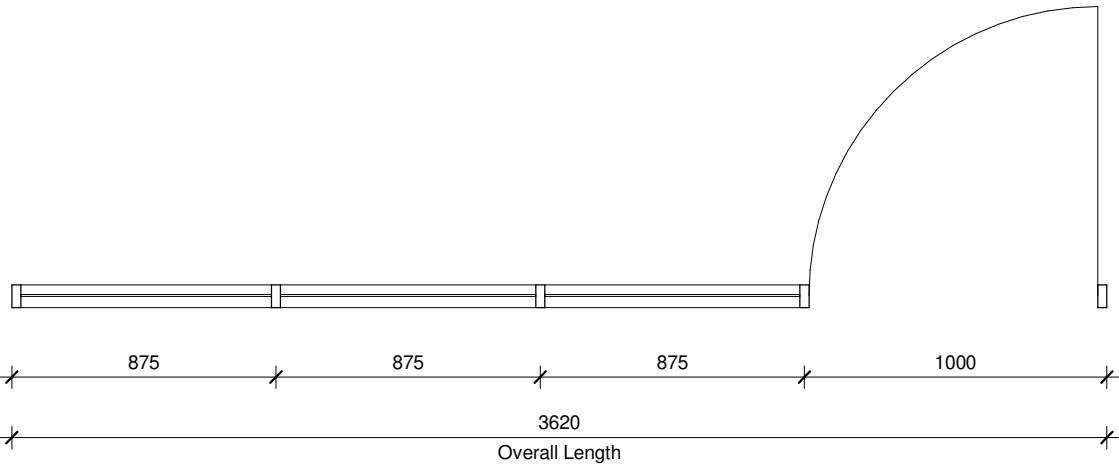

W810_SF02 - PLAN
1 : 25

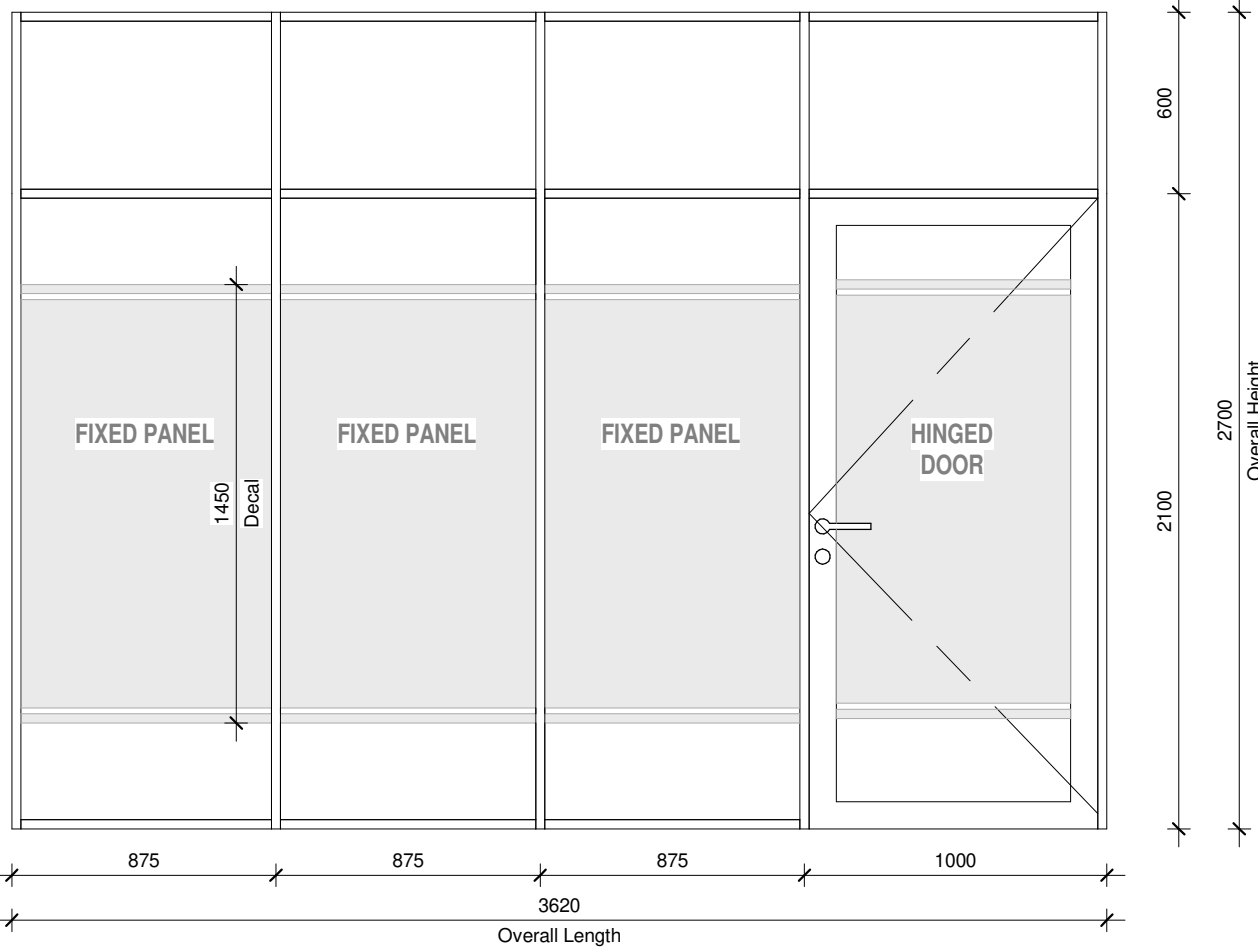

W810_SF02 - ELEVATION
1 : 25

LENGTH	HEIGHT	FRAME DESCRIPTION	FRAME FINISH	GLASS DESCRIPTION	DOOR/WINDOW	NO.
3621	2700	Clip44 Aluminium shopfront system	Powdercoated black	6.38mm Clear laminated safety glass	Single hinged door - frame and glass to match shopfront. Ironmongery: Bontebok Black Lever Handle on Rose, Matte Black finish (UNION - 6272-06SSBLK) Euro Spring Cylinder Latch and Dead Lock, s/s finish (UNION-Q60X85MM-SS) Black Series Euro Profile Single Cylinder, grand master keyed, Matte Black finish (UNION-2X18BL) Black Series Euro profile Round Escutcheon, Matte Black finish (UNION-SS5305-05SSBLK)	1

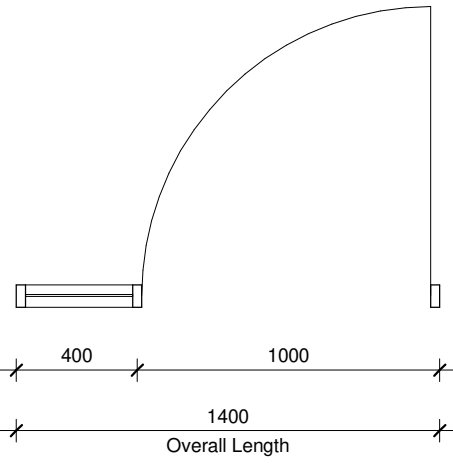

W810_SFD2 - PLAN
1 : 25

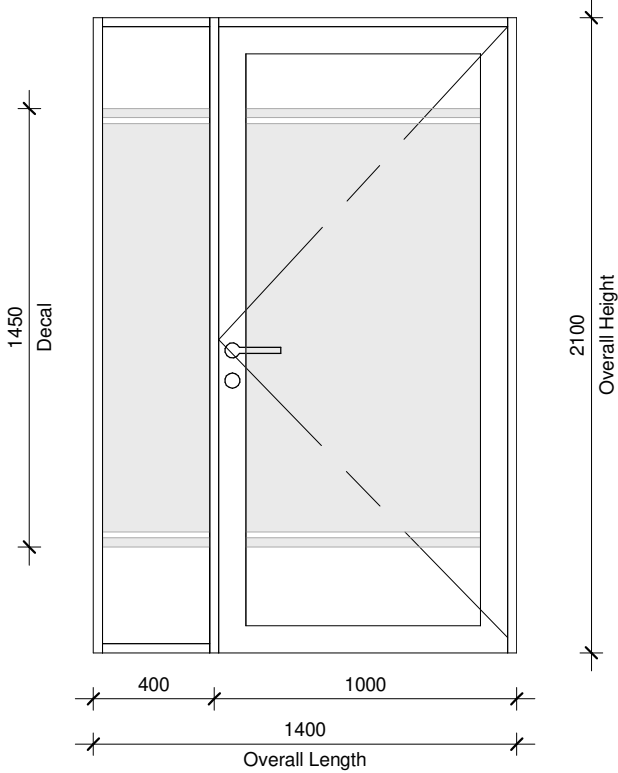

W810_SFD2 - ELEVATION
1 : 25

LENGTH	HEIGHT	FRAME DESCRIPTION	FRAME FINISH	GLASS DESCRIPTION	DOOR/WINDOW	NO.
1400	2100	Clip44 Aluminium shopfront system	Powdercoated black	6.38mm Clear laminated safety glass	Single hinged door - frame and glass to match shopfront. Ironmongery: Bontebok Black Lever Handle on Rose, Matte Black finish (UNION - 6272-06SSBLK) Euro Spring Cylinder Latch and Dead Lock, s/s finish (UNION-Q60X85MM-SS) Black Series Euro Profile Double Cylinder, grand master keyed, Matte Black finish (UNION-2X18BL) Black Series Euro profile Round Escutcheon, Matte Black finish (UNION-SS5305-05SSBLK)	1

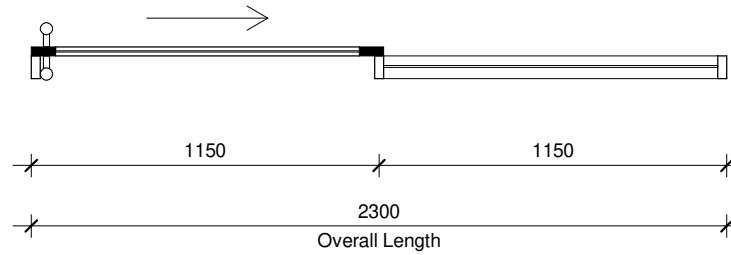

W810_SFD4 - PLAN
1 : 25

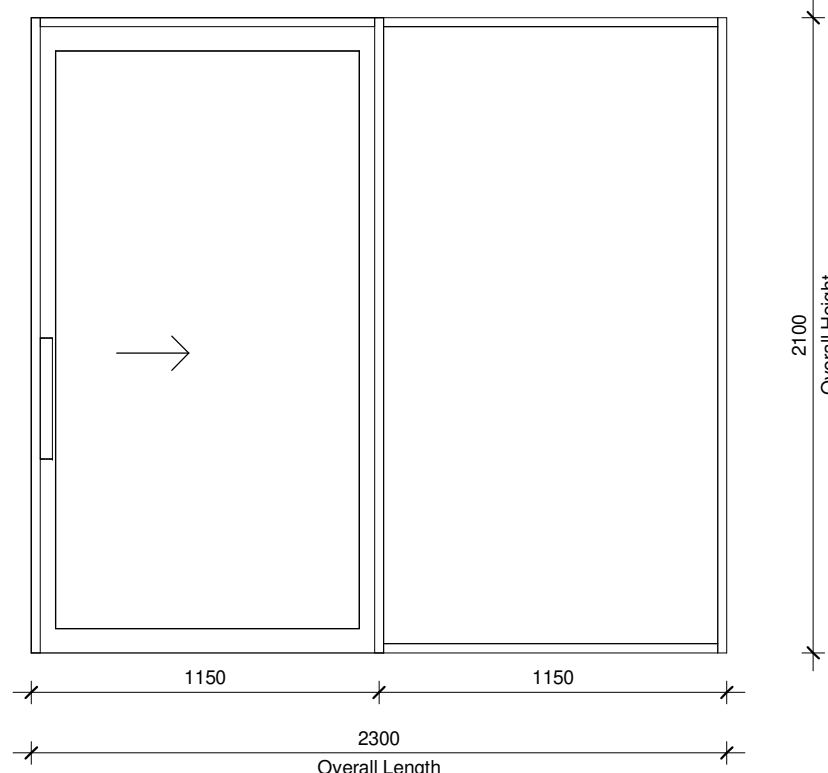

W810_SFD4 - ELEVATION
1 : 25

LENGTH	HEIGHT	FRAME DESCRIPTION	FRAME FINISH	GLASS DESCRIPTION	DOOR/WINDOW	NO.
2300	2100	Clip44 Aluminium shopfront system	Powdercoated black	6.38mm Clear laminated safety glass	Sliding door – frame and glass to match shopfront. Ironmongery: Euro Cylinder Hook Lock (QH50X85MM-SS) Black Series Euro Profile Double Cylinder, grand master keyed, Matte Black finish (UNION-2X18BL) Black Series Euro profile Round Escutcheon, Matte Black finish (UNION-SS5305-05SSBLK) Black Series 350mm Pull Handle, back to back, Matte Black finish (UNION-S209BSSBLK)	2

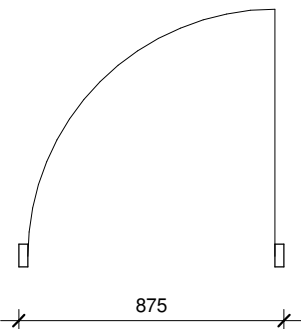

W810_SFD6 - PLAN
1 : 25

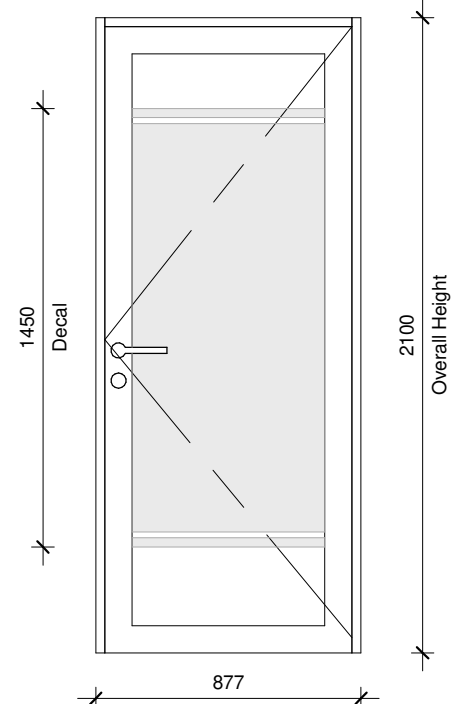

W810_SFD6 - ELEVATION
1 : 25

LENGTH	HEIGHT	FRAME DESCRIPTION	FRAME FINISH	GLASS DESCRIPTION	DOOR/WINDOW	NO.
877	2100	Clip44 Aluminium shopfront system	Powdercoated black	8.76mm *PG Smart Glass - Soundprufe* clear acoustic glass	Single hinged door - frame and glass to match shopfront. Ironmongery: Bontebok Black Lever Handle on Rose, Matte Black finish (UNION - 6272-06SSBLK) Euro Spring Cylinder Latch and Dead Lock, s/s finish (UNION-Q60X85MM-SS) Black Series Euro Profile Double Cylinder, grand master keyed, Matte Black finish (UNION-2X18BL) Black Series Euro profile Round Escutcheon, Matte Black finish (UNION-SS5305-05SSBLK)	1

GENERAL CONSTRUCTION NOTES:

- This drawing is not to be scaled, all figured dimensions to be used.
- All dimensions, heights, and angles to be checked and verified before any work commences on site or in contractors workshop and any discrepancies must be reported to the Designer immediately.
- All work is to comply with the **NATIONAL BUILDING REGULATIONS (NBR)** AND **BUILDING STANDARDS** act 103 of 1977 as amended and all relevant specifications and codes of practice of the **SOUTH AFRICAN BUREAU OF STANDARDS (SABS) SOUTH AFRICAN NATIONAL STANDARDS (SANS)** and amendments thereto.
- All materials and workmanship to be as per the **MODEL PREAMBLES FOR TRADES 2008**, and further additional premises as noted in the Bills of Materials.
- Any errors, discrepancies, omissions or queries arising from this documentation to be reported to the Designer immediately, for clarification before such work is put in hand.
- ELECTRICAL Engineer:** All materials and workmanship to be as specified on the Consultants drawings.
- STRUCTURAL Engineer:** All materials and workmanship to be as specified on the Consultants drawings.
- HVAC Engineer:** All materials and workmanship to be as specified on the Consultants drawings.
- RATIONAL FIRE Engineer:** All materials and workmanship to be as specified on the Consultants drawings.
- WET SERVICES Engineer:** All materials and workmanship to be as specified on the Consultants drawings.
- HEALTH AND SAFETY:** All construction activities to conform to the **OCCUPATIONAL HEALTH AND SAFETY ACT 1993 (Act No 85 of 1993)**.
- COPYRIGHT:** This drawing remains solely vested in **FLUID SPACE DESIGN STUDIO** in terms of **COPYRIGHT ACT NO. 98 OF 1978, Amendment Act, no. 9 of 2002**. Any reproduction in and to this drawing and the use of intellectual property contained herewith is an infringement of the act.

No.	Description	Date

fluidspace
DESIGN STUDIO

99 Conrad Drive,
Blairgowrie, 2194

Tel: 084 832 1115
retha@fluidspacea.com

CLIENT

necsa
We're in your world

PROJECT TITLE
P1000 REFURBISHMENT

Elias Motsoaledi St,
Hartbeespoort, 0216,
South Africa

CLIENT
NECSA SOC Ltd

Author	Checker	REG. #
DRAWN BY	CHECKED BY	

DRAWING TITLE

SHOPFRONT SCHEDULE

ISSUED FOR FOR TENDER	SCALE 1 : 25	FORMAT A1
DRAWING CODE 08/27/25	PROJECT INT056	DRAWING NUMBER W810
ISSUE DATE	PROJECT	DRAWING NUMBER
		REV