

SECTION A-A



1. Remove all burrs and sharp edges.
2. General tolerances $\pm 0.2\text{mm}$ U.O.S.
3. Dimensions in brackets(...) are for reference only

4. Machining $\frac{0.8}{\nabla}$ where indicated
(∇ casting finish otherwise)

Finish: Clean, ultrasonic and dye penetrant tested, test certificates to be provided

Material: BS 4360 GR 43A

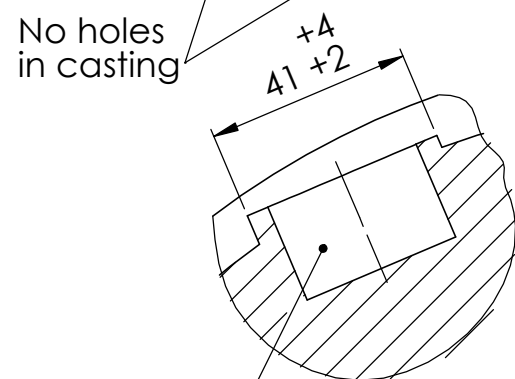

DETAIL G

FOR QUOTATION PURPOSE ONLY

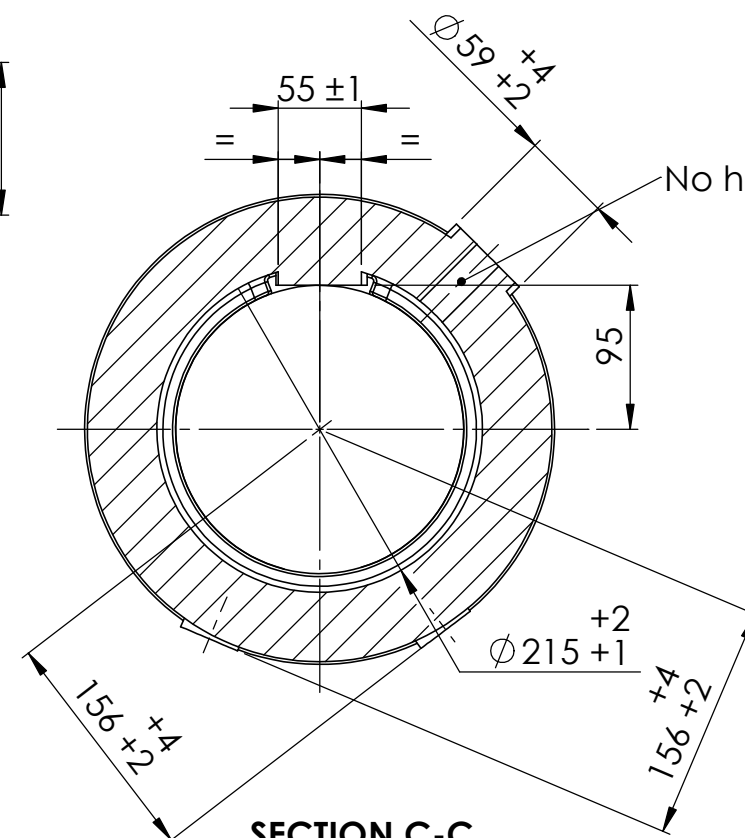

SECTION C-C

[illegible]

