

LAYOUT PLAN  
SCALE 1:500

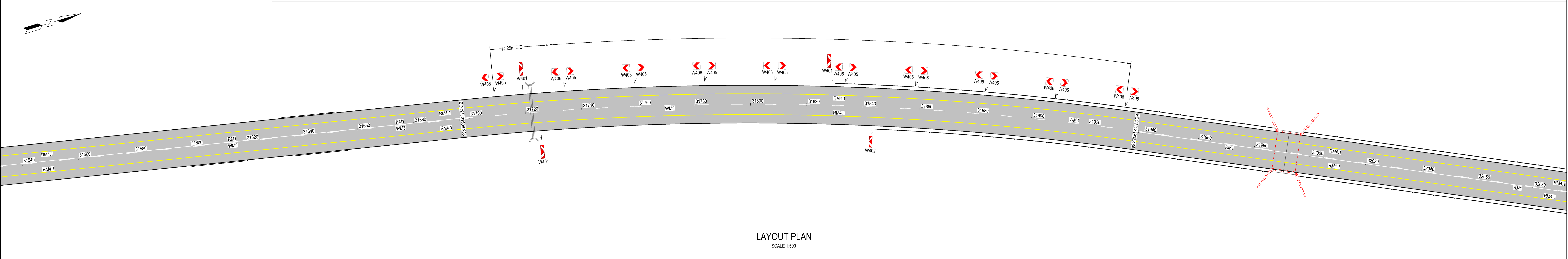

LAYOUT PLAN  
SCALE 1:500

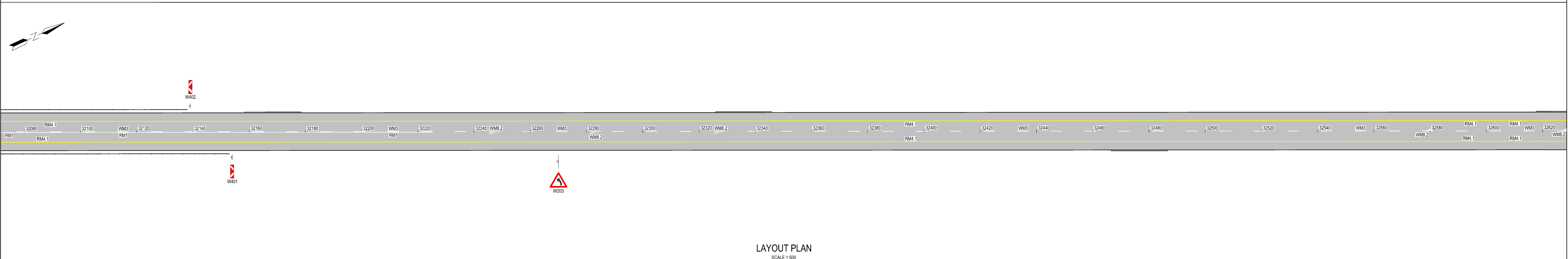

LAYOUT PLAN  
SCALE 1:500

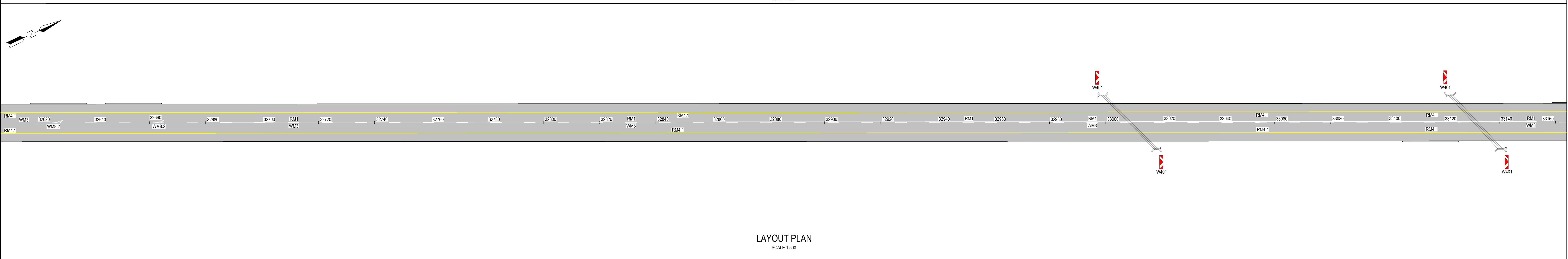

LAYOUT PLAN  
SCALE 1:500

				CONSTRUCTION RECORD (AS-BUILT)		<div>35A Piet Retief Street PO Box 802 Harrismith 9880 Tel: (058) 622 1297 Fax: 058 623 0827 E-mail: harrismith@ilifa.biz</div> <div><b>ilifa</b> AFRICA ENGINEERS</div>	<div>103 Maranata Ave Mossel Bay 6500 South Africa +27 44 690 4417 Mosselbaai@Quantra.co.za</div> <div><b>QUANTRA</b> CONSULTING SA Reg No: 2015/340071 / 07</div>	DESIGNED BY		<div>48 Tambotie Avenue Val de Grace Pretoria 0184 PO Box 415 Pretoria 0001 South Africa Tel: (012) 844 8000</div> <div><b>SANRAL</b> SOUTH AFRICAN NATIONAL ROADS AGENCY SOC. LTD. BUILDING SOUTH AFRICA THROUGH BETTER ROADS</div>	CONSULTANT APPROVAL		<div>38 Ida Street Menlo Park Pretoria 0081 Private Bag X17 Lynnwood Ridge 0040 Tel: (012) 426 6200</div> <div>NORTHERN REGION</div>	ACCEPTANCE		PROJECT DESCRIPTION		PROJECT NUMBER		R.052-030-2020/1			
		WORKS CONTRACT ENGINEER														DRAWING LOCATION DATA		START		END			
		Name: : J.J.OLIVIER																ROUTE		R 052		R 052	
		Prof. Reg. No. : 940253																SECTION		03N		03N	
		Date : JUNE 2021																DRAWING km DISTANCE		31020		33160	
		SANRAL PROJECT MANAGER																DRAWING TYPE		ROADS - ANCILLARY WORKS			
		Name: : J.J.OLIVIER												BRIDGE/STRUCTURE No.									
		Date: : JUNE 2021												CONSULTANT DRAWING No.		H17- 028-00-RR-RM17		VER					
		SANRAL DOCUMENT #																V1					
		SCALE : 1:500												SHEET 17 OF 20									

V1	June 2021	ORIGINAL VERSION	J.J.OLIVIER
No.	DATE	REVISION	CONSULT. ENG.