

THIS DRAWING IS TO BE READ IN CONJUNCTION WITH:

- 2-01 GROUND FLOOR PLAN
2-02 FIRST FLOOR REFLECTED CEILING PLAN
2-03 SECOND FLOOR PLAN

- 3-01 SECTIONS A & B
3-02 SECTIONS C & D

- 4-01 ELEVATIONS

ALL RELEVANT STRUCTURAL, MECHANICAL,
ELECTRICAL, WET SERVICES, AND FIRE
CONSULTANTS DRAWINGS & SPECIFICATIONS.

NBR SANS 10400 NOTES & SPECIFICATIONS

FOUNDATIONS:
ALL WORK TO BE DESIGNED BY ENGINEER AND CONSTRUCTED IN
ACCORDANCE WITH SANS 10400 PART H.

STRUCTURAL DESIGN:
ALL WORK TO BE DESIGNED BY ENGINEER AND CONSTRUCTED IN
ACCORDANCE WITH
SANS 10400 PART B.

DIMENSIONS:
ALL WORK TO BE DESIGNED AND CONSTRUCTED IN ACCORDANCE
WITH SANS 10400 PART C.

PUBLIC SAFETY:
ALL WORK TO BE DESIGNED AND CONSTRUCTED IN ACCORDANCE
WITH SANS 10400 PART D.

SITE OPERATIONS:
ALL WORK TO BE DESIGNED AND CONSTRUCTED IN ACCORDANCE
WITH SANS 10400 PART F.

EXCAVATIONS:
ALL WORK TO BE DESIGNED AND CONSTRUCTED IN ACCORDANCE
WITH SANS 10400 PART G.

FOUNDATIONS:
ALL WORK TO BE DESIGNED BY ENGINEER AND CONSTRUCTED IN
ACCORDANCE WITH
SANS 10400 PART H.

FLOORS:
ALL WORK TO BE DESIGNED BY ENGINEER AND CONSTRUCTED IN
ACCORDANCE WITH
SANS 10400 PART J.

TILED FLOOR PERFORMANCE SPECIFICATION:
FULLY VITRIFIED PORCELAIN TILES IN ACCORDANCE WITH ISO
13006 TO HAVE SUITABLE PROPERTIES AND CHARACTERISTICS
COMPLIANT WITH EN 14411 AND EN ISO 10545 FOR THE TILE
GROUP 1A (DRY PRESSED) OR 1A1 (EXTRUDED).
SLIP RESISTANCE: PENDULUM TEST VALUE (PTV) TO EN 7932:
PUBLIC MALL AREAS: 25-35 MODERATE (DRY CONDITIONS)
ABRASION RESISTANCE CLASS TO SANS 13006 AND PORCELAIN
ENAMEL INSTITUTE (PEI) RETAIL: SANS 13006 CLASS 5 AND PEI 5
REQUIRED MARKING ON TILE AND PACKAGING:
- COUNTRY OF ORIGIN
- CLASS OF RESISTANCE OF GLAZED TILES TO ACIDS AND ALKALIS
- TILE HARDNESS
- SURFACE ABRASION RESISTANCE
- TILE DIMENSIONS

WALLS:
ALL WORK TO BE DESIGNED BY ENGINEER AND CONSTRUCTED IN
ACCORDANCE WITH
SANS 10400 PART K.
ALL WALLS TO ACHIEVE ACOUSTIC RATING BETWEEN 45dBA -
55dBA IN ACCORDANCE WITH SANS 10103.

STAIRWAYS:
ALL WORK TO BE DESIGNED AND CONSTRUCTED IN ACCORDANCE
WITH SANS 10400 PART M & S.

GLAZING:
THIS DRAWING INDICATES DESIGN INTENT FOR THE PROPOSED
ALUMINIUM SHOPFRONT INSTALLATION AND MUST BE READ IN
CONJUNCTION WITH THE GLAZING AND ALUMINIUM
PERFORMANCE SPECIFICATION AND INDEMNITY FORM.
THE SUBCONTRACTORS DESIGN PROPOSAL SHALL EQUAL OR
BETTER THE DESIGN, FUNCTION, SIZING AND MATERIAL
STANDARDS AS SHOWN ON THE DRAWINGS AND SPECIFIED
HEREIN. IN ACCORDANCE WITH SANS 10400 PART N AND ALL SUB
REGULATIONS CONTAINED THEREIN AND AAMSA
ON AESTHETIC DESIGN MATTERS, THE DECISION OF THE
ARCHITECT WILL BE FINAL.
DESIGN PROPOSAL SUBMISSIONS WHICH FOLLOW EXACTLY THE
DETAILS INDICATED ON THE DRAWINGS, SHALL NOT RELIEVE THE
SUBCONTRACTOR OF HIS RESPONSIBILITY FOR THE DESIGN,
FABRICATION, ERECTION, OR PERFORMANCE OF THIS WORK.
SHOP DRAWINGS BY SPECIALIST TO BE APPROVED BY ARCHITECT
PRIOR TO MANUFACTURE.
SHOPFRONTS TO ACHIEVE ACOUSTIC RATING BETWEEN 45dBA -
55dBA IN ACCORDANCE WITH SANS 10103.
IN ACCORDANCE WITH SANS 10400 PART N 4.4, ALL GLAZING
EXCEEDING 1m² IN SIZE OR LESS THAN 500mm ABOVE FFL TO BE
SABS SAFETY GLASS & TO COMPLY WITH SANS 1263-1.
LIGHTING AND VENTILATION:
ALL WORK TO BE DESIGNED AND CONSTRUCTED IN
ACCORDANCE WITH SANS 10400 PART O.

DRAINAGE:
ALL WORK TO BE DESIGNED BY ENGINEER AND CONSTRUCTED IN
ACCORDANCE WITH
SANS 10400 PART P.

FACILITIES FOR PERSONS WITH DISABILITIES:
ALL WORK TO BE DESIGNED AND CONSTRUCTED IN
ACCORDANCE WITH SANS 10400 PART S.

FIRE PROTECTION:
ALL WORK TO BE DESIGNED BY ENGINEER AND CONSTRUCTED IN
ACCORDANCE WITH
SANS 10400 PART T.

FIRE SPRINKLERS ON THIS LEVEL:
TO ENG'S DETAILS AND SPEC AND IN ACCORDANCE WITH
SANS10400 PART T.

FIRE INSTALLATION:
ALL WORK TO BE DESIGNED BY ENGINEER AND CONSTRUCTED IN
ACCORDANCE WITH
SANS 10400 PART W.

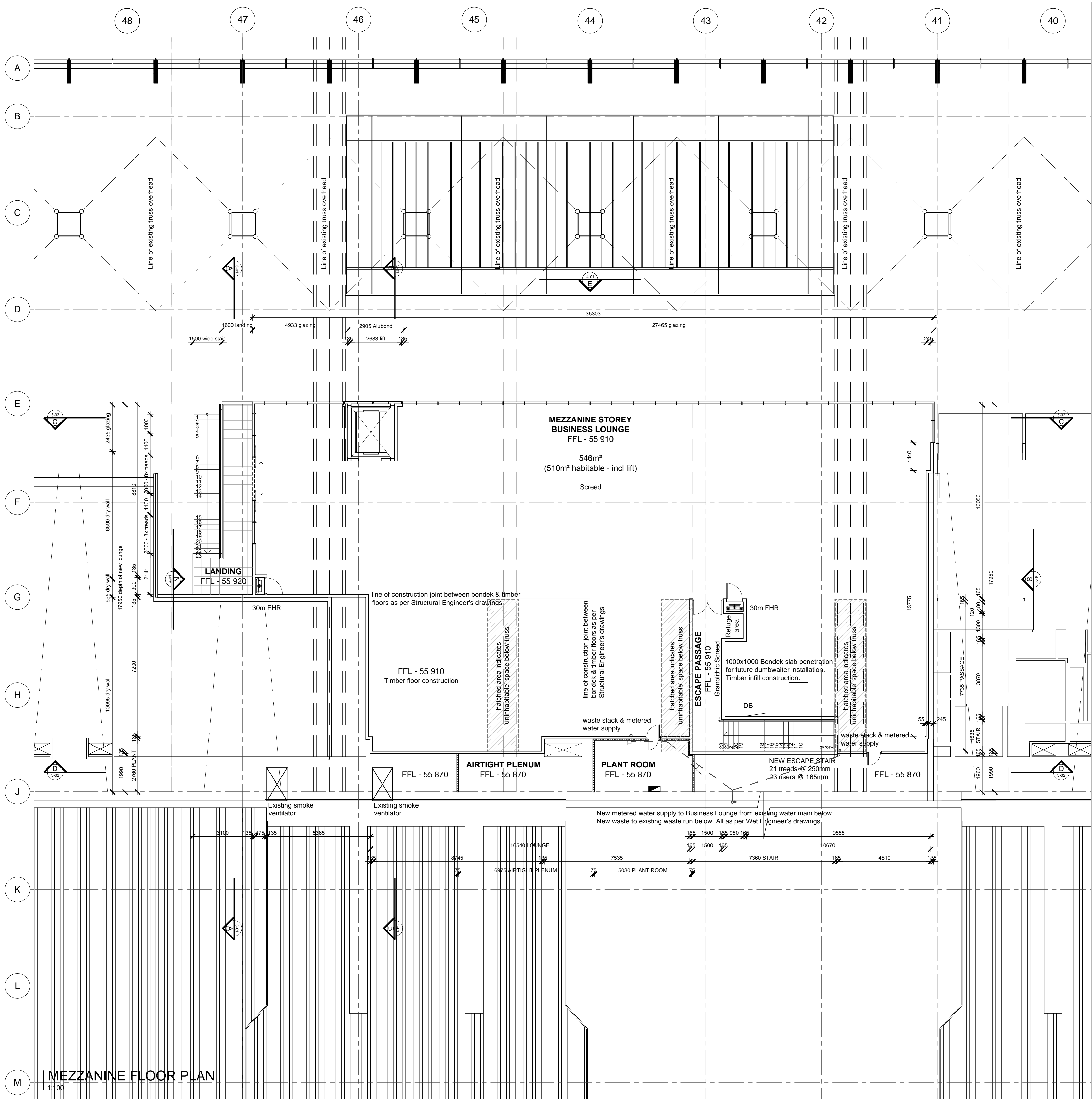

NOTES

CONTRACTORS MUST VERIFY ALL LEVELS AND DIMENSIONS ON SITE
BEFORE COMMENCING WORK OR MAKING ANY SHOP DRAWINGS. USE
WRITTEN DIMENSIONS IN PREFERENCE TO SCALED DIMENSIONS.
THIS DRAWING TO BE READ IN CONJUNCTION WITH ANY RELEVANT
CONSULTANTS DRAWINGS. ANY DISCREPANCIES AND OR ERRORS TO
BE REPORTED TO ARCHITECT.

REV NO.	DATE	ISSUED BY	REVISION NOTES
-	11.01.2019	LE	• AS-BUILT

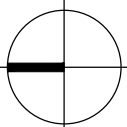
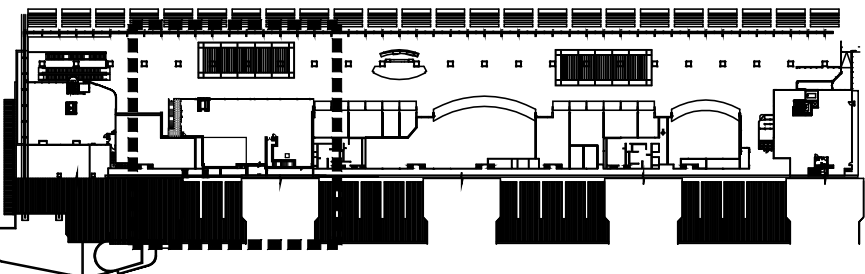

IDT MEZZANINE FLOOR KEY PLAN
1:2000

AS-BUILT

client



architect



architecture interior architecture space planning urban design town planning
116 Ross street Cape Town 8001 Tel 021 423 1411 Fax 021 425 1380 email blueprint@capeblueprint.co.za

workstage

WORKSTAGE 6

project name
CAPE TOWN INTERNATIONAL AIRPORT
INTERNATIONAL DEPARTURES TERMINAL
NEW CENTRAL BUSINESS LOUNGE

location
ERF 173970

drawing name
MEZZANINE FLOOR PLAN

project no.
0616-01

date	scale	drawn	checked	drwg no.	revision
11.01.2019	1:100 @ A1	LE	RSS	2-04	-