

## BENCH MARKS

NAME	Y	X	Z
TM726	-10948.545	265294.906	1474.494
TM727	-11022.074	265249.316	1480.820
TM728	-10920.018	265250.372	1479.400

## SCHOOL INFORMATION

SCHOOL NAME	TUTUWANA PRIMARY SCHOOL
GRS NUMBER	9222202
MANUAL DESIGN	CONSTRUCTION
SCHOOL LOCATION	LONGITUDE: 26°58'01" S LATITUDE: 28°14'06" E
TOTAL NUMBER OF LEARNERS ENROLLED 2022	222
TOTAL NUMBER OF EDUCATORS 2022	9

## SCHOOL ENROLMENT 2022

ENROLMENT NUMBERS		NUMBER OF LEARNERS ENROLLED BY GRADE												TOTAL
No. of learners 553 girls		G1	G2	G3	G4	G5	G6	G7	G8	G9	G10	G11	G12	
BOYS	21	22	22	19	20	9	6	21						172
GIRLS	20	21	21	25	30	16	5	21						180
TOTAL														222

EDUCATORS		TOTAL	
TEACH	03	TECHN	06
TOTAL		09	

POWERLINE	
FENCE	
BOREHOLE	
GATE	
STAY WIRE	
TREE	
BENCH MARK	
WATER TAP	
ELECTRIC POLE	
EXISTING ABULTION BLOCK	
PROPOSED NEW ABULTION BLOCK	
SCHEDULE INDICATING DEMOLITION AREAS	
1 X 18 SEATS TO BE DEMOLISHED IN THIS SCHOOL	
0 ENVIRO-LOO TOILET SEATS TO BE REFURISHED/RENOVATED	

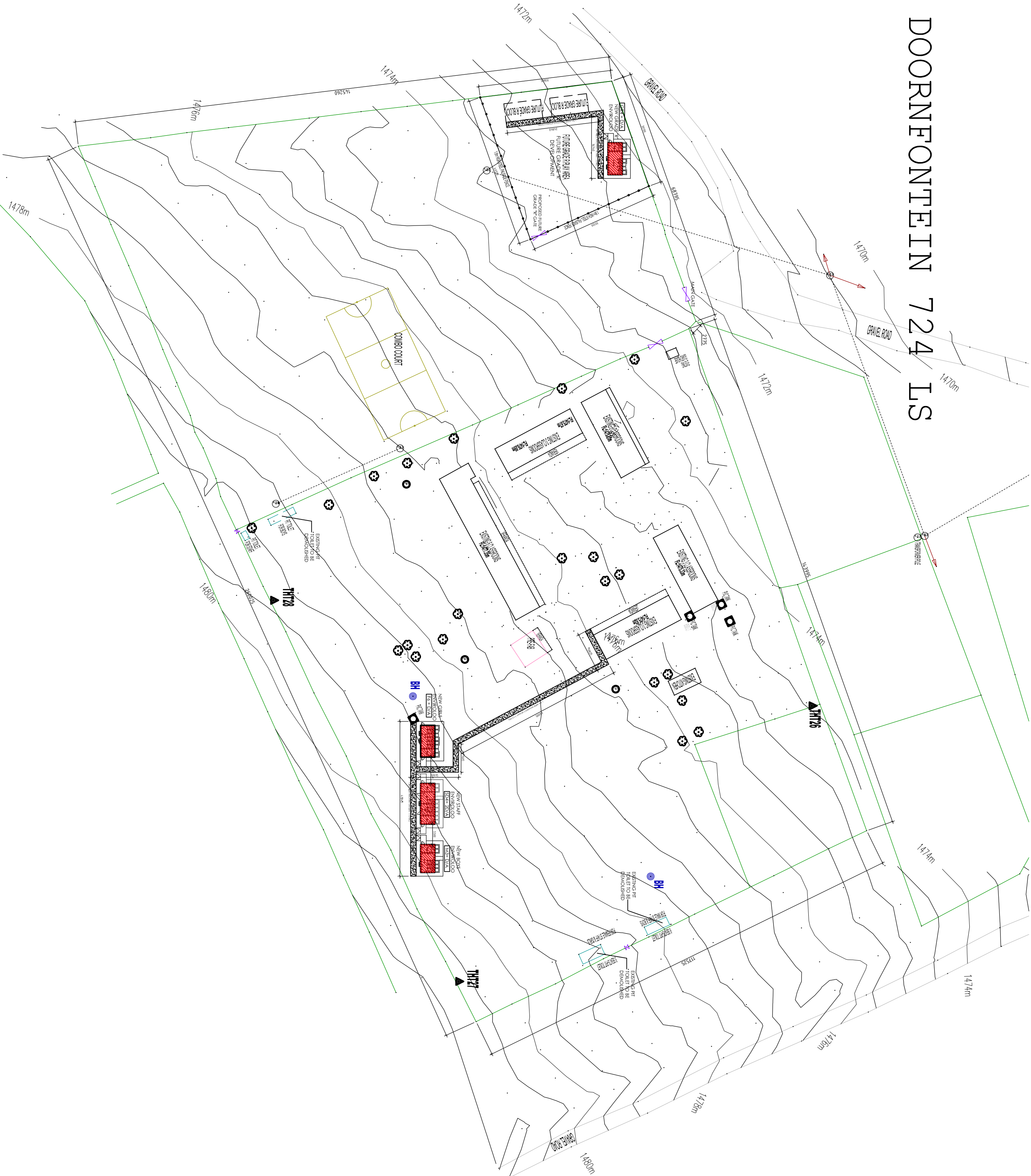
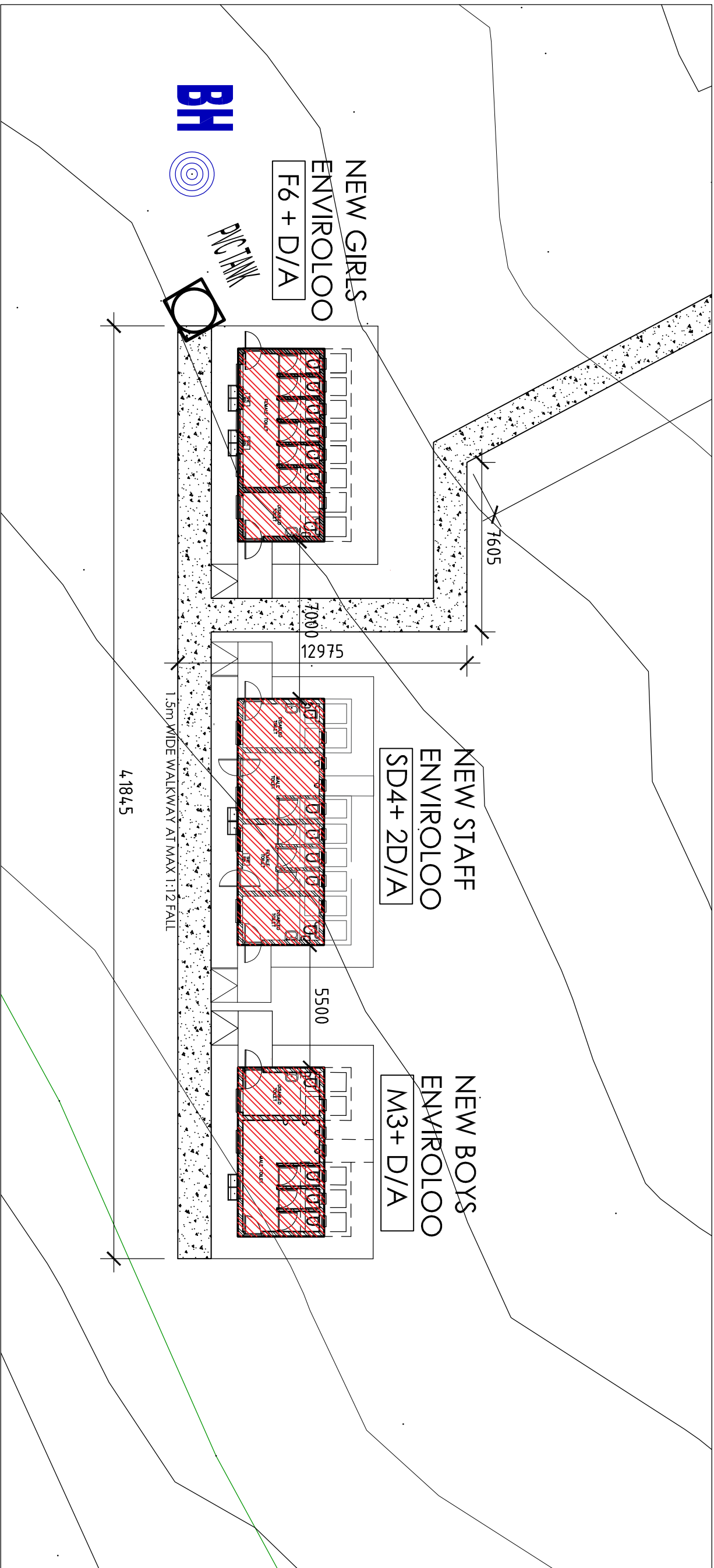

## THE FARM DOORNFONTEIN 724 LS

SDP SITE DEVELOPMENT PLAN  
Scale 1:1000

## GENERAL NOTES:

- \* ALL DIMENSIONS AND LEVELS ARE TO BE VERIFIED ON SITE PRIOR TO COMMENCING CONSTRUCTION.
- \* REQUIRED DIMENSIONS ONLY TO BE USED.
- \* DISCREPANCIES, ERRORS AND OMISSIONS ARE TO BE REPORTED TO ARCHITECTS IMMEDIATELY THEY BECOME EVIDENT.
- \* SHOP DRAWINGS TO BE SUBMITTED FOR APPROVAL PRIOR TO MANUFACTURE OR INSTALLATION.
- \* COPYRIGHT AND RIGHT OF REPRODUCTION OF THIS DRAWING OR ANY PORTION THEREOF IS RESERVED BY ARCHITECTS.

## Revisions During Construction

Rev #	Issue Date	Revision description	Sign
-------	------------	----------------------	------

## Revisions Prior to Construction

Rev #	Issue Date	Revision description	Sign
A	03.10.2022	Change in seat numbers	
B	11.07.2022	Change in seat numbers	

Issued for	Information	Order - Contract	Client Approval	Measurement	Municipal Approval
Design Symbols	Design Symbols	Design Symbols	Design Symbols	Design Symbols	Design Symbols



Tel: (015) 231 1005 | Fax: (086) 580 4404  
www.sdp.co.za



A leading developmental NGO

THE MVULA TRUST LIMPOPO

Client project number: CLUSTER 04

PROPOSED NEW WATER, SANITATION AND FENCING FOR THE MVULA TRUST  
TUTUWANA PRIMARY SCHOOL,  
GA-MATLAPA MASHASHANE,  
MAUNE CIRCUIT

EMIS NO.: 922221609

Project Architect:

Project Co-ordinator/Manager:

Project Architectural Technician:

## SITE DEVELOPMENT PLAN

Project number:	Drawing number:	Project Stage:	Drawing Revision:
-	SDP	Const	B
Scale:	Drawn:	Checked:	RM
AS SHOWN	TM	RM	
First 20/06/2022	2022/06/30	2022/11/07	