

PROPOSED CELL 1 LAYOUT

SCALE 1:1000

- EARTHWORKS NOTES:**
- 1.1 FINISHED BULK EARTHWORKS SHALL BE SMOOTH AND FREE FROM PROTRUSIONS THAT COULD PUNCTURE THE GEOMEMBRANE LINER. ALL EARTHWORKS SHALL BE APPROVED BY THE ENGINEER BEFORE ANY GEOSYNTHETICS ARE LAID.
 - 1.2 BASE PREPARATION SHALL INCLUDE SCARIFYING AND COMPACTING IN-SITU MATERIAL TO 93% OF MOD - AASHTO MAXIMUM DENSITY.
 - 1.3 UNLESS OTHERWISE SPECIFIED ELSEWHERE, ALL EMBANKMENT FILL MATERIAL SHALL BE SOIL MATERIAL CLASSIFYING AS G9 COMPACTED TO 93% OF MOD - AASHTO MAXIMUM DENSITY IN LAYERS NOT EXCEEDING 150mm THICK.
 - 1.4 ALL TYPE 2 GEOSYNTHETICS ANCHOR TRENCHES SHALL BE BACKFILLED AS SHOWN.
 - 1.5 ALL PROTECTION LAYERS ON TOP OF BERMS AND IN DRAINS SHALL BE STABILISED SAND.
- GEOSYNTHETICS NOTES:**
- 2.1 THE GEOMEMBRANE TO BE CLEAN AND DRY BEFORE SEAMING COMMENCES.
 - 2.2 TRIAL SEAM TO BE DONE BEFORE THE MAJOR WORKS COMMENCE TO CHECK THE CALIBRATION OF THE EQUIPMENT.

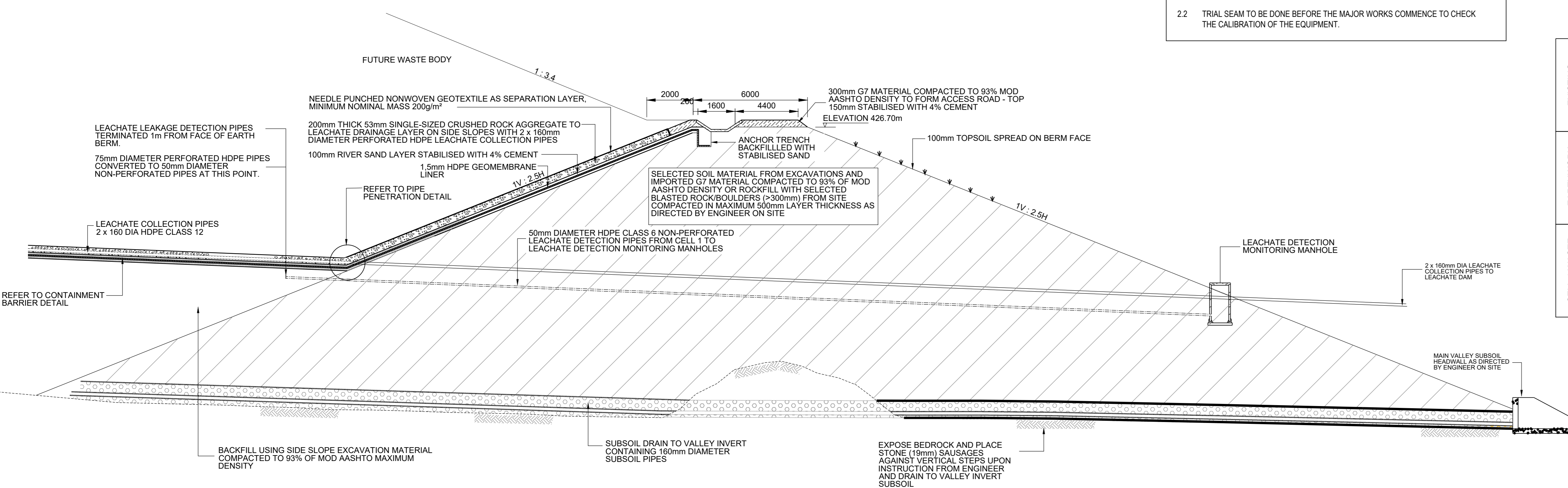

PROPOSED CELL 1: TYPICAL EARTH BERM AND PIPEWORK DETAILS

FOR PIPE, MANHOLE AND HEADWALL CONFIGURATION AND LAYOUT, REFER TO TYPICAL DETAILS DRAWINGS NOT TO SCALE

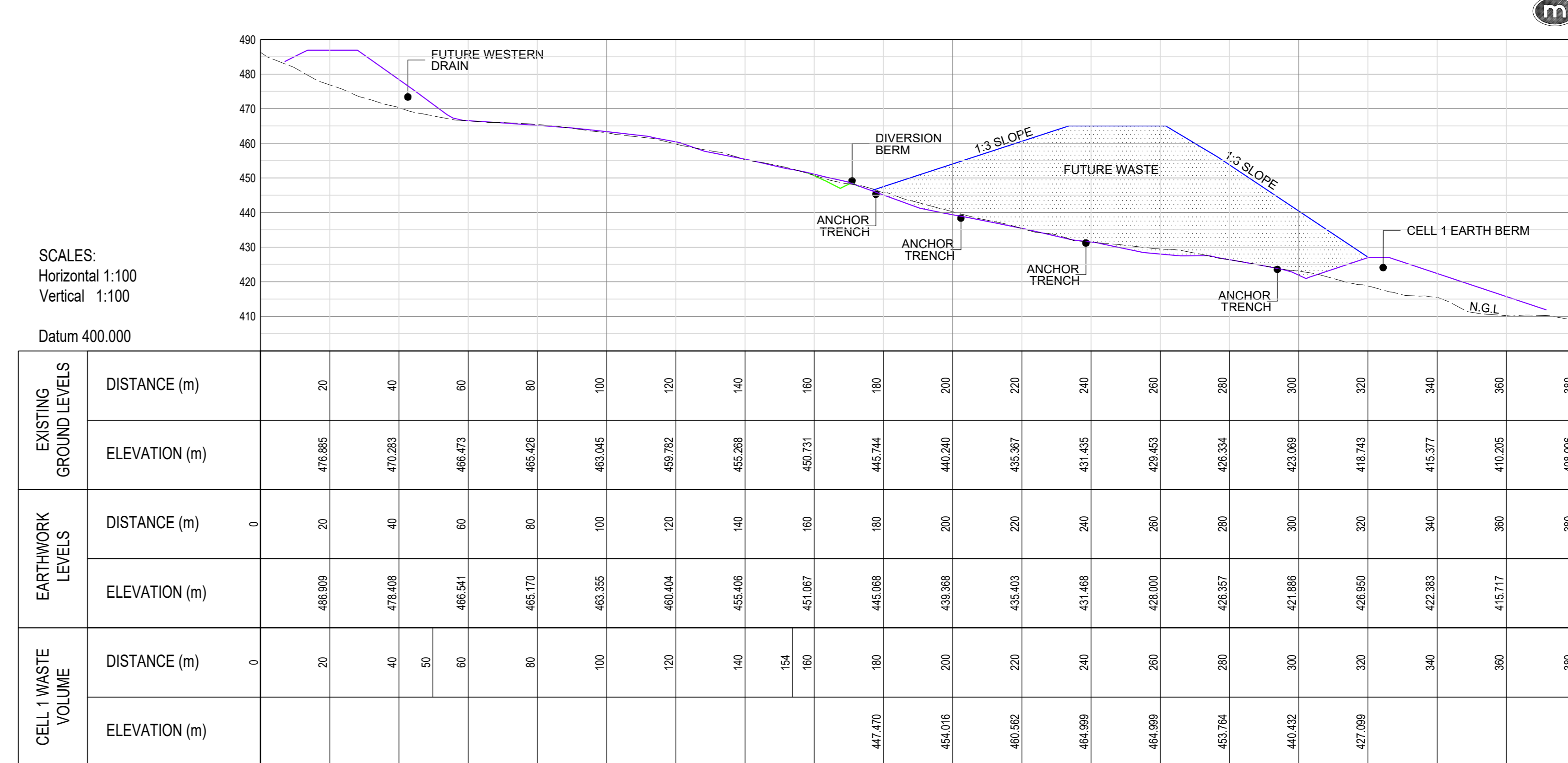

LONG SECTION 1-1

SCALES:
Horizontal 1:100
Vertical 1:100
Datum 400.000

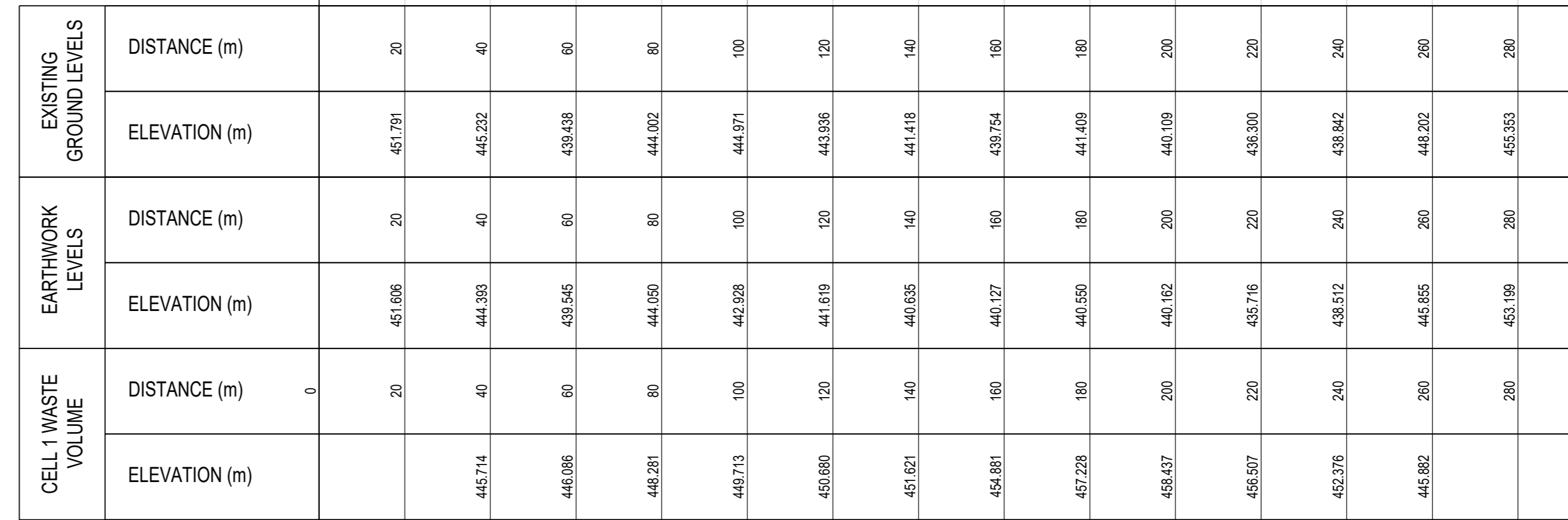

LONG SECTION 2-2

SCALES:
Horizontal 1:100
Vertical 1:100
Datum 400.000

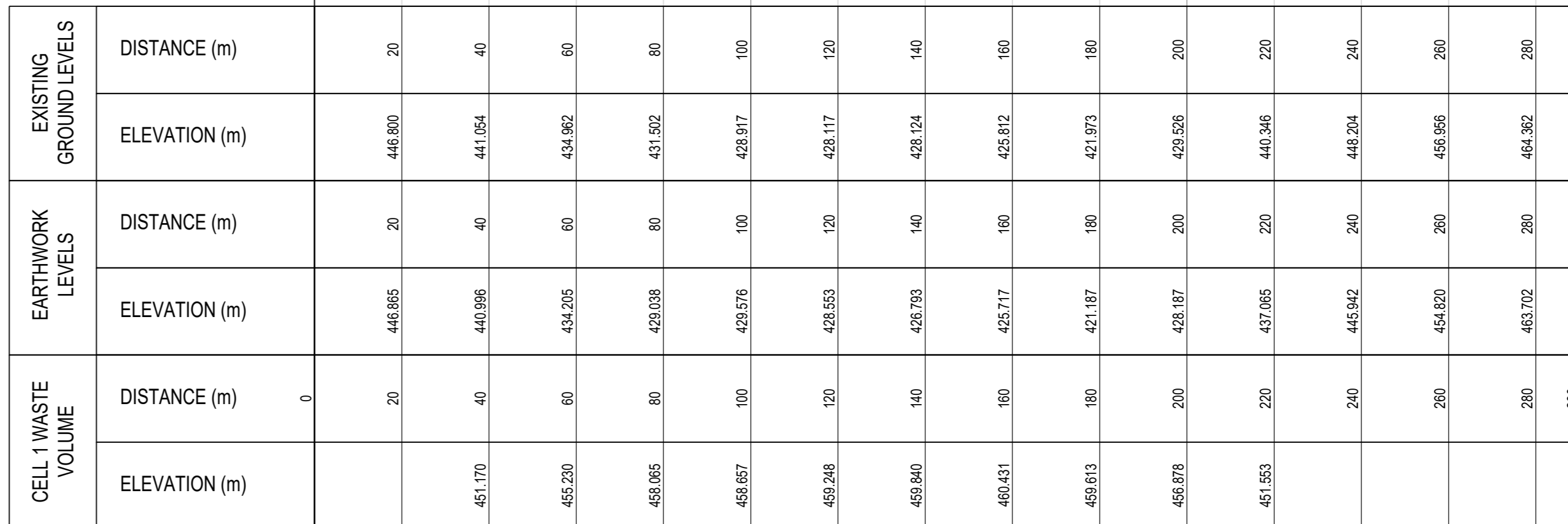

LONG SECTION 3-3
TYPICAL SECTIONS THROUGH CELL 1