

1 2 3 4 5 6 7 8 9 10 11 12 13 14 15 16

A
B
C
D
E
F
G
H
J
K
L
M

A
B
C
D
E
F
G
H
J
K
L
M

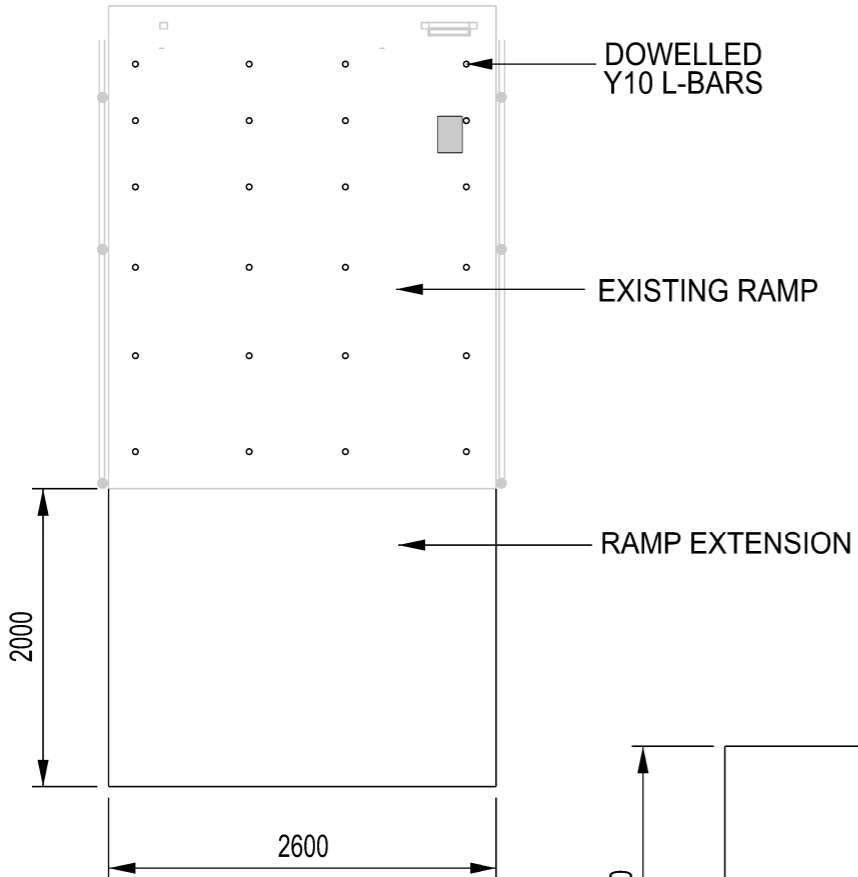

RAMP EXTENSION TOP VIEW

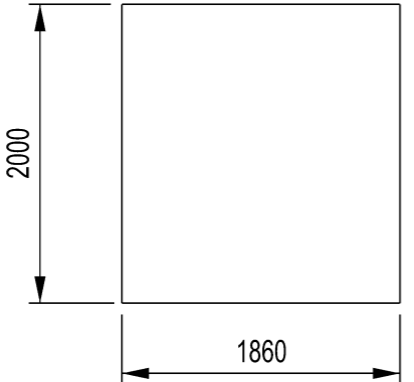

NEW RAMP TOP VIEW

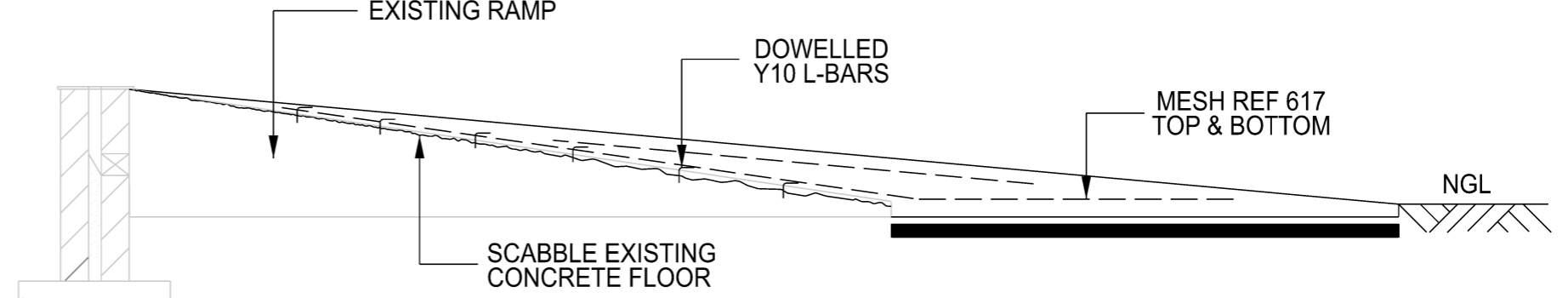

RAMP EXTENSION SIDE VIEW SCALE 1:25

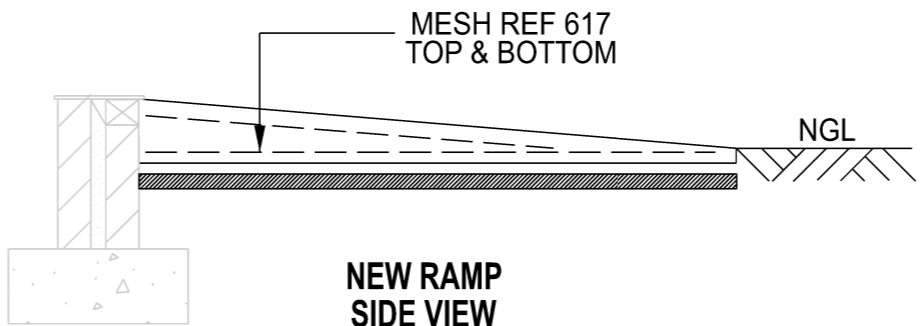

NEW RAMP SIDE VIEW SCALE 1:25

BENDING SCHEDULE (NEW RAMP + RAMP EXTENSION)						
No. of Bars	DIA	Length	Mark	SC	A	B
24	10	120	L-BARS	37	60	60
MESH 617		30 m2				
TOTAL MASS = 180 KG						

NOTES

1. CONCRETE STRENGTH AT 28 DAYS/STONE SIZE :
BLINDING = 15/19
FOUNDATION = 25/19
SLUMP VALUE 75mm(25mm)
2. MIN. COVER TO REINFORCEMENT TO BE 50mm +/-
3. FORMWORK TO EXTEND AT LEAST 150mm BELOW GROUND LEVEL
4. ALL TOP EDGES TO HAVE 20 x 20 CHAMFER
5. ALL WORK TO BE IN ACCORDANCE WITH SANS 1200 SERIES
6. THESE FOUNDATIONS HAVE BEEN DESIGNED TO FOUND ON COMPETENT FOUNDING MATERIAL. IN ALL CASES COMPETENCY MUST BE ESTABLISHED BY A QUALIFIED GEOTECHNICAL ENGINEER
7. IMPORT 150 mm G6 MATERIAL FROM COMMERCIAL SOURCE, COMPACTED TO 90%
8. FLOOR TO BE FINISHED WITH DRY SHAKE GREY NON-METALLIC FLOOR HARDNER. FLOOR TO BE POWER FLOATED
9. RIP IN-SITU AND REMOVE BOULDERS, COMPACT IT TO 90% MDD @OM

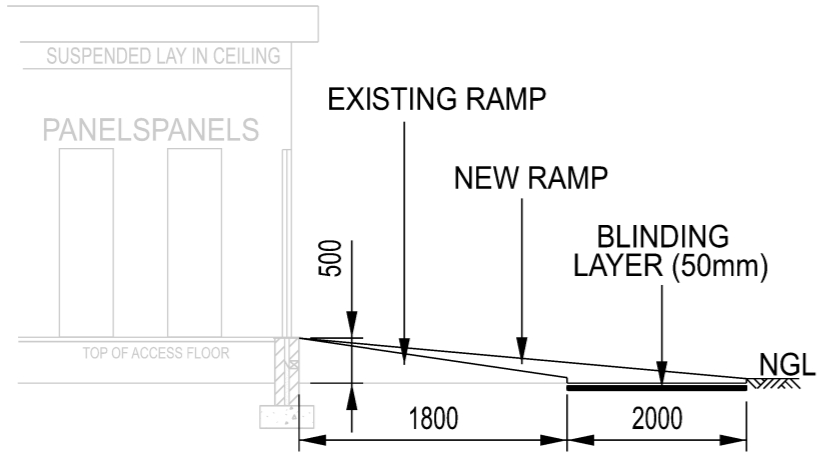

RAMP EXTENSION SIDE VIEW SCALE 1:80

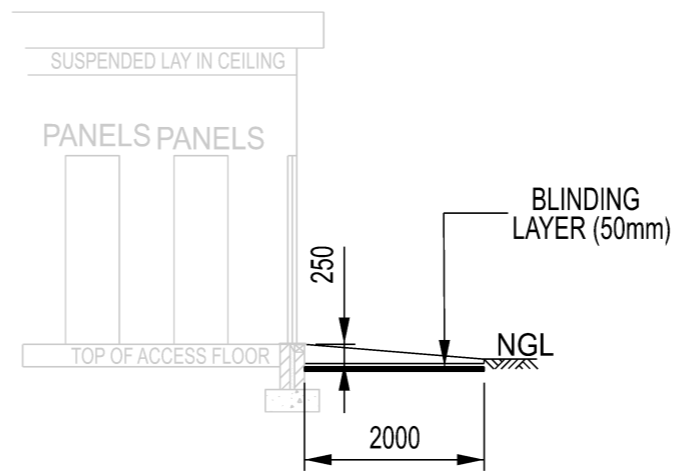

NEW RAMP SIDE VIEW SCALE 1:80

DETAIL DESIGN NOT FOR CONSTRUCTION
ORIGINAL DWG #: SIMCO25P25-SE-D67 Rev 0
CONCEPT DWG #/ N/A

REV	REVISION DESCRIPTION	DRAWN	CHKD	AUTH	DATE	4319	132 kV BUSBAR SUPPORT
						0.54/	REFERENCE DRAWINGS
APPROVED BY B. HAJEE DATE 09/01/2026				National Transmission Company South Africa SOC Ltd Reg No 2021/539129/30			
CHECKED BY A. MAYET DATE 18/11/2025		SIMMERPAN COMPLEX PTM&C LAB REFURBISHMENT RAMPS					
DRAWN BY M. MAKHUVHA DATE 22-10-2025		©		SIMCO25P02-SE-D67			
SCALE 1:50		SHEET NUMBER		REVISION			
		1		0			

1 2 3 4 5 6 7 8 9 10 11 12 13 14 15 16 A3L