



KWAZULU-NATAL PROVINCE

PUBLIC WORKS
REPUBLIC OF SOUTH AFRICA

NQUTHU (KWAZULU NATAL) - MASHESHELENG PRIMARY SCHOOL: COMPLETION OF ADMINISTRATION, MULTI-PURPOSE CLASSROOM AND KITCHEN BLOCKS INCLUDING CONSTRUCTION OF NEW GUARD HOUSE, THREE TOILET BLOCKS, PARKING FACILITIES, PATHWAYS AND FENCING

PART C3. SCOPE OF WORKS

C3.1 SCOPE OF WORKS			
GCC FOR CONSTRUCTION WORKS (Edition 2 of 2010)			
Scope of Works complied in accordance with SANS 10403 where reference is made to this part of SANS 1921-1:2004			
Project title:	NQUTHU (KWAZULU NATAL) - MASHESHELENG PRIMARY SCHOOL: COMPLETION OF ADMINISTRATION, MULTI-PURPOSE CLASSROOM AND KITCHEN BLOCKS INCLUDING CONSTRUCTION OF NEW GUARD HOUSE, THREE TOILET BLOCKS, PARKING FACILITIES, PATHWAYS AND FENCING		
Tender no:	ZNTL 05813 W	Project Code:	042720
1	<p><u>SECTION 1</u></p> <p><u>EXTENT OF THE WORKS</u></p> <p>1.1 EMPLOYERS OBJECTIVES To complete current un-finished scope of works</p> <p>1.2 OVERVIEW OF THE WORKS Repairs, renovations and upgrading of current facilities.</p> <p>1.3 EXTENT OF THE WORKS Completion of Administration building, Multi Purpose classroom block, Guard House, Kitchen and external works.</p> <p>1.4 LOCATION OF THE WORKS The site is situated within the premises of the existing Primary school. The school is approximately 10km outside Nqutu. Comming from Nqutu on the Dundee road turning left at the sign towards St Augustene Church for approximately 5km. GPS Co-ordinates for the site is -28,239803; 30,607931</p> <p>1.5 TEMPORARY WORKS All temporary work to comply with the Occupational Health and Safety Act (Act 85 of 1993). Special care should be taken to barricade all excavations and fence off the project site where appropriate. The contractor is specifically alerted to the fact that the Works are situated within the school grounds and precautions must be taken to ensure the safety of all learners and staff.</p>		
2	<p><u>ENGINEERING</u></p> <p>2.1 EMPLOYER'S DESIGN Not applicable</p> <p>2.2 DESIGN BRIEF Not applicable</p> <p>2.3 DRAWINGS See list of drawings/Annexure's attached to this document.</p> <p>2.4 DESIGN PROCEDURES Not applicable</p>		

<p>3</p> <p>3.1</p> <p>3.2</p> <p>3.3</p> <p>3.4</p> <p>3.5</p>	<p><u>PROCUREMENT</u></p> <p>PREFERENTIAL PROCUREMENT PROCEDURES</p> <p>This tender will be subject to the implementation of the Preferential Procurement Regulations, 2017 pertaining to the Preferential Procurement Policy Framework Act, Act Number 5 of 2000 and the relevant Supply Chain Management Legislation and the KwaZulu-Natal Supply Chain Management Policy Framework published by the KwaZulu-Natal Provincial Treasury. Tenderders are referred to www.kzntreasury.gov.za for access to the relevant documents.</p> <p>Tenderders are advised to familiarize themselves with the contents of the KwaZulu-Natal Supply Chain Management Policy Framework regarding Preference Point Systems, evaluation of tenders appeals and other matters.</p> <p>RESOURCE STANDARD PERTAINING TO TARGETED PROCUREMENT</p> <p>NOTE : This project will be adjudicated as not exceeding R 50,000 000,00</p> <p>SCOPE OF MANDATORY SUBCONTRACT WORK</p> <p>The contractor will be required to appoint a reasonable number of emerging sub-contractors to undertake work to the minimum of 5% of the contract value on the various service areas but not limited to the following services</p> <p>PREFERRED SUBCONTRACTORS/SUPPLIERS</p> <p>Not applicable</p> <p>SUBCONTRACTING PROCEDURES</p> <p>Not applicable</p>
<p>4</p> <p>4.1</p>	<p><u>CONSTRUCTION</u></p> <p>APPLICABLE SANS 2001 STANDARDS FOR CONSTRUCTION WORKS</p> <p>The Contractor is referred to the "Model Preambles to Trades - 2008", any "Supplementary Preambles", the Electrical Specifications and Mechanical Specification for full descriptions of materials and methods referred to in these Bills of Quantities/Lump Sum documents, insofar as they apply. The Contractor is advised to study the "Standard Preambles to all Trades", any "Supplementary Preambles", the Electrical Specifications and Mechanical Specification, before pricing Bills of Quantities/Lump Sum documents.</p> <p>Where the description in the Bills of Quantities/Lump Sum documents differ from those in the Standard Electrical Specifications, the descriptions in the Bills of Quantities/Lump Sum documents are to apply. No claim whatsoever will be allowed in respect of errors in pricing due to brevity of description of items in the Bills of Quantities/Lump Sum documents which are fully described when read in conjunction with the relevant Preambles and/or Specifications. Suppliers of materials and the like, whose quality systems apply with one or more of the SABS/SANS ISO 9000 Series should be used whenever possible in the absence of a particular SABS/SANS Specification Standard Mark.</p> <p>Wherever the words "shall be deemed to be included in the description", "shall be stated" or other words having the same effect, appear in the Standard System, it shall be deemed that all descriptions in these Bills of Quantities/Lump Sum documents incorporated such inclusions and statements whether specifically stated or not.</p> <p>The Contractor is hereby informed that where SABS/SANS Specifications are referred to in these Bills of Quantities/Lump Sums documents and Specifications thereto, then ONLY the Specification of Work Clauses will apply. The method of measurement and payment clauses will NOT apply to this Contract.</p> <p>The Contractor is hereby informed that risk of collapse and keeping excavations free from water (excluding subterranean water) generally are deemed to be included in the descriptions unless accommodated in the system of measurement. Please refer to the Geotechnical Investigation report when included at the end of these tender documents.</p> <p>Whenever reference is made to "Sub-Contractor", "Nominated Sub-Contractor" or the like in the specifications included or referred to in these Bills of Quantities/Lump Sums documents, it shall be deemed to mean "Contractor" as defined.</p>

<p>4.2</p>	<p>APPLICABLE NATIONAL AND INTERNATIONAL STANDARDS</p> <p>See above 4.1</p>												
<p>4.3</p>	<p>PARTICULAR / GENERIC SPECIFICATIONS</p> <p>The Contractor is referred to the following documents whether attached to this document or not:</p> <table border="0"> <thead> <tr> <th style="text-align: left;"><u>SPECIFICATION</u></th> <th style="text-align: left;"><u>PAGES</u></th> </tr> </thead> <tbody> <tr> <td>Specification for HIV/AIDS Awareness (CIDB)</td> <td>HIV1 TO HIV3</td> </tr> <tr> <td>Specific Construction, Safety, Health and Environmental Plan</td> <td></td> </tr> <tr> <td>Model Preambles for Trades 2008</td> <td>1 to 32</td> </tr> <tr> <td>General Electrical Specification</td> <td>E/1 to E/20</td> </tr> <tr> <td>Lightning Protection Installation</td> <td>LP/1 to LP/6</td> </tr> </tbody> </table>	<u>SPECIFICATION</u>	<u>PAGES</u>	Specification for HIV/AIDS Awareness (CIDB)	HIV1 TO HIV3	Specific Construction, Safety, Health and Environmental Plan		Model Preambles for Trades 2008	1 to 32	General Electrical Specification	E/1 to E/20	Lightning Protection Installation	LP/1 to LP/6
<u>SPECIFICATION</u>	<u>PAGES</u>												
Specification for HIV/AIDS Awareness (CIDB)	HIV1 TO HIV3												
Specific Construction, Safety, Health and Environmental Plan													
Model Preambles for Trades 2008	1 to 32												
General Electrical Specification	E/1 to E/20												
Lightning Protection Installation	LP/1 to LP/6												
<p>4.4</p>	<p>CERTIFICATION BY RECOGNIZED BODIES</p>												
<p>4.5</p>	<p>Only contractors registered with the Electrical Contracting Board of South Africa in accordance with the Regulations of the Occupational Health and Safety Act will be accepted and permitted to do work under this contract.</p>												
<p>4.6</p>	<p>AGRÉMENT CERTIFICATES</p>												
<p>4.7</p>	<p>Not applicable</p>												
<p>4.8</p>	<p>PLANT AND MATERIAL PROVIDED BY THE EMPLOYER</p>												
<p>4.7</p>	<p>SERVICES AND FACILITIES PROVIDED BY THE EMPLOYER</p>												
<p>4.8</p>	<p>Not applicable</p>												
<p>5</p>	<p>OTHER SERVICES AND FACILITIES</p>												
<p>5.1</p>	<p>The Contractor shall provide any artificial lighting which may be necessary or required for the proper execution of the works, and provide electric power and water required by all Sub-Contractors, Nominated Sub-Contractors and Sub-Contractors appointed directly by the Administration.</p> <p>The Contractor shall give all notices and pay all fees in connection with temporary electrical and water connections and shall connect temporary Electrical and Water meters for and pay for all current and water consumed.</p> <p>The Contractor is advised that the permanent light fittings and water points of any kind installed in the Works are not to be used to provide temporary lighting and supplement water requirements for construction purposes.</p>												
<p>5.1</p>	<p>MANAGEMENT</p>												
<p>5.1</p>	<p>APPLICABLE SANS 1921 STANDARDS</p>												
<p>5.1</p>	<p>Tenderders are referred to SECTION 2 : SPECIFICATION DATA ASSOCIATED WITH SANS 1921-1:2004 IN THIS DOCUMENT</p>												
<p>5.2</p>	<p>RECORDING OF WEATHER</p>												
<p>5.2</p>	<p>The Contractor shall keep record of abnormal climatic conditions to facilitate the adjudication of claims for extension of the contract period.</p>												
<p>5.2</p>	<p>The Contractor shall allow in his programme for the following number of days for rain days (rain > 10mm per day) as per the table below:</p>												
<p>5.2</p>	<table border="1" style="width: 100%; border-collapse: collapse;"> <thead> <tr> <th colspan="2" style="text-align: center;">CURRENT YEAR</th> <th colspan="2" style="text-align: center;">YEAR + 1</th> </tr> </thead> <tbody> <tr> <td style="width: 25%;">January</td> <td style="width: 25%;">w/days</td> <td style="width: 25%;"></td> <td style="width: 25%; text-align: center;">3</td> </tr> <tr> <td>February</td> <td>w/days</td> <td></td> <td style="text-align: center;">3</td> </tr> </tbody> </table>	CURRENT YEAR		YEAR + 1		January	w/days		3	February	w/days		3
CURRENT YEAR		YEAR + 1											
January	w/days		3										
February	w/days		3										

March	w/days		3	
April	w/days		3	
May	w/days		3	
June	w/days		3	
July	w/days		3	
August	w/days		3	
September	w/days		3	
October	w/days		3	
November	w/days			
December	w/days			

5.3	<p>MANAGEMENT MEETINGS</p> <p>In order to facilitate the smooth functioning of the Works and to ensure the closest co-operation between all the parties concerned, the Employer will call for regular meetings to be held on the site, at which a senior member of the Contracting firm and the General Foreman of the Works will always be required to be present. In addition to the above, other persons will be required to attend these meetings as and when their presence is necessary, e.g., Consultants in all disciplines, representatives of the various Sub-Contractors, etc. Proper minutes of these meetings will be kept by the Employer\Principal Agent and copies will be circulated to all persons attending the meetings and to others who need to be kept informed.</p>
5.4	<p>FORMS FOR CONTRACT ADMINISTRATION</p> <p>The Employer shall provide all necessary forms.</p>
5.5	<p>ELECTRONIC PAYMENTS</p> <p>The Contractor shall provide all required information to the Employer to facilitate electronic payments upon request.</p>
5.6	<p>DAILY RECORDS</p> <p>The Contractor shall keep daily records of people and equipment employed as well as a site diary in respect of work performed on the site. At the end of each week the Contractor shall provide the Principal Agent with a written record, in schedule form, reflecting the number and description of tradesmen and labourers employed by him and all Sub-Contractors on the works each day. At the end of each week the Contractor shall provide the Principal Agent with a written record, in schedule form, reflecting the number, type and capacity of all plant, excluding hand tools, currently used on the works.</p>
5.7	<p>BONDS AND GUARANTEES</p> <p>The Contractor shall within 10 calendar days after receiving notice from the Engineer and prior to receiving a completed copy of this agreement, including the schedule of deviations (if any), contact the Employer's agent (whose details are given in the contract data) to arrange the delivery of any bonds, guarantees, proof of insurance and any other documentation to be provided in terms of the conditions of contract identified in the Contract Data.</p>
5.8	<p>PAYMENT CERTIFICATES</p> <p>Requirements will be in accordance with the Employers prescriptions.</p>

<p>4.12.1</p>	<p>Samples of materials</p> <p>The work is to be executed with materials of the best specified and in the most substantial and workmanlike manner under the inspection of the Employer and to his satisfaction. The Contractor shall furnish, without delay, such samples as called for or may be called for by the Employer, who may reject all materials or workmanship not corresponding with the approved sample. The samples of materials, workmanship and finishes that the Contractor is to provide and deliver to the employer are:</p> <ul style="list-style-type: none"> - Tile sample. - Brick sample. - Light fitting sample. - Screed panel 2m x 2m impact test. - Tested trial mix to be approved by the Engineer.
<p>4.12.2</p>	<p>Fabrication drawings that the contractor is to provide to the employer are:</p>
<p>4.12.3</p>	<p>Office accommodation, equipment, accommodation for site meetings and other facilities for use by the employer and his agents are:</p> <p>OFFICE FOR FOREMAN</p> <p>Provide, erect, maintain and remove at completion a suitable temporary office for the Contractor or his Foreman, perfectly secured, lighted and ventilated and having a desk with drawers.</p> <p>TELEPHONE</p> <p>The Contractor shall provide a telephone on the site for the use of the Contractor and all Sub-Contractors for the duration of the Contract, and must make the necessary application for connection, give all notices and pay all fees, rentals and charges for the service and also for all calls.</p> <p>OFFICE FOR INSPECTOR OF WORKS</p>
	<p>Provide, erect, maintain and remove at completion a well constructed temporary office for the Inspector of Works not less than 4 x 3 m on plan and 3 m high to eaves to the approval of the Employer. The office shall be constructed of wood framing covered externally with corrugated iron or corrugated asbestos and with a lean-to roof covered with the same material as the external wall covering. The office shall be lined internally with soft board or other approved material and a ceiling shall be provided of the same material as the internal lining. A suspended wood floor shall be provided and is to finish not less than 300 mm above the ground level. A lockable door and a window, which provides adequate light and ventilation, shall be fitted. An office constructed of 115 mm thick brick-work and provided with a screeded concrete floor and roofed and ceiled as above described may be accepted as an alternative but prior permission of the Employer will be necessary before construction of such an office is commenced and his requirements shall be stated and fulfilled by the Contractor. The office shall be fitted in an approved manner with a sloping topped desk of height and length suitable for the laying out and studying of drawings, a desk or table with not less than two lock-up drawers, shelves, seating and wash-stand, and the Contractor shall provide all necessary attendance.</p> <p>TELEPHONE IN OFFICE FOR INSPECTOR OF WORKS</p> <p>The Contractor shall arrange for the installation of a lockable telephone in the Office for the Inspector of Works for the duration of the Contract. The Contractor will be required to make the necessary application for connection and give all notices on behalf of the Employer. The Employer will, however, be responsible for the direct payment of all fees, rentals and other charges by Telkom for the service for the Inspector of Works and for all calls made from this telephone.</p>

	SHED
	Provide, erect, maintain and remove at completion, ample temporary sheds for the proper storage of materials and for the use of the workmen, and remove when no longer required.
4.14.6	The requirement for provision and erection of signboards are:
	Supply, erect, maintain and remove at completion a painted notice board, size overall 2800 x 2345 mm high sign written to detail as Drawing No. T9506 which drawing is available from offices of the Department of Public Works. Only the official notice board is to be displayed on the site and no Sub-Contractor's boards will be permitted. The Contractor, at his own cost, may provide a board on which all sub-contract firms' names may be sign written. The notice board is to be to the approval of the Employer and is to be maintained in first class condition and placed where directed at the entrance to the site and remain there for the duration of the Contract.
4.17.1	Requirement for the termination, diversion or maintenance of existing services:
	Should the Contractor come in contact with any underground cables or pipes during excavations, immediate notification must be made to the Employer and all work in the vicinity of such cables, pipes, etc., shall cease until authority to proceed has been obtained from the Employer. Should the Contractor damage underground cables or pipes resulting in a disruption of services to an existing institution such damage shall be repaired immediately.
4.17.3	Services which are known to exist on the site:
	Investigate and provide detail drawings.
4.17.4	Requirement for detection apparatus
	None
4.18	ADDITIONAL HEALTH AND SAFETY REQUIREMENTS ARE:
	By the submission of a tender, any Tenderder will, if awarded the contract to which this tender document relates, be deemed to be the mandatory as envisaged by Section 37 (2) of the Act. As a mandatory the successful Tenderder will be deemed to be the "principal contractor" and an employer in his/her/their own right with duties as prescribed in the Act and accordingly will be deemed to have agreed to be solely responsible for ensuring that in connection with the service to which this tender document relates, all work will be performed and machinery and plant used in accordance with the Act. Should the Contractor, for whatever reason be unable to perform as required by the Act, the Contractor undertakes to inform the Employer accordingly. Tenderders are advised that it is a Condition of this Tender that a 'Construction Phase Safety, Health and Environmental Plan' specifically relates to the project for which tenders are being submitted and must be prepared by the Tenderder and submitted with the other tender documents at the time of tender. Failure to do so Tenderders are therefore advised to study the 'Construction Safety, Health and Environmental Specification' which is issued as part of this tender document, the Model Preambles to Trades - 2008, any project Specification included in this tender document and any and all drawings which are referred to and issued as part of this tender document before preparing their own project specific 'Construction Phase Safety, Health and Environmental Plan' . Tenderders are also advised that such a plan which is submitted with a tender but is incomplete or considered inadequate by the Employer or his Representative will invalidate the tender. The Contractor will be deemed to have satisfied himself with his obligations in terms of the Act and to have allowed for all costs arising from compliance with the Act as no claim for extra costs arising from compliance with, and obligations in terms of the Act will be entertained.
4.22	WORK BY NOMINATED AND SELECTED SUBCONTRACTORS COMPRISE:
	[Provide list of applicable contractors]

C3.2 - SPECIFICATION FOR HIV/AIDS AWARENESS

1 Scope

This generic specification contains requirements applicable to the reduction of the risk of transfer of the HIV virus between and among construction workers and the local community through the following four strategies:

- a) raising awareness about HIV/AIDS;
- b) providing construction workers with access to condoms;
- c) HIV counselling, testing and referral services; and
- d) Sexually Transmitted Infection diagnosis and treatment.

2 Normative references:

The following standard contains provisions that, through reference in this text, constitute provisions of this standard:

SANS 4074 ISO 4074, *Condom Rubbers*

3 Definitions and Abbreviations

3,1 Definitions

Construction Worker: all persons in the employ of the contractor or in the employ of any of the subcontractors contracted by the contractor.

Local Community: the communities local to the site which are most likely to have contact with the construction worker and, in particular, sex workers in those communities.

Service provider: the natural or juristic person recognised by the South African Department of Health as specialist in conducting Aids Awareness Programmes.

3,2 Abbreviations

STI: Sexually transmitted infection

HIV: Human Immunodeficiency Virus

AIDS: Acquired Immune Deficiency Syndrome

4 Objectives

The objectives are to:

- a) reduce the risk of transfer of the HIV virus between and among construction workers and the local community;
- b) raise awareness amongst construction workers and the local community of the risk of infection with the HIV virus;
- c) promote early diagnosis; and
- d) assist affected individuals to access care and counselling.

5 Requirements

5.1 General requirement

The contractor shall, in order to satisfy the objectives stated in 4:

- a) make condoms complying with the requirements of SABS ISO 4074 available to all construction workers at readily accessible points on the site, suitably protected from the elements, for the duration of the contract;
- b) either place and maintain HIV/AIDS awareness posters of size of not less than A1 in areas which are highly trafficked by construction workers, or provide construction workers with a pamphlet, in languages largely understood by construction workers, which
- c) encourage voluntary HIV/STI testing;
- d) provide information concerning counselling, support and care of those that are infected services; and
- e) comply with the requirements of 5.2.

The provisions of 5.1 c) and d) do not apply to this contract.

5.2 HIV awareness programme

5.2.1 The contractor shall:

- a) engage a qualified service provider as described in the scope of works to conduct an HIV Awareness Programme which is structured to achieve the outcomes stated in 5.2.3 for contract workers as soon as a construction workers camp is established and populated or, where no such camp is established, within two weeks of the commencement of a significant portion of the works and at subsequent intervals, if any, provided for in the scope of works; and
- b) arrange for, provide a suitable venue, and instruct all construction workers to attend the HIV Awareness Programme and notify the Employer's Representative of the date, time and venue whenever a session with construction workers is conducted.

Note: The National Department of Public Works maintains a list of qualified service providers.

5.2.2 The contractor shall do nothing to dissuade construction workers from attending such an HIV Awareness Programme and shall take all reasonable steps to ensure that a minimum of 90% of construction workers engaged in the works attend such a programme, when it is conducted.

5.2.3 The outcomes of the HIV Awareness Programme shall as a minimum, result in contract workers exposed to such a programme being able to:

- a) communicate the existence of problems of HIV and be able to outline the consequences of transmission of HIV to or from the local community;
- b) recall and communicate the mode of HIV transmission and preventative measures including the proper use of the condom.

The HIV/ Aids awareness programme described in 5.2 is to be repeated at four month intervals throughout the duration of the contract. (Four times in total, including the initial one at the start of the contract)

5.3 Reporting

- 5.3.1** The contractor shall prepare and attach to his claims for payment a brief report which outlines how the actions taken by the contractor in the period for which payment is claimed satisfy the requirements and a schedule which lists the names, identity numbers, trade / occupation and name of employer of all construction workers exposed to the programme (see **HIV/STI Compliance Report**).
- 5.3.2** The employer's representative shall certify the report and schedule described in 5.3.1 whenever a claim for payment is issued to the employer.

Note: In the event that the contractor fails to satisfy the requirements of this specification, the employer (Head: Public Works) may apply any of the sanctions provided for in the contract. Sanctions may include the application of a financial penalty of .04% of the Contract Sum.

The *HIV /Aids awareness programme described in 5.2 shall in addition be conducted for the benefit of the local community on two occasions in the community centre nearest to the building site. The contractor shall be responsible for inviting identifiable community-based institutions and organisations, churches, and schools to participate in the programme.*

C3.3 - HIV/STI COMPLIANCE REPORT

Pro-forma reporting format in terms of the SPECIFICATION FOR HIV/AIDS AWARENESS

Project Code:

042720

Payment Claim number:

Period covered by payment claim:

1. Distribution of condoms (briefly describe where and how condoms are distributed).

2. Posters / pamphlets (briefly describe where posters were placed / how pamphlets were distributed).

3. Voluntary testing (briefly describe the actions taken / information provided to promote testing).

4. Counselling, support and care (summarise information provided).

5. HIV awareness programme (briefly describe action).



NQUTHU (KWAZULU NATAL) - MASHESHELENG PRIMARY SCHOOL: COMPLETION OF ADMINISTRATION, MULTI-PURPOSE CLASSROOM AND KITCHEN BLOCKS INCLUDING CONSTRUCTION OF NEW GUARD HOUSE, THREE TOILET BLOCKS, PARKING FACILITIES, PATHWAYS AND FENCING

PART C4. SITE INFORMATION

[

C4.1 SITE INFORMATION
GCC FOR CONSTRUCTION WORKS (2 Edition of 2010)

Project title:	NQUTHU (KWAZULU NATAL) - MASHESHELENG PRIMARY SCHOOL: COMPLETION OF ADMINISTRATION, MULTI-PURPOSE CLASSROOM AND KITCHEN BLOCKS INCLUDING CONSTRUCTION OF NEW GUARD HOUSE, THREE TOILET BLOCKS, PARKING FACILITIES, PATHWAYS AND FENCING		
Tender No.	ZNTL 05813 W	Project Code:	042720

C4.1 Site Information

C4.1	GENERAL
(a)	Work to existing buildings
(b)	Access/entrance to site to be through current contractors entrance at the side of the school property.
(c)	The construction site lies within the existing school premises. As such, the works shall be undertaken in a manner that will not adversely affect the day to day operations of the school. All matters pertaining to Health, Safety and Environmental shall be attended to in accordance with the project requirements. Existing underground services where affecting construction shall be proved or exposed prior to proceeding with any work and any service that is damaged during construction shall be repaired immediately by the contractor. Existing fences, roads, driveways, poles, etc. that will be affected during construction shall be reinstated or replaced if damaged. Items have been made available in the BOQ to deal with these issues, but where damage has been caused due to contractor's negligence, the costs to repair will be for the contractor's account.
C4.2	GEOTECHNICAL INVESTIGATION REPORT
(a)	Not applicable



KWAZULU-NATAL PROVINCE
PUBLIC WORKS
REPUBLIC OF SOUTH AFRICA

**NQUTHU (KWAZULU NATAL) - MASHESHELENG PRIMARY SCHOOL: COMPLETION OF
ADMINISTRATION, MULTI-PURPOSE CLASSROOM AND KITCHEN BLOCKS INCLUDING
CONSTRUCTION OF NEW GUARD HOUSE, THREE TOILET BLOCKS, PARKING FACILITIES,
PATHWAYS AND FENCING**

PART C5 - DRAWINGS / ANNEXURES

[

ANNEXURES	
Annexure 1	List of Drawings
Annexure 2	General Electrical Specifications
Annexure 3	Lightning Protection Specifications
Annexure 4	Map of Tender submission location
Annexure 5	Project Specific Electrical Specification
Annexure 6	Joint Venture Agreement
Annexure 7	Health and Safety Specification and Bill of Quantities
Annexure 8	Builders Lien Agreement
Annexure 9	Additional Specification - EPWP
Annexure 10	EPWP - BOQ
Annexure 11	Scope of Works - EPWP
Annexure 12	EPWP Employment Contract
Annexure 13	Attendance Register - Infrastructure and Other projects
Annexure 14	EPWP Data Collection tool for Phase 3 system



KWAZULU-NATAL PROVINCE

PUBLIC WORKS
REPUBLIC OF SOUTH AFRICA

**NQUTHU (KWAZULU NATAL) - MASHESHELENG PRIMARY SCHOOL: COMPLETION OF
ADMINISTRATION, MULTI-PURPOSE CLASSROOM AND KITCHEN BLOCKS INCLUDING
CONSTRUCTION OF NEW GUARD HOUSE, THREE TOILET BLOCKS, PARKING FACILITIES,
PATHWAYS AND FENCING**

ANNEXURES

[



KWAZULU-NATAL PROVINCE
PUBLIC WORKS
REPUBLIC OF SOUTH AFRICA

**NQUTHU (KWAZULU NATAL) - MASHESHELENG PRIMARY SCHOOL: COMPLETION OF
ADMINISTRATION, MULTI-PURPOSE CLASSROOM AND KITCHEN BLOCKS INCLUDING
CONSTRUCTION OF NEW GUARD HOUSE, THREE TOILET BLOCKS, PARKING FACILITIES,
PATHWAYS AND FENCING**

**ANNEXURE 1
DRAWINGS**

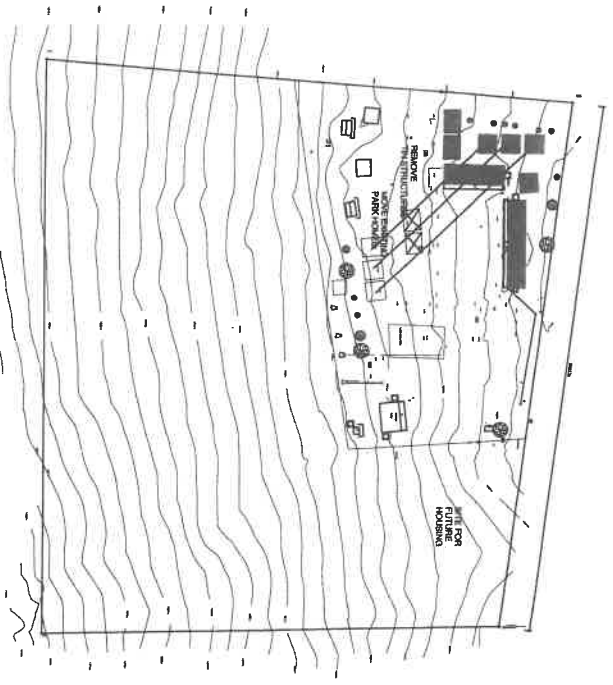

PRE PHASE 1

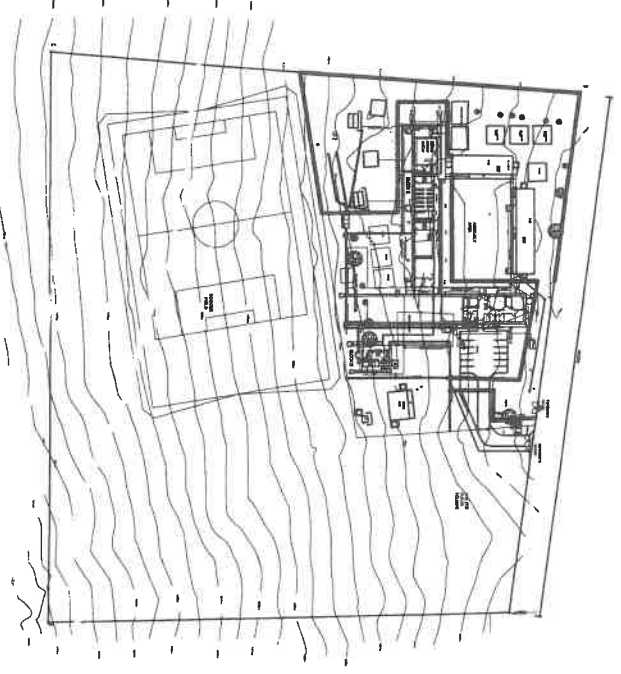

PHASE 1

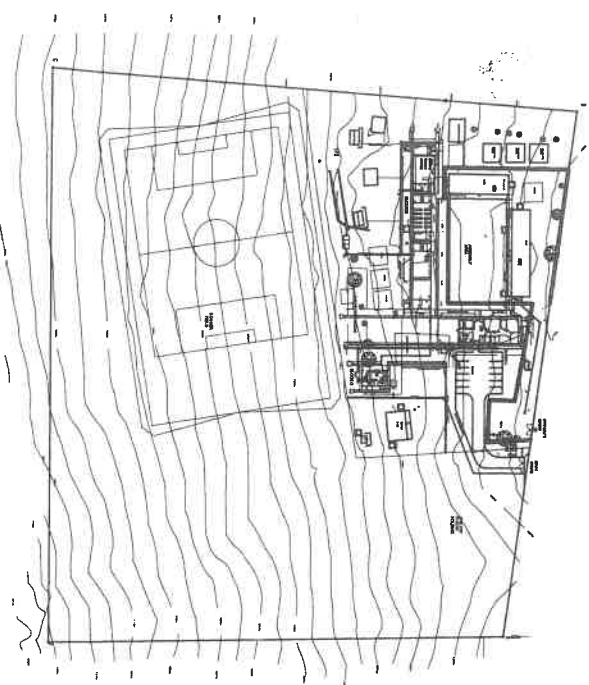

PHASE 2

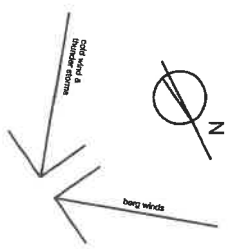

LOCAL GOVERNMENT TECHNICAL SERVICES
SCHOOL, MUNICIPAL & CIVIL

MANUFACTURING MANAGER

GENUINE MANAGER

Checked by: Consultant
Name: W. Koster

Drawn by: W. Koster

Project: MASHESHELENG
PRIMARY SCHOOL:
UPGRADES &
ADDITIONS

Department: public works

Public Works
PROVINCE OF KWAZULU-NATAL

MIDLANDS REGION

Project: MASHESHELENG
PRIMARY SCHOOL:
UPGRADES &
ADDITIONS

Drawing Description: PHASING

Drawn: W. Koster

Checked: as shown

Consultant Drawing No.:

DOI Drawing No. 039396 / W 0

Scale: 1:1000

Date: October 2012

Sheet: 1 of 1

Approved: [Signature]

CLIENT DEPARTMENT/DIVISIONS SCHOOL PRINCIPAL & STAMP:		 public works Department: Public Works PROVINCE OF KWAZULU-NATAL	MIDLANDS REGION MASHESHELENG PRIMARY SCHOOL: UPGRADES & ADDITIONS	Drawing Description: SITE & LOCALITY PLAN	Drawn: W. Venter Date: November 2015
INFRASTRUCTURE MANAGER: GENERAL MANAGER: Checked by: Consultant Name: W. Venter Signature: _____ Date: _____					Drafted: _____ Date: _____

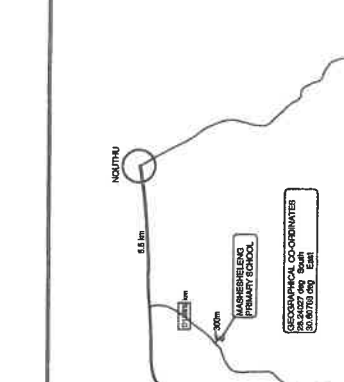
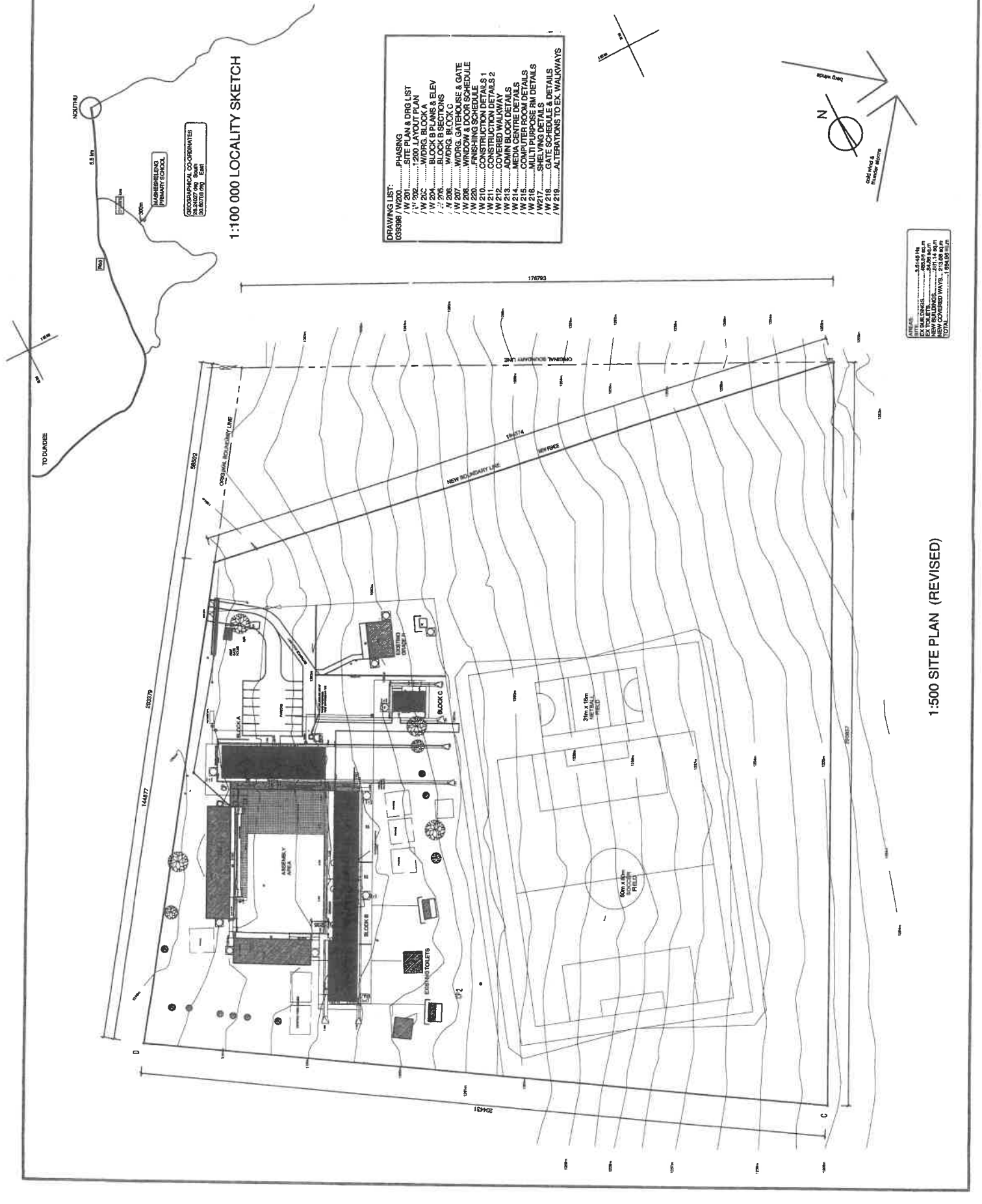

- DRAWING LIST:**
- 0393996 SITE PLAN & DRG LIST
 - /W 201 SITE PLAN & DRG LIST
 - /W 202 1:200 LAYOUT PLAN
 - /W 203 WDRG. BLOCK A
 - /W 204 BLOCK B PLANS & ELEV
 - /W 205 BLOCK C PLANS & ELEV
 - /W 206 WDRG. BLOCK A
 - /W 207 WDRG. BLOCK B
 - /W 208 WDRG. GATEHOUSE & GATE
 - /W 209 WINDOW & DOOR SCHEDULE
 - /W 210 FINISHING SCHEDULE
 - /W 211 CONSTRUCTION DETAILS 1
 - /W 212 CONSTRUCTION DETAILS 2
 - /W 213 COVERED WALKWAY
 - /W 214 ADMIN BLOCK DETAILS
 - /W 215 MEDIA CENTRE DETAILS
 - /W 216 COUNSELLOR ROOM DETAILS
 - /W 217 COUNSELLOR ROOM DETAILS
 - /W 218 SHELTER DETAILS & DETAILS
 - /W 219 GATE SCHEDULE & DETAILS
 - /W 218 ALTERATIONS TO EX. WALKWAYS

AREA:	21 410 m ²
EX. BUILDINGS:	465 m ²
NEW BUILDINGS:	24 945 m ²
NEW COVERED WAYS:	21 000 m ²
TOTAL:	1 064 300 m ²

1:500 SITE PLAN (REVISED)

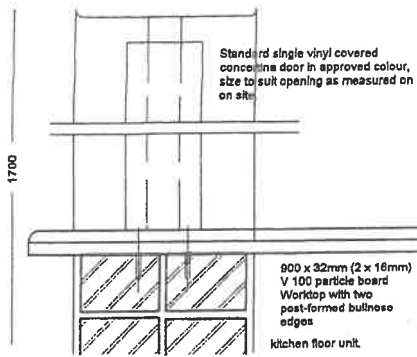

DETAIL SECTION X

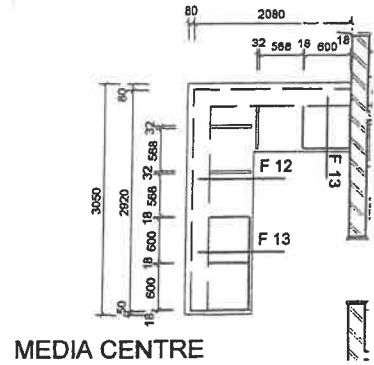

MEDIA CENTRE

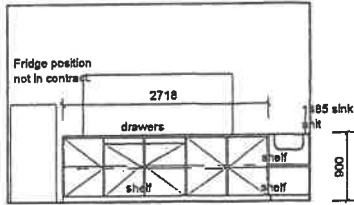

ELEVATION

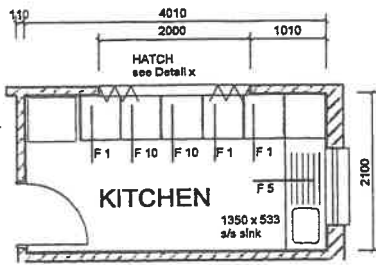

DETAIL PLAN OF KITCHEN

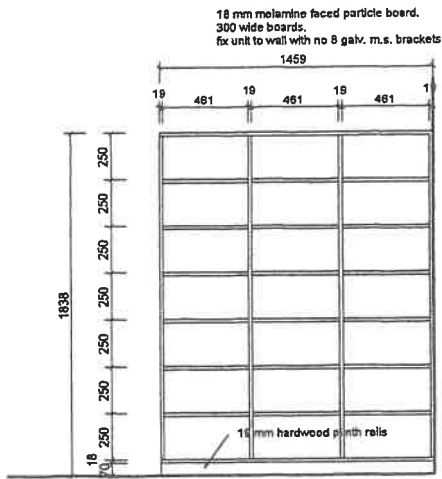

ELEVATION OF PIGEON HOLE UNIT

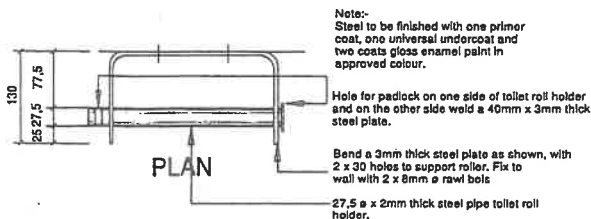

PLAN

ELEVATION

DETAIL TOILET ROLL HOLDER

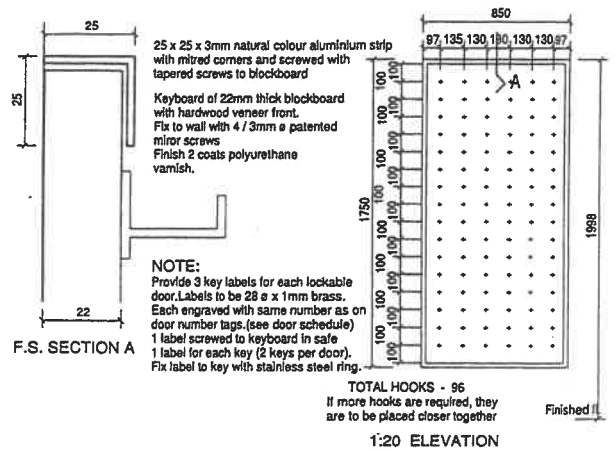

F.S. SECTION A

1:20 ELEVATION

Q 4: DETAIL OF KEY BOARD

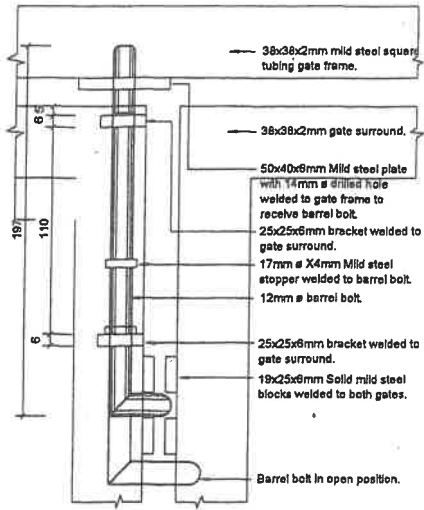

ELEVATION

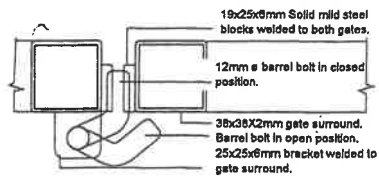

SECTION

BARREL BOLT

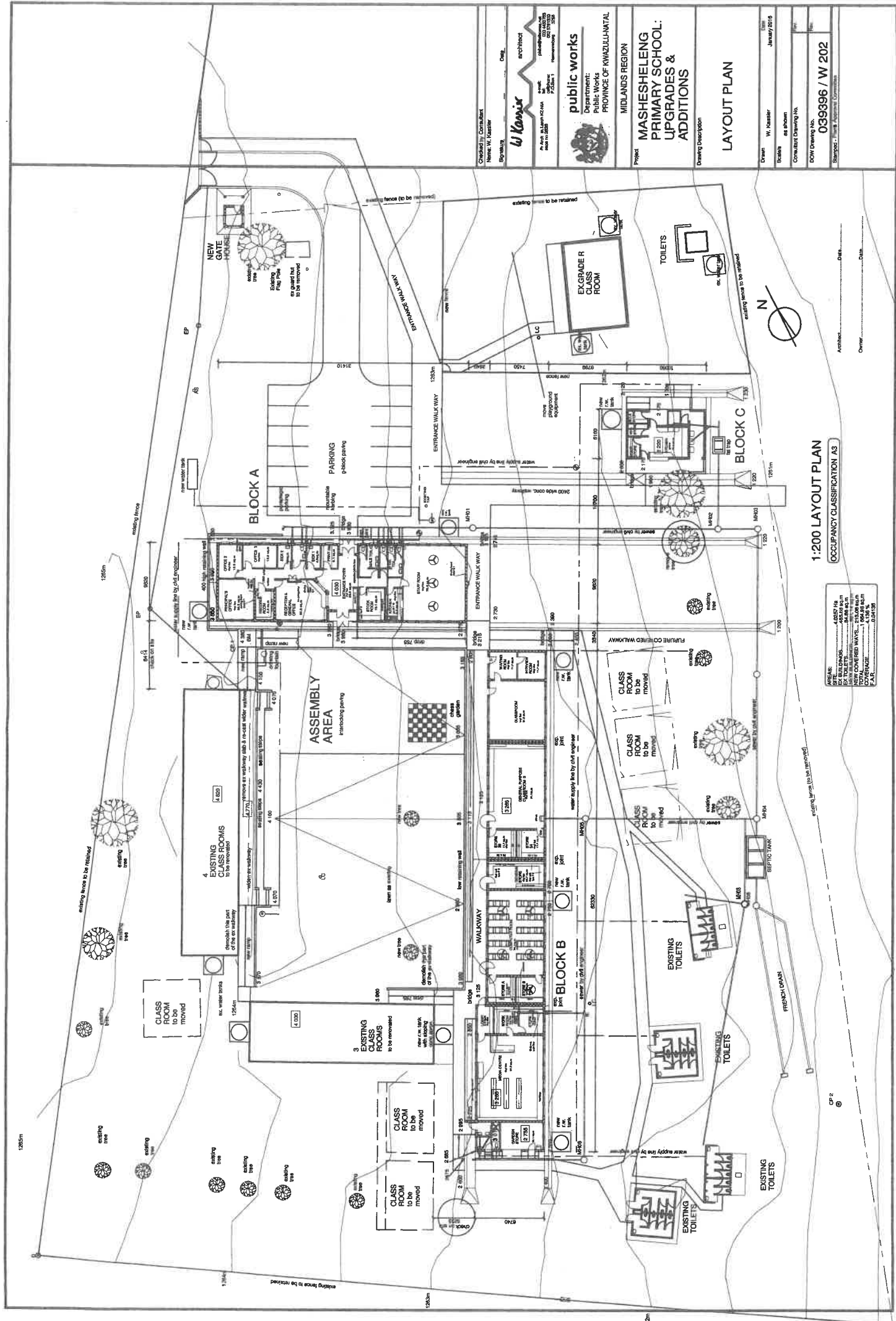

Checked / Consultant
Name: W. Koster
Signifying

architect
W Koster
P.O. Box 1414, Clarens, 5620
Tel: 051 837 0000
Fax: 051 837 0001

public works
Department:
Public Works
PROVINCE OF KWAZULU-NATAL

MIDLANDS REGION

Project
MASHEHELELE PRIMARY SCHOOL: UPGRADES & ADDITIONS

Drawing Description
LAYOUT PLAN

Drawn
W. Koster

Scale
as shown

Consultant Drawing No.
039396 / W 202

Date
January 2016

Author
D. M. ...

Owner
D. M. ...

1:200 LAYOUT PLAN
OCCUPANCY CLASSIFICATION A3

NOTES:

AREA	4 000 m ²
PERMITTED BUILDING	4 000 m ²
PERMITTED COVERED WALKWAY	1 000 m ²
TOTAL PERMITTED WALKWAY	1 000 m ²
TOTAL PERMITTED WALKWAY	1 000 m ²
TOTAL PERMITTED WALKWAY	1 000 m ²
TOTAL PERMITTED WALKWAY	1 000 m ²

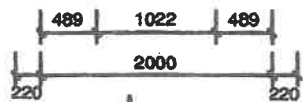
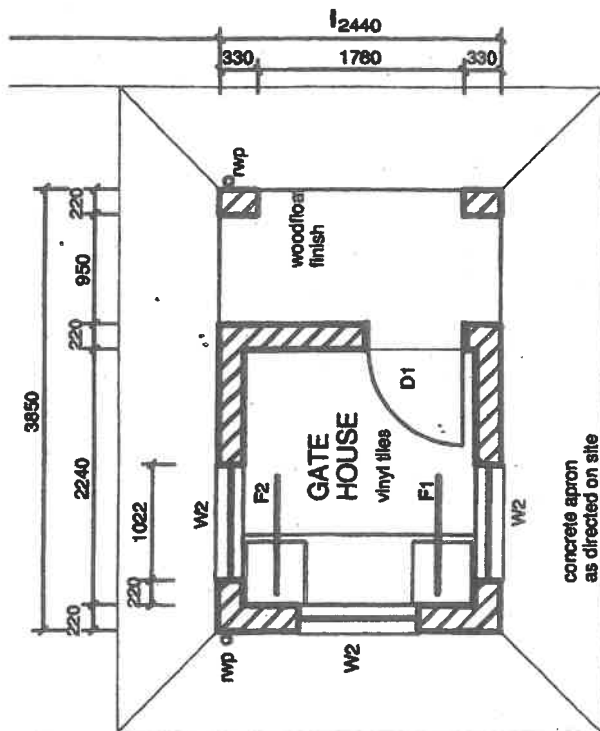

1:50 PLAN

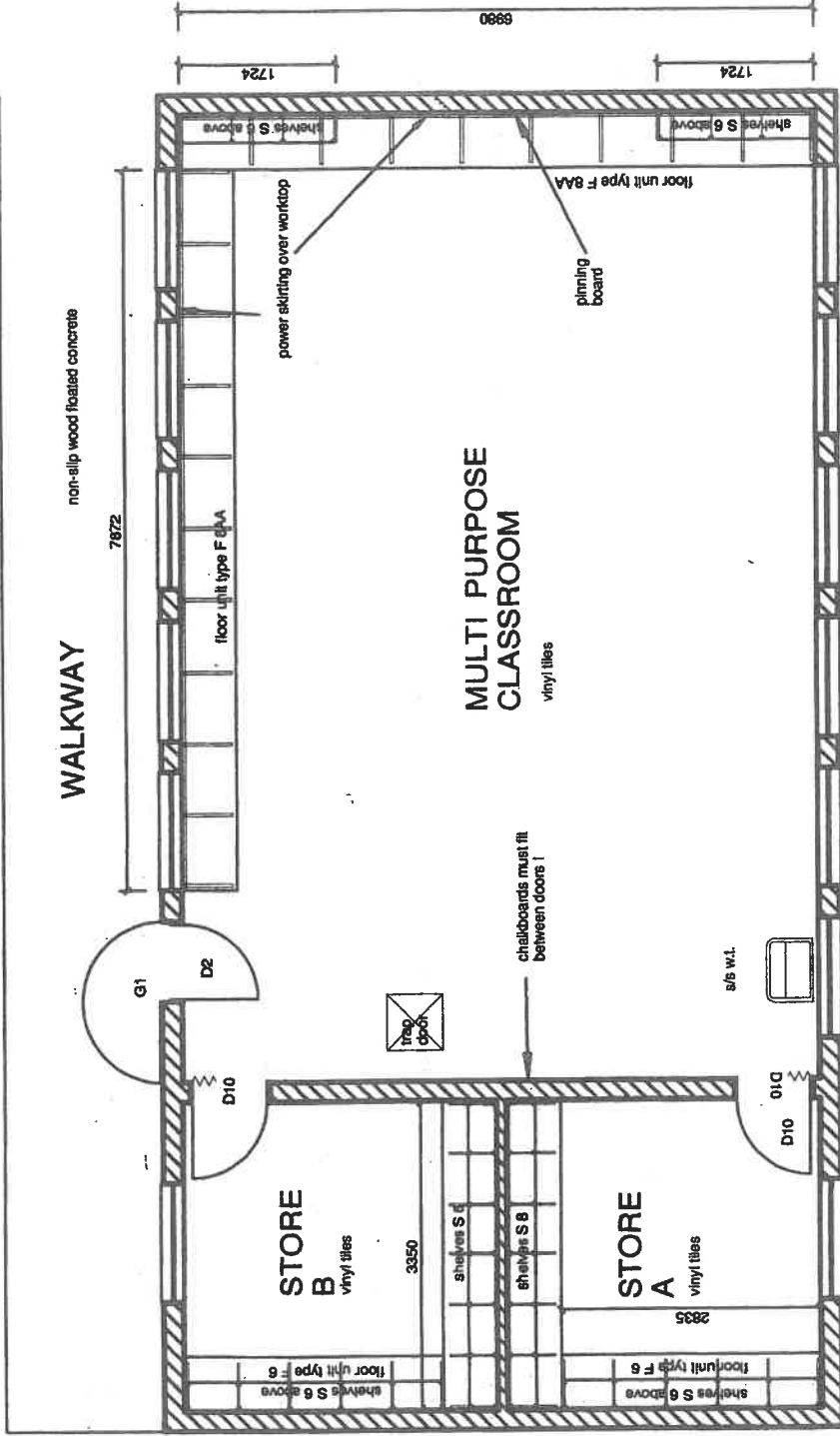

1:50 PLAN

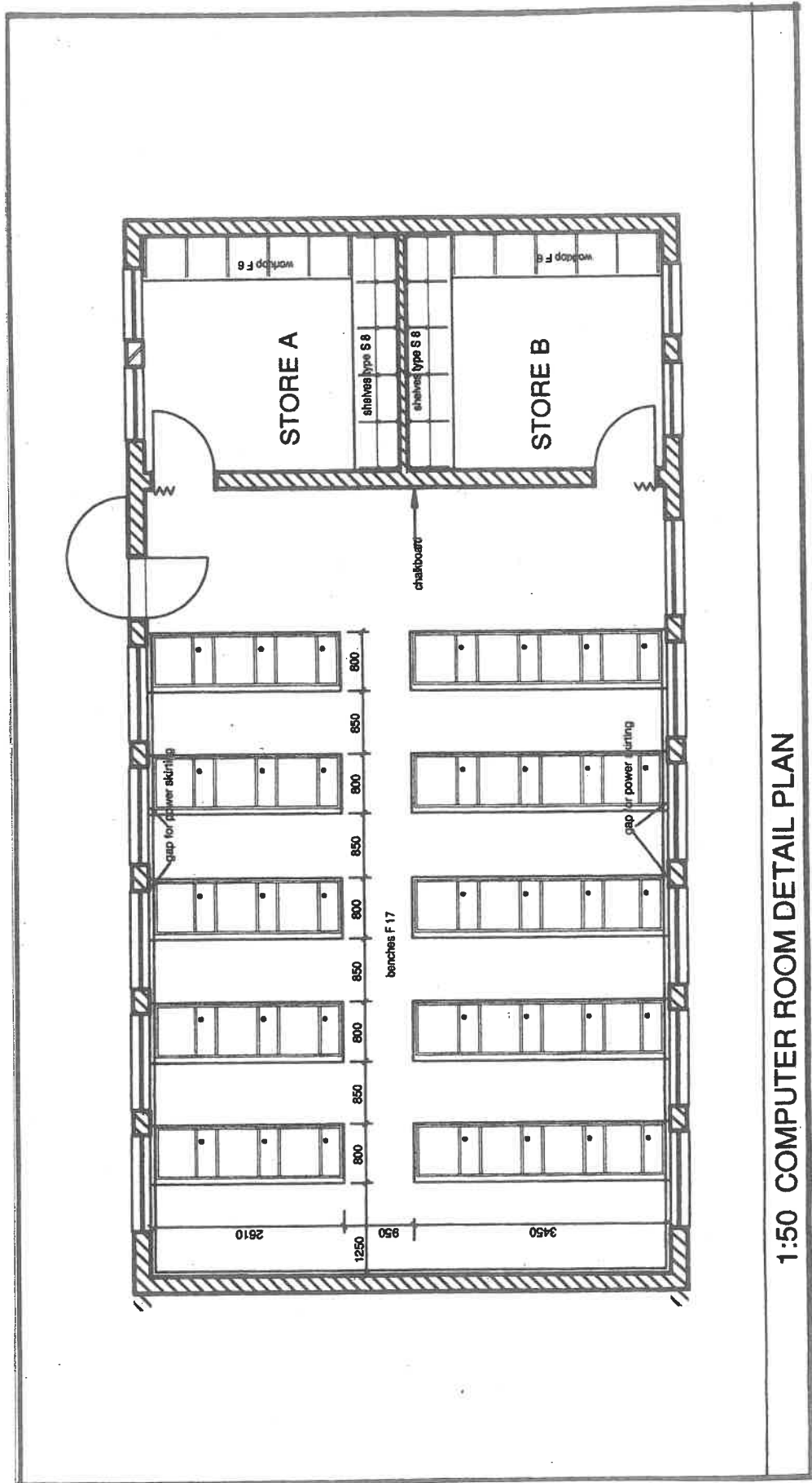

1:50 COMPUTER ROOM DETAIL PLAN

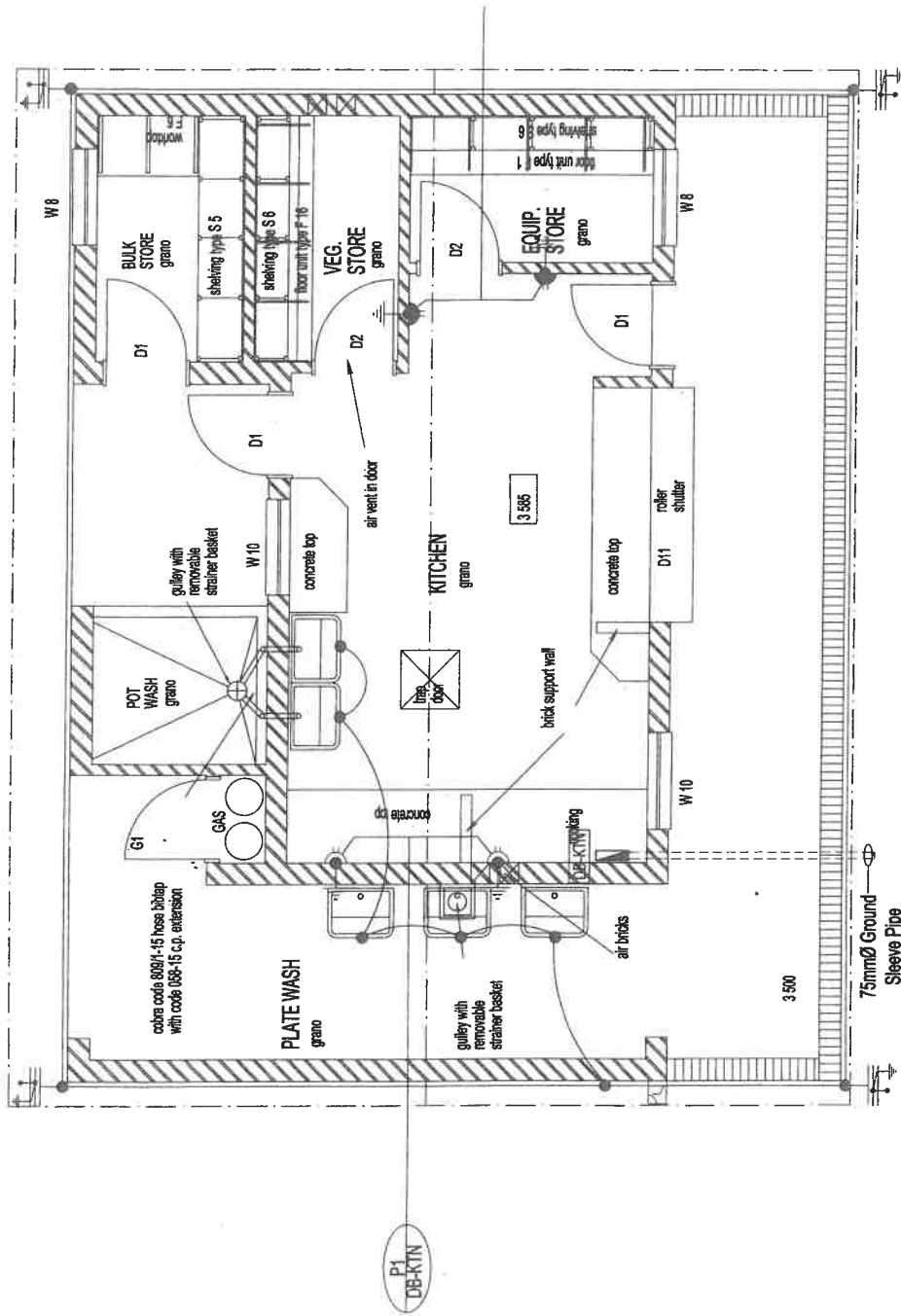

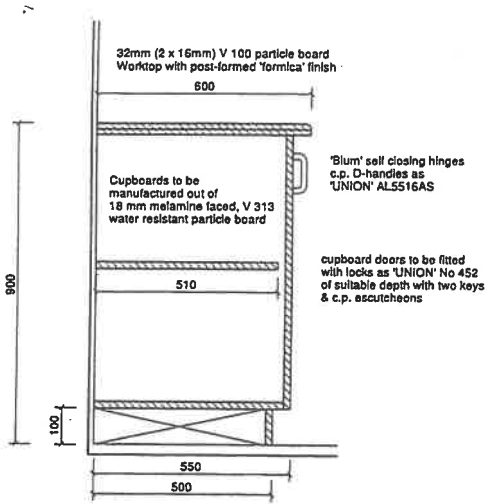

DETAIL SECTION F1

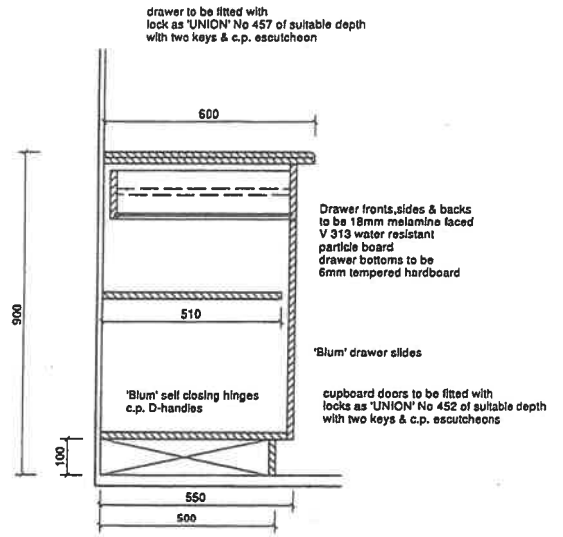

DETAIL SECTION F2

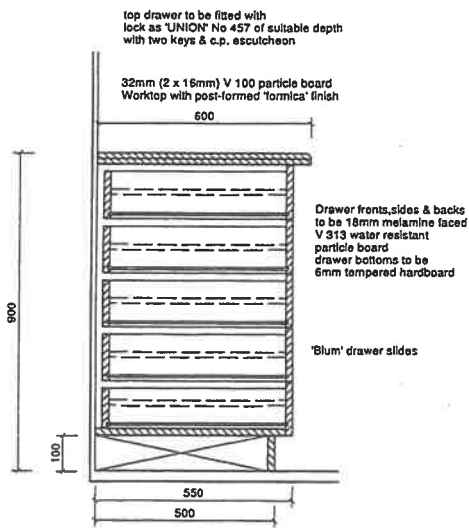

DETAIL SECTION F3

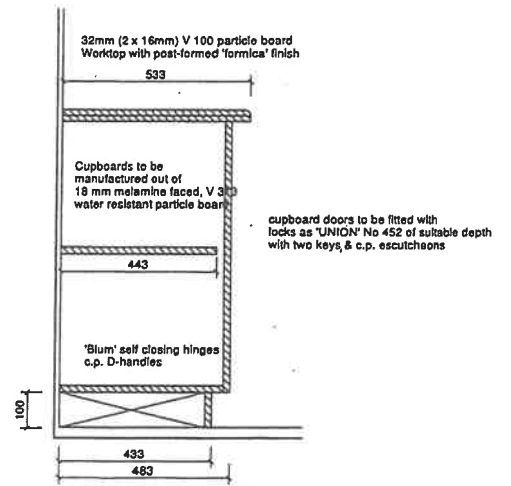

DETAIL SECTION F4

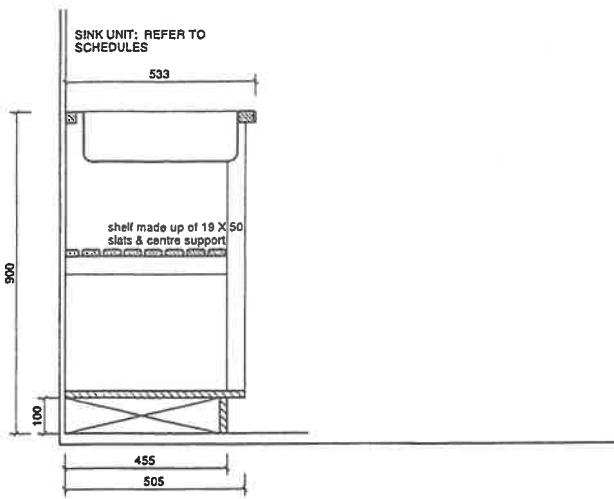

DETAIL SECTION F5

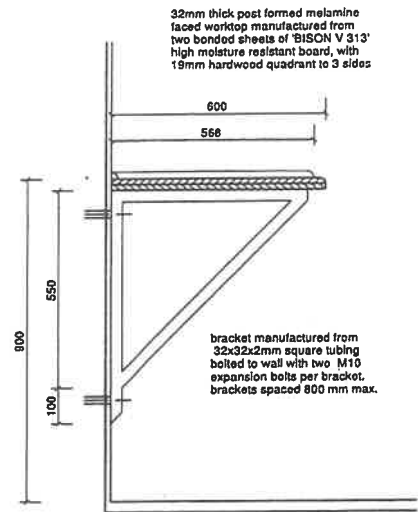

DETAIL SECTION F6

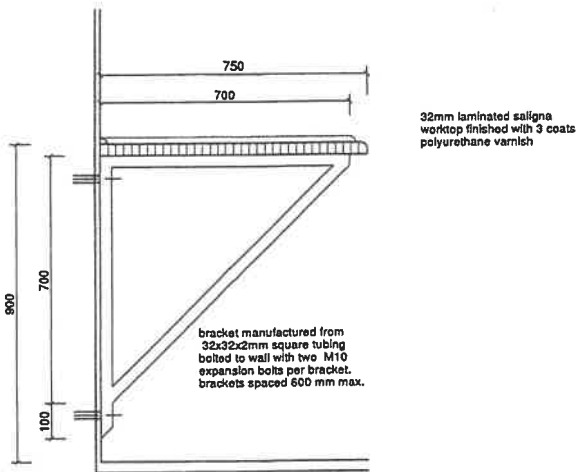

DETAIL SECTION F7

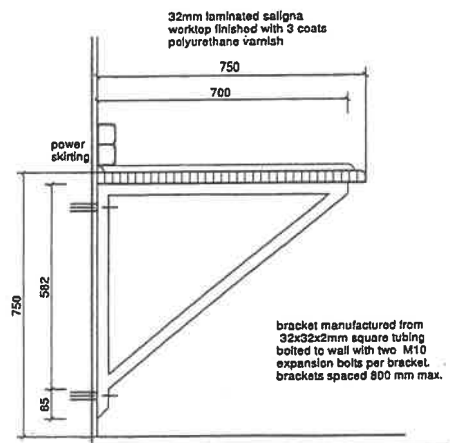

DETAIL SECTION F8

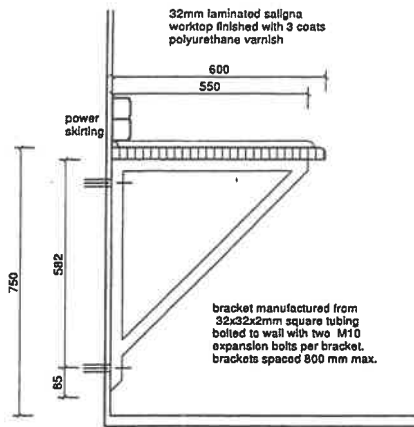

DETAIL SECTION F8AA

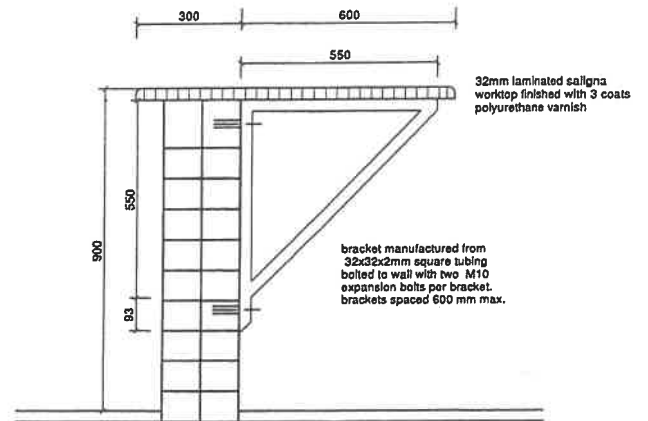

DETAIL SECTION F9

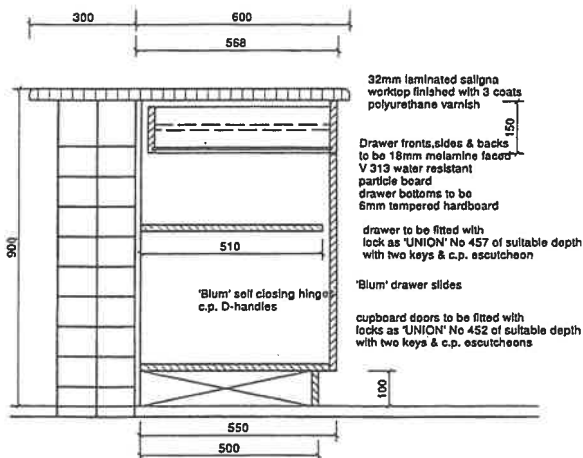

DETAIL SECTION F10

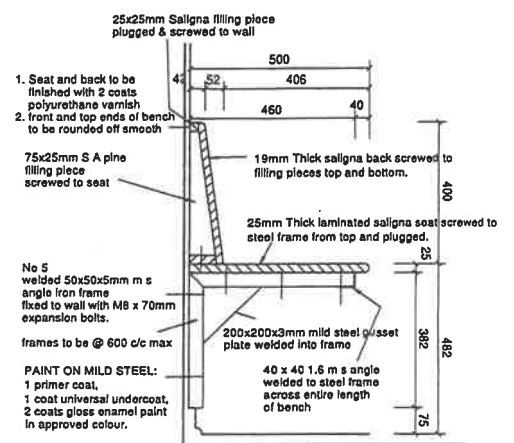

DETAIL SECTION F11

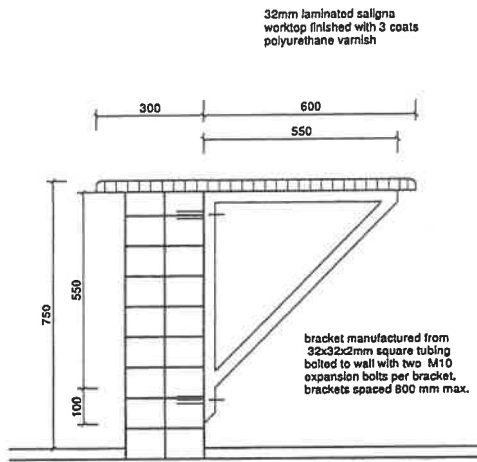

DETAIL SECTION F12

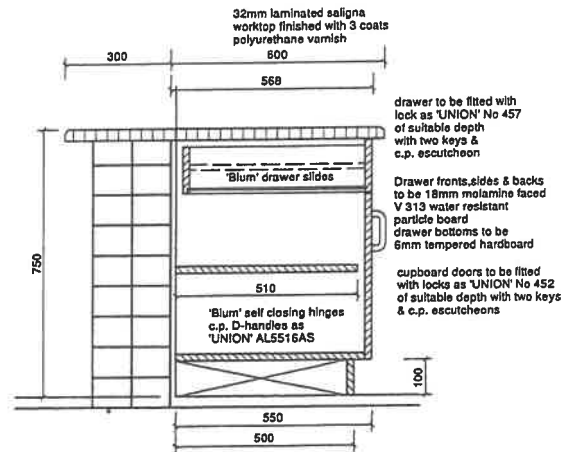

DETAIL SECTION F13

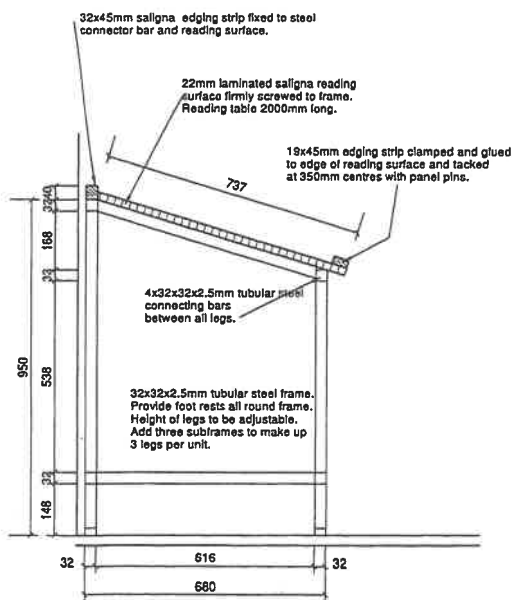

DETAIL SECTION F14

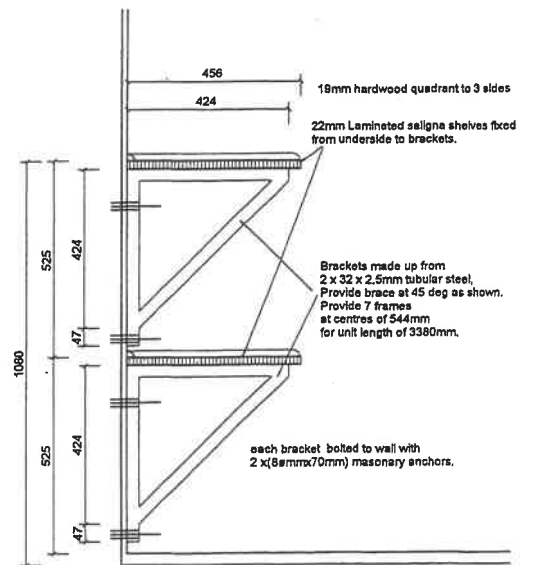

DETAIL SECTION F15

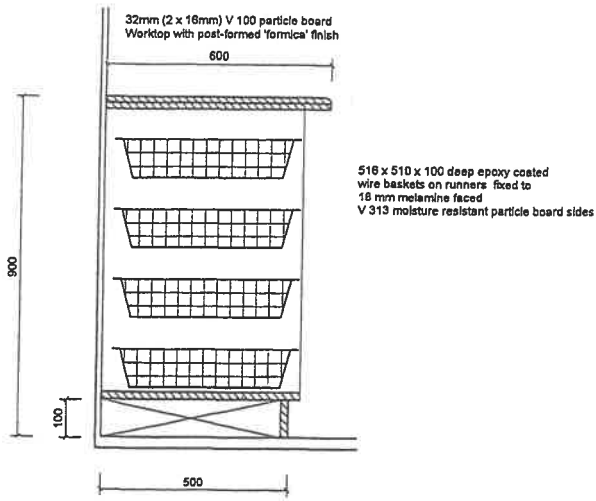

DETAIL SECTION F16

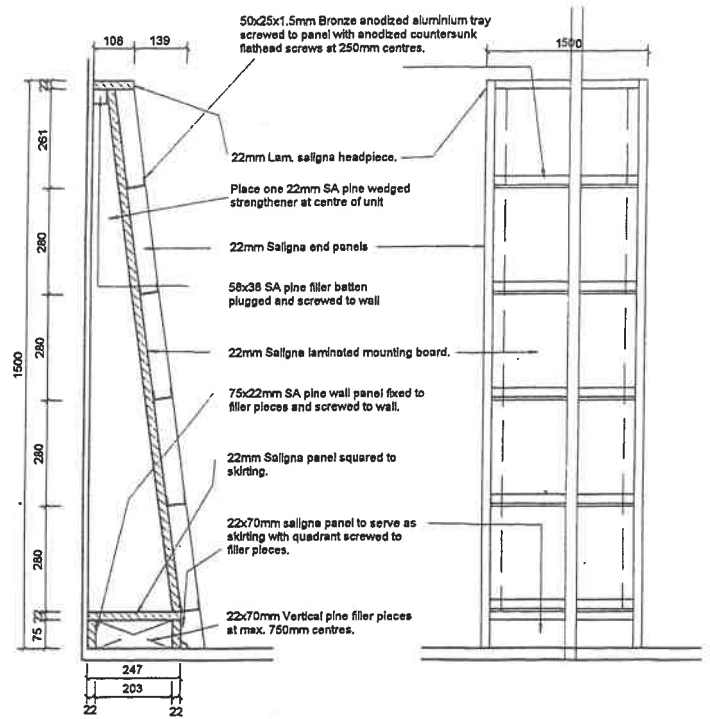

DETAIL SECTION F18 FRONT ELEVATION

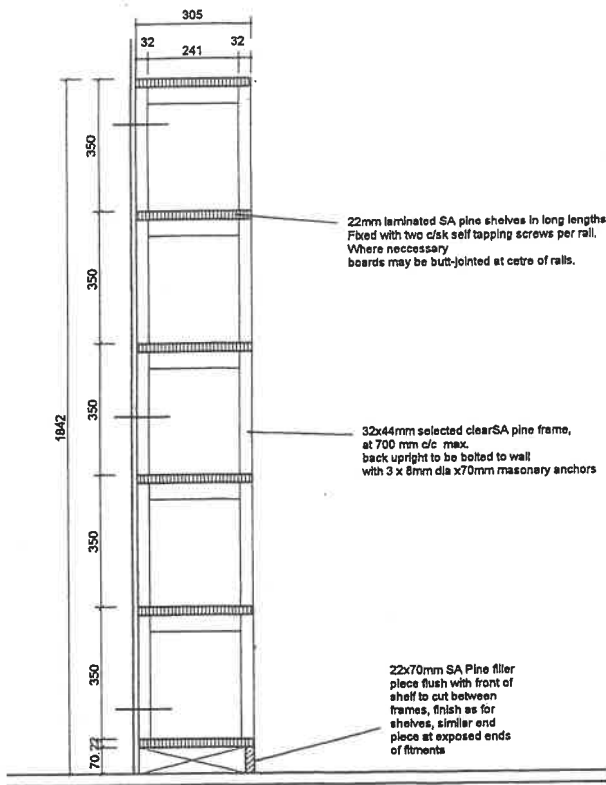

SECTION S 2

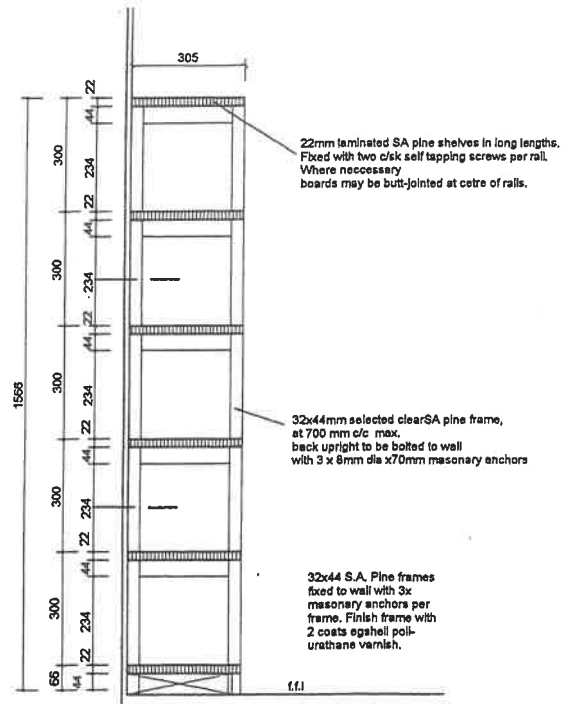

SECTION S 3

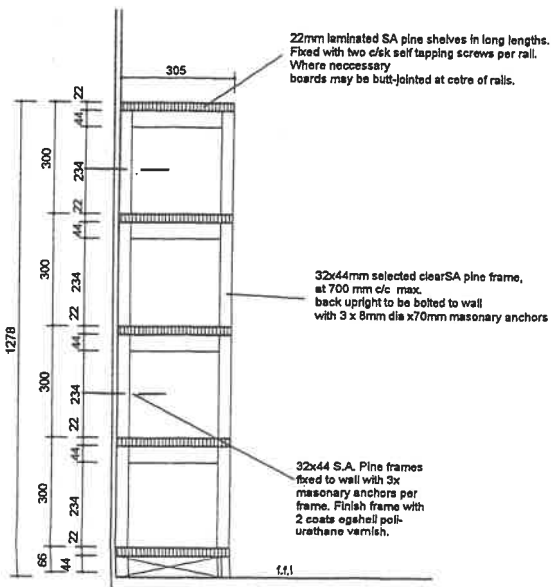

SECTION S 4

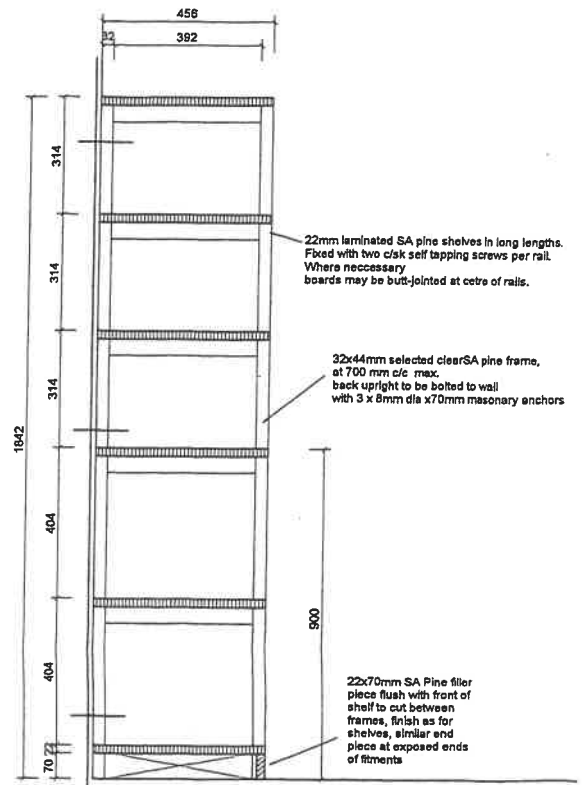

SECTION S 5

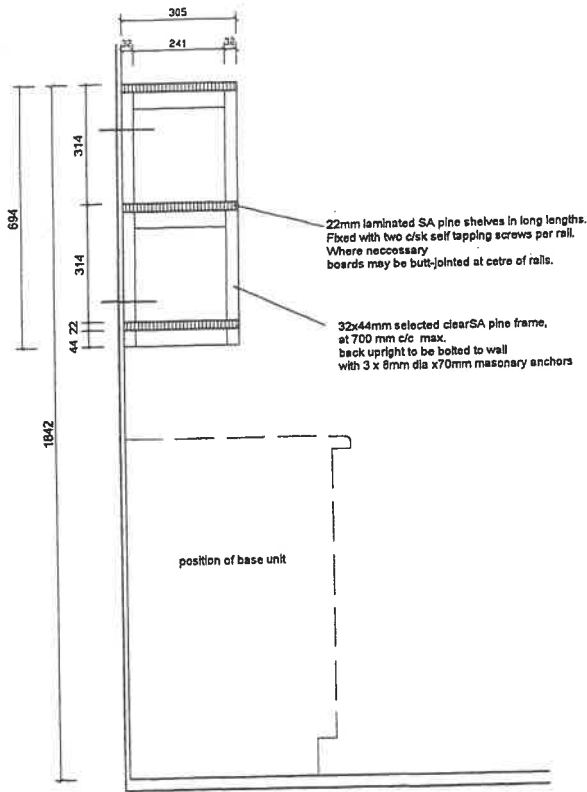

SECTION S 6

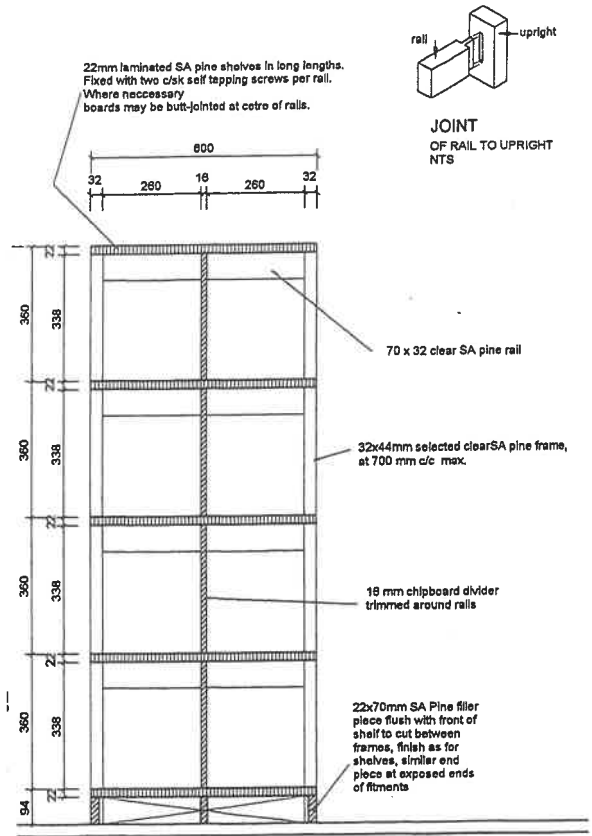

SECTION S 7

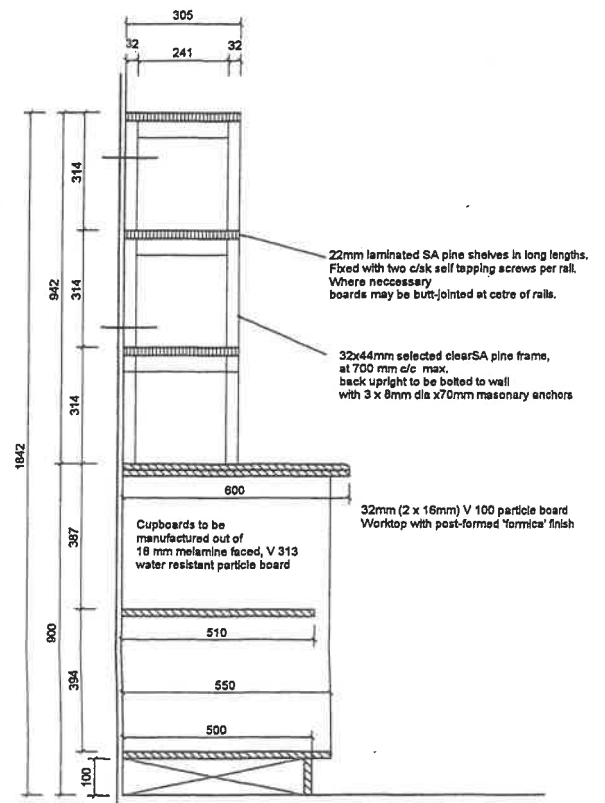

SECTION S 8

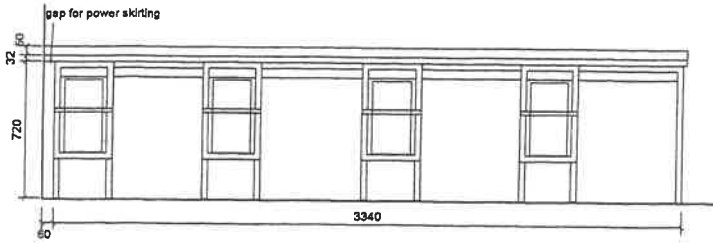
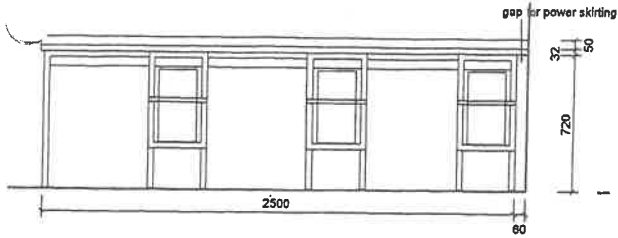

COMPUTER BENCH ELEVATIONS

"HAMMERITE" FINISHED FRAMEWORK
 30 x 30 x 2,5mm Tubular sections neatly welded to form frame to take worktop.
 Frame top member to be 10mm and 5mm drilled to allow for screwdriver to reach through the frame from below to fix 5mm wood screws to worktop. Allow for 4 no. fixing points to each frame top member.

30 x 30 x 2,5mm tubular section frame supports at front and rear of the table will also be 10mm and 5mm drilled to allow for screwdriver to reach through the frame from below to fix 5mm wood screws to worktop.

Weld 90 x 30 x 4mm flats to legs 10mm drilled for 10mm Dyna bolt fix. Frame to be finished with "Hammerite" paint in accordance with manufacturer's specifications, prior to installation.

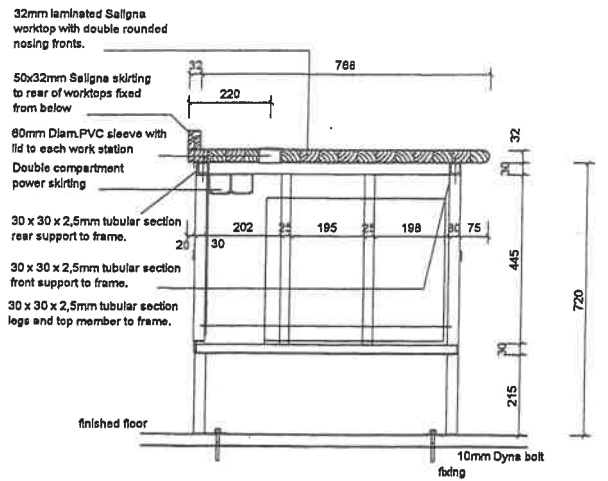

SECTION THROUGH BENCH F17

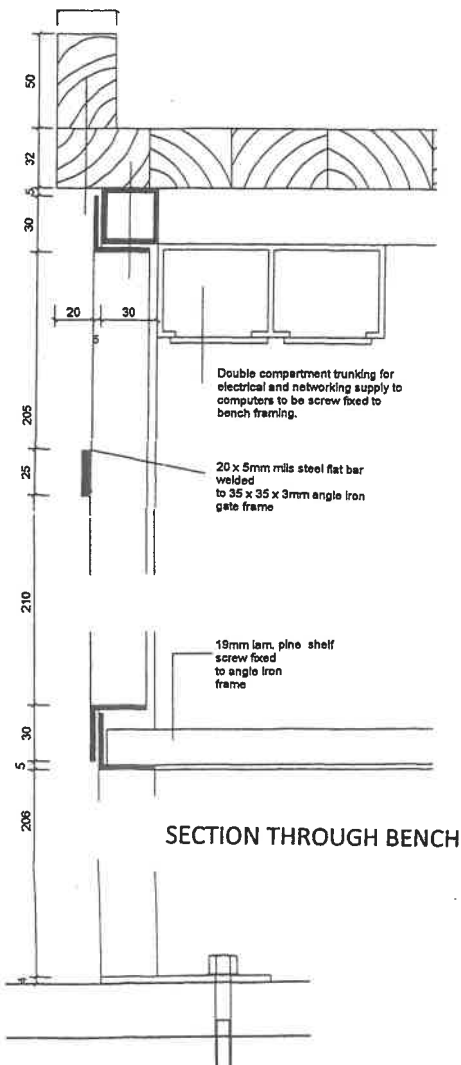

SECTION THROUGH BENCH

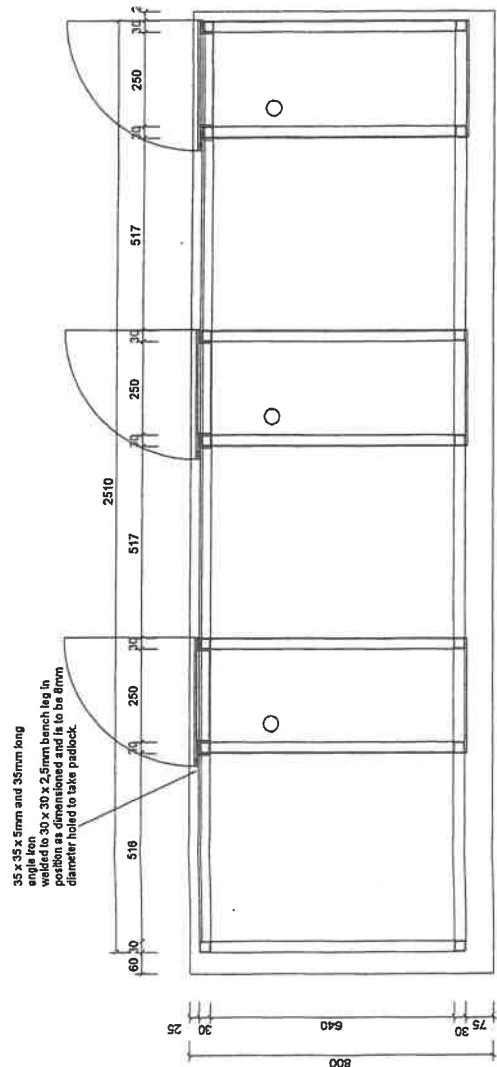

DETAIL PLAN OF 3 STATION COMPUTER BENCH

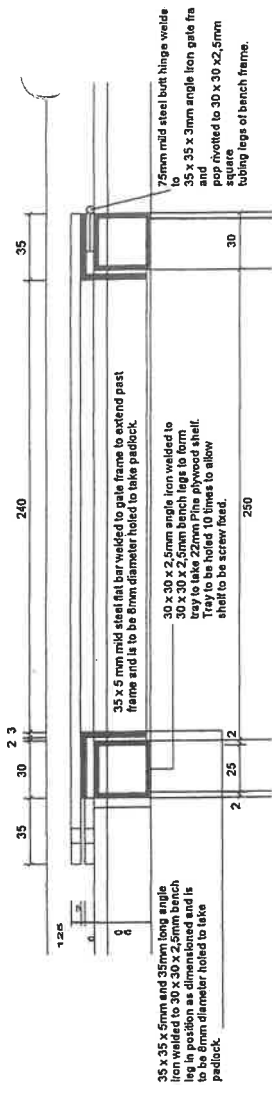

PLAN OF GATE TO BENCH

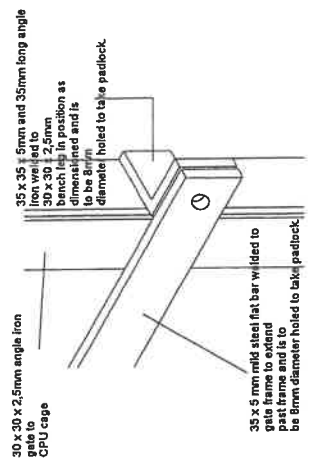

LOCKING DETAIL

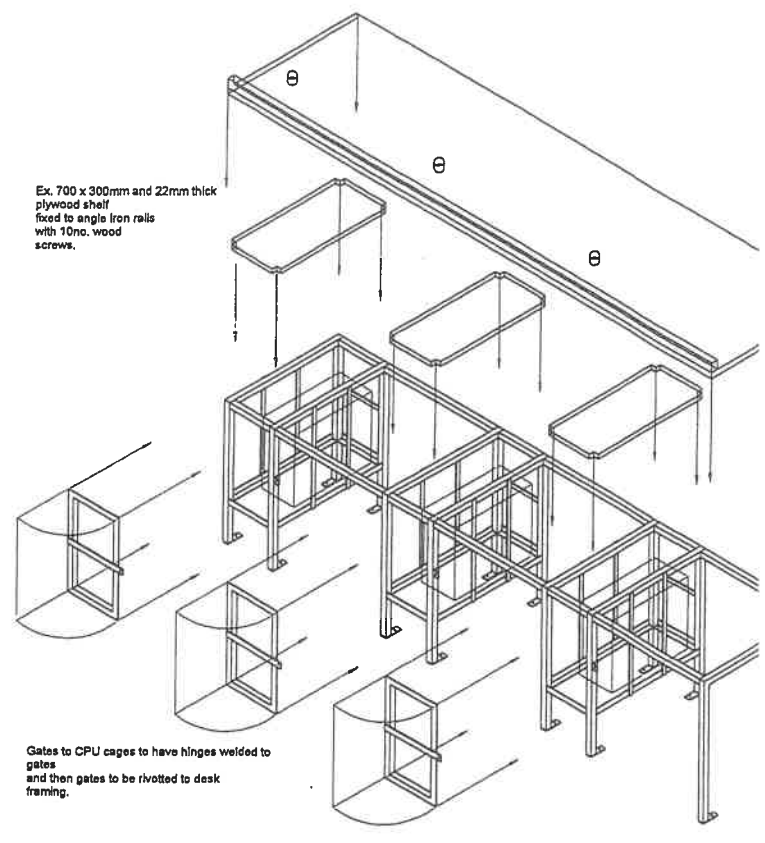

ISOMETRIC VIEW OF COMPUTER BENCH ASSEMBLY



KWAZULU-NATAL PROVINCE
PUBLIC WORKS
REPUBLIC OF SOUTH AFRICA

**NQUTHU (KWAZULU NATAL) - MASHESHELENG PRIMARY SCHOOL: COMPLETION OF
ADMINISTRATION, MULTI-PURPOSE CLASSROOM AND KITCHEN BLOCKS INCLUDING
CONSTRUCTION OF NEW GUARD HOUSE, THREE TOILET BLOCKS, PARKING FACILITIES,
PATHWAYS AND FENCING**

**ANNEXURE 2
GENERAL ELECTRICAL SPECIFICATION**

GENERAL ELECTRICAL SPECIFICATION

(ALL IN CONTRACTS)

1. CONDUIT AND CONDUIT ACCESSORIES

1.1 Conduit

Conduit shall be of steel galvanised internally and externally, either solid drawn, or welded and not less than 20 mm diameter, with all rough edges removed. All tube ends removed. All tube ends are to be reamed. With screwed conduit one threaded end is to be fitted with a coupling and the other end is to be protected against damage.

UPVC conduit may only be used if permitted by the Head : Works and only in those areas which he may specify. In this case this conduit shall be according to SABS 950.

Conduit accessories, which are secured to the conduit by means of lugs, screws or setscrews, are not acceptable.

General requirements of conduiting to SABS IEC 60614 (1).

Metal conduits shall be fully in accordance with SABS 1065 PART I.

1.2 Conduit Accessories

All conduit accessories shall be galvanised both internally and externally and comply with SABS 1065 – PART II.

All screwed conduit fittings shall be of malleable cast iron.

Where fittings are fitted with covers, the covers shall be of galvanised pressed steel secured with brass screws.

1.3 Flexible Conduit

Flexible conduit shall be of the plastic covered metal type complete with brass connectors to the approval of the Head : Works.

2. INSTALLATION OF CONDUIT

2.1 General

Except where cables are specified for certain circuits, the installation(s) shall be tubed throughout in steel conduit. Split conduit is not permitted. All conduits shall, wherever possible, or unless otherwise specified or agreed, be concealed in the structural work.

Except where agreed or otherwise specified or indicated on the drawings, all conduit to points shall run via the ceiling and floor slabs or roof space. In damp situations and where exposed to the weather, the conduits shall be so installed as to avoid, as far as possible, the condensation of moisture within them. All running joints are to be painted with an approved metal primer.

Mechanical and Electrical continuity must be maintained throughout the installation. Each length of conduit and every conduit fitting must be inspected for defects and all sharp edges or burrs must be removed before it is installed. All joints are to be tightly fitted together.

Running joints with long threads, where used, are to be fitted with a lock nut and the running thread shall not be longer in length than a coupling and lock unit.

In conduits smaller than 32 mm elbows and normal bends are not to be used but conduits are to be set to the required angles.

Flexible connections between conduit and appliance or other equipment shall be by means of flexible tubing (see Par 1.3).

No wiring shall be drawn into conduits until the conduits have been installed.

Where more than one socket outlet is connected on a circuit, the conduit shall be looped from the one outlet box to the following outlet box.

All switch-boxes, socket outlet boxes and any other purpose made metal box including distribution board trays shall be suitable treated against corrosion before installation with "Rustodian" or other approved metal primer.

All conduits shall be securely fixed into chases, and all flush switch and socket outlet boxes must be firmly embedded in cement mortar.

The Contractor shall make himself familiar with the positions of all fittings, such as blackboards, pinning boards, cupboards, shelving, worktops, etc, before commencing the conduit installation. The position of switches and socket outlets as indicated on the drawings are approximate only. The Contractor must verify that the final position of these will not be covered by the installation of the fittings referred to above, or come midway between the junction of any dados and upper wall finishes.

No extras will be entertained for moving switches or socket outlets as a result of the Contractor's failure to verify the final positions of the fittings or type of wall finish.

2.2 In Roof Spaces

The conduit in roof spaces shall be installed parallel or at right angles to the roof truss members and shall be secured at centers not exceeding 1,2 m by means of galvanised saddles nailed to the timbers with galvanised clout nails. Crampets will not be allowed.

Crossing of conduits is to be avoided wherever possible. Where unavoidable, one conduit must be neatly set over the other. Where a number of conduits have to run back to the distribution board or switchboard, they shall run parallel to the distribution board or switchboard, and at saddle distance to each other wherever possible.

Conduit runs from distribution boards shall terminate in fabricated sheet steel draw boxes installed in the roof above the distribution boards. Each draw box shall be fabricated from 1,6 mm galvanised sheet steel with welded corners and suitably treated against corrosion with "Rustodian" or other approved primer and finished in aluminium paint.

Each draw box is to be fitted with slip-on lid with a 13 mm skirt. The box shall be 75 mm deep, shall be rectangular in shape and the size of conduits entering or leaving the box. Conduits shall be fixed to the box by means of couplings and brass male bushes or lock nuts and brass bush-nuts.

Conduit droppers shall be neatly cut into timber wall plates and set to face the right direction. All sets must be uniform. Conduits may be set at angles only where droppers or ceiling points are within 230 mm of roof members.

No conduits are to be run over the top of gangplanks or trapdoors.

Draw-in boxes with metal covers shall be provided where required and shall be installed near the gangplanks, if any. All inspection conduit fittings in open roof spaces shall face upwards to facilitate wiring and to permit easy inspection. Three-way conduit boxes shall be used for tee-off purposed in open roof spaces. Inspection tees are not to be used except where otherwise agreed or specified.

All conduits extended into a roof space with a roof clearance of more than 900 mm shall be set onto the beam and extended into the roof for a distance where there is sufficient clearance. Under flat roofs or where there is less than 900 mm clearance, the conduit shall be installed as specified for tubing in concrete slabs, right angle bends should be kept to a minimum and the shortest route taken.

Where false ceilings occur they shall be tubed as called for in the detailed specification. Conduits in restricted spaces and run as for concrete slabs must however, be installed in a neat and orderly manner.

Conduits to ceiling points for all types of fittings must be firmly supported and shall terminate in a back entry conduit box. The conduit box shall be taken through to the face of the ceiling and finish flush. Where the ceiling brandering interferes with the installation of the ceiling point specified, the Contractor must trim the brandering to allow the conduit box to be taken through to the face of the ceiling as specified. Luminaires must be bonded to the conduit box by means of metal threaded screws.

2.3 In Concrete Slabs

In order not to delay building operations, the Contractor must ensure that all conduits and conduit fittings, which are to be cast in concrete, are laid in good time. The Contractor shall have a competent Electrical Artisan standing by during casting of concrete, etc, to ensure that the conduit boxes are not damaged during casting of concrete.

Draw boxes, expansion joints boxes and round conduit boxes are to be provided where necessary.

Deep type conduit boxes shall be used for side entering conduits and normal shallow boxes may be used for back entry conduits. No elbows, bends or sharp sets will be allowed in concrete slabs except in cases of conduits of 40 mm diameter or when larger sweeping bends will be permitted.

Common drawn and/or inspection boxes shall be used where there is more than one circuit involved. They shall be installed in lavatories, storerooms, or other inconspicuous places. Covers shall be of hardboard neatly finished to match the finished ceiling or wall surface, and shall be fitted parallel to the wall or ceiling.

All boxes, etc. are to be securely fixed to the shuttering to prevent displacement when concrete is cast. All conduits must be laid off the deck, supported and secured at regular intervals and installed as close as possible to the neutral axis of concrete beams and slabs.

Expansion joints shall be shown on layout drawings and shall consist of a metal box in which one conduit is fixed and the other capable of movement with the building's expansion and contraction. Earth continuity of these joints shall be maintained by means of stranded copper conductors bonded to the conduits in the box as shown on the drawing.

Earth conductors and clamps buried in concrete are not permitted.

Conduits must be spaced sufficiently apart to allow for proper concreting. All joints shall be painted with an approved metal primer after completion of the tubing installation, prior to the concreting. All exposed parts of the conduit installation shall be suitably, protected against corrosion at the discretion of the Head : Works.

Before any concrete slab is cast, all conduit droppers to switchboards shall be neatly spaced and rigidly fixed.

2.4 **Surface Work**

All conduit must be plumbed and leveled and only straight lengths shall be used.

In cases where doorframes are out of plumb, or fittings, beams etc, are out of level, the conduit shall be run parallel with the doorframes, fittings, beams etc.

No threads shall be visible when the conduit installation is complete, except on running couplings.

Running couplings shall only be used where unavoidable and shall be fitted with a sliced coupling as a lock nut.

No inspection or normal bends are to be used on surface work, except with the approval of the Works Inspector and where conduits of 32 mm diameter or larger are used. Conduits shall be set uniformly and inspection couplings shall be used where necessary.

Fittings, tees, boxes, couplings, etc, are to be cut into the surface to allow the conduit to fit flush against the surface or alternatively spacer bar saddles may be used. Conduit is to be bedded into any irregularities to avoid gaps between the surface and the conduit.

Double sets, where used, shall be parallel with no twists and shall be as short as possible. All conduits, which terminate at metal trays, boxes, industrial switches and plugs shall do so by means of couplings and male bushes. No couplings will be permitted in droppers of lengths less than 3.6 m.

Where crossings of conduits is unavoidable, purpose made metal boxes shall be used. The length of the box is to be 8 times the diameter of the largest conduit, the width one and half times the sum of the diameter of all the conduits, and the depth one and half times the diameter of the largest conduit with a minimum depth of 50 mm. The box shall be fitted with a neatly fitting cover and the finish shall be in keeping with the general layout.

Where a number of conduits are to be installed in parallel they shall be evenly spaced and grouped under one purpose made saddle. Conduit spacing shall not exceed 10 mm. The purpose made saddle shall be made of 25 x 2 mm galvanised steel strip or other approved material, formed to suit the curvature of the various conduits and shall be drilled and fixed by means of screws between. Saddles shall be spaced at intervals not exceeding 1.8 m, except for conduit droppers, which shall be saddled centrally between ceiling and accessory box. All saddles are to be secured to the wall by means of black japan or brass rounded head screws. Distribution boards, draw boxes, industrial switches and plugs, etc, shall be neatly recessed into the surface of plastered walls to avoid double sets or alternatively spacer bar saddles may be used. On face brick walls the conduit shall be tightly set into the switch or plug.

In situations where there are not ceilings, the conduits are to be run along the wall plates and tie beams.

No wiring is to be carried out until the tubing has been inspected and approved.

Where spacer bar saddles are used, these shall be installed at centers of 1 m for horizontal and 1.5 m for vertical runs.

All conduits shall be painted with an approved enamel paint to match the background colour.

2.5 Future Extensions

In roof spaces with a minimum clearance of 900 mm, switch and plug drips for future use are to be set 300 mm in the correct direction and shall be threaded and fitted with plugged couplings. Where the roof over a slab is to be removed for future expansions, conduits for future use are to terminate 40 mm above tie beams and shall be threaded and fitted with plugged couplings.

Where future extensions are to be below slabs, all switch, socket outlet and other conduit droppers are to terminate 130 mm below slabs or beams with conduit ends threaded and fitted with plugged couplings.

Where provision is made for future extensions to a concrete slab, all conduits required for future use are to project 130 mm from the slab. Conduit projections are to be painted with an approved anti-corrosive paint and must be fitted with plugged couplings.

All switch, plug and other outlet boxes required for future use shall be fitted with approved blank cover plates.

Unused lighting outlet boxes are to be fitted with round hardboard or plastic covers with brass cover screws, which shall fit flat on the finished ceiling.

2.6 Fixing of Conduits

Conduits shall be fixed to switch and socket outlet boxes by means of couplings and brass male bushes or lock nuts and brass bush nuts. Couplings and male bushes to be used on all surface work.

2.7 Chases and Building Work

Except where otherwise specified conduits, switch boxes, plug boxes and distribution boards are to be built into the brick walls by the Contractor. It will, however, remain the responsibility of the Contractor to ensure that the above-mentioned boxes and distribution boards are correctly built in and are firmly bedded and cemented into the walls, plumb and square.

The Contractor shall, unless otherwise specified, do all necessary chasing and cutting of bricks. All electrical materials (e.g. conduits up to 40 mm for UG cables, conduits, conduit boxes, distribution boards etc) must be supplied by the Contractor who must arrange to have these on site, and positioned when required for the building work. A competent Electrical Artisan must be in attendance and ensure that the conduits etc are correctly installed and positioned.

The Contractor is to ensure that tubing installed in chases is securely nailed and covered by a layer of 5:1 mixture of coarse sand and cement, finished flush with brickwork and that switch and plug boxes finish flush with the finished wall surface.

The Contractor is to ensure that below distribution boards connected by means of underground cables, a 230 mm wide by 115 mm deep cavity in the wall from the cable pipe to the distribution board is to be provided by the Contractor, or alternatively, cable sleeves as specified.

3. PLUGGING OF WALLS

Only approved plastic plugs shall be used to secure conduit or equipment up to 5kg mass. The use of round-headed screws only will be permitted.

Heavier equipment shall be secured by means of approved expansion bolts.

Wood plugs and any plugs in the joints in brick walls are not permitted.

4. FIXING TO CONCRETE CEILINGS

Ceilings mounted equipment other than luminaires shall be secured to concrete ceilings by means of expansion bolts, shot bolts or "Robot" tools bolts or as expressly specified for the service.

5. WIRING

5.1 PVC Insulated Single Core Medium Voltage Conductor

The conductor is to be of high conductivity copper wire insulated with Polyvinyl Chloride. The cable shall be finished in the required colours and shall be in accordance with SABS 1507 and 1574.

Circuit wiring shall be of the Loop-in system and no wiring joints in the conduit or conduit fittings will be permitted. Not more than two conductors of a kind will be allowed at any outlet point. The end strands of cables, whether single or looped which have to be connected to terminals of switched, plugs, lamp-holders, fittings and distribution boards, etc, are to be tightly twisted together. Cutting away of wire strands of any cable will not be allowed. Only one circuit in any one conduit will be permitted unless otherwise specified.

Conductor sizes shall be as follows except where otherwise specified:

Lighting circuits	1,5 mm ²	
Bells circuits	1,5 mm ²	
Clock circuits	1,5 mm ²	
Incinerator circuits	2,5 mm ²	
Ironing circuits	2,5 mm ²	with 2,5 mm ² insulated earth wire
Plug circuits	4,0 mm ²	with 2,5 mm ² insulated earth wire
Geysers circuits	4,0 mm ²	with 2,5 mm ² insulated earth wire
Heater circuits	4,0 mm ²	with 2,5 mm ² insulated earth wire
Stove	10 mm ²	with 6,0 mm ² insulated earth wire
Motor circuits		
Up to 4kW single phase	4,0 mm ²	with 2,5 mm ² insulated earth wire
Up to 11kW three phase	4,0 mm ²	with 2,5 mm ² insulated earth wire

To avoid deformation of PVC insulated cables at temperatures in excess of 57° C, they shall not be brought directly on to the terminals of appliances such as electric heaters, or any other electrical appliances or apparatus (including luminaires) which have a temperature in excess of 57° C. They shall terminate in a suitable terminal box as near to the appliance or fittings as possible and connect up from thereon, with heat resistant conductor.

6. MOUNTING AND POSITIONING OF LUMINAIRES

Luminaires and installation to comply with SABS 1464 Parts 1 to 22 and IEC 598-1 and IEC 60598 as applicable.

The contractor shall, in the case of board and acoustic tile ceilings (i.e. as opposed to concrete slabs), ensure that the luminaires are symmetrically positioned with regard to the ceiling pattern.

The layout of the luminaires as indicated on the drawings shall be adhered to as far as possible: The exact positions must be confirmed on site with the Head : Works.

Except where otherwise specified, pendant luminaires are to be mounted with the bottom of the fittings 2,5 m above finished floor level, mounted on either metal discs or wood blocks.

Under no circumstances shall cover strips be cut to accommodate wood blocks. Wood blocks must be neatly slotted to fit over cover strips and are to be secured by a minimum of two screws, which shall penetrate at least 25 mm into solid wood. Ceiling cover strips shall be neatly cut to accommodate fluorescent luminaires.

Where ceilings are raked, all incandescent luminaires are to be mounted on shaped leveling wood blocks securely fixed to the ceiling. Batten holders shall be secured to woodblocks by suitable brass screws. Fluorescent luminaires are to be mounted direct on raked ceiling without leveling blocks.

Fluorescent luminaires to be mounted on concrete ceilings shall be screwed to the outlet boxes and additionally supported by means of 50 x 6 mm expansion bolts. The bolts are to be ¾ of the length of luminaires apart.

Where a number of luminaires are installed end to end, outlet points must be provided after every second luminaire unless otherwise indicated on the drawing.

The luminaires are to be joined together by means of 20 mm conduit nipples, lock nuts and male brass bushes, and the wiring led through the channels of the luminaires. The Contractor shall ensure that all such rows are correctly lined up and that the rows are parallel with the relevant building line.

The luminaires are to be jointed together by means of 20 mm conduit nipples, lock nuts and male brass bushes, and the wiring led through the channels of the luminaires. The Contractor shall ensure that all such rows are correctly lined up and that the rows are parallel with the relevant building line.

Incandescent luminaires are to be screwed directly to outlet boxes in concrete slabs and in board ceilings. In board ceilings the conduit box and the conduit shall be secured to the timberwork of the ceiling in such a manner that it shall support any incandescent luminaire, which is designed to be fixed to a normal conduit box.

Fluorescent luminaires shall be secured to board ceilings by means of the conduit box and 6 mm bolts passing through the boards and brandering.

7. **BATTEN HOLDERS**

B.C. batten holders shall be of brass or moulded plastic reinforced type complete with shade ring. The batten holders shall comply with SABS IEC 60238 and SABS IEC 61184. All lamp holders are to have brass terminals with screw type connection.

8. **LAMP HOLDERS**

Edison screw lamp holders	:	SABS IEC 60238
Bayonet lamp holders	:	SABS IEC 61184
Lamp holders for tubular fluorescent lamps	:	SABS IEC 60400

B.C. screwed lamp holders shall be of brass 20 mm E.T. complete with shade ring and shall comply with SABS IEC 60238 and SABS IEC 61184 with screw type connection terminals.

9. **SWITCHES AND SOCKET OUTLETS**

Switches SABS IEC 60669 as applicable and socket outlets SABS IEC 60884 as applicable shall be of the most modern manufacture and bear the SABS mark.

Flush switch and plug cover plates shall, unless otherwise specified, be of anodized aluminium of thickness not less than 0,9 mm, satin or other approved finish as directed and otherwise to be fully in accordance with SABS IEC 1084 for cover plates and SABS 1085 for wall boxes.

10. **POSITIONS OF SWITCHES AND SOCKET OUTLETS**

Except where otherwise specified, lighting switches and socket outlets are to be installed 1,4 m above finished floor level.

All mounting heights specified are to be measured from finished floor level to the bottom of the outlet box.

Where the lower portion of the wall consists of face brickwork and the upper portion of plastered finish, switches and socket outlets are to be mounted in the plastered surface, provided that the lower edge of the plasterwork does not exceed a height of 1,5 m above finished floor level in which case the switches or socket outlets are to be installed in the face brick dado.

Where socket outlet and switch boxes have been installed with fixing lugs below finished wall surface, only approved distance pieces required to compensate for the recess shall be used. The lengths of distance pieces are not to exceed 15 mm.

Unless otherwise approved, light switches adjacent to doors are to be installed at the lock side of the door. Where the lock position is not indicated on the drawings, its position shall be ascertained before the switch box is installed. Switches are to be installed 150 mm from the reveal, or centrally if there is a fitting near the door.

All switch and socket outlet boxes shall be installed plumb, and built into the wall with a 1:1 mixture of cement and sand.

Industrial type switches and socket outlets shall be neatly recessed into the surface of plastered walls to avoid sets or alternatively spacer bar saddles may be used.

Deep type boxes may be used where switches or socket outlets are back to back, but where one side only is to be utilized at the time and the other is for future use, the side for future use shall be suitably covered with a metal cover plate.

11. LOW TENSION SWITCHBOARDS

Low Voltage switch gear and control gear to comply with SABS 1473 and SABS IEC 60947 and SABS 60349.

Where switchboards are to be installed in switch rooms or switch cupboards, the Contractor must ensure that the boards are manufactured to suit the dimensions of the rooms or cupboards.

Low tension switchboards shall be specified in detail for each service, but shall generally conform to the following:

They are to be of strong and rigid construction, with suitable angle, channel or folded steel framework. They are to be flush fronted and totally enclosed with sheet steel panels suitably formed at the edges and reinforced to prevent distortion. Unless otherwise directed, all front panels must be at least 2 mm thick and all other panels at least 1.6 mm thick. Panels are to be secured to the framework with studs and chromium plated dome nuts (self-tapping and similar screws are not permitted).

Switches, etc, are to be mounted on metal frames within the boards to give flush front panels. Equipment of normally surface mounted types such as energy meters, time switches and contractors, are to be mounted on inner metal trays behind hinged front panels. In the case of supply authority meters the hinged front panels must have transparent inserts.

All metal work of the boards must be thoroughly degreased, primed with PA 10 self etching primer and finished with one coat of undercoat and two coats of electrical orange high gloss enamel, unless otherwise specified.

All accessible current carrying parts, bus-bars, connecting strips, collector bars, etc, are to be adequately insulated in phase colours and suitably braced to withstand projected fault currents.

Connecting strips and collector bars must be of sufficient cross sectional area to carry full rated current of the switches served, irrespective of the fuse or trip rating.

The complete distribution board including bus-bars must be suitably constructed to withstand fault currents specified.

Connections to bus-bars are to be made by means of lugs suitably bolted and locked with high tensile bolts and connections to lugs must be effected by means of a crimping tools.

Incoming and outgoing bus-bar studs, where required, must be suitably insulated where they pass through panels of the board, and firmly supported within the board.

Where applicable, incoming and outgoing collector bars for cables in parallel must so arrange that the multiple cable ends can be connected to the bars with reasonably short tails which do not have to cross.

Cable supports must be placed at suitable heights having regard to the bending radius of the cables concerned and convenience in making off.

Wall-mounting and floor-standing back to wall type boards must be provided with full easy access to all equipment and wiring without any necessity of disconnecting or removing of any of the equipment mounted in the board.

Clear visible indication of all switch positions must be provided and the switches must be clearly labeled as directed by the Head : Works.

The details of construction proposed, and the Head : Works must approve all equipment of switchboards: Works before manufacture is commenced.

12. **DISTRIBUTION BOARDS**

12.1 **Approval**

The Head : Works must approve the details of construction proposed and all equipment within distribution boards: Works before manufacture is commenced.

12.2 **Flush Mounting Distribution Boards**

These shall be generally manufactured in accordance with SABS 1765. The board shall consist of two panels fitted side by side with common bonding tray and attached to a common architrave. One panel shall accommodate all single phase MCB's and the second panel shall accommodate the main isolator, main bus-bars and the triple pole MCB's. Chassis shall be of rigid channel section rust proofed steel with clip-on trays for the single pole MCB's. The main isolator is to be mounted at the bottom of the second panel with the triple pole circuit breakers above.

12.3 **Surface Mounting Distribution Boards**

These shall be generally manufactured in accordance with SABS 1765, with two panels as for flush boards.

12.4 **Single Phase Distribution Boards**

Single Phased boards shall be generally constructed as three phase boards except they shall have a single panel. Single phase boards shall be mounted with the bottom of the architrave 1,5 m above finished floor level unless specifically directed otherwise.

12.5 **Distribution Board – In Roof Spaces**

Where distribution boards are installed below a roof space, a minimum of 2 x 20 mm and 1 x 25 mm spare conduits are to be run from the distribution board into the roof space.

13. **METER BOXES**

The meter box shall be mounted with the top 1,7 m above finished ground level. Surface mounted meter boxes shall be secured by at least 4 x 10 mm expansion bolts.

Service cables entering the meter box shall be protected by means of a suitably sized galvanised pipe extended 450 mm below the ground surface and securely saddled to the wall and bonded to the meter box.

14. **CONNECTIONS TO OUTLETS**

14.1 **General**

Where connectors are used to connect to the wiring of luminaires and other appliances, the connectors shall comply with SABS Specification 1239.

14.2 **Connection to Stoves**

14.2.1 **General**

The connection to an electric stove, unless otherwise specified shall consist of 2 x 10 mm² conductors and a 6 mm² insulated earth wire in 25 mm conduit. The stove shall be controlled by a 60 Amp micro gap switch of approved make and the connection shall be by means of a 45 Amp 3 pin stove plug of the "Cape Town" type. Cable ends, which are to be connected to the stove, shall be equipped with suitable soldered or crimped lugs. The connection between the stove plug and stove shall be by means of flexible conduit.

Except for high school domestic science unit kitchens (see Clause 14.2.2), the conduit shall be chased into the wall and fitted with a switchbox for housing the micro gap switch and a 25 mm circular conduit box over which the stove plug will be mounted. The stove plug shall be fitted with an adaptor plate and shall be screwed directly to the conduit box by means of round head metal screws. The plug outlet shall face downward.

The stove plug and switch shall be mounted 430 mm and 1,4 m respectively above finished floor level unless otherwise specified or indicated on the drawings.

14.2.2 Stove Connections in High School Domestic Science Unit Kitchens

Connections to stoves in High School Domestic Science Unit Kitchens, where the stoves are situated in front of a fitting, shall be generally as specified in Clause 14.2.1 except that the 25 mm diameter conduit shall be run in the floor slab, from the distribution board to a position to the right of the stove. A pedestal, which is complete with a 45 Amp 3 pin "Cape Town" type cooker plug, mounted on the back, shall be fitted over the conduit and securely bolted to the floor by means of expansion bolts. The plug circuit, which passes through the pedestal, is to be on a separate circuit.

14.3 Connections to Hot-water Cylinders

The connections to hot-water cylinders not exceeding 3kW loading shall consist of 2 x 4 mm² PVC conductors and 1 x 2,5 mm² earth wire in a 20 mm diameter conduit from the distribution board. The conduits shall be chased in the wall and shall terminate at the side of the cylinder in a box over which is to be mounted a double pole isolator with pilot light.

The final connection between the isolator and cylinder shall be by means of silicone heat resistant conductors in 20 mm diameter flexible conduit.

Connections to roof mounted hot-water cylinders shall generally be as specified above with an isolator with pilot light mounted adjacent.

14.4 Connections to Power Points

Connections to electric motors and fixed apparatus to vibration shall, unless otherwise specified or indicated on the drawings, have final connections consisting of conduit and flexible tubing or reinforced hose in accordance with Clause 1.3 of this specification and PVC cables and earth wire of the required size.

An isolator shall protect all fixed apparatus and where necessary a starter fitted with a no-volt coil and overload protection adjacent to such apparatus.

Power points for connection of fixed apparatus to be installed by others, shall terminate in an approved type wall mounted switch unless otherwise specified.

The minimum conductor size for all power points shall be 4 mm² unless otherwise specified.

14.5 Underground Service Connection

This clause refers to underground service connections not provided by the Supply Authority.

The service cable and earth wire to be connected at the supply point in accordance with Clause 15.8 of this specification, and unless otherwise specified, shall be laid 600 mm below ground level throughout and otherwise fully in accordance with Clause 15 and all applicable sub-clauses thereof. Cable entries to meter boxes shall be in accordance with Clause 13 and other entries shall be by pipe or duct as directed.

14.6 Connections to Outbuildings

Connections to outbuildings shall be made by means of underground cable only, laid in accordance with Clause 15 and all applicable sub-clauses.

Where the cable is run from the roof space of the main building, it shall be enclosed in suitably sized galvanised pipe built into the wall or run surface as directed. Surface run pipes shall be securely saddled at 1,8 m centers. Where the cable connects to the conduit in the roof space, a suitable joint box shall be provided or alternatively the cable may be taken through the roof space, a suitable joint box shall be provided or alternatively the cable may be taken through the roof space with fixings at regular intervals, and down to the main board. At the outbuildings, the cable shall be enclosed in a suitably sized galvanised sleeve pipe built into the wall or run surface and terminated in the distribution board tray.

14.7 Connection and Mounting of Cable Fed Street/Site Lighting

Street/site lights shall in all cases, except where otherwise specified, be fed by underground cable. Unless otherwise directed, a suitable terminal board shall be provided in the base of the lighting pole for the connection of the incoming and outgoing cables, the feeds from the terminal board to the fitting shall be as specified.

"Surfix" cable and compression glands shall be installed between terminal board and cross arm/bracket mounted luminaires. The terminal board shall also accommodate a miniature circuit-breaker in the phase connection to the fitting. Poles intended for mounting directly in ground are to be provided with a 300 x 300 mm base plate.

15. UNDERGROUND CABLES

1000 volt PVC SWA and 110 Volt PILCA cable and accessories shall be in accordance with the relevant SABS specifications to SABS 1507.

The storage, transportation, handling and laying of underground cables shall be according to the manufacturer's requirements and the Contractor shall have adequate and suitable equipment and labour to ensure that no damage is done to cables during such operation. All cable pipes and ducts entering buildings are to be sealed against the ingress of vermin, water, etc.

15.1 Trenching

Cables, unless otherwise specifically directed, shall be laid at a depth of 600 mm below ground level. Trenches shall not be less than 300 mm wide for one to three cables, and the width shall be increased where more than three cables are to be laid together so that the cables may be placed at least 75 mm throughout the run.

The Contractor shall take all necessary precautions to prevent trenching work being in any way a hazard to the public and to safeguard all structures, roads, sewer works, or other property from risk of subsidence and damage.

15.2 Cable Joints

Joints in underground cable runs will not be permitted unless unavoidable and at the discretion of the Head : Works. Where cable joints are unavoidable, the cable jointer is to work efficiently and cleanly and so that each end of the cables to be joined may have a minimum of 0,9 m of slack disposed in a loop without stress. Back-filling under joints must be firmly tamped to prevent any subsequent settling.

15.3 Bedding

In trenches made in intermediate, hard rock, or boulder material, the cables shall be laid on a 75 mm thick bed of earth and be covered with a 150 mm layer of earth before the trench is filled in. The Contractor to supply all earth required for trench filling.

15.4 Laying

Cables shall be removed from the cable drum in such a way that no twisting, tension or mechanical damage is caused, and must be adequately supported at short intervals during the whole operation. Particular care must be exercised where it is necessary to draw cables through pipes and ducts, to avoid abrasion, elongation or distortion of any kind. The ends of such pipes and ducts shall be sealed to approval after the drawing in of the cables.

15.5 Back Filling

Back filling after bedding (see Clause 15.3) is to be carried out with a proper grading of the material to ensure settling without voids, and the material is to be tamped down after the addition of every 150 mm. The surface is to be made good as required.

Back filling of cable trenches must not be commenced until after the cable trenches and laid cable(s) have been inspected by the Head : Works. Where a Contractor fails to observe this requirement he may, at the discretion of the Head : Works, be required to re-open such cable trenches for inspection at his own expense.

15.6 Protection of Cables

Where so directed by the Head : Works, concrete or other warning covers shall be placed over cables above the top bedding layer. Cable pipes when directed are to be installed at road and other crossings.

15.7 Marking of Cables

Cable marking tape is to be supplied by the Contractor and is to be laid 150 mm below ground over a cable run and as may be directed by the Head : Works to give early indication of underground cable runs.

15.8 Joints and Termination of Cables

Joints in underground cables and terminations shall be made by means of "Scotch Cast" or other approved epoxy-resin pressure type jointing kits. Low tension PVC cables are to be made off with sealing glands and materials designed for this purpose, which must be of approved make.

15.9 Sealing of Paper Insulated Cable Ends

Where cables are cut and not immediately made off, the ends must be sealed without delay. If cables are cut and the ends not immediately made off or sealed, the cable may be rejected and the Contractor will be required to replace it at his own expense.

15.10 Earth Wires

Except where specifically directed otherwise, earth continuity conductors are to be run with all underground cables constituting part of a low tension distribution system. Such earth continuity conductors shall be bare copper wire of a cross sectional area in accordance with the Code of Practice 0142 but shall not be less than 4 mm² nor more than 70 mm². The earth continuity conductor is to be bonded to the cable armouring, and to the lead sheath if any, at each termination, as well as to the local earth bard. The earth wire must be secured to the cable at 1,8 m centers.

15.11 Opening Up of Existing Cables

Where it is necessary to expose existing buried cables for any purpose, or to excavate in the vicinity of existing buried cables, pipes, etc, every care is to be exercised and only labourers experienced in such work, and duly warned by the Contractor, shall be employed thereon.

15.12 Definitions for Classifying of Excavation

- (a) Soft Excavation – shall be excavation in material that can be efficiently removed by a back-acting excavator of flywheel power approximately 0,10kW per millimeter of tinned-bucket width, without the assistance of pneumatic tools such as paving breakers, or that can be efficiently loaded without prior ripping or stockpiling by a rubber tyred front-end loader approximately 15T mass and a flywheel power of approximately 100kW.
- (b) Intermediate Excavation – shall be excavation in material that requires a back-acting excavator of flywheel power exceeding 0,10kW per millimeter of tinned-bucket width and the assistance of pneumatic tools prior to removal by equipment equivalent to that specified in (a) above.
- (c) Hard Rock Excavation – shall be excavation in material that cannot be efficiently removed without blasting or without wedging and splitting prior to removal.
- (d) Class A Boulder Excavation – shall be excavation in materials containing more than 40% by volume of boulders of sizes between 0,03 cubic meter and 20 cubic meter in a matrix of softer material or smaller boulders.

Note: (1) Excavation of solid boulders or lumps of size exceeding 20 cubic meter will be classified as hard rock excavation.

(2) Excavation of fissured or fractured rock will not be classed as boulder excavation but as hard rock intermediate excavation according to the nature of the material.

- (e) Class B Boulder Excavation – shall be excavation of boulders only in a material containing 40% or less by volume of boulders of size between 0,03 cubic meter and 20 cubic meter in a matrix of softer material or smaller boulders.

Note: Those boulders that required individual drilling and blasting in order to be loaded by a back-acting excavator as specified in (a) above, or by a track type front-end loader, will each be separately classed as Class B Boulder Excavation.

16. **EARTHING**

16.1 **Main Earthing**

The type of main earthing shall be as required by the Supply Authority, if other than the Head : Works and in any case as directed by the Head : Works who may require additional earthing to meet test standards.

Where required, an earth mat is to be provided, the minimum size, unless otherwise specified, being constructed from copper straps 950 x 25 x 3 mm at 230 mm centers and braced at all intersections. Alternatively or additionally earth rods or trench earths may be required, as the Head : Works may direct, and installed according to his instructions.

All earth electrodes and connections thereto must be approved "in-situ" by the Head : Works before back-filling.

The electrical installation shall not be earthed by means of the lightning arrester earth electrode, if such is included in the installation, but may be bonded thereto.

16.2 **Earthing in Installations**

The installation shall be effectively earthed in accordance with the relevant sections of the Code of Practice 0142 and the requirements of the Supply Authority.

All hot and cold water and waste pipes are to be effectively bonded by means of 12 x 1,5 mm solid copper tape (perforated tape or wire will not be permitted), clamped by means of brass bolts and nuts. Bonding tapes exceeding 75 mm in length must be fixed to the wall by means of No. 6 x 20 mm brass screws and plastic plugs not exceeding 150 mm centers. Main earth copper tapes where installed less than 2,5 m from ground level, must be run in 20 mm diameter conduit securely saddled to the wall.

Gutters and down pipes are to be bonded by means of 6 mm round headed brass bolts, with nuts and washers. Self-tapping screws are not permitted.

Connections from the earth bar or terminal on the main board must be made to a visible cold water main, the incoming service conductor, if any, and the earth mat or plate (where such is required) by means of either 12 x 1,5 mm solid copper tape or bare 25 mm² copper wire, or such larger conductor as the Head : Works may direct. From each distribution board separate earth conductors are to be taken to the main earth bar or terminal on the main board. Each conductor shall consist to stranded copper conductors drawn into the conduit together with the distribution board feeders. The size of the earth conductors to be in accordance with the requirements of the Code of Practice 0142 or as specified.

Earthing clips shall be made of not less than 0,9 mm thick copper strips not less than 12 mm wide. They are to be complete with 25 x 7,7 mm brass bolts, washers and nuts and must be constructed so that the clips will fit firmly to the conduit without any additional packing.

Adjustable earth clips are not permitted.

17. **EXISTING BUILDINGS**

17.1 **Occupied Buildings**

Where work is to be carried out in occupied buildings the Contractor must arrange to carry out the installation with as little interruption to services and discomfort to the occupants as possible.

17.2 **Temporary Connections**

Temporary connections shall be provided where necessary for continuity of services, and as directed by the Head : Works. The contractor must ensure that such connections are both electrically safe and free from physical hazard.

17.3 **Old Materials**

Unless otherwise specified all existing materials removed by the Contractor shall remain the property of the Head : Works and are to be handed to the Head : Works.

17.4 **Making Good**

Any damage which may be done to the plaster work, floors, ceilings, wood and paint work, furniture and other equipment in the building, etc, during the progress of the electrical installation shall be repaired and made good by the Contractor to the satisfaction of the Head : Works.

18. **COMPLETION**

18.1 **Balancing of Load**

The Contractor is required to balance the load as equally as possible over multi-phase supplies.

18.2 **Tests**

The installation shall be tested by the Contractor as the service progresses or as required by the Head : Works and upon completion, for earth continuity and insulation. The final test before the taking over of the installation shall be made in the presence of the Head : Works.

The mandatory "Certificate of Compliance" shall be issued by the Contractor to the Supply Authority, with a copy to the Head : Works prior to first delivery being taken.

18.3 **Labelling**

All circuits and apparatus on switchboards shall be suitably correctly labeled by means of engraved plastic labels (white lettering on black), which are to be either bolted or screwed to the equipment panel, or fitted in channeling provided below the switch gear.

Sub-circuits are to be numbered and a legend detailing the circuits is to be framed and fitted to the door of the distribution board.

All other equipment is to be individually labeled to indicate the function.

All switchboards are to be fitted with a label on which the designation of the board is clearly indicated.

A separate engraved label depicting the origin and cable/conductor size shall be fixed below the main switch.

18.4 **Finishes**

Covers for all boxes, expansion boxes, etc, shall be finished to match the paint work of the ceiling or wall surface or as specified.

18.5 **Site Drawing**

On all completed new work or where specifically called for in the Tender Document, the Contractor shall, on completion of the works, submit to the Head : Works, a marked up site plan indicating the exact underground cable reticulation.

19. **POWER DUCTING FOR SCHOOL SCIENCE LABORATORIES**

The ducting shall be "Ductline 3" supplied by Messrs. Lascon Lighting, 102 Malbourne Road, P.O. Box 2479, Durban 4000: Telephone 031-2075081 or other approved.

20. **SPEAKER AND MICROPHONE OUTLETS**

Speaker and microphone outlets are to conform to the following details:

1. Speaker outlet – To have one flat and one round pin.
2. Microphone outlet – To have one round pin only.

Both female and male parts to be supplied and installed by the Contractor.

21. **BELLS AND BUZZERS**

21.1 **Bells**

Bells for schools and hostels shall be 220 Volt AC or 24 Volt DC as specified for the service. They are to be of robust construction encased in a sturdy cast metal weather-proof case. They are to operate on the frequency of the supply. They shall have an adjustable stabilizing spring, gold-silver contact points and 150 mm gongs.

21.2 **Doorbells, Buzzers and Bell Transformers**

These will be as specified for each service.

21.3 **Bell Pushes**

Except where otherwise specified, bell pushes shall be of the flush type suitable for mounting in a standard 100 x 50 mm box. They shall be clearly marked as a bell push and shall be fitted with satin finished anodized aluminium cover plates.

22. **SIGNAL TIMERS**

22.1 **Primary Schools**

The timer shall be designed to automatically signal the start and finish of school periods by the switching of a bell circuit and is to comply with the following specification:

1. The mechanism may be synchronous motor or quartz movement driven with a 24 hour dial or digital time read-out suitable for operation on a 220V 50Hz supply and is to be provided with a spring or battery reserve of a least 24 (twenty four) hours.
2. The unit is preferably to have minute to minute timing for a 24 (twenty four) hour period although 5 (five) minute intervals are acceptable, and is to be provided with Weekend lockout. Signal periods shall be adjustable from 5 – 45 seconds.
3. The unit shall be housed in a metal or plastic case with detachable front cover suitable for wall mounting.
4. Timers with punch tape programming are not acceptable.

22.2 **High Schools and Colleges**

Timers for these institutions shall generally be as for Primary Schools but are to have at least 3 (three) separate programmes and be fitted with three push buttons for independent manual operations for testing of each programme, plus an on/off switch for each programme, which does not affect the running of the clock.

23. **CLOCKS**

Electric clocks shall be of the quartz electronic battery operated type, with a dial of 250 mm diameter. The dial shall be white, with distinctive minute markings and chapters shall be black Arabic figures. Time adjustment shall be simple. Where mains operated electronic clocks are specified, these shall be of the synchronous self starting type, suitable for a 200 – 250 V 50 Hz AC supply

24. **TIME SWITCHES**

The time switch shall consist of a single pole switch with silver to silver or other approved contacts operated by a quartz movement with a 24 hour reserve.

A suitable 24 hour, night and day dial, with hour indicator and two adjustable strikers, one OFF and one ON must be provided. The whole mechanism is to be totally enclosed in a dust proof case.

The current rating shall be required and the switch is to be suitable for operation on 220 volt 50 Hertz AC supply. Time switches used for under floor heating are to be fitted with weekend cut-out.

25. **MOULDED CASE CIRCUIT BREAKERS (INCLUDING MINIATURE)**

Circuit breakers shall be of the size and type as directed and specified for the service. They shall comply with SABS Specification 156 and SABS IEC 60947-2.

26. **SWITCHES: ON-LOAD FAULT MAKING (CIRCUIT BREAKER TYPE) WITHOUT TRIPS**

The switches shall be triple pole, hand operated, panel mounting air break type, having continuous current rating as specified and suitable for operation of 380 – 440 Volt 50 Hz AC system.

The contacts are to be of silver alloy and the switch mechanism shall be of the quick-make, quick-break type.

27. **SWITCHBOARD EQUIPMENT**

Switchboard equipment such as switches, circuit breakers, etc, shall be as directed and specified in the detail specification for the service.

Circuit breaker equipment of SABS IEC 60934.

28. **FUSE-SWITCH UNITS (WITH HRC FUSES)**

The fuse-switch unit is to be of the double pole, or triple pole or triple pole with neutral link type, and of the required current rating, as specified for the service and must be in accordance with BS EN 60947-3.

The fuse links must be fully isolated when the switch is in the open position, and interlocks must be provided to prevent the switch being operated with the cover open.

The fuse links shall comply with SABS Specification 172 and SABS IEC 60269-1 to 4.

29. **BUS-BAR COPPER**

Bus-bar copper must be fully in accordance with Tables A1 and A2 of SABS 1473-2 and SABS IEC 60439-2.

30. **SPECIFICATION COMPLIANCE**

The complete installation shall comply with the requirements of this specification. Should any differences or contradictions exist between this Specification and the detailed requirements for a specific installation, then the detailed requirements shall take precedence.



KWAZULU-NATAL PROVINCE
PUBLIC WORKS
REPUBLIC OF SOUTH AFRICA

NQUTHU (KWAZULU NATAL) - MASHESHELENG PRIMARY SCHOOL: COMPLETION OF ADMINISTRATION, MULTI-PURPOSE CLASSROOM AND KITCHEN BLOCKS INCLUDING CONSTRUCTION OF NEW GUARD HOUSE, THREE TOILET BLOCKS, PARKING FACILITIES, PATHWAYS AND FENCING

**ANNEXURE 3
LIGHTNING PROTECTION SPECIFICATIONS**

LIGHTNING PROTECTION INSTALLATION

GENERAL SPECIFICATION

1. SATISFACTORY INSTALLATION

The whole of the installation shall be carried out in accordance with:

- (a) The latest S.A.B.S. Code of Practice for the Protection of Structures against Lightning - S.A.B.S. 03 ; SABS IEC 61024 (1) , 61024 (1 -1); SABS IEC 61312 (1) ; SABS IEC 61662 & NRS 042.
- (b) The KwaZulu-Natal Department of Works General Electrical Specification.
- (c) The Municipal By-Laws and any other special requirements as deemed necessary by the Local Supply Authority;
- (d) Local Fire Regulations.

2. S.A.B.S. APPROVED DRAWINGS

SABS Approved drawings are not required for this project.

3. TEST ON COMPLETION

Upon completion of the lightning protection system, the following tests shall be witnessed by an appointed representative of the Employer. The results shall be recorded on suitable test certificates which must be signed by both the Contractor and the Employers representative. A sketch must be included on each test certificate indicating the positions of each earth electrode in relation to some permanent reference point. It must also indicate the positions at which tests were carried out, the type of test and the results of these tests.

3.1 Earth Resistance Test

The Earth Resistance Test shall involve measuring the resistance to earth of each rod-type electrode, or group of rod-type electrodes, or trench earth which would normally be connected to one down-conductor or earth terminal. This test must be made with the electrodes completely disconnected from any part of the structure or lightning protection system.

3.2 Electrical Continuity Tests

(a) External Down-Conductors

Electrical continuity between the lower ends of external down-conductors which must all be disconnected from the earthing system during the test shall not exceed 1 (one) ohm.

(b) Metallic Services

Electrical continuity between any metallic structures of services (e.g. rainwater pipes) which form an integral part of the lightning protection system shall not exceed 1 (one) ohm. These tests should be carried out with all other components of the lightning protection system disconnected from the component being tested.

4. DESCRIPTION OF MATERIAL

4.1 Air Terminals and Down-conductors

All conductors must be in accordance with the requirements of BSS 1474 or American Standards Specification 6063. All aluminium conductors shall have a cross-section area of not less than 30 mm² (domestic dwelling only) or 50 mm² for all other applications. The dimensions of flat section conductors to be 20 mm x 3 mm. Where conductors are mounted in stand-off guides, the cross-section area of the conductor must be not less than 70 mm² to give adequate mechanical strength.

4.2 Conductor Guides

The conductor must be mounted in aluminium alloy guides conforming with the material specification given in 4.1 above. The guides must allow for free longitudinal movement of the conductor to cater for expansion and contraction of the system caused by temperature variation. The minimum thickness of any part of the guide shall not be less than 3 mm. The guides must be securely attached to the structure using two stainless steel screws and plugs, the use of plated screws is not permitted.

The conductor system shall be supported in guides so that an air gap exists at all times between the aluminium and the surface of the structure, the guides being seated upon plastic or other similar insulating material. Should conductors be installed directly upon the surface of concrete or cement plaster, an insulating strip is to be installed over its whole length to prevent contact between the two surfaces. Guides shall be installed to support the conductor at intervals not exceeding 1,2 metres horizontally or 1,5 metres vertically.

N.B.: No part of an aluminium conductor system must be allowed to come into direct contact with concrete or cement plaster as this may cause the aluminium to corrode.

4.3 Expansion Loops

Where conductors are installed horizontally without deviation from a straight line over long distances, expansion loops must be provided at distances not exceeding 30 metres. These expansion loops must have a cross-sectional area which is at least equal to that of the conductor.

4.4 Protection of Down-conductors

Where external down-conductors are installed in areas which are readily accessible to the public, the lower ends of the conductors shall be enclosed in a semi-rigid insulating material. In the case of a circular section conductor this shall comprise a 2 metre length of 20 mm diameter P.V.C. conduit. This conduit shall be securely attached to the wall by means of galvanized steel saddles fixed with stainless steel screws and plugs, spaced at intervals not exceeding 1 m. Where a flat section conductor is used this shall be covered by a similar length of 25 mm P.V.C. conduit. The lower end of the conduit shall be positioned as close as practicable to ground level, i.e. immediately above an aluminium to copper joint. The ends of the conduit shall not be sealed.

4.5 Earthing Electrodes

Earthing electrodes must consist of either copper-clad steel rods not less than 12 mm in diameter and having a minimum copper thickness of 0,20 mm driven into the ground, or a 50 mm² (35 mm² for domestic dwellings) bare copper conductor buried in a trench, or a combination thereof. Where copper clad steel electrodes are used they must have a suitable bond between the steel core and copper exterior to prevent moisture ingress between the two metals. Where it is necessary to extend earth rods, an electrolytically compatible corrosion resistant, coupling device, which prevents ingress or moisture into the joint shall be used. The copper conductor below the down-conductor joint shall be covered by a semi-rigid P.V.C. conduit for a distance of approximately 200 mm above ground and 400 mm below ground.

4.6 Joints Above Ground

Circular section aluminium conductors shall be jointed by aluminium ferrules or lugs which are securely crimped into place. Aluminium lugs must be bolted together using 10 mm diameter aluminium bolts and washers. The material specification for these components must conform with that laid down in paragraph 4.1. Alternatively heavily tinned copper lugs and ferrules may be used. The lugs should be joined together by means of 10 mm diameter copper, brass or bronze bolts and washers. Care should be taken to inhibit corrosion where dissimilar metals are used by thoroughly cleaning the surfaces of the metal before assembly and subsequently sealing the joint with an inert tenacious compound or tape.

Flat section aluminium conductors shall be joined by double riveting, using aluminium rivets which comply with the material specification laid down in 4.1. Alternatively 2 x 6 mm diameter stainless steel bolts, nuts and washers may be used. Fold over type bends will not be permitted.

Down-conductors are to be terminated approximately 200 mm above finished ground level. Circular section aluminium is to be jointed to a 50 mm² (35 mm² in the case of domestic dwellings) stranded copper conductor by securely crimping in place two heavily tinned lugs and bolting these together using 10 mm diameter copper, brass or bronze nuts, bolts and washers.

N.B. : Under no circumstances shall aluminium conductors be buried in the ground.

4.7 Joints Below Ground

A joint in the stranded copper conductor which forms part of the earthing system must be made by using a crimped copper ferrule clamping (not lugs) using two copper line taps of suitable dimensions, or exothermic welding. The copper earth conductor must be joined to an earth rod by either clamping, using a standard earth rod clamp or copper line tap or by exothermic welding. Joints which are made between dissimilar metals (i.e. copper conductor to galvanized steel water main), must be thoroughly cleaned before assembly. They shall be rendered watertight using waterproof adhesive tape on a suitable compound for a minimum distance of 200 mm in all directions from the joint.

4.8 Bonds

Where it is necessary to bond the aluminium conductor to any other metallic surface, this must be done by bolting or riveting. When attaching aluminium to a dissimilar metal the joints are to be thoroughly cleaned and sealed to prevent corrosion.

5. GENERAL INSTALLATION PROCEDURE

5.1 Air Terminals for Non-metallic Pitched Roofs

Aluminium conductors are to be installed along all ridges of roofs and projections such as dormer windows, etc., terminating at the ends with conductors running downwards over the surface of the roof and the eaves. Non-metallic chimneys must be protected by means of a finial of sufficient length to cover the chimney within a 45° angle struck downwards from its point. Alternatively it should have a conductor installed in the form of a closed loop upon the upper surface. The conductors are to follow the outer contour of the stack and must be bonded at a convenient point to the nearest component of the air terminal system.

N.B. : This bond may run in a horizontal or downward direction, but under no circumstances must any part of it run above horizontal.

Conductors may be dead-ended (i.e. have one end free and unbonded), providing that the length of such a conductor does not exceed 10 metres and that the unbonded end is either at the same level or higher than the bonded end. This technique may be used where ridge conductors are installed over dormer windows, etc.

In all cases where metallic gutters have been installed along the eaves of a pitched roof, these must be bonded to the air terminal system. Where metallic gutters do not exist, however, a conductor must be installed over the surface of the roof at eaves level to which the remainder of the air terminal system is to be bonded, with the following exceptions :

- (a) Where the maximum distance from the ground level to the eaves of the building is less than 4 metres and the pitch of the roof is more than 1 in 2 (27° from the horizontal).
- (b) Where the maximum distances from ground level to the eaves is less than 7 metres and the pitch of the roof is more than 1 in 1,5 (34° from the horizontal).
- (c) Where the distance from the ground level to the eaves is more than 7 metres and the pitch of the roof is more than 1 in 1 (i.e. the included angle at the apex of the roof is less than 90°).

Under these circumstances eaves conductors need not be installed.

Any non-metallic objects which protrude above the general roof lines, such as Cape Dutch gable ends, must be protected as described above with a suitable air terminal system. Any metallic objects which protrude above the general roof line, such as hot water expansion pipes must be bonded as directly as possible to the nearest eaves conductor, gutter or other part of the lightning system.

N.B. : These bonding conductors must run in a horizontal or preferably a downward direction, from the vent pipe, etc., to the lightning protection system.

5.2 **Air Terminals for Metallic Pitched Roofs**

Buildings with roofs covered with electrically continuous metal sheets do not require separate air terminals but must be earthed via down conductors generally as described in 5.6 and 5.7. Any non-metallic objects projecting above the general roof line must be separately protected as described in 5.1 and bonded to the metal roof covering.

5.3 **Air Terminals for Non-metallic flat or Mono-pitched Roofs**

For flat or mono pitched roofs of non-metallic construction the air terminal system must consist of aluminium alloy conductors installed around the outer perimeter of each section of the roof structure. These conductors must be installed on top of parapet walls if these exist. Lift motor rooms, tank rooms, penthouses, etc., which protrude above the general roof line must have air terminal conductors installed around the outer perimeter of each roof slab or parapet wall. Any metallic objects which protrude above the roof line, such as expansion pipes, signs, flag poles, handrails, etc., must be bonded directly to the nearest component of the lightning protection system as described in 5.1.

N.B. : It is not permissible for the ends of conductors to be bonded directly to the perimeter air terminal system if the latter is installed upon a parapet wall having a height exceeding 500 mm above roof slab level. In these circumstances the conductors are to be bonded directly to the down conductors.

5.4 **Air Terminals for Metallic flat or Mono Pitched Roofs**

Metallic flat or mono pitched roofs do not require separate air terminal conductors, providing that there is electrical continuity between the metallic roofing sheets, (see 5.2). A metallic roof surrounded by a non-metallic parapet wall shall have conductors installed at the top of the parapet wall and these must be bonded to the metallic roof at intervals not exceeding 20 metres. If the parapet wall is clad with metal over its upper surface or a handrail is installed which affords good electrical continuity, separate air terminal conductors need not be installed. Under these circumstances the metal handrail or cladding must be bonded to the metal roof covering at intervals not exceeding 20 metres.

All non-metallic covering such as slates, tiles, asbestos cement sheeting, etc., supported by a steel structure being electrically continuous throughout may be treated as being of a complete metal construction. In these circumstances no separate air terminal system need be installed providing the steel roof structure is bonded to earth at intervals given in 5.5.

5.5 Down Conductors for Non-metallic Structures

Down conductors must be installed at regular intervals around structures and to run as directly as possible between the air terminal and earthing system. They must, where practicable, be positioned at the external corners of the structure. The maximum separating distance between down conductors around the perimeter of the structure must not exceed 30 metres. In the case of very tall buildings having a slender base (i.e. chimney stacks, water towers, etc.), a minimum of two down conductors must be installed.

The lower ends of down conductors are to be terminated and bonded to the earthing system approximately 200 mm above finished ground level. Under no circumstances must aluminium conductors be buried underground. Test joints must be provided between the down conductors and earthing system. Down conductors must run vertically between the air terminal and earthing systems. Where this is impracticable, their course may be deviated to run at any angle up to and including horizontal.

Where it is necessary to run conductors horizontally over the upper surface of a structural protrusion, such as an exposed concrete slab, the conductor may run down vertically over the edge of the slab and return to the main structure, so that the distance between the upper and lower conductors exceeds one third of the length of the horizontal run. Looped down conductors are not permitted. Down conductors must not run over the underside of large overhangs which are less than 6 metres above ground level, or other areas where people are likely to be present during a thunderstorm.

External or internal metallic rainwater pipes may be used as down conductors providing these are of substantial section and are jointed by screwing one length into another or welding. Thin gauge galvanized steel pipes whose sections are held together by friction, rivets or screws must not form part of a lightning protection system.

5.6 Down conductors for reinforced concrete framed structures

The steel reinforcement of this type of structure may be used in place of down conductors. Where the reinforcing system is used, the air terminal system must be bonded to it at a maximum of 30 metre intervals using steel clamps. This bond may be achieved by clamping, with a steel clamp, a steel conductor to a selected reinforcing bar, the opposite end of this conductor must terminate at a corrosion resistant metallic terminal such as Grade 316 stainless steel.

The reinforcing system of prefabricated concrete buildings must not be used unless special provision is made for bonding the various prefabricated sections together.

The terminals should be mounted flush with the face of the concrete. An aluminium alloy bond must then be taken from the air terminal system and be connected to the stainless steel terminal by means of a heavily tinned crimp lug for circular section aluminium, or a suitable bi-metallic joint in the case of flat section aluminium. A similar system must be used to bond the reinforcing system at ground level to the earthing system at points directly below the air terminal bonds. Here copper conductors must be used as the external bonding material.

Under no circumstances must copper, or other non-ferrous material be allowed to come into contact with steel reinforcing bars, as this may cause severe corrosion and subsequent structural damage. The lightning protection system must not be bonded to any part of the structure which is electrically isolated from the remainder of the building, i.e. cantilevered sections. In these circumstances, or where it is otherwise impracticable to use the reinforcing system, external down conductors must be installed as described in 5.5.

5.7 Down conductors for steel framed structures

Where the framework of a building is constructed of structural steel columns, these may be used in place of down conductors providing the separating distance between them does not exceed 30 metres. The upper ends of the columns must be bonded to the air terminal systems and the lower ends to the earthing system.

5.8 Earthing by means of vertically installed rod type electrodes

Rod-type electrodes must be driven into the ground at a position directly below each down connector. The maximum earthing resistance of each electrode or number of electrodes bonded to any one down conductor shall not exceed $N \times 30$ ohms, where N equals the total number of down conductors which are bonded to a common air terminal system, or 200 ohms whichever is the lower value.

The minimum horizontal separating distance between rod-type electrodes bonded together must not be less than their installed depth. The upper ends of installed rod-type electrodes are to be terminated approximately 500 mm below finished surface level. A 50 mm² copper bonding conductor must be installed to run between each earthing electrode system and the lower ends of the adjacent down conductors. A joint is to be made between each of these bonding conductors and the down conductors at a position approximately 200 mm above finished ground level. These bonding conductors must be installed in P.V.C. conduit securely affixed to the wall (see 3.4). The length of this P.V.C. conduit must be approximately 600 mm and must be installed so that approximately 200 mm protrudes above ground level, the remainder being buried into the soil.

5.9 Earthing by means of metallic water mains

Where two or three down conductors are installed the water mains may serve as an earth terminal for one of these. Where three or more down conductors are installed the water mains may serve as an earth terminal for two of these. Regardless of whether the water mains are used as an earth terminal or not, the incoming metal water pipe must be bonded to the lightning protection earthing system underground.

5.10 Earthing by means of trench type electrodes

Where the soil conditions prevent the satisfactory installation of rod-type electrodes, a trench earth system must be installed. This method is to comprise a 50 mm² stranded copper conductor installed horizontally into a trench at a depth of 500 mm below finished ground level. The conductor is to follow the general outline of the structure to be protected and be installed 1 metre away from the outside walls. Where the building stands on rocky ground, the trench earth may be attached to the lower part of the wall in areas where rock protrudes through the soil. The conductor must, however, be buried wherever possible as described above.

Each down conductor must be bonded to the trench earth system as directly as possible by means of a copper conductor.

Trench earth systems must have a maximum earth resistance of 30 ohms. An isolated length of trench earth mat must be bonded to the down conductor system in such a way as to reduce the length of dead-ends to the minimum.

Should trench earths be installed beneath pathways where people are likely to be present during a thunderstorm, a plastic, bitumastic or ceramic pipe must be installed having a length similar to the width of the pathway and the trench earth conductor run inside it.

N.B. : The maximum useful length of a dead-ended trench earth is 80 metres.



KWAZULU-NATAL PROVINCE

PUBLIC WORKS
REPUBLIC OF SOUTH AFRICA

**NQUTHU (KWAZULU NATAL) - MASHESHELENG PRIMARY SCHOOL: COMPLETION OF
ADMINISTRATION, MULTI-PURPOSE CLASSROOM AND KITCHEN BLOCKS INCLUDING
CONSTRUCTION OF NEW GUARD HOUSE, THREE TOILET BLOCKS, PARKING FACILITIES,
PATHWAYS AND FENCING**

**ANNEXURE 4
MAP OF BID SUBMISSION LOCATION**

