

LAYOUT OF ACCESS ROAD No.5  
1:1000

SETTING OUT POINTS  
WGS - LO-29

POINT	Y-COORD	X-COORD	ELEVATION
ARS-7-EC	-42285.298	2962378.304	1626.384
ARS-8-BC	-42287.330	2962786.626	1625.548
ARS-8-EC	-42286.444	2962769.979	1625.562
ARS-9-PI	-42288.324	2962778.222	1625.570
ARS-8-R	-42237.696	2962781.100	1623.942
ARS-9-BC	-42284.142	2962759.891	1625.571
ARS-9-EC	-42292.051	2962719.923	1625.681
ARS-9-PI	-42279.181	2962738.143	1624.910
ARS-9-R	-42332.890	2962748.770	1625.727
ARS-10-BC	-42295.518	2962715.014	1625.711
ARS-10-EC	-42310.976	2962681.082	1625.931
ARS-10-PI	-42306.467	2962699.515	1625.856
ARS-10-R	-42213.841	2962657.319	1625.410
ARS-11-BC	-42320.210	2962643.338	1626.161
ARS-11-EC	-42279.984	2962408.012	1626.942
ARS-11-PI	-42351.129	2962516.952	1626.218
ARS-11-R	-42028.803	2962572.049	1621.492
ARS-12-BC	-42241.067	2962348.421	1627.147
ARS-12-EC	-42126.711	2962278.859	1627.304
ARS-12-PI	-42209.396	2962299.924	1624.856
ARS-12-R	-42073.613	2962457.778	1624.195
ARS-13-BC	-42116.451	2962257.469	1627.343
ARS-13-EC	-42090.059	2962239.885	1627.372
ARS-13-PI	-42101.843	2962250.798	1627.332
ARS-13-R	-42158.000	2962166.509	1628.228

NOTE:  
- FOR TYPICAL CULVERT CROSSING REFER TO DWG. 0.61/96773  
- FOR CHANNEL CROSS SECTION DETAILS REFER TO DWG. 0.61/96772-02

ABBREVIATIONS:  
BC - BEGINNING OF CIRCULAR CURVE  
EC - END OF CIRCULAR CURVE  
CC - CENTRE OF CIRCULAR CURVE  
PI - POINT OF INTERSECTION  
PM - POINT OF VERTICAL INTERSECTION  
R - RADIUS  
BP - BEGIN POINT  
EP - END POINT  
SVC - BEGINNING VERTICAL CURVE  
EVC - END OF VERTICAL CURVE  
VCL - VERTICAL CURVE LENGTH  
HCL - HORIZONTAL CURVE LENGTH  
CH - CHAINAGE  
ELEV - ELEVATION

Legend:  
--- NGL-CENTERLINE  
--- ROAD LEFT & RIGHT LEVEL  
--- ROAD CENTERLINE-LEVEL

SCALES:  
Horizontal 1:1000  
Vertical 1:100  
Datum (m.a.m.s.): 1620

CHAINAGE (m)	
0.000	
1620.000	
1625.000	
1626.000	
1627.000	
1628.000	
1629.000	
1630.000	
1631.000	
1632.000	
1633.000	
1634.000	
1635.000	
1636.000	
1637.000	
1638.000	
1639.000	
1640.000	
1641.000	
1642.000	
1643.000	
1644.000	
1645.000	
1646.000	
1647.000	
1648.000	
1649.000	
1650.000	
1651.000	
1652.000	
1653.000	
1654.000	
1655.000	
1656.000	
1657.000	
1658.000	
1659.000	
1660.000	
1661.000	
1662.000	
1663.000	
1664.000	
1665.000	
1666.000	
1667.000	
1668.000	
1669.000	
1670.000	
1671.000	
1672.000	
1673.000	
1674.000	
1675.000	
1676.000	
1677.000	
1678.000	
1679.000	
1680.000	
1681.000	
1682.000	
1683.000	
1684.000	
1685.000	
1686.000	
1687.000	
1688.000	
1689.000	
1690.000	
1691.000	
1692.000	
1693.000	
1694.000	
1695.000	
1696.000	
1697.000	
1698.000	
1699.000	
1700.000	
1701.000	
1702.000	
1703.000	
1704.000	
1705.000	
1706.000	
1707.000	
1708.000	
1709.000	
1710.000	
1711.000	
1712.000	
1713.000	
1714.000	
1715.000	
1716.000	
1717.000	
1718.000	
1719.000	
1720.000	
1721.000	
1722.000	
1723.000	
1724.000	
1725.000	
1726.000	
1727.000	
1728.000	
1729.000	
1730.000	
1731.000	
1732.000	
1733.000	
1734.000	
1735.000	
1736.000	
1737.000	
1738.000	
1739.000	
1740.000	
1741.000	
1742.000	
1743.000	
1744.000	
1745.000	
1746.000	
1747.000	
1748.000	
1749.000	
1750.000	
1751.000	
1752.000	
1753.000	
1754.000	
1755.000	
1756.000	
1757.000	
1758.000	
1759.000	
1760.000	
1761.000	
1762.000	
1763.000	
1764.000	
1765.000	
1766.000	
1767.000	
1768.000	
1769.000	
1770.000	
1771.000	
1772.000	
1773.000	
1774.000	
1775.000	
1776.000	
1777.000	
1778.000	
1779.000	
1780.000	
1781.000	
1782.000	
1783.000	
1784.000	
1785.000	
1786.000	
1787.000	
1788.000	
1789.000	
1790.000	
1791.000	
1792.000	
1793.000	
1794.000	
1795.000	
1796.000	
1797.000	
1798.000	
1799.000	
1800.000	

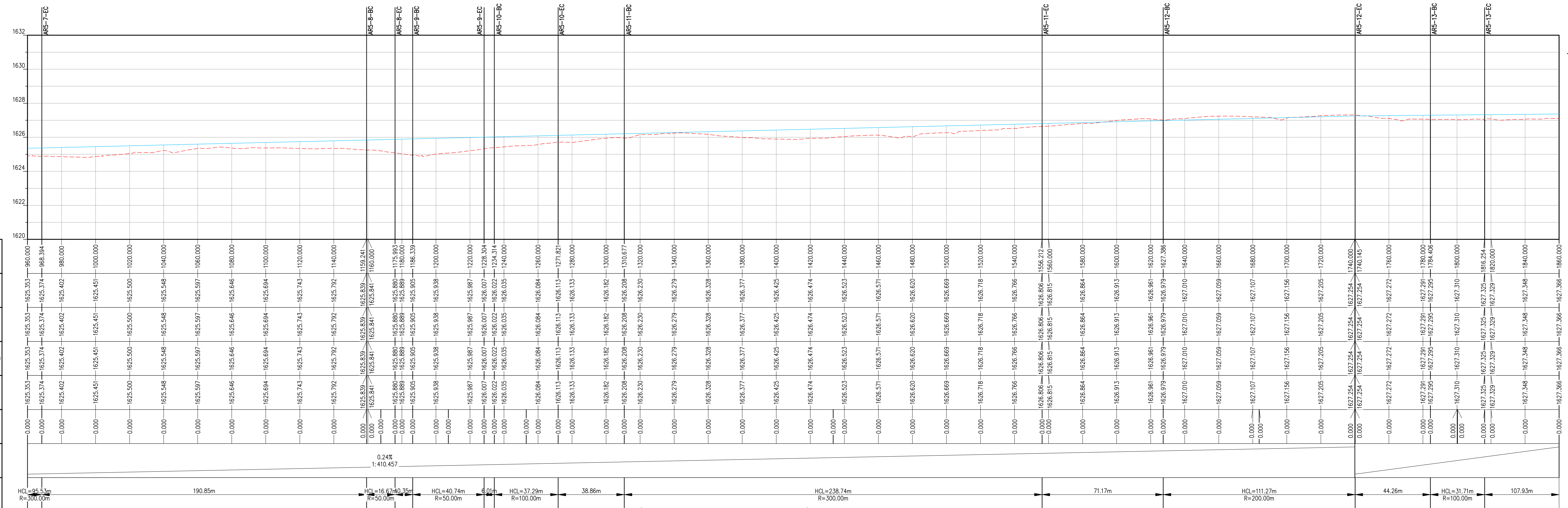

LONGITUDINAL SECTION ACCESS ROAD No.5 (FROM CH960.00 TO CH1860.00)  
HORIZONTAL 1:1000  
VERTICAL 1:100

D.O. REV		INDEX REFERENCE		REV		AUTH		ISS		REFERENCE		REFERENCE	
NO.	DATE	NO.	DATE	NO.	DATE	NO.	DATE	NO.	DATE	NO.	DATE	NO.	DATE
01	10/10/2024	01	10/10/2024	01	10/10/2024	01	10/10/2024	01	10/10/2024	01	10/10/2024	01	10/10/2024

ISSUED FOR TENDER

THIS DRAWING HAS BEEN CREATED ON A C.A.D. SYSTEM. ANY AMENDMENT MUST BE EFFECTED ON THE SAME SYSTEM.

TUTUKA POWER STATION  
ASH DISPOSAL FACILITY  
SITE SERVICES  
ACCESS ROAD No. 5 (SHEET 2 OF 3)

ESKOM HOLDINGS LTD.  
RIS No. 2002/01/0527/06

SCALE: AS SHOWN

20/00