

Grosvenor Station

Station category: Halt

PRASA Cres South Gauteng Region

Braamfontein To Naledi (Corridor - 3)

Alternative Building Technologies (ABT)

Presentation

Stage 3

2022.05.30

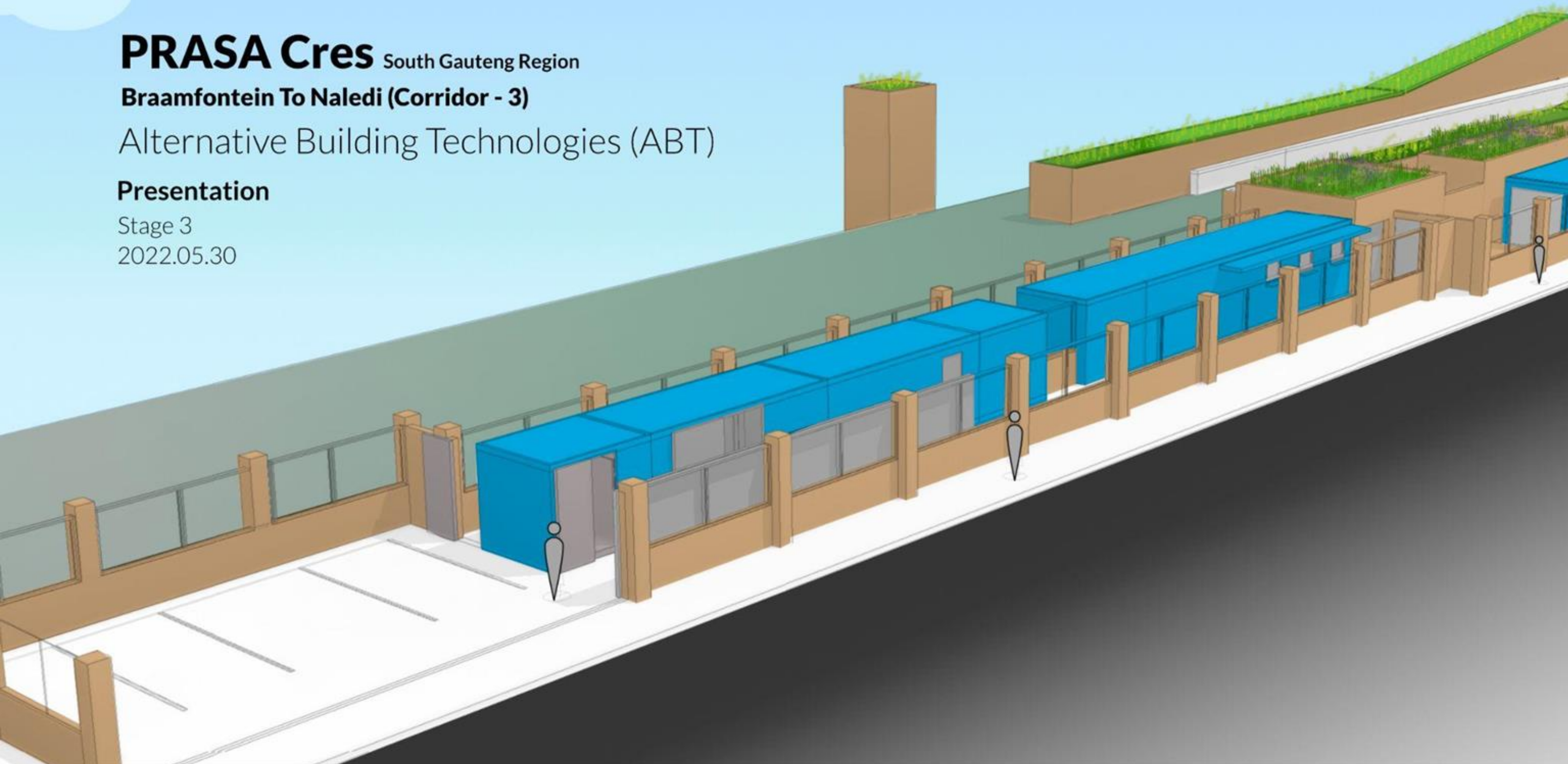

© 2022 Are Key Studios Pty Ltd. Produced by Are Key Studios. Cell: +27 81 349 2177. Email: info@arekeystudios.space. Website: https://arekeystudios.space/. Address: 40 Agiesdoring Drive Hueweloord, Centurion Gauteng 0157 Are Key Studios Pty Ltd. Reg.no. 2020 / 739448 / 07. A listed architectural practice with SACAP (PA10220704). Director: NRS Kekana (PrArch44840036).

PRASA Cres South Gauteng Region - Braamfontein To Naledi (Corridor - 3)
Grosvenor Station - Halt, Rev B Date 2022.05.30
ABT Exploration Presentation, Stage 3



Context



[illegible]

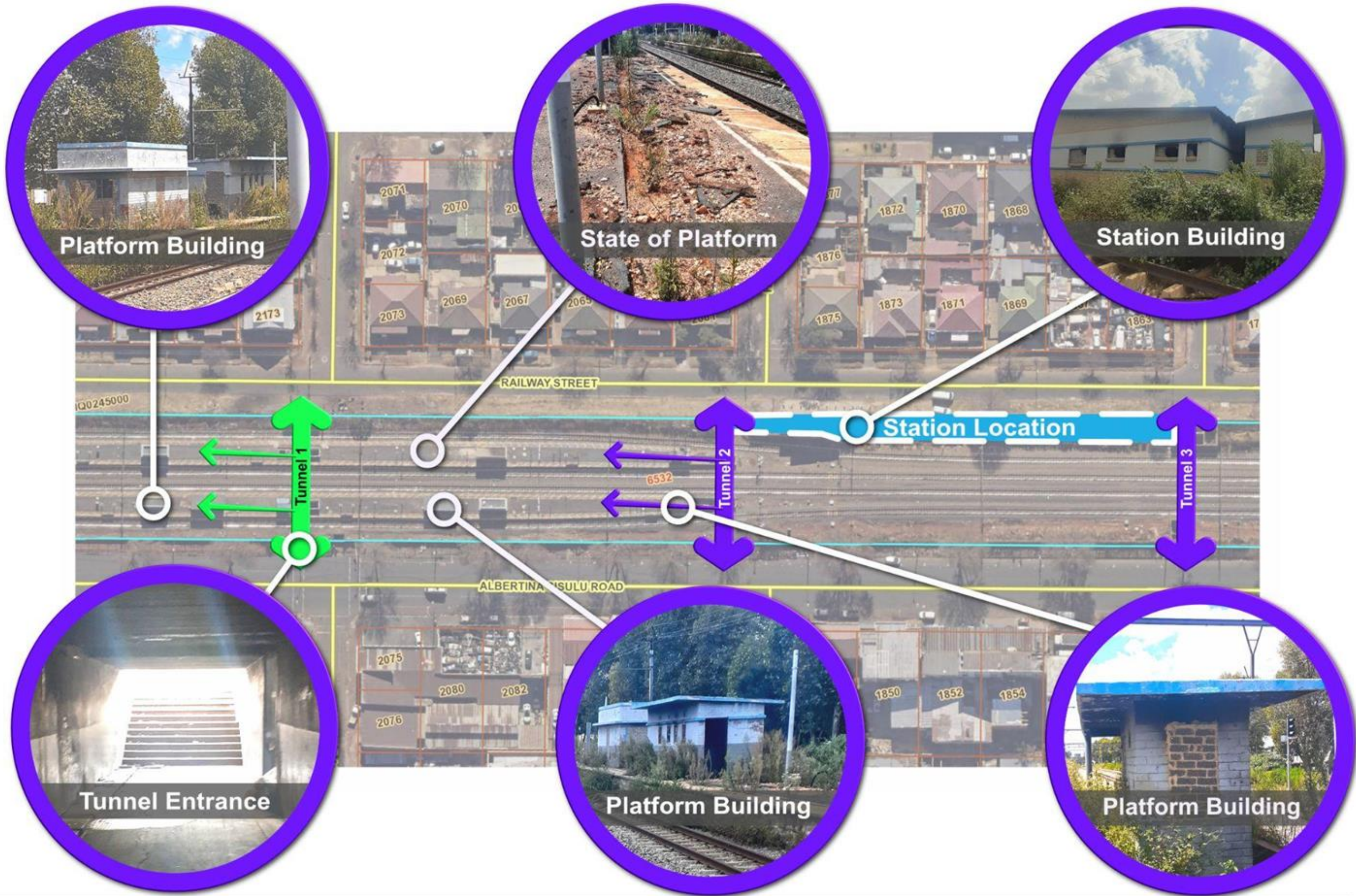

Basic Summary of Brief

- Full Ticket office suite - with 2 Ticket Sales Points
- Refuse Area
- Staff Parking
- Ticket Check Point
- Controlled Access to Platform
- 24hour Public Access Tunnel
- Public Ablutions
- Security & Cleaners Quarters

**How did we go about it
achieving this**



Site Plan

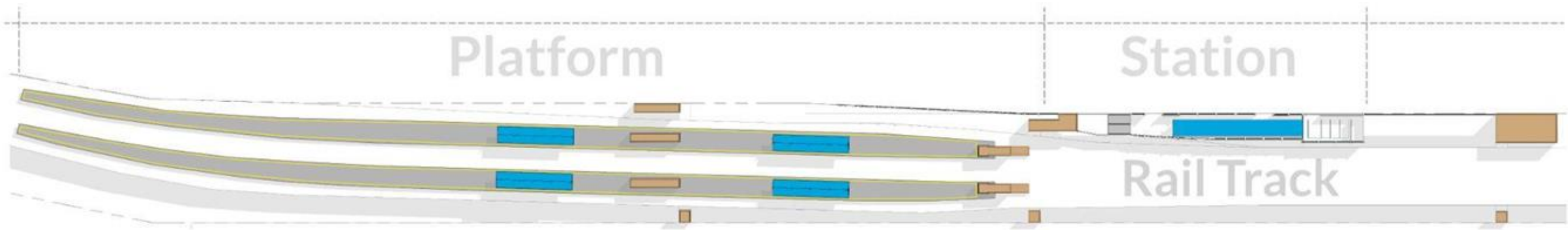

Site Plan

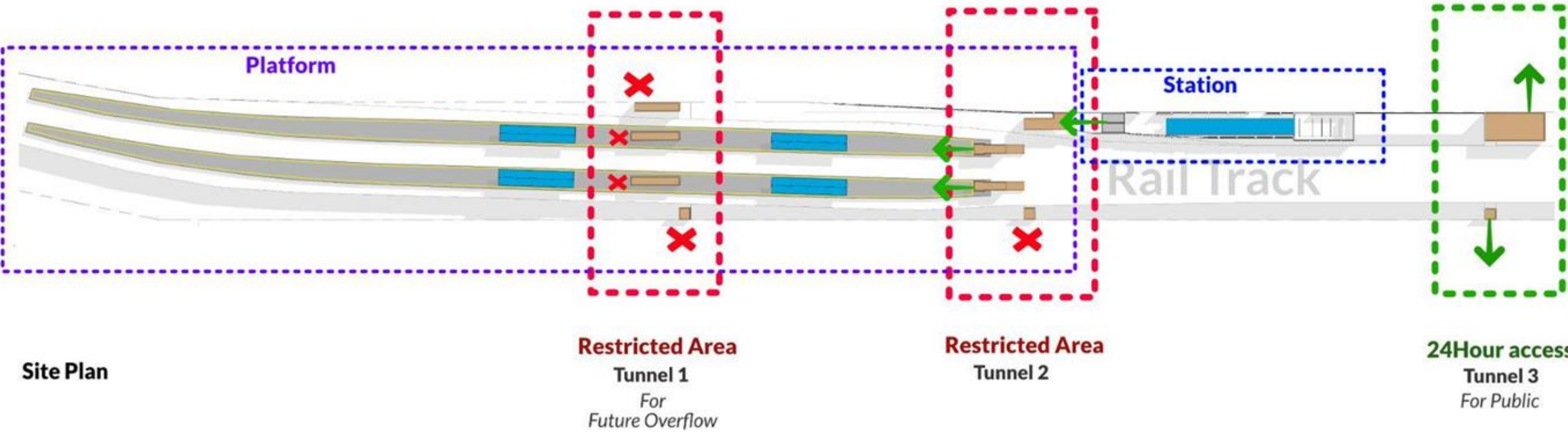

Site Plan

Plans

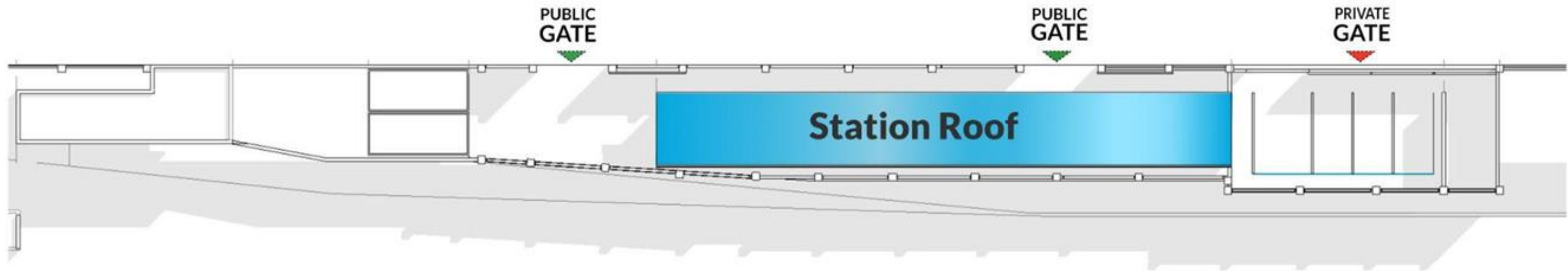

Roof Plan

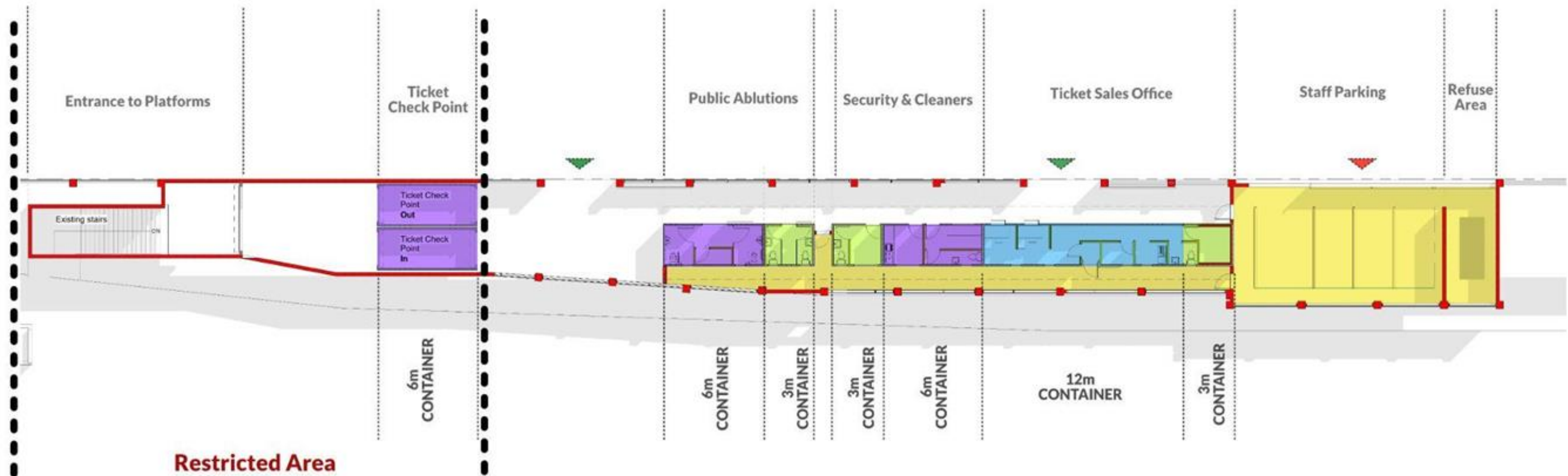

Ground Floor Plan

Strong Room Detail

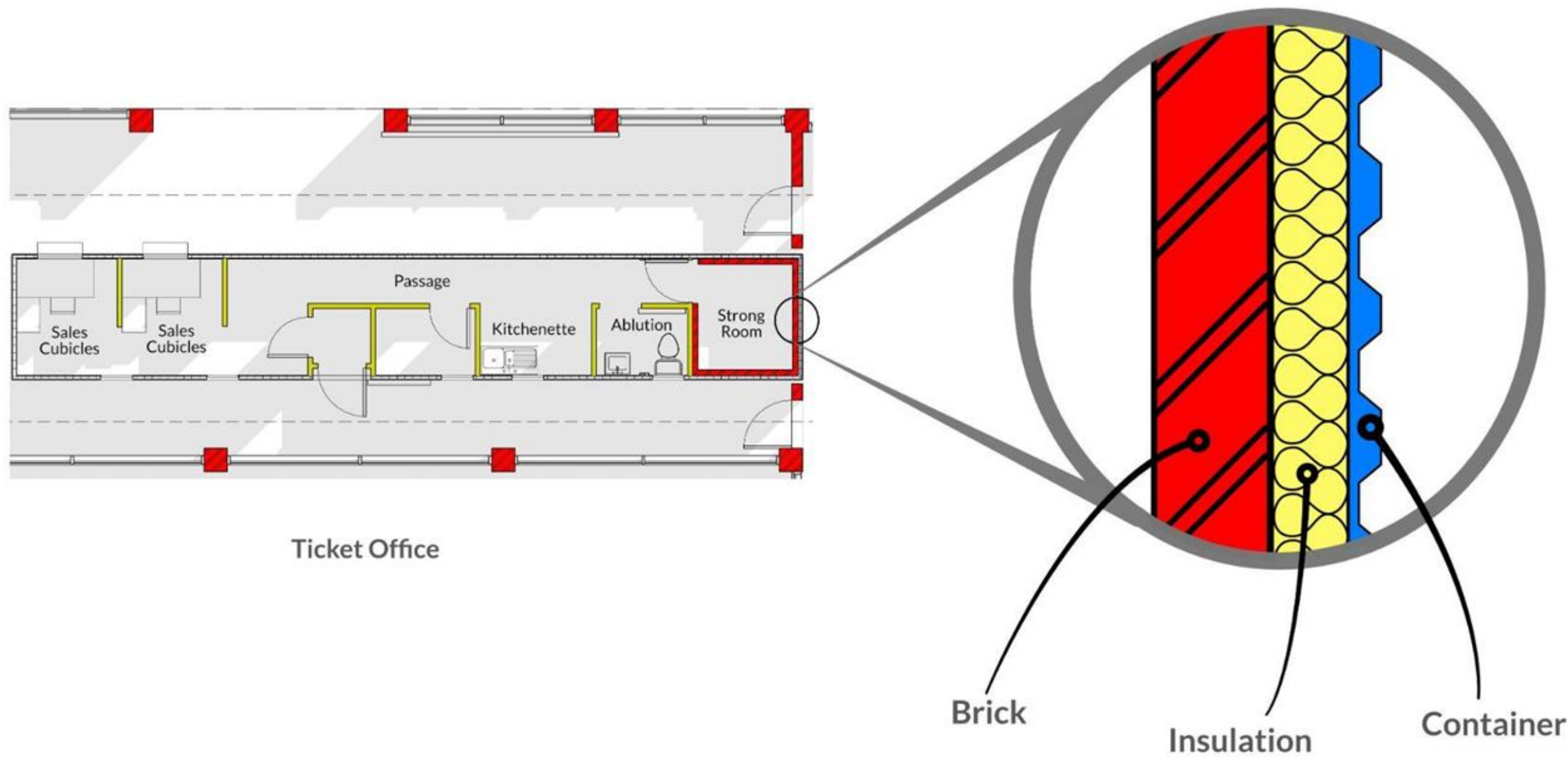

Basic Summary of Brief

- Full Ticket office suite - with 2 Ticket Sales Points
- Refuse Area
- Staff Parking
- Ticket Check Point
- Controlled Access to Platform
- 24hour Public Access Tunnel
- Public Ablutions
- Security & Cleaners Quarters

Design Proposal

To achieve these requirements

- Eight (8) High Cube Shipping Containers
 - Three (3) 3m Containers
 - Four (4) 6m Containers
 - One (1) 12m Containers
- Mixed in with some traditional brick and mortar



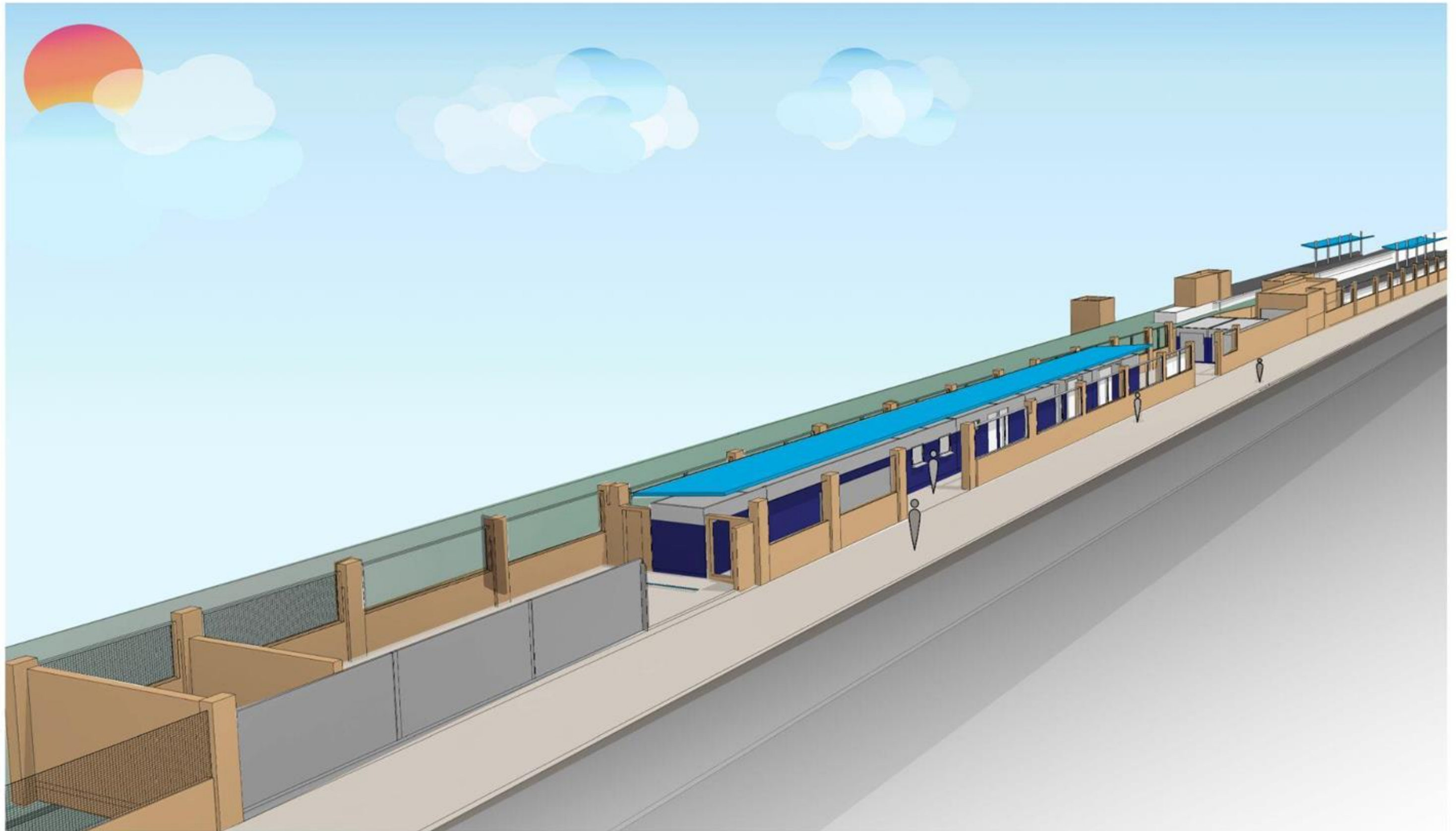

Diagram

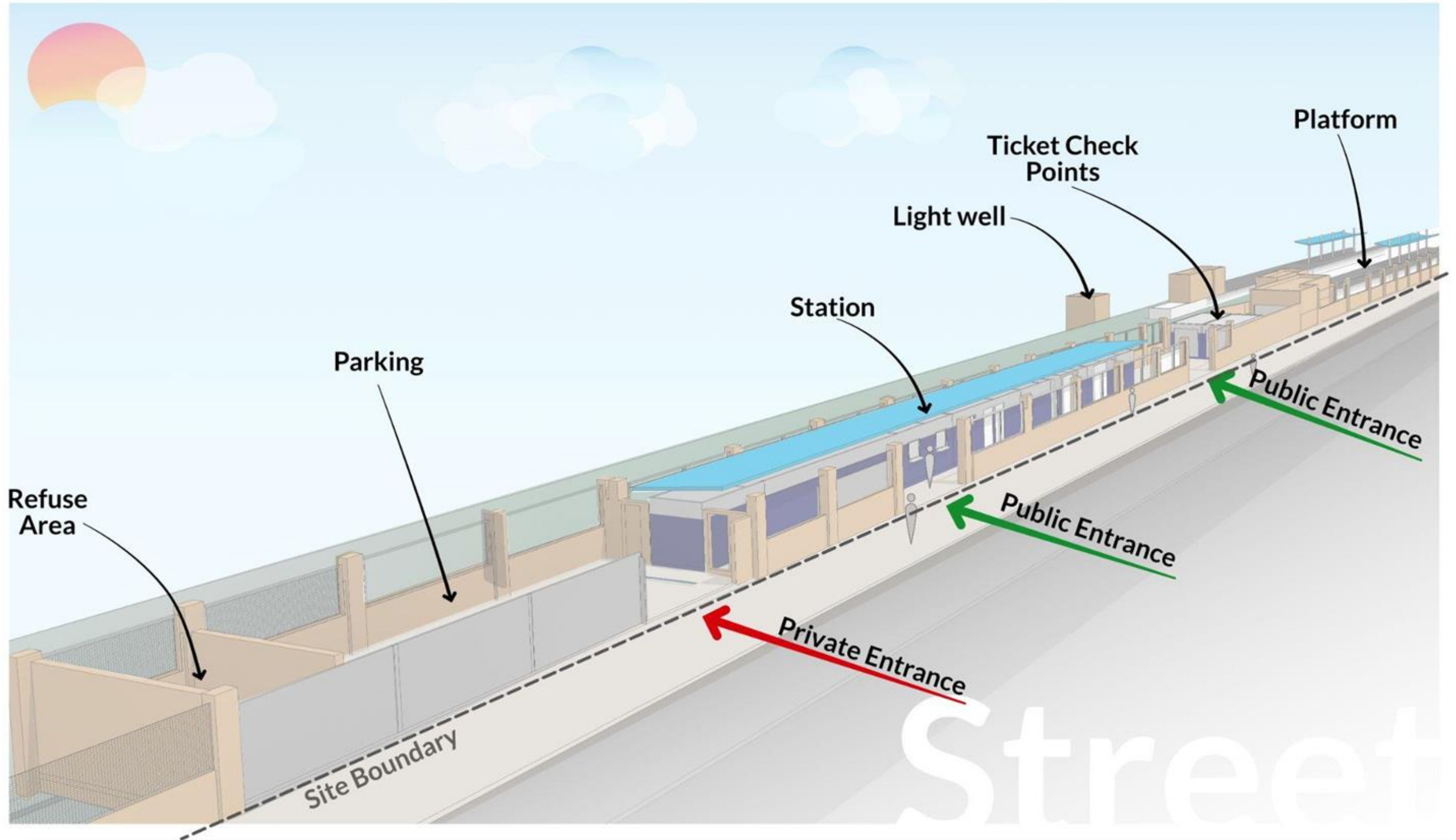

© 2022 Are Key Studios Pty Ltd. Produced by Are Key Studios. Cell: +27 81 349 2177. Email: info@arekeystudios.space. Website: https://arekeystudios.space/. Address: 40 Agriestoring Drive Hueloord, Centurion Gauteng 0157 Are Key Studios Pty Ltd. Reg.no. 2020 / 739448 / 07. A listed architectural practice with SACAP (PA10220704). Director: NRS Kekana (PrArch44840036).

PRASA Ceres South Gauteng Region - Braamfontein To Naledi (Corridor - 3)
Grosvenor Station - Halt, Rev B Date 2022.05.30
ABT Exploration Presentation, Stage 3



Section

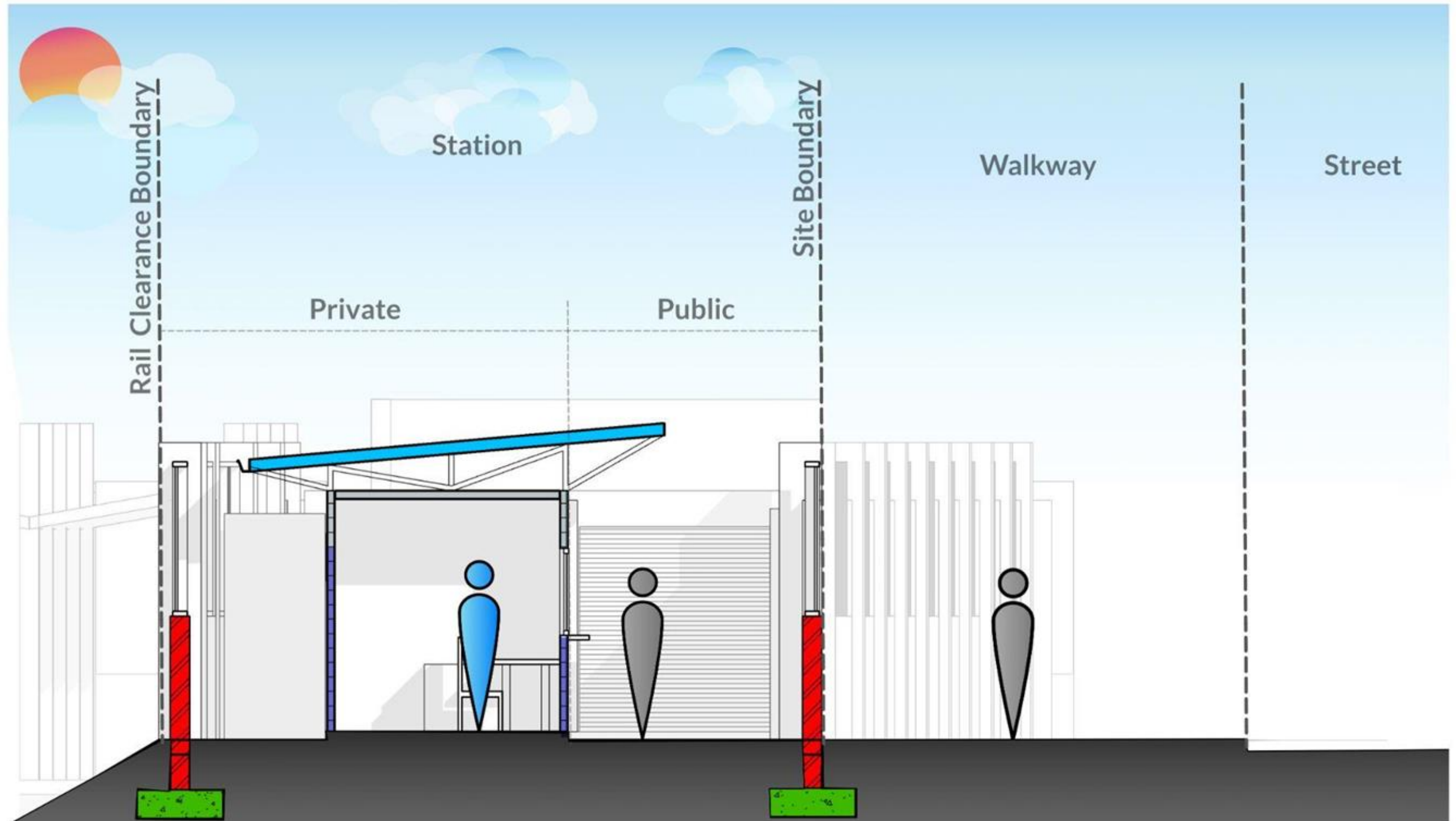

Well that's The First Station Layout & Here is the Second

Plans

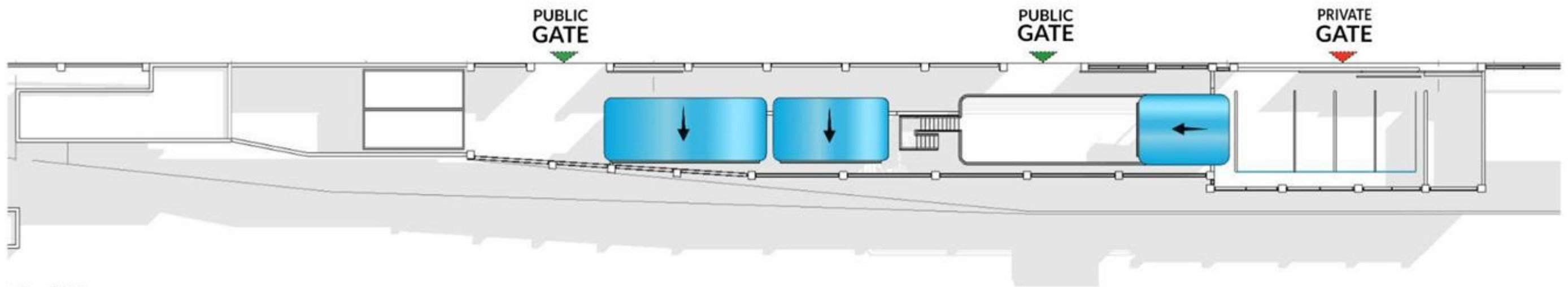

Roof Plan

Plans

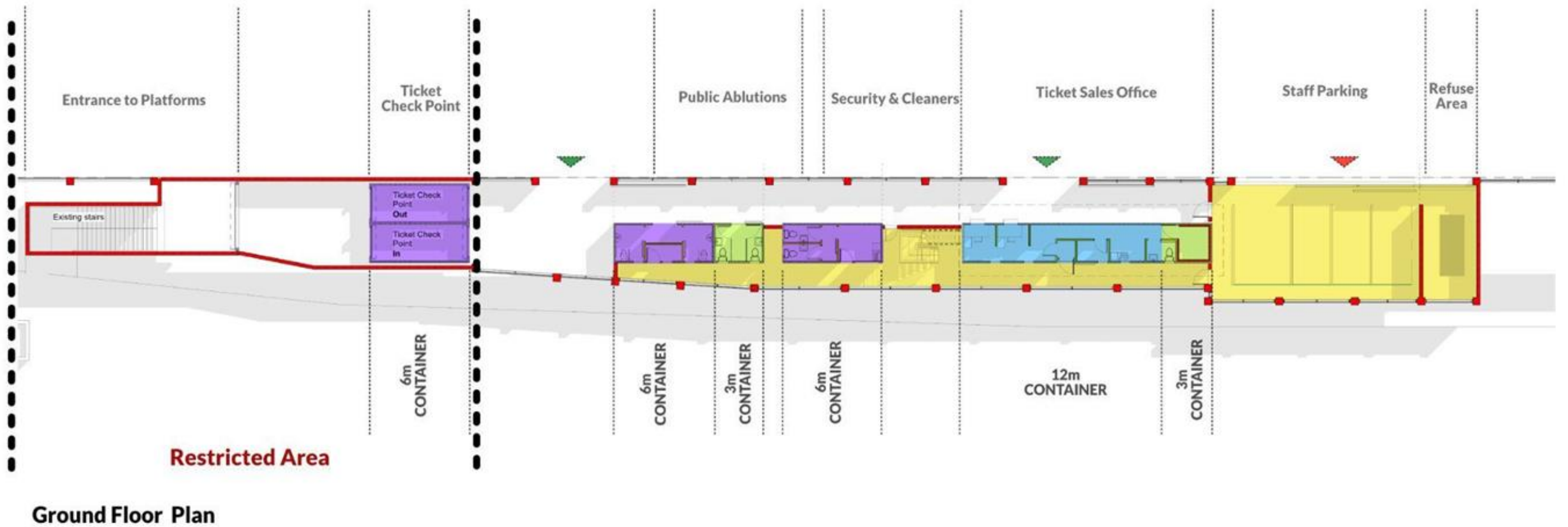
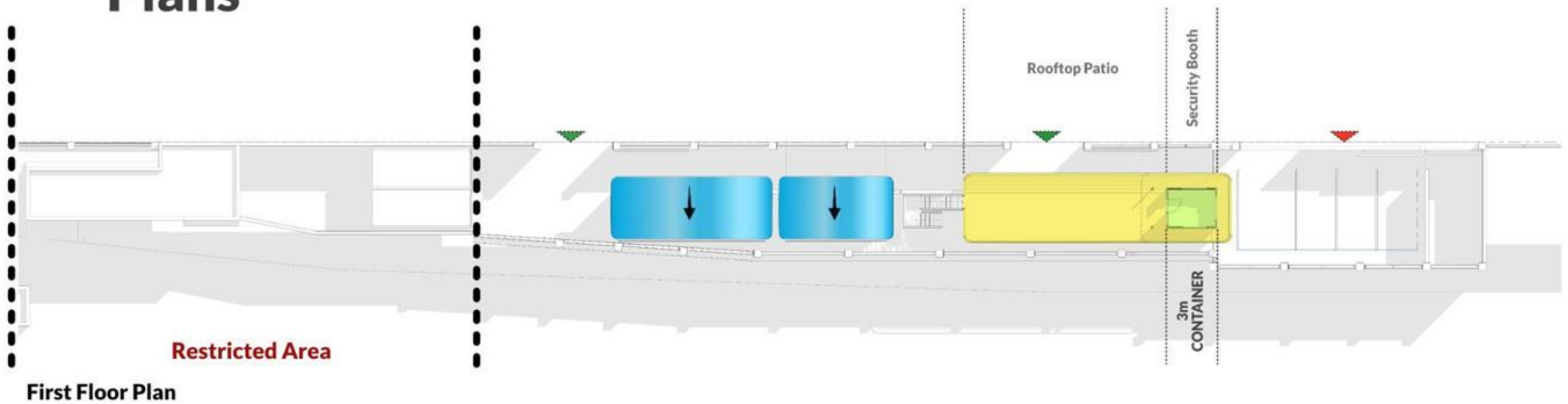

Strong Room Detail

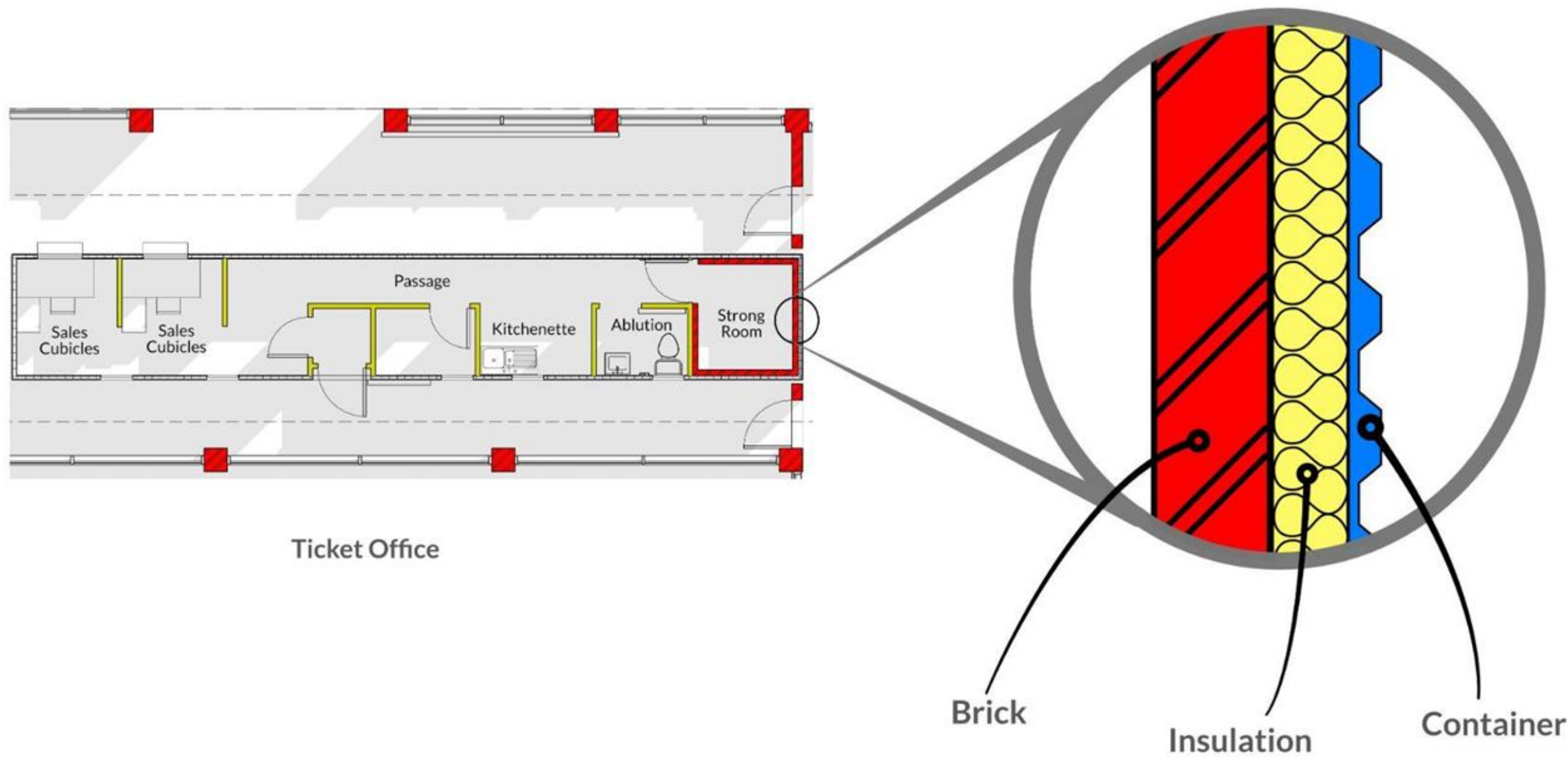

Basic Summary of Brief

- Full Ticket office suite - with 2 Ticket Sales Points
- Refuse Area
- Staff Parking
- Ticket Check Point
- Controlled Access to Platform
- 24hour Public Access Tunnel
- Public Ablutions
- Security & Cleaners Quarters

Design Proposal - Option 2

To achieve these requirements

- Eight (8) High Cube Shipping Containers
 - Three (3) 3m Containers
 - Four (4) 6m Containers
 - One (1) 12m Containers
- Mixed in with some traditional brick and mortar





Diagram

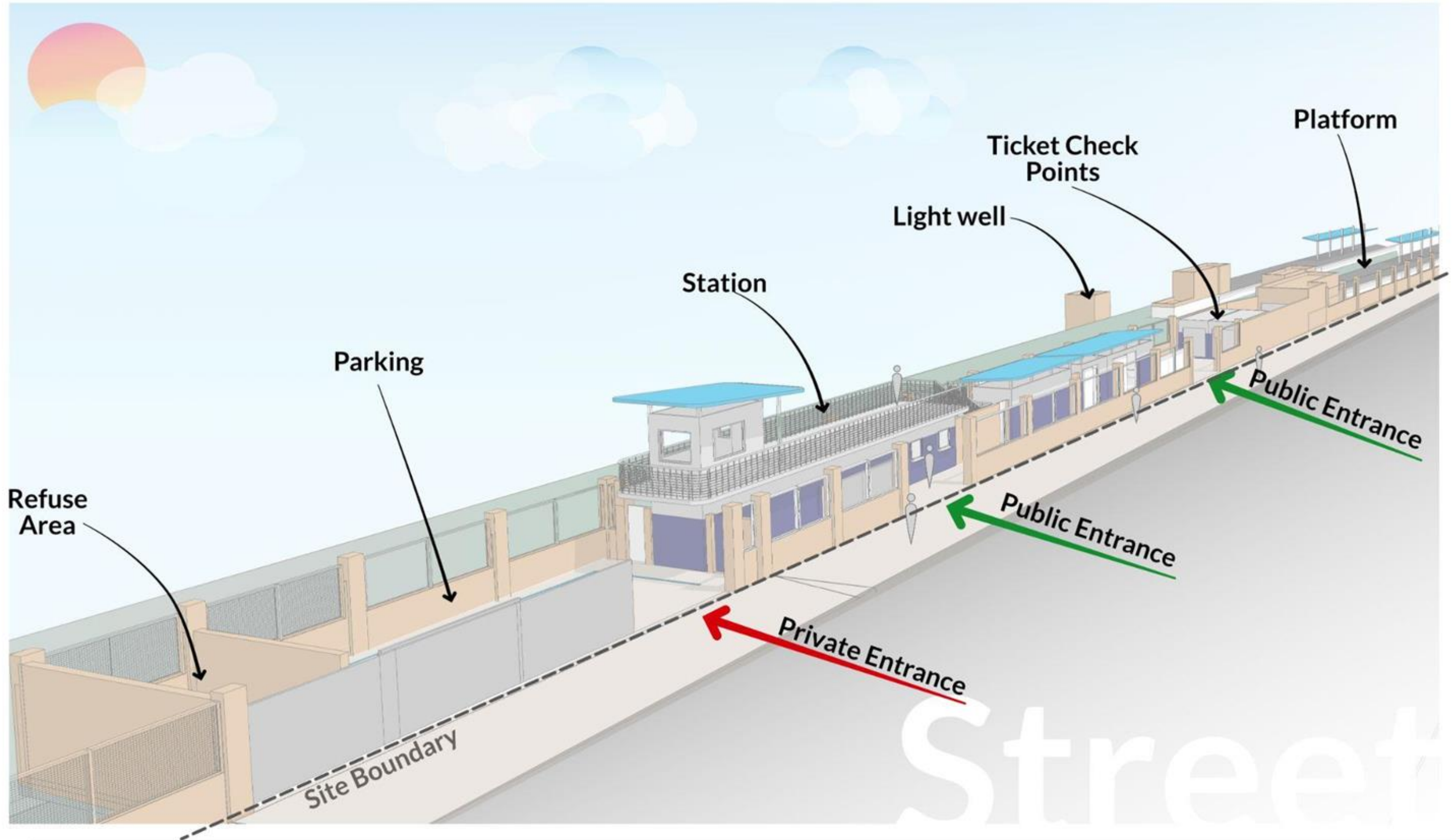

© 2022 Are Key Studios Pty Ltd. Produced by Are Key Studios. Cell: +27 81 349 2177. Email: info@arekeystudios.space. Website: https://arekeystudios.space/. Address: 40 Agriestoring Drive Hueloord, Centurion Gauteng 0157 Are Key Studios Pty Ltd. Reg.no. 2020 / 739448 / 07. A listed architectural practice with SACAP (PA10220704). Director: NRS Kekana (PrArch44840036).

PRASA Ceres South Gauteng Region - Braamfontein To Naledi (Corridor - 3)
Grosvenor Station - Halt, Rev B Date 2022.05.30
ABT Exploration Presentation, Stage 3



Section

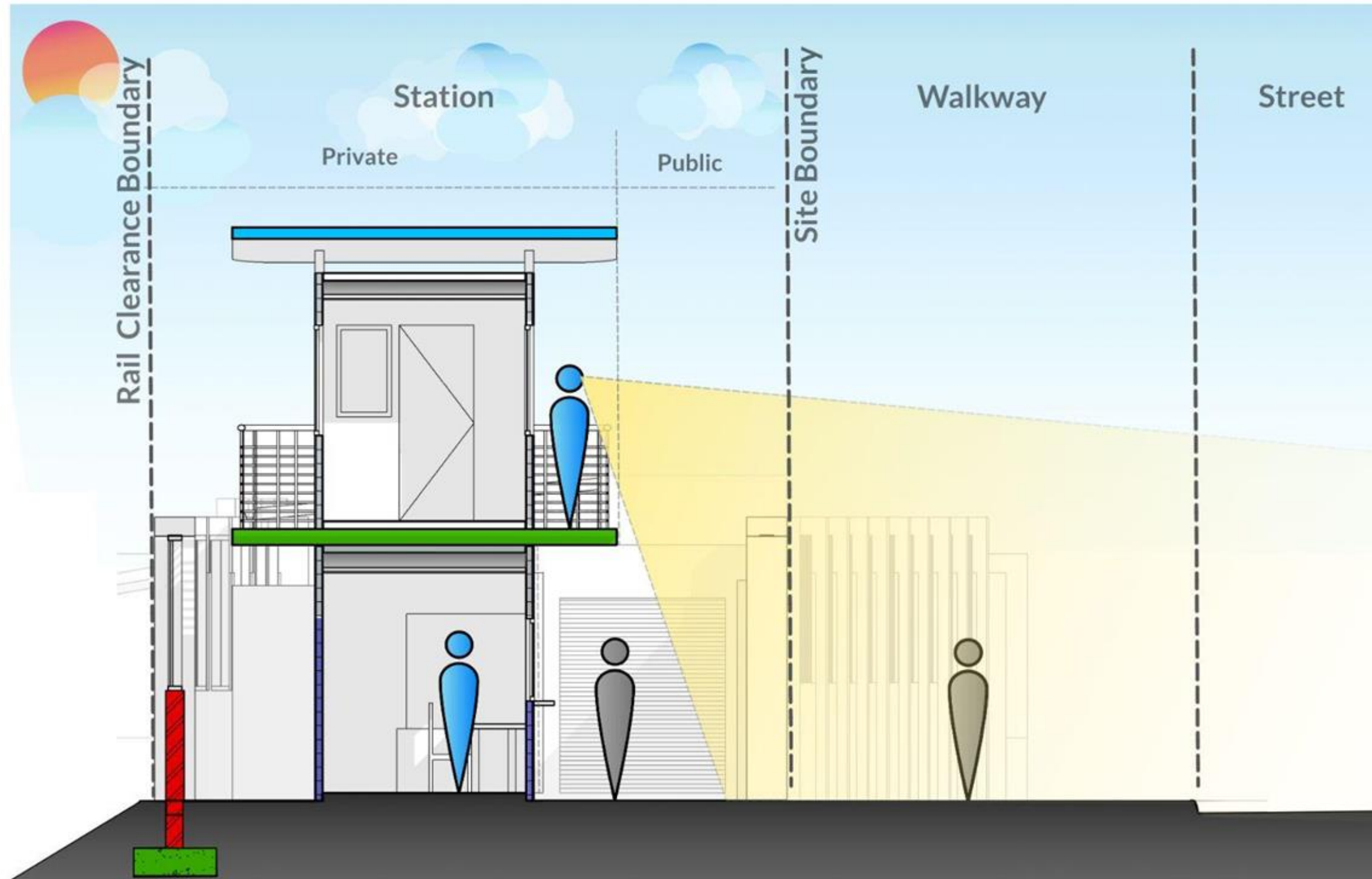

Aerial view



