

Existing Ticket Office Building Floor Plan

Scale 1:100

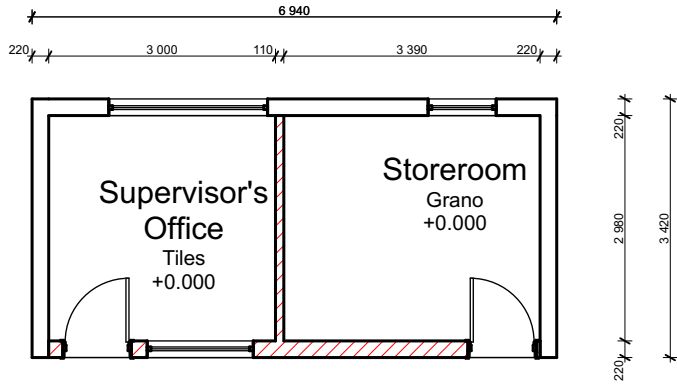

Supervisor's Office

Scale 1:100

Note:
Existing ticket office to
be converted to supervisor's
office and storeroom.

NORTH :	NOTES DRAWINGS ARE NOT TO BE SCALED. DIMENSIONS TO BE CHECKED INFORMATION RELATIVE TO SITE CONDITIONS TO BE CHECKED DISCREPANCIES TO BE REPORTED TO THE ARCHITECT BY THE USER WITHOUT DELAY AND PRIOR TO EXECUTION OF WORK ALL INFORMATION CONTAINED IN THIS DRAWING IS PROJECT SPECIFIC COPYRIGHT ARCHITECT DESIGN LAB. NO AMENDMENTS SHALL BE TO THIS DRAWING WITHOUT THE KNOWLEDGE OF THIS ARCHITECT AND WITHOUT THE REFERENCE TO THIS ARCHITECT.
----------------	---

SCHEDULE A: MEANS BY WHICH REGULATION A24 IS TO BE SATISFIED	
Occupancy / Building classification:	
DIMENSIONS:	The dimensions of any room or space are in accordance with the detailed requirements of SANS 10400-C.
PUBLIC SAFETY:	A change in level, the design of ramps and driveways, or access to swimming pools and swimming baths is in accordance with the detailed requirements of SANS 10400-D.
SITE OPERATIONS:	The provision of sanitary facilities is in accordance with the detailed requirements of SANS 10400-F.
EXCAVATIONS:	The excavation relating to a building is less than 0.3 m deep and is in accordance with the detailed requirements of SANS 10400-G (is the subject of a rational design or a rational assessment (or both)).
FOUNDATIONS:	A geotechnical investigation in accordance with the rules is to be carried out and is available for use. The foundations for the building are in accordance with SANS 10400-H - the detailed requirements of SANS 10400-H.
FLOORS:	Floors in any laundry, kitchen, shower room, bathroom or room containing a toilet pan or urinal are in accordance with the detailed requirements of SANS 10400-I. Suspended floors are in accordance with the requirements of SANS 10400-J and SANS 10400-K. The requirements of SANS 10400-L. The detailed requirements of SANS 10400-L. Slabs supported on the ground are in accordance with SANS 10400-M. Slabs supported on the ground are in accordance with SANS 10400-N. A competent person (civil engineering) is to be appointed in respect of the slab or slabs.
WALLS:	The structural strength and stability of a wall is in accordance with SANS 10400-B and SANS 10400-C. The water penetration through a wall is in accordance with the detailed requirements of SANS 10400-E. The water penetration through a wall is in accordance with the detailed requirements of SANS 10400-E.
STAIRWAYS:	Any in accordance with SANS 10400-B and SANS 10400-T. The detailed requirements of SANS 10400-M. Walls, ceilings, ceilings or balustrades to each stairway are in accordance with the requirements of SANS 10400-B and SANS 10400-T. SANS 10400-A and SANS 10400-T.
GLAZING:	The type and fixing of glazing is in accordance with SANS 10400-B. The detailed requirements of SANS 10400-N. The selection of the glazing is in accordance with the detailed requirements of SANS 10400-N.
LIGHTING & VENTILATION:	The lighting in a habitable room, bathroom, shower room and room containing a toilet pan complies with the requirements of SANS 10400-T and the detailed requirements of SANS 10400-O. The ventilation is in accordance with the requirements of SANS 10400-T and is in accordance with the detailed requirements of SANS 10400-C.
DRAINAGE:	The design of the drainage system is in accordance with the detailed requirements of SANS 10400-P. The subject of a rational design or rational assessment (or both).
NON WATER-BORNE:	Is in accordance with the detailed requirements of SANS 10400-Q. Is the subject of a rational design or rational assessment (or both). Is the subject of a rational design or rational assessment (or both). The subject of a rational design or rational assessment (or both).
STORM WATER DISPOSAL:	The means for the control and disposal of stormwater is in accordance with the requirements of SANS 10400-R. The subject of a rational design or rational assessment (or both). The subject of a rational design or rational assessment (or both).
PERSONS WITH DISABILITIES:	The means for providing facilities for persons with disabilities is in accordance with the detailed requirements of SANS 10400-S. The subject of a rational design or rational assessment (or both).
FIRE PROTECTION:	The fire protection measures provided are in accordance with the detailed requirements of SANS 10400-T. The subject of a rational design or rational assessment (or both).
SPACE HEATING:	The provision of space heating is in accordance with the detailed requirements of SANS 10400-V.
FIRE INSTALLATION:	The fire installations comply with the detailed requirements of SANS 10400-W. The supply of water is in accordance with the detailed requirements of SANS 10400-W. The subject of a rational design or rational assessment (or both).
ENERGY EFFICIENCY IN BUILDINGS:	The building is so designed that: Orientation and shading are in accordance with the requirements of SANS 204. External walls are in accordance with the detailed requirements of SANS 10400-XA. Foundation is in accordance with SANS 10400-XA. Roof assembly construction is in accordance with SANS 10400-XA. Floors with insula heating is in accordance with SANS 10400-XA. Services that use energy or control the use of energy is in accordance with SANS 204. Hot water systems is in accordance with SANS 10400-XA. A competent person certifies that the building has a theoretical annual energy consumption and demand less than or equal to a reference building that complies with the requirements of SANS 10400-XA.

REVISIONS		
REV:	DATE:	DESCRIPTION:
0	09/11/2022	FOR CONCEPT



30 Long Reach Road
Donchester Heights
East London
Principal Architect: Taurai Chinoruma
SACAP Reg Number: 24748561

CLIENT:

PROJECT :
**ADDITIONS AND ALTERATIONS FOR
SYDENHAM STATION , PORT ELIZABETH**

ERF NUMBER:
SYDENHAM STATION, PORT ELIZABETH

DRAWINGS :
TICKET OFFICES

SCALE : AS SHOWN	MEASUREMENT : MM	DATE : 12 NOV. 2022	ISSUED FOR : CONCEPT
DRAWN BY : T. CHINORUMA	CHECKED BY : T. CHINORUMA	CLIENT SIGNATURE :	
PROJECT NUMBER: AP/2022-037		REVISION NUMBER: 0	
DRAWING NUMBER: SYND/SK-002		PAPER SIZE: A-3	