

GENERAL NOTES

1. SPECIFIC CATALOGUE DIMENSIONS WITH REGARD TO PUMPING EQUIPMENT, VALVES, ETC. WERE USED IN THE DESIGN LAYOUTS. SHOULD DIMENSIONS OF APPROVED EQUIPMENT NOT COINCIDE WITH THOSE OF THE DESIGN, IT SHALL BE THE **CONTRACTOR'S SOLE RESPONSIBILITY** TO REVISE SUCH DIMENSIONS ACCORDINGLY, TO THE APPROVAL OF THE ENGINEER.
2. **ITEM:**
EACH ITEM IS TO BE CLEARLY MARKED ACCORDING TO THE NUMBERS GIVEN IN THE LIST
3. ALL FLANGES ARE TO BE IN ACCORDANCE WITH SABS 1123, UNLESS STATED DIFFERENTLY.
- | CLASS | WORKING PRESSURE | TABLE SABS 1123 |
|-------|------------------|-----------------|
| 6 | 600 kPa | 600/3 |
| 10 | 1 000 kPa | 1 000/3 |
| 16 | 1 600 kPa | 1 600/3 |
| 25 | 2 500 kPa | 2 500/3 |
| 40 | 4 000 kPa | 4 000/3 |
- * FLAT FACED FLANGES TO BE USED
TESTING PRESSURE - 1.5 x WORKING PRESSURE, FOR ALL FLANGES, COUPLING AS WELL AS PUDDLE FLANGES.
- IT IS ESSENTIAL THAT PUDDLE FLANGES ARE NOT DRILLED.**
WHERE PUDDLES ARE NON STANDARD SUCH PUDDLE FLANGES NEED NOT BE CIRCULAR, BUT SHALL MEET THE SPECIFIED PRESSURE RATING AND SHALL PROJECT AT LEAST 100mm FROM OUTER WALL OF THE PIPE.
- GASKETS FOR PRESSURE RATINGS UP TO AND INCLUDING 2 500 kPa, SHALL BE CUT FROM MATERIAL MANUFACTURED TO THE SPECIFICATION BEP J59, OR EQUIVALENT. GASKETS FOR PRESSURE RATINGS ABOVE 2 500 kPa UP TO AND INCLUDING 4 000 kPa, SHALL BE CUT FROM MATERIAL MANUFACTURED TO THE SPECIFICATION B.S. 2815 B, OR EQUIVALENT. GASKETS FOR PRESSURE RATINGS UP TO AND INCLUDING 1 600 kPa SHALL BE 3 mm THICK CAF FULL FACE GASKETS. GASKETS FOR PRESSURE RATINGS ABOVE 1 600 kPa SHALL BE 3 mm THICK CAF RING GASKETS.
4. **PROTECTION CODES:**
- EP:** ALL SURFACES SHALL BE BLAST CLEANED TO SA 2½ AND TO BE COATED WITH 3 LAYERS OF EPOXY RESIN TO GIVE A MIN. DRY FILM THICKNESS OF 250µm. REFER TECHNICAL SPECIFICATION: PUMPS, PIPEWORK AND ANCILLARY EQUIPMENT CLAUSE 1.2.3, 1.2.4 AND 1.2.5
- FP:** FACTORY PROTECTION.
- CM:** ALL PIPE SPECIALS TO BE SANDBLASTED TO Sa 2½, CLEANED AND TO BE COATED WITH SINTAKOTE EXTERNAL, 10mm THICK CEMENT MORTAR LINED INTERNAL.
- GM:** HOT DIPPED GALVANISED MILD STEEL IN ACCORDANCE WITH THE SPECIFICATION.
5. **MATERIAL:** GRADE 300 WA STEEL AS PRESCRIBED IN SABS 1431 WITH A MINIMUM WALL THICKNESS AS SPECIFIED.
ALL PIPE ITEMS TO BE 4.5mm MINIMUM WALL THICKNESS UNLESS INDICATED DIFFERENTLY. ALSO REFER TECHNICAL SPECIFICATION: PUMPS, PIPEWORK AND ANCILLARY EQUIPMENT CLAUSE 2.3.4 FOR MINIMUM WALL THICKNESS.
6. **VALVES:**
ALL VALVES TO BE FLANGED AND RATED PN10 MINIMUM.
ALL GEARBOX POSITIONS TO BE AS FOR RIGHT HAND VALVE, RIGHT HAND PROJECTION, UNLESS STATED DIFFERENTLY ON DRAWINGS OR ITEM LIST.
RESILIENT SEAL GATE: IN ACCORDANCE TO SABS 664, RIGHT HAND LOCKING. ALL VALVES ARE TO BE EQUIPPED WITH HAND WHEELS, UNLESS OTHERWISE STATED. VALVES TO BE SUPPLIED WITH THE NECESSARY PRESSURE REDUCERS AND / OR GEARS TO ENABLE FUNCTIONING AT THE SPECIFIED UNBALANCED PRESSURE.
7. **ABBREVIATIONS:**
AC - ASBESTOS CEMENT
CI - CAST IRON
FA - FLANGE ADAPTOR
FC - FLEXIBLE COUPLING
GS - GALVANISED STEEL
MS - MILD STEEL
SS - STAINLESS STEEL
8. **BOLTS**
BOLT LENGTHS SHALL MAKE ALLOWANCE FOR TWO x 3mm THICK WASHERS AND A 3mm THICK GASKET SHALL BE PROVIDED FOR EACH PIPE ITEM AS LISTED. BOLTS THAT PROTRUDE BEYOND THE NUT BY A MINIMUM OF TWO THREADS, WHEN THE ASSEMBLIES ARE FULLY TIGHTENED, SHALL BE USED.

A WASHER SHALL BE FITTED UNDER ALL BOLT/SCREW HEADS AND NUTS.

ALL BOLTS, NUTS AND WASHERS ON PIPE WORK TO BE HOT DIP GALVANISED MS
- EXCEPTIONS SHALL BE**
FOR SS TO SS FLANGE CONNECTIONS, OR NON-INSULATED SS TO MS FLANGE CONNECTIONS
- CONNECTING MATERIAL FOR SUCH TO BE POWDER COATED 304 SS BOLTS, NUTS AND WASHERS.
9. PROVIDE APPROPRIATE BOLT UNITS (CONSISTING OF A STANDARD LENGTH BOLT, NUT AND TWO WASHERS) AND RING GASKET FOR EACH SET OF FLANGES AND FOR FLANGE ADAPTOR TO FLANGE INSTALLATIONS.
10. **SUPPORTS AND ANCHOR SUPPORTS**
SUPPORTS OR ANCHOR SUPPORTS ARE REQUIRED FOR CERTAIN PIPE ITEMS.
TENDERER TO SUBMIT DETAILS OF PROPOSED SUPPORTS AND ANCHORS AS PART OF WORKSHOP DRAWINGS REQUIRED FOR EACH PIPE ITEM. IF NOT DETAILED, NO SITE WELDING SHALL BE PERMITTED ON SUPPORTS OR ANCHORS, WHICH COULD DAMAGE FACTORY APPLIED CORROSION PROTECTION. ALL ANCHOR BOLTS TO BE 16 mm Ø MINIMUM of 316 STAINLESS STEEL.
11. **PIPE DETAILING:**
LAYOUTS DETAILED INCLUDE FOR A 3mm THICK GASKET.
12. PIPE ITEM DIMENSIONS ON DRAWINGS NEED TO BE VERIFIED BY THE CONTRACTOR ON SITE PRIOR TO THE MANUFACTURE OF ANY ITEMS.

PIPE LIST

800mm Ø OUTLET PIPE ASSY					AMEND
ITEM	AMOUNT	CLASS	PROTEC-TION	DESCRIPTION	DIMENSIONS
7.4.1	2	10	FP	800mm Ø FLANGE ADAPTOR.	STANDARD
7.4.2	1	10	SS	800mm Ø FLANGED SS GRADE 304 PIPE PIECE, WITH POSITION OF PUDDLE FLANGE AS INDICATED.	5049
					4522
7.4.3	1	10	EP	800mm Ø FLANGED GMS PIPE PIECE, WITH POSITION OF PUDDLE FLANGE AS INDICATED.	541 541
7.4.4	1	10	FP	800mm Ø, RSV GATE VALVE FLANGED BOTH ENDS AND DRILLED TO SABS 1123, TABLE 2500/3.	711

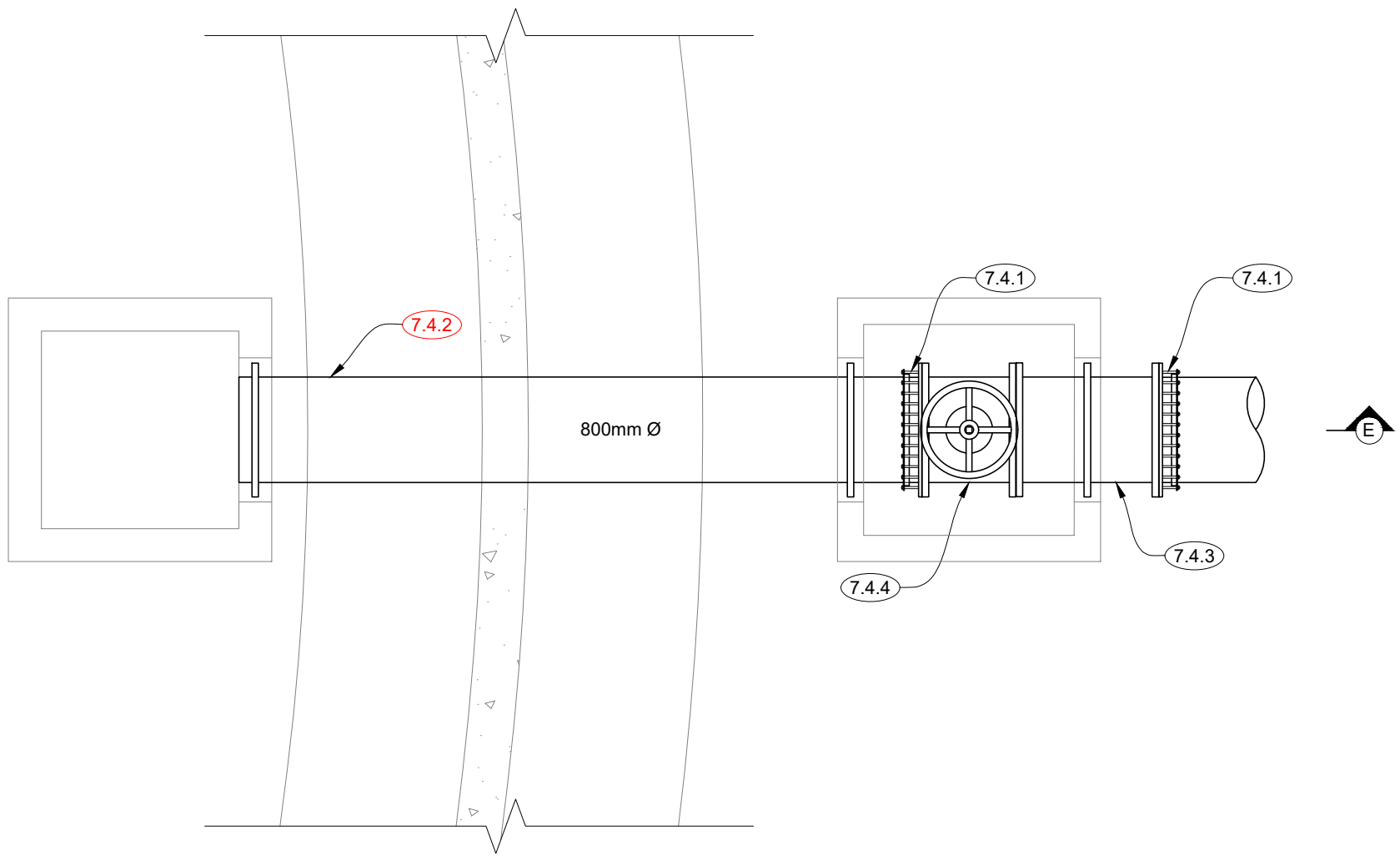

PLAN OF OUTLET PIPEWORK

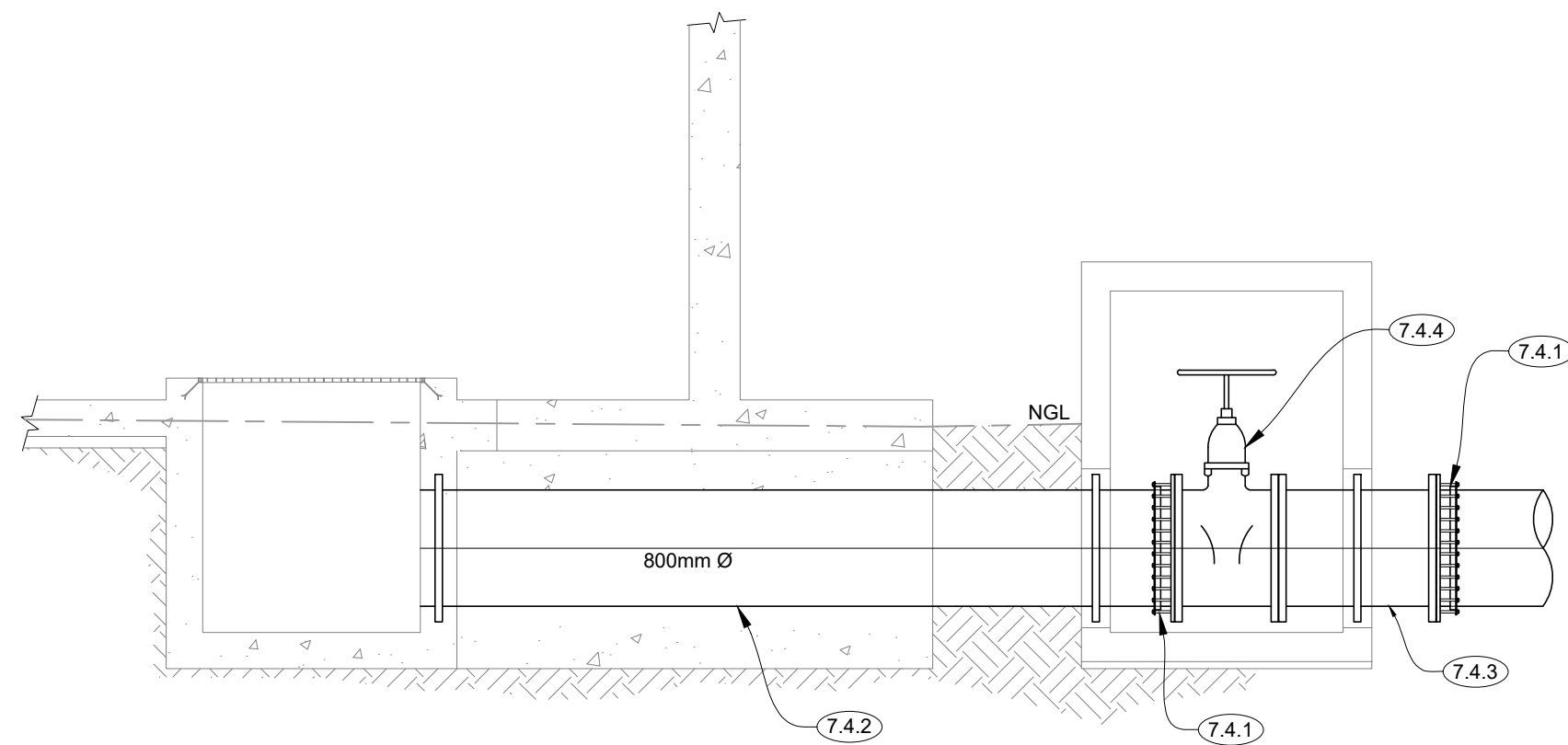

SECTION E-E : DETAILED SECTION OF OUTLET PIPEWORK

FOR TENDER PURPOSE

COPYRIGHT RESERVED

RA	REVISED PROJECT DESCRIPTION	2022/06/09	P.M
Rev. Her.	Description Beskrywing	Date Datum	By Deur

AMENDMENTS/WYSIGING

SERVICE	DIENS
---------	-------

MECHANICAL

DESIGNED/ONTWERP	J. LUCKHOFF
DRAWN/GETEKEN	I.NEL
CAD FILE NAME/CAD LÊER NAAM	N3110M7001RA-003RA.dwg
CHECKED/NAGESIEN	W.J. STRYDOM (jnr)
APPROVED/GOEDGEKEUR	W.J. STRYDOM (jnr)

ENDECON
UBUNTU (PTY) LTD
ENGINEERING CONSULTANTS
P.O. BOX 10345
NELSPRUIT
1200
Tel:(013) 755 1190
Fax:(013) 755 4904

CLIENT
Nkangala District Municipality
KLIËNT

PROJECT
LOSKOP REGIONAL BULK WATER SUPPLY SCHEME: WORK PACKAGE 2
PROJEK

TITLE
10 MI RAW WATER RESERVOIR: OUTLET DETAILS
TITEL

DATE/DATUM
DECEMBER 2021
SCALE/SKAAL
1:50

SCALE REF.
4.0 2.0 0 2.0 4.0
3.0 1.0 1.0 3.0
meter
SKAAL VERWYS.

CONSULTANT DWG. NO.
N/3110/M/7/003/RA
CONSULTANT TEK. NR.
CLIENT DWG. NO.
KLIËNT TEK. NO.