

NOTES:
 1. THIS DRAWING SHOULD BE READ IN CONJUNCTION WITH THE PROJECT SPECIFICATIONS AND THE GENERAL LAYOUTS, TYPICAL CROSS SECTIONS AND ROAD SETTING OUT DRAWINGS APPLICABLE TO WORKPACKAGES 2,3,4 AND 5.

TYPICAL BARRIER ELEVATION
SCALE 1:25

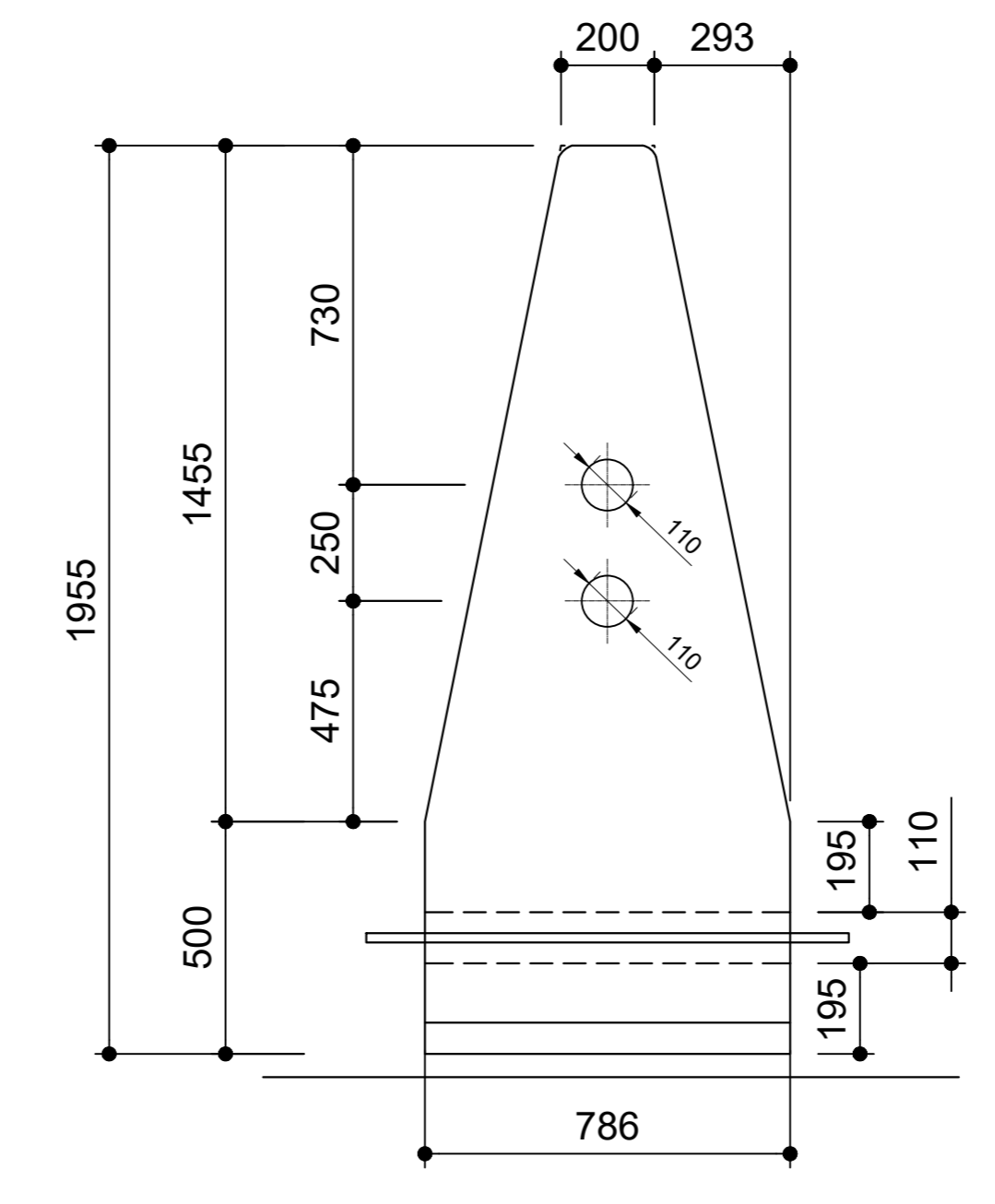

- NOTES
- MATERIAL REQUIREMENTS
CONCRETE GRADE: 40/19
 - MATERIAL CHARACTERISTICS
CONCRETE :32 GPa
MILD STEEL :250 MPa
HIGH TENSILE STEEL :450 MPa
 - MINIMUM LAP LENGTH: 50x REBAR Ø
 - SURFACES
HIDDEN : CLASS 1
EXPOSED : CLASS 3(a)
COVER : 50mm MIN.
CHAMFERS: 25x25mm UNLESS SPECIFIED
 - MEDIAN BARRIERS HAVE BEEN DESIGNED TO:
(a) TMH 7: PARTS 1 & 2 (1981 REVISED 1988):
NA& NB36 TRAFFIC LOADING
(b) TMH 7: PART 3 (1989)

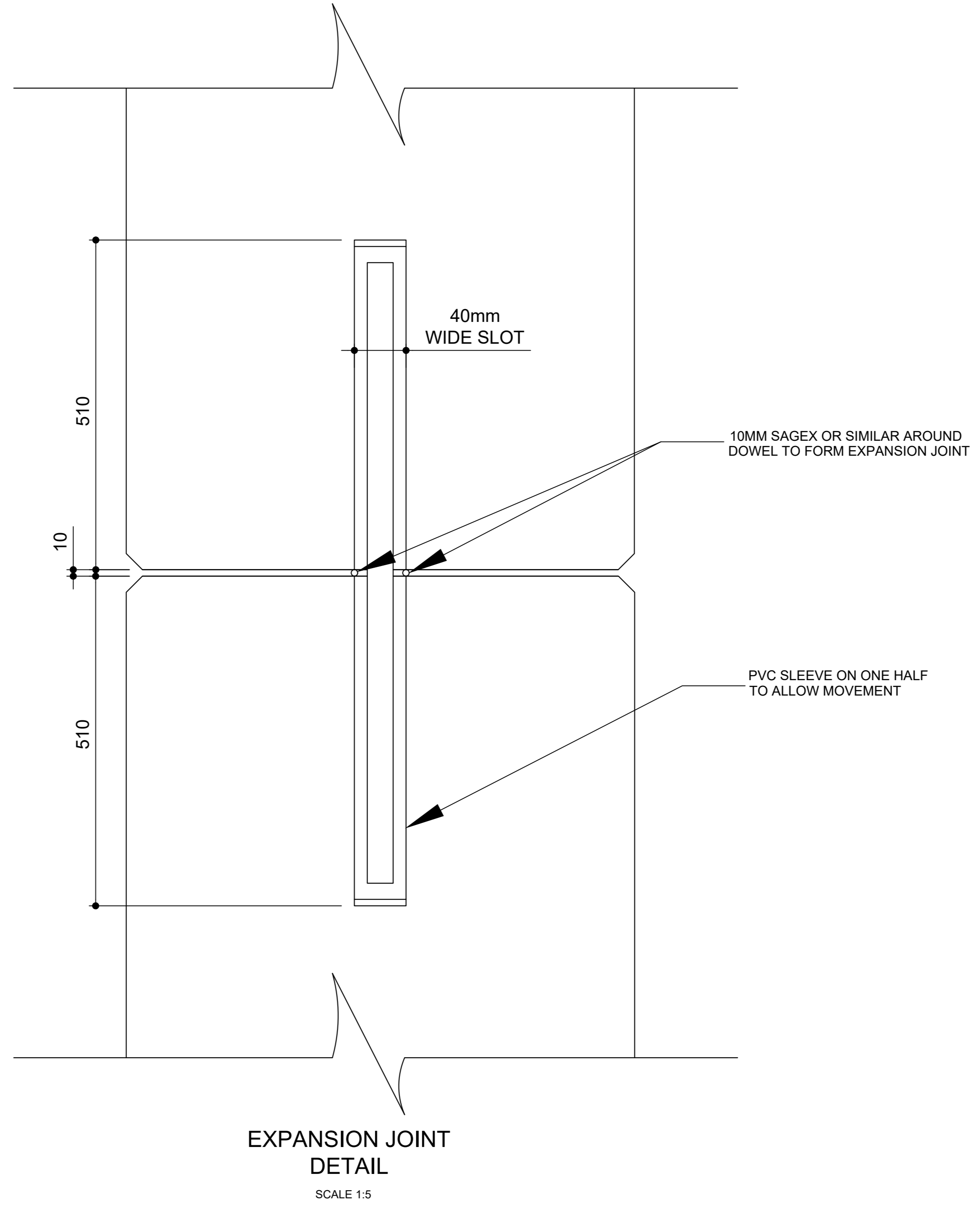
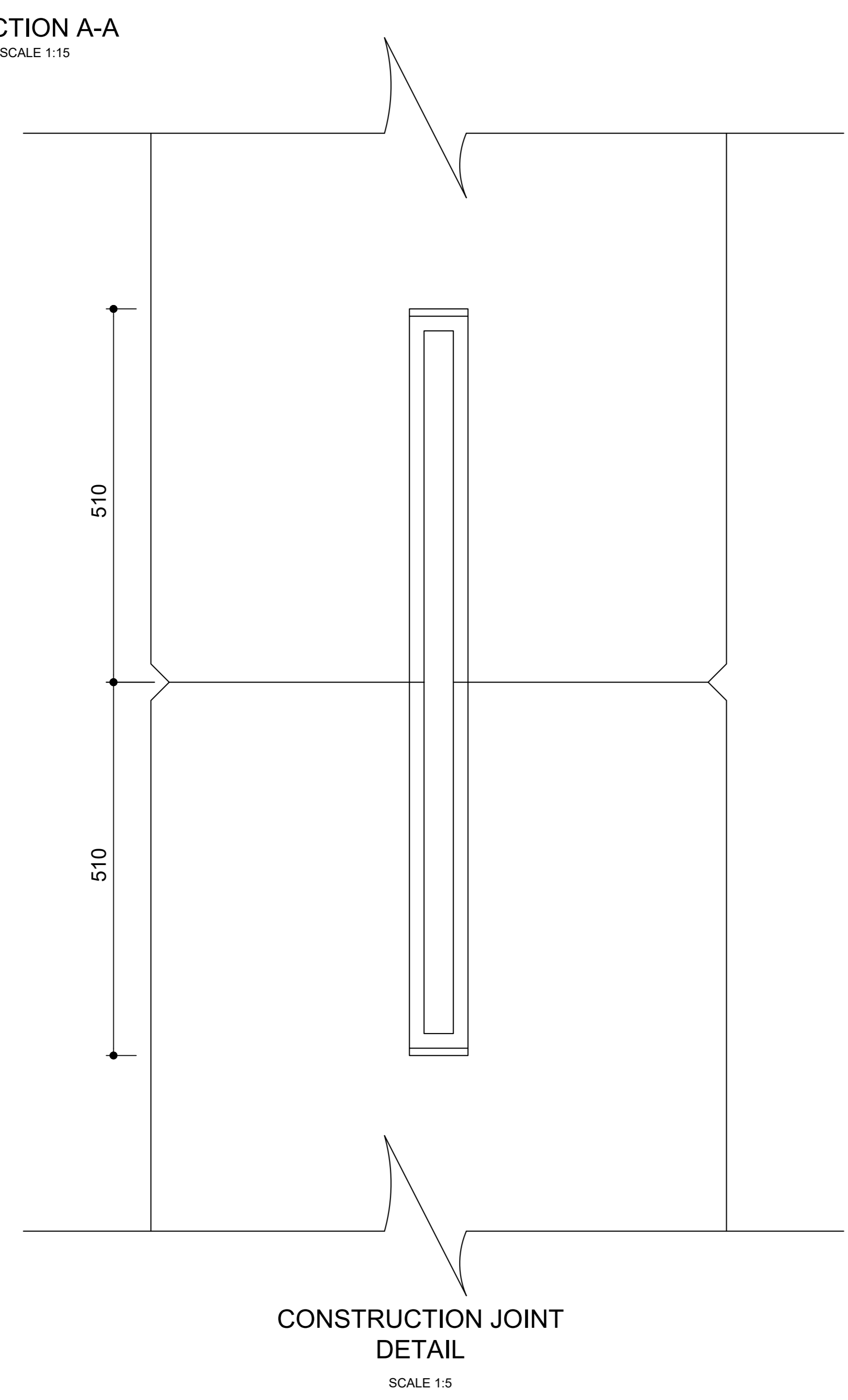

FOR TENDER PURPOSES ONLY
 NB: FINISHED CONCRETE LEVELS
 SUBJECT TO CHANGE

Revision	Date	Description
V1	05/06/2021	ISSUED FOR TENDER
NOTE: No construction work to commence until land and servitude acquisitions have been completed		
Acquisitions completed:		
Date	Engineer	
UNDERGROUND SERVICES CHECKED		
SERVICE	DATE	SIGNATURE
S/W DRAINS		
SEWERS		
WATER MAINS		
G.P.O CABLES		
ELECTRIC CABLES		
S.A.R. CABLES		
E.S.C. CABLES		
OIL PIPE LINE		
NOTE: Only underground services affected by new construction work are shown. Care must be taken during excavations for road foundations, trenches etc. to avoid damage to underground services such as sewers, drains, cables, water mains and connections. Whenever possible these must be located before work proceeds.		
Contract No.	1T-47319	
Project Title	IRPTN - C3 CORRIDOR: CROSSROADS CONSTRUCTION AND CULVERT WIDENING OVER PIESANG RIVER	
Drawing Title	M25 CULVERT EXTENSION OVER PIESANG RIVER IRPTN BRT CONCRETE BARRIER DETAILS	
SCALES	AS SHOWN	Date: 16/06/2021
Designed:	ENGINEER	Checked: P. FENTON
Drawn:	HLAKA MBINA	Surveyed: SURVEY DEPT.
Manager:	Structures	
Deputy Head:	Roads Provision	
G. EVANS	HEAD : ENGINEERING	
Drawing No.	48918	Sheet of Rev. 06 06 V1