

1:100 FIRST FLOOR AIR CONDITIONING LAYOUT

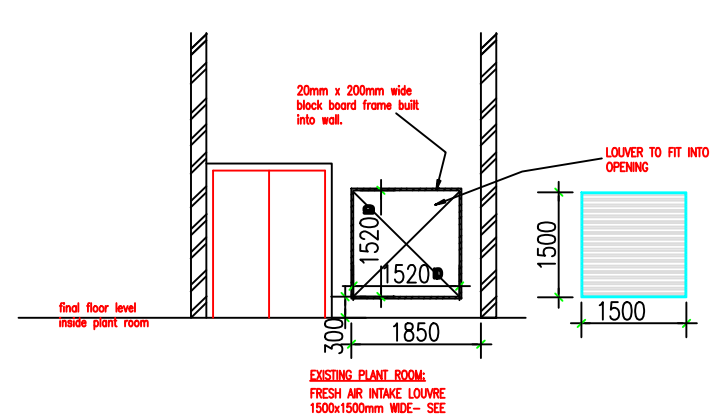
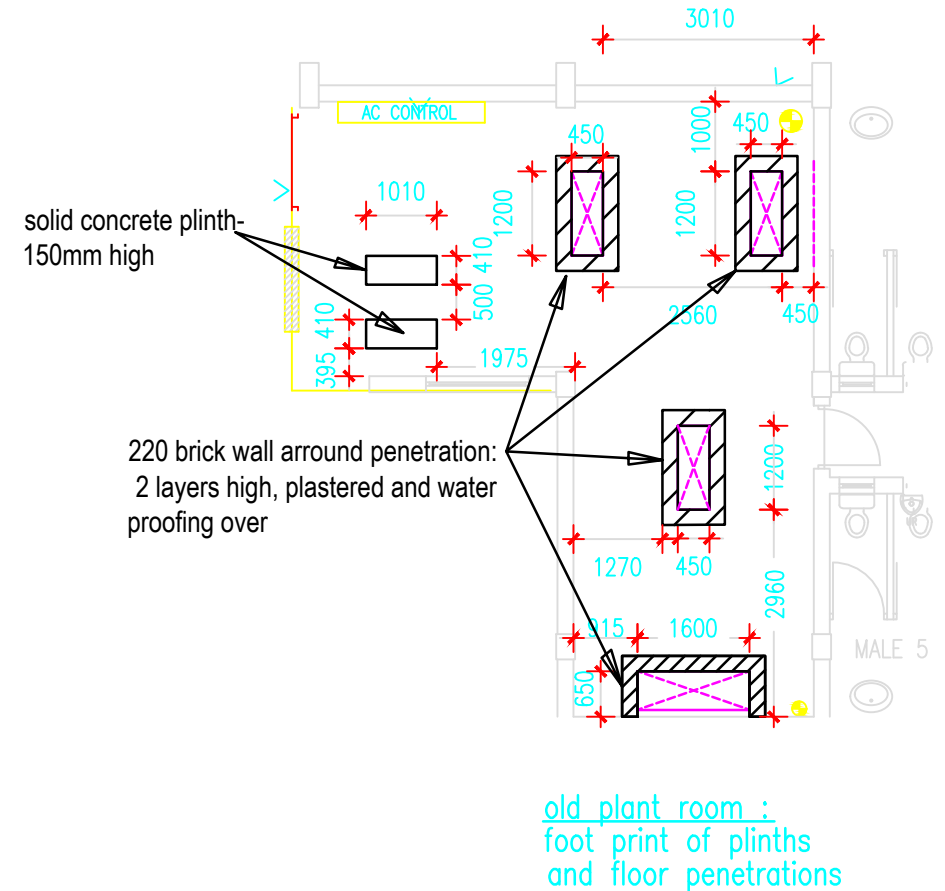
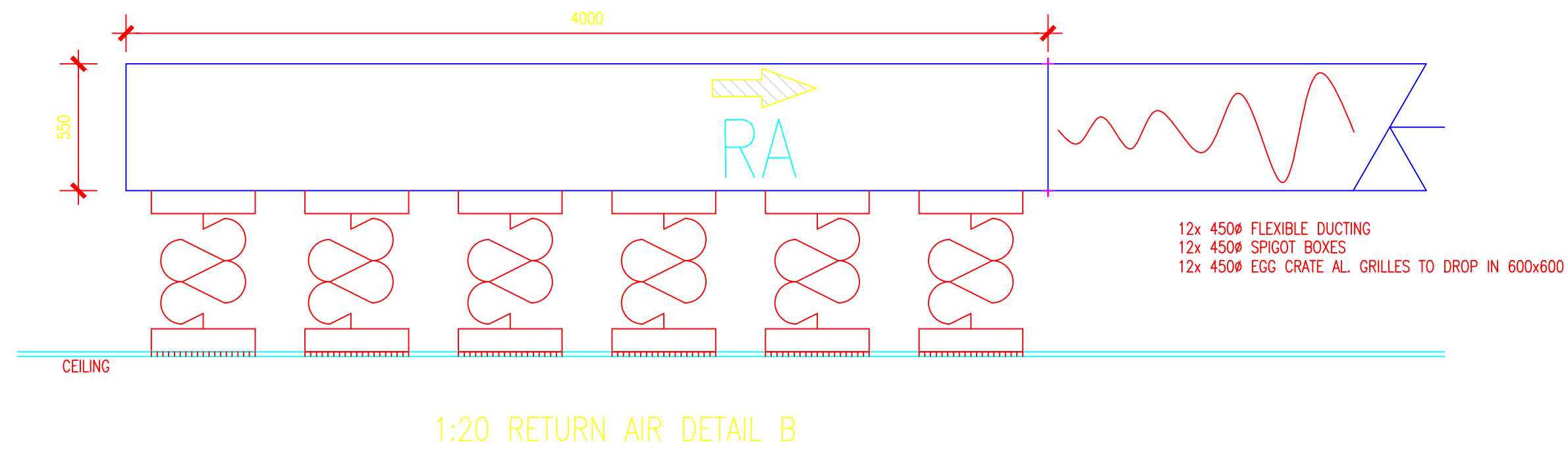
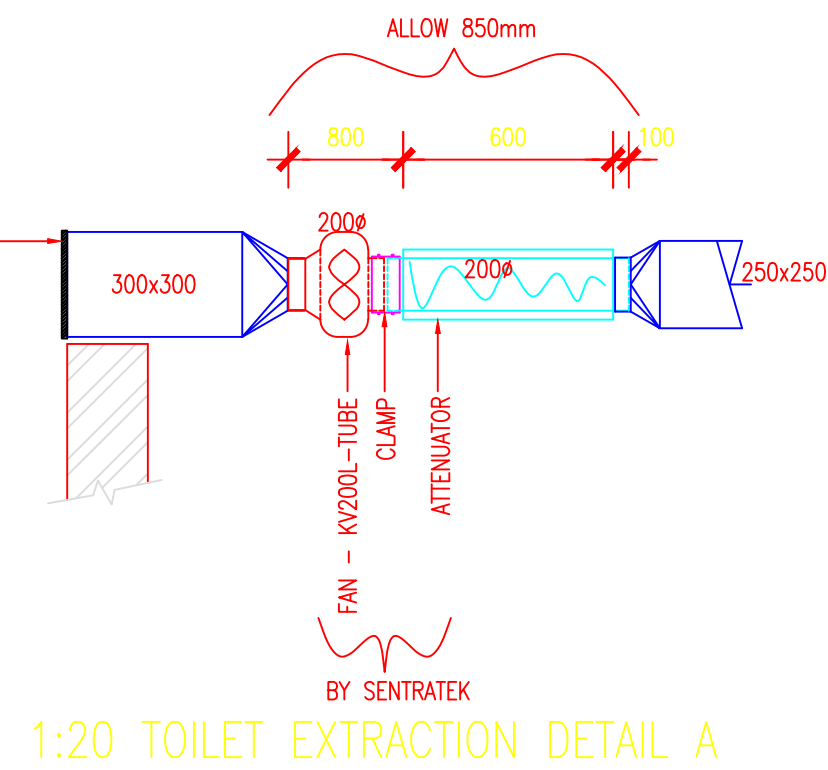

	INITIALS	SIGN	DATE	
DESIGNED				
DRAWN	TM		10.10.05	
PROJECT ENG.	GW			
APPROVED	AC			
1	REVISED TO SHIP ARCH'S LATEST DESIGN	TM	04.05.06	
0	ISSUED FOR CONSTRUCTION	TM	30.01.06	
REV	DESCRIPTION	DR	APP	DATE

LETSHABILE CONSULTANTS
(CAPE) (Pty) Ltd
Consulting Engineers and Project Managers
PO BOX 94 CAPE TOWN TEL : (021) 421 8940

K&T
KANTEY & TEMPLER
CONSULTING ENGINEERS
ENGINEERING AFRICAN DEVELOPMENT
PO BOX 3132 CAPE TOWN 8000 TEL : (021) 405 9600

CLIENT

ACSA
AEROPORTS COMPANY SOUTH AFRICA

REV	DESCRIPTION	BY	DATE
1	AS BUILT UPDATE	ES	03/09/07
2	PLANT ROOM UPDATED - DETAIL & ADDRESS	ES	12/07/06
3	PLANT ROOM UPDATED - DETAIL & ADDRESS	ES	08/06/06
4	PLANT ROOM UPDATED - DETAIL & ADDRESS	ES	08/06/06
5	PLANT ROOM UPDATED - DETAIL & ADDRESS	ES	08/06/06

APPROVED BY: MECHANICAL: MZ DATE: 03/09/07
ELECTRICAL: MZ DATE: 03/09/07
PROJECT LEADER: MZ DATE: 03/09/07
CONSULTANT: AC DATE: 03/09/07

PROJECT DESCRIPTION:
AS BUILT NEW ADDITIONS TO THE TERMINAL BUILDINGS
GEORGE AIRPORT - PHASE 3

SERVICE:
AIR CONDITIONING LAYOUT
FIRST FLOOR

DESIGN	DATE	DRAWN	DATE
PJS		PJS	08/06/06

FILE NO	DRAWING NO	Revision
564	564/AC02	4

SCALE: AS SHOWN