

DETAIL 2
1 : 10

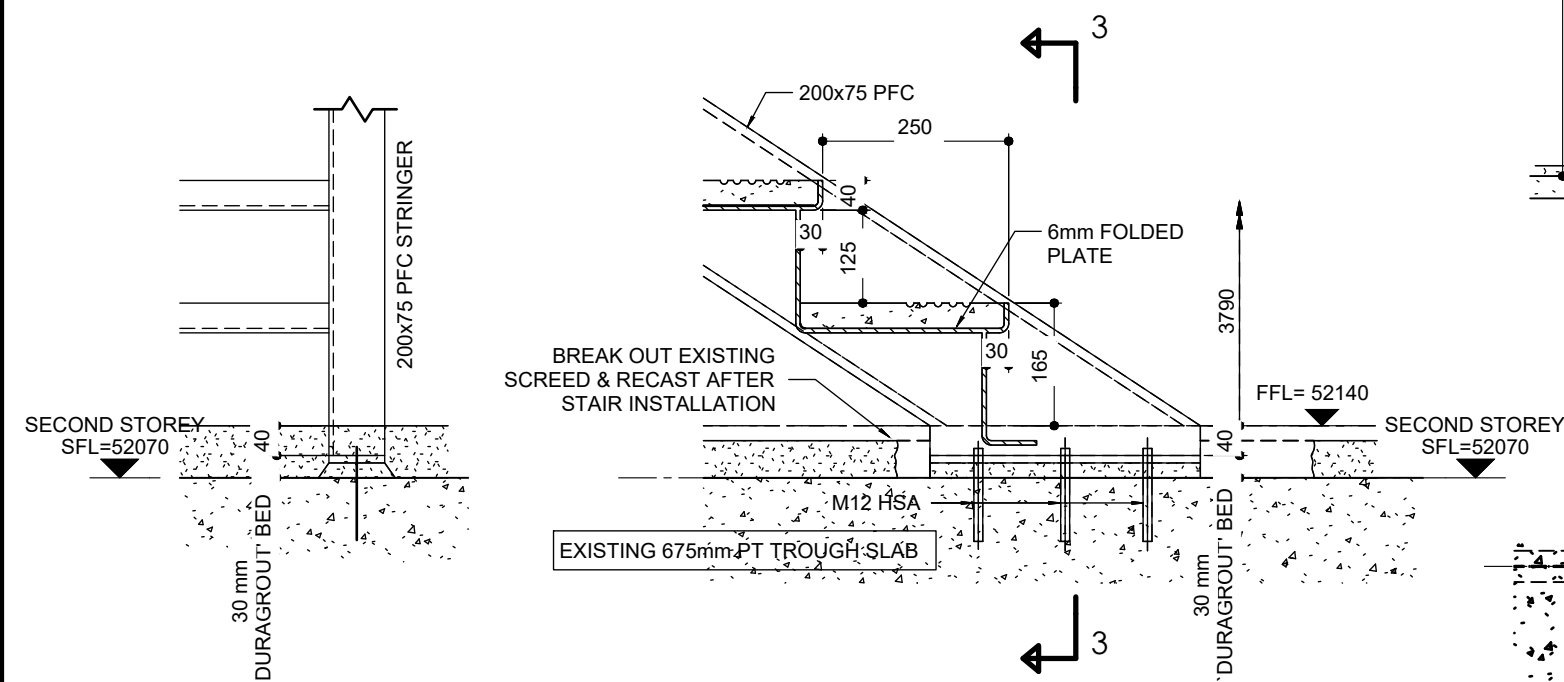

SECTION 3-3
1 : 10

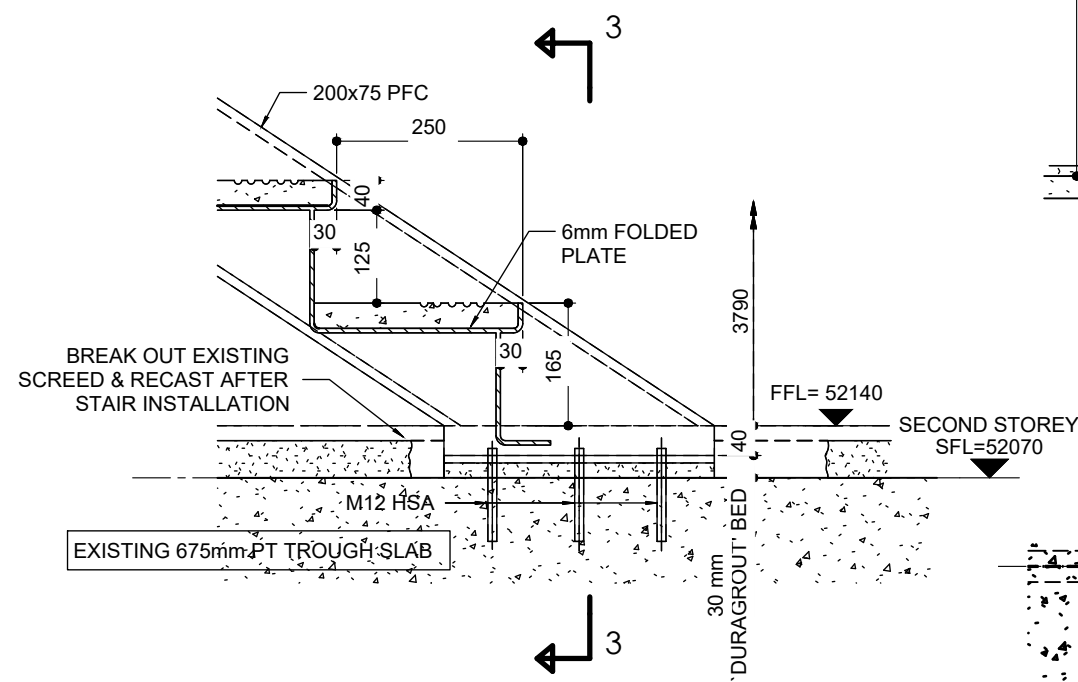

DETAIL 1
1 : 10

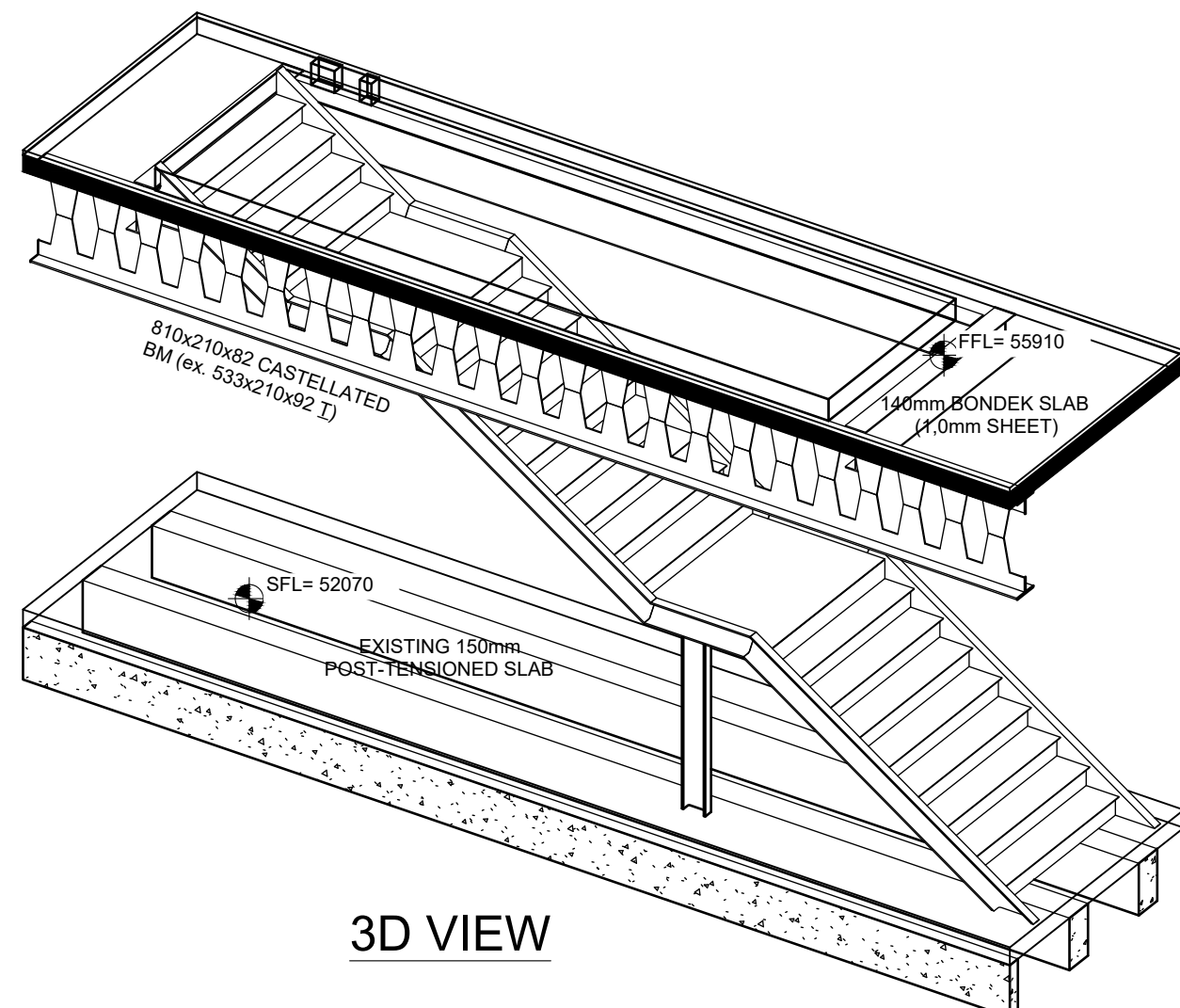

3D VIEW

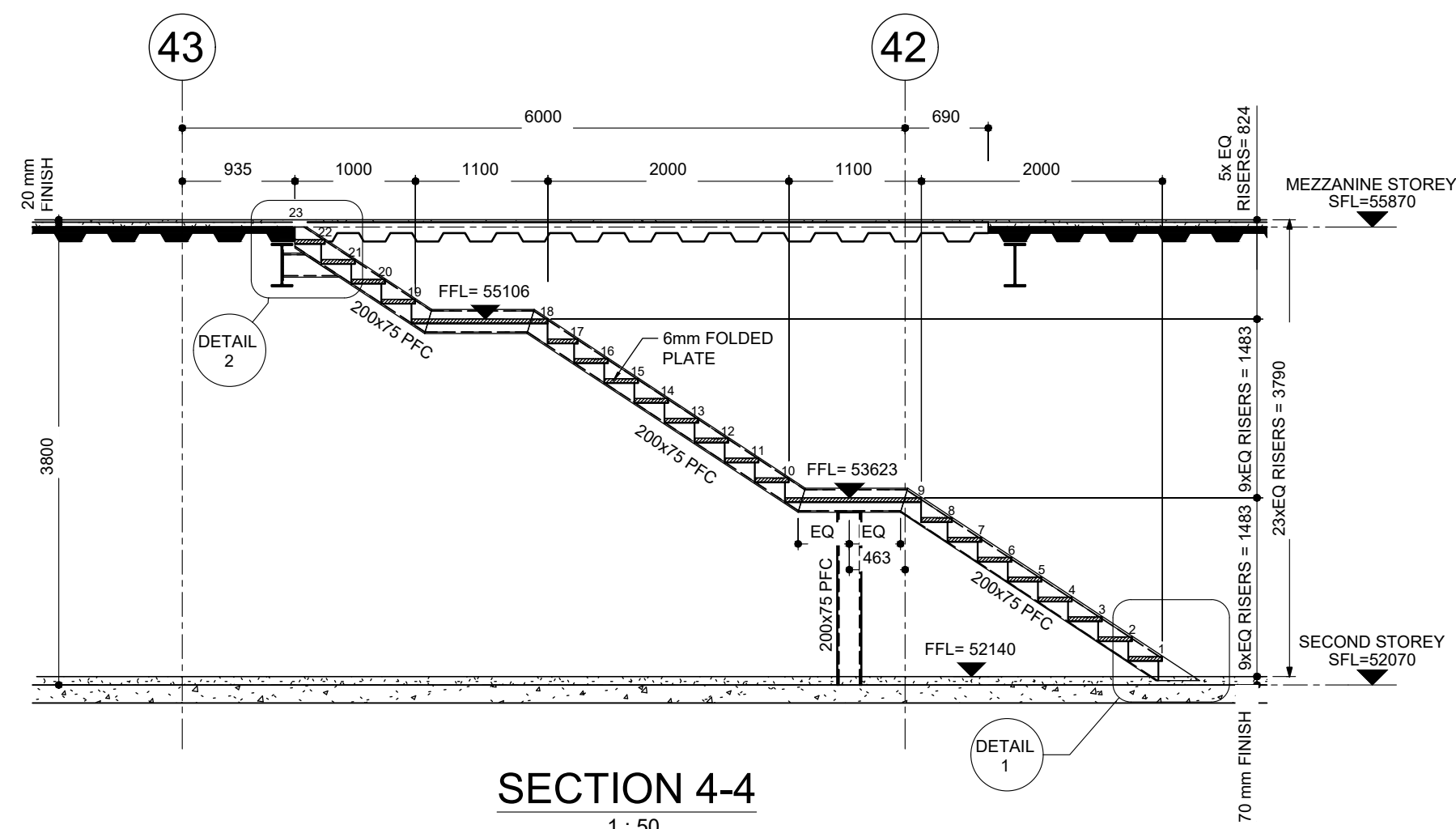

SECTION 4-4
1 : 50

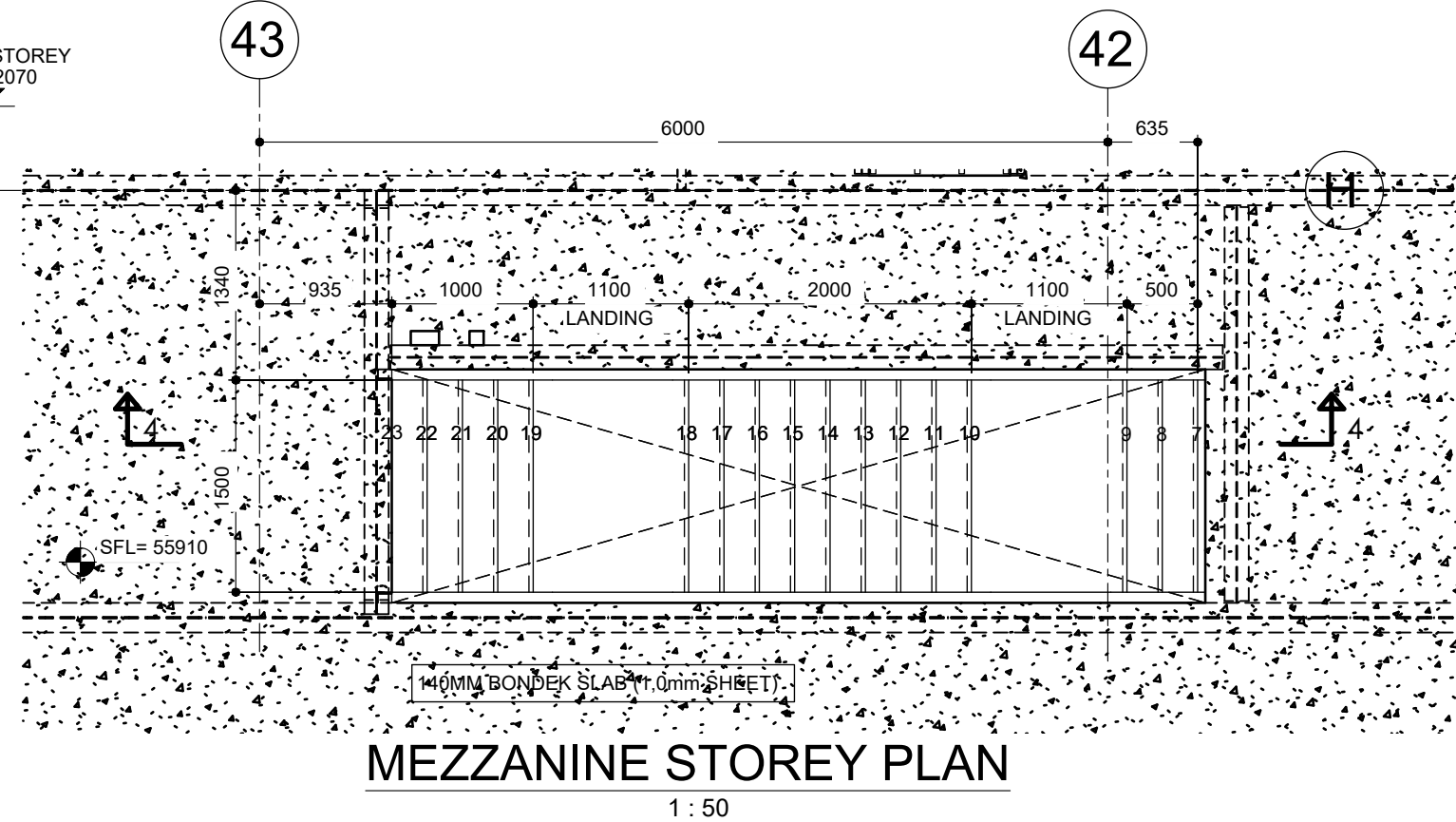

MEZZANINE STOREY PLAN
1 : 50

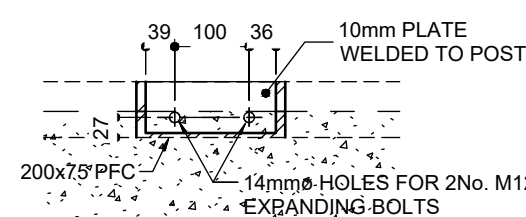

DETAIL 4
1 : 10

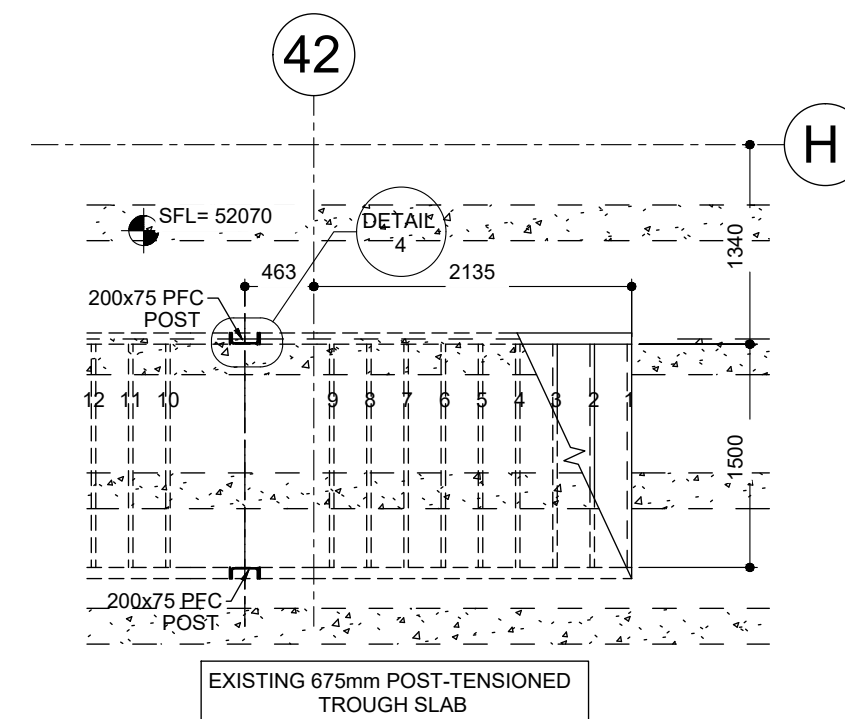

SECOND STOREY PLAN
1 : 50

NOTES

THIS DRAWING TO BE READ IN CONJUNCTION WITH ALL RELEVANT ARCHITECTS' & CONSULTANTS DRAWINGS & SPECIFICATIONS

FOR GENERAL NOTES REFER DRAWING A.509-28/01

AS BUILT

THIS AS BUILT DRAWING REFLECTS THE INFORMATION ON THE FINAL DESIGN DRAWING AND CHANGES / ADDITIONS ISSUED BY SITE INSTRUCTION. THIS DRAWING DOES NOT INCORPORATE ANY ON SITE 'AS BUILT' MEASUREMENTS

AMENDMENTS

NO.	DATE	BY	REASON	DESIGNED	DRAWN	CHECKED
Z	JAN 2019	JKW	AS BUILT	BS	JKW	RGD
B	24/05/18	JKW	GENERAL REVISION, LEVELS & FINISHES AMENDED			
A	16/02/18	JKW	FOR CONSTRUCTION			



CAPE TOWN
INTERNATIONAL AIRPORT
AIRPORTS COMPANY SOUTH AFRICA

**INTERNATIONAL DEPARTURES TERMINAL:
CENTRAL BUSINESS LOUNGE**

**STAIR 2 PLANS,
SECTIONS & DETAILS**

KFD WILKINSON
CONSULTING ENGINEERS

12TH FLOOR PICBEL PARKADE STRAND STREET CAPE TOWN 8001
P.O. BOX 3276 CAPE TOWN 8000
TEL (021) 425-1610 • FAX (021) 425-1644 • E-MAIL admin@kfdw.co.za

SCALE	DWG. NO.	REV
AS SHOWN	A.509-28/09	Z