

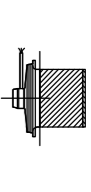

NOTE: ALL HVAC UNITS TO SWITCH OFF IN THE EVENT OF FIRE. SINGLE PHASE FANS TO BE INTERCONNECTED TO LIGHTING WHICH SHALL BE CONTROLLED BY MOTION SENSOR. FANS SHALL HAVE STOP/START BUTTON. ALLOW OVERLOAD PROTECTION ON ALL FANS

LEGEND:		
	WMEF	WALL MOUNTED EXTRACT FAN
	DG	DOOR GRILLE
	WL	WEATHER LOUVRE

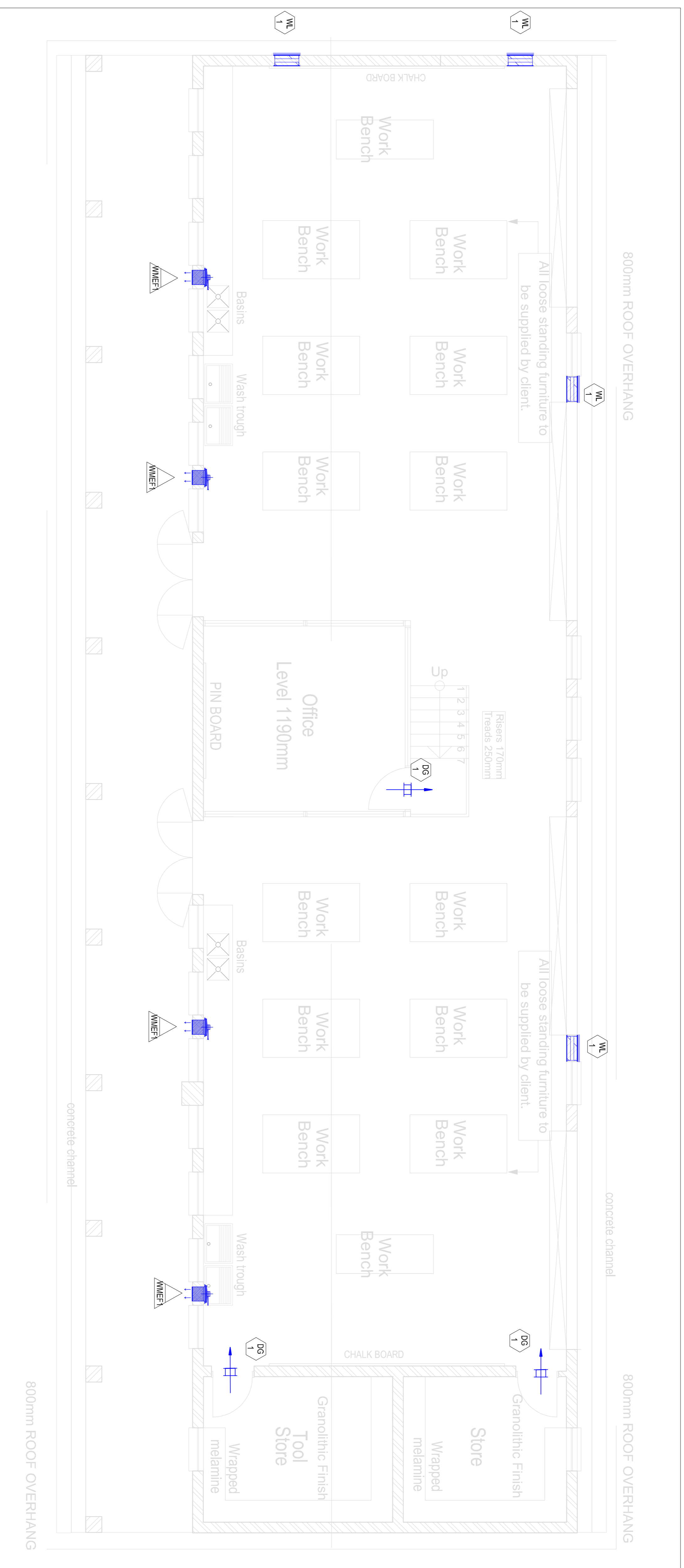

FLOOR PLAN: METAL WORK
SCALE 1:50

Air Terminal Schedule			
Mark	Description	Flow(L/S)	Count
DG 1	Door Grille c/w Vermin Proof Mesh	207.0	3
WL 1	Weather Louvre Vermin Proof Mesh	450.0	4

Mechanical Equipment Schedule							
Mark	Description	Cooling Capacity (Kw)	Heating Capacity (Kw)	Fan Speed (RPM)	Sound (dBA)@3m	Flow (L/s)	Pressure (Pa)
WMEF 1	Wall Mounted Extract Fan			1400	47	380.0	50.0 Pa

REV	DATE	DESCRIPTION	ISSUED BY	APPR. BY	SIGNATURE
A	15-08-19	ISSUED FOR TENDER ONLY	JM	KH	
B	20-08-19	UPDATED LAYOUTS ISSUED FOR TENDER ONLY	JM	KH	
C	17-09-20	UPDATED MECHANICAL LAYOUT	RR	RR	
D	01-07-21	ISSUED FOR TENDER	RR	RR	

NOTES:

- THIS DRAWING MUST ONLY BE USED FOR THIS MECHANICAL PROJECT. FOR ANY OTHER DETAIL AND BUILDING LAYOUT SEE ARCHITECT'S DRAWING.
- ALL DIMENSIONS MUST BE TAKEN ON SITE.
- THE EXACT POSITION OF EQUIPMENT WILL BE INDICATED ON SITE BY THE MECHANICAL ENGINEER
- DOORS UNDERCUT TO HAVE 25MM UNDERCUT.
- ALLOW 50MM WOODEN SLEEVES ALL ROUND, UNLESS SPECIFIED OTHERWISE.
- ALL FANS SHALL BE INTERCONNECTED WITH FIRE DETECTION SYSTEM AND SHALL SHUT-OFF IN THE EVENT OF FIRE.
- CONTRACTOR TO REPORT UNFORSEEN CLASHES TO THE MECHANICAL ENGINEER.
- THIS DRAWING IS MERELY A GUIDE AND NO DIMENSIONS SHOULD BE TAKEN DIRECTLY FROM IT. ALL DIMENSIONS TO BE VERIFIED ON SITE.
- ALL WORK TO BE DONE IN ACCORDANCE WITH NATIONAL BUILDING REGULATIONS AND BUILDING STANDARDS ACT (ACT 107 OF 1977)
- DUCTING INSTALLATION IN ACCORDANCE TO SANS 1238
- ALL WEATHER LOUVRE OPENINGS COMPLETE WITH 50MM ALL ROUND TIMBER SLEEVE.
- ALL DOOR GRILLES TO BE 305MM ABOVE FFL.
- UNDERSIDE OF ALL TRANSFER GRILLES TO BE 2195MM ABOVE FFL, INCLUDING SLEEVE, UNLESS SPECIFIED OTHERWISE
- HARD-WIRED CONTROLS TO ALL AC UNITS.
- DEDICATED SWITCH FOR EXTRACT FANS AS SPECIFIED BY ELECTRICAL ENGINEER.
- NO GRATING, ANGLE SECTIONS, ETC MAY BE CUT, DRILLED OR WELDED AFTER GALVANIZING
- THE GULLEYS ARE TO BE LINED WITH A SMOOTH EPOXY SUITABLE FOR SERVICE BETWEEN 0° & 90° AND RESISTANT TO IMPACT AND DETERGENTS
- FANS TO BE SWITCHED ON FROM WALL MOUNTED SWITCHES NEXT TO THE LIGHT SWITCHES COORDINATED BY ARCHITECTS AND ELECTRICAL ENGINEER.



CLIENT:



CONSULTANT:



Gauteng Office (Head Office)
GladAfrica House Herford Office Park
90 Bekker Road, Vorna Valley, Midrand, 1686
P. O. Box 6723 Halfway House 1685
Tel: +27 11 312 2537/2584
Fax: +27 11 605 1990
www.gladfrica.com

NAME	REG. NO.	SIGNATURE	DATE
DRAWN	C.T.P.K		20140432
DESIGNED	R.R		20140432
APPROVED	R.R		

PROJECT DESCRIPTION
TROMPSBURG SPECIAL SCHOOL : SCHOOL SECTION

DRAWING TITLE
METAL WORK & WELDING HVAC LAYOUT

STATUS LEGEND	SHEET SIZE
I = INFORMATION	A1
CV = CONCEPT AND VIABILITY	
D = DESIGN DEVELOPMENT	
T = TENDER	SCALE
C = CONSTRUCTION	AS SPECIFIED
AB = AS BUILT	
DISCIPLINE	DRAWING NUMBER
MECHANICAL	92-ME-AC-009
	STATUS
	T
	REVISION
	D

FOR TENDER