



**SUPPLY, DELIVERY AND REPAIR  
BUILDINGS (CANTEEN & GUARD HOUSE)  
DAMAGED BY FLOODS AT THE ROTATING  
MACHINES DEPOT.**

**ROTATING MACHINES DEPOT, 150 EEL ROAD,  
UMBILO INDUSTRIAL, UMBILO.**

**REFERENCE No: FAI\_DBN\_SOW\_010**

**DATE OF RELEASE: APRIL 2024**

The information contained herein is the sole property of Transnet Engineering. It may not be used, disclosed or reproduced in part or in whole in any manner, except with the written permission of and in a manner permitted by the proprietors.

## Table of Contents





---

1. INTRODUCTION/ SCOPE OF WORK	4
2. SITE INSPECTION	4
3. INFORMATION REQUIRED	4
4. TECHNICAL REQUIREMENTS	4
5. SPECIFICATION REQUIREMENTS	5
6. CONSTRUCTION INDUSTRY DEVELOPMENT BOARD (CIDB) REGISTRATION	9
7. HEALTH AND SAFETY REQUIREMENTS	10
8. SPECIALIST SUB-CONTRACTORS	10
9. MATERIAL AND WORKMANSHIP	10
10. GENERAL REQUIREMENTS	10
11. DEFINITIONS AND ABBREVIATIONS	12
12. GENERAL	12
13. SITE ESTABLISHMENT	12
14. PENALTY CLAUSES	12

Signature of Bidder/s: \_\_\_\_\_

Date: \_\_\_\_\_

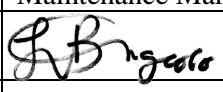
## DOCUMENT AUTHORITIES

Department Affected	Rotating Machine Business
Effective Date	April 2024
Compiled by	Zolani Mngqithi
Designation	Engineering Technician
Signature & Date	 10.04.2024
Reviewed by	Soojith Ramnund
Designation	Engineering Manager (Rotating Machines)
Signature & Date	PP.  11.04.2024
Reviewed by	Lindo Ngcobo
Designation	Maintenance Manager
Signature & Date	 11/04/2024
Approved by	Mhlonipheni Nxumalo
Designation	Executive Manager
Signature & Date	 11/04/2024

Signature of Bidder/s: \_\_\_\_\_

Date: \_\_\_\_\_

## 1. INTRODUCTION / SCOPE of Work

#	TASK	REQUIRED
1	Design	
2	Supply	✓
3	Repair	✓
4	Replacement	✓
5	Installation	✓
6	Documentation	✓
7	Testing	✓
8	COC	✓
9	Commissioning	

#	ITEM	REQUIRED
1	Supply, delivery and repair buildings (Canteen & Guard house) damaged by floods at the Rotating Machines Depot.	✓
2	Submission of project completion documents.	✓

## 2. SITE INSPECTION

- 2.1 All prospective contractors shall be required to undertake a compulsory site inspection to fully acquaint themselves with all aspects involved.
- 2.2 Arrangements to visit the site and confirmation of the date and time of the site inspection shall be made with Transnet Engineering Contract Manager.
- 2.3 The site inspection certificate shall be completed and countersigned by the Contract Manager on the day of the visit and must be submitted with the tender documents.

## 3. INFORMATION REQUIRED

- 3.1 Offers will not be considered unless full particulars and sufficient literature are provided at the tendering stage to enable Transnet Engineering Technical Officers the opportunity to assess each technical offer properly.
- 3.2 Prospective Contractors will complete the relevant questionnaire in full and must indicate whether their offer complies with each item of the specification
- 3.3 Should there be insufficient space for furnishing full details; contractors shall provide the additional details in their covering letter. The additional details shall be numbered in accordance with the applicable clause specified in the specification.
- 3.4 As prospective contractors are considered to be experts in their field, they are obliged to identify any shortcomings, such as omissions or sub-standard requirements, to the completeness of this specification. These must be brought to the attention of Transnet Engineering at tender stage with alternatives to address these shortcomings. However, each offer shall be quoted for separately.

## 4. TECHNICAL REQUIREMENTS

The following legislation (including all relevant legislations and codes) must be complied with:-

- The Occupational Health and Safety Act – Act 85 of 1993.

Signature of Bidder/s: \_\_\_\_\_

Date: \_\_\_\_\_

- 4.1 Except where otherwise provided for in the specification, all equipment offered will comply with the requirements of the relevant standard specifications of the SABS, if published, otherwise with the relevant standard of the British Standards Institution in force at the time of tendering.
- 4.2 Where equipment offered complies with the recognized standards of the country of manufacture and not specifically with the standards required by this specification, such equipment will be considered at the discretion of Management. In this case, tenders shall state fully all respects in which the equipment departs from the standard laid down in this specification.
- 4.3 The successful tender will at the conclusion of the installation provide a document along the lines “that the installation complies with national/international requirements and that all selected /designed items are compliant with Act 85 of 1995 and SABS practices applicable to the installation. The equipment has been commissioned/ calibrated and employees as specified have been trained and found competent to operate the plant.”

## 5. SPECIFIC REQUIREMENTS

**Any person with the intention of tendering for this job shall ensure that the information below is complied with.**

### 5.1 Scope of work

ITEM	<b>This scope of work document covers the minimum requirements.</b> <b>Figure 1. shows the canteen building inside.</b>
5.1	This scope of work shall be read with Annexure 1 (Transnet Engineering Safety, Health and Environmental Management specification) and contractor management SOP 014. • Bidders shall include costs of Health, Safety and Environmental Management compliance.
5.2	<b>Room 1.</b>
5.2.1	Clean the toilet.
5.2.2	Unblock water pipes, flush all the dirt, ensure that the toilet is fully functional.
5.2.3	Replace window frame and glasses (approximately 59.5cm x 48cm bronze Aluminium). Replace like with the like.
5.2.4	Replace standard size door frame and door (0.9m x 2.1m), bronze Aluminium.
5.2.5	Remove damaged wall tiles and fit new tiles (1m <sup>2</sup> ).
5.3	<b>Room 2.</b>
5.3.1	1 piece of the double door shall be supplied and installed.
5.3.2	Supply and fit the door glass (0.675m x 1.92m).
5.3.3	Install 2 off single electrical plugs.
5.3.4	Install 1 x switch.
5.3.5	Fit tiles at the entrance, dimensions are 1.22m x 1.6m and 1.13 x 3.05. Use first grade decorative tiles to enhance good looks for the area.
5.4	<b>Room 3.</b>
5.4.1	Door 3A is missing. Install new door (0.815m x 2.025m Bronze Aluminium).
5.4.2	Remove the existing, fit new skirting board.

Signature of Bidder/s: \_\_\_\_\_

Date: \_\_\_\_\_

ITEM	<b>This scope of work document covers the minimum requirements</b>
5.4.3	Paint the wall. Dimensions are 4.1m (l) x 3m (w) x 3m (h) .
<b>5.5</b>	<b><u>Room 4.</u></b>
5.5.1	Replace door 4A with Aluminium door (0.815m x 202.5m).
5.5.2	<ul style="list-style-type: none"> <li>• Use M150 concrete blocks to brick up the kitchen counter (5.1m long x 0.9m high). See figure 3.</li> <li>• Plaster, prime and paint with 2 coats.</li> <li>• Build the counter base support after every 1m length of the wall.</li> </ul>
5.5.3	Install a granite top, bullnose edges on both ends, 5.1m (l) x 1m (w) x 0.03m (thickness).
5.5.4	<u>Window 4A.</u> Install new window frame and glass (0.495m x 0.29m bronze Aluminium).
5.5.5	Repair and oil window mechanism.
5.5.6	Remove the cracked window glass, fit new window glass.
5.5.7	<u>Window 4B</u> Install new window frame and glass (0.425m x 0.49m).
5.5.8	Install 2 off double electrical plugs. Use Crabtree plugs or equivalent.
5.5.9	Install 2 off single electrical plugs. Use Crabtree plugs or equivalent.
5.5.10	Install 2 off single electrical switches. Use Crabtree switches or equivalent.
5.5.11	<u>Window 4C</u> Repair window mechanism.
5.5.12	Skim, prime and paint wall with 2 coats of Plascon WAA8. Dimensions are 12m (l) x 9m (w) x 3m (h).
<b>5.6</b>	<b><u>Room 5</u></b>
5.6.1	Replace 95 broken floor tiles. Used first grade 300mm x 300mm tiles similar to existing tiles.
5.6.2	Replace 10 off 1.7m x 1.55m window frames and glasses (bronze Aluminium frame). Windows in question are 5A, 5B, 5C, 5D, 5E, 5F, 5G, 5H, 5I, 5J and 5K.
5.6.3	Door 5A is a double door, 1 piece is broken (0.63m wide x 2.055m high). Fix the broken part and re-install it. Piece is on site, it does not need to be supplied.
5.6.4	Door 5B is a double door, 1 piece is broken (0.63m wide x 2.066m high bronze Aluminium frame). Fix the broken part and re-install it. Piece is on site, it does not need to be supplied.
5.6.5	Door 5C is a double door, 2 pieces are broken (1.61m wide x 2.066m high bronze Aluminium frame). Supply and fit 2 pieces.
5.6.6	Install 1 off single electrical plug.

Signature of Bidder/s: \_\_\_\_\_

Date: \_\_\_\_\_

ITEM	<ul style="list-style-type: none"> <li><b>This scope of work document covers the minimum requirements</b></li> </ul>
5.6.7	<ul style="list-style-type: none"> <li>Scrape, skim, prime and paint wall with 2 coats of Plascon WAA8. The dimensions are 27m (l) x 9m (w) x 3m (h).</li> <li>Scrape, skim, prime and paint wall with 2 coats of Plascon WAA8. The dimensions are 8 off 0.265m (l) x 0.265m (w) x 2.57m (h).</li> <li>Scrape, skim, prime and paint wall columns with 2 coats of Plascon WAA8. The dimensions are 8 off 0.265m (l) x 0.265m (w) x 2.57m (h).</li> </ul> <p>Scrape, skim, prime and paint ceiling with 2 coats of Duram 110-10-020. The dimensions are 2 off 0.265m x 0.54m (w) x 27m (l).</p>
<b>5.7</b>	<b><u>Veranda</u></b>
5.7.1	<p>Replace 3 steel poles with 110mm (diameter, 3mm thick) poles. See figure 3 for suitable kind of poles.</p> <p>Poles shall be hot dip galvanized, in accordance with SANS 121.</p> <p>Paint all poles in black paint Duram 52-90-001.</p>
5.7.2	Replace 120 cracked and broken floor tiles.
5.7.3	<p>Replace 12 damaged ceiling rhino boards and secure.</p> <p>Use rhinolite to skim and level.</p> <p>Paint the ceiling (9m x 2.5m) with 2 coats of white paint (use Duram 110-10-020 Wall &amp; Ceiling Paint).</p>
5.7.4	Replace 50m of gutters. Use PVC.
5.7.5	Repair and seal the leaking portions of the roof.
<b>5.8</b>	<b><u>Guard house</u></b>
5.8.1	Remove existing cupboards, fit new ones.
5.8.2	Fit cabinets as shown on figure 2.
5.8.3	<p>Cabinets shall be 3m (l) x 0.6m (w) x 0.5m (h).</p> <ul style="list-style-type: none"> <li>3m x 0.6m granite top (bull nose). Add 20mm on 3 sides for overhang.</li> <li>8 studs shall be fitted to support the cabinets (each to be approximately 20mm high) at the bottom.</li> <li>6 door handles for cupboards doors and 2 drawer handles.</li> <li>12 Hinges to enable closing and opening of cupboard doors.</li> <li>Quality ply wood to be used as supports and plywood shelves, doors and side boards to be made with melamine.</li> <li>Paint the wall, 3m x 4m x 3.0m (high).</li> </ul>
5.8.4	Paint the ceiling with 2 coats of white ceiling paint. Paint code is 110-10-020 Duram.
5.8.5	Repair the roof and put into their positions the displaced tiles and strengthen.
5.8.6	Remove existing windows and fit new bronze Aluminium frames and glasses. 2 off 1.2m x 1.2m.
5.8.7	Supply and install window panes 2 off 1.2m (l).

Signature of Bidder/s: \_\_\_\_\_

Date: \_\_\_\_\_

ITEM	<ul style="list-style-type: none"> <li>• <b>This scope of work document covers the minimum requirements</b></li> </ul>
5.8.8	<ul style="list-style-type: none"> <li>• Repair the stoep, the dimensions are 0.40m (w) x 4m (l) x 0.3m (h).</li> <li>• Fit Terazzo light grey slip resistant tiles, as finishes.</li> </ul>  <ul style="list-style-type: none"> <li>• Water proof the stoep.</li> </ul>
5.8.9	Replace 10 broken red clay bricks.

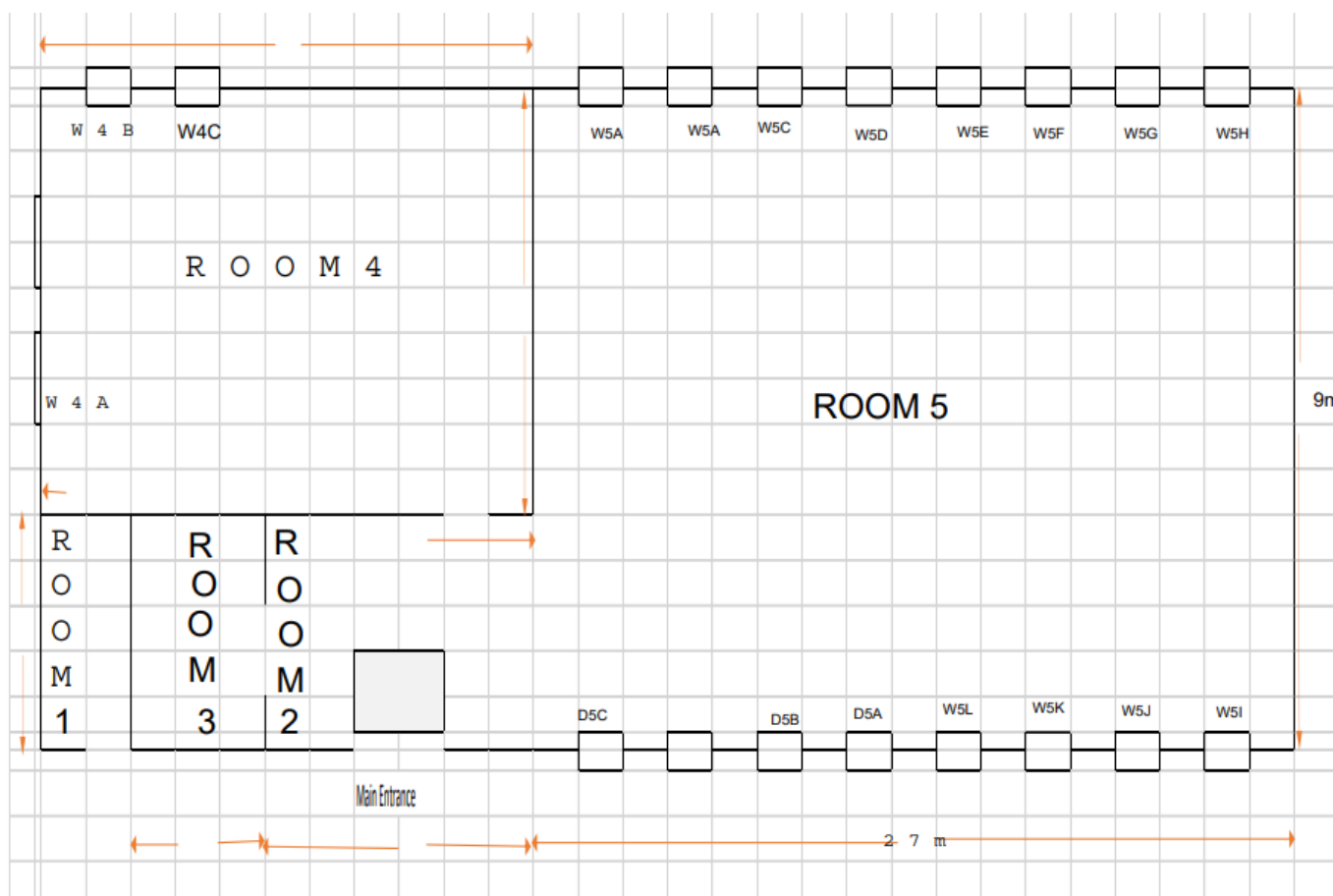

**Fig. 1**

Signature of Bidder/s: \_\_\_\_\_

Date: \_\_\_\_\_



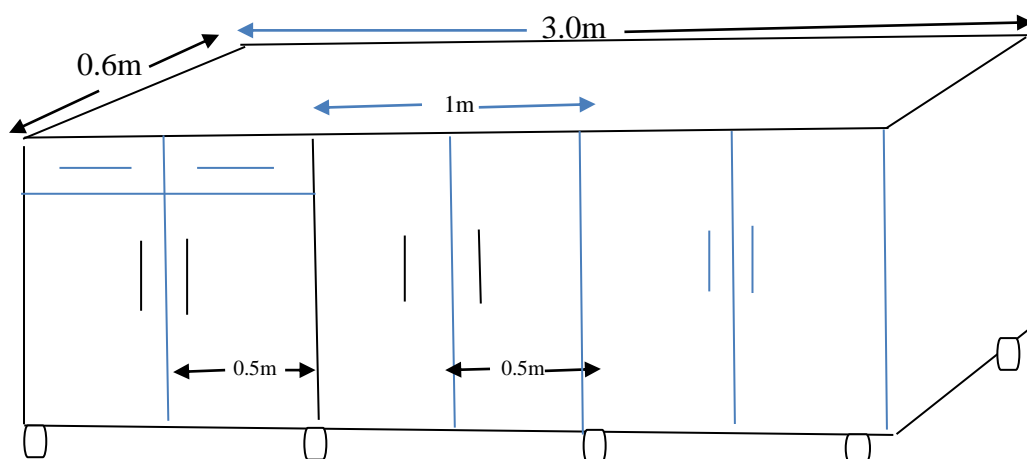

Figure 2.

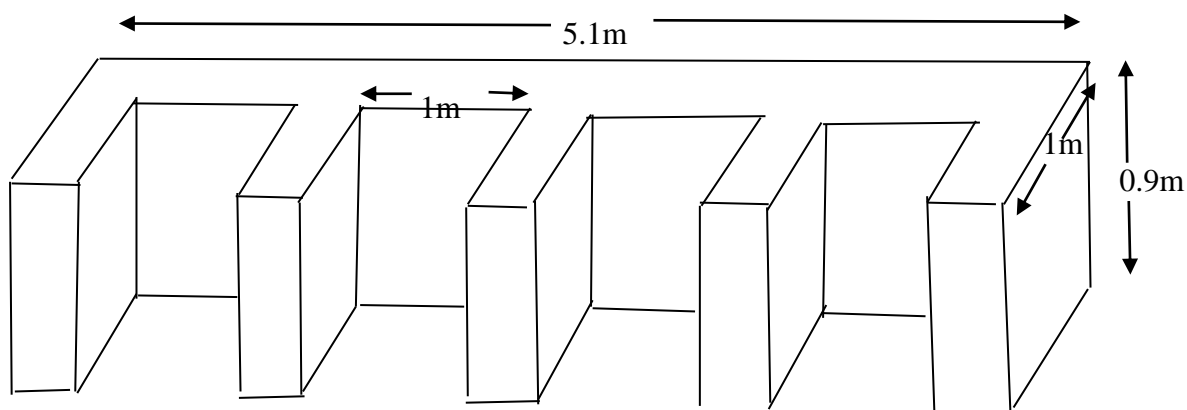

Figure 3.



Fig. 4

Signature of Bidder/s: \_\_\_\_\_

Date: \_\_\_\_\_

#### 5.9 Site

- The work shall be done at Rotating Machines Depot, 150 Eel Road, Umbilo Industrial, Umbilo.

#### 5.10 Warranty

- The contractor shall undertake to repair all faults due to bad workmanship and/or faulty materials during a period of 24 calendar months, calculated from the date that the completed plant installation is accepted by Transnet Engineering.
- Any latent defects that become apparent during the guarantee period shall be rectified to the satisfaction of Transnet Engineering at the cost of the supplier.
- The contractor shall undertake work on the rectification of any defects that may arise during the guarantee period within 7 days of being notified of such defects.
- **The warranty shall be 2 years.**

#### 5.11 After-Sales Service

- The successful tenderer shall provide Transnet Engineering with acceptable proof that spares/parts can be easily and speedily procured for the equipment within 7 working days through agents locally.

**Note:** All work to be completed in each respect by suitably qualified person.

### 6. CONSTRUCTION INDUSTRY DEVELOPMENT BOARD (CIDB) REGISTRATION

The contractor to be appointed under this contract must be registered with the CIDB with a minimum grading of **2GB**. To this end, Transnet Engineering Durban does not award contracts to any company without proof of this registration.

### 7. HEALTH AND SAFETY REQUIREMENTS

- 7.1 All repair work whether detailed in this scope of work or not shall comply with the requirements of the Occupational Health and Safety Act 85 of 1993 as amended and all other applicable legislation including specific set of regulations and local authority bylaws where applicable.
- 7.2 All the necessary safety equipment such as guards over rotating equipment shall be supplied and the equipment shall comply fully with all the requirements of the South African Occupational Health and Safety Act, Act 85 of 1993 and all other applicable legislation including specific set of regulations and local authority bylaws where applicable. At all times during the manufacture, assembly and testing of the equipment the contractor will be responsible for the safety of all persons on site and the equipment.

#### 7.3 SHE SPECIFICATION

Prior to commencement of contract, the contractor shall be issued with a SHE specification in order to compile a SHE file in line with TE requirements. Prior to establishing on site, it is an explicit requirement of this contract that all of the Contractor's personnel directly involved with this contract, including those of sub-contractors, attend a **Safety induction course**.

Transnet will provide the course free of charge and attendance is compulsory for all personnel under the control of the Contractor who, during the duration of the contract, will be present on site whether on a full time or adhoc basis.

The contractor must allow for all additional charges because of these requirements as no claims for extras will be accepted in connection with the foregoing.

Signature of Bidder/s: \_\_\_\_\_

Date: \_\_\_\_\_

#### 7.4 As part of the legislative and TE SHE requirements.

The successful contractor is required to conduct a Risk assessment to ascertain all potential risks associated with this project.

The completed risk assessment is to be formally submitted to the Risk department via the project manager at least two weeks prior to the commencement of the actual project. A safety file and associated documents will be required from a successful tenderer and such will be communicated by the Risk department.

### 8. SPECIALIST SUB-CONTRACTORS

- 8.1 Only specialist sub-contractors who have previously successfully completed work of the type and extent specified in this document should be engaged.

The tenderer shall provide the technical officer with sufficient proof of having suitable experience regarding the design and manufacturing of similar equipment. To this end, complete and detailed reference list shall be submitted with the tender. Reference list shall include addresses as well as contact person who may be visited for inspection of the equipment during the adjudication period.

- 8.2 The tender shall submit a complete list of proposed sub-contractors and suppliers of major components with his tender.
- 8.3 The tenderer shall be prepared to commit themselves in writing to the technical officer with an adequate, experienced and stable project team for the duration of the contract.
- 8.4 Transnet Engineering will not consider any Tenderer's offer that, in the sole opinion of Transnet Engineering, does not have adequate experience in the design and manufacture of such equipment.
- 8.5 Contractors shall do the installation simultaneously with other contractors on-site busy with other work and shall plan work that it integrates with other work performed.

### 9. MATERIAL AND WORKMANSHIP

- 9.1 The materials shall be offered complete in all respects.
- 9.2 The materials, as made and supplied, shall be complete in every respect, of modern design, using the most advanced proven technology extensively supported by reputable local companies, and be built to good engineering practices. Tenderers shall supply a list of all the main components proposed as well as the addresses of the local support companies.
- 9.3 All materials shall be adequately protected against damage and corrosion during shipping, transport and storage.

### 10. GENERAL REQUIREMENTS

Operation will be in the following conditions:

Altitude	Sea level
Ambient temperature	0°C to 45°C
Relative humidity	50% to 100%
Atmosphere	Heavy saline

- 10.1 Tenderers shall indicate clause-by-clause either that they comply in every respect with the specific requirements, or if not, exactly how it differs.

Signature of Bidder/s: \_\_\_\_\_

Date: \_\_\_\_\_

## 11. DEFINITIONS AND ABBREVIATIONS

CLIENT	Transnet Engineering Durban
TECHNICAL OFFICER	Project Manager, Transnet Engineering Durban
CONTRACTOR	Contractor appointed under this scope of work document
SABS	South African Bureau of Standards
SANS	South African National Standards

## 12. GENERAL

- 12.1 The successful tenderer will be subjected to a workshop inspection by Transnet Engineering, to ensure that the facilities are to the satisfaction of the Transnet Engineering in terms of the quality control and equipment capabilities for manufacturing such type of equipment.
- 12.2 The tenderers shall guarantee that the rating and size etc. of the equipment offered, will be adequate to perform the duties required.

## 13. SITE ESTABLISHMENT

- 13.1 The contractor shall be solely responsible for safety of his staff and for providing security to safeguard his works and material on site, until such a time.
- 13.2 The contractor shall be required to attend site meetings when convened by the Project Leader controlling the contract.
- 13.3 The contractor will be responsible for any damages caused by his staff to the building and civil works on site.

## 14. PENALTY CLAUSES

- 14.1 Due to the criticality of this project, penalties will be levied for late deliveries.

Signature of Bidder/s: \_\_\_\_\_

Date: \_\_\_\_\_