

133 - Ground Storey Plan -  
Flooring Layout Copy 1

1 : 100

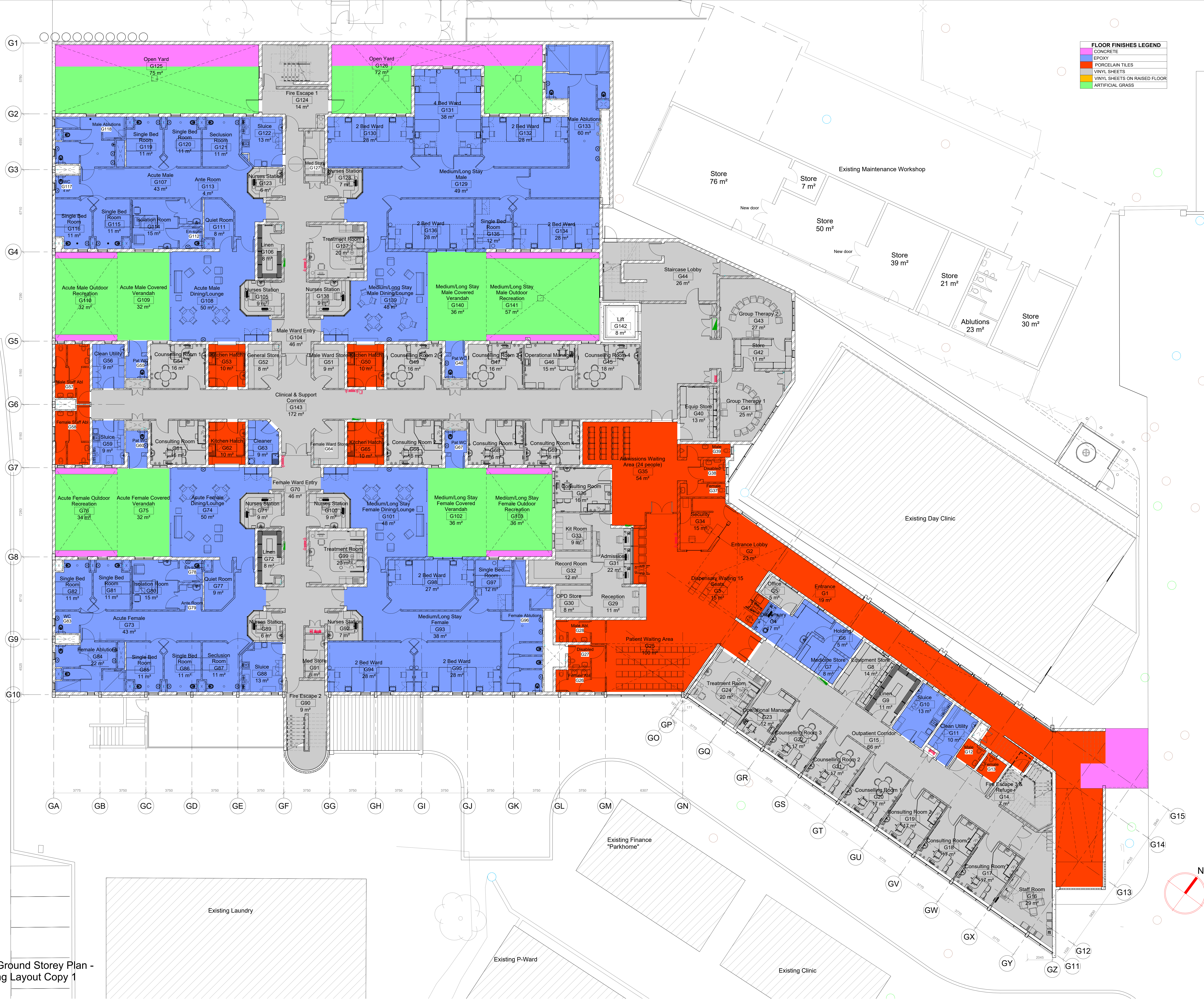

FLOOR FINISHES LEGEND		
	CONCRETE	
	EPOXY	
	PORCELAIN TILES	
	VINYL SHEETS	
	VINYL SHEETS ON RAISED FLOOR	
	ARTIFICIAL GRASS	

REVISIONS			Date	By
A1	Minor changes as per NDOH		06.09.2021	SG
A2	Minor changes as per NDOH		20.09.2021	SG
A3	Fire escapes passages to Outdoor Recreation omitted. Fire escape passage from Dining/Lounge widened. Stores in Clinical Area omitted. Serving Hatches & Ward Stores size increased.		27.09.2021	SG
A4	Issued to NDOH.			
A4	300 x 300mm Electrical duct added in Medicine room.		30.09.2021	WP
A5	Minor changes as per NDOH		15.10.2021	SG
A6	Minor changes as per NDOH		05.11.2021	SG
A7	Entrance added to Lobby/Refuge. Assembly area added.		12.11.2021	WP
A8	Nurses Station & Security reconfigured. Treatment room & Linen Store relocated. Cleaners room & Staff WC added in Nurses Station. Refuge & Fire exit reconfigured.		09.12.2021	WP
A9	Medicine Room converted to Satellite Pharmacy. Lift Lobby & staircase reconfigured. Linen Store in Nurses Station changed to Sluice Room. Cleaner room & WC in Nurses Station changed to Linen & Med Store. Fire escape staircase reconfigured. Kitchen Hatches moved Security area increased.		15.02.2022	WP
A9.1	Issued to consultants.			
A9.1	Ward fire escape route revised.		02.03.2022	WP
A10	Medicine Dispensary layout revised. Consulting Room, Counselling Room, Sluice Room, Clean Utility & Acute Single Room layouts revised. Male & Female Ward Store added. External ramp to walkway updated. Ward room played walls with doors updated. Lift lobby wall moved back & double door changed to single door. General Ward store changed to 'General Store'.		14.03.2022	WP
A10	Ward room played walls with doors updated.		18.03.2022	WP
A11	Furniture layouts updated. Glazing added to external walls. Patient abutment walls changed to 230mm.		01.04.2022	WP
A11	Glazing added to external walls.		19.04.2022	WP
A12	External columns & wall added to Main Entrance walkway with man trap. Ramp & stairs added at Main Entrance. Medicine Drop-off Zone changed to Medicine Store & delivery hatch added in man trap.		03.06.2022	WP
A13	Brick pinnas added to WCs & WHBs.		21.06.2022	WP
A14	Treatment Rooms layout updated. Group Therapy Store increased. Linen Store layouts updated. 4 Bed Ward layout updated. Drinking fountains and dividing walls in Med/Long Stay omitted. Ducts added in Acute Rooms & abutments. Ante Room & Disabled WC & shower added to Isolation Room. Pharmacy layout updated.		19.08.2022	WP
A15	Structural grid updated. SE staircase updated. Entrance ramp & stairs updated. M/L Female Ablution layout updated.		02.11.2022	WP
A16	Wall thicknesses updated. Building footprint updated. Lift lobby and back staircases updated. Medicine store walls thickened to 230mm. Admissions side wall thickened to 230mm.		02.12.2022	WP
A16	Building footprint updated.		27.09.2023	WP
A17	Structural grid updated. Windows added on SW elevation & Male ward Sluice. WHB added in Long Stay Recreation. Open yards floor finish change to AG.		02.11.2023	WP
A17	Admissions abutments duct external wall replaced with mesh screen and windows added to abutments. Clinical Counselling Room 4 size extended to Lift shaft. Brickwork removed from Staff Entrance. Mesh screen added to ducts on SW. Access doors added to ducts.		16.11.2023	WP
A18	Grid added for columns on perimeter. Wall on grid GA changed to 230mm.		24.07.2024	WP

THIS DRAWING IS TO BE READ IN CONJUNCTION WITH SPECIFICATION DOCUMENT 1518-500-00

HEALTH DEPARTMENT SIGNATURES  
ACTING CHIEF DIRECTOR: DOH INFRASTRUCTURE  
HEAD OFFICE PROGRAMME / SERVICE  
DISTRICT MANAGER  
CEO / MANAGER OF THE FACILITY  
DOH PROJECT MANAGER  
IMPLEMENTING AGENT PROJECT MANAGER  
PROFESSIONAL SERVICE PROVIDER  
NAME: MR. S.M. GOVENDER  
SIGNATURE: DATE: 2024.03.20

ARCHITECT  
ARTEK 4 ARCHITECTS (Pty) Ltd  
Durban: 46 Lema Avenue Road, Glenwood, Durban 4099  
tel: 031 201 0445 fax: 031 201 6609 email: admin@artek4.co.za  
Port Shepstone: 19 Trade Winds, Marine Drive, Shelly Beach  
tel: 039 662 2447 fax: 039 662 2446 email: admin@artek4.co.za



SOUTHERN REGION

Project  
WIMS No. 044044: SOUTHERN REGION: PORT SHEPSTONE: DEPARTMENT OF HEALTH: PORT SHEPSTONE: PORT SHEPSTONE HOSPITAL: NEW PSYCHIATRIC WARD

Drawing Description  
Ground Storey Plan - Flooring Layout Copy 1

Scale  
1 : 100  
Drawn  
SG/ WP  
Date  
01/17/22  
Consultant Project No.  
1518  
Drawing No.  
134  
Rev.  
A18  
DOW Drawing number  
WIMS no. 044044  
Stamped by Plans Approval Committee