

PLAN DESCRIPTION	DWG. NO.	SHEET NO.
CONTINUED FROM		
CONTINUED ON		
CROSS SECTIONS		
TYPICAL CROSS SECTION		
SURVEY LAYOUT		

UPHONGOLO LOCAL MUNICIPALITY
61 Martins Street
P.O. Box 191
PONGOLA 3170
T: 034 413 1706
E: thokozanim@uphongolo.co.za

GENERAL NOTES:

CONTRACTOR TO VERIFY ALL HEIGHTS, HEIGHTS & DIMENSIONS ON SITE PRIOR TO COMMENCEMENT OF WORK.

FOR ALL DIMENSIONS, THE CONTRACTOR SHALL PROVIDE LARGE SCALE DRAWINGS TAKING PREFERENCE OVER SMALL SCALE DRAWINGS.

DO NOT SCALE DRAWINGS. DIMENSIONS ONLY TO BE USED.

DAMAGE TO UNKNOWN SERVICES - THE CONTRACTOR SHALL BE RESPONSIBLE IF HE ENCOUNTERS UNKNOWN SERVICES IS TO NOTIFY THE ENGINEER IMMEDIATELY.

IF ANY PARTICULARS OR THE MEANING OF THE DESCRIPTION OF ANY ITEM IS NOT CLEAR OR IS AMBIGUOUS, THE CONTRACTOR SHALL NOT BE IN CONFUSION AS TO ITS MEANING OR IF ANY OTHER CLARIFICATION IS REQUIRED, THE CONTRACTOR MUST INFORM THE ENGINEER IMMEDIATELY, IN ACCORDANCE TO HAVE THE MATTER CLARIFIED AND EXPLAINED, AS THE CASE MAY BE.

ALL WORK TO BE EXECUTED IN ACCORDANCE WITH THE NATIONAL BUILDING REGULATIONS AND THE LOCAL BY-LAWS & REGULATIONS.

FOLLOWING LIST OF MATERIALS TO BE SUPPLIED IN ACCORDANCE WITH SABS CODES AND STANDARDS INDICATED.

STRUCTURE: CONCRETE: SABS-0100

FOUNDATIONS: SABS-0162

STEEL: STRUCTURAL STEEL: SABS-0163

STRUCTURAL TIMBER: SABS - 0163

Revision	Date	Description
		<p>NOTE: No construction work to commence until land and servitude acquisitions have been completed</p> <p>Acquisitions completed</p> 

UNDERGROUND SERVICES CHECKED		
SERVICE	DATE	SIGNATURE
W. DRAINS		
SEWERS		
WATER MAINS		
P.O. CABLES		
ELECTRIC CABLES		
A.R. CABLES		
S.C. CABLES		
IL PIPE LINE		

NOTE:
Only underground services affected by new construction work are shown. Care must be taken during excavations for road foundations, trenches etc., to avoid damage to underground services such as sewers, drains, cables, water mains and connections. Wherever possible these must be located before work proceeds.

Project Title	
---------------	--

CONSTRUCTION OF KWATHENGIZWE SPORTS COMPLEX

Drawing Title

ENTRANCE PLAN
LAYOUT, GRAND
STANDS AND SECTIONS

Scales	Reference
AS SHOWN	
Designed M.N.	Date MAY 2021
Checked B.K.	Drawn by M.N.

PMU Manager:

Technical Director:

Drawing No	Sheet 1
UPH_002	of 1 Sheets

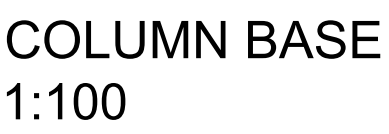

STANDARD SEATING REINFORCEMENT SCHEDULE									
REINFORCEMENT SCHEDULE									
MARK	No.	TOTAL No.	DIA	CODE	A	B	C	D	MASS
2390 x 575 x 120mm THICK SEATING SLABS (8 No.)									
01	5	40	Y12	38	60	2290	60		83
02	12	96	R8	20	500				19.5
2390 x 575 x 120mm THICK SEATING SLABS (8 No.)									
03	5	20	Y12	38	60	2180	60		40
04	12	84	R8	20	500				9.5



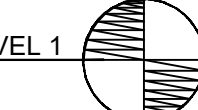
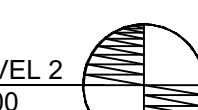
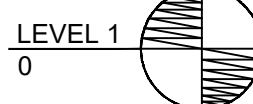
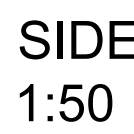
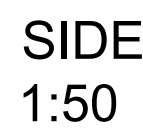

1. CONCRETE AND FLOORS
 - 1.1 25MPa/15mm CONCRETE FOR ALL RAFT FOUNDATIONS AND FLOOR SLABS
 - 1.2 375 MICRON DAMP PROOF MEMBRANE
 - 1.3 25mm FLOOR SCREE
2. WALLS
 - 2.1 BRICKWORK SHALL COMPLY WITH SABS 0145 "CONCRETE MASONRY" HAVING COMPRESSIVE STRENGTH OF 3.5MPa.
 - 2.2 ALL WALLS TO BE PLASTERED WITH 1:4 CEMENT : SAND RATIO. SAND TO BE CLEAN FINE FROM CLAY AND IMPURITIES. SURFACE TO BE PLASTERED SHALVE. JOINTS RAKED OUT AT LEAST 10mm TO PROVIDE A KEY.
 - 2.3 200 x 10mm FIBRE CEMENT WINDOW SAILS
 - 2.4 PRECAST CONCRETE LINTEL ON ALL DOORS AND WINDOW FRAMES.
 - 2.5 BRICK WORK ON EVERY THIRD COURSE.
 - 2.6 AIR BRICKS TO BE INSTALLED ABOVE EACH WINDOW
 - 2.7 100 x 100mm CONCRETE APRON AROUND THE BUILDING WITH EXPANSION JOINT AS SHOWN.
3. ROOFS
 - 3.1 152 x 38mm RAFTERS AT 1200mm CENTERS NAILED ON RAFTERS.
 - 3.2 32 x 16mm CRAMP 1200mm LONG WITH ONE END ENL 750mm DEEP INTO ROOF AND OTHER END WRAPPED OVER RAFTERS
 - 3.3 38 x 14mm WALL PLATE.
 - 3.4 76 x 50mm PURLINS AT 1200mm CENTERS NAILED ON RAFTERS.
 - 3.5 6.0mm THICK IBR GALVANISED SINGLE LENGTH SHEETING ON 76 x 50mm PURLINS.
4. WINDOWS
 - 4.1 ALL WINDOWS TO BE HOT DIPPED GALVANISED WITH BURGLAR GUARD INCLUDED.

ISSUED FOR TENDER

Date Sign.

PLAN DESCRIPTION	DWG. NO.	SHEET NO.
CONTINUED FROM		
CONTINUED ON		
CROSS SECTIONS		
TYPICAL CROSS SECTION		
SURVEY LAYOUT		

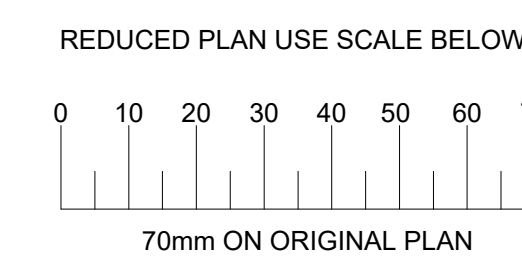

UPHONGO LOCAL MUNICIPALITY
61 Martins Street
P.O. Box 191
PONGOLA 3170
T: 034 413 1706
E: thokozanim@uphongo.co.za

- GENERAL NOTES:
- CONTRACTOR TO VERIFY ALL LEVELS, HEIGHTS & DIMENSIONS ON SITE PRIOR TO COMMENCEMENT OF WORK.
 - LARGE SCALE DRAWINGS TAKES PREFERENCE OVER SMALL SCALE DRAWINGS.
 - DO NOT SCALE DRAWINGS. DIMENSIONS ONLY TO BE USED.
 - DAMAGE TO UNKNOWN SERVICES - THE CONTRACTOR'S LIABILITY WHEN HE ENCOUNTERS UNKNOWN SERVICES IS TO NOTIFY.
 - IF ANY PARTICULARS OR THE MEANING OF THE DESCRIPTION OF ANY ITEM IS NOT CLEAR OR IS AMBIGUOUS, INDISTINCT OR CAUSES CONFUSION AS TO ITS MEANING OR IF ANY OBVIOUS ERROR OCCURS ON THE DRAWINGS, THE CONTRACTOR MUST INFORM THE ENGINEER IMMEDIATELY. IN ORDER TO HAVE THE ERROR CORRECTED OR EXPLAINED, AS THE CASE MAY BE.
 - ALL WORK TO BE EXECUTED IN ACCORDANCE WITH THE NATIONAL BUILDING REGULATIONS AND THE LOCAL BY-LAWS & REGULATIONS. FOLLOWING TRADES TO BE EXECUTED IN ACCORDANCE WITH SABS CODES AND STANDARDS INDICATED:
A. STRUCTURAL CONCRETE: SABS-0100
B. FOUNDATIONS: SABS-0162
C. STRUCTURAL STEEL: SABS - 0162
D. STRUCTURAL TIMBER: SABS - 0163

Revision	Date	For tender purposes only
01	05/14/2021	

Revision	Date	Description
		NOTE: No construction work to commence until land and servitude acquisitions have been completed.
		Acquisitions completed

DATE	Engineer
UNDERGROUND SERVICES CHECKED	
SERVICE	DATE SIGNATURE
S.W. DRAINS	
SEWERS	
WATER MAINS	
G.P.O. CABLES	
ELECTRIC CABLES	
S.A.R. CABLES	
E.S.C. CABLES	
OIL PIPE LINE	
NOTE: Only underground services affected by new construction work are shown. Care must be taken during excavations for road foundations, trenches etc. to avoid damage to underground services such as sewers, drains, cables, water mains and connections. Whenever possible these must be located before work proceeds.	

Contract No.	592/05/21
Project Title	

CONSTRUCTION OF KWATHENGIZWE SPORTS COMPLEX

SOCCER FIELD AND COMBO-COURT LAYOUT DETAILS

Scales	Reference
AS SHOWN	
Designed	M.N.
Checked	B.K.
Date	MAY 2021
Drawn by	M.N.

Project Technician:	
PMU Manager:	
Technical Director:	
Drawing No	UPH_004
Sheet	1
of	1
Sheets	

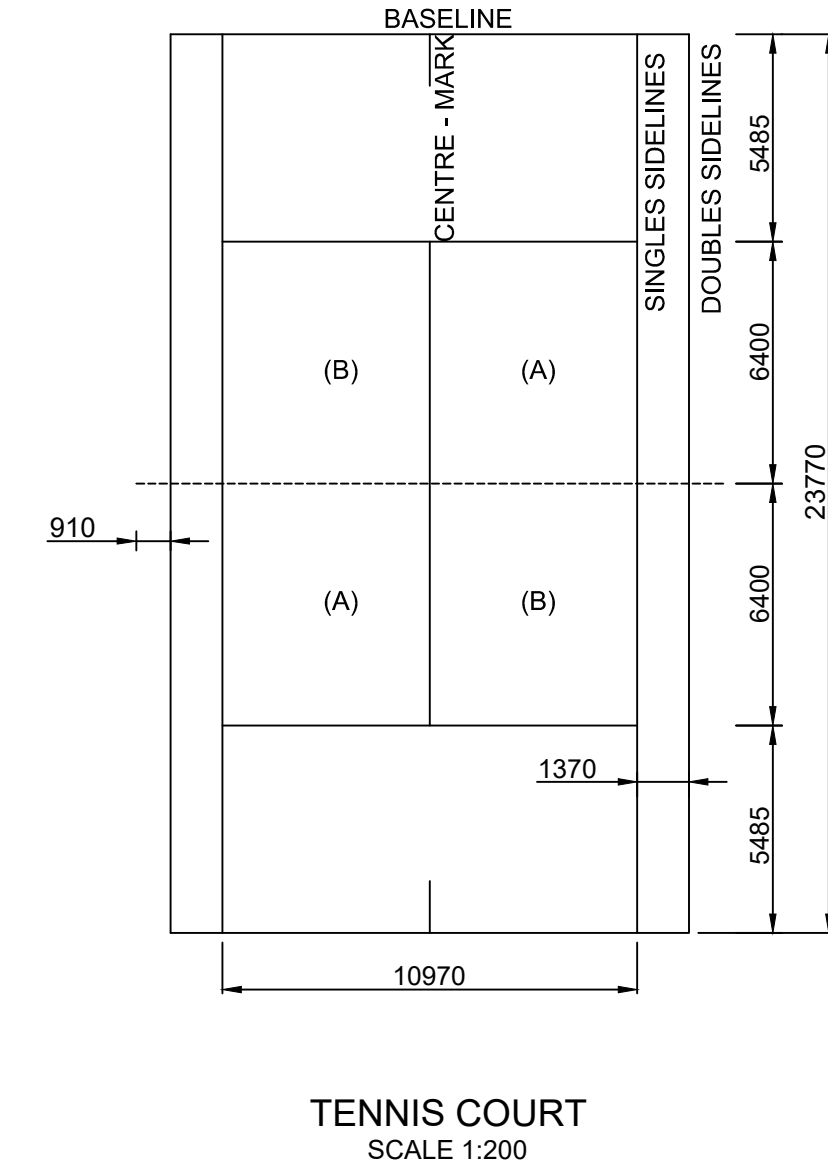
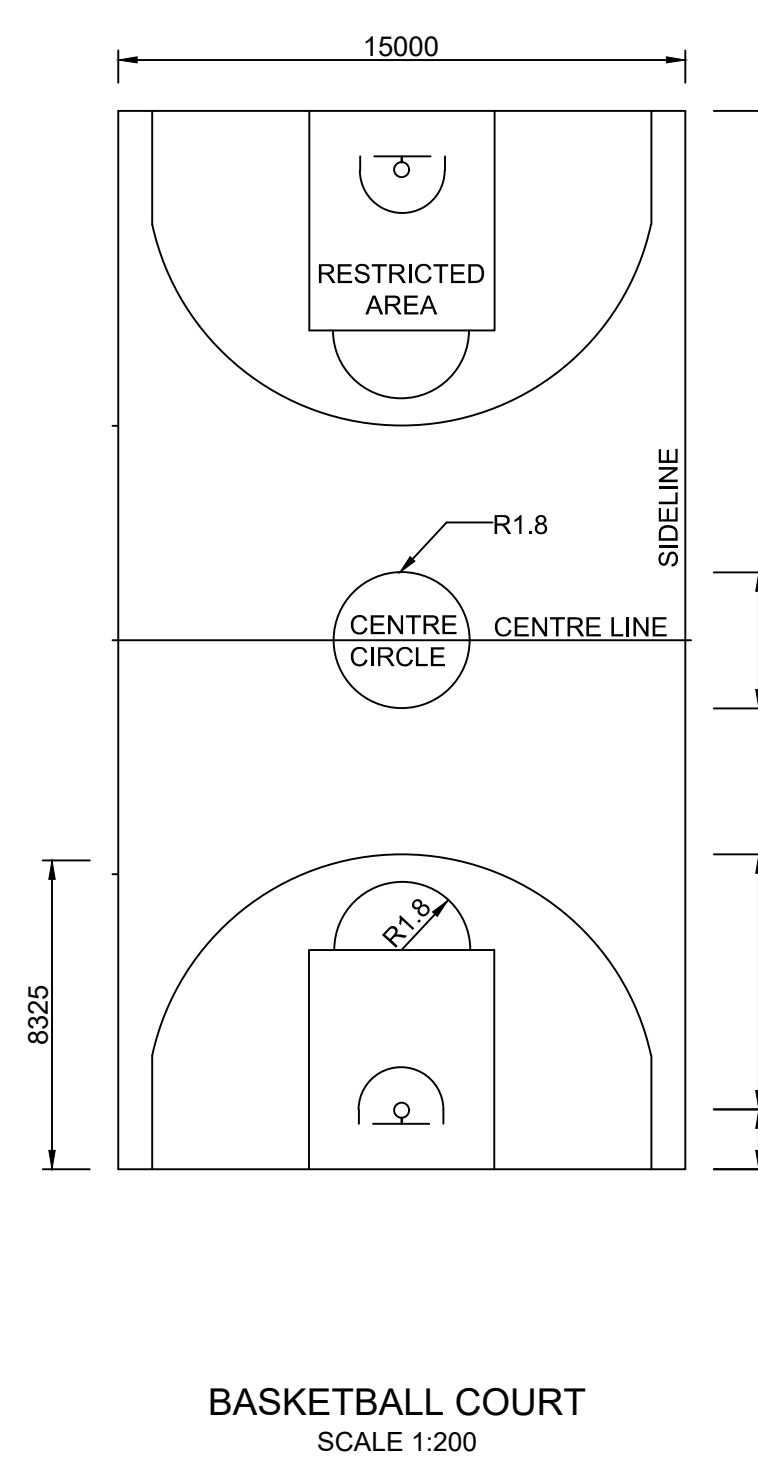
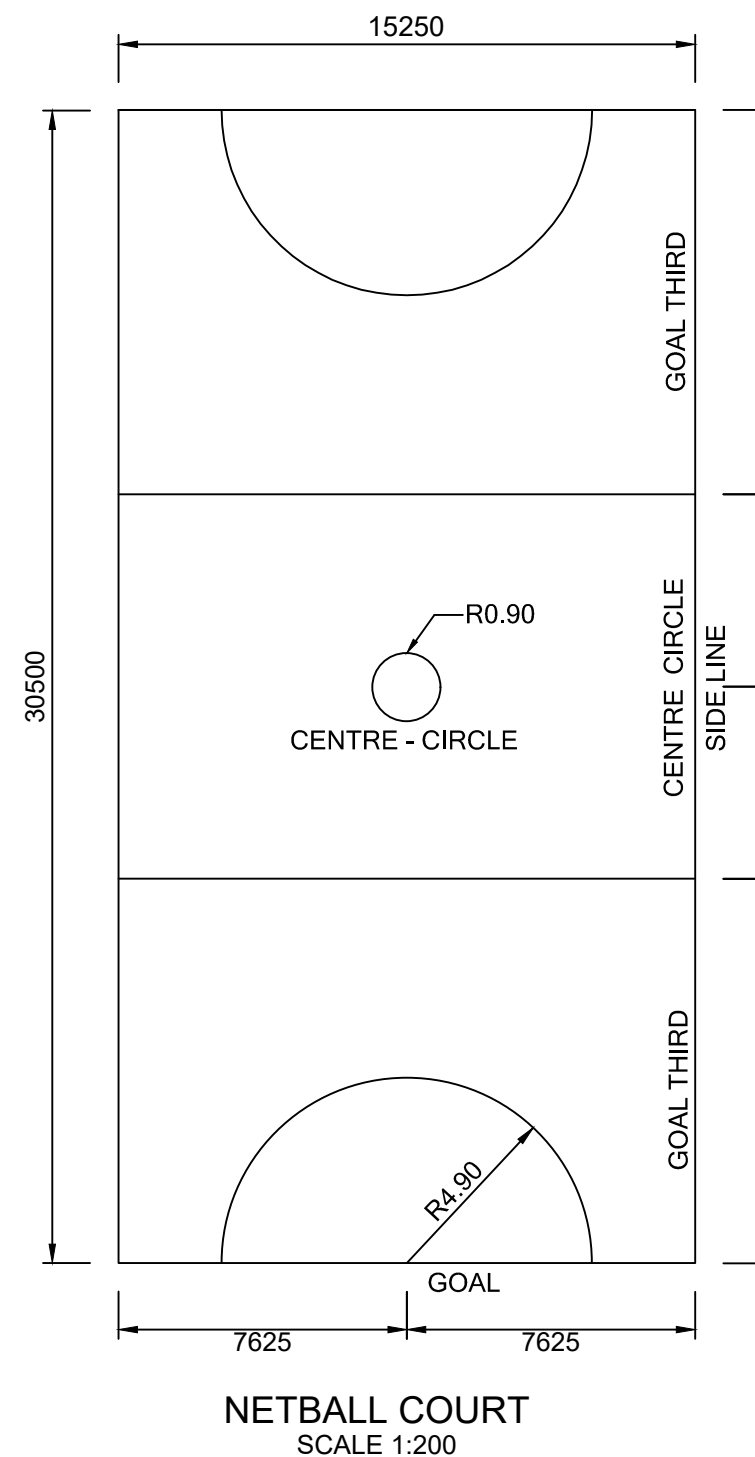
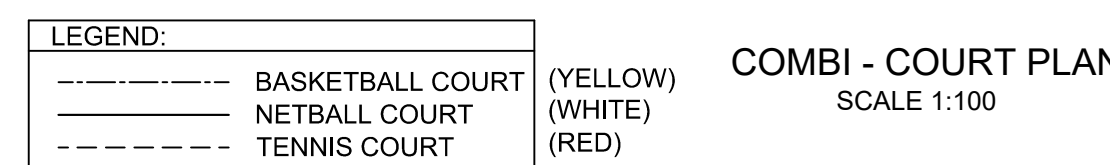
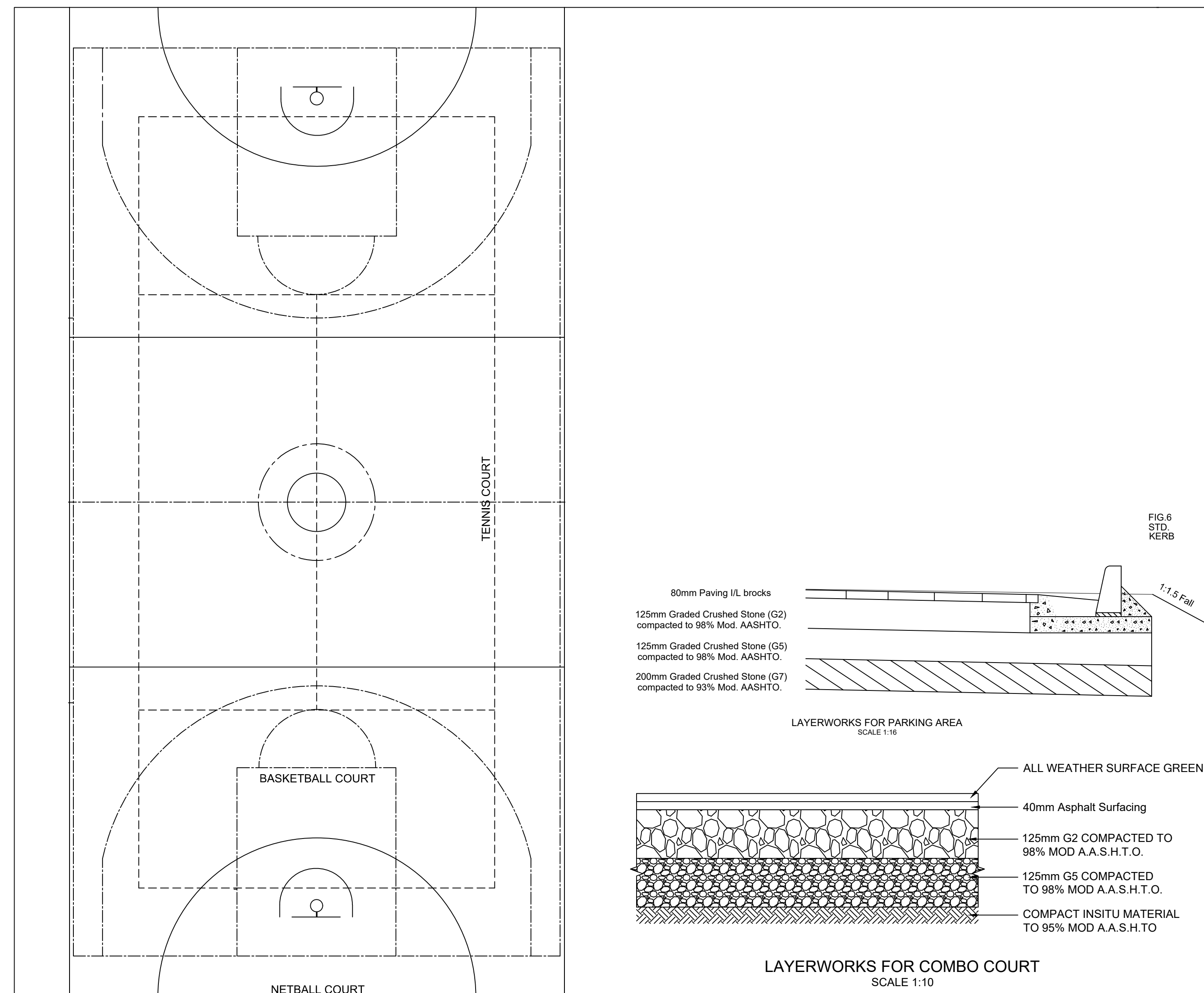
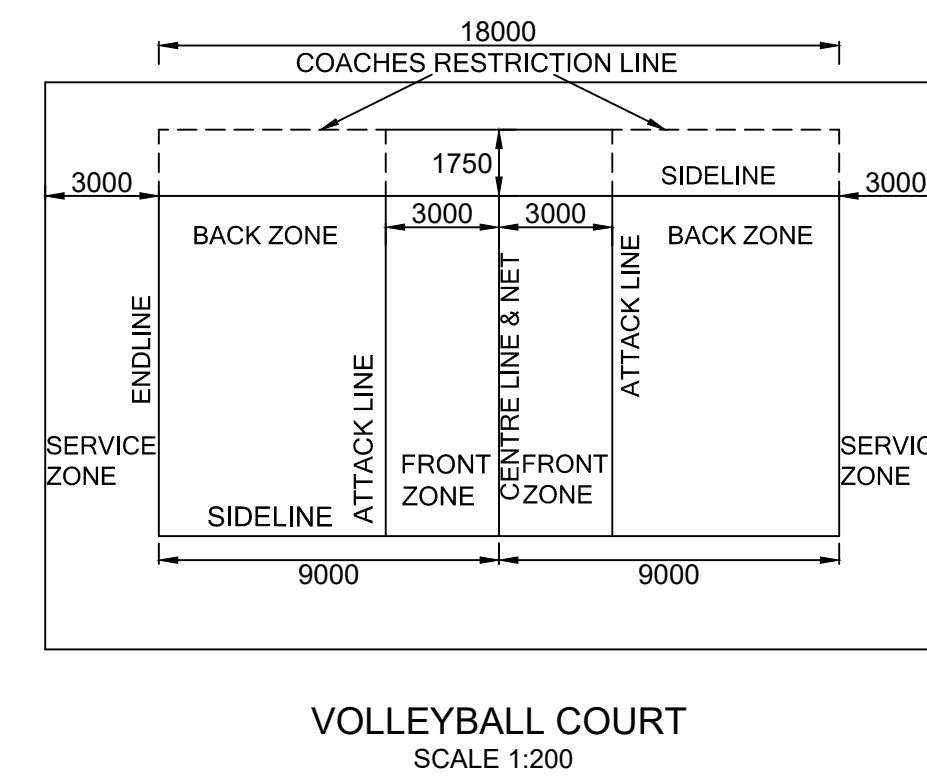
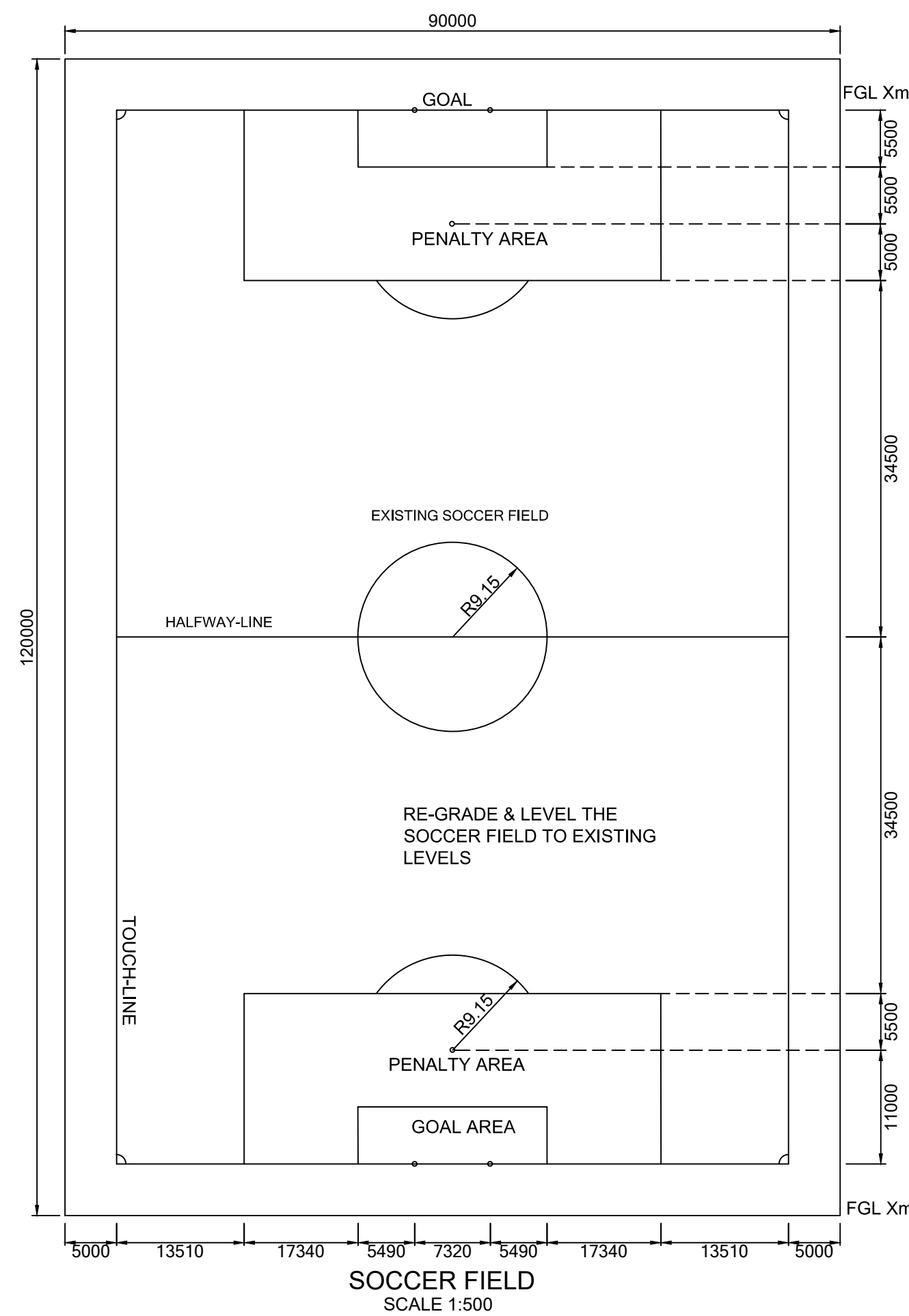

ISSUED FOR TENDER
Date Sign

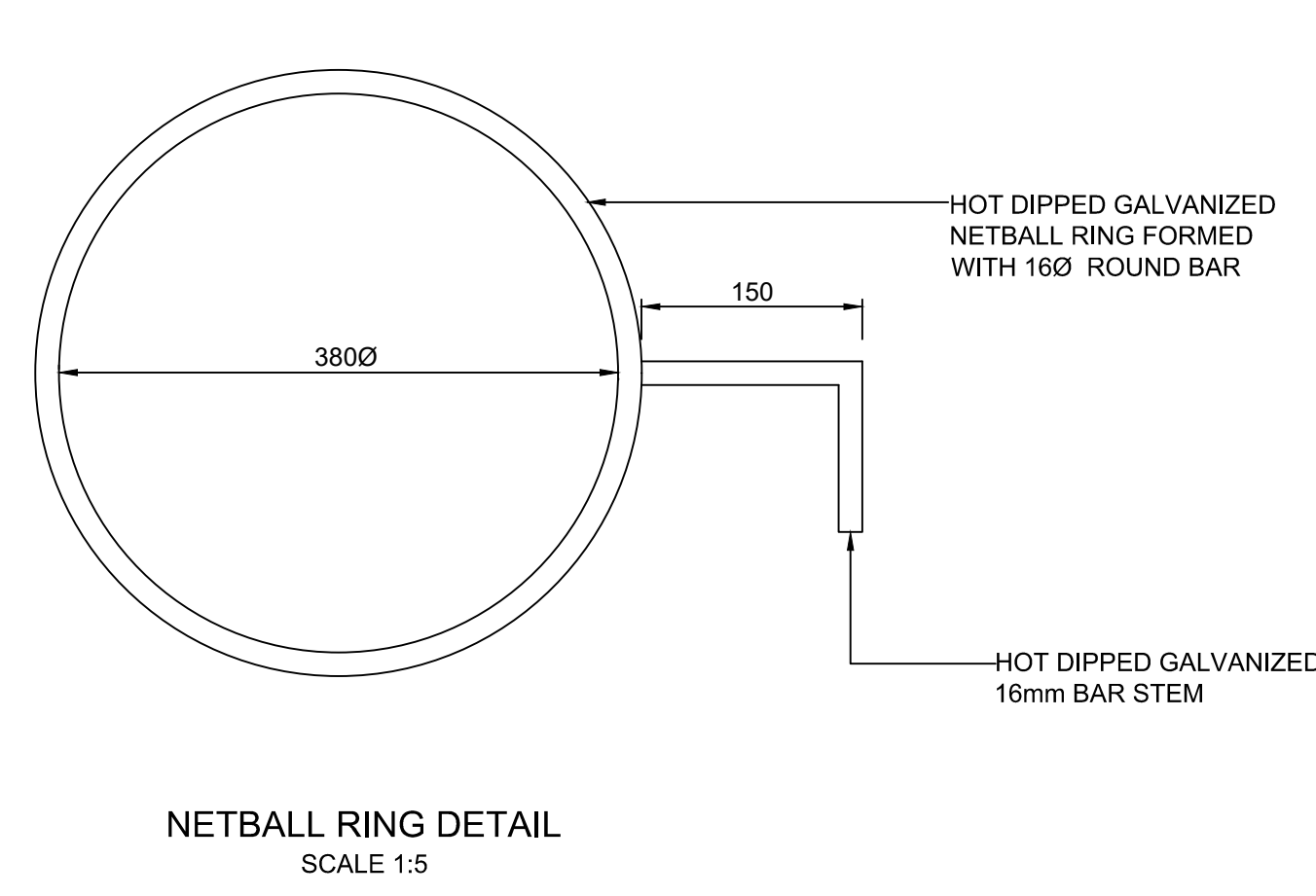
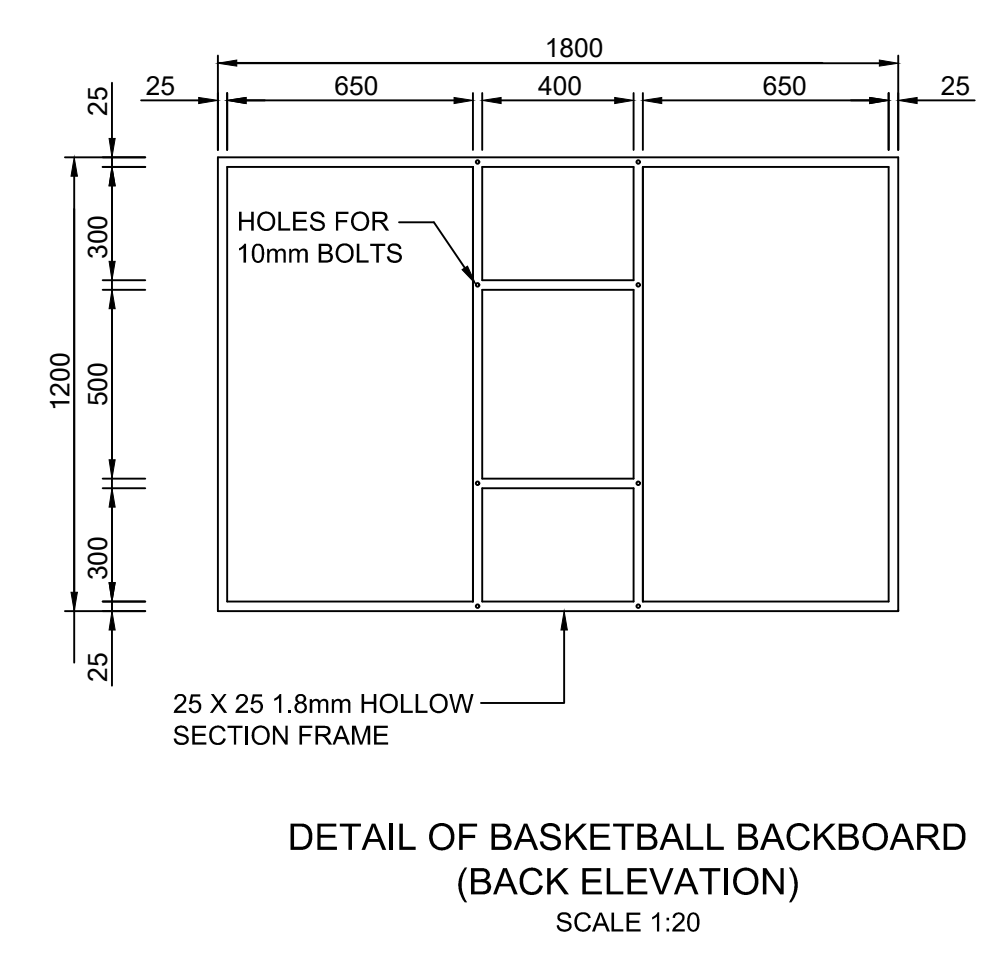
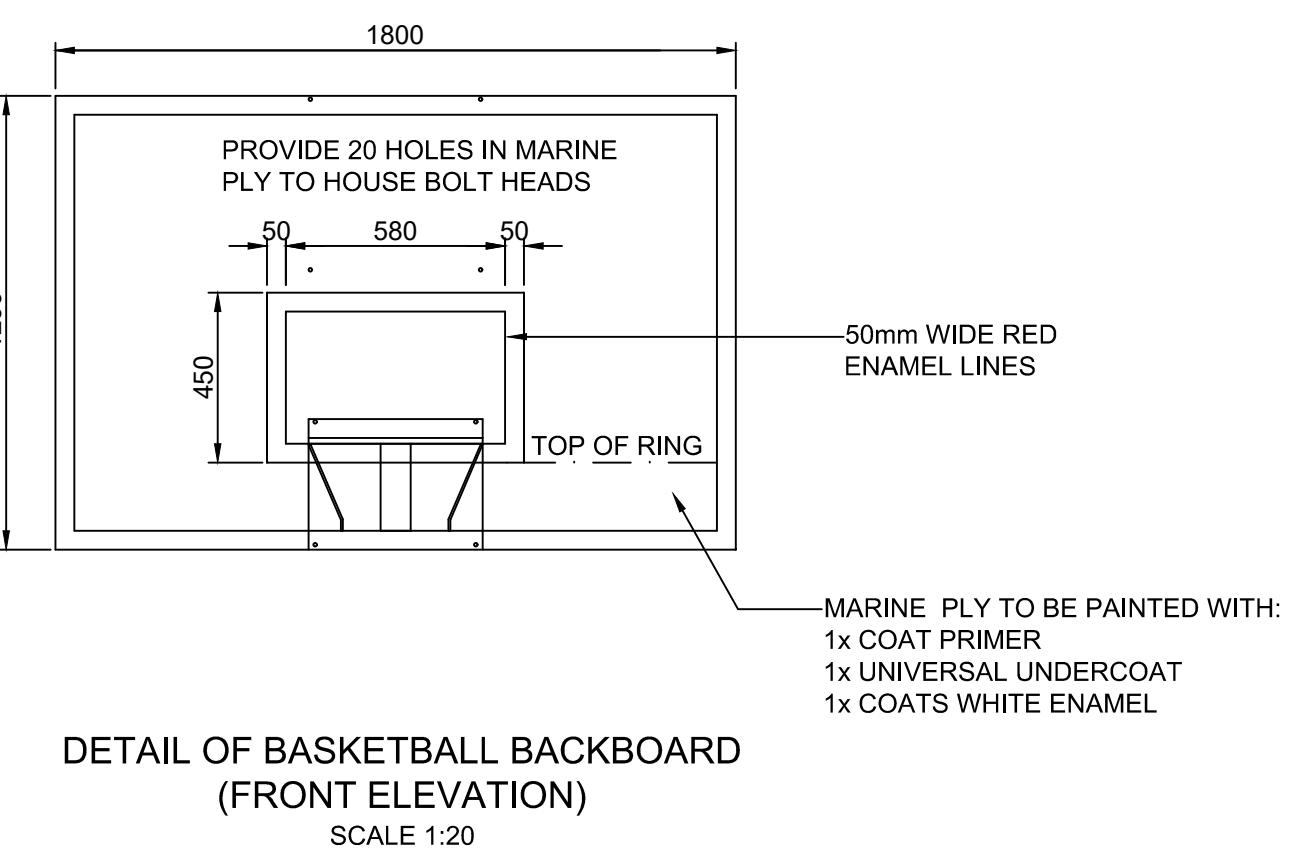
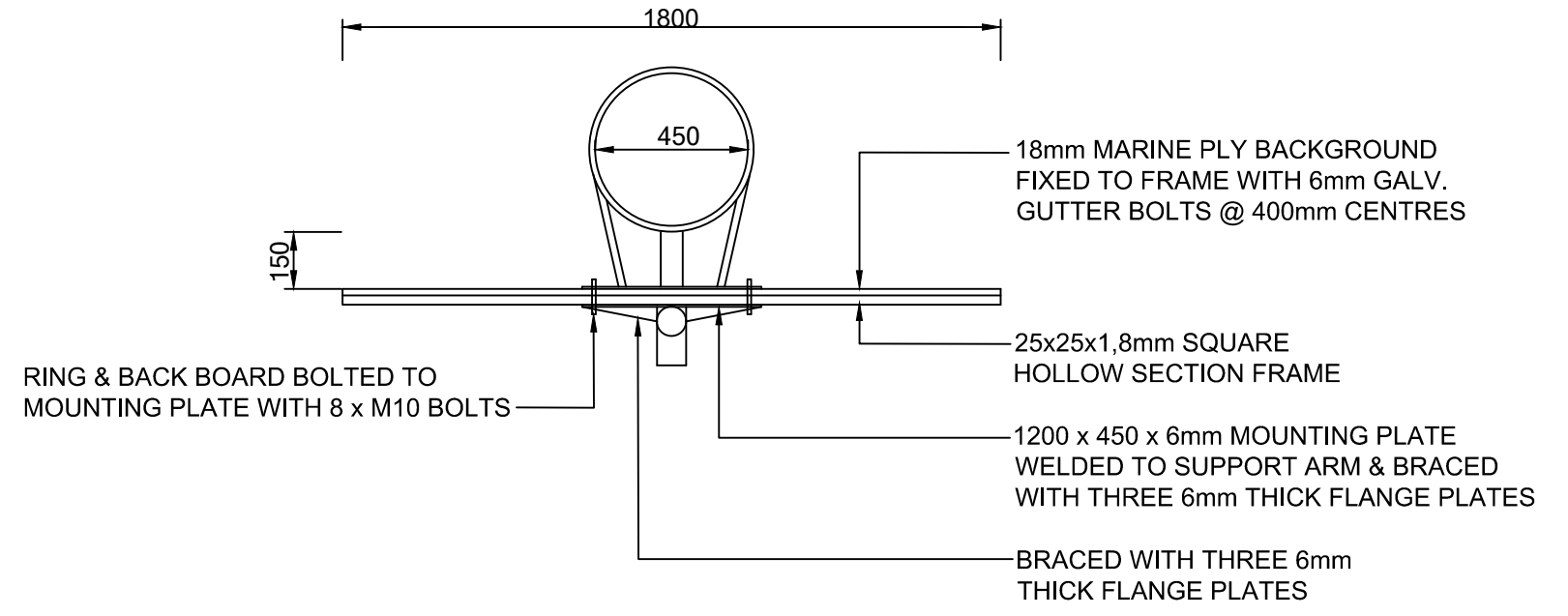
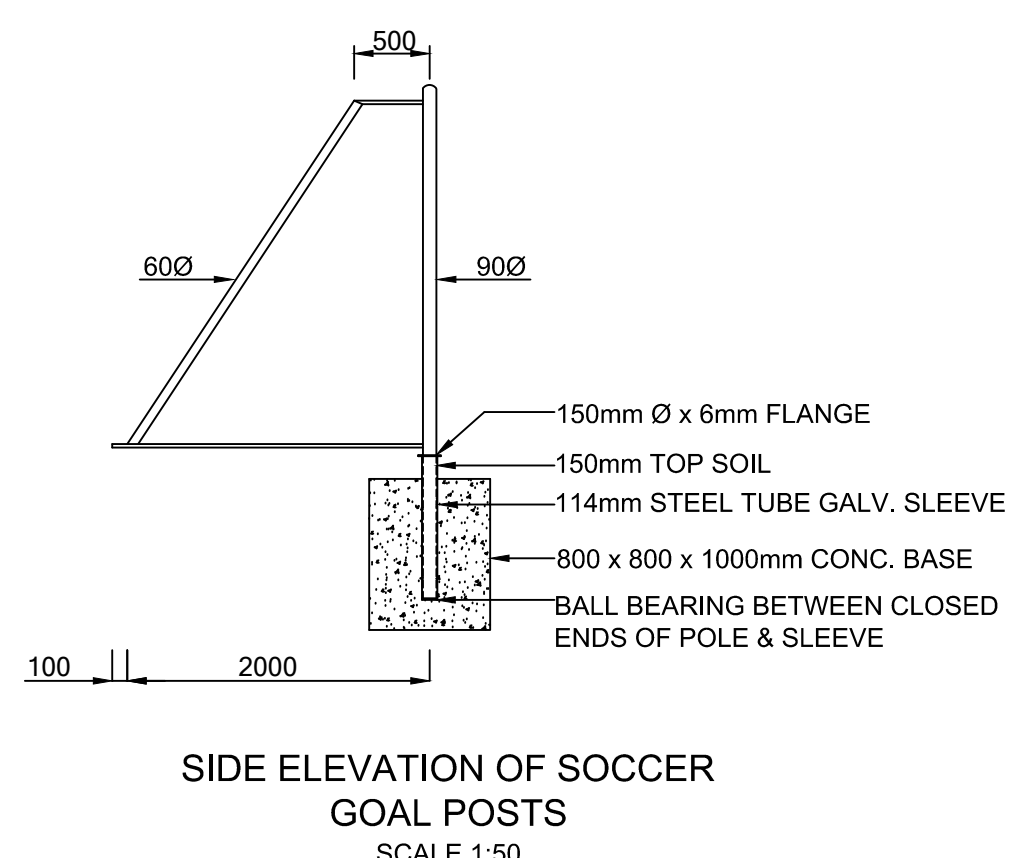
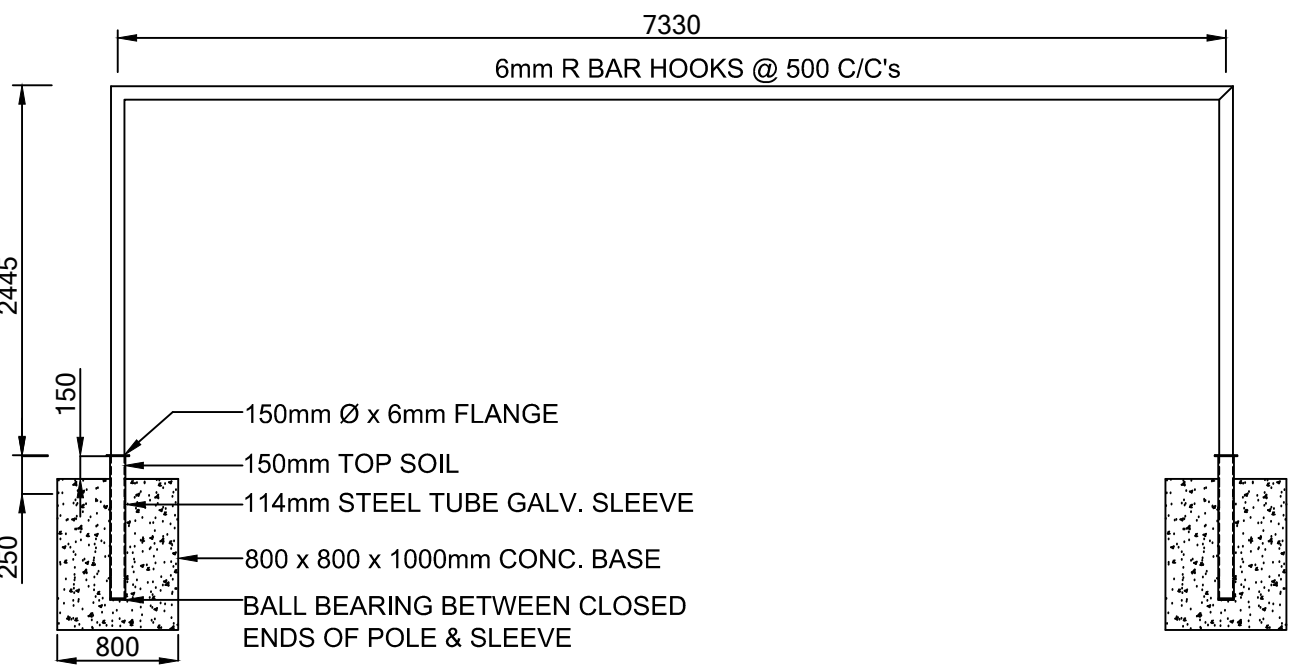
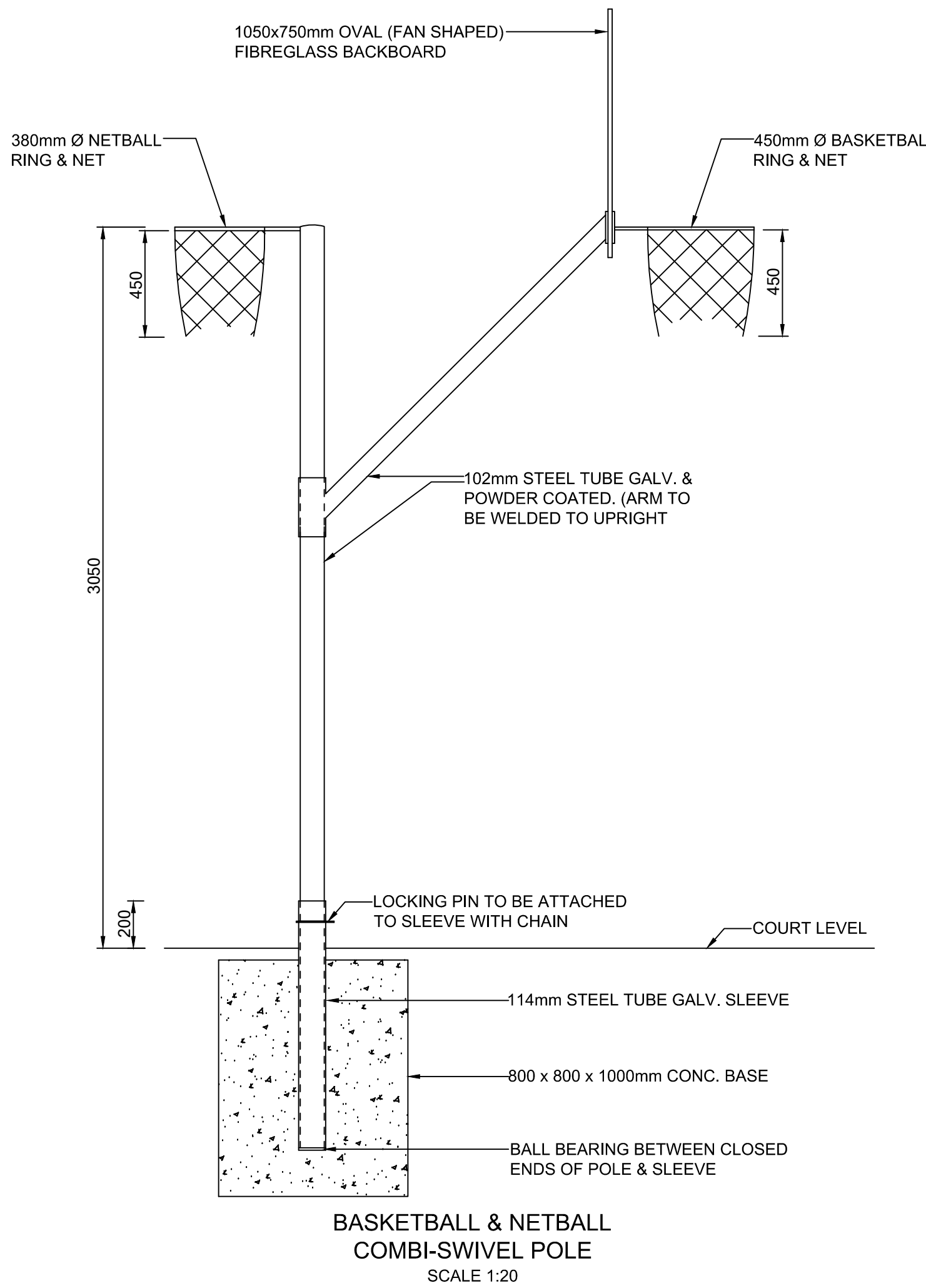
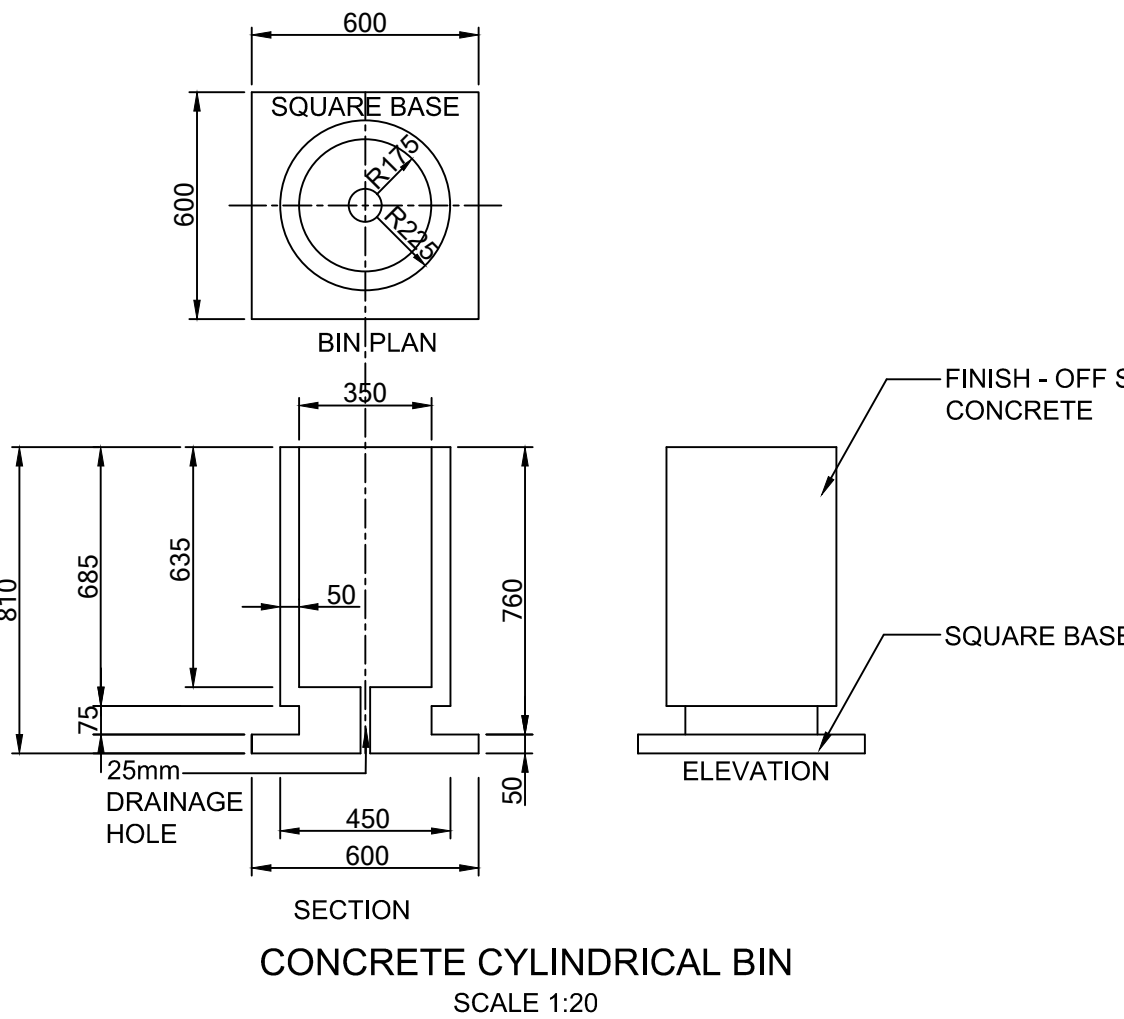
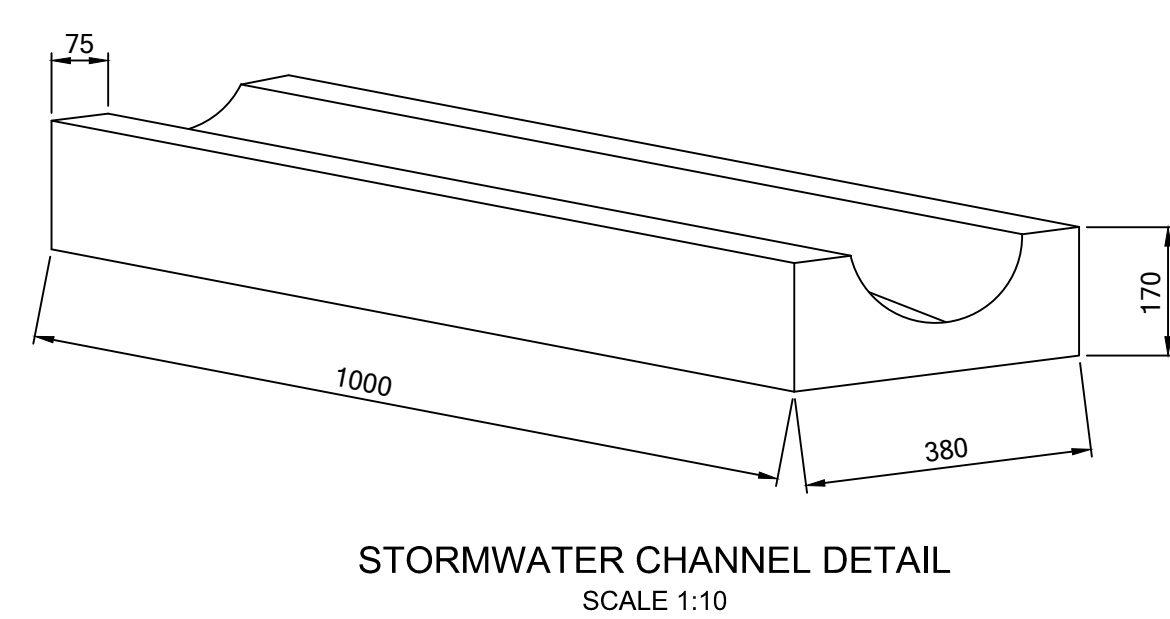

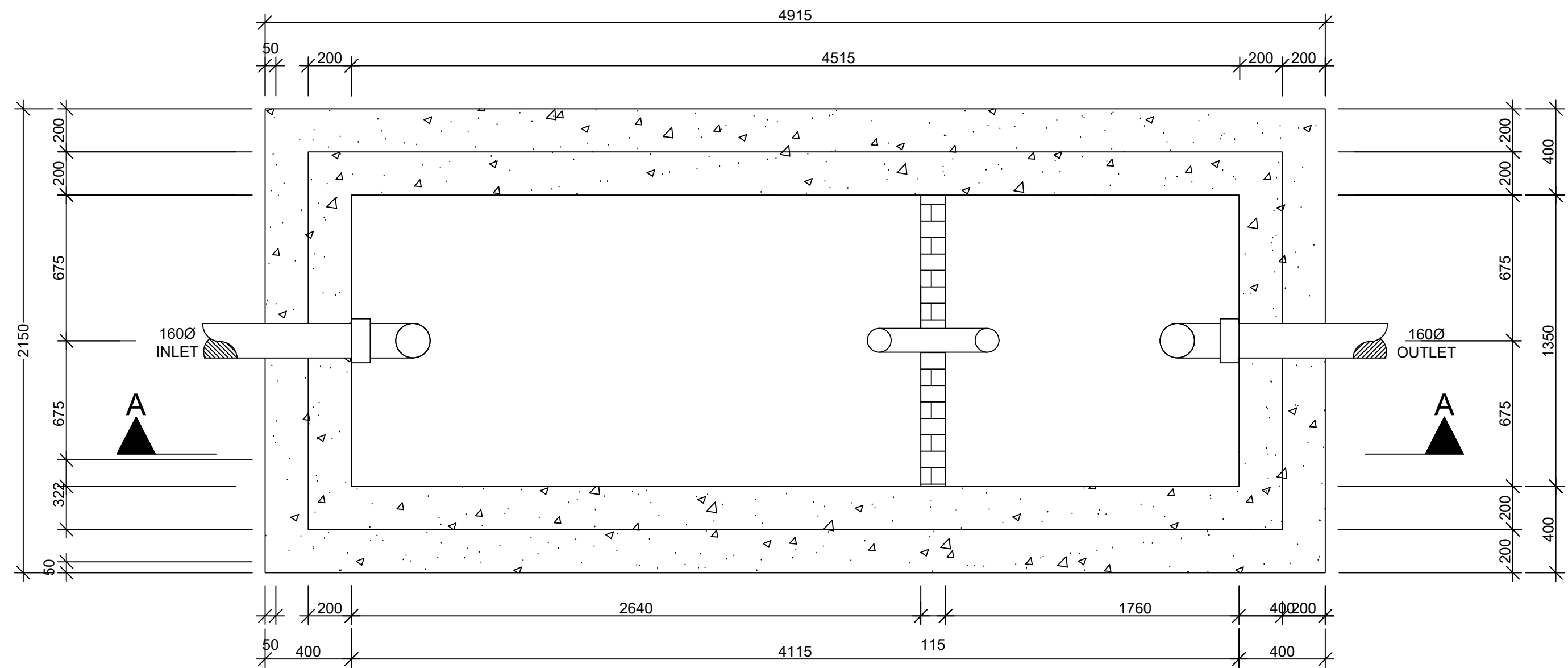

PLAN OF SEPTIC TANK DETAIL
SCALE 1:20

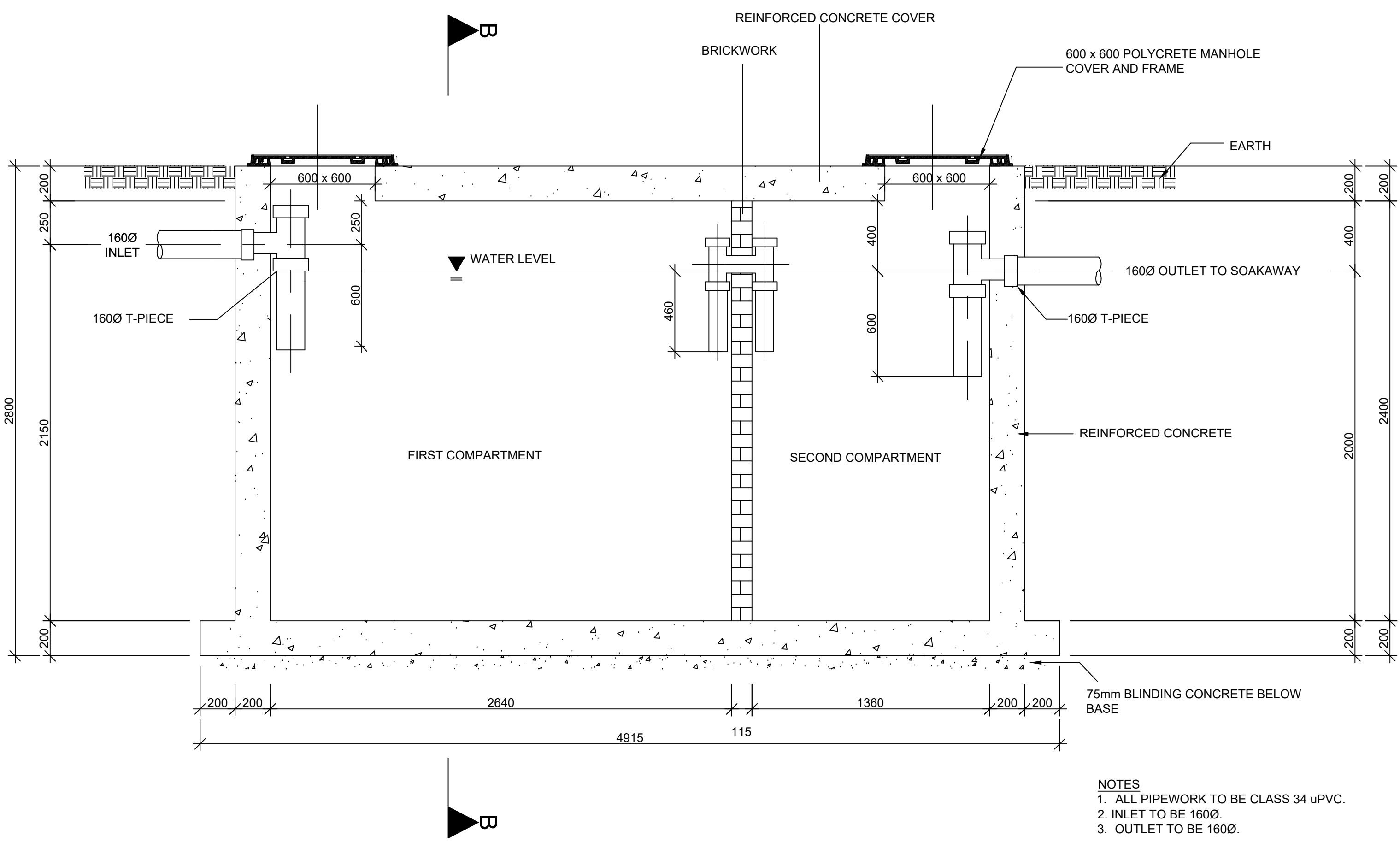

SEPTIC TANK DETAIL SECTION A-A
SCALE 1:20

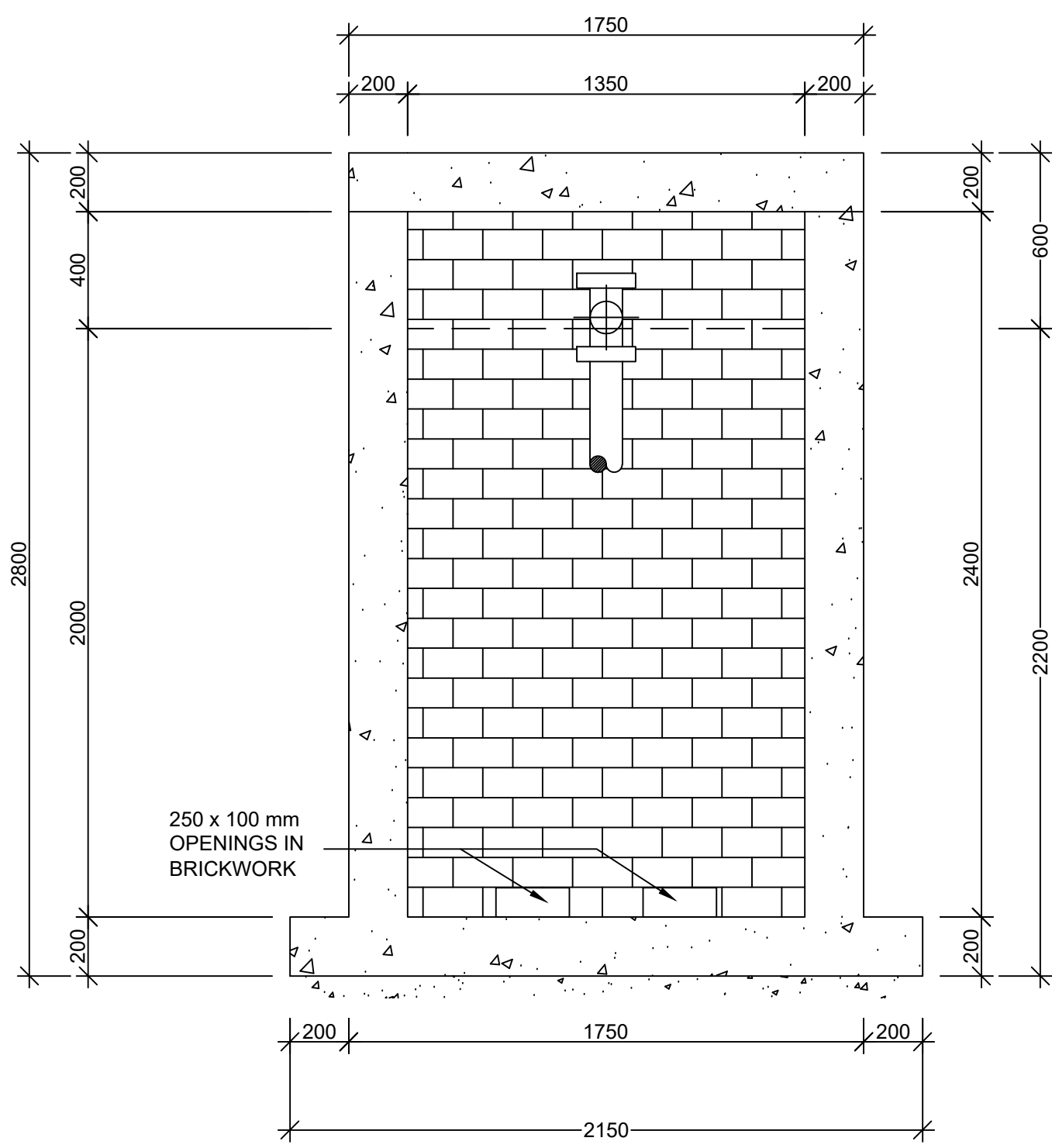

SEPTIC TANK DETAIL SECTION B-B
SCALE 1:20

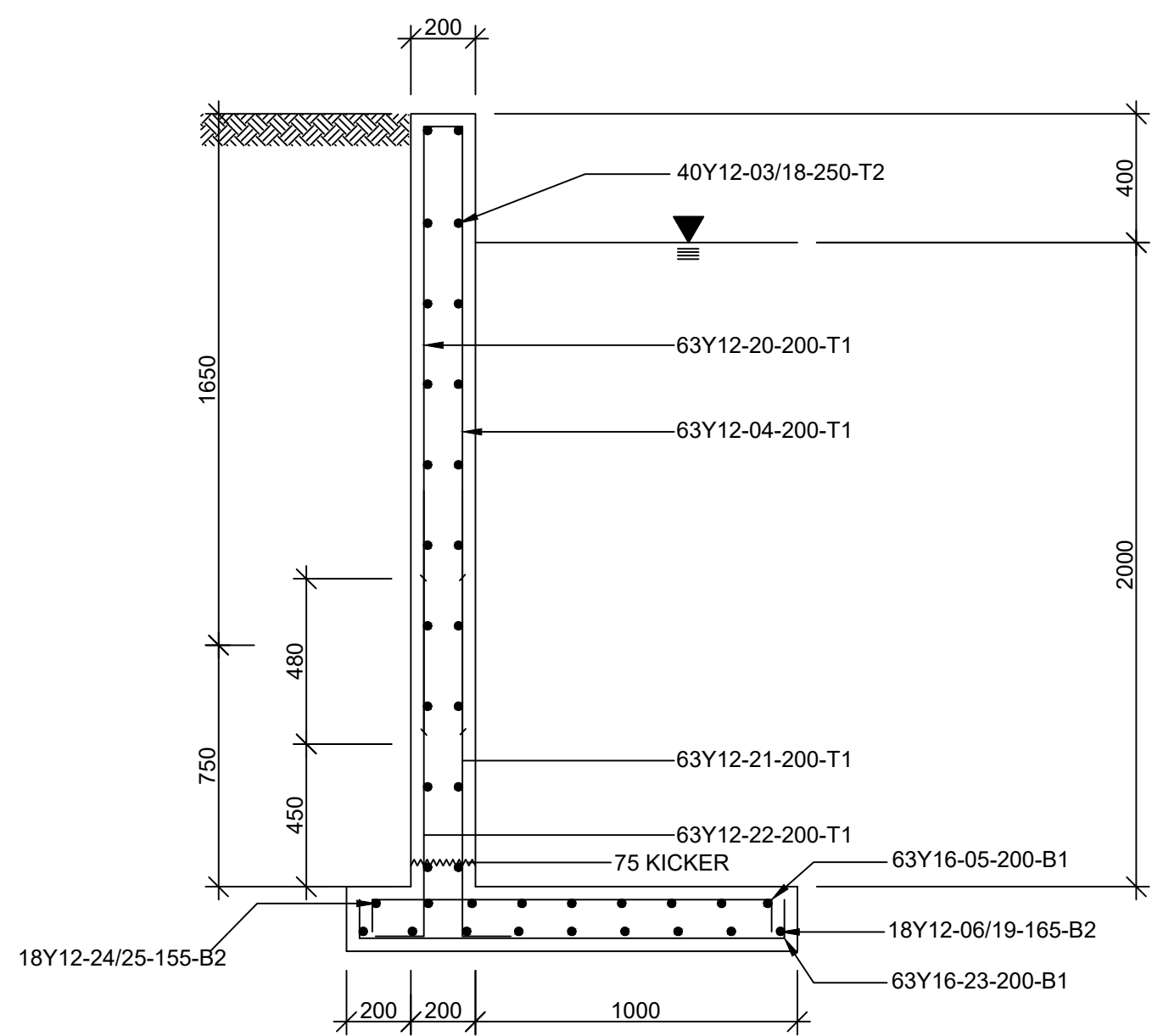

WALL REINFORCEMENT
SCALE 1:20

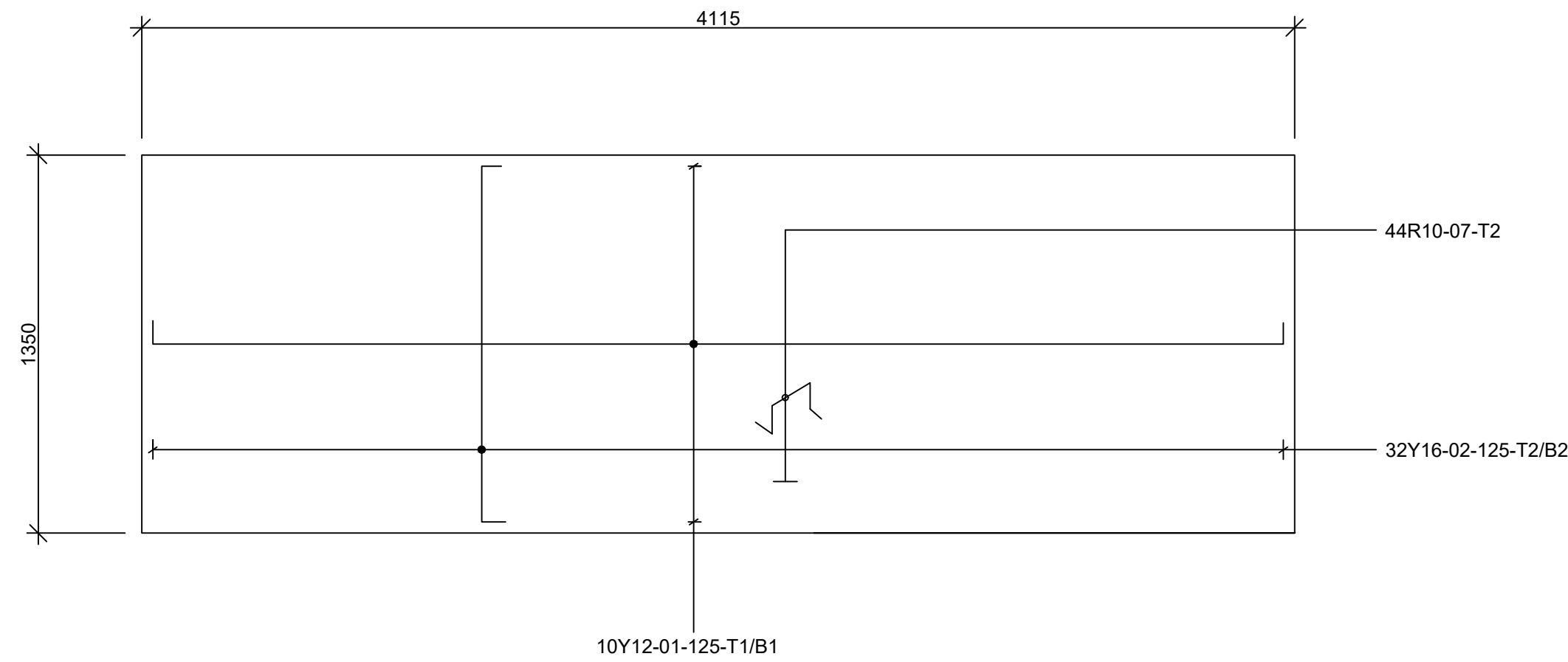

BASE SLAB REINFORCEMENT
SCALE 1:20

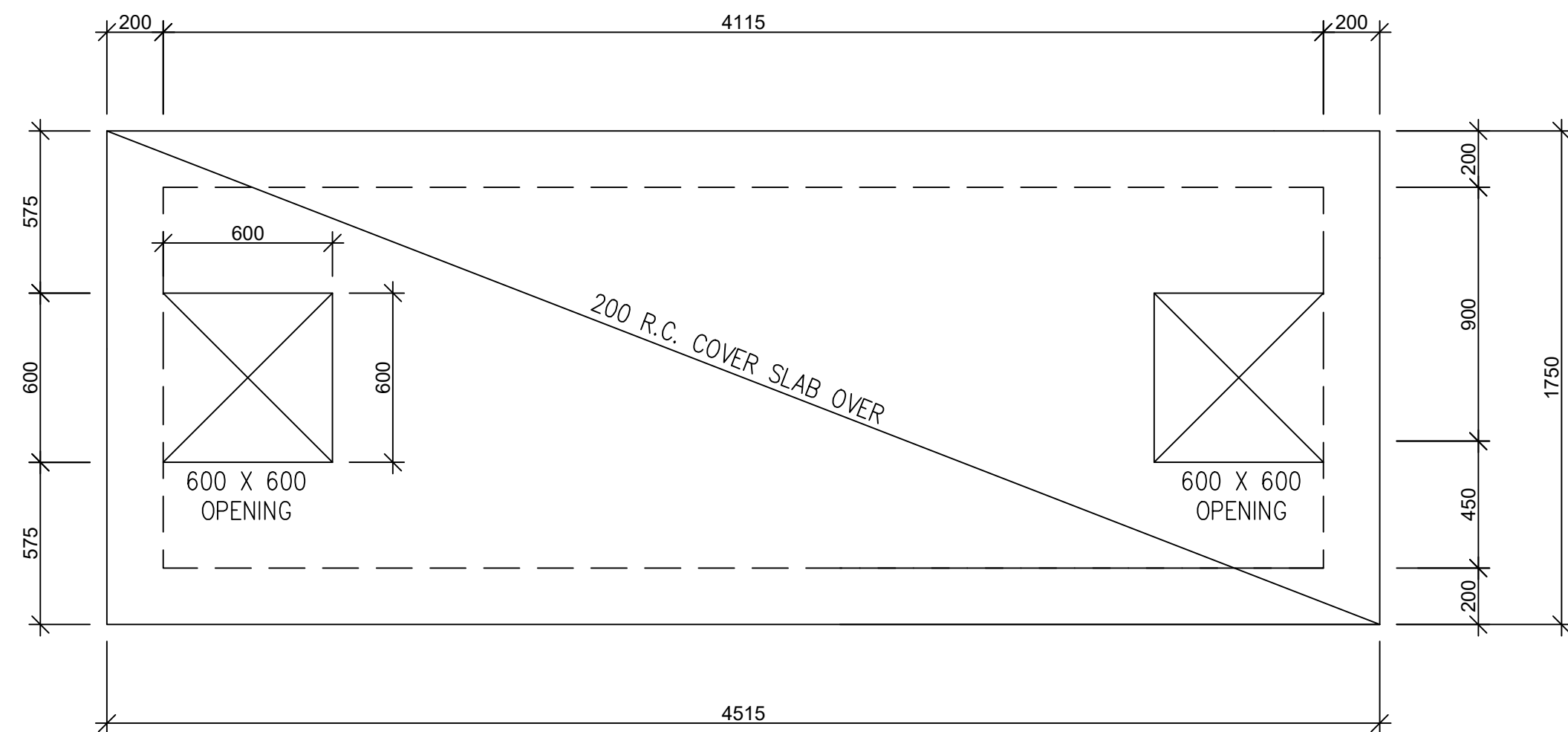

PLAN FOR TOP SLAB
SCALE 1:20

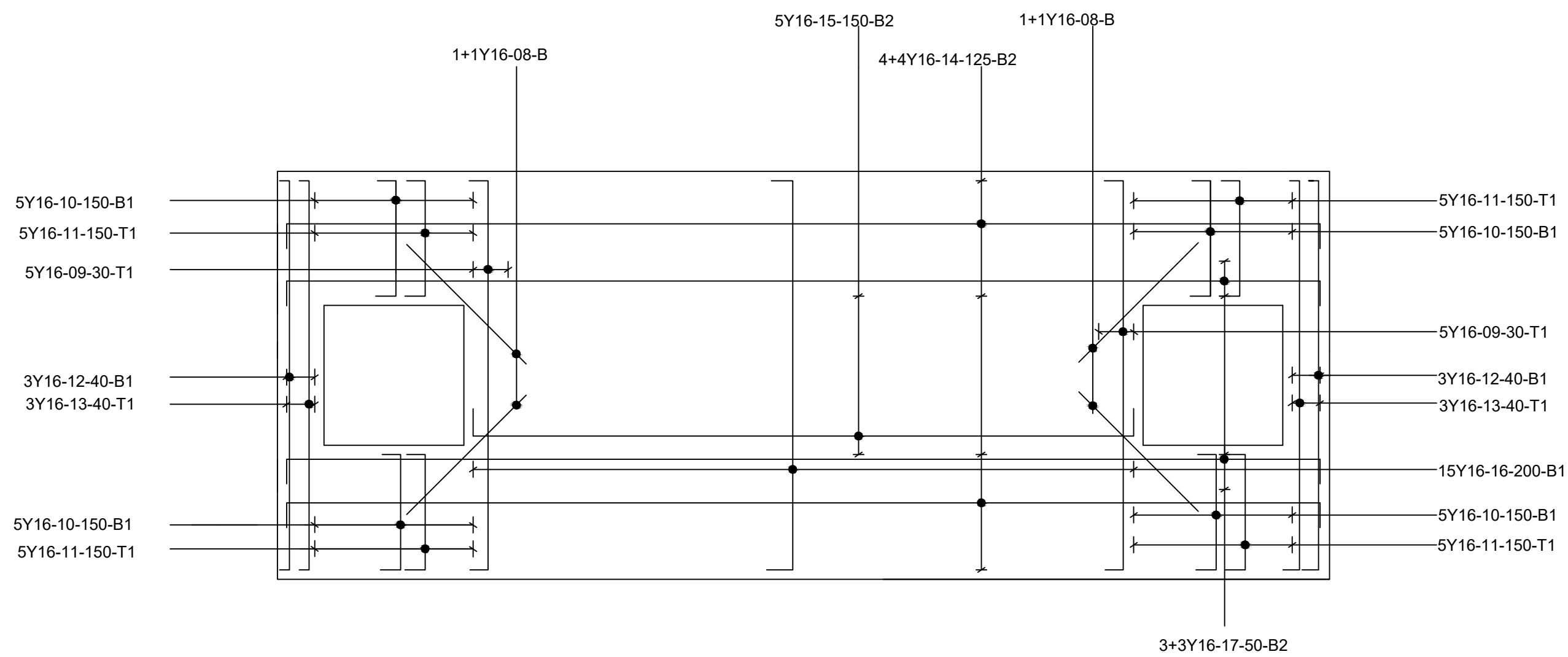

COVERING SLAB REINFORCEMENT
SCALE 1:25

BENDING SCHEDULE (SABS 82-1997)									
REINFORCEMENT				STANDARD BENDINGS					
MARK	DIA	No	OFF TOTAL	LENGTH	CODE	A	B	C	D E/R
01	Y12	20		4275	35	4035			
02	Y16	64		1510	35	1270			
03	Y12	40		1670	20	1670			
04	Y12	63		2000	37	120			
05	Y12	69		1440	38	100	1240		
06	Y12	18		2070	20	2070			
07	R10	28		810	63	330	90	150	
08	Y16	4		725	20	725			
09	Y16	10		1910	35	1670			
10	Y16	20		735	35	495			
11	Y16	20		735	35	495			
12	Y16	6		1910	35	1670			
13	Y16	6		1910	35	1670			
14	Y16	8		4675	35	4435			
15	Y16	5		3075	35	2835			
16	Y16	15		1910	35	1675			
17	Y16	6		4675	35	4435			
18	Y12	64		4435	20	4435			
19	Y12	18		4835	20	4835			
20	Y12	63		2000	37	120			
21	Y12	63		1535	37	150			
22	Y12	63		1535	37	150			
23	Y16	63		1560	38	120	1320		
24	Y12	18		2070	20	2070			
25	Y12	18		4835	20	4835			

NOTES
1. STRUCTURAL CONCRETE TO CONSIST OF GRADE 25/19 WITH CUBE CRUSHING STRENGTH OF 25MPa AT 28 DAYS.
2. COVER TO REINFORCEMENT = 40mm.

BTK2
CONSULTING AND PROJECT MANAGERS
BTK2 Consultants and Project Managers
Seadome Office Park
No.24 Seadome Road, AMANZIMTOTI 4126
T: 083 278 4086
E: untando@gmail.com

PLAN DESCRIPTION DWG. NO. SHEET NO.

CONTINUED FROM

CONTINUED ON

CROSS SECTIONS

TYPICAL CROSS SECTION

SURVEY LAYOUT

REDUCED PLAN USE SCALE BELOW

0 10 20 30 40 50 60 70
70mm ON ORIGINAL PLAN

UPHONGO LOCAL MUNICIPALITY
61 Martins Street
P.O. Box 191
PONGOLA 3170
T: 034 413 1706
E: thokozanim@uphongo.co.za

- GENERAL NOTES:
- CONTRACTOR TO VERIFY ALL LEVELS, HEIGHTS & DIMENSIONS ON SITE PRIOR TO COMMENCEMENT OF WORK.
 - LARGE SCALE DRAWINGS TAKES PREFERENCE OVER SMALL SCALE DRAWINGS.
 - DO NOT SCALE DRAWINGS, DIMENSIONS ONLY TO BE USED.
 - DAMAGE TO UNKNOWN SERVICES - THE CONTRACTOR'S LIABILITY WHEN HE ENCOUNTERS UNKNOWN SERVICES IS TO NOTIFY.
 - IF ANY PARTICULARS OR THE MEANING OF THE DESCRIPTION OF ANY ITEM IS NOT CLEAR OR IS AMBIGUOUS, INDISTINCT OR CAUSES CONFUSION AS TO ITS MEANING OR IF ANY OBVIOUS ERROR OCCURS ON THE DRAWINGS, THE CONTRACTOR MUST INFORM THE ENGINEER IMMEDIATELY. IN ORDER TO HAVE THE ERROR CORRECTED OR EXPLAINED, AS THE CASE MAY BE.
 - ALL WORK TO BE EXECUTED IN ACCORDANCE WITH THE NATIONAL BUILDING REGULATIONS AND THE LOCAL BY-LAWS & REGULATIONS, FOLLOWING TRADES TO BE EXECUTED IN ACCORDANCE WITH SABS CODES AND STANDARDS INDICATED.
A. STRUCTURAL CONCRETE: SABS-0100
B. FOUNDATIONS: SABS-0162
C. STRUCTURAL STEEL: SABS - 0162
D. STRUCTURAL TIMBER: SABS - 0163

01	05/14/2021	For tender purposes only
Revision	Date	Description
NOTE: No construction work to commence until land and servitude acquisitions have been completed.		
Acquisitions completed		
NORTH POINT		
DATE: 05/14/2021		
Engineer		
UNDERGROUND SERVICES CHECKED		
SERVICE	DATE	SIGNATURE
S.W. DRAINS		
SEWERS		
WATER MAINS		
G.P.O. CABLES		
ELECTRIC CABLES		
S.A.R. CABLES		
E.S.C. CABLES		
OIL PIPE LINE		
NOTE: Only underground services affected by new construction work are shown. Care must be taken during excavations for road foundations, trenches etc. to avoid damage to underground services such as sewers, drains, cables, water mains and connections. Whenever possible these must be located before work proceeds.		

592/05/21

Contract No.

Project Title

CONSTRUCTION OF
KWATHENGZWE
SPORTS COMPLEX

SEPTIC TANK LAYOUT
AND DETAILS

Scales	Reference
AS SHOWN	

Designed	Date
M.N.	MAY 2021
Checked	Drawn by
B.K.	M.N.

Project Technician:

PMU Manager:

Technical Director:

ISSUED FOR TENDER	
Date	Sign

Drawing No	Sheet 1
UPH_005	of 1 Sheets



BTK2 Consultants and Project Managers
Seadome Office Park,
No.24 Seadome Road, AMANZIMTOTI 4126
T: 083 278 4086
E: untando@gmail.com

PLAN DESCRIPTION	DWG. NO.	SHEET NO.
CONTINUED FROM		
CONTINUED ON		
CROSS SECTIONS		
TYPICAL CROSS SECTION		
SURVEY LAYOUT		

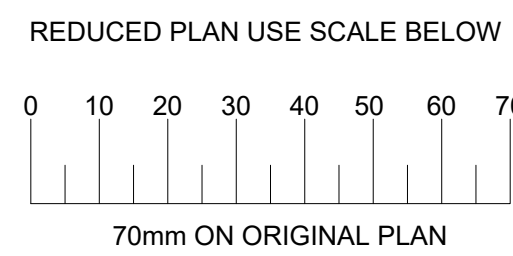

UPHONGOLO LOCAL MUNICIPALITY
61 Martins Street
P.O. Box 191
PONGOLA 3170
T: 034 413 1706
E: thokoananim@upthongolo.co.za

GENERAL NOTES:

- CONTRACTOR TO VERIFY ALL LEVELS, HEIGHTS & DIMENSIONS ON SITE PRIOR TO COMMENCEMENT OF WORK.
- LARGE SCALE DRAWINGS TAKES PREFERENCE OVER SMALL SCALE DRAWINGS.
- DO NOT SCALE DRAWINGS, DIMENSIONS ONLY TO BE USED.
- DAMAGE TO UNKNOWN SERVICES - THE CONTRACTOR'S LIABILITY WHEN HE ENCOUNTERS UNKNOWN SERVICES IS TO NOTIFY.
- IF ANY PARTICULARS OR THE MEANING OF THE DESCRIPTION OF ANY ITEM IS NOT CLEAR OR IS AMBIGUOUS, INDISTINCT OR CAUSES CONFUSION AS TO ITS MEANING OR IF ANY OBVIOUS ERROR OCCURS ON THE DRAWINGS, THE CONTRACTOR MUST INFORM THE ENGINEER IMMEDIATELY. IN ORDER TO HAVE THE ERROR CORRECTED OR EXPLAINED, AS THE CASE MAY BE.
- ALL WORK TO BE EXECUTED IN ACCORDANCE WITH THE NATIONAL BUILDING REGULATIONS AND THE LOCAL BY-LAWS & REGULATIONS. FOLLOWING TRADES TO BE EXECUTED IN ACCORDANCE WITH SABS CODES AND STANDARDS INDICATED:
 - STRUCTURAL CONCRETE: SABS-0100
 - FOUNDATIONS: SABS-0162
 - STRUCTURAL STEEL: SABS - 0162
 - STRUCTURAL TIMBER: SABS - 0163

Revision	Date	Description
----------	------	-------------

NOTE: No construction work to commence until land and servitude acquisitions have been completed

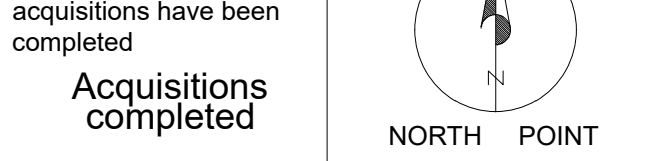

DATE	Engineer
UNDERGROUND SERVICES CHECKED	
SERVICE	DATE
SEWERS	
WATER MAINS	
G.P.O. CABLES	
ELECTRIC CABLES	
S.A.R. CABLES	
E.S.C. CABLES	
OIL PIPE LINE	

NOTE:
Only underground services affected by new construction work are shown. Care must be taken during excavations for road foundations, trenches etc. to avoid damage to underground services such as sewers, drains, cables, water mains and connections. Wherever possible these must be located before work proceeds.

Contract No. 592/05/21

Project Title

CONSTRUCTION OF KWATHENGIZWE SPORTS COMPLEX

Drawing Title

SIGNBOARD LAYOUT AND DETAILS

Scales	Reference
AS SHOWN	

Designed	Date
M.N.	MAY 2021
Checked	Drawn by
B.K.	M.N.

Project Technician:

PMU Manager:

Technical Director:

Drawing No	Sheet
UPH_006	1
	of 1 Sheets

ISSUED FOR TENDER

Date Sign

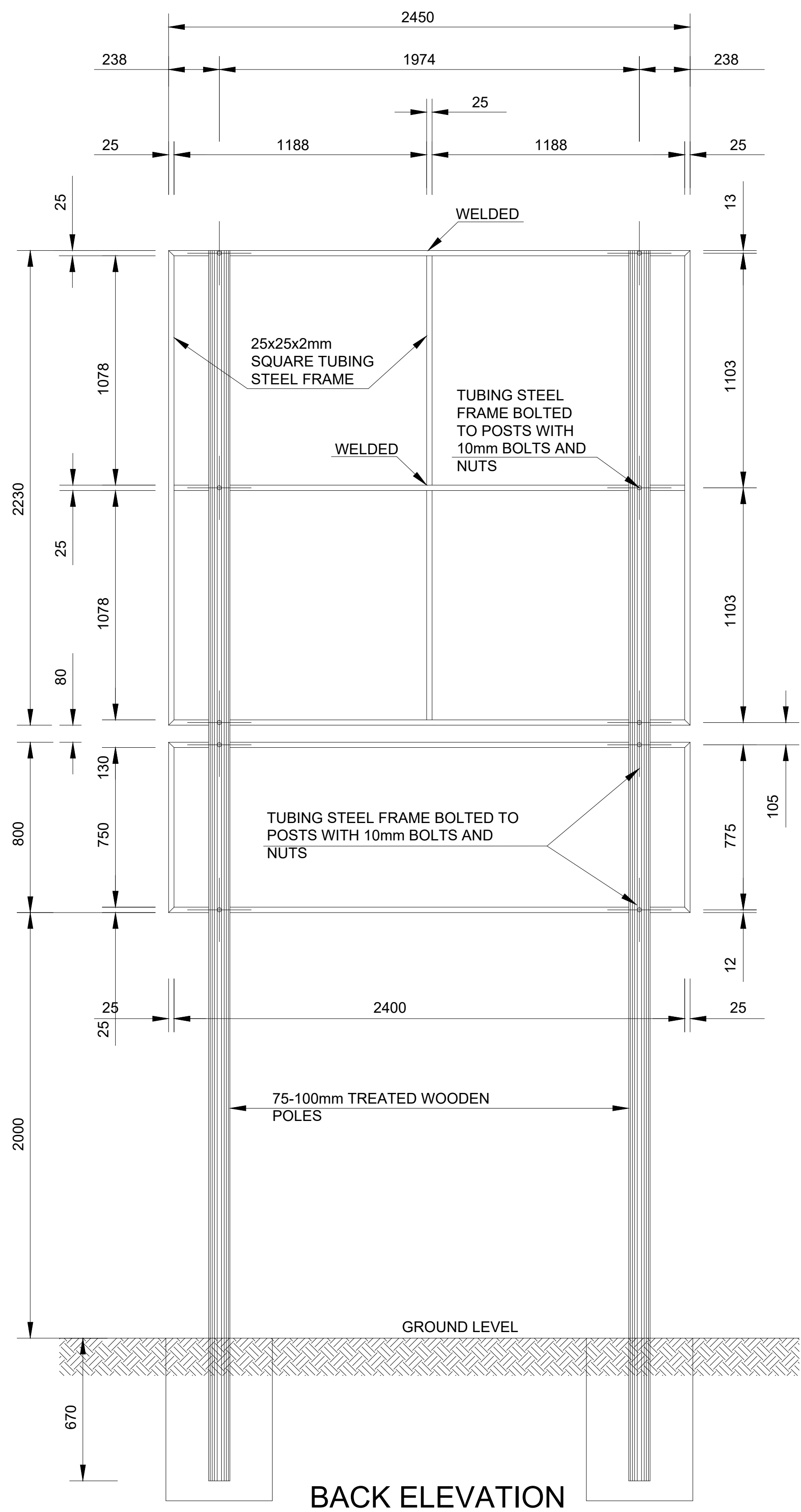

BACK ELEVATION

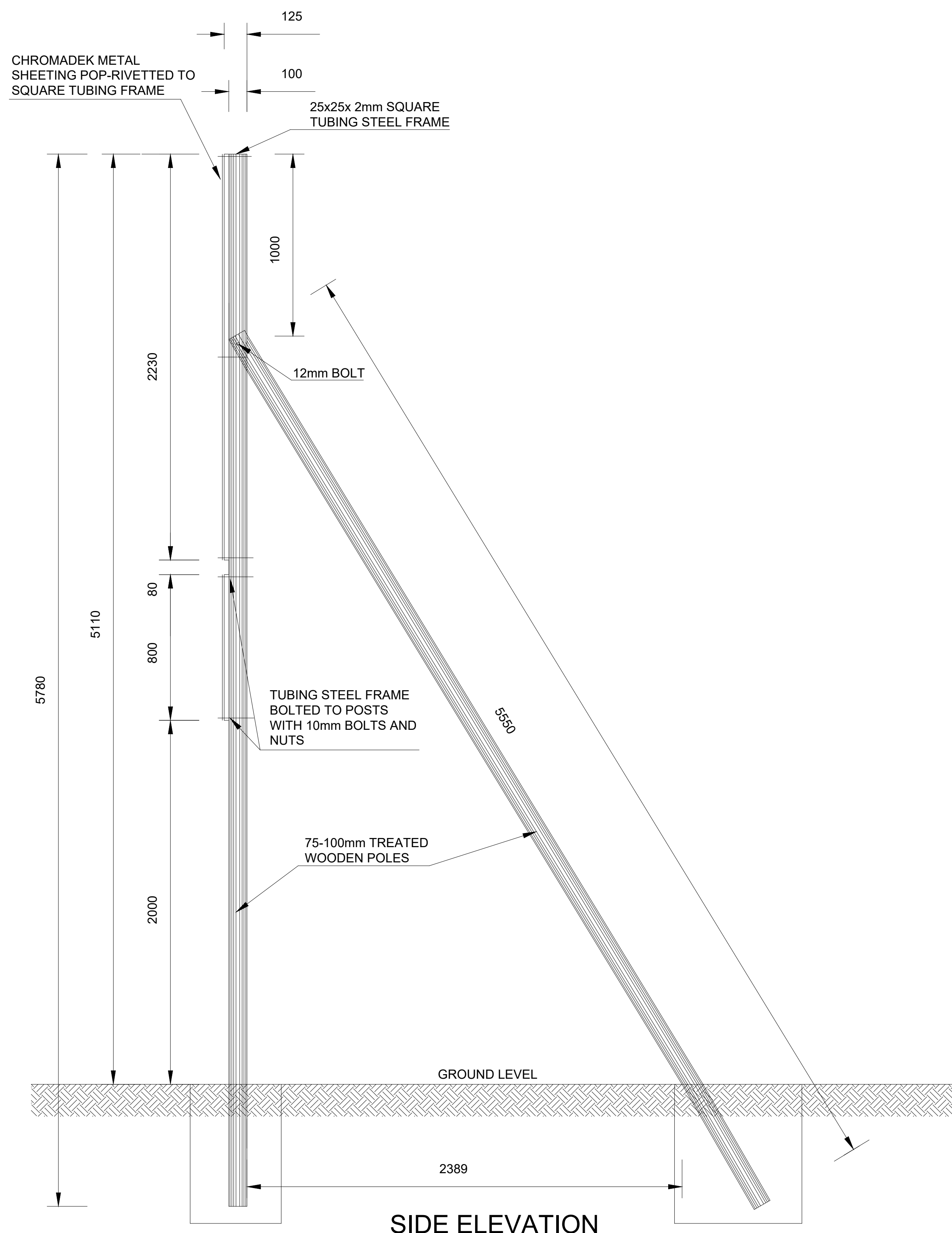

SIDE ELEVATION

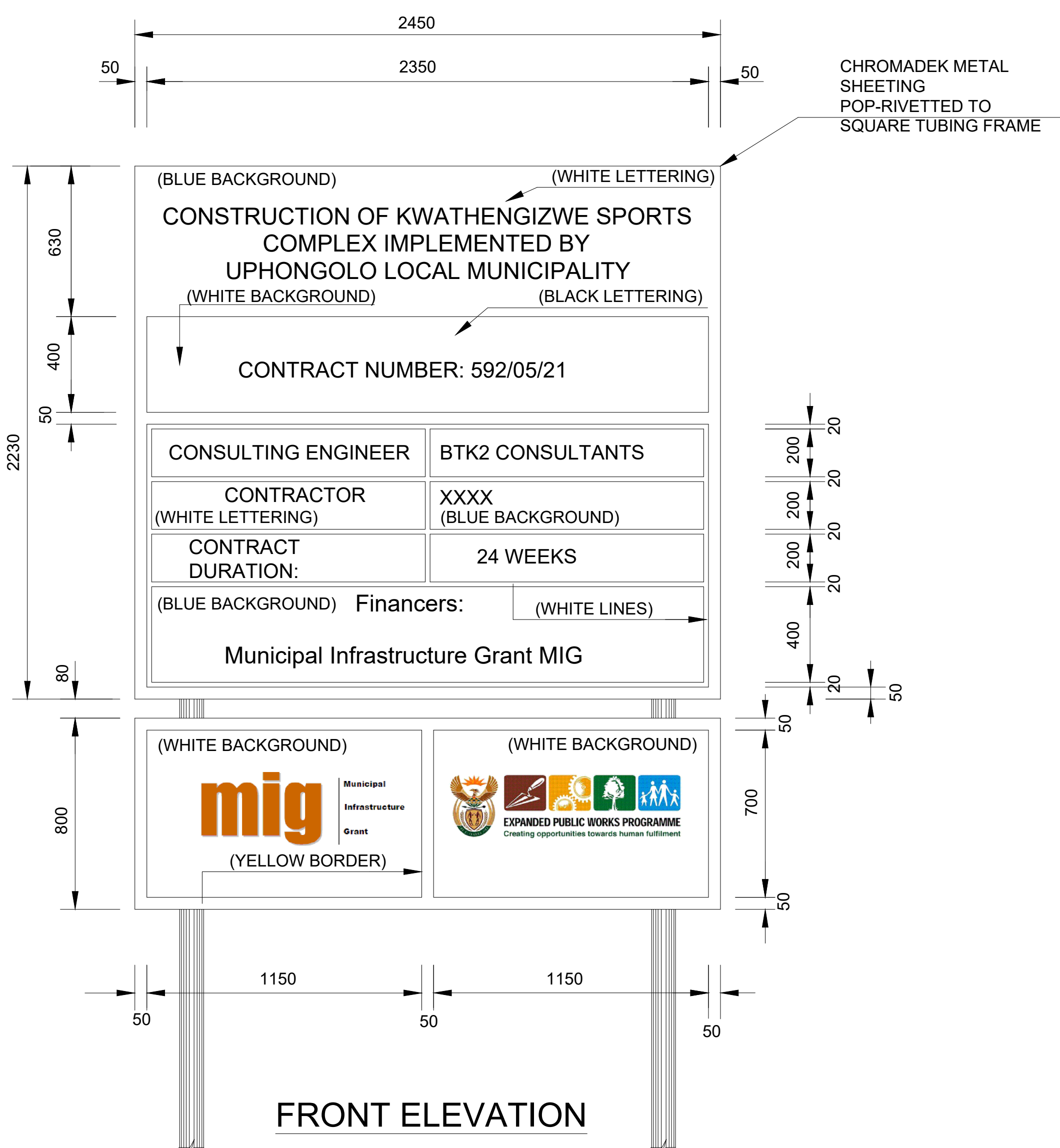

FRONT ELEVATION

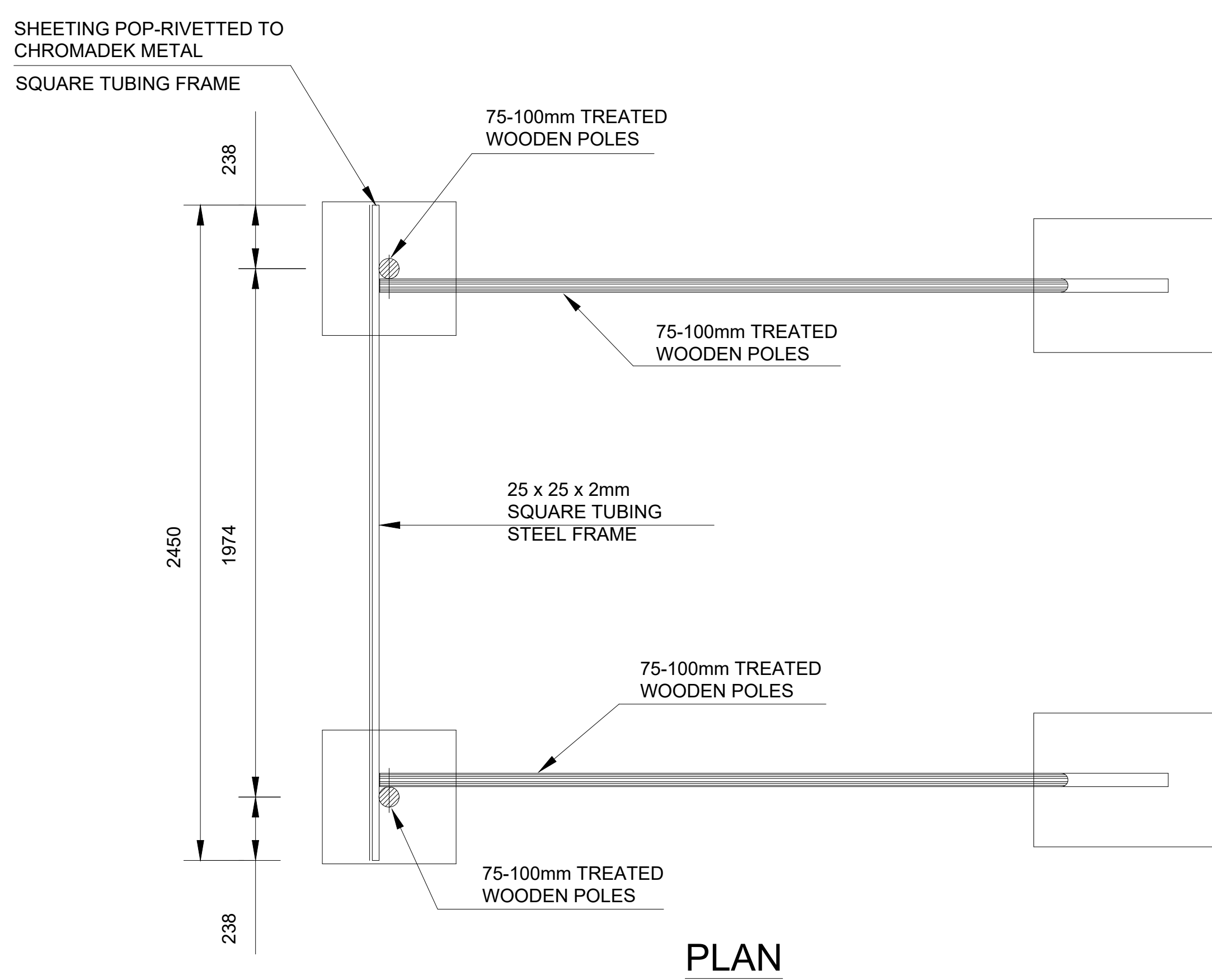

PLAN

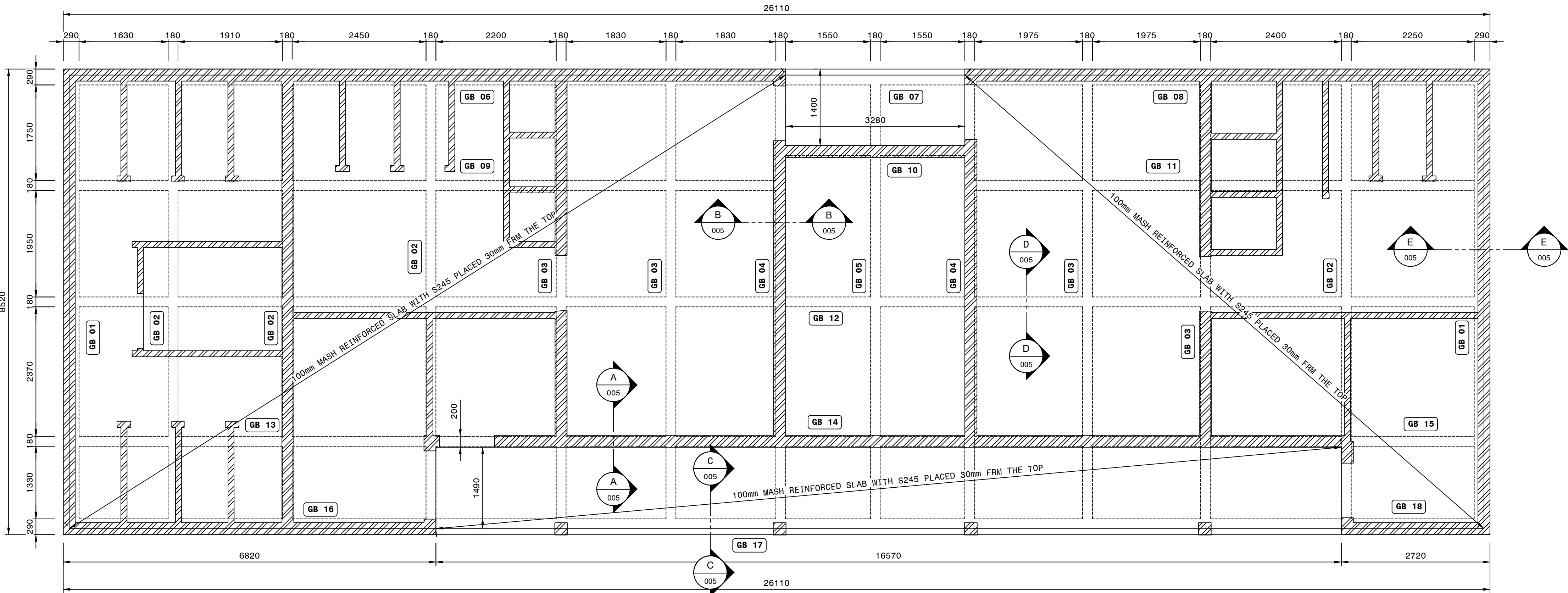

RAFT FOUNDATION LAYOUT

SCALE 1=50

BEAM ID	SIZE	LENGTH(MM)	TOTAL No.
GB 01	180x650	8520	2
GB 02	180x650	8520	4
GB 03	180x650	8520	4
GB 04	180x650/735	8520	2
GB 05	180x650	8520	1
GB 06	180x650	13200	1
GB 07	180x650	3280	1
GB 08	180x650	9610	1
GB 09	180x650	13200	1
GB 10	180x735	3210	1
GB 11	180x650	9610	1
GB 12	180x650	26110	1
GB 13	180x650	6820	1
GB 14	180x735	16570	1
GB 15	180x650	2720	1
GB 16	180x650	6820	1
GB 17	180x650	16570	1
GB 18	180x650	2720	1

NOTE:

1. ALL DIMENSIONS TO BE CHECKED AND VERIFIED ON SITE.
2. POSITION OF ALL NEW STRUCTURES TO BE CONFIRMED OR DETERMINED ON SITE.
3. CONTRACTOR TO ACCORDINGLY REINSTATE ALL AREAS AFFECTED BY CONSTRUCTION AND INSTALLATION OF NEW WORKS.

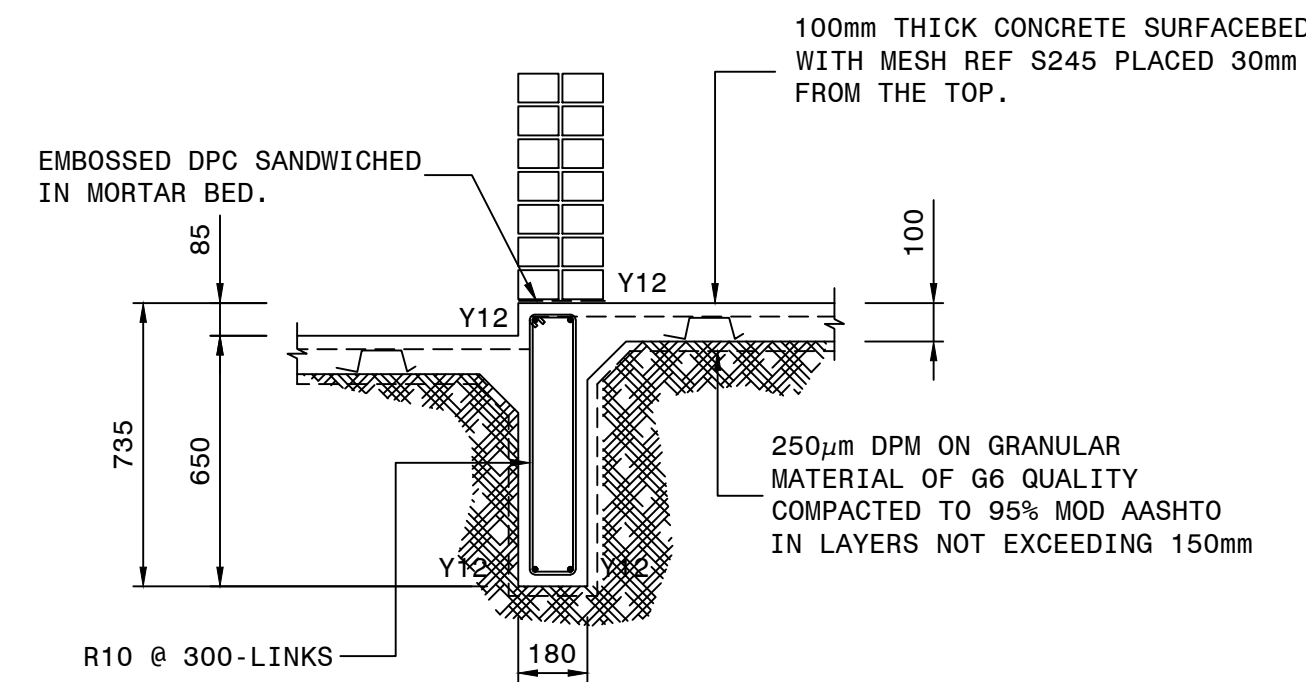

SECTION 'A-A'

SCALE 1=20

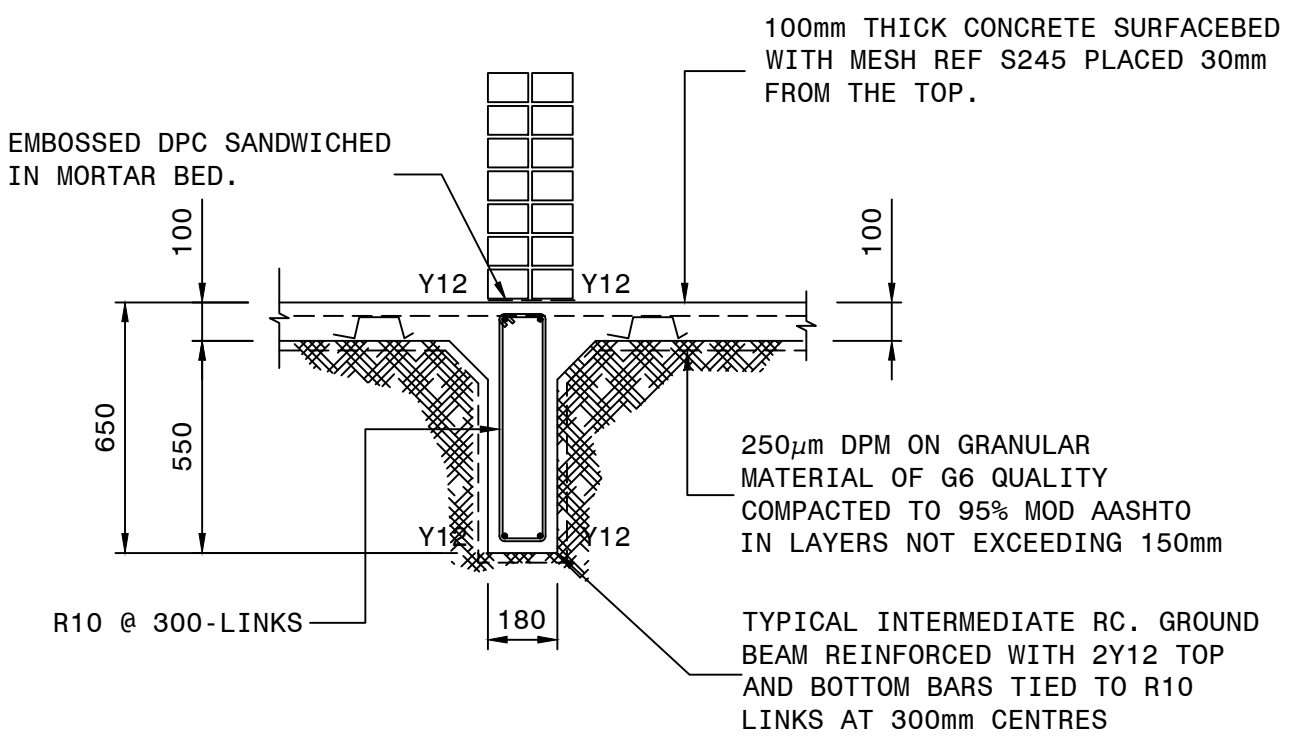

SECTION 'B-B'

SCALE 1=20

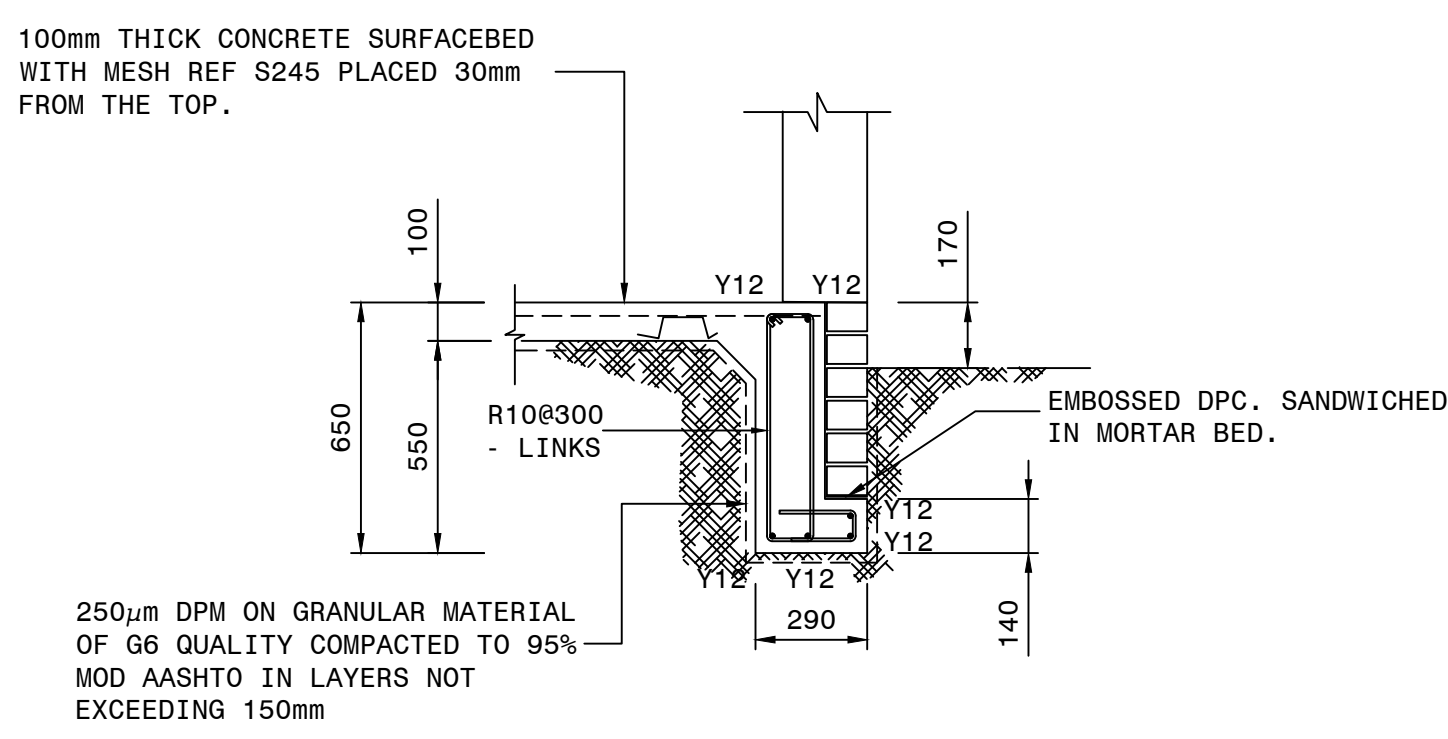

SECTION 'C-C'

SCALE 1=20

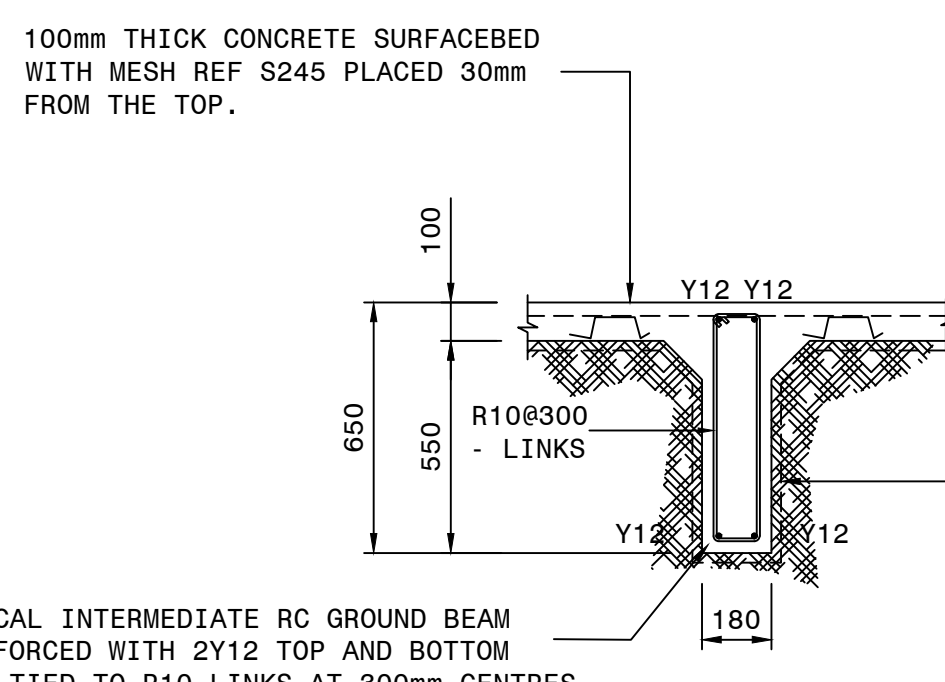

SECTION 'D-D'

SCALE 1=20

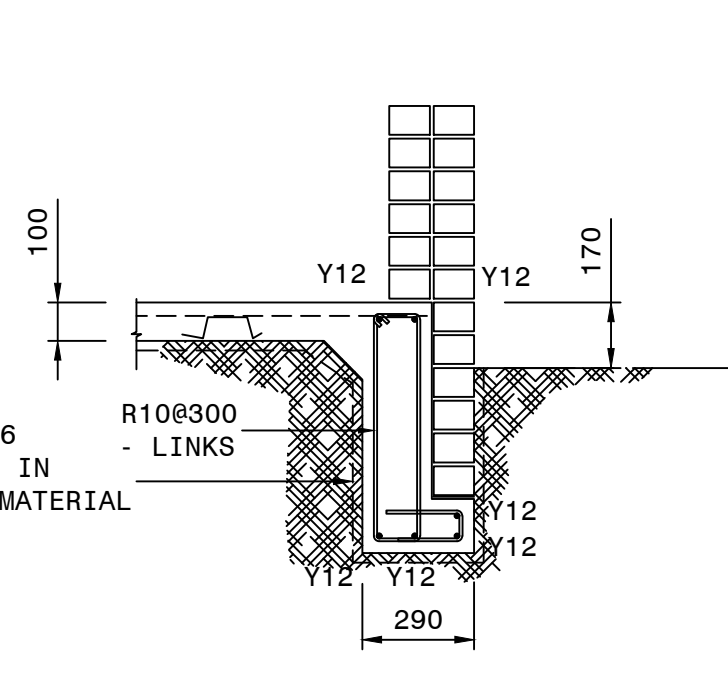

SECTION 'E-E'

SCALE 1=20

MEMBER	No OF	BARS PER MEME	DIA	LENGTH	TOTAL NUM-BER	MARK	S C	BENDING				
								A	B	C	D	E/r
GB 01 180x650	2	29	R10	1900	55	01	75	260	100			
	2	8	Y12	2000	16	02	37	150	1860		230	590
	2	4	Y12	6000	8	03	20	6000				
GB 02 180x650	4	29	R10	1550	116	04	60	590	120			
	2	8	Y12	2000	16	02	37	150	1860			
	2	4	Y12	6000	8	03	20	6000				
GB 03 180x650	4	29	R10	1550	116	04	60	590	120			
	4	4	Y12	6150	16	05	37	150	6000			
	4	4	Y12	1800	16	06	37	150	1390			
	4	4	Y12	1650	16	07	37	150	1500			
	4	4	Y12	1000	16	08	37	150	1880			
GB 04 180x650	2	24	R10	1550	48	04	60	590	120			
	2	4	Y12	6150	8	05	37	150	6000			
	2	4	Y12	1500	8	06	37	150	1390			
	2	4	Y12	1650	8	07	37	150	1500			
	2	4	Y12	1000	8	08	37	150	1880			
GB 05 180x650	2	6	R10	1750	12	09	60	670	120			
	2	2	Y12	1450	4	10	37	130	1340			
	1	29	R10	1550	29	04	60	590	120			
GB 06 180x650	1	4	Y12	1500	4	06	37	150	1390			
	1	8	Y12	1650	8	07	37	150	1500			
	1	8	Y12	1000	8	08	37	150	1880			
	1	4	Y12	4900	4	11	37	150	4780			
GB 07 180x650	1	45	R10	1900	45	01	75	260	100		230	590
	1	8	Y12	4350	8	12	37	150	4210			
	1	4	Y12	6000	4	13	20	6000				
GB 08 180x650	1	13	R10	1900	13	01	75	260	100		230	590
	1	4	Y12	3150	4	14	37	150	3000			
	1	4	Y12	1450	4	15	37	150	1340			
GB 09 180x650	1	33	R10	1900	33	01	75	260	100		230	590
	1	8	Y12	2550	8	16	37	150	2400			
	1	4	Y12	6000	4	17	20	6000				
GB 10 180x735	1	45	R10	1550	45	04	60	590	120			
	1	8	Y12	4350	8	12	37	150	4210			
	1	4	Y12	6000	4	13	20	6000				
GB 11 180x650	1	6	R10	1750	6	09	60	670	120			
	1	4	Y12	3150	4	14	37	150	3000			
	1	4	Y12	1450	4	15	37	150	1340			
GB 12 180x650	1	33	R10	1550	33	04	60	590	120			
	1	8	Y12	2550	8	16	37	150	2400			
	1	4	Y12	6000	4	17	20	6000				
R	8	10	12	16	20	25	32	40	TOT	Date	2020/03/05	
Y	564	624							564	Det. by		
TOT	564	624							624	Ref Dwg	ES1D 005	
									1188	Job No		
										Revision		
										Schedule No	01	

MEMBER	No OF	BARS PER MEME	DIA	LENGTH	TOTAL NUM-BER	MARK	S C	BENDING				
								A	B	C	D	E/r
GB 12 180x650	1	45	R10	1550	45	04	60	590	120			
	1	8	Y12	4800	8	18	37	150	4650			
	1	12	Y12	6600	12	19	20	6000				
GB 13 180x650	1	24	R10	1550	24	04	60	590	120			
	1	8	Y12	1250	8	20	37	150	1110			
	1	4	Y12	6000	4	21	20	6000				
GB 14 180x735	1	57	R10	1750	57	09	60	670	120			
	1	4	Y12	6000	4	21	20	6000				
	1	8	Y12	6250	8	22	37	150	6100			
GB 15 180x650	1	10	R10	1550	10	04	60	590	120			
	1	4	Y12	2150	4	23	37	150	2000			
	1	4	Y12	1450	4	24	37	150	1320			
GB 16 180x650	1	24	R10	1900	24	01	75	260	100		230	590
	1	8	Y12	1250	8	20	37	150	1110			
	1	4	Y12	6000	4	21	20	6000				
GB 17 180x735	1	57	R10	1900	57	01	75	260	100		230	590
	1	4	Y12	6000	4	21	20	6000				
	1	8	Y12	6250	8	22	37	150	6100			
GB 18 180x650	1	10	R10	1900	10	01	75	260	100		230	590
	1	4	Y12	2150	4	23	37	150	2000			
	1	4	Y12	1450	4	24	37	150	1320			
R	8	10	12	16	20	25	32	40	TOT	Date	2020/03/05	
Y	244	322							244	Det. by		
TOT	244	322							322	Ref Dwg	ES1D 005	
									565	Job No		
										Revision		
										Schedule No	02	

NOTES

1. GENERAL

- 1.1 All building work must comply with Local and National Building Regulations.
- 1.2 This drawing must be read in conjunction with the architect's and all relevant specialists' and engineer's drawings verified against the same.
- 1.3 All brickwork to be set out according to architect's drawing.
- 1.4 All work to be performed in accordance with the latest version of SANS 10100 part 2, 12006, SANS 12006 & SANS 12006P as applicable.
- 1.5 All notes are general unless otherwise shown on the drawing.
- 1.6 No structural alterations may be done without the approval of the engineer.
- 1.7 No scaling of dimensions are permitted.
- 1.8 All dimensions to be checked on site.
- 1.9 Contractor to keep a full set of drawings on site.
- 1.10 Contractor is responsible for correct setting out of building on site with particular reference to boundary and building lines.

2. CONCRETE (at 28 days)

- 2.1 Brick Veneer Bases 30 MPa/19mm
- 2.2 Beams and Suspended Slabs 30MPa/19mm
- 2.3 Surface Beds. 25 MPa/19mm
- 2.4 Blinding. 10 MPa/19mm
- 2.5 All exposed concrete to have smooth off shutter finish in accordance with SANS 12006.

3. COVER

- 3.1 Beams 35mm
- 3.2 Slabs 30mm
- 3.3 CONSTRUCTION
- 3.4 No concrete may be cast until the reinforcement has been completed and approved by the Engineer.
- 3.5 Stripping times of formwork and props to be in accordance with SANS 12006 clause 5.2.5.
- 3.6 Concrete to be adequately compacted by means of a vibrator.
- 3.7 The contractor must use approved cover blocks of adequate strength in order to withstand working conditions. Minimum strength equal to concrete strength specified.
- 3.8 Construction joints to be approved by engineer.
- 3.9 Exposed concrete surfaces to be continually cured for a minimum of 10 days.

5. FOUNDATIONS

- 5.1 Founding conditions to be inspected and approved by the engineer prior to casting concrete.
- 5.2 Design bearing pressure = 150kPa.
- 5.3 Foundation levels indicated are approximate and will be confirmed on site by the Engineer.
- 5.4 CONCRETE CUBE TEST
- 5.5 Concrete cube tests to be done in accordance with SANS 12006 clause 7: Tests.

7. BRICKWORK

- 7.1 All load bearing brickwork must be in accordance with SANS 10164.
- 7.2 All load bearing brickwork to be NF3 20MPa bricks.
- 7.3 All non-loadbearing brickwork to be 7MPa bricks.
- 7.4 Class II mortar to be used in accordance with Table 1 SANS 10164 Part 1 - 1980.
- 7.5 Wall ties in cavity walls and brick retaining walls shall be of the plastic type 'Post-Tite'.
- 7.6 SANS 10164 Part 1 - 1980 or similar approved placed every 4th layer vertically and at 500mm c/c horizontally.
- 7.7 All brickwork shall be tied to concrete with galvanized hoop iron every 4th course.



BTX2 CONSULTANTS
Sedatone Office Park,
No 24 Sedatone Road, AMANZIMTOTI 4126
T: 083 278 4086
E: untando@gmail.com

PLAN DESCRIPTION	DWG. NO.	SHEET NO.
CONTINUED FROM		
CONTINUED ON		
CROSS SECTIONS		
TYPICAL CROSS SECTION		
SURVEY LAYOUT		

REDUCED PLAN USE SCALE BELOW

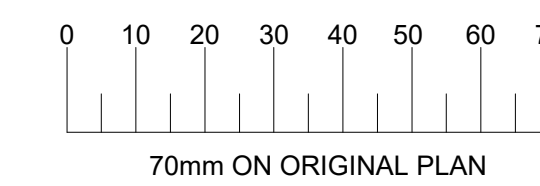

UPHONGOLO LOCAL MUNICIPALITY
61 Martins Street
P.O. Box 191
PONGOLA 3170
T: 034 413 1706
E: thokoanini@uphongo.co.za

GENERAL NOTES:

1. CONTRACTOR TO VERIFY ALL LEVELS, HEIGHTS & DIMENSIONS ON SITE PRIOR TO COMMENCEMENT OF WORK.
2. LARGE SCALE DRAWINGS TAKES PREFERENCE OVER SMALL SCALE DRAWINGS.
3. DO NOT SCALE DRAWINGS, DIMENSIONS ONLY TO BE USED.
4. DAMAGE TO UNKNOWN SERVICES - THE CONTRACTOR'S LIABILITY WHEN HE ENCOUNTERS UNKNOWN SERVICES IS TO NOTIFY.
5. IF ANY PARTICULARS OR THE MEANING OF THE DESCRIPTION OF ANY ITEM IS NOT CLEAR OR IS AMBIGUOUS, INDISTINCT OR CAUSES CONFUSION AS TO ITS MEANING OR IF ANY OBVIOUS ERROR OCCURS ON THE DRAWINGS, THE CONTRACTOR MUST INFORM THE ENGINEER IMMEDIATELY. IN ORDER TO HAVE THE ERROR CORRECTED OR EXPLAINED, AS THE CASE MAY BE.
6. ALL WORK TO BE EXECUTED IN ACCORDANCE WITH THE NATIONAL BUILDING REGULATIONS AND THE LOCAL BY-LAWS & REGULATIONS. FOLLOWING TRADES TO BE EXECUTED IN ACCORDANCE WITH SABS CODES AND STANDARDS INDICATED:
A. STRUCTURAL CONCRETE: SABS-0100
B. FOUNDATIONS: SABS-0162
C. STRUCTURAL STEEL: SABS - 0162
D. STRUCTURAL TIMBER: SABS - 0163

01	05/12/2021	For tender purposes only
Revision	Date	Description
		NOTE: No construction work to commence until land and servitude acquisitions have been completed.
		Acquisitions completed
		DATE: _____ ENGINEER: _____
		UNDERGROUND SERVICES CHECKED
		SERVICE DATE SIGNATURE
		S.W.DRAINS
		SEWERS
		WATER MAINS
		G.P.O.CABLES
		ELECTRIC CABLES
		S.A.R.CABLES
		E.S.C. CABLES
		OIL PIPE LINE
		NOTE: Only underground services affected by new construction work are shown. Care must be taken during excavations for road foundations, trenches etc. to avoid damage to underground services such as sewers, drains, cables, water mains and connections. Wherever possible these must be located before work proceeds.
		592/05/21
		Contract No.
		Project Title

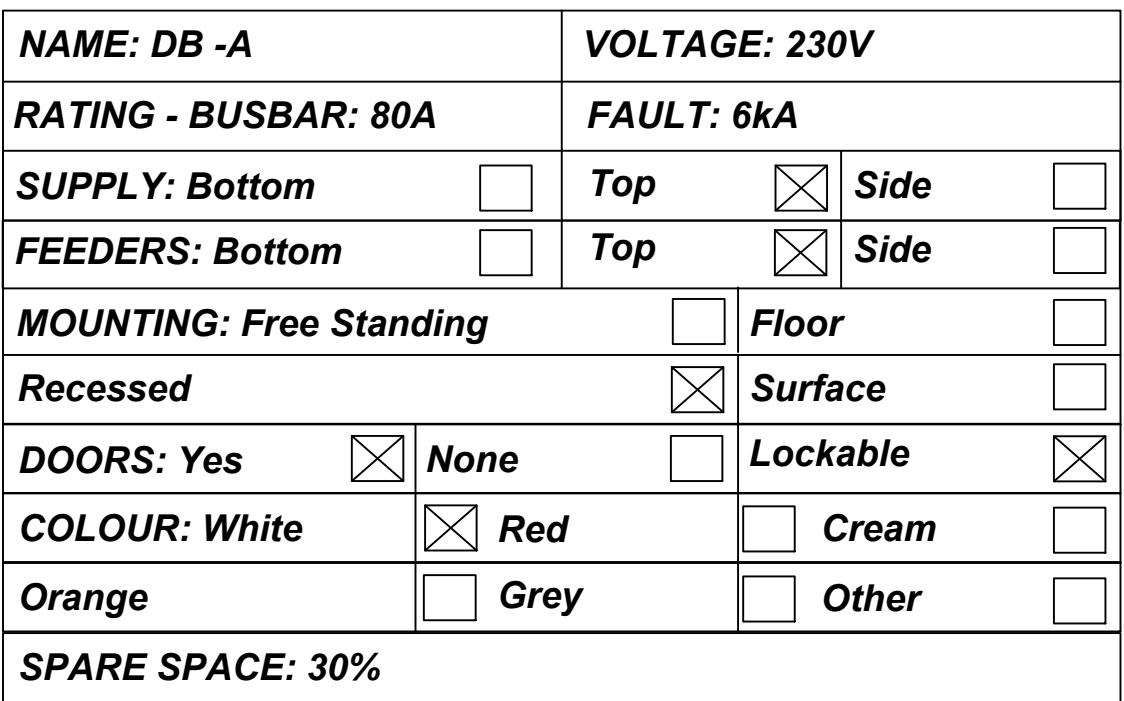

GENERAL NOTES:

- A. CONTRACTOR TO VERIFY ALL LEVELS, HEIGHTS & DIMENSIONS ON SITE PRIOR TO COMMENCEMENT OF WORK
- B. JAWNS TO BE DRAWN TO THE PREFERENCE OVER SMALL SCALE DRAWINGS
- C. DIMENSIONS TO DRAWINGS, DIMENSIONS ONLY TO BE USED.
- D. NOTICE TO UNKNOWN SERVICES - THE CONTRACTOR'S LIABILITY WHEN HE ENCOUNTERS UNKNOWN SERVICES IS TO NOTIFY THE ENGINEER IMMEDIATELY
- E. IF ANY PARTICULARS OR THE MEANING OF THE DESCRIPTION OF ANY ITEM IS NOT CLEAR OR IS IN DOUBT, THE CONTRACTOR SHALL NOTIFY THE ENGINEER AS TO ITS MEANING OR IF ANY OBVIOUS ERROR OCCURS ON THE DRAWINGS, THE CONTRACTOR MAY NOTIFY THE ENGINEER IMMEDIATELY. IN ORDER TO HAVE THE CONTRACTOR'S LIABILITY EXPOSED AT THE CASE MAY BE.
- F. ALL WORK TO BE EXECUTED IN ACCORDANCE WITH THE BUILDING REGULATIONS AND THE LOCAL BY-LAWS & REGULATIONS.
- G. THE CONTRACTOR SHALL COMPLY WITH ALL STANDARDS WITH SABS CODES AND STANDARDS INDICATED.
- H. CONCRETE TO BE SABS-0100
- I. STRUCTURAL STEEL SABS-0162
- J. TIMBER SABS-0163

UPH_008

