

FOUNDATION PLAN LAYOUT  
SCALE 1:250

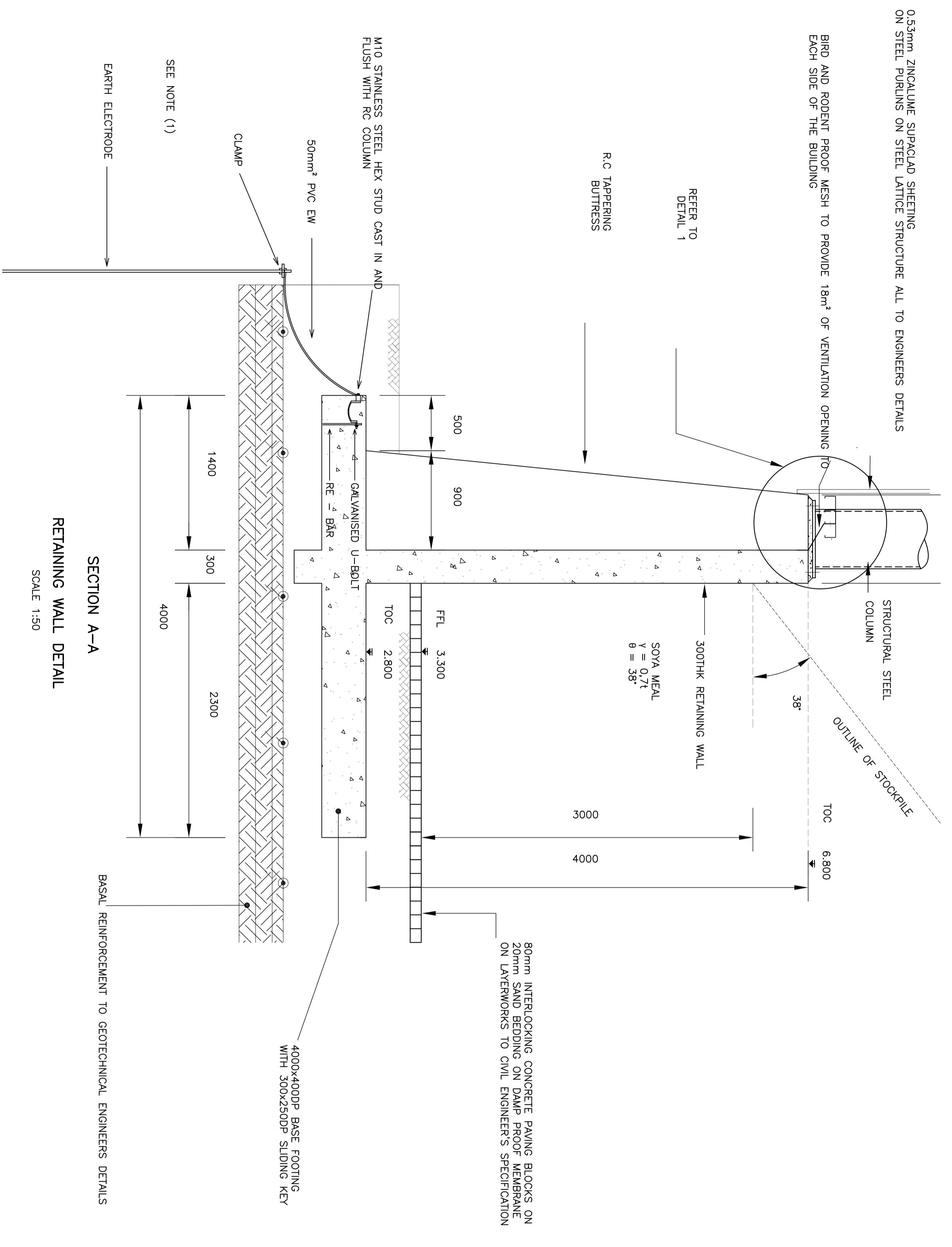

SECTION A-A  
RETAINING WALL DETAIL  
SCALE 1:50

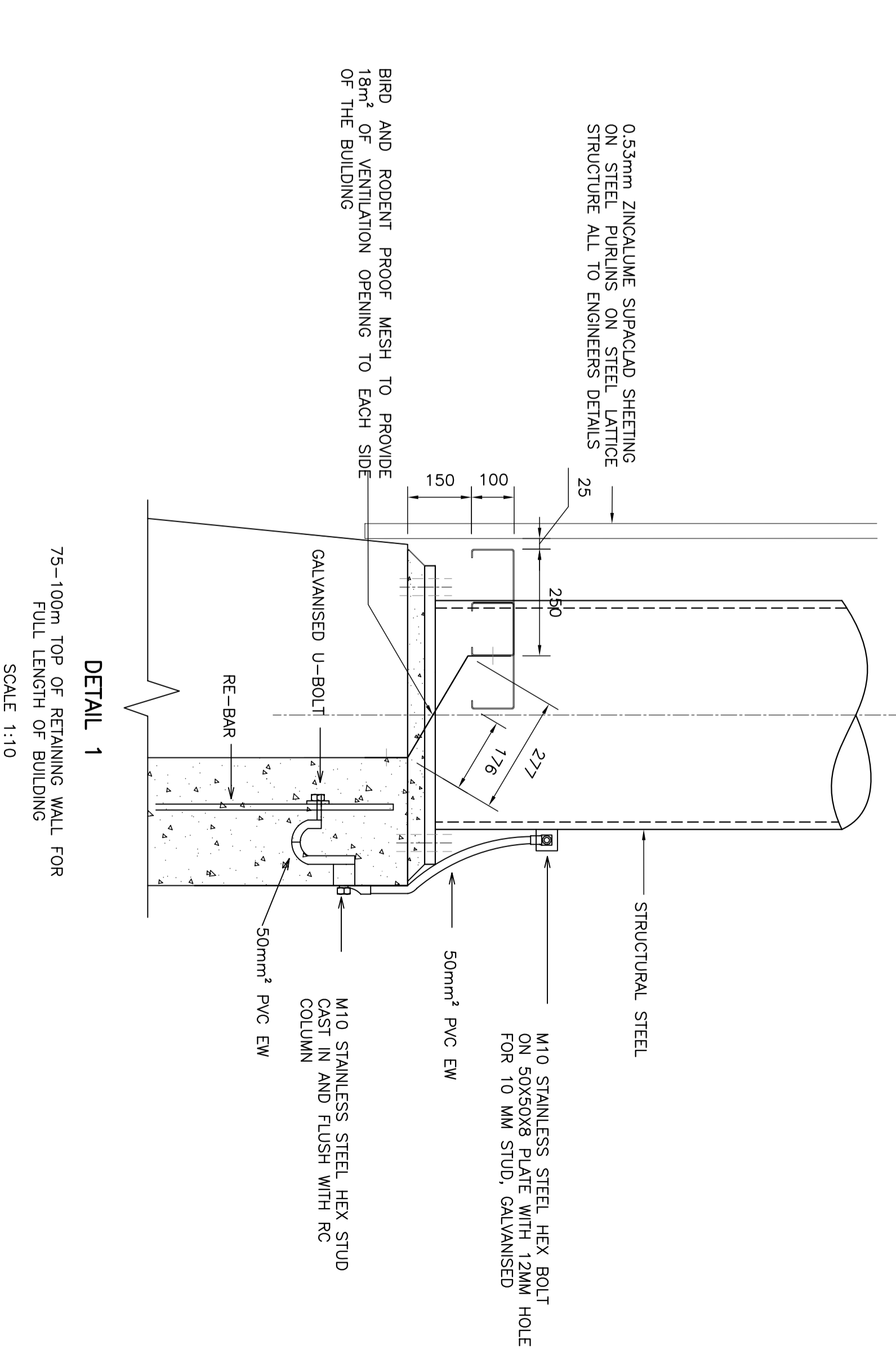

DETAIL 1  
75-100mm TOP OF RETAINING WALL FOR FULL LENGTH OF BUILDING  
SCALE 1:10

DISCLAIMER: THESE DRAWINGS AND PROJECT SPECIFICATIONS ARE ISSUED BY PDNA FOR THE EXCLUSIVE USE OF THE CLIENT. THE USER SHALL ACCEPT FULL RESPONSIBILITY FOR ANY CONSEQUENCES ARISING FROM THE USE OF THESE DRAWINGS AND PROJECT SPECIFICATIONS. THE USER SHALL REMAIN THE COPYRIGHT HOLDER AGAINST ALL LIABILITIES, CLAIMS, DAMAGES, LOSSES, FINES AND/OR PENALTIES INCURRED AS A RESULT OF THEIR RELIANCE ON THESE DRAWINGS AND PROJECT SPECIFICATIONS.

REV	DATE	BY	CHKD	DESCRIPTION
AS BUILT				
01	03/04/09	RR	NTT	FOR CONSTRUCTION
02	03/04/09	RR	NTT	FOR CONSTRUCTION

PDNA  
PD NAWAZ & ASSOCIATES  
1, 060374 SC 000 T REV A

TRANSNEF  
port terminals

PROJECT	SCALE	SIGNATURE	DATE
PROPOSED NEW BULK STORAGE WAREHOUSE FOR AIRPORT, MAYDON WHARF PORT OF DURBAN	ORIGINAL DESIGNED	R.R.	18/02/2008
	DRAWN	R.R.	18/02/2008
	CHECKED	N.T.T.	18/02/2008
	APPROVED FOR CONSTRUCTION		
	REGISTERED NAME		
	REGISTRATION NO.		
	REGISTRATION DATE		
	REGISTRATION AUTHORITY		

COPYRIGHT RESERVED