

LAND INCLUDING IMPROVEMENTS

Description	Asset No.	Area
PORTION OF ERF 20436, EAST LONDON	EBX0251L	± 233 m²
PORTION OF ERF 20448, EAST LONDON	EBX0252L	± 569 m²
PORTION OF ERF 26760, EAST LONDON	EBX2016L	± 448 m²
TOTAL AREA		± 1 250 m

LIST OF IMPROVEMENTS

Description	Asset No.	Area



Plan prepared for:  
**TRANSNET NATIONAL PORTS AUTHORITY**  
**REAL ESTATE**  
Port Control Building  
Ganteaume Crescent  
Port of East London  
EAST LONDON  
Contact person: Ms Zinhle Small  
Tel: (041) 507 1872

LEGEND:

Ownership

Buildings

Structures

Land

TRANSNET NATIONAL PORTS AUTHORITY

TRANSNET PROPERTY

TRANSNET CADASTRAL BOUNDARY

AREA AVAILABLE FOR LEASING



AERIAL PHOTO NOT TO SCALE

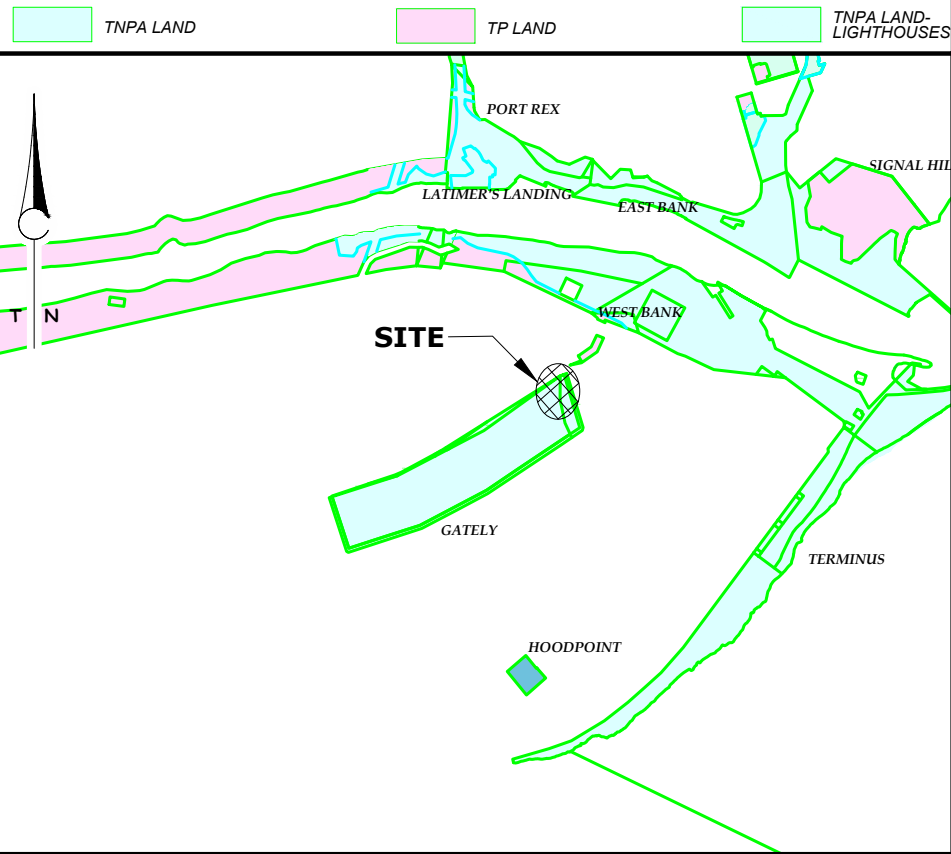

LOCALITY PLAN NOT TO SCALE

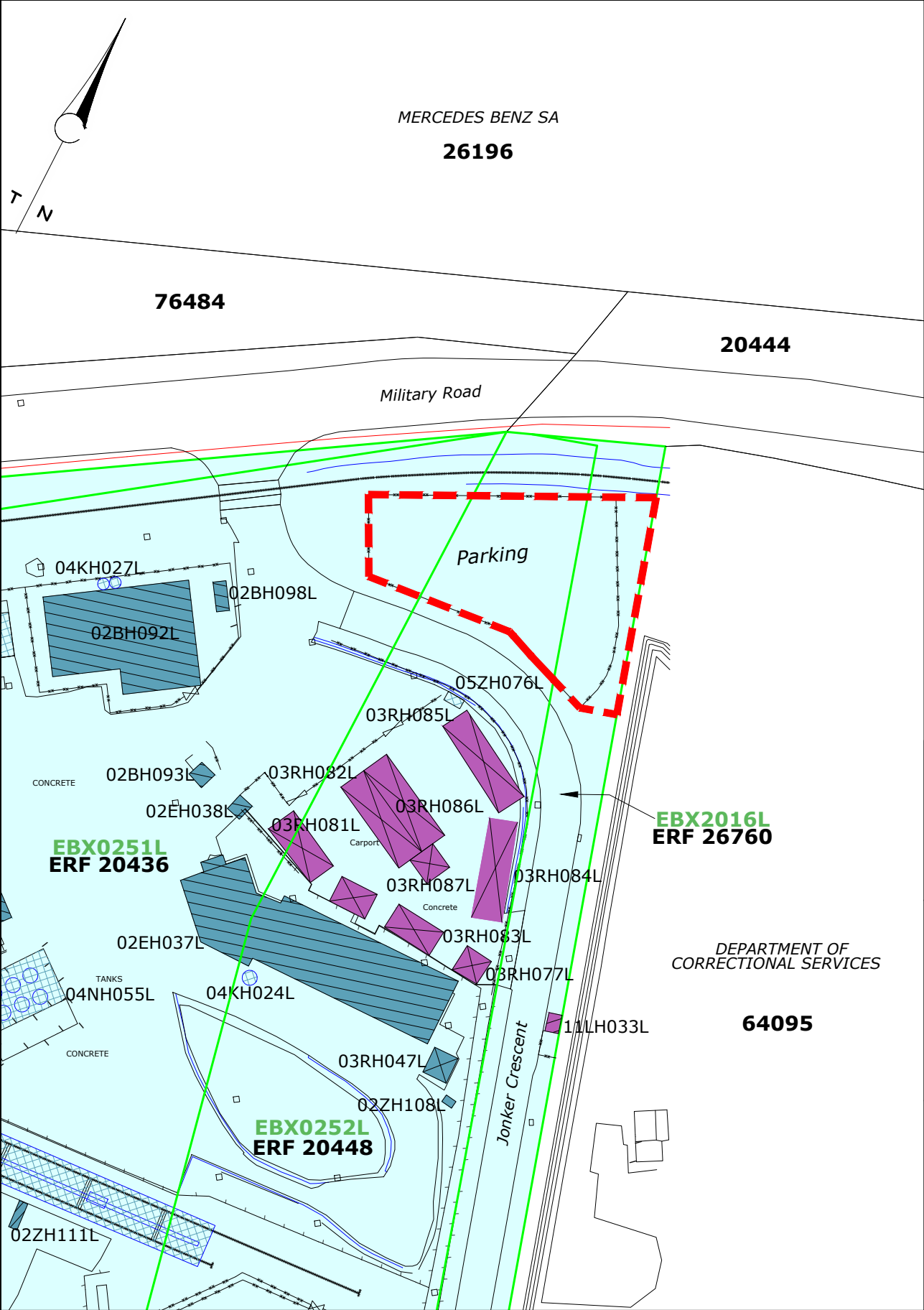



Plan prepared by:  
**TRANSNET PROPERTY, GEO-SPATIAL: EASTERN CAPE REGION**  
Room 502, 5th Floor,  
Transnet Building  
Gqeberha  
6000  
PO Box 1030  
Gqeberha  
6000  
Tel: (041) 507-1331  
Fax: (041) 507-2884

GATELY

AREA AVAILABLE FOR LEASING

Compiled:	Checked:	Client File Ref.:
W.CERFONTEYN	M.MOODALEY	GS File Ref.: LSEL/EB1/1225/0
Date:	2025-06-10	Original Ref.:
		SCALE : 1 / 1 000
COPYRIGHT AND RIGHT OF REPRODUCTION OF THIS DRAWING OR PART THEREOF IS RESERVED BY TRANSNET PROPERTY.		
Rev. # #-:		
PLAN No.		GTL_0058m