

- 1.) C.I. STEP IRONS, 300mm c/c STAGGERED IN BOTH DIRECTIONS TO BE INSTALLED IN MH'S EXCEEDING 1.5m IN DEPTH, AS SHOWN.
- 2.) CONCRETE STRENGTH:
 - i) TOP AND COVER SLAB 25MPa/19mm
 - ii) BASE SLAB 20MPa/19mm
 - iii) BENCHING 15MPa
- 3.) ALL BRICKWORK TO BE CONSTRUCTED USING CLAY BRICKS IN ENGLISH BOND METHOD WITH CLASS 1 MORTAR TO SABS 0164.
- 4.) FOR LAYOUT AND SETTING OUT CO-ORDINATES, REFER TO DRAWING.
- 5.) CLEAN SURFACE AND APPLY UNIVERSAL UNDER-COAT (PLASCON UC1) TO 25um DRIED FINISHED THICKNESS. FINAL COAT ENAMEL TO 35um DRIED FINISHED THICKNESS TO ALL ANGLE IRON SUPPORT STRUCTURE. (COLOUR TO ARCHITECT'S REQUIREMENTS).

MANHOLE WALL THICKNESS TABLE		
PIPE Ø	DEPTH 2500max	DEPTH 3000max
<900	220	220
1050-1350	220	330
1500-1800	330	330 (CAVITY) (SEE DETAIL A)

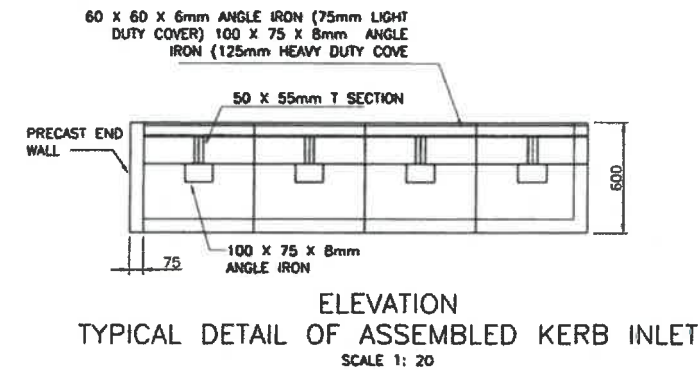

GENERAL NOTES:

1. ALL WORK IS TO BE DEGREE OF ACCURACY II UNLESS OTHERWISE SHOWN.
2. ALL TESTING IS TO BE IN ACCORDANCE WITH CLAUSE 7 OF THE RELEVANT CODE UNLESS REPLACED BY A MUNICIPAL TESTING REQUIREMENT.
3. THE CONTRACTOR IS TO PROTECT EXISTING BOUNDARY STRUCTURES AND BURIED SERVICES.
4. INSPECTIONS SUBJECT TO THE AVAILABILITY OF MUNICIPAL REPRESENTATIVES.
5. TWO BENCHMARKS ARE TO BE ESTABLISHED BY AN INDEPENDENT ENGINEERING SURVEYOR AND THE POSITIONS THEREOF FORWARDED TO LITE CONSULTING ENGINEERS.
6. TIE-IN LEVELS ARE TO BE CONFIRMED PRIOR TO CONSTRUCTION.

Rev. No.	Description	By	Check'd	Date
1	ISSUED FOR RE-DESIGN	AM	BY	28-09-2017
2	REVISED FOR RE-DESIGN	BY	CH'd	28-09-2017

**FREE STATE PROVINCIAL GOVERNMENT
DEPARTMENT OF HUMAN SETTLEMENTS**

Physical Address: LEBOWENG BUILDING, ST ANDREW STREET, BLOEMFONTEIN
Postal Address: PO BOX 221, BLOEMFONTEIN 9600

LTE

APPOINTED ORGANISATION: LITE CONSULTING
PERFORMING ORGANISATION: LITE CIVIL & STRUCTURAL

Physical Address: LITE House, Building 1 Office Park (Belvedere Plaza), 5 Tjiba Road, Sunning Hill 2157
Postal Address: Private Suite No. 326, Private Bag X26, Sunninghill 2157

Tel: +27 (0) 11 061 5700
Fax: +27 (0) 11 061 5773

APPROVED BY: [Signature]

PROF. REGISTRATION: [Number]

DATE: [Date]

Project Name: **G-HOSTEL HOUSING DEVELOPMENT**

Drawing Title: **STORMWATER KERB INLET DETAIL**

APPROVED: J. MHLANGA
ENGINEER: J. MHLANGA
CHECKED: B. MOKOBI
DRAWN: M. MOKOBI

ALL RIGHTS ON THIS DRAWING REST AT ANY TIME WITH LITE CONSULTING, WITHOUT WHOSE WRITTEN CONSENT IT MAY NOT BE COPIED, REPRODUCED, COMMUNICATED OR RENDERED ACCESSIBLE TO THIRD PARTIES.

Client Drawing No.: **E405-SW-DT-01**

Rev: **3**