



AgriCentre Building
Cnr. Dr. James Moroka
& Stadium Rd
Private Bag X2039,
Mmabatho 273

CHIEF DIRECTORATE: FINANCIAL MANAGEMENT
DIRECTORATE: SUPPLY CHAIN MANAGEMENT

Tel: +27 (18) 389 5151 / 5297
Fax: +27(18) 389-5994
E-mail: MMatsheka@nwpg.gov.za

INVITATION TO BID

13 DARD 04/2022: CONSTRUCTION OF A 20 SOW UNIT HOUSE AT INYAMA YETHU PTY (LTD) IN MADIBENG MUNICIPALITY, BOJANALA PLATINUM DISTRICT

You are invited to submit a bid for the service as indicated in the attached bid documents.

1. The conditions contained in the General Conditions of Contract (GCC), and the attached bid forms, as well as any other conditions accompanying this invitation, are applicable.
2. The work procedure, the bidder proposes to follow in order to obtain the required result must be clearly outlined and its terms may not conflict with those contained in the General Conditions of Contract (GCC).
3. Kindly receive attached the following bid documents:
 - 3.1. SBD 1- Invitation to Bid Form
 - 3.2. SBD 4- Declaration of Interest
 - 3.3. SBD 6.1—Preferential Points
 - 3.4. SBD 6.2 - Local production and content
 - 3.5. Terms of reference
 - 3.6. General conditions of contract (GCC)
4. All the documents accompanying this invitation to bid must be completed in detail, be sealed in an envelope and be deposited in the bid box before the closing date and time as follows:

Location of bid box: Department of Agriculture and Rural Development AgriCentre Building

Physical address: Cnr. Dr James Moroka Drive and Stadium Road, Mmabatho, 2735

Identification details: Construction of a 20 Sow Unit House at Inyama Yethu Pty (Ltd) in Madibeng Municipality, Bojanala Platinum District

Closing date and time:

The closing time for submission of Bid Offers is **25 August 2022 at 11H00**

Compulsory Briefing Session:

The Briefing session for this bid will be held on Friday, 05 August 2022 at 11H00 Site situated at: Farm Elba 223 Kleinfontein, Brits,

Co-ordinates: S: 25°26'52.4" E: 27°46'38.4"

5. No Telephonic, telegraphic, telex, facsimile, electronic or e-mailed bids will be considered.

6. The Department of Agriculture and Rural Development reserves the right to accept any bid in whole or in part and does not bind itself to accept the lowest or any bid.

7. For more information please contact the following:

Department : Department of Agriculture and Rural Development

Contact Person : Mr. L. Mothibi - 018 389 5053: Email: smothibi@nwpg.gov.za

Technical Person: Ms. K. Madira – 068 063 2914: Email: kmadira@nwpg.gov.za

8. BID REQUIREMENTS

a) Late bids will not be considered. Please note that bids are late if they are received at the address given in the bid document after the bid closing date and time.

b) Bids will be valid for a period of 90 days.

c) All the relevant forms attached to this bid document must be completed and signed in ink where applicable by a duly authorised official.

9. REQUIRED DOCUMENTATION

The prospective bidders are required to provide the following documentation which will be used for the **phase 1 of the evaluation on Legal Requirements**:

9.1 SARS TAX Pin.

9.2 Certified copy of Broad-Based Black Economic Empowerment (BBBEE) Status Level Verification Certificates accredited by **SANAS**, DTI approved BBBEE Certificate or **Sworn Affidavit** signed by **Commissioner of Oath** or **SAPS**.

9.3 In case of Joint Venture, an original Valid Tax Clearance Certificate of all partners should be submitted and a consolidated Broad-Based Black Economic Empowerment (BBBEE) Status Level Certificates.

9.4 CIDB Grade Certificate 3CE or 3GB

9.5 A valid COIDA certificate/ Letter of good standing from the Department of Labour.

10. EVALUATION METHODOLOGY:

The Evaluation Processes will entail the following phases:

10.1 **Phase 1**- Evaluation on Legal requirements as stated in 9 above.

10.2 **Phase 2**- Technical/ functional Requirements and bidders who obtain 70% or more will proceed to the next evaluation phase.

10.3 **Phase 3- Price and BBBEE Level of Contribution Points**

Evaluation in terms of Preferential Procurement Policy Framework Act, i.e Evaluation on BBBEE points and Price

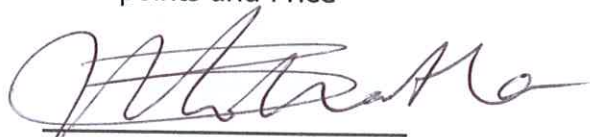

MR T Z MOKHATLA
HEAD OF DEPARTMENT

18/07/2022
DATE

TERMS OF REFERENCE
CONSTRUCTION OF A 20 SOW UNIT HOUSE AT INYAMA YETHU PTY (LTD) IN MADIBENG
MUNICIPALITY, BOJANALA PLATINUM DISTRICT

1. INTRODUCTION

- 1.1 The Agricultural Sector Strategy of 2001 refers to a number of reforms that have reshaped the sector over the last ten years and recommends strategic interventions for achieving the vision of a united and prosperous agricultural sector. The Comprehensive Agricultural Support Programme (CASP) is a vehicle in the realization of the set vision.
- 1.2 The program intends to bring about agrarian reform by supporting previously disadvantaged farmers to can farm at the commercial scale of farming. The mandate of the Branch of Agriculture is to ensure that there is agricultural growth and development in the province with the focus on improving agricultural productivity, technical empowerment, poverty alleviation, income generation, and job creation throughout the agricultural sector. Subsequently development programs which include amongst others CASP have been put in place as catalysts in the realization of the set objectives.
- 1.3 The Agricultural Producer Support and Development Chief Directorate is in the process of implementing this action oriented program (CASP) throughout the province. The program aims to provide agricultural support services to farmers through district services, to ensure that there is sustainable management of agricultural resources, sustainable agricultural development and meaningful contribution to the economy of the North West Province.
- 1.4 It is against this background that the Department of Agriculture and Rural Development (DARD), through its Agricultural Producer Support and Development (APSD) seeks to appoint competent and suitably qualified service provider to construct a 20 sow unit house for Inyama Yethu in Kleinfontein, Bojanala Platinum District.
- 1.5 Inyama Yethu Pty (ltd) project is currently operating at 15 sow units whereby it produces anything between 10 and 15 carcasses per month. The business seeks to expand its operations hence the construction of 20 sow unit house through the Comprehensive Agricultural Support Program.

2. REFERENCE TO NATIONAL TREASURY GUIDELINES

- 2.1 **Supply Chain Management "a guide to accounting officers/authorities February 2004" Clause 4.6** "To stimulate the promotion of BEE and development of HDIs and SMMEs, it is suggested that institutions should advertise in the local media for businesses to bid as

potential suppliers for goods and services to be obtained by means of quotations. The accounting officer/authority may further categorise the suppliers according to the goods/services they are capable of supplying. Quotations for the required goods/services should be obtained from all potential suppliers in the specific category or on a rotation basis from various suppliers”.

2.2 This Request For Bids (RFB) documents details the scope of work with regard to the construction of 20 sow unit house within Madibeng Municipality, Bojanala Platinum District. The RFB incorporates, as far as possible, the tasks and responsibilities of the potential service provider, required by the North West Department of Agriculture and Rural Development (DARD) in terms of constructing the sow unit house.

2.3 DARD has a detailed evaluation methodology premised on Treasury Regulation 16A3 promulgated under section 76 of the Public Finance Management Act 1999 (Act, No. 1 of 1999), the Preferential Procurement Policy Framework Act 2000 (Act No.5 of 2000) and the Broad-Based Black Economic Empowerment Act, 2003 (Act No. 53 of 2003).

3. PURPOSE OF THIS RFB

3.1 The purpose of this Request for Bids (RFB) is to invite interested and qualified service providers to submit competitive bids for construction of 20 sow unit house in Madibeng Municipality under Bojanala Platinum District.

4. APPOINTMENT TERMS

- 4.1. The successful service provider will be appointed once-off for the duration of the project as shall be outlined in the Service Level Agreement (SLA).
- 4.2. Once bids have been received, evaluated and adjudicated upon, only the successful bidder will be approached so as to enter into a formal agreement with the Department.
- 4.3. **It is a requirement from the successful bidder to Sub-Contract a minimum of twenty percent (20%) towards any of the following:**

Local Enterprises owned by Women, Youth or People with Disability. (This requirement will form part of the Site Service level agreement before Purchase Order is issued to the successful bidder)

5. LOCALITY

The site for the construction of 20 sow unit house is situated in Madibeng Municipality under Bojanala Platinum District. Location of the site is as follows:

5.1 Site situated at: **Farm Elba 223 Kleinfontein, Brits.**

5.2 Co-ordinates: **S: 25°26'52.4" E: 27°46'38.4"**

6. PROJECT DESCRIPTION

The project work execution is to be prepared and implemented in four phases as described below:

- i. **Regulatory** (obtaining of water, electricity authorisation etc)
- ii. **Site establishment;**
- iii. **Supply of all materials and equipment;**
- iv. **Construction of the facility.**
 1. Foundations and concrete work.
 2. Brick works.
 3. Water reticulation/Plumbing work.
 4. Electrical installation.

This contract covers **all 4 phases**.

7. SCOPE OF WORK

The following are the detailed scope of works for the project.

Details of these works are specified in **Project Technical Specifications**.

This contract entails the regulatory, site clearance, supply of all building materials and equipment, the construction and installation of facilities included under Section 18 (project technical specifications).

7.1 Preparatory

7.1.1 **Regulatory:** verification of all municipal by-laws and authorization before construction.

7.2 Implementation

7.2.1 Site establishment;

7.2.2 **Earthworks for site drainage:** cut off drains, etc;

7.2.3 **Earthworks buildings:** finalise cut and fill of building platforms and drainage trenches. Including all necessary soil compaction;

7.2.4 Supply and delivery of all **building materials and equipment** to site;

7.2.5 **Construction of all sub/super structure:** foundations, foundation brickwork, drainage etc to specifications;

7.2.6 **Connection** of the project with existing water and electricity utilities;

7.2.7 Supply of all materials for installation of all **water and electrical reticulation;** and

7.2.8 Installation of **finishes** to the structure and related areas as specified.

8. SPECIAL CONDITIONS

- 8.1. Where an entity forms a joint venture or a consortium with (an) other entities(y), the parties to this agreement must express in the bid proposal what aspect of the scope of work each party would be adding value to and what percentage each party will receive in terms of the proceeds flowing from any assignment.

- 8.2. All prospective bidders (s) shall have to treat all available data provided by the Department in the process as strictly confidential and not for any form of distribution or use unless an express written approval is obtained from the Head of the Department in advance.
- 8.3. Successful bidders must be in a position to establish site within one (1) week and actual work to start within two (2) weeks from receipt of an official order.
- 8.4. The service provider who meets the minimum requirements in terms of the evaluation will be considered for appointment.

9. LOGISTICAL ARRANGEMENTS

- 9.1. The prospective bidders will be expected to complete SBD documents when submitting bids. The quotation or bid will include the details of the assignment and will be evaluated in terms of Preferential Procurement Policy Framework Act 05 of 2000 and Regulations of 2017.
- 9.2. Once appointed, an order number will be issued to the service provider which must be used in all future financial related correspondence.
- 9.3. No up-front payments will be made. DARD will pay for satisfactory completion of work within 30 days of submission of the invoice.

10. TIME FRAMES

- 10.1 The successful bidder will be expected to establish site within one (1) week of appointment. If there is a delay, reasons should be provided and agreed upon by both parties. The timeframe for the completion of different activities will be specified in the SLA and must be strictly adhered to. Delivery schedule must be submitted together with the quotations.

11. CANCELLATION

DARD reserves the right to cancel the contract if the service provider fails to adhere to the conditions of the contract.

- 11.1. On termination of the contract for whatever reason, the service provider shall on demand, deliver, without the right to retention all documents and information gained in terms of this agreement.

12. CONTRACTUAL ARRANGEMENTS

- 12.1 A standard agreement will be drawn up detailing all contractual obligations and it will be expected of the service provider to sign such with the Department. The Department will become the owners of any intellectual property that may be a product or an outcome of this project.

13. EVALUATION METHODOLOGY

DARD has set minimum standards (Gates) that a bidder needs to meet in order to be evaluated and selected as a successful bidder(s). The minimum standards consist of the following:

- 13.1 Pre-Qualification Criteria (Phase 1) – Evaluation on legal requirements
- 13.2 Technical Evaluation Criteria (Phase 2) – Bidder(s) must attain a minimum of 70 out of 100 points to be in the list of approved service providers. This might include physical visits.
- 13.3 Preference Points (Phase 3) – Price and B-BBEE

13.1. **Phase 1- Evaluation on Legal requirements:**

13.1.1 This phase will entail initial screening of bid responses received at close of bid. During this phase bid responses are registered and to ascertain the number of bid responses received before the closing date and time and to verify if the bidders submitted all mandatory requirements.

13.1.2 The prospective bidders are required to ensure that original bid documents are completed and signed where applicable and ensure that the following documents are submitted:

13.1.3 The prospective bidders are required to provide the following documentation which will be used for the **phase 1 of the evaluation on Legal Requirements:**

13.1.3.1 SARS TAX Pin.

13.1.3.2 Certified copy of Broad-Based Black Economic Empowerment (BBBEE) Status Level Verification Certificates accredited by SANAS, DTI approved BBBEE Certificate or Sworn Affidavit signed by Commissioner of Oath or SAPS.

13.1.3.3 In case of Joint Venture, an original Valid Tax Clearance Certificate of all partners should be submitted and a consolidated Broad-Based Black Economic Empowerment (BBBEE) Status Level Certificates.

13.1.3.4 CIDB Grade Certificate 3CE or 3GB

13.1.3.5 A valid COIDA certificate/ Letter of good standing from the Department of Labour.

NB: Bidders who do not submit B-BBEE certificates or Sworn Affidavits will not be disqualified but shall not claim points for B-BBEE.

During this stage, bids that do not comply will be disqualified, and will not be considered for the second stage of evaluation i.e. technical / functional capability and ability.

13.2. **Phase 2 – Technical / functional Requirements:**

This evaluation will be based on the responses using the resource requirements i.e. equipment and machinery, previous experience, and financial strength. The threshold values set for the qualification of bid is 70 % or 70 out of 100 and all the bidders who score below this score will be eliminated.

The bidder(s) information will be scored according to the following points system:

NO.	CIRTERIA	MAXIMUM SCORE
1. Experience on similar job and Proven Track Record	Proof of experience and expertise in the Field and proven track records. To this effect, Bidders are required to attach completion certificates from previous contracts.	80
1.1 Company Profile	A Comprehensive Organizational Profile (Maximum three Pages) <ul style="list-style-type: none">Submitted = 20None Submission = 0	20

1.2 Value of Projects	The contractor to provide a list of all previous similar projects bidding undertaken in the last 5 years accompanied by a completion certificate/s signed by Project Manager as proof with the following values:	30
	Above R 3 000 000 = 30	
	R 2 000 001-R2 999 999 = 20	
	R0 – R2 000 000 = 10	
1.3 Number of Projects	Previous Track Record of similar work done by the contractor in the last five years : (Proof of completion certificates must be attached)	30
	1 completion certificate = 10	
	2-3 completion certificates = 20	
	More than 3 completion certificates = 30	
2.Project Implementation Plan	<p>Delivery Schedule - Construction programme must be submitted together with the quotations indicating that the works will be completed within 90 days (each and every site should have its own team).</p> <ol style="list-style-type: none"> 1. Delivery within the stipulated period submitted = 20 2. Delivery not within the stipulated period submitted = 0 3. No submission = 0 	20
TOTAL POINTS	NB: Minimum Threshold: Bidders scoring less than 70 points during this stage would not be considered for the next stage of evaluation	100

Kindly note that the shortlisted bidders may be subjected to site inspections where the information submitted will be verified.

13.3. Phase 3 – Price and BBBEE Level of Contributor Points

This stage will entail evaluating price and BBBEE and will only be done once quotes have been requested from approved service providers. The criteria will depend on the specific work / service to be undertaken.

14. DEPARTMENTAL RIGHT

The Department reserves the right to award the bid in its entirety to one successful bidder or to award individual units or structures to various bidders.

15. DURATION OF THE CONTRACT

The successful bidder/s will enter into a once off contract with the department clearly stipulating terms and conditions of the agreement. The required deliverables will be communicated and agreed upon with the bidder. The contracted bidder/s will be legally bound to deliver within the set duration of the contract.

16. Enquiries

Technical Enquiries: Ms K Madira, 068 063 2914 - KMadira@nwpg.gov.za

Project Leader Enquiries: Mr D Molemi, 072 752 2886 – MMolemi@nwpg.gov.za

17. PROJECT TECHNICAL SPECIFICATIONS

IMPORTANT:

The Contractor should consult the Engineer for advice in case the Drawings or Bill of Quantities were to contradict in any way any of the specifications listed below.

1) PRELIMINARIES AND GENERAL

- 1.1 The Contractor is to note that all insurances (UIF, workman's compensation, works, public liability etc.); site and equipment safety; site establishment and security; services (water and electricity); testing of materials and any specialist services are for the Contractors responsibility and attention throughout the contract duration until handover of the project. The Department reserves the right to stop progress of the works until these conditions are complied with.

2) PROJECT SPECIFICATIONS

PSc2.1 Details of Contract

- 2.1.1 Supply and delivery to site of all materials and equipment required for the work.
- 2.1.2 Construction/Installation of all **sub and super structure**, foundations, brickwork, etc.
- 2.1.3 Bulk water supply (connection with mains/pressure line and connections to buildings).
- 2.1.4 Connection and installation of all the electrical works.

PS 2.2 Preliminaries and General

- 2.2.1 The Contractor is to note that all site and equipment safety; site establishment and security; services (Water and electricity); testing of materials and any specialist services are for the Contractors responsibility and attention throughout the contract duration until handover of the project. The Department reserves the right to stop progress of the works until these conditions are complied with.

PS 2.3 Earthworks and Site Preparations

- 2.3.1 Normal regulations regarding safety, municipal by-laws, contamination of water sources, erosion, siltation etc. will still apply. All installations and construction work must be according to the following SABS:
- 2.3.2 Site preparations & establishment: SABS 1200 AA (4);
- 2.3.3 Setting out of works: SABS 1200 AA (5.1.1);
- 2.3.4 Permissible deviations: SABS 1200 GA (6.4) Degree of accuracy II for all bases;
- 2.3.5 Restricted Excavations: SABS 1200 AA (5);
- 2.3.6 SABS 1200 DA (5.1; 5.2.2);

- 2.3.7 SABS 1200 LB: Bedding (Pipes);
- 2.3.8 SABS 1200 GA: Concrete small works; and
- 2.3.9 SABS 1200 DA (Earthworks: small works).
- 2.3.10 The site must be cleared and stripped of all plant materials, roots and topsoil prior to site levelling.
- 2.3.11 The site is to be levelled prior to any construction. This includes excavation of in situ material to provide a level platform and well-compacted sub base for the structure.
- 2.3.12 Material excavated and suitable for backfilling will be placed in even, thin layers and compacted with thickness applicable to the compaction method/machinery used.
- 2.3.13 Compaction of the site shall take place at optimum moisture content (OMC) to a maximum dry density of at least 95% of Mod. AASHTO. The platform is to be **inspected** prior to the pouring of any concrete.

PS 2.4 Materials and Construction

- 2.4.1 All materials must conform to SABS specifications for the products. This includes all items such as bricks, brick reinforcement, damp proofing, plumbing and drainage etc. All construction works must conform to the applicable standard specifications and installation requirements as per National Building Regulation (NBR) requirements and manufacturers recommendations.

PS 2.5 Standard Concrete Mixes

- 2.5.1 All concrete work purpose shall be ready mix, and concrete strength test certificates to be provided. For situation where the contractor shall not be able get a ready mix, the following prescribed mix shall be used; however a mechanical concrete mixer shall be used and the contractor shall provide all concrete strength test certificate. 250 micron "consol plastic USB green" to be placed before casting concrete on the slab.

crete Class	Estimated Minimum Compressive Strength in MPA at 28 Days	Maximum Nominal Size of Coarse Aggregate in mm	Proportion of Constituents			
			Cement (Parts) ¹	Fine Aggregate (Parts)	Coarse Aggregate (Parts)	
A	10	37,5	1 (= 2 bags)	4	5	
B	15	19,0	1 (= 2 bags)	3	4	
C	20	19,0	1 (= 2 bags)	2½	3½	
D	25	19,0	1 (= 2 bags)	2	3	
E	30	19,0	1 (= 2 bags)	2	2½	

PS 2.6 Finishes to In-Situ Concrete

- 2.6.1 The structure is to have **Class U1 Ordinary Finish**, Immediately after placing, the concrete shall be finished rough by screeding with the edge of a wooden board of straight and true line and working between guides set accurately to level. No mortar shall be added and noticeable surface irregularities caused by the displacement of coarse aggregate shall be made good by rescreeding after removing or tamping down the offending aggregate.

PS2.7 Foundations

- 2.7.1 All foundations are to be on suitable, well compacted material (to extend through any fill material where applicable and well compacted to minimum 95% Mod AASHTO). **The foundation trenches are to be inspected prior to the pouring of any concrete.**
- 2.7.2 Final foundation levels 200mm above NGL and to correspond to the floor slab level.

PS 2.8 Floor Slabs

- 2.8.1 The soil layer under the floor slab is to be well and uniformly compacted. Backfilling & soil compaction to be according to SABS 1200 DA (3.2; 5.2.3.2). The floor slabs are to be on a leveled base and well compacted to minimum 95% Mod AASHTO – Contractor to supply test results proving compaction results – Department Engineer to be notified of test and observe test procedures. The floor sub base is to be inspected prior to the pouring of any concrete. **The base is to be inspected prior to laying of the damp proofing or pouring of any concrete.**

PS 2.9 Brick Works

- 2.9.1 The use of any clay masonry units require that the units are wet before being laid and the course of units last laid shall be wet before laying a fresh course upon it. All brickwork shall be built in stretcher bond in class II mortar for super structure walls. The mortar is to be a general-purpose mix (class II).

PS 2.10 House Accessories

- 2.10.1 All required accessories and fittings for electrical and plumbing reticulation works must be according to the BOQ below.
- 2.10.2 Materials must be SABS approved.

PS 2.11 Electrical

- 2.11.1 All electrical work (connection to the grid, installation of the lights and switches) to be done by a licensed electrician and certificate of compliance (CoC) must be submitted.

2.11.2 Connection to the grid is only to be made from a legal connection which has not been tampered with and which has a sealed and working meter measuring consumption.

2.11.3 All installations must be according to BoQ per subject.

18. BILL OF QUANTITY

PREAMBLE

1. The General Conditions of Contract, the Special Conditions of Contract, the Specifications (including the Project Specification) and the Drawings are to be read in conjunction with the Schedule of Quantities.
2. The Bidder is at liberty to insert a rate of his own choosing for each item in the schedule and his attention is drawn to the fact that the Contractor has the right, under various circumstances, to payment for additional works carried out and that the Engineer is obliged to base his assessment of the rates to be paid for such additional work on the rates inserted in the schedule by the Contractor.
3. Any additional work that the contractor deems necessary must first be approved in writing by the site engineer.
4. Unless otherwise stated, items are measured net in accordance with the Schedule of Quantities and Drawings and no allowance has been made for waste.
5. The prices and rates to be inserted in the Schedule of Quantities are to be the full inclusive prices to the Employer for the work described. Such prices shall cover the cost of all general risks, liabilities and obligations set forth or implied in the documents on which the Bid is based.
6. A price or rate is to be entered against each item in the Schedule of Quantities whether the quantities are stated or not. An item against which no price or rate is entered will be considered to be covered by other prices or rates in the schedule and no payment for that item will be made.
7. Items and requirements indicated on any drawing but not specifically mentioned in the schedule of quantities must be included in the total pricing. No additional payment for such items or requirements will be made.
8. The Bidder must price each item in the Schedule of Quantities in **BLACK INK**.
9. All prices and rates shall **include** value added tax (VAT).
10. Supply, delivery and functional installation.

PRICING SCHEDULE A.

Background/Deliberation: This is a supply deliver and construct invite. Plan and quantity schedule must be read together as the project is required to be functionally installed. Contractor must familiarise with site conditions, responsible for site surveying and availability of electricity and water - or none availability as this will be the responsibility of contractor to provide for during the construction period. Take note of Clay bricks that will not be plastered and bricks on inner side that will be plastered.

NO	DESCRIPTION	QTY	UNIT	RATE	AMOUNT
A1	Site establishment and removal and OHS is contractors responsibility	1	Count		
A2	Clear and Grub - as specified during site briefing	1	Count		
A3	Geo Tech report - as per registered person(all inclusive) this report can influence the construction processes and cost - to continue or not is dependant on this outcome - (contractor must not quote on this item)	1	Count	*****	*****
A4	Backfill:- Suitable G 5 Backfill material will be paid on proof of invoice.Quantified as 3 layers of 150mm for the entire active square metres of the structure. Hence, only actuals should be paid and the service provider must submit a quote according to the site's topography	250	m ³		
1.	CONCRETE - 25 mPa for all concrete after 28 days				
1.1	Foundation for I - sections (500mm x 500mm x 500mm)(22 positions)	2,75	m ³		
1.2	Foundations for double brick wall - 300mm deep x 400mm wide x 136m	16,5	m ³		
1.3	Foundation for double brick wall - inner partitioning - 300mm wide by 200mm deep x 160m, it is inclusive of feeding troughs	10	m ³		
1.4	75mm Floorslab - >360m ² (actuals as walls are not included)	27	m ³		
1.5	75mm Concrete shoulders at main entrance - 2.0m x 11m x (2)	3,5	m ³		
1.6	75mm concrete channel - 1m wide x 100m + P trap positions	8	m ³		
1.7	400mm x 400mm x 400mm for 100mm vertical pipe uprights - refer to gates - 54 positions	3,5	m ³		
2.	FOOTPLATE - 9 pillars per side				
2.1	Welded on IPE Pillar and bolted on to the foundation block - 250mm x 250mm x 10mm	18	count		
3.	PILLARS - Refer to section AA				
3.1	IPE - 120mm x 64mm x 8.36kg/m	48	m		

3.2	Starter Bar - Quantify all steel as per section view drawing and quote all inclusive price per position	22	count		
4.	BEAMS - Refer to section AA				
4.1	IPE - 120mm x 64mm x 8.36kg/m	84	m		
5.	WEB-CUTS - Refer to section AA				
5.1	IPE - 120mm x 64mm x 8.36kg/m	27	m		
6.	RIDGE CONSTRUCTION - 16 lengths of 3m each				
6.1	0.5mm-0.6mm galvanized ridge	16	count		
7.	RAFTER - Lipped channel rafters - with 250mm overhang each side				
7.1	150mm x 50mm x 20mm x 2mm (4,32kg/m)	405	m		
8.	INSULATION - Under lipchannel - (allow overlapping)				
8.1	Bubble foil D10 - thermal resistance 1,71 m ² . K/W . Foil both sides installed under lipped channel	400	m ²		
8.2	Silicon tubes - to seal overlaps	10	count		
8.3	Galvanized binding wire 2.0mm	2	rolls		
8.4	Galvanized perforated strap 20mm X 0,5mm - attach insulation to lipped channels	500	m		
9.	ROOF - 126 sheets of 5m each				
9.1	0.5mm Corrugated roof sheets	126	count		
10.	TEKSCREWS - Roof to lipchannel attachment				
10.1	75 mm tek screws	3000	count		
11.	WASHERS - Tek screw washers				
11.1	19mm bonded washers	3000	count		
12.	DAMPCOURSE - Before bricklaying may commence				
12.1	Double	300	m		
13.	BRICKS - Clay Brick - (prior approved by Regional Engineer)				
13.1	Face bricks - Outside and none plastered positions - Mottled Rustic or Similar	28000	count		
13.2	FBX or NFP - will be plastered	30000	count		
<p>* Care must be taken to understand that the outer building will be built with Mottled rustic Clay Face bricks or similar quality and esthetical appearance and that the inner part of the building will be built with plastered bricks (Face brick extra or None Face Plastered) except for the inner wall part that is not being plastered and that will be all bricks above the 1.2m height from the floor level.If contractor makes a mistake on this aspect the expectation is that everything will be plastered at contractors expense.</p>					

14.	BRICKFORCE - Each and every fourth layer of bricks				
14.1	SABS – double	800	m		
15.	WELDED MESH - Galvanized - Refer to northern sideview on drawing				
15.1	1.5m x 25mm x 13mm x 1.6mm mesh	50	m		
15.2	Hiltees 40mm X 6mm - to attach welded mesh to wall - every 0,5m	80	count		
15.3	Tekscrews 16mm X 8mm - to attach welded mesh to lipped channel and IPE	130	count		
16.	BINDING WIRE - Galvanized mesh attachment				
16.1	3.15mm galv.binding wire	200	m		
16.2	1,6mm Galvanized binding wire (5kg/roll)	1	count		
17.	WIND RE-INFORCING - 12mm cross bracing				
	Refer to northern sideview on drawing				
17.1	12mm threaded rod	50	m		
17.2	M12 nut and washer	16	count		
17.3	50 x 8mm flatbar	1	m		
18.	BUILDMIX - Bricklaying purpose				
18.1	Buildingsand	34	m ³		
18.2	Cement (50kg)	170	count		
19.	PLASTERMIX - All inner walls needs to be plastered from floor to height of 1.2m (nominal), finish must be steel "smoothed" = ± 700 m ²				
19.1	Plastersand	22	m ³		
19.2	Cement (50kg)	109	count		
20.	LINTELS				
20.1	Single doors 1.2m each	6	count		
20.2	Windows 4.5m each	12	count		
21.	DOORS				
21.1	813mm x 2032mm x 1.2mm x 110mm - single steel door - open in	3	count		
22.	FEEDER - Refer to plan				
22.1	Manual feeders - purpose built 6mm steelplate	36	count		
23.	HEATER				

23.1	DRM ceramic heater 250 watt - complete with reflector,generator,cable, plugs switches and hanging hook (175 watt lamp is acceptable).	6	count		
23.2	SBM 6 ZRS with variable regulators - (gas heater)	6	count		
23.3	Gas cylinder - 48kg	4	count		
23.4	Regulators	2	count		
23.5	Gas pipe - pexpipe16/20	60	m		
23.6	Expanded metal cages - to secure 48kg gas cylinders [roll bolts]	4	count		
23.7	Manifold - gas Double 2 Vapor	2	count		
23.8	2 shut off valves - one inside and one outside	2	count		
23.9	Certificate of compliance to be handed in with completion of LPG Gas installation Act - 2009 Spec 17.3	1	count		
24.	WATER SUPPLY - EXTERNAL				
6m Tank stand must be built according to departmental plan. If not, it must be procured as shelve item via registered company able to give engineering approval. Concrete for tank stand pillars or Foot must be according to prior approved plan.					
24.1	TANKSTAND				
24.1.1	Legs: Angle iron 60mm x 70mm x 6mm - inclusive of offcut for foot legs	30,4	m		
24.1.2	Support beam: Channel iron 100mm x 50mm x 11kg/m - 2 lengths of 1738mm each	3,476	m		
24.1.3	Carrier beam: Channel iron 100mm x 50mm x 11kg/m - 3 lengths of 2200mm each	6,6	m		
24.1.4	Platform: Lipchannel 100mm x 75mm x 20mm x 2mm (4,32kg/m) (10 of them)				
24.1.5	Must be 2.2m to accommodate tank diameter	22	m		
24.1.6	Cross braces: Angle iron 50mm x 50mm x 5mm - 28 lengths of 1738mm each	48,664	m		
24.1.7	Tie rods: 10mm rod (alternative is 20mm x 3mm flatbar) - flatbar can be bolted	107,46	m		
24.1.8	Bolts: M10 bolts - inclusive of nuts and washers -				
24.1.9	quantity will differ if rod is used	124	count		
24.1.10	Foundation: Concrete 1:4:4 (cement:sand:stone)	1,6	m³		
24.1.11	Concrete slab 2.5m x 2.5m x 0.075m	0,5	m³		
24.1.12	Tank: JoJo or similar drinkwater (outlet 50mm) - 10 000l	1	count		
24.1.13	Red oxide - 2 layers	10	l		
24.1.14	Galvanized paint - 2 layers	10	l		
24.1.15	Dia 40mm pipe Polyethylene - HDPE - with fittings, connectors and 110mm reducer- to be connected from existing municipal supply line to tank	150	m		
24.1.16	Control valves complete with rainbird 15-20 cm round valve box cover or similar	2	count		

24.1.17	1.1 kW booster pump with maximum pressure of 40 bar, complete with connection to tank, fittings, cabling from electrical source that is 80m away, housed with IBR/corrugated iron sheet protective cage and placed on 25 MPa concrete slab/base.	1	Sum		
24.2	DRINKER SYSTEM				
24.2.1	2 Inline and 1 outlet at tankstand (valves) - 40mm one way ball valve	3	count		
24.2.2	15mm stainless steel drinker nipples (Farrow crates must come readily equipped)	28	count		
24.2.3	Galvanized pipe - 25mm -7@380mm and 17@450mm NGL - standard items placed on outside, - functional installation	28	count		
24.2.4	Wall brackets 15 x 25mm x 15° bend:	28	count		
24.2.5	Inclusive of all fittings - thread tape with galv fittings - complete	1	count		
24.2.6	External water supply (complete), 40mm polyethylene pipe-HDPE – existing tank to new tank and building	350	m		
24.2.7	Galvanize pipe - internal distribution - 20mm	100	m		
25.	ELECTRICAL				
25.2	External electrical supply - Main DB - 16mm² Ø underground cable - complete installation	150	m		
25.3	60w Double Fluorescent 1.5 complete unit - as indicated on plan	20	count		
25.4	Surflex cable - 2.5mm²	150	m		
25.5	Sub-distribution box	1	count		
25.6	S 11 weatherproof plug - S 11 weathertight wall plug - placement confirmed on site	9	count		
25.7	Main switch (60amp) - in sub-DB box	1	count		
25.8	Earth switch circuit breaker (60amp) – earth breaker in sub-DB box	1	count		
25.9	Earth cable & copper rod	1	count		
25.10	Circuit breaker - lights (20amp) - place in sub-DB box	1	count		
25.11	Circuit breaker - plugs (15amp) - placed in sub-DB box	1	count		
25.12	Cable ties	100	count		
25.13	Energy saving flood lights - both sides of building - 100w equivalent	2	count		
25.14	Light switches - complete	4	count		
	COC				
25.15	Certificate of compliance to be handed in with completions (Electricity installation)	1	count		
26.	SAIL/CURTAIN - Inclusive and complete according to suppliers specification				

	*contractor must familiarise with existing approved project in order to functionally install - copy and paste of already approved installation via site engineer recommendation.				
26.1	Hollow steel tubing 20mm X 2mm - install in top seam of curtains	50	m		
26.2	PVC Sail (Tarpaulin) 550g/m ² - 2 of 35m x 1.8m	2	count		
26.3	Screws (Hiltees) - also for sail to wall fitment - 40mm X 6mm	90	count		
26.4	Washers dia 30mm -	1	Sum		
26.5	Hole must be small enough that Hiltee does not go through	90	count		
26.7	Tarpaulin 200mm x 500mm - Envelopes 2m - 550g/m ²	4	count		
26.8	Double 200mm Pelmit - 550g/m ²	4	count		
26.9	Nylon belt 50mm - 2m intervals (straps) - for total length of 50m	60	m		
27.	WINDOWS				
27.1	Windows E4 - burglar proofed - complete with glass	12	count		
28.	WINCH				
28.1	Winch 750kg - gear ration 3:1 with counter gear	2	count		
28.2	Steel plate 250mm x 250mm x 5mm - with support welded on to IPE	1	Sum		
28.3	Winch secured with bolts & nuts	2	count		
28.4	Bolts M10	8	count		
28.5	Nuts M10 + washers	8	count		
28.6	Cable dia 5mm	60	m		
28.7	Cable dia 3mm	50	m		
28.8	Nylon swivel pully - 40mm	22	count		
28.9	Gate wheel pully - 80mm	2	count		
28.10	Crosby clamps 3mm - tie 3mm to 5mm cable (x2)	44	count		
28.11	Aluminium farrel - tie 3mm cable to pipe in sail	22	count		
28.12	Washer 50mm with 10mm hole - to secure eye bolts	22	count		
28.13	Eye bolts - 8mm x 150mm - supplier must include 2 nuts per bolt	22	count		
28.14	Nuts 8mm	44	count		
29.	BOAR/SOW CAGES and GATES - Refer to detail drawing 30 - 33				
29.1	25mm x 2.5mm pipe frame	150	m		
29.2	12mm rod	300	m		
29.3	100 x 50 x 10 Flat iron	4	m		
29.4	M16 x 60mm Rawl bolt	25	count		
29.5	100mm x 2.5mm x 1.5m circular tube - vertical gate posts	56	count		

30.	FARROWING CRATES				
30.1	Complete farrowing crates (shelve item) - inclusive of feeder and drinker nipple - complete functional installation - water via galvanize pipe	6	count		
31.	EXCAVATION - Foundations - Building and gate posts	40	m ³		
a	Excavation - electrical and backfilling [(150mx0.3mx0.3m) and (80mx0.3mx0.3m)]	21	m ³		
b	Excavation and backfilling - water supply from tank and municipal water supply line	45	m ³		
c	Excavation and backfilling- waste water supply	6,5	m ³		
32.	LOADING RAMP				
32.1	Foundation excavations - 400mm x 300mm x 19,6m	2,5	m ³		
32.2	Concrete foundations	2,5	m ³		
32.3	Bricks (columns + side walls) - according to layout plan - Face brick - clay brick , mottled rustic or similar prior approved	3000	count		
32.3	Floor - 75mm x 25 mPa (12mm stone)	1	m ³		
32.4	Backfilling material - appropriate backfill material - prior approved	10,5	m ³		
32.5	Gates Functional installation on vertical posts – all-inclusive as per plan	3	count		
33.	EFFLUENT				
33.1	110mm pipe for purpose effluent waste water management	70	m		
33.2	P - Trap, functionally installed - complete with steel grid over the plastic grid. Refer to site briefing explanation as each drop off point or outflow area must be indicated – refer to site engineer explanation.	2	count		
33.3	Trapezoidal effluent dam complete with excavation works, compaction and rough paving on slopes according to the layout plan– Refer to attached drawing	1	Sum		
				SUBTOTAL	
				ADD 10% CONTINGENCIES	
				SUBTOTAL	
				15% VAT	
				GRANDTOTAL	

NB: All Prices must be inclusive of transport and labour costs for functional installation.

Conditions of Contract:

- All the materials for the project must SABS approved.
- Only actuals will be paid.
- Relevant CIDB Grading: 3CE/3GB.
- Duration of project is Four (4) months.
- All Installation and Construction Works to be according to SABS Standards.
- SBD 6.2. must form part of the bid document: Sector Designation - Local Content

South African Technical Specification (SATS) 1286:2011, Local content Declaration template (Annexure C, D & E) and the Guidance Document for the Calculation of local content is accessible to all potential bidders on the DTI official website: (<http://www.dti.gov.za/industrialdevelopment/ip.jsp>) at no cost.

This bid will be evaluated in terms of the Local Content and production requirements for different categories of Steel Products and Components for Construction as follows:

- A. This bid will be evaluated in terms of the Local Content and production requirements for different categories of Pumps, Medium Voltage (MV) Motors and associated accessories as follows:

Minimum Local Content Designated for Pumps					
Category	Type of pumps	% Local content per unit	Minimum Pressure	Maximum Pressure	Sizes
End Suction Centrifugal	Single Stage end suction Centrifugal pumps	70%	1 bar	16 bar	DN25 – DN300
	Single Stage end suction Centrifugal solid handling pumps	70%	0,5 bar	16 bar	DN40 – DN400
Multistage Centrifugal	Multistage Centrifugal pumps: medium - high	70%	10 bar	63 bar	DN32 – DN350
Horizontal split casing pumps	Horizontal split casing pumps	70%	1 bar	18 bar	DN80 – DN300
Vertical Turbine pumps	Vertical Turbine pumps: Radial, Mixed, and axial	70%	0,3 bar	4 bar	DN100 – DN500
Positive Displacement	Positive Displacement pumps	70%	5 bar	45 bar	DN25 – DN150
	Diaphragm pumps	70%	5 bar	45 bar	DN25 – DN150
Self Priming Centrifugal Pumps	Single stage end suction self-priming pumps	70%	0,3 bar	16 bar	DN25 – DN150
Slurry Pumps	Vertical Cantilever slurry pumps	70%	1 bar	10 bar	DB40 – DN300
	Single stage slurry pumps	70%	0,5 bar	50 bar	DN32 – DN300
Vacuum Pumps	Liquid ring Vacuum Pumps	70%	1.13 CFM	950 CFM	
Centrifugal Process Pumps	Vertical Spindle Centrifugal Process Pumps	70%	0,3 bar	40 bar	DN25 – DN300
	Single stage Centrifugal Process Pumps	70%	0,3 bar	40 bar	DN25 – DN300
	Single stage Centrifugal chemical Pumps	70%	0,3 bar	25 bar	DN25 – DN300

Fully Built Unit and components and manufacturing processes against which the overall local content must be discharged, per Medium Voltage (MV) motor			
Medium Voltage electric motor	185kW to 20 000kW and greater than 1 000 Volts	Casting or Frame Fabrication	100%
		Fabrication and winding of the Stator Core	100%
		Fabrication and winding of the Rotor Core	100%
		Accessories	100%
		Assembly and testing of the fully-built unit	100%
		Total Minimum Local Content (per unit)	70%

- B. This bid will be evaluated in terms of the Local Content and production requirements for different categories of Electrical Cable Products as follows:

Power Cables: Cables used for power transmission

Cable Products	Stipulated Minimum Threshold
Low Voltage	90%
Low Cost Reticulation	90%
Medium & High Voltage	90%
ACR	90%

List of Specific Cables designated under this instruction note:

Category	Type
Low Voltage	Housewire, Flat Twin and Earth, Surface Cable, Rip Cord, Cable Tyre, Bells Cable, 1.5mm ² – 16mm ² , 2 – 37 core, Fire Retardant, Low Halogen and Low Smoke Zero Halogen (LSCH) Main Cable 25mm ² - 100mm ² , 1 - 4 cores, Fire Retardant, Low Halogen and Low Smoke Zero Halogen (LSOH), Flexible Cables, Aerial Cables, ACSR, Split Concentric & Aerial Bundled Conductor (ABC)

Category	Type
Medium Voltage	3,3kV – 22kV, 1 -3 cores, Cross Linked Polyethylene (XLPE) and paper insulated Lead Covered (PILC), Fire Retardant, Low Halogen and Low Smoke Zero Halogen (ELSOH)
High Voltage	132kV, Single Core, Corrugated Seamless Aluminium (CSA) Sheathed

- C. This bid will be evaluated in terms of the Local Content and production requirements for different categories of Steel Products and Components for Construction as follows:

Description		% Local Content
A. Steel Products and Components for Construction : Steel Value-added Products		100%
1.	Fabricated Structural Steel	100%
2.	Joining/Connecting Components	100%
3.	Frames	100%
4.	Roof and Cladding	100%
5.	Fasteners	100%
6.	Wire products	100%
7.	Ducting and Structural pipework	100%
8.	Gutters, downpipes and Lauders	100%
9.	Plates	100%
10.	Sheets	100%
11.	Galvanised and Colour Coated Coils	100%
12.	Wire Rod and Drawn Wire	100%
13.	Sections	100%
14.	Reinforcing bars	100%

TECHNICAL SPECIFICATIONS FOR 6m TANKSTAND AND FOUNDATION (5000l and 10 000l Tanks)

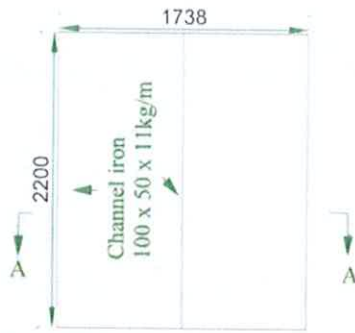

SECTION AA : Carrier and support beams

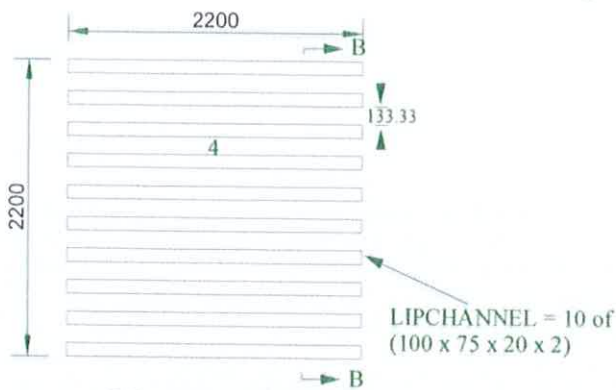

SECTION BB : Platform

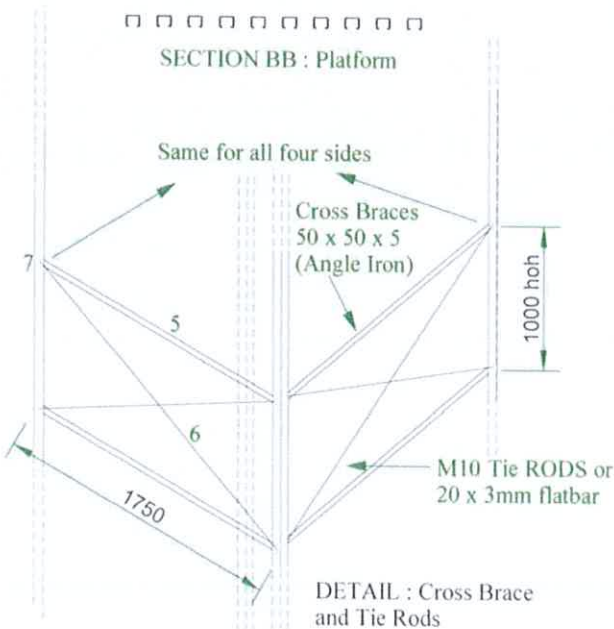

Notes :
Fastening must be welded or by using M10 bolts.
Numbering = refer to quantity schedule
Cross braces start at bottom and end at top.
Follow same specifications for 3m Stand.

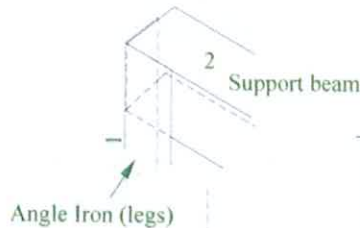
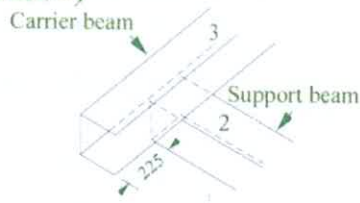

Legs : Angle Iron
70 x 70 x 6

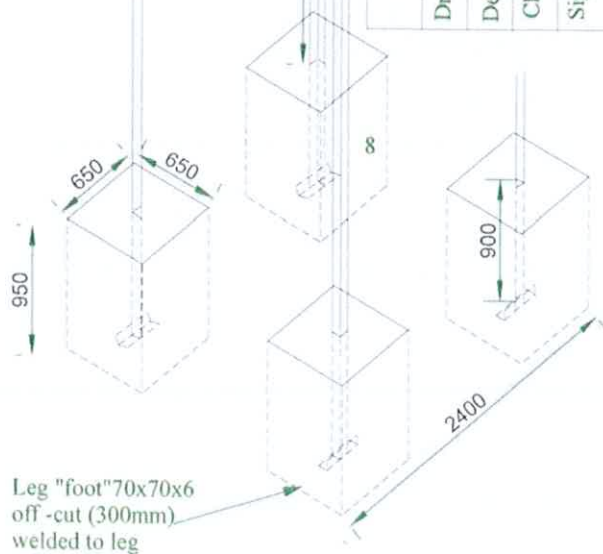

AGRICULTURAL ENGINEERING P.BAG X 804 POTCHEFSTROOM 2520

Drawn by: R Du Plessis

Designed : W Viljoen

Checked : W Viljoen

Signed off:

Tankstand 6m : Suitable for 5000 and 10 000 liter water tank.

at:

Tel : (018) 299 6667

Fax : (018) 293 0147

Date : 2006.03.10

Drawing nr.

D02/06

Ref. no. : C:\ENG\Tankstand\51101 6m.DRG

Scale : None

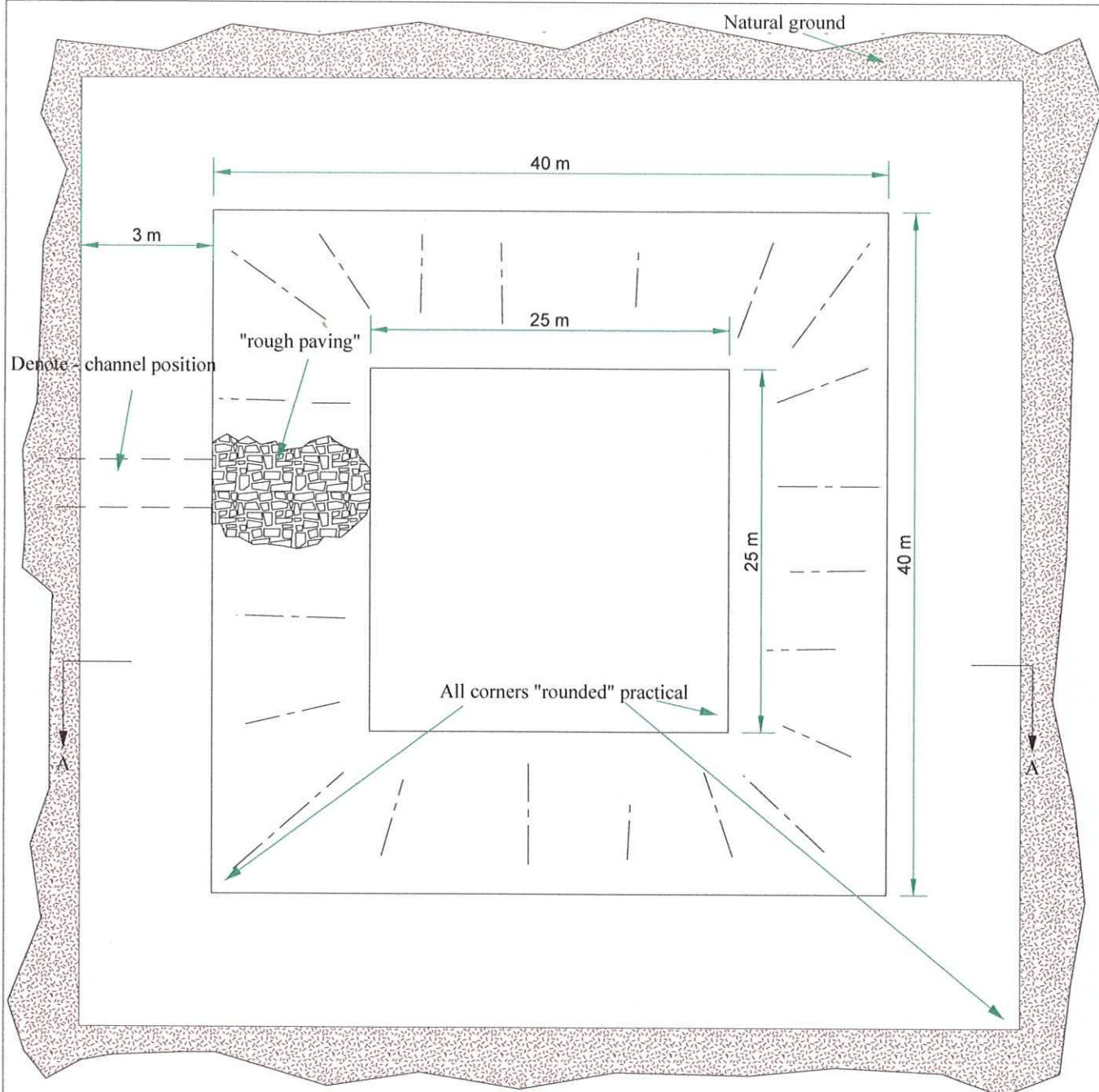

PLAN VIEW - Effluent dam (not to scale)

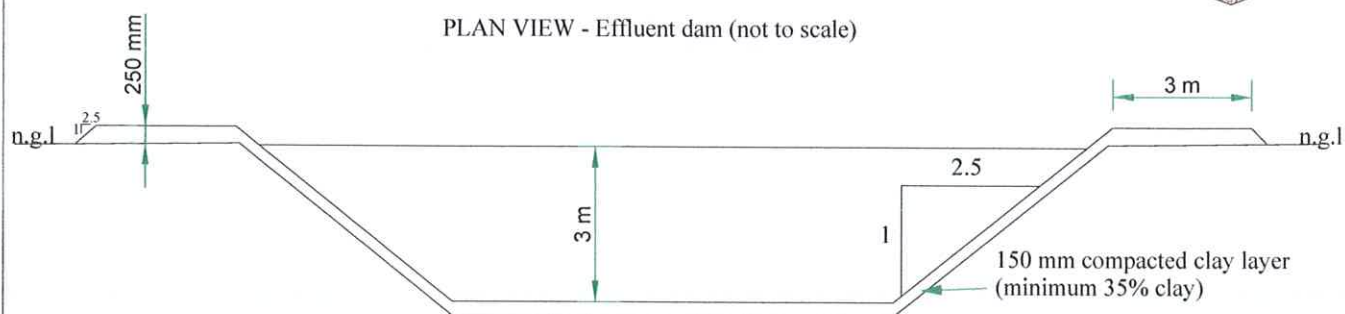

SECTION AA - (not to scale)

AGRICULTURAL ENGINEERING P.BAG X 804 POTCHEFSTROOM 2520

Drawn by: R Du Plessis	EFFLUENT DAM FOR 160 PIGGERY GROWER UNIT		Tel : (018) 299 6669
Signed off:			Date : 2019.05.09
Scale : None	Ref. no. :	C:\ENG\hod\Terms\Piggery\160Grower\Misdam	Drawing nr. on A4

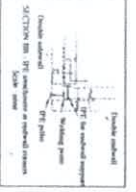
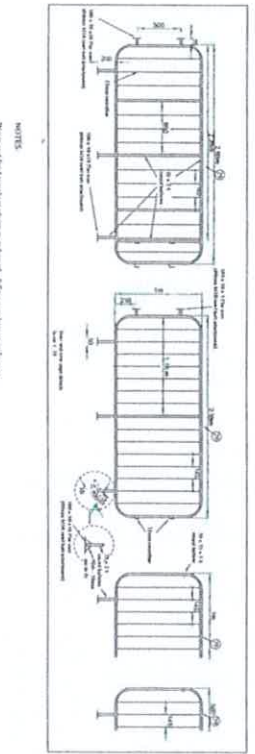
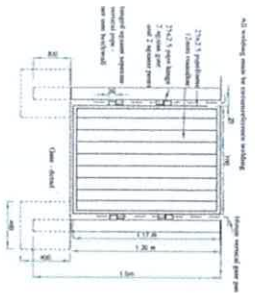
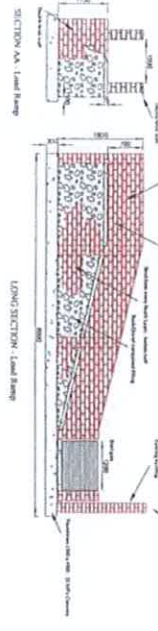
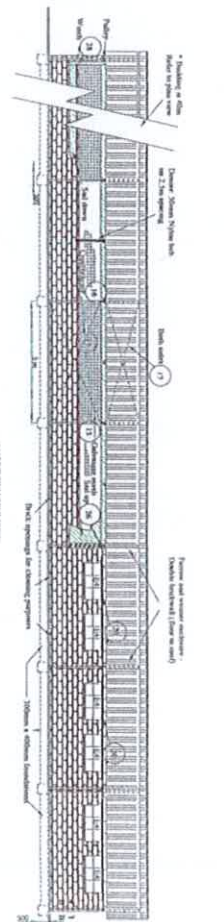
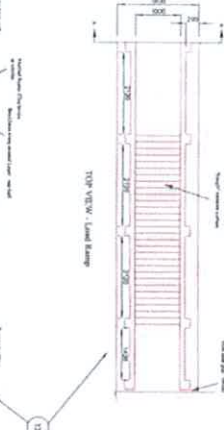
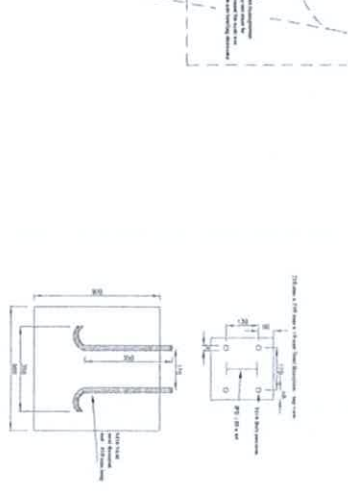
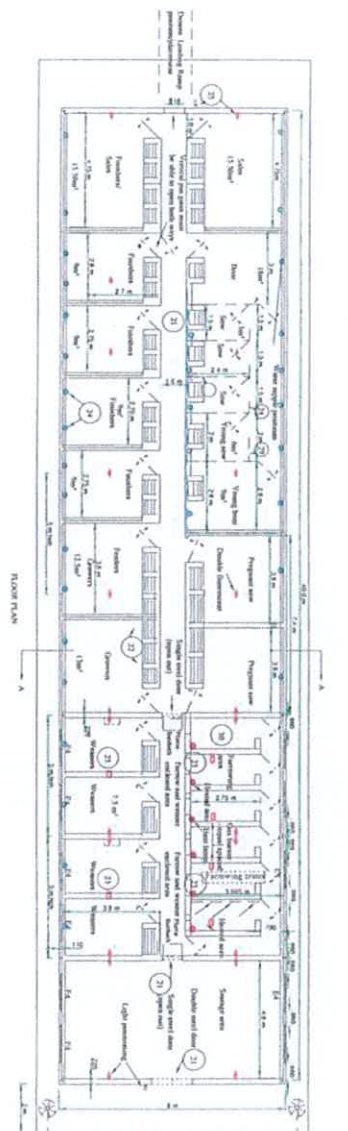

NOTES:

- Water and fluid supply in picture is indicated. (Subject to specific requirements.)
- Electrical supply in picture is indicated. (Subject to specific requirements.)
- Sanitary supply in picture is indicated. (Subject to specific requirements.)
- Gas supply in picture is indicated. (Subject to specific requirements.)
- Structural steelwork in picture is indicated. (Subject to specific requirements.)
- Roofing in picture is indicated. (Subject to specific requirements.)
- Foundation in picture is indicated. (Subject to specific requirements.)
- External walls in picture are indicated. (Subject to specific requirements.)
- Internal walls in picture are indicated. (Subject to specific requirements.)
- Floors in picture are indicated. (Subject to specific requirements.)
- Stairs in picture are indicated. (Subject to specific requirements.)
- Doors in picture are indicated. (Subject to specific requirements.)
- Windows in picture are indicated. (Subject to specific requirements.)
- Kitchen in picture is indicated. (Subject to specific requirements.)
- Bathroom in picture is indicated. (Subject to specific requirements.)
- Bedroom in picture is indicated. (Subject to specific requirements.)
- Living area in picture is indicated. (Subject to specific requirements.)
- Dining area in picture is indicated. (Subject to specific requirements.)
- Storage area in picture is indicated. (Subject to specific requirements.)
- Laundry area in picture is indicated. (Subject to specific requirements.)
- Garage area in picture is indicated. (Subject to specific requirements.)
- Other areas in picture are indicated. (Subject to specific requirements.)

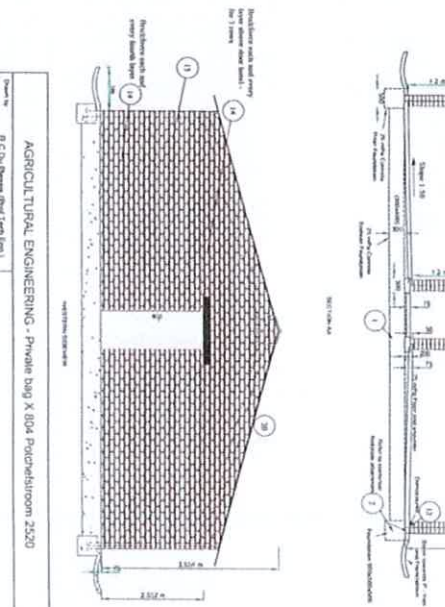

Item	Description	Quantity	Unit	Price	Total
1	Foundation	1	m ²	1000	1000
2	External walls	1	m ²	2000	2000
3	Internal walls	1	m ²	1500	1500
4	Floors	1	m ²	1200	1200
5	Roofing	1	m ²	800	800
6	Stairs	1	m ²	600	600
7	Doors	1	m ²	400	400
8	Windows	1	m ²	300	300
9	Kitchen	1	m ²	200	200
10	Bathroom	1	m ²	150	150
11	Bedroom	1	m ²	100	100
12	Living area	1	m ²	80	80
13	Dining area	1	m ²	60	60
14	Storage area	1	m ²	40	40
15	Laundry area	1	m ²	30	30
16	Garage area	1	m ²	20	20
17	Other areas	1	m ²	10	10
18	Foundation	1	m ²	1000	1000
19	External walls	1	m ²	2000	2000
20	Internal walls	1	m ²	1500	1500
21	Floors	1	m ²	1200	1200
22	Roofing	1	m ²	800	800
23	Stairs	1	m ²	600	600
24	Doors	1	m ²	400	400
25	Windows	1	m ²	300	300
26	Kitchen	1	m ²	200	200
27	Bathroom	1	m ²	150	150
28	Bedroom	1	m ²	100	100
29	Living area	1	m ²	80	80
30	Dining area	1	m ²	60	60
31	Storage area	1	m ²	40	40
32	Laundry area	1	m ²	30	30
33	Garage area	1	m ²	20	20
34	Other areas	1	m ²	10	10

PART A
INVITATION TO BID

YOU ARE HEREBY INVITED TO BID FOR REQUIREMENTS OF (DEPARTMENT OF AGRICULTURE AND RURAL DEVELOPMENT)

BID NUMBER:	13 DARD 04/2022	CLOSING DATE:	25 August 2022	CLOSING TIME:	11:00
DESCRIPTION	CONSTRUCTION OF 20 SOW UNIT HOUSE AT INYAMA YETHU PTY (LTD) IN MADIBENG MUNICIPALITY, BOJANALA DISTRICT				

BID RESPONSE DOCUMENTS MAY BE DEPOSITED IN THE BID BOX SITUATED AT (STREET ADDRESS)

Department of Agriculture and Rural Development

Agricentre Building

Corner Dr. James Moroka and Stadium Road

Mmabatho

BIDDING PROCEDURE ENQUIRIES MAY BE DIRECTED TO

CONTACT PERSON	Mr. L.S. Mothibi
TELEPHONE NUMBER	018 389 5053
FACSIMILE NUMBER	086 646 0925
E-MAIL ADDRESS	smothibi@nwpg.gov.za

TECHNICAL ENQUIRIES MAY BE DIRECTED TO:

CONTACT PERSON	Ms Kgaugelo Madira
TELEPHONE NUMBER	068 063 2914
FACSIMILE NUMBER	N/A
E-MAIL ADDRESS	kmadirai@nwpg.gov.za

SUPPLIER INFORMATION

NAME OF BIDDER					
POSTAL ADDRESS					
STREET ADDRESS					
TELEPHONE NUMBER	CODE		NUMBER		
CELLPHONE NUMBER					
FACSIMILE NUMBER	CODE		NUMBER		
E-MAIL ADDRESS					
VAT REGISTRATION NUMBER					
SUPPLIER COMPLIANCE STATUS	TAX COMPLIANCE SYSTEM PIN:		OR	CENTRAL SUPPLIER DATABASE No:	MAAA
B-BBEE STATUS LEVEL VERIFICATION CERTIFICATE	TICK APPLICABLE BOX] <input type="checkbox"/> Yes <input type="checkbox"/> No		B-BBEE STATUS LEVEL SWORN AFFIDAVIT	[TICK APPLICABLE BOX] <input type="checkbox"/> Yes <input type="checkbox"/> No	

[A B-BBEE STATUS LEVEL VERIFICATION CERTIFICATE/ SWORN AFFIDAVIT (FOR EMES & QSEs) MUST BE SUBMITTED IN ORDER TO QUALIFY FOR PREFERENCE POINTS FOR B-BBEE]

ARE YOU THE ACCREDITED REPRESENTATIVE IN SOUTH AFRICA FOR THE GOODS /SERVICES /WORKS OFFERED?	<input type="checkbox"/> Yes <input type="checkbox"/> No [IF YES ENCLOSE PROOF]	ARE YOU A FOREIGN BASED SUPPLIER FOR THE GOODS /SERVICES /WORKS OFFERED?	<input type="checkbox"/> Yes <input type="checkbox"/> No [IF YES, ANSWER PART B:3]
---	--	--	--

QUESTIONNAIRE TO BIDDING FOREIGN SUPPLIERS

IS THE ENTITY A RESIDENT OF THE REPUBLIC OF SOUTH AFRICA (RSA)?	<input type="checkbox"/> YES <input type="checkbox"/> NO
DOES THE ENTITY HAVE A BRANCH IN THE RSA?	<input type="checkbox"/> YES <input type="checkbox"/> NO
DOES THE ENTITY HAVE A PERMANENT ESTABLISHMENT IN THE RSA?	<input type="checkbox"/> YES <input type="checkbox"/> NO
DOES THE ENTITY HAVE ANY SOURCE OF INCOME IN THE RSA?	<input type="checkbox"/> YES <input type="checkbox"/> NO
IS THE ENTITY LIABLE IN THE RSA FOR ANY FORM OF TAXATION?	<input type="checkbox"/> YES <input type="checkbox"/> NO

IF THE ANSWER IS "NO" TO ALL OF THE ABOVE, THEN IT IS NOT A REQUIREMENT TO REGISTER FOR A TAX COMPLIANCE STATUS SYSTEM PIN CODE FROM THE SOUTH AFRICAN REVENUE SERVICE (SARS) AND IF NOT REGISTER AS PER 2.3 BELOW.

PART B
TERMS AND CONDITIONS FOR BIDDING

1. BID SUBMISSION:

- 1.1. BIDS MUST BE DELIVERED BY THE STIPULATED TIME TO THE CORRECT ADDRESS. LATE BIDS WILL NOT BE ACCEPTED FOR CONSIDERATION.
- 1.2. ALL BIDS MUST BE SUBMITTED IN THE MANNER PRESCRIBED IN THE BID DOCUMENT.
- 1.3. THIS BID IS SUBJECT TO THE PREFERENTIAL PROCUREMENT POLICY FRAMEWORK ACT, 2000 AND THE PREFERENTIAL PROCUREMENT REGULATIONS, 2017, THE GENERAL CONDITIONS OF CONTRACT (GCC) AND, IF APPLICABLE, ANY OTHER SPECIAL CONDITIONS OF CONTRACT.
- 1.4. THE SUCCESSFUL BIDDER WILL BE ENGAGED WITH NEGOTIATIONS BY THE CSIR THAT MIGHT RESULT IN THE ISSUING OF A PURCHASE ORDER.

2. TAX COMPLIANCE REQUIREMENTS

- 2.1 BIDDERS MUST ENSURE COMPLIANCE WITH THEIR TAX OBLIGATIONS.
- 2.2 BIDDERS ARE REQUIRED TO SUBMIT THEIR UNIQUE PERSONAL IDENTIFICATION NUMBER (PIN) ISSUED BY SARS TO ENABLE THE CSIR TO VERIFY THE TAXPAYER'S PROFILE AND TAX STATUS.
- 2.3 APPLICATION FOR TAX COMPLIANCE STATUS (TCS) PIN MAY BE MADE VIA E-FILING THROUGH THE SARS WEBSITE WWW.SARS.GOV.ZA.
- 2.4 BIDDERS MAY ALSO SUBMIT A PRINTED TCS CERTIFICATE TOGETHER WITH THE BID.
- 2.5 IN BIDS WHERE CONSORTIA / JOINT VENTURES / SUB-CONTRACTORS ARE INVOLVED, EACH PARTY MUST SUBMIT A SEPARATE TCS CERTIFICATE / PIN / CSD NUMBER.
- 2.6 WHERE NO TCS IS AVAILABLE BUT THE BIDDER IS REGISTERED ON THE CENTRAL SUPPLIER DATABASE (CSD), A CSD NUMBER MUST BE PROVIDED.
- 2.7 NO BIDS WILL BE CONSIDERED FROM PERSONS IN THE SERVICE OF THE STATE, COMPANIES WITH DIRECTORS WHO ARE PERSONS IN THE SERVICE OF THE STATE, OR CLOSE CORPORATIONS WITH MEMBERS PERSONS IN THE SERVICE OF THE STATE

NB: FAILURE TO PROVIDE / OR COMPLY WITH ANY OF THE ABOVE PARTICULARS MAY RENDER THE BID INVALID.

SIGNATURE OF BIDDER:

.....

CAPACITY UNDER WHICH THIS BID IS SIGNED:

.....

(Proof of authority must be submitted e.g. company resolution)

DATE:

.....

BIDDER'S DISCLOSURE

1. PURPOSE OF THE FORM

Any person (natural or juristic) may make an offer or offers in terms of invitation to bid. In line with the principles of transparency, accountability, impartiality, and ethics as enshrined in the Constitution of the Republic of South Africa and further expressed in various pieces of legislation, it is required for the bidder to make this declaration in respect of the details required hereunder.

Where a person/s are listed in the Register for Tender Defaulters and / or the List of Restricted Suppliers, that person will automatically be disqualified from the bid process.

2. Bidder's declaration

- 2.1 Is the bidder, or any of its directors / trustees / shareholders / members / partners or any person having a controlling interest¹ in the enterprise, employed by the state? **YES/NO**

- 2.1.1 If so, furnish particulars of the names, individual identity numbers, and, if applicable, state employee numbers of sole proprietor/ directors / trustees / shareholders / members/ partners or any person having a controlling interest in the enterprise, in table below.

Full Name	Identity Number	Name of State institution

- 2.2 Do you, or any person connected with the bidder, have a relationship with any person who is employed by the procuring institution? **YES/NO**

- 2.2.1 If so, furnish particulars:

.....

- 2.3 Does the bidder or any of its directors / trustees / shareholders / members / partners or any person having a controlling interest in the enterprise have any interest in any other related enterprise whether or not they are bidding for this contract? **YES/NO**

- 2.3.1 If so, furnish particulars:

.....

3 DECLARATION

¹ the power, by one person or a group of persons holding the majority of the equity of an enterprise, alternatively, the person/s having the deciding vote or power to influence or to direct the course and decisions of the enterprise.

I, (name)..... in submitting the accompanying bid, do hereby make the following statements that I certify to be true and complete in every respect:

- 3.1 I have read and I understand the contents of this disclosure;
- 3.2 I understand that the accompanying bid will be disqualified if this disclosure is found not to be true and complete in every respect;
- 3.3 The bidder has arrived at the accompanying bid independently from, and without consultation, communication, agreement or arrangement with any competitor. However, communication between partners in a joint venture or consortium² will not be construed as collusive bidding.
- 3.4 In addition, there have been no consultations, communications, agreements or arrangements with any competitor regarding the quality, quantity, specifications, prices, including methods, factors or formulas used to calculate prices, market allocation, the intention or decision to submit or not to submit the bid, bidding with the intention not to win the bid and conditions or delivery particulars of the products or services to which this bid invitation relates.
- 3.4 The terms of the accompanying bid have not been, and will not be, disclosed by the bidder, directly or indirectly, to any competitor, prior to the date and time of the official bid opening or of the awarding of the contract.
- 3.5 There have been no consultations, communications, agreements or arrangements made by the bidder with any official of the procuring institution in relation to this procurement process prior to and during the bidding process except to provide clarification on the bid submitted where so required by the institution; and the bidder was not involved in the drafting of the specifications or terms of reference for this bid.
- 3.6 I am aware that, in addition and without prejudice to any other remedy provided to combat any restrictive practices related to bids and contracts, bids that are suspicious will be reported to the Competition Commission for investigation and possible imposition of administrative penalties in terms of section 59 of the Competition Act No 89 of 1998 and or may be reported to the National Prosecuting Authority (NPA) for criminal investigation and or may be restricted from conducting business with the public sector for a period not exceeding ten (10) years in terms of the Prevention and Combating of Corrupt Activities Act No 12 of 2004 or any other applicable legislation.

I CERTIFY THAT THE INFORMATION FURNISHED IN PARAGRAPHS 1, 2 and 3 ABOVE IS CORRECT.

I ACCEPT THAT THE STATE MAY REJECT THE BID OR ACT AGAINST ME IN TERMS OF PARAGRAPH 6 OF PFMA SCM INSTRUCTION 03 OF 2021/22 ON PREVENTING AND COMBATING ABUSE IN THE SUPPLY CHAIN MANAGEMENT SYSTEM SHOULD THIS DECLARATION PROVE TO BE FALSE.

.....
Signature

.....
Date

.....
Position

.....
Name of bidder

² Joint venture or Consortium means an association of persons for the purpose of combining their expertise, property, capital, efforts, skill and knowledge in an activity for the execution of a contract.

PREFERENCE POINTS CLAIM FORM IN TERMS OF THE PREFERENTIAL PROCUREMENT REGULATIONS 2017

This preference form must form part of all bids invited. It contains general information and serves as a claim form for preference points for Broad-Based Black Economic Empowerment (B-BBEE) Status Level of Contribution

NB: BEFORE COMPLETING THIS FORM, BIDDERS MUST STUDY THE GENERAL CONDITIONS, DEFINITIONS AND DIRECTIVES APPLICABLE IN RESPECT OF B-BBEE, AS PRESCRIBED IN THE PREFERENTIAL PROCUREMENT REGULATIONS, 2017.

1. GENERAL CONDITIONS

1.1 The following preference point systems are applicable to all bids:

- the 80/20 system for requirements with a Rand value of up to R50 000 000 (all applicable taxes included); and
- the 90/10 system for requirements with a Rand value above R50 000 000 (all applicable taxes included).

a) The value of this bid is estimated to **not exceed** R50 000 000 (all applicable taxes included) and therefore the **80/20** Preference point system shall be applicable; or

b) Either the 80/20 or 90/10 preference point system will be applicable to this tender (*delete whichever is not applicable for this tender*).

1.2 Points for this bid shall be awarded for:

- (a) Price; and
- (b) B-BBEE Status Level of Contributor.

1.3 The maximum points for this bid are allocated as follows:

	POINTS
PRICE	80
B-BBEE STATUS LEVEL OF CONTRIBUTOR	20
Total points for Price and B-BBEE must not exceed	100

1.4 Failure on the part of a bidder to submit proof of B-BBEE Status level of contributor together with the bid, will be interpreted to mean that preference points for B-BBEE status level of contribution are not claimed.

1.5 The purchaser reserves the right to require of a bidder, either before a bid is adjudicated or at any time subsequently, to substantiate any claim in regard to preferences, in any manner required by the purchaser.

2. DEFINITIONS

- (a) **"B-BBEE"** means broad-based black economic empowerment as defined in section 1 of the Broad-Based Black Economic Empowerment Act;
- (b) **"B-BBEE status level of contributor"** means the B-BBEE status of an entity in terms of a code of good practice on black economic empowerment, issued in terms of section 9(1) of the Broad-Based Black Economic Empowerment Act;
- (c) **"bid"** means a written offer in a prescribed or stipulated form in response to an invitation by an organ of state for the provision of goods or services, through price quotations, advertised competitive bidding processes or proposals;
- (d) **"Broad-Based Black Economic Empowerment Act"** means the Broad-Based Black Economic Empowerment Act, 2003 (Act No. 53 of 2003);

- (e) **“EME”** means an Exempted Micro Enterprise in terms of a code of good practice on black economic empowerment issued in terms of section 9 (1) of the Broad-Based Black Economic Empowerment Act;
- (f) **“functionality”** means the ability of a tenderer to provide goods or services in accordance with specifications as set out in the tender documents.
- (g) **“prices”** includes all applicable taxes less all unconditional discounts;
- (h) **“proof of B-BBEE status level of contributor”** means:
1. B-BBEE Status level certificate issued by an authorized body or person;
 2. A sworn affidavit as prescribed by the B-BBEE Codes of Good Practice;
 3. Any other requirement prescribed in terms of the B-BBEE Act;
- (i) **“QSE”** means a qualifying small business enterprise in terms of a code of good practice on black economic empowerment issued in terms of section 9 (1) of the Broad-Based Black Economic Empowerment Act;
- (j) **“rand value”** means the total estimated value of a contract in Rand, calculated at the time of bid invitation, and includes all applicable taxes;

3. POINTS AWARDED FOR PRICE

3.1 THE 80/20 OR 90/10 PREFERENCE POINT SYSTEMS

A maximum of 80 or 90 points is allocated for price on the following basis:

$$P_s = 80 \left(1 - \frac{P_t - P_{\min}}{P_{\min}} \right) \quad \text{or} \quad P_s = 90 \left(1 - \frac{P_t - P_{\min}}{P_{\min}} \right)$$

80/20 or 90/10

Where

P_s = Points scored for price of bid under consideration

P_t = Price of bid under consideration

P_{\min} = Price of lowest acceptable bid

4. POINTS AWARDED FOR B-BBEE STATUS LEVEL OF CONTRIBUTOR

- 4.1 In terms of Regulation 6 (2) and 7 (2) of the Preferential Procurement Regulations, preference points must be awarded to a bidder for attaining the B-BBEE status level of contribution in accordance with the table below:

B-BBEE Status Level of Contributor	Number of points (90/10 system)	Number of points (80/20 system)
1	10	20
2	9	18
3	6	14
4	5	12
5	4	8
6	3	6
7	2	4
8	1	2
Non-compliant Contributor	0	0

5. BID DECLARATION

5.1 Bidders who claim points in respect of B-BBEE Status Level of Contribution must complete the following:

6. B-BBEE STATUS LEVEL OF CONTRIBUTOR CLAIMED IN TERMS OF PARAGRAPHS 1.4 AND 4.1

6.1 B-BBEE Status Level of Contributor: = (maximum of 10 or 20 points)

(Points claimed in respect of paragraph 7.1 must be in accordance with the table reflected in paragraph 4.1 and must be substantiated by relevant proof of B-BBEE status level of contributor.)

7. SUB-CONTRACTING

7.1 Will any portion of the contract be sub-contracted?

(Tick applicable box)

YES		NO	
-----	--	----	--

7.1.1 If yes, indicate:

- i) What percentage of the contract will be subcontracted.....%
- ii) The name of the sub-contractor.....
- iii) The B-BBEE status level of the sub-contractor.....
- iv) Whether the sub-contractor is an EME or QSE

(Tick applicable box)

YES		NO	
-----	--	----	--

- v) Specify, by ticking the appropriate box, if subcontracting with an enterprise in terms of Preferential Procurement Regulations, 2017:

Designated Group: An EME or QSE which is at least 51% owned by:	EME √	QSE √
Black people		
Black people who are youth		
Black people who are women		
Black people with disabilities		
Black people living in rural or underdeveloped areas or townships		
Cooperative owned by black people		
Black people who are military veterans		
OR		
Any EME		
Any QSE		

8. DECLARATION WITH REGARD TO COMPANY/FIRM

8.1 Name of company/firm:.....

8.2 VAT registration number:.....

8.3 Company registration number:.....

8.4 TYPE OF COMPANY/ FIRM

- ☐ Partnership/Joint Venture / Consortium
- ☐ One person business/sole propriety
- ☐ Close corporation
- ☐ Company
- ☐ (Pty) Limited

[TICK APPLICABLE BOX]

8.5 DESCRIBE PRINCIPAL BUSINESS ACTIVITIES

8.6 COMPANY CLASSIFICATION

- ☐ Manufacturer
- ☐ Supplier
- ☐ Professional service provider
- ☐ Other service providers, e.g. transporter, etc.

[TICK APPLICABLE BOX]

8.7 Total number of years the company/firm has been in business:.....

8.8 I/we, the undersigned, who is / are duly authorised to do so on behalf of the company/firm, certify that the points claimed, based on the B-BBE status level of contributor indicated in paragraphs 1.4 and 6.1 of the foregoing certificate, qualifies the company/ firm for the preference(s) shown and I / we acknowledge that:

- i) The information furnished is true and correct;
- ii) The preference points claimed are in accordance with the General Conditions as indicated in paragraph 1 of this form;
- iii) In the event of a contract being awarded as a result of points claimed as shown in paragraphs 1.4 and 6.1, the contractor may be required to furnish documentary proof to the satisfaction of the purchaser that the claims are correct;
- iv) If the B-BBEE status level of contributor has been claimed or obtained on a fraudulent basis or any of the conditions of contract have not been fulfilled, the purchaser may, in addition to any other remedy it may have –
 - (a) disqualify the person from the bidding process;
 - (b) recover costs, losses or damages it has incurred or suffered as a result of that person's conduct;
 - (c) cancel the contract and claim any damages which it has suffered as a result of having to make less favourable arrangements due to such cancellation;
 - (d) recommend that the bidder or contractor, its shareholders and directors, or only the shareholders and directors who acted on a fraudulent basis, be restricted by the National Treasury from obtaining business from any organ of state for a period not exceeding 10 years, after the *audi alteram partem* (hear the other side) rule has been applied; and
 - (e) forward the matter for criminal prosecution.

WITNESSES

1.

2.

.....
SIGNATURE(S) OF BIDDERS(S)

DATE:

ADDRESS

.....
.....

DECLARATION CERTIFICATE FOR LOCAL PRODUCTION AND CONTENT FOR DESIGNATED SECTORS

This Standard Bidding Document (SBD) must form part of all bids invited. It contains general information and serves as a declaration form for local content (local production and local content are used interchangeably).

Before completing this declaration, bidders must study the General Conditions, Definitions, Directives applicable in respect of Local Content as prescribed in the Preferential Procurement Regulations, 2011, the South African Bureau of Standards (SABS) approved technical specification number SATS 1286:2011 (Edition 1) and the Guidance on the Calculation of Local Content together with the Local Content Declaration Templates [Annex C (Local Content Declaration: Summary Schedule), D (Imported Content Declaration: Supporting Schedule to Annex C) and E (Local Content Declaration: Supporting Schedule to Annex C)].

1. General Conditions

- 1.1. Preferential Procurement Regulations, 2011 (Regulation 9) makes provision for the promotion of local production and content.
- 1.2. Regulation 9.(1) prescribes that in the case of designated sectors, where in the award of bids local production and content is of critical importance, such bids must be advertised with the specific bidding condition that only locally produced goods, services or works or locally manufactured goods, with a stipulated minimum threshold for local production and content will be considered.
- 1.3. Where necessary, for bids referred to in paragraph 1.2 above, a two stage bidding process may be followed, where the first stage involves a minimum threshold for local production and content and the second stage price and B-BBEE.
- 1.4. A person awarded a contract in relation to a designated sector, may not sub-contract in such a manner that the local production and content of the overall value of the contract is reduced to below the stipulated minimum threshold.
- 1.5. The local content (LC) expressed as a percentage of the bid price must be calculated in accordance with the SABS approved technical specification number SATS 1286: 2011 as follows:

$$LC = [1 - x / y] * 100$$

Where

x is the imported content in Rand

y is the bid price in Rand excluding value added tax (VAT)

Prices referred to in the determination of x must be converted to Rand (ZAR) by using the exchange rate published by South African Reserve Bank (SARB) at 12:00 on the date of advertisement of the bid as indicated in paragraph 4.1 below.

The SABS approved technical specification number SATS 1286:2011 is accessible on [http://www.thedti.gov.za/industrial development/ip.jsp](http://www.thedti.gov.za/industrial%20development/ip.jsp) at no cost.

- 1.6 A bid may be disqualified if –
 - (a) this Declaration Certificate and the Annex C (Local Content Declaration: Summary Schedule) are not submitted as part of the bid documentation; and
 - (b) the bidder fails to declare that the Local Content Declaration Templates (Annex C, D and E) have been audited and certified as correct.

2. Definitions

- 2.1. **"bid"** includes written price quotations, advertised competitive bids or proposals;
- 2.2. **"bid price"** price offered by the bidder, excluding value added tax (VAT);
- 2.3. **"contract"** means the agreement that results from the acceptance of a bid by an organ of state;
- 2.4. **"designated sector"** means a sector, sub-sector or industry that has been designated by the Department of Trade and Industry in line with national development and industrial policies for local production, where only locally produced services, works or goods or locally manufactured goods meet the stipulated minimum threshold for local production and content;
- 2.5. **"duly sign"** means a Declaration Certificate for Local Content that has been signed by the Chief Financial Officer or other legally responsible person nominated in writing by the Chief Executive, or senior member / person with management responsibility (close corporation, partnership or individual).
- 2.6. **"imported content"** means that portion of the bid price represented by the cost of components, parts or materials which have been or are still to be imported (whether by the supplier or its subcontractors) and which costs are inclusive of the costs abroad (this includes labour or intellectual property costs), plus freight and other direct importation costs, such as landing costs, dock duties, import duty, sales duty or other similar tax or duty at the South African port of entry;
- 2.7. **"local content"** means that portion of the bid price which is not included in the imported content, provided that local manufacture does take place;
- 2.8. **"stipulated minimum threshold"** means that portion of local production and content as determined by the Department of Trade and Industry; and
- 2.9. **"sub-contract"** means the primary contractor's assigning, leasing, making out work to, or employing another person to support such primary contractor in the execution of part of a project in terms of the contract.

3. The stipulated minimum threshold(s) for local production and content (refer to Annex A of SATS 1286:2011) for this bid is/are as follows:

<u>Description of services, works or goods</u>	<u>Stipulated minimum threshold</u>
_____	_____ %
_____	_____ %
_____	_____ %

4. Does any portion of the services, works or goods offered have any imported content?

(Tick applicable box)

YES		NO	
-----	--	----	--

- 4.1 If yes, the rate(s) of exchange to be used in this bid to calculate the local content as prescribed in paragraph 1.5 of the general conditions must be the rate(s) published by SARB for the specific currency at 12:00 on the date of advertisement of the bid.

The relevant rates of exchange information is accessible on www.reservebank.co.za.

Indicate the rate(s) of exchange against the appropriate currency in the table below (refer to Annex A of SATS 1286:2011):

Currency	Rates of exchange
US Dollar	
Pound Sterling	
Euro	
Yen	
Other	

NB: Bidders must submit proof of the SARB rate (s) of exchange used.

5. Were the Local Content Declaration Templates (Annex C, D and E) audited and certified as correct?

(Tick applicable box)

YES		NO	
-----	--	----	--

5.1. If yes, provide the following particulars:

- (a) Full name of auditor:
- (b) Practice number:
- (c) Telephone and cell number:
- (d) Email address:

(Documentary proof regarding the declaration will, when required, be submitted to the satisfaction of the Accounting Officer / Accounting Authority)

6. Where, after the award of a bid, challenges are experienced in meeting the stipulated minimum threshold for local content the dti must be informed accordingly in order for the dti to verify and in consultation with the AO/AA provide directives in this regard.

LOCAL CONTENT DECLARATION
(REFER TO ANNEX B OF SATS 1286:2011)

LOCAL CONTENT DECLARATION BY CHIEF FINANCIAL OFFICER OR OTHER LEGALLY RESPONSIBLE PERSON NOMINATED IN WRITING BY THE CHIEF EXECUTIVE OR SENIOR MEMBER/PERSON WITH MANAGEMENT RESPONSIBILITY (CLOSORPORATION, PARTNERSHIP OR INDIVIDUAL)

IN RESPECT OF BID NO.

ISSUED BY: (Procurement Authority / Name of Institution):
.....

NB

1. The obligation to complete, duly sign and submit this declaration cannot be transferred to an external authorized representative, auditor or any other third party acting on behalf of the bidder.
3. Guidance on the Calculation of Local Content together with Local Content Declaration Templates (Annex C, D and E) is accessible on <http://www.thdti.gov.za/industrialdevelopment/ip.jsp>. Bidders should first complete Declaration D. After completing Declaration D, bidders should complete Declaration E and then consolidate the information on Declaration C.
Declaration C should be submitted with the bid documentation at the closing date and time of the bid in order to substantiate the declaration made in paragraph (c) below. Declarations D and E should be kept by the bidders for verification purposes for a period of at least 5 years. The successful bidder is required to continuously update Declarations C, D and E with the actual values for the duration of the contract.

I, the undersigned, (full names),
do hereby declare, in my capacity as
of (name of bidder entity),
the following:

- (a) The facts contained herein are within my own personal knowledge.
- (b) I have satisfied myself that:
 - (i) the goods/services/works to be delivered in terms of the above-specified bid comply with the minimum local content requirements as specified in the bid, and as measured in terms of SATS 1286:2011; and
 - (ii) the declaration templates have been audited and certified to be correct.
- (c) The local content percentage (%) indicated below has been calculated using the formula given in clause 3 of SATS 1286:2011, the rates of exchange indicated in paragraph 4.1 above and the information contained in Declaration D and E which has been consolidated in Declaration C:

Bid price, excluding VAT (y)	R
Imported content (x), as calculated in terms of SATS 1286:2011	R
Stipulated minimum threshold for local content (paragraph 3 above)	
Local content %, as calculated in terms of SATS 1286:2011	

If the bid is for more than one product, the local content percentages for each product contained in Declaration C shall be used instead of the table above.

The local content percentages for each product has been calculated using the formula given in clause 3 of SATS 1286:2011, the rates of exchange indicated in paragraph 4.1 above and the information contained in Declaration D and E.

(d) I accept that the Procurement Authority / Institution has the right to request that the local content be verified in terms of the requirements of SATS 1286:2011.

(e) I understand that the awarding of the bid is dependent on the accuracy of the information furnished in this application. I also understand that the submission of incorrect data, or data that are not verifiable as described in SATS 1286:2011, may result in the Procurement Authority / Institution imposing any or all of the remedies as provided for in Regulation 13 of the Preferential Procurement Regulations, 2011 promulgated under the Preferential Policy Framework Act (PPPFA), 2000 (Act No. 5 of 2000).

SIGNATURE: _____

DATE: _____

WITNESS No. 1 _____

DATE: _____

WITNESS No. 2 _____

DATE: _____

38

13 DARD 04/2022: CONSTRUCTION OF 20 SOW UNIT HOUSE AT INYAMA YETHU PTY (LTD) IN MADIBENG MUNICIPALITY, BOJANALA PLATINUM DISTRICT

Note: VAT to be excluded from all calculations

[illegible][illegible]

Date:

THE NATIONAL TREASURY
Republic of South Africa



GOVERNMENT PROCUREMENT:

GENERAL CONDITIONS OF CONTRACT

July 2010

The purpose of this document is to:

- (i) Draw special attention to certain general conditions applicable to government bids, contracts and orders; and
- (ii) To ensure that clients be familiar with regard to the rights and obligations of all parties involved in doing business with government.

In this document words in the singular also mean in the plural and vice versa and words in the masculine also mean in the feminine and neuter.

- The General Conditions of Contract will form part of all bid documents and may not be amended.
- Special Conditions of Contract (SCC) relevant to a specific bid, should be compiled separately for every bid (if applicable) and will supplement the General Conditions of Contract. Whenever there is a conflict, the provisions in the SCC shall prevail.

TABLE OF CLAUSES

1. Definitions
2. Application
3. General
4. Standards
5. Use of contract documents and information; inspection
6. Patent rights
7. Performance security
8. Inspections, tests and analysis
9. Packing
10. Delivery and documents
11. Insurance
12. Transportation
13. Incidental services
14. Spare parts
15. Warranty
16. Payment
17. Prices
18. Contract amendments
19. Assignment
20. Subcontracts
21. Delays in the supplier's performance
22. Penalties
23. Termination for default
24. Dumping and countervailing duties
25. Force Majeure
26. Termination for insolvency
27. Settlement of disputes
28. Limitation of liability
29. Governing language
30. Applicable law
31. Notices
32. Taxes and duties
33. National Industrial Participation Programme (NIPP)
34. Prohibition of restrictive practices

General Conditions of Contract

1. Definitions

1. The following terms shall be interpreted as indicated:
 - 1.1 "Closing time" means the date and hour specified in the bidding documents for the receipt of bids.
 - 1.2 "Contract" means the written agreement entered into between the purchaser and the supplier, as recorded in the contract form signed by the parties, including all attachments and appendices thereto and all documents incorporated by reference therein.
 - 1.3 "Contract price" means the price payable to the supplier under the contract for the full and proper performance of his contractual obligations.
 - 1.4 "Corrupt practice" means the offering, giving, receiving, or soliciting of anything of value to influence the action of a public official in the procurement process or in contract execution.
 - 1.5 "Countervailing duties" are imposed in cases where an enterprise abroad is subsidized by its government and encouraged to market its products internationally.
 - 1.6 "Country of origin" means the place where the goods were mined, grown or produced or from which the services are supplied. Goods are produced when, through manufacturing, processing or substantial and major assembly of components, a commercially recognized new product results that is substantially different in basic characteristics or in purpose or utility from its components.
 - 1.7 "Day" means calendar day.
 - 1.8 "Delivery" means delivery in compliance of the conditions of the contract or order.
 - 1.9 "Delivery ex stock" means immediate delivery directly from stock actually on hand.
 - 1.10 "Delivery into consignees store or to his site" means delivered and unloaded in the specified store or depot or on the specified site in compliance with the conditions of the contract or order, the supplier bearing all risks and charges involved until the supplies are so delivered and a valid receipt is obtained.
 - 1.11 "Dumping" occurs when a private enterprise abroad market its goods on own initiative in the RSA at lower prices than that of the country of origin and which have the potential to harm the local industries in the RSA.
 - 1.12 "Force majeure" means an event beyond the control of the supplier and not involving the supplier's fault or negligence and not foreseeable. Such events may include, but is not restricted to, acts of the purchaser in its sovereign capacity, wars or revolutions, fires, floods, epidemics, quarantine restrictions and freight embargoes.

- 1.13 "Fraudulent practice" means a misrepresentation of facts in order to influence a procurement process or the execution of a contract to the detriment of any bidder and includes collusive practice among bidders (prior to or after bid submission) designed to establish bid prices at artificial non-competitive levels and to deprive the bidder of the benefits of free and open competition.
- 1.14 "GCC" means the General Conditions of Contract.
- 1.15 "Goods" means all of the equipment, machinery, and/or other materials that the supplier is required to supply to the purchaser under the contract.
- 1.16 "Imported content" means that portion of the bidding price represented by the cost of components, parts or materials which have been or are still to be imported (whether by the supplier or his subcontractors) and which costs are inclusive of the costs abroad, plus freight and other direct importation costs such as landing costs, dock dues, import duty, sales duty or other similar tax or duty at the South African place of entry as well as transportation and handling charges to the factory in the Republic where the supplies covered by the bid will be manufactured.
- 1.17 "Local content" means that portion of the bidding price which is not included in the imported content provided that local manufacture does take place.
- 1.18 "Manufacture" means the production of products in a factory using labour, materials, components, and machinery and includes other related value-adding activities.
- 1.19 "Order" means an official written order issued for the supply of goods or works or the rendering of a service.
- 1.20 "Project site," where applicable, means the place indicated in bidding documents.
- 1.21 "Purchaser" means the organization purchasing the goods.
- 1.22 "Republic" means the Republic of South Africa.
- 1.23 "SCC" means the Special Conditions of Contract.
- 1.24 "Services" means those functional services ancillary to the supply of the goods, such as transportation and any other incidental services, such as installation, commissioning, provision of technical assistance, training, catering, gardening, security, maintenance and other such obligations of the supplier covered under the contract.
- 1.25 "Written" or "in writing" means handwritten in ink or any form of electronic or mechanical writing.
- 2.1 These general conditions are applicable to all bids, contracts and orders including bids for functional and professional services, sales, hiring, letting and the granting or acquiring of rights, but excluding immovable property, unless otherwise indicated in the bidding documents.

2. Application

- 2.2 Where applicable, special conditions of contract are also laid down to cover specific supplies, services or works.
- 2.3 Where such special conditions of contract are in conflict with these general conditions, the special conditions shall apply.

3. General

- 3.1 Unless otherwise indicated in the bidding documents, the purchaser shall not be liable for any expense incurred in the preparation and submission of a bid. Where applicable a non-refundable fee for documents may be charged.
- 3.2 With certain exceptions, invitations to bid are only published in the Government Tender Bulletin. The Government Tender Bulletin may be obtained directly from the Government Printer, Private Bag X85, Pretoria 0001, or accessed electronically from www.treasury.gov.za

4. Standards

- 4.1 The goods supplied shall conform to the standards mentioned in the bidding documents and specifications.

5. Use of contract documents and information; inspection.

- 5.1 The supplier shall not, without the purchaser's prior written consent, disclose the contract, or any provision thereof, or any specification, plan, drawing, pattern, sample, or information furnished by or on behalf of the purchaser in connection therewith, to any person other than a person employed by the supplier in the performance of the contract. Disclosure to any such employed person shall be made in confidence and shall extend only so far as may be necessary for purposes of such performance.
- 5.2 The supplier shall not, without the purchaser's prior written consent, make use of any document or information mentioned in GCC clause 5.1 except for purposes of performing the contract.
- 5.3 Any document, other than the contract itself mentioned in GCC clause 5.1 shall remain the property of the purchaser and shall be returned (all copies) to the purchaser on completion of the supplier's performance under the contract if so required by the purchaser.
- 5.4 The supplier shall permit the purchaser to inspect the supplier's records relating to the performance of the supplier and to have them audited by auditors appointed by the purchaser, if so required by the purchaser.

6. Patent rights

- 6.1 The supplier shall indemnify the purchaser against all third-party claims of infringement of patent, trademark, or industrial design rights arising from use of the goods or any part thereof by the purchaser.

7. Performance security

- 7.1 Within thirty (30) days of receipt of the notification of contract award, the successful bidder shall furnish to the purchaser the performance security of the amount specified in SCC.
- 7.2 The proceeds of the performance security shall be payable to the purchaser as compensation for any loss resulting from the supplier's failure to complete his obligations under the contract.
- 7.3 The performance security shall be denominated in the currency of the contract, or in a freely convertible currency acceptable to the purchaser and shall be in one of the following forms:

- (a) a bank guarantee or an irrevocable letter of credit issued by a reputable bank located in the purchaser's country or abroad, acceptable to the purchaser, in the form provided in the bidding documents or another form acceptable to the purchaser; or
 - (b) a cashier's or certified cheque
- 7.4 The performance security will be discharged by the purchaser and returned to the supplier not later than thirty (30) days following the date of completion of the supplier's performance obligations under the contract, including any warranty obligations, unless otherwise specified in SCC.

8. Inspections, tests and analyses

- 8.1 All pre-bidding testing will be for the account of the bidder.
- 8.2 If it is a bid condition that supplies to be produced or services to be rendered should at any stage during production or execution or on completion be subject to inspection, the premises of the bidder or contractor shall be open, at all reasonable hours, for inspection by a representative of the Department or an organization acting on behalf of the Department.
- 8.3 If there are no inspection requirements indicated in the bidding documents and no mention is made in the contract, but during the contract period it is decided that inspections shall be carried out, the purchaser shall itself make the necessary arrangements, including payment arrangements with the testing authority concerned.
- 8.4 If the inspections, tests, and analyses referred to in clauses 8.2 and 8.3 show the supplies to be in accordance with the contract requirements, the cost of the inspections, tests and analyses shall be defrayed by the purchaser.
- 8.5 Where the supplies or services referred to in clauses 8.2 and 8.3 do not comply with the contract requirements, irrespective of whether such supplies or services are accepted or not, the cost in connection with these inspections, tests or analyses shall be defrayed by the supplier.
- 8.6 Supplies and services which are referred to in clauses 8.2 and 8.3 and which do not comply with the contract requirements may be rejected.
- 8.7 Any contract supplies may on or after delivery be inspected, tested, or analyzed and may be rejected if found not to comply with the requirements of the contract. Such rejected supplies shall be held at the cost and risk of the supplier who shall, when called upon, remove them immediately at his own cost and forthwith substitute them with supplies which do comply with the requirements of the contract. Failing such removal, the rejected supplies shall be returned at the suppliers cost and risk. Should the supplier fail to provide the substitute supplies forthwith, the purchaser may, without giving the supplier further opportunity to substitute the rejected supplies, purchase such supplies as may be necessary at the expense of the supplier.

- 8.8 The provisions of clauses 8.4 to 8.7 shall not prejudice the right of the purchaser to cancel the contract on account of a breach of the conditions thereof, or to act in terms of Clause 23 of GCC.

9. Packing

- 9.1 The supplier shall provide such packing of the goods as is required to prevent their damage or deterioration during transit to their destination, as indicated in the contract. The packing shall be sufficient to withstand, without limitation, rough handling during transit and exposure to extreme temperatures, salt and precipitation during transit, and open storage. Packing, case size and weights shall take into consideration, where appropriate, the remoteness of the goods' destination and the absence of heavy handling facilities at all points in transit.
- 9.2 The packing, marking, and documentation within and outside the packages shall comply strictly with such special requirements as shall be expressly provided for in the contract, including additional requirements, if any, specified in SCC, and in any subsequent instructions ordered by the purchaser.

10. Delivery and documents

- 10.1 Delivery of the goods shall be made by the supplier in accordance with the terms specified in the contract. The details of shipping and/or other documents to be furnished by the supplier are specified in SCC.
- 10.2 Documents to be submitted by the supplier are specified in SCC.

11. Insurance

- 11.1 The goods supplied under the contract shall be fully insured in a freely convertible currency against loss or damage incidental to manufacture or acquisition, transportation, storage and delivery in the manner specified in the SCC.

12. Transportation

- 12.1 Should a price other than an all-inclusive delivered price be required, this shall be specified in the SCC.

13. Incidental services

- 13.1 The supplier may be required to provide any or all of the following services, including additional services, if any, specified in SCC:
- (a) performance or supervision of on-site assembly and/or commissioning of the supplied goods.
 - (b) furnishing of tools required for assembly and/or maintenance of the supplied goods.
 - (c) furnishing of a detailed operations and maintenance manual for each appropriate unit of the supplied goods.
 - (d) performance or supervision or maintenance and/or repair of the supplied goods, for a period of time agreed by the parties, provided that this service shall not relieve the supplier of any warranty obligations under this contract; and
 - (e) training of the purchaser's personnel, at the supplier's plant and/or on-site, in assembly, start-up, operation, maintenance, and/or repair of the supplied goods.
- 13.2 Prices charged by the supplier for incidental services, if not included in the contract price for the goods, shall be agreed upon in advance by the parties and shall not exceed the prevailing rates charged to other parties by the supplier for similar services.

- 14. Spare parts**
- 14.1 As specified in SCC, the supplier may be required to provide any or all of the following materials, notifications, and information pertaining to spare parts manufactured or distributed by the supplier:
- (a) such spare parts as the purchaser may elect to purchase from the supplier, provided that this election shall not relieve the supplier of any warranty obligations under the contract; and
 - (b) in the event of termination of production of the spare parts:
 - (i) Advance notification to the purchaser of the pending termination, in sufficient time to permit the purchaser to procure needed requirements; and
 - (ii) following such termination, furnishing at no cost to the purchaser, the blueprints, drawings, and specifications of the spare parts, if requested.
- 15. Warranty**
- 15.1 The supplier warrants that the goods supplied under the contract are new, unused, of the most recent or current models, and that they incorporate all recent improvements in design and materials unless provided otherwise in the contract. The supplier further warrants that all goods supplied under this contract shall have no defect, arising from design, materials, or workmanship (except when the design and/or material is required by the purchaser's specifications) or from any act or omission of the supplier, that may develop under normal use of the supplied goods in the conditions prevailing in the country of final destination.
- 15.2 This warranty shall remain valid for twelve (12) months after the goods, or any portion thereof as the case may be, have been delivered to and accepted at the final destination indicated in the contract, or for eighteen (18) months after the date of shipment from the port or place of loading in the source country, whichever period concludes earlier, unless specified otherwise in SCC.
- 15.3 The purchaser shall promptly notify the supplier in writing of any claims arising under this warranty.
- 15.4 Upon receipt of such notice, the supplier shall, within the period specified in SCC and with all reasonable speed, repair or replace the defective goods or parts thereof, without costs to the purchaser.
- 15.5 If the supplier, having been notified, fails to remedy the defect(s) within the period specified in SCC, the purchaser may proceed to take such remedial action as may be necessary, at the supplier's risk and expense and without prejudice to any other rights which the purchaser may have against the supplier under the contract.
- 16. Payment**
- 16.1 The method and conditions of payment to be made to the supplier under this contract shall be specified in SCC.
- 16.2 The supplier shall furnish the purchaser with an invoice accompanied by a copy of the delivery note and upon fulfillment of other obligations stipulated in the contract.

- 16.3 Payments shall be made promptly by the purchaser, but in no case later than thirty (30) days after submission of an invoice or claim by the supplier.
- 16.4 Payment will be made in Rand unless otherwise stipulated in SCC.
- 17. Prices**
- 17.1 Prices charged by the supplier for goods delivered and services performed under the contract shall not vary from the prices quoted by the supplier in his bid, with the exception of any price adjustments authorized in SCC or in the purchaser's request for bid validity extension, as the case may be.
- 18. Contract amendments**
- 18.1 No variation in or modification of the terms of the contract shall be made except by written amendment signed by the parties concerned.
- 19. Assignment**
- 19.1 The supplier shall not assign, in whole or in part, its obligations to perform under the contract, except with the purchaser's prior written consent.
- 20. Subcontracts**
- 20.1 The supplier shall notify the purchaser in writing of all subcontracts awarded under this contract if not already specified in the bid. Such notification, in the original bid or later, shall not relieve the supplier from any liability or obligation under the contract.
- 21. Delays in the supplier's performance**
- 21.1 Delivery of the goods and performance of services shall be made by the supplier in accordance with the time schedule prescribed by the purchaser in the contract.
- 21.2 If at any time during performance of the contract, the supplier or its subcontractor(s) should encounter conditions impeding timely delivery of the goods and performance of services, the supplier shall promptly notify the purchaser in writing of the fact of the delay, its likely duration and its cause(s). As soon as practicable after receipt of the supplier's notice, the purchaser shall evaluate the situation and may at his discretion extend the supplier's time for performance, with or without the imposition of penalties, in which case the extension shall be ratified by the parties by amendment of contract.
- 21.3 No provision in a contract shall be deemed to prohibit the obtaining of supplies or services from a national department, provincial department, or a local authority.
- 21.4 The right is reserved to procure outside of the contract small quantities or to have minor essential services executed if an emergency arises, the supplier's point of supply is not situated at or near the place where the supplies are required, or the supplier's services are not readily available.
- 21.5 Except as provided under GCC Clause 25, a delay by the supplier in the performance of its delivery obligations shall render the supplier liable to the imposition of penalties, pursuant to GCC Clause 22, unless an extension of time is agreed upon pursuant to GCC Clause 21.2 without the application of penalties.
- 21.6 Upon any delay beyond the delivery period in the case of a supplies contract, the purchaser shall, without cancelling the contract, be entitled to purchase supplies of a similar quality and up to the same

quantity in substitution of the goods not supplied in conformity with the contract and to return any goods delivered later at the supplier's expense and risk, or to cancel the contract and buy such goods as may be required to complete the contract and without prejudice to his other rights, be entitled to claim damages from the supplier.

22. Penalties

- 22.1 Subject to GCC Clause 25, if the supplier fails to deliver any or all of the goods or to perform the services within the period(s) specified in the contract, the purchaser shall, without prejudice to its other remedies under the contract, deduct from the contract price, as a penalty, a sum calculated on the delivered price of the delayed goods or unperformed services using the current prime interest rate calculated for each day of the delay until actual delivery or performance. The purchaser may also consider termination of the contract pursuant to GCC Clause 23.

23. Termination for default

- 23.1 The purchaser, without prejudice to any other remedy for breach of contract, by written notice of default sent to the supplier, may terminate this contract in whole or in part:
- a) the supplier fails to deliver any or all of the goods within the period(s) specified in the contract, or within any extension thereof granted by the purchaser pursuant to GCC Clause 21.2;
 - b) if the Supplier fails to perform any other obligation(s) under the contract; or
 - c) if the supplier, in the judgment of the purchaser, has engaged in corrupt or fraudulent practices in competing for or in executing the contract.
- 23.2 In the event the purchaser terminates the contract in whole or in part, the purchaser may procure, upon such terms and in such manner as it deems appropriate, goods, works or services similar to those undelivered, and the supplier shall be liable to the purchaser for any excess costs for such similar goods, works or services. However, the supplier shall continue performance of the contract to the extent not terminated.
- 23.3 Where the purchaser terminates the contract in whole or in part, the purchaser may decide to impose a restriction penalty on the supplier by prohibiting such supplier from doing business with the public sector for a period not exceeding 10 years.
- 23.4 If a purchaser intends imposing a restriction on a supplier or any person associated with the supplier, the supplier will be allowed a time period of not more than fourteen (14) days to provide reasons why the envisaged restriction should not be imposed. Should the supplier fail to respond within the stipulated fourteen (14) days the purchaser may regard the intended penalty as not objected against and may impose it on the supplier.
- 23.5 Any restriction imposed on any person by the Accounting Officer / Authority will, at the discretion of the Accounting Officer / Authority, also be applicable to any other enterprise or any partner, manager, director or other person who wholly or partly exercises or exercised or

may exercise control over the enterprise of the first-mentioned person, and with which enterprise or person the first-mentioned person, is or was in the opinion of the Accounting Officer / Authority actively associated.

- 23.6 If a restriction is imposed, the purchaser must, within five (5) working days of such imposition, furnish the National Treasury, with the following information:
- (i) the name and address of the supplier and / or person restricted by the purchaser;
 - (ii) the date of commencement of the restriction
 - (iii) the period of restriction; and
 - (iv) the reasons for the restriction.

These details will be loaded in the National Treasury's central database of suppliers or persons prohibited from doing business with the public sector.

- 23.7 If a court of law convicts a person of an offence as contemplated in sections 12 or 13 of the Prevention and Combating of Corrupt Activities Act, No. 12 of 2004, the court may also rule that such person's name be endorsed on the Register for Tender Defaulters. When a person's name has been endorsed on the Register, the person will be prohibited from doing business with the public sector for a period not less than five years and not more than 10 years. The National Treasury is empowered to determine the period of restriction and each case will be dealt with on its own merits. According to section 32 of the Act the Register must be open to the public. The Register can be perused on the National Treasury website.

24. Anti-dumping and countervailing duties and rights

- 24.1 When, after the date of bid, provisional payments are required, or anti-dumping or countervailing duties are imposed, or the amount of a provisional payment or anti-dumping or countervailing right is increased in respect of any dumped or subsidized import, the State is not liable for any amount so required or imposed, or for the amount of any such increase. When, after the said date, such a provisional payment is no longer required or any such anti-dumping or countervailing right is abolished, or where the amount of such provisional payment or any such right is reduced, any such favourable difference shall on demand be paid forthwith by the contractor to the State or the State may deduct such amounts from moneys (if any) which may otherwise be due to the contractor in regard to supplies or services which he delivered or rendered, or is to deliver or render in terms of the contract or any other contract or any other amount which may be due to him

25. Force Majeure

- 25.1 Notwithstanding the provisions of GCC Clauses 22 and 23, the supplier shall not be liable for forfeiture of its performance security, damages, or termination for default if and to the extent that his delay in performance or other failure to perform his obligations under the contract is the result of an event of force majeure.
- 25.2 If a force majeure situation arises, the supplier shall promptly notify the purchaser in writing of such condition and the cause thereof. Unless otherwise directed by the purchaser in writing, the supplier shall

continue to perform its obligations under the contract as far as is reasonably practical and shall seek all reasonable alternative means for performance not prevented by the force majeure event.

26. Termination for insolvency

26.1 The purchaser may at any time terminate the contract by giving written notice to the supplier if the supplier becomes bankrupt or otherwise insolvent. In this event, termination will be without compensation to the supplier, provided that such termination will not prejudice or affect any right of action or remedy which has accrued or will accrue thereafter to the purchaser.

27. Settlement of Disputes

27.1 If any dispute or difference of any kind whatsoever arises between the purchaser and the supplier in connection with or arising out of the contract, the parties shall make every effort to resolve amicably such dispute or difference by mutual consultation.

27.2 If, after thirty (30) days, the parties have failed to resolve their dispute or difference by such mutual consultation, then either the purchaser or the supplier may give notice to the other party of his intention to commence with mediation. No mediation in respect of this matter may be commenced unless such notice is given to the other party.

27.3 Should it not be possible to settle a dispute by means of mediation, it may be settled in a South African court of law.

27.4 Mediation proceedings shall be conducted in accordance with the rules of procedure specified in the SCC.

27.5 Notwithstanding any reference to mediation and/or court proceedings herein,

(a) the parties shall continue to perform their respective obligations under the contract unless they otherwise agree; and

(b) the purchaser shall pay the supplier any monies due the supplier.

28. Limitation of liability

28.1 Except in cases of criminal negligence or willful misconduct, and in the case of infringement pursuant to Clause 6;

(a) the supplier shall not be liable to the purchaser, whether in contract, tort, or otherwise, for any indirect or consequential loss or damage, loss of use, loss of production, or loss of profits or interest costs, provided that this exclusion shall not apply to any obligation of the supplier to pay penalties and/or damages to the purchaser; and

(c) the aggregate liability of the supplier to the purchaser, whether under the contract, in tort or otherwise, shall not exceed the total contract price, provided that this limitation shall not apply to the cost of repairing or replacing defective equipment.

29. Governing language

29.1 The contract shall be written in English. All correspondence and other documents pertaining to the contract that is exchanged by the parties shall also be written in English.

30. Applicable law

30.1 The contract shall be interpreted in accordance with South African laws, unless otherwise specified in SCC.

31. Notices

- 31.1 Every written acceptance of a bid shall be posted to the supplier concerned by registered or certified mail and any other notice to him shall be posted by ordinary mail to the address furnished in his bid or to the address notified later by him in writing and such posting shall be deemed to be proper service of such notice.
- 31.2 The time mentioned in the contract documents for performing any act after such aforesaid notice has been given, shall be reckoned from the date of posting of such notice.

32. Taxes and duties

- 32.1 A foreign supplier shall be entirely responsible for all taxes, stamp duties, license fees, and other such levies imposed outside the purchaser's country.
- 32.2 A local supplier shall be entirely responsible for all taxes, duties, license fees, etc., incurred until delivery of the contracted goods to the purchaser.
- 32.3 No contract shall be concluded with any bidder whose tax matters are not in order. Prior to the award of a bid the Department must be in possession of a tax clearance certificate, submitted by the bidder. This certificate must be an original issued by the South African Revenue Services.

33. National Industrial Participation (NIP) Programme

- 33.1 The NIP Programme administered by the Department of Trade and Industry shall be applicable to all contracts that are subject to the NIP obligation.

34 Prohibition of Restrictive practices

- 34.1 In terms of section 4 (1) (b) (iii) of the Competition Act No. 89 of 1998, as amended, an agreement between, or concerted practice by, firms, or a decision by an association of firms, is prohibited if it is between parties in a horizontal relationship and if a bidder (s) is / are or a contractor(s) was / were involved in collusive bidding (or bid rigging).
- 34.2 If a bidder(s) or contractor(s), based on reasonable grounds or evidence obtained by the purchaser, has / have engaged in the restrictive practice referred to above, the purchaser may refer the matter to the Competition Commission for investigation and possible imposition of administrative penalties as contemplated in the Competition Act No. 89 of 1998.
- 34.3 If a bidder(s) or contractor(s), has / have been found guilty by the Competition Commission of the restrictive practice referred to above, the purchaser may, in addition and without prejudice to any other remedy provided for, invalidate the bid(s) for such item(s) offered, and / or terminate the contract in whole or part, and / or restrict the bidder(s) or contractor(s) from conducting business with the public sector for a period not exceeding ten (10) years and / or claim damages from the bidder(s) or contractor(s) concerned.

