

**CWType H** Crealco Clip44 or eq. approved aluminium shopfront system, incl fixed lights, per layout.  
Fixing suitable for fixing to concrete / brickwork reveals.  
**Exposure** AAAMSA exposure category: A0, SANS613 - 600Pa wind load capacity  
**Coating:** Class 2 powder coated to SANS 10322:2014; Coatings in accordance with SANS 1796 using powders in accordance with SANS 1578.  
**colour:** TBC. Provisionally Mat Black

Glazing Glazing throughout to be 12mm thick toughened safety glass , per PFG Armourplate.

SHGC: N/A

U-Value N/A

Curtains: N/A

QUANTITY: 2 Excl Curtains  
CG13  
CG21

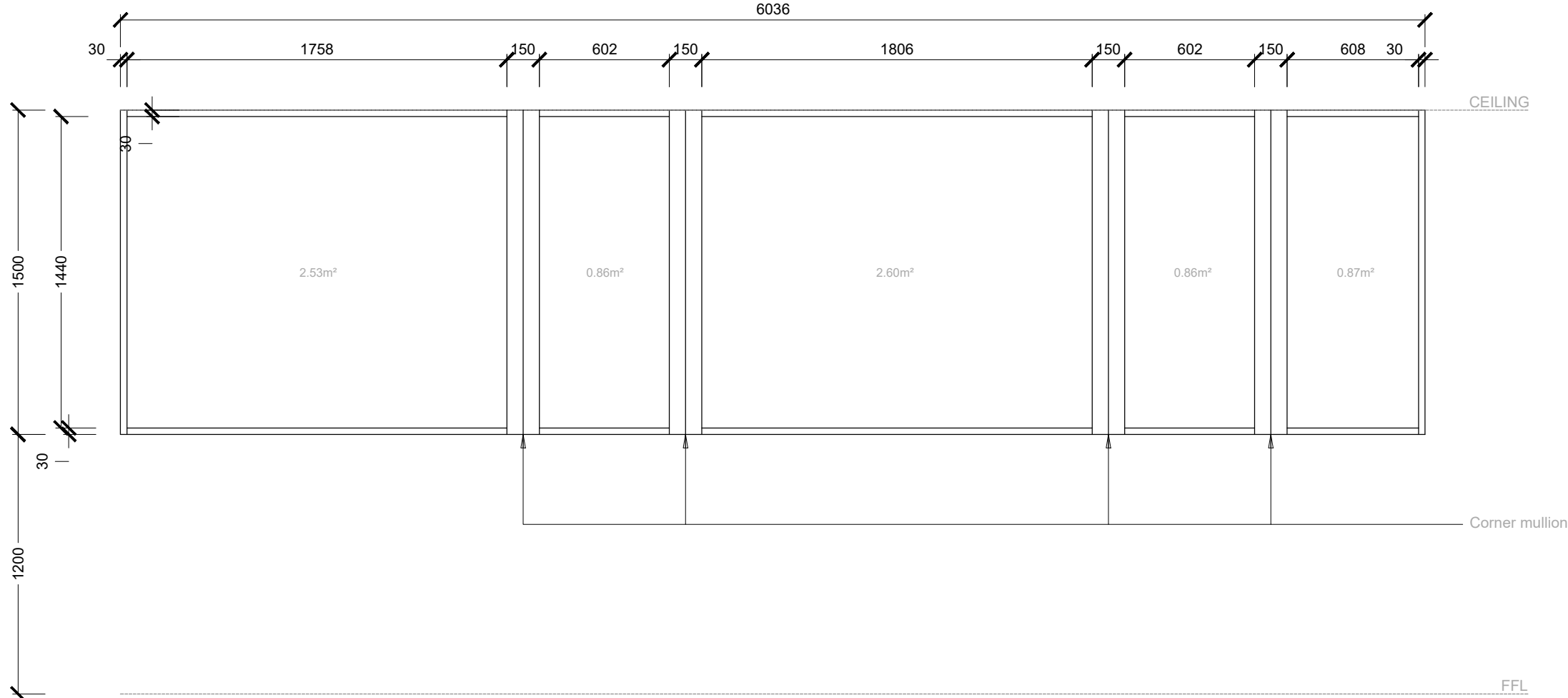

**CWType J** Crealco Clip44 or eq. approved aluminium shopfront system, incl fixed lights, per layout.  
Fixing suitable for fixing to concrete / brickwork reveals.  
**Exposure** AAAMSA exposure category: A0, SANS613 - 600Pa wind load capacity  
**Coating:** Class 2 powder coated to SANS 10322:2014; Coatings in accordance with SANS 1796 using powders in accordance with SANS 1578.  
**colour:** TBC. Provisionally Mat Black

Glazing Glazing throughout to be 12mm thick toughened safety glass , per PFG Armourplate.

SHGC: N/A

U-Value N/A

Curtains: N/A

QUANTITY: 2 Excl Curtains  
CG15  
CG19

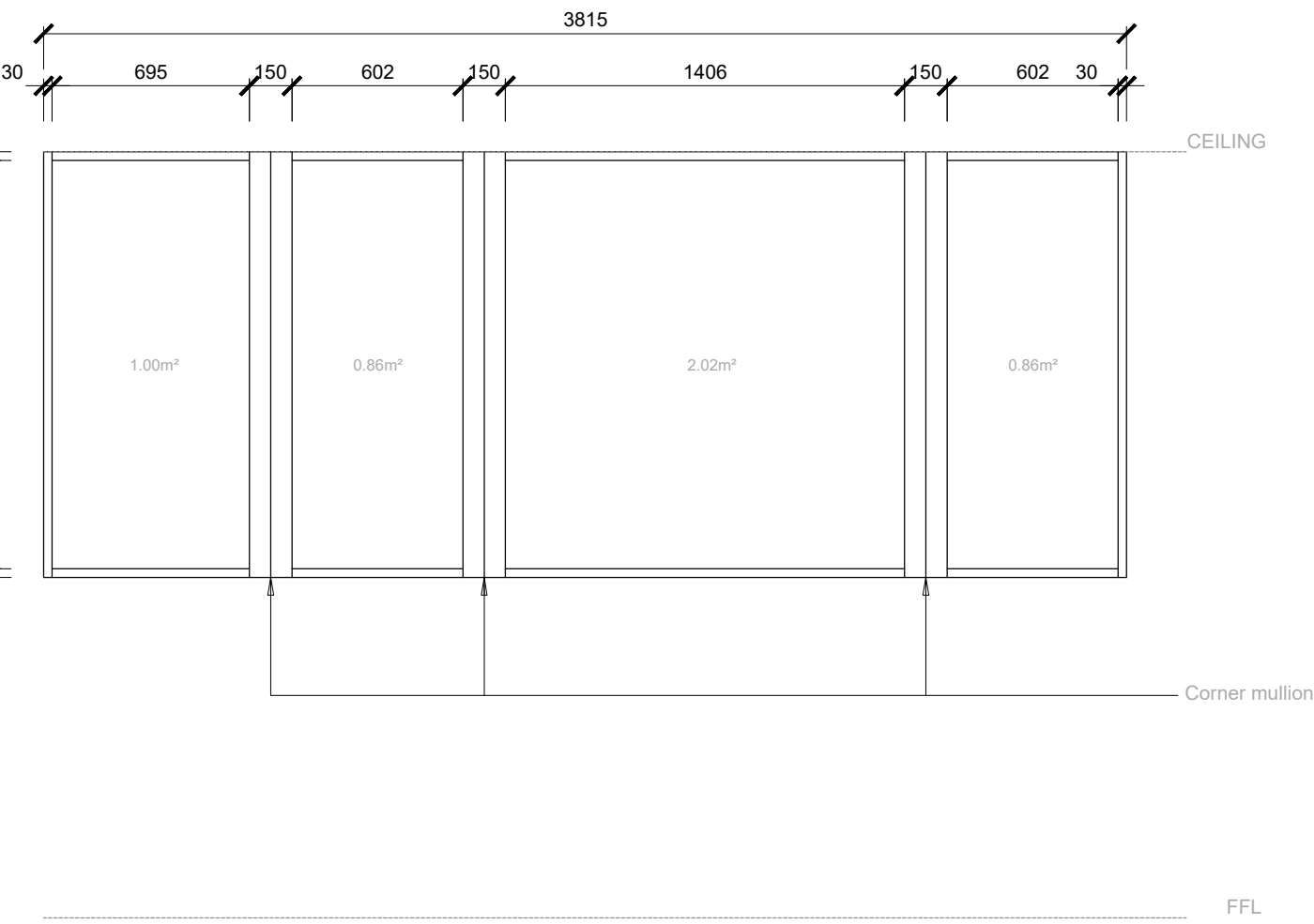
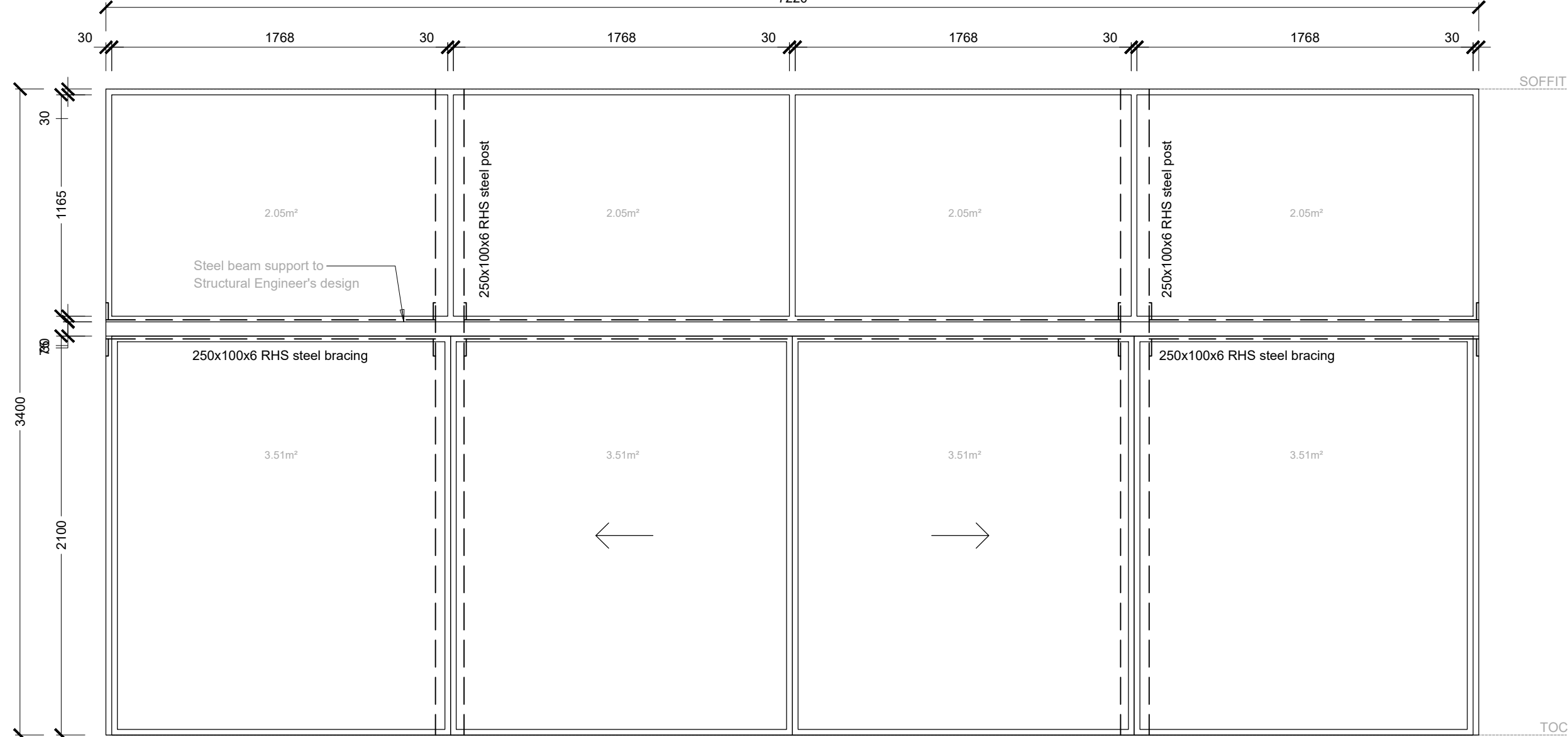

**CWType I** Crealco Clip44 or eq. approved aluminium shopfront system, incl fixed lights, per layout.  
Fixing suitable for fixing to concrete / brickwork reveals.

**Exposure** AAAMSA exposure category: A0, SANS613 - 600Pa wind load capacity

**Coating:** Class 2 powder coated to SANS 10322:2014; Coatings in accordance with SANS 1796 using powders in accordance with SANS 1578.

**colour:** TBC. Provisionally Mat Black

Glazing Glazing throughout to be 12mm thick toughened safety glass , per PFG Armourplate.

SHGC: N/A

U-Value N/A

Curtains: N/A

QUANTITY: 2 Excl Curtains  
CG14  
CG22

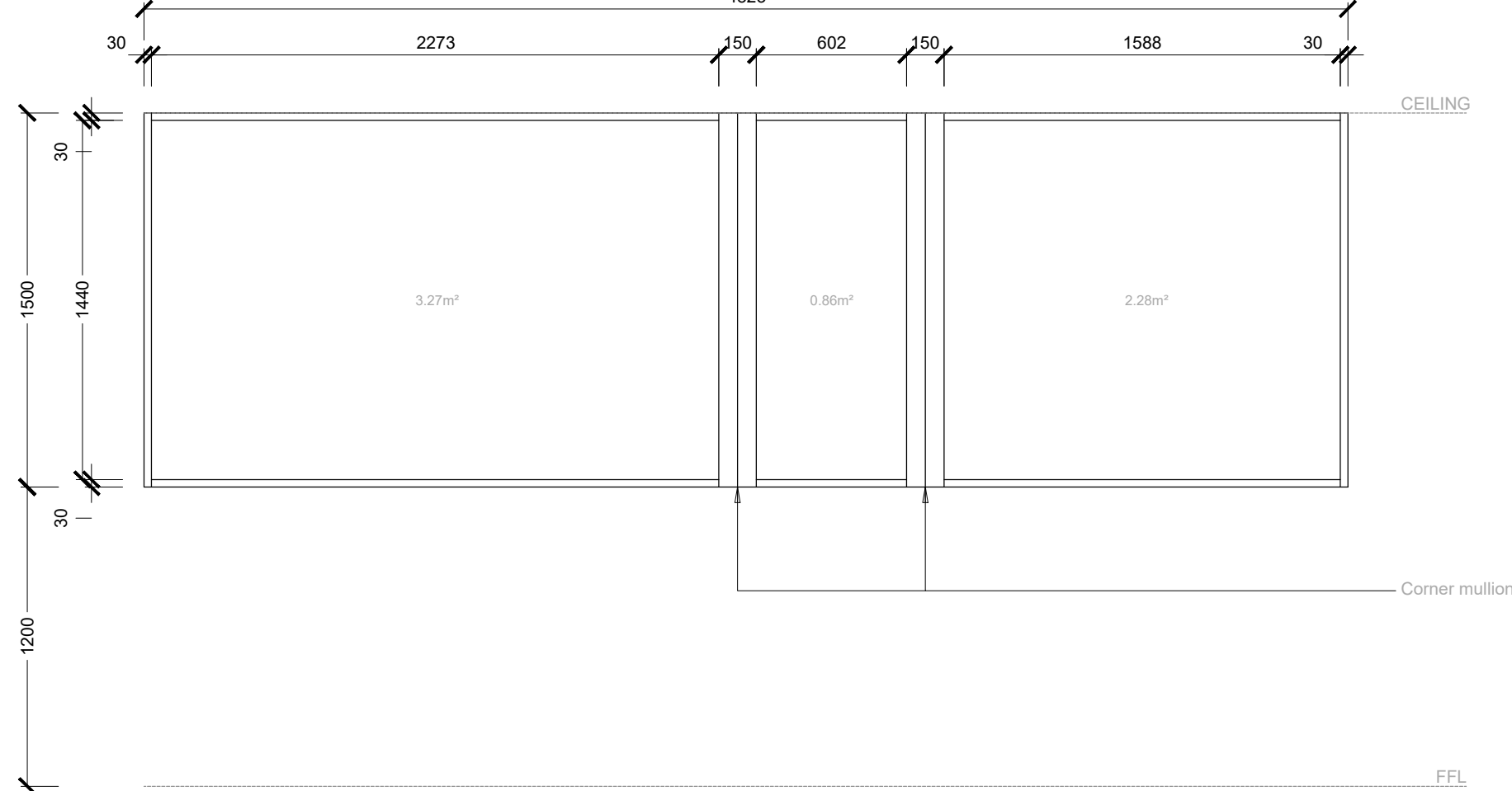

**CWType K** Crealco Clip44 or eq. approved aluminium shopfront system, incl fixed lights, per layout.  
Fixing suitable for fixing to concrete / brickwork reveals.

**Exposure** AAAMSA exposure category: A0, SANS613 - 600Pa wind load capacity

**Coating:** Class 2 powder coated to SANS 10322:2014; Coatings in accordance with SANS 1796 using powders in accordance with SANS 1578.

**colour:** TBC. Provisionally Mat Black

Glazing Glazing throughout to be 12mm thick toughened safety glass , per PFG Armourplate.

SHGC: N/A

U-Value N/A

Curtains: N/A

QUANTITY: 2 Excl Curtains  
CG16  
CG20

**CWType L** Crealco Facade 60 or eq. approved aluminium pressure glazed drained facade system, incl Sliding door per layout.  
Fixing suitable for fixing to concrete / brickwork reveals.

**Exposure** AAAMSA exposure category: A3, SANS613 - 2000Pa wind load capacity

**Coating:** Class 2 powder coated to SANS 10322:2014; Coatings in accordance with SANS 1796 using powders in accordance with SANS 1578.

**colour:** TBC. Provisionally Mat Black

**Structural bracing** Installation to include horizontal structural steel RHS, 250x100x6mm incl 12mm end plates of size 280x280, bolt fixed to concrete columns, and Same column supports (x2)

**Steel to be Hot dipped galvanised and painted to spec. Degrease, Etching primer, Undercoat, and 2 enamel finishing coats.**

**Colour to match window framing.**

**Furniture** Handles - Per manufacturers specification to suite operation indicated.

Glazing Glazing throughout to be 12mm thick toughened safety glass , per PFG Armourplate.

SHGC: N/A

U-Value N/A

Curtains: N/A

QUANTITY: 4 Incl Curtains  
CG17 CG23  
CG18 CG24

| No. | Description                         | Date       | By |
|-----|-------------------------------------|------------|----|
|     | Information only                    | 17.02.2016 | SG |
| A   | For purpose of discussion           | 23.02.2016 | SG |
| B   | All glazing types updated           | 12.10.2023 | WP |
| C   | Curtain wall & description updated. | 08.08.2024 | PD |

## Window Specification:

PRIOR TO COMMENCEMENT OF WORK ON SITE THE FOLLOWING CERTIFICATES ARE TO BE PROVIDED:

- Copy of the relevant AAAMSA Performance certificate from the manufacturer/contractor supplying the architectural aluminum product.
- A Certificate of conformance certifying that all anodizing or powder coating has been processed in strict accordance with SABS 999/1998 and SABS 1796/2001 respectively.
- A powder guarantee of no less than 15 years issued by the powder manufacturer. The specific conditions contained in this guarantee shall form part of the process and may only be applied by an approved powder applicator.
- A Certificate of conformance that the glazing has been installed in accordance with SABS137 ensuring that safety glazing materials have been installed in the mandatory areas & that each individual pane of safety glazing material has been permanently marked.
- A warranty from the manufacture of the laminated safety glass and / or hermetically sealed glazing units warranting the products against delamination for a period of not less than 5 years.

## HEALTH DEPARTMENT SIGNATURES

DEPUTY DIRECTOR GENERAL \_\_\_\_\_

HEAD OFFICE PROGRAMME / SERVICE \_\_\_\_\_

DISTRICT MANAGER \_\_\_\_\_

CEO / MANAGER OF THE FACILITY \_\_\_\_\_

DOH PROJECT MANAGER \_\_\_\_\_

IMPLEMENTING AGENT PROJECT MANAGER \_\_\_\_\_

## PROFESSIONAL SERVICE PROVIDER

NAME \_\_\_\_\_

SIGNATURE \_\_\_\_\_ DATE \_\_\_\_\_

## ARCHITECT:

ARTEK 4 ARCHITECTS (KZN) CC  
Durban: 46 Lena Ahrens Road, Glenwood, Durban 4000  
tel: 031 201 0445 fax: 031 201 6609 email: admin@artek4.co.za  
Port Shepstone: 19 Tradewinds, Marine Drive, Shelly Beach  
tel: 039 682 2447 fax: 039 682 2446 email: admin@artek4.co.za



## SOUTHERN REGION

Project  
WIMS NO. 044044: SOUTHERN REGION: PORT SHEPSTONE: DEPARTMENT OF HEALTH: PORT SHEPSTONE: PORT SHEPSTONE HOSPITAL: NEW PSYCHIATRIC WARD

## Drawing Description

CURTAIN WALL SCHEDULE  
TYPE H-L

|                                       |                       |                    |
|---------------------------------------|-----------------------|--------------------|
| Scale<br>1:25                         | Drawn<br>WP           | Date<br>17/01/2022 |
| Consultant Project No.<br><b>1518</b> | Drawing No.<br>402-03 | Rev<br>C           |
| DOW Drawing number<br>-               |                       | Rev<br>-           |
| Stamped by Plans Approval Committee   |                       |                    |