



CITY OF TSHWANE METROPOLITAN MUNICIPALITY

**ADVERTISEMENT: QUOTATION FOR THE SUPPLY, DELIVERY AND OFFLOADING OF
DIGITAL CAMERAS (PROFESSIONAL AND STANDARD) WITH LENSES AND
ACCESSORIES TO THE TSHWANE METRO POLICE DEPARTMENT FOR A 12-MONTH
PERIOD, AS AND WHEN REQUIRED**

QUOTATION NUMBER: Q40-2022-23

NAME OF BIDDER:

CSD NUMBER:

VENDOR NUMBER:
(compulsory)

Prepared by:
City of Tshwane Metropolitan Municipality
Tshwane House
320 Madiba Street
Pretoria
0001

Tel: 012 358 9999

CLOSING DATE

9 NOVEMBER 2022

**Only bidders registered on the central supplier database (CSD) and with a CSD number
will be considered for this tender, as it is a requirement from the National Treasury.**



CITY OF TSHWANE METROPOLITAN MUNICIPALITY

DEPARTMENT: TSHWANE METRO POLICE

Bids are hereby invited from suppliers for the following bid:

Bid number	Description	Department	Contact persons	Compulsory briefing session	Closing date
Q40-2022-23	ADVERTISEMENT: QUOTATION FOR THE SUPPLY, DELIVERY AND OFFLOADING OF DIGITAL CAMERAS (PROFESSIONAL AND STANDARD) WITH LENSES AND ACCESSORIES TO THE TSHWANE METRO POLICE DEPARTMENT FOR A 12-MONTH PERIOD, AS AND WHEN REQUIRED	TSHWANE METRO POLICE	Willem Breedt	Date: 1 November 2022 Time: 11:00 Venue: Tshwane Metro Police Department Main Hall at 118 WF Nkomo Street Pretoria West	9 November 2022 @ 10:00

The document is downloadable on the e-Tender Portal.

Each quotation must be enclosed in a sealed envelope that bears the correct identification details and must be placed in the tender box located at:

**City of Tshwane Metropolitan Municipality
Tshwane House
320 Madiba Street
Pretoria
0002**

Documents must be deposited in the bid box not later than **10:00 on 9 November 2022** when the bids will be opened in public.

Technical enquiries: Willem Breedt at 012 358 0926 or willemb@tshwane.gov.za

Supply chain enquiries: Josia Masenya at 012 358 0658 or josiasma@tshwane.gov.za

Bids will remain valid for a period of 90 days after the closing date.

- Bids received after the closing date and time will not be considered. The City of Tshwane does not bind itself to accept the lowest or any other bid in whole or in part.
- Bid documents must be completed using a black pen (not retyped or scanned).
- Mistakes made on the price schedule must be crossed out in ink and each price alteration must be initialled.
- Price corrections may not be made with correction fluid, such as Tipp-Ex or a similar product.
- If correction fluid was used on any specific item price, such an item will not be considered. No correction fluid may be used on a bill of quantities where prices are calculated to arrive at a total amount. If correction fluid was used, the quotation as a whole will be repudiated.
- The City of Tshwane will reject the quotation if corrections are not made in accordance with the above.

INDEX

Number	Details	Document	Page
1.	Scope of work		
2.	Pricing schedule		
3.	Invitation to bid	MBD 1	
4.	Declaration of interest	MBD 4	
5.	Preference points claimed form	MBD 6.1	
6.	Contract form – Purchase of Goods/Works	MBD 7.1	
7.	Declaration of past supply chain management practice	MBD 8	
8.	Certificate of independent bid determination	MBD 9	
LIST OF RETURNABLE DOCUMENTS THAT SHOULD FORM PART OF BID DOCUMENT			
9.	Company registration certificate		
10.	Tax clearance certificate or unique PIN		
11.	BBBEE certificate		
12.	Rates and taxes		
13.	CSD summary report		



COMMUNITY SAFETY: METRO POLICE DEPARTMENT

BID NAME

QUOTATION FOR THE SUPPLY, DELIVERY AND OFF-LOADING OF DIGITAL CAMERAS (PROFESSIONAL AND STANDARD) WITH LENSES AND ACCESSORIES TO THE METRO POLICE DEPARTMENT FOR A PERIOD TWELVE (12) MONTHS ON AN AS AND WHEN REQUIRED BASIS

BID NUMBER

Q 40-2022-23

1. INTRODUCTION AND PURPOSE

The Tshwane Metro Police Department need service providers for the supply, delivery and off-loading of Digital Cameras (Professional and Standard) on an as and when required basis, for a period of one (1) year.

This bid is for the procurement of equipment, Digital Cameras to assist the Tshwane Metro Police Department and its officials in the execution of their duties as prescribed by various laws. The City of Tshwane must therefore provide the necessary tools and equipment to TMPD members to perform their duties

2. BACKGROUND

The Tshwane Metro Police Department is required to perform various functions stipulated within the applicable legislative mandate for Metro Police. In accordance with this mandate, the Tshwane Metro Police Department is required to supplement operational services rendered by the South African Police Services on an as and when required basis.

For this Department to fulfil these services, the Department is required to procure the relevant equipment and resources to ensure that the required services can be rendered effectively.

3. PROJECT SCOPE

This bid consists of two main items:

Item 1: Digital Camera Single-Lens Reflex (DSLR) – **Professional Camera** - including lenses and accessories

Item 2: Digital Camera Single-Lens Reflex (DSLR) – **Standard Camera** - including lenses and accessories.

3.1 ITEM 1.1 DIGITAL CAMERA SINGLE-LENS REFLEX (SLR) – PROFESSIONAL CAMERA.

NOTE: PHOTO INCLUDED FOR ILLUSTRATION PURPOSES ONLY AND DO NOT PRESCRIBE OR SUPPORT ANY SPECIFIC PRODUCT.

The Camera Body

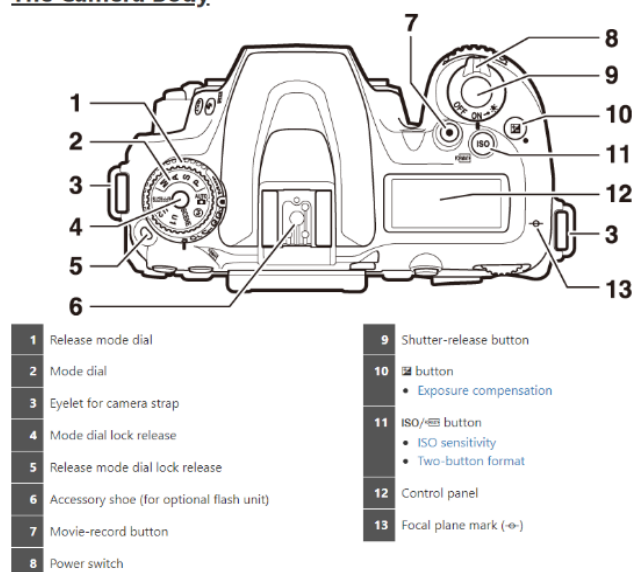

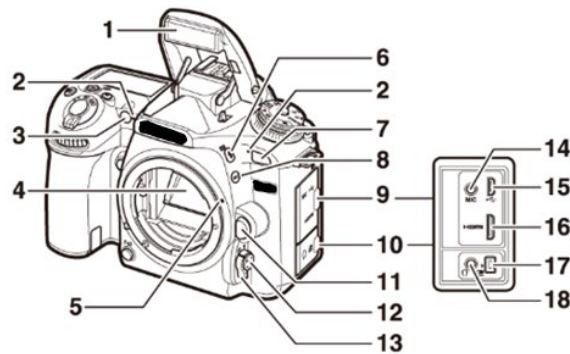

- | | |
|----------------------------------------------------------------------------------------------------------------------------------------------------------------------------------------------------------------------------------------------------------------------------------------------------------------------------------------|------------------------------------------------------------------------------------------------------------------------------------------------------------------------------------------------------------------------------------------------------------------------------------------------------------------------------------------------------------------------------|
| <p>1 Built-in flash</p> <p>2 Stereo microphone</p> <p>3 AF-assist illuminator
Self-timer lamp
Red-eye reduction lamp</p> <p>4 Mirror</p> <p>5 Lens mounting mark</p> <p>6 $\frac{1}{2}$ button
• Flash photography
• Flash compensation</p> <p>7 Infrared receiver</p> <p>8 BKT button
• Bracketing</p> | <p>9 Cover for USB, HDMI, and external microphone connectors</p> <p>10 Cover for accessory terminal and headphone connector</p> <p>11 Lens release button</p> <p>12 AF-mode button</p> <p>13 Focus-mode selector</p> <p>14 Connector for external microphone</p> <p>15 USB connector</p> <p>16 HDMI connector</p> <p>17 Accessory terminal</p> <p>18 Headphone connector</p> |
|----------------------------------------------------------------------------------------------------------------------------------------------------------------------------------------------------------------------------------------------------------------------------------------------------------------------------------------|------------------------------------------------------------------------------------------------------------------------------------------------------------------------------------------------------------------------------------------------------------------------------------------------------------------------------------------------------------------------------|

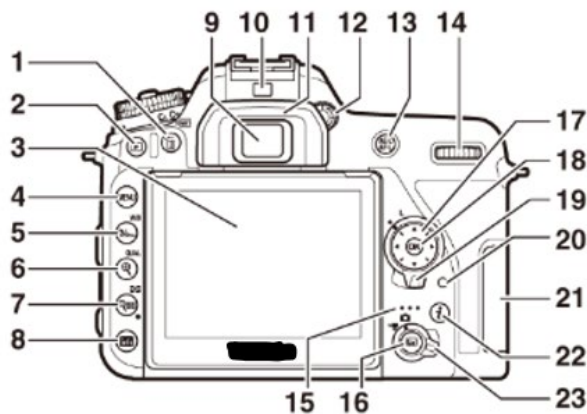

- | | |
|--------------------------------------------------------------------------------------------------------------------------------------------------------------------------------------------------------------------------------------------------------------------------------------------------------------------------------------------------------------------------------------------------------------------------------------------------------------------------------------------------------------------------------------------------------------------------------------------------------------------|-----------------------------------------------------------------------------------------------------------------------------------------------------------------------------------------------------------------------------------------------------------------------------------------------------------------------------------------------------------------------------------------------------------------------------------------------------------------------------------------------------------------------------------------------------------------------------|
| <p>1 $\frac{1}{2}$ button
• Deleting photographs
• Two-button format</p> <p>2 $\frac{1}{2}$ button
• Playback</p> <p>3 Tilting monitor</p> <p>4 MENU button</p> <p>5 $\frac{1}{4}$ button
• Help
• Protecting photographs
• White balance</p> <p>6 $\frac{1}{2}$ button
• Playback zoom
• Image quality
• Image size</p> <p>7 $\frac{1}{2}$ button
• Thumbnail playback
• Metering</p> <p>8 $\frac{1}{2}$ button
• The information display</p> <p>9 Viewfinder eyepiece</p> <p>10 Eye sensor</p> | <p>11 Rubber eyecup</p> <p>12 Diopter adjustment control</p> <p>13 BKT button
• Autoexposure lock
• Focus lock</p> <p>14 Main command dial</p> <p>15 Speaker</p> <p>16 $\frac{1}{2}$ button
• Photo live view
• Movie live view</p> <p>17 Multi-selector</p> <p>18 $\frac{1}{2}$ button</p> <p>19 Focus selector lock</p> <p>20 Memory card access lamp</p> <p>21 Memory card slot cover</p> <p>22 $\frac{1}{2}$ button
• Viewfinder photography
• Movie recording
• Playback</p> <p>23 Live view selector</p> |
|--------------------------------------------------------------------------------------------------------------------------------------------------------------------------------------------------------------------------------------------------------------------------------------------------------------------------------------------------------------------------------------------------------------------------------------------------------------------------------------------------------------------------------------------------------------------------------------------------------------------|-----------------------------------------------------------------------------------------------------------------------------------------------------------------------------------------------------------------------------------------------------------------------------------------------------------------------------------------------------------------------------------------------------------------------------------------------------------------------------------------------------------------------------------------------------------------------------|

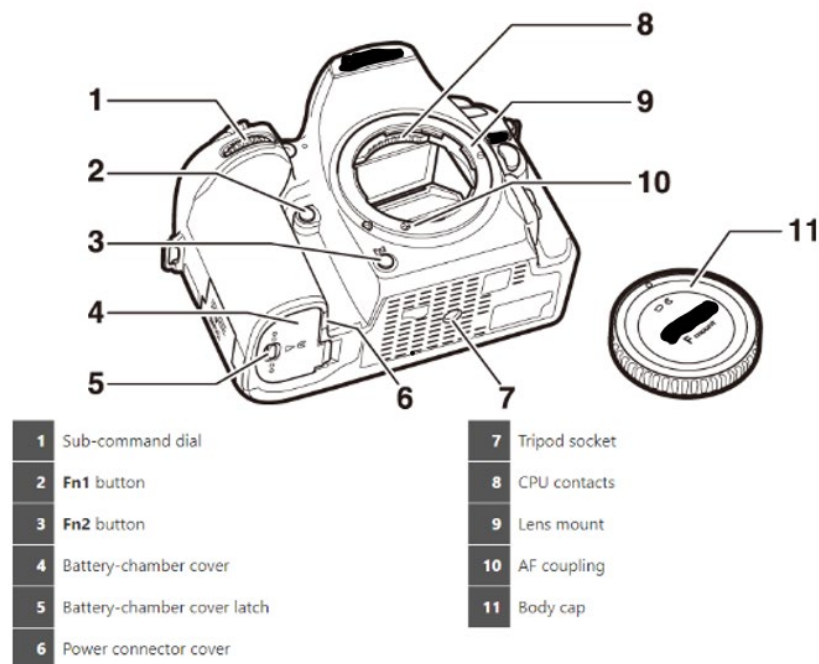

The Professional Digital Camera Single-Lens Reflex (SLR) Camera with Lenses and accessories must conform to and comply with the following minimum requirements:

SPECIFICATION

TYPE

- Single lens reflex digital camera

LENS MOUNT

- F mount (with AF coupling and AF contacts)

EFFECTIVE ANGLE OF VIEW

- DX format.
- Focal length in 35 mm [135] format equivalent to approximately $1.5 \times$ that of lenses with FX format angle of view

EFFECTIVE PIXELS

- 20.9 million

IMAGE SENSOR

- 23.5 × 15.7 mm CMOS sensor

TOTAL PIXELS

- 21.51 Mega Pixels

DUST-REDUCTION SYSTEM

- Image Sensor Cleaning.
- Image Dust Off Reference Data (Capture NX-D software required)

STORAGE

- Image Size (Pixels)
 - DX (24×16) Image Area
 - 5568 × 3712 (Large: 20.7 M).
 - 4176 × 2784 (Medium: 11.6 M).
 - 2784 × 1856 (Small: 5.2 M)
 - 1.3 × (18×12) Image Area
 - 4272 × 2848 (Large: 12.2 M).
 - 3200 × 2136 (Medium: 6.8 M).
 - 2128 × 1424 (Small: 3.0 M)
- Photographs with image area of DX taken during movie recording
 - 5568 × 3128 (Large).
 - 4176 × 2344 (Medium).
 - 2784 × 1560 (Small).
- Photographs with image area of 1.3 × taken during movie recording
 - 4272 × 2400 (Large).
 - 3200 × 1800 (Medium).
 - 2128 × 1192 (Small).
- Photographs taken during movie recording at a frame size of 3840 × 2160:
 - 3840 × 2160

FILE FORMAT

- NEF (RAW): 12 or 14 bit, lossless compressed or compressed.

- PEG: JPEG-Baseline compliant with fine (approximately 1:4), normal (approximately 1:8), or basic (approximately 1:16) compression; optimal quality compression available.
- NEF (RAW) + JPEG: Single photograph recorded in both NEF (RAW) and JPEG formats.

PICTURE CONTROL SYSTEM

- MEDIA Auto.
- Standard.
- Neutral.
- Vivid.
- Monochrome.
- Portrait.
- Landscape.
- Flat.
- Selected Picture Control must allow to be modified.
- Storage for custom Picture Controls.
- Secure Digital (SD) Card.
- Secure Digital High Capacity (SDHC) Card - Ultra-High Speed Compliant (UHS-I)
- Secure Digital Extended Capacity (SDXC) Card - Ultra-High Speed Compliant (UHS-I).

FILE SYSTEM

- Must support Design Rule for Camera File System Version 2 (DCF 2.0).
- Must support Exif Image File Version 2.31 (Exif 2.31).
- Must support PictBridge (PictBridge is a computing industry standard for direct printing from the camera).

VIEWFINDER

- Eye-level pentaprism single-lens reflex viewfinder

FRAME COVERAGE

- DX (24×16) image area: Approximately 100% horizontal and 100% vertical

- $1.3 \times (18 \times 12)$ image area: Approximately 97% horizontal and 97% vertical

MAGNIFICATION

- Approximately $0.94 \times (50 \text{ mm f/1.4 lens at infinity, } -1.0 \text{ m}^{-1})$

EYEPOINT

- 18.5 mm (-1.0 m^{-1} ; from center surface of viewfinder eyepiece lens)

DIOPTER ADJUSTMENT

- $-2 - +1 \text{ m}^{-1}$

FOCUSING SCREEN

- Type B BriteView Clear Matte Mark II screen with AF area brackets (framing grid can be displayed).

REFLEX MIRROR

- Quick return

LENS APERTURE

- Instant return, electronically controlled

LENS

- Compatible Lenses
 - Central Processing Unit (CPU) lenses with the presence of Central Processing Unit (CPU) contacts:

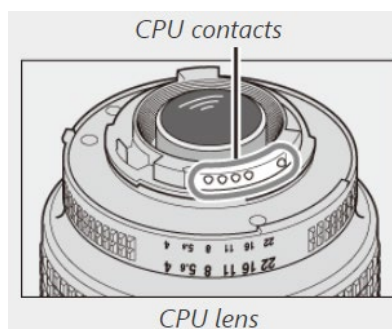

- Type G/E lenses with the following identification markers:

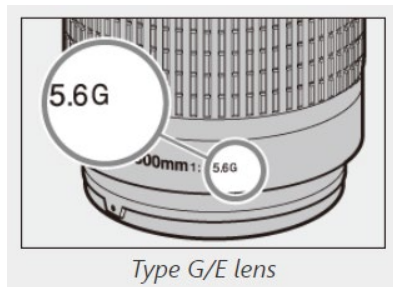

- Type D lenses with the following identification markers:

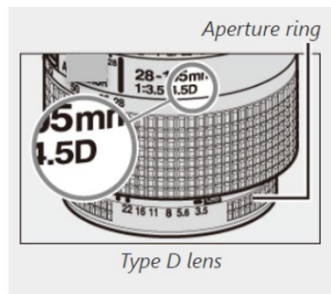

- Must support the use of the electronic rangefinder with lenses that have a maximum aperture of f/5.6 or faster.
- The electronic rangefinder must support the center 1 focus point with lenses that have a maximum aperture of f/8 or faster.

SHUTTER

- Type
 - Electronically controlled vertical-travel focal-plane mechanical shutter.
 - Electronic front-curtain shutter in mirror up release mode
- Speed
 - 1/8000–30 seconds (s) in steps of 1/3 or 1/2 EV, bulb, time, X250
- Flash Sync Speed
 - X = 1/250 seconds (s); synchronizes with shutter at 1/320 seconds (s) or slower (flash range drops at speeds between 1/250 and 1/320 seconds (s))

RELEASE

- Release Mode
 - Single Frame (S).
 - Continuous Low Speed (CL).
 - Continuous High Speed (CH).
 - Quiet shutter-release (Q)

- Quiet continuous shutter-release (QC).
- Self-timer ().
- Mirror up (MUO).
- Approximate Frame Advance Rate
 - Continuous Low Speed (CL): 1-7 frames per second (fps).
 - Continuous High Speed (CH): 8 frames per second (fps).
- Self-Timer Options
 - 2 Seconds (s).
 - 5 Seconds (s).
 - 10 Seconds (s).
 - 20 Seconds (s).
 - 1-9 exposures at intervals of 0.5, 1, 2, or 3 Seconds (s) respectively.
- Remote control modes (ML-L3)
 - Delayed remote, quick-response remote, remote mirror-up

EXPOSURE

- Metering System
 - Through-the-lens (TTL) exposure metering using Red, Blue, and Green (RGB) sensor with approximately 180K (180,000) pixels.
- Metering Mode
 - Matrix
 - Three-dimensional (3D) color matrix metering III for types G, E, and D lenses.
 - Color matrix metering III for other Central Processing Unit (CPU) lenses.
 - Center-Weighted
 - Weight of approximately 75% given to 8 mm circle in center of frame.
 - Diameter of circle can be changed to 6, 10, or 13 mm, or weighting can be based on average of entire frame.
 - Spot
 - Meters circle with diameter of about 3.5 mm (about 2.5% of frame) centered on selected focus point.
 - Highlight-Weighted
 - Must be available with type G, E, and D lenses.
- Range (ISO 100, f/1.4 lens, 20 °C/68 °F)

- Matrix, center-weighted, or highlight-weighted metering: 0 – 20 EV
- Spot metering: 2 – 20 EV
- Meter Coupling
 - Central Processing Unit (CPU)
- Modes
 - Must support the following:
 - Auto modes (Photo auto, Flash auto, Flash off).
 - Scene Modes (Portrait; Landscape; Child; Sports; Close-Up; Night Portrait; Night Landscape; Party/Indoor; Beach/Snow; Sunset; Dusk/Dawn; Pet Portrait; Candlelight; Blossom; Autumn Colors; Food).
 - Special Effects Modes (Night Vision; Super Vivid; Pop; Photo Illustration; Toy Camera Effect; Miniature Effect; Selective Color; Silhouette; High Key; Low Key).
 - Programmed Auto with Flexible Program (P).
 - Shutter-Priority Auto (S).
 - Aperture-Priority Auto (A).
 - Manual (M).
 - User Settings Option 1 (U1).
 - User Settings Option 2 (U2).
- Exposure Compensation
 - Must allow for adjustment by –5 – +5 EV in increments of 1/3 or 1/2 EV in modes included above (P, S, A, M, Scene, and Effects Modes).
- Exposure lock
 - Luminosity locked at detected value.
- ISO sensitivity (Recommended Exposure Index)
 - ISO 100–51200 in steps of 1/3 or 1/2 EV. Can also be set to approximately 0.3, 0.5, 0.7, or 1 EV (ISO 50 equivalent) below ISO 100 or to approximately 0.3, 0.5, 0.7, 1, 2, 3, 4, or 5 EV (ISO 1640000 equivalent) above ISO 51200.
 - Auto include ISO sensitivity control.
- Active D-Lighting
 - Must allow for the following selections:
 - Auto.
 - Extra High.
 - High.

- Normal.
- Low.
- Off.

FOCUS

- Autofocus
 - Must include an advanced multi-CAM autofocus sensor module with Through-The-Lens (TTL) phase detection.
 - Fine-tuning.
 - 51 Focus points (including 15 cross-type sensors; f/8 supported by 1 sensor).
 - AF-assist illuminator (range approximately 0.5 – 3 m/1 ft 8 in. – 9 ft 10 in.)
- Detection range
 - –3 – +19 EV (ISO 100, 20 °C/68 °F)
- Lens Servo
 - Auto-Focus (AF):
 - Single-servo Auto-Focus (AF-S).
 - Continuous-servo Auto-Focus (AF-C).
 - Automatic Auto Auto-Focus (AF-A) selection between Auto-Focus (AF-S) Auto-Focus (AF-C).
 - Predictive focus tracking activated automatically according to subject status
 - Manual focus (M):
 - Electronic rangefinder can be used.
- Focus Point
 - Must include selections between either 51, or 11 focus points.
- Auto-Focus (AF) Area Modes
 - Must include following selections:
 - Single-point Auto-Focus (AF): 9-, 21-, or 51-point dynamic-area.
 - Auto-Focus (AF) 3D-tracking.
 - Auto-Focus (AF) Group Area.
 - Auto-Focus (AF) Auto Area.
- Focus Lock
 - Must include following selections:

- Be locked by pressing shutter-release button halfway (single-servo Auto-Focus (AF)).
- Be locked by pressing Automatic Exposure Lock (AEL).
- Be locked by pressing Auto-Focus Lock (AFL) button.

FLASH

- Built-In Flash
 - Must include auto flash with auto pop-up.
 - Must allow for manual pop-up with button release.
- Guide Number
 - Approximately 12/39 with auto flash.
 - Approximately 12/39 with manual flash. (m/ft, ISO 100, 20 °C/68 °F).
- Flash control
 - Must include the following Through-The-Lens (TTL) capabilities:
 - Intelligent-Through-The-Lens (i-TTL) flash control using Red, Green, Blue (RGB) sensor with approximately 180,000(180K) pixels with built-in flash.
 - Intelligent-Through-The-Lens (i-TTL) balanced fill-flash for digital SLR with matrix center-weighted and highlight-weighted metering.
 - Standard Intelligent-Through-The-Lens (i-TTL) fill-flash for digital SLR with spot metering.
- Flash Modes
 - Must include the following flash mode options:
 - Auto.
 - Auto with red-eye reduction.
 - Auto slow synchronization (sync).
 - Auto slow synchronization (sync) with red-eye reduction.
 - Fill-flash.
 - Red-eye reduction.
 - Slow synchronization (sync).
 - Slow synchronization (sync) with red-eye reduction.
 - Rear-curtain with slow synchronization (sync).
 - Rear-curtain synchronization (sync).
 - Off.
 - Must support Auto Focal Plane (FP) High-Speed synchronization (sync).

- Flash Compensation
 - $-3 - +1$ Exposure Value (EV) in increments of $1/3$ or $1/2$ Exposure Value (EV).
- Flash-Ready Indicator
 - The following indicators must be included:
 - Light indicating when built-in flash, or optional flash unit is fully charged.
 - Light indicating that flash is fired at full output.
- Accessory Shoe
 - The shoe must include the following:
 - ISO 518 Hot-shoe with synchronization (sync).
 - Data Contacts.
 - Safety Lock.
- Creative Lighting System (CLS)
 - Must include the following functions:
 - Intelligent-Through-The-Lens (i-TTL) flash control.
 - Radio-controlled Advanced Wireless Lighting.
 - Optical Advanced Wireless Lighting.
 - Modelling Illumination.
 - Flash Value Lock (FV).
 - Color Information Communication.
 - Auto Focal Plane (FP) High-Speed synchronization (sync).
 - Auto-Focus (AF)-assist for multi-area Autofocus (AF).
- Synchronization (Sync) Terminal.
 - Must accommodate a AS-15 sync terminal adapter which can be procured separately.

WHITE BALANCE

- White Balance
 - Must allow for the management of the following White Balance capabilities:
 - Auto (2 types).
 - Incandescent.
 - Fluorescent (7 types).
 - Direct Sunlight.
 - Flash.
 - Cloudy.

- Shade.
- Pre-set Manual (up to 6 values to be stored, spot white balance measurement during live view).
- Choose Color Temperature (2500 K–10,000 K).
- All the above with fine-tuning.

BRACKETING

- Bracketing Types
 - Must allow for the following:
 - Exposure.
 - Flash.
 - White Balance.
 - Active-D Lighting (ADL) Live View.

LIVE VIEW

- Must allow for the following modes:
 - Photo Live View.
 - Movie Live View.
- Lens Artificial Intelligence Servo Automatic Focusing (SERVO)
 - Must include the following:
 - Auto-Focus (AF): Single-servo AF (AF-S); Full-time servo AF (AF-F)
 - Manual Focus (M).
- Auto-Focus (AF) Area Modes
 - Must include the following modes:
 - Face-priority Auto-Focus (AF).
 - Wide Area Auto-Focus (AF).
 - Normal Area Auto-Focus (AF).
 - Subject Tracking Auto-Focus (AF).
- Autofocus
 - Must include Contrast-detect Auto-Focus (AF) anywhere in frame (camera must select focus point automatically when face-priority Auto-Focus (AF) or Subject Tracking Auto-Focus (AF) is selected).

MOVIE

- Metering System

- Through-The-Lens (TTL) exposure metering using main image sensor.
- Metering Mode
 - Matrix, Center-Weighted, or Highlight-Weighted
- Frame Size (Pixels) and Frame Rate
 - 3840 × 2160 (4K UHD); 30p (progressive), 25p, 24p
 - 1920 × 1080; 60p, 50p, 30p, 25p, 24p
 - 1280 × 720; 60p, 50p
- Actual frame rates for 60p, 50p, 30p, 25p, and 24p are 59.94, 50, 29.97, 25, and 23.976 fps respectively.
- High quality available at all frame sizes, normal quality available at all sizes except 3840 × 2160.
- File Format
 - MOV
 - MP4
- Video Compression
 - H.264/MPEG-4 Advanced Video Coding
- Audio Recording Format
 - Linear PCM.
 - AAC.
- Audio Recording Device
 - Built-in stereo or external microphone.
 - Sensitivity adjustable.
- ISO sensitivity (Recommended Exposure Index)
 - Mode M: Auto ISO sensitivity control (ISO 100 to Hi 5) available with selectable upper limit; manual selection (ISO 100 to 51200 in steps of 1/3 or 1/2 EV) with additional options available equivalent to approximately 0.3, 0.5, 0.7, 1, 2, 3, 4, or 5 EV (ISO 1640000 equivalent) above ISO 51200.
 - Modes P, S, and A: Auto ISO sensitivity control (ISO 100 to Hi 5) with selectable upper limit.
 - % (EFFECT) mode: Auto ISO sensitivity control (ISO 100 to Hi 5).
 - Other modes: Auto ISO sensitivity control (ISO 100 to 12800).
- Active D-Lighting
 - Similar selection options as per Photo Settings:
 - Extra High.

- High.
- Normal.
- Low.
- Off.
- Other Options

Must include the following:

 - Index marking.
 - Time-lapse Movies.
 - Electronic vibration reduction.
- Monitor

Must be as follows:

 - 8-cm (3.2-inches).
 - Approximately 922k-dot (VGA) tilting TFT touch-sensitive LCD with 170° viewing angle.
 - Approximately 100% frame coverage.
 - Manual monitor brightness control.
 - Eye-sensor controlling display on/off.
- Playback
 - Full-frame and thumbnail (4, 9, or 72 images or calendar) playback with playback zoom.
 - Playback zoom cropping.
 - Movie playback.
 - Photo and/or movie slide shows.
 - Histogram display.
 - Highlights.
 - Photo information.
 - Location data display.
 - Picture rating.
 - Auto image rotation.

INTERFACE

- USB
 - Hi-Speed USB with Micro-B connector.
 - Connection to built-in USB port.

- HDMI Output
 - Type C HDMI connector
- Accessory Terminal
 - Must allow to be used with MC-DC2 and other optional accessories.
- Audio Input
 - Stereo mini-pin jack (3.5 mm diameter; plug-in power supported)
- Audio Output
 - Stereo mini-pin jack (3.5 mm diameter)
- Wireless Standards

These are the standards for wireless Local Area Networks (LAN's). It refers to the specifications that is more commonly known as Wi-Fi.

- IEEE 802.11b.
- IEEE 802.11g.
- Operating frequency: 2412–2462 Megahertz (MHz) (channels 1–11).
- Maximum output power: 8.4 dBm (EIRP).
- Authentication: Open system, WPA2-PSK.
- Bluetooth
 - Communication protocols: Bluetooth Specification Version 4.1.
 - Operating frequency.
 - Bluetooth: 2402–2480 Megahertz (MHz).
 - Bluetooth Low Energy: 2402–2480 Megahertz (MHz).
 - Maximum Output Power (EIRP):
 - Bluetooth: 6.4 dBm.
 - Bluetooth Low Energy: 6.4 dBm.
- Range (line of sight)

Approximately 10 meter (m) (32 ft) without interference which may vary with signal strength and presence or absence of obstacles.
- Supported languages
 - Must support the following:

Arabic, Bengali, Bulgarian, Chinese (Simplified and Traditional), Czech, Danish, Dutch, ENGLISH, Finnish, French, German, Greek, Hindi, Hungarian, Indonesian, Italian, Japanese, Korean, Marathi, Norwegian, Persian, Polish, Portuguese (Portugal and Brazil), Romanian, Russian, Serbian, Spanish, Swedish, Tamil, Telugu, Thai, Turkish, Ukrainian, Vietnamese.

- Power Source
 - Battery
 - One (1) EN-EL15a rechargeable Li-ion battery.
- Alternating Current (AC) Adapter
 - One (1) EH-5b/EH-5c AC adapter which MUST include an EP-5B power connector.
- Tripod Socket
 - 0.635 cm (1/4 in., ISO 1222)
- Approximate Dimensions
 - Width: 135.5mm (5.4 inches).
 - Height: 104mm (4.1 inches).
 - Depth: 72.5 mm (2.9 inches).
 - Weight:
 - 720g (1 lb 9.4 oz) WITH battery and memory card.
 - 640g (1 lb 6.6 oz) WITHOUT battery and memory card (camera body only)
- Operating Environment
 - Temperature: 0 °C–40 °C (+32 °F–104 °F).
 - Humidity: 85% or less (no condensation).

BATTERY CHARGER

Must be manufacturer approved with the following requirements:

- Rated Input (in North America): AC 120 V, 60 Hz, 0.2 A
- Rated Input (in other regions): AC 100–240 V, 50/60 Hz, 0.23–0.12 A\
- Rated Output: DC 8.4 V/1.2 A
- Supported Batteries:
 - EN-EL15c/EN-EL15b/EN-EL15a/EN-EL15 rechargeable Li-ion batteries.
- Charging Time

Approximately two (2) hours and thirty-five (35) minutes at an ambient temperature of 25 °C (77 °F) when no charge remains.
- Operating Temperature: 0 °C–40 °C (+32 °F–104 °F)
- Approximate Dimensions (excluding projections):
 - Width: 95mm (3.7 inches).
 - Height: 33.5mm (1.3 inches).
 - Depth: 71mm (2.8 inches).

- Weight: 115g (4.1 oz), excluding supplied power connector (power cable or AC wall adapter)
- Length of Power Cable
 - Must include a 1.5m power cable (4.9 ft).

EN-EL15A RECHARGEABLE LI-ION BATTERY

- Type: Rechargeable Lithium-ion Battery.
- Rated Capacity: 7.0 V/1900 mAh.
- Operating Temperature: 0 °C–40 °C (+32 °F–104 °F).
- Approximate Dimensions:
 - Width: 40mm (1.6 inches).
 - Height: 56mm (2.2 inches).
 - Depth: 20.5mm (0.8 inches).
 - Weight: 78g (2.8 oz), excluding terminal cover.
- Supported Standards
 - DCF Version 2.0: The Design Rule for Camera File Systems (DCF) is a standard widely used in the digital camera industry to ensure compatibility among different makes of camera.
 - Exif version 2.31: The camera supports Exif (Exchangeable Image File Format for Digital Still Cameras) version 2.31, a standard in which information stored with photographs is used for optimal color reproduction when the images are output on Exif-compliant printers.
 - PictBridge: A standard developed through cooperation with the digital camera and printer industries, allowing photographs to be output directly to a printer without first transferring them to a computer.
 - HDMI: High-Definition Multimedia Interface is a standard for multimedia interfaces used in consumer electronics and AV devices capable of transmitting audio-visual data and control signals to HDMI-compliant devices via a single cable connection.

COMPLETE PACKAGE REQUIREMENTS: CAMERA & ACCESSORIES

The proposed Professional Digital Camera Single-Lens Reflex (SLR) Camera on offer, **MUST INCLUDE THE FOLLOWING** as a complete package and be included in the unit price of the proposal:

- One (1) x Professional Digital Camera, Single-Lens Reflex (SLR) Camera.
- One (1) x manufacturer approved carry bag with shoulder strap.
- One (1) x manufacturer approved camera charger (AC-5VX Alternating Current (AC) Adapter with Direct Current (DC) power connector coupler).
- Two (2) x manufacturer approved rechargeable Lithium-ion Batteries.
- One (1) x manufacturer approved power cable (minimum 1.5 meters).
- One (1) x manufacturer approved HDMI cable (minimum 1.5 meters).
- One (1) x manufacturer approved Lens Cap and Lens Cap Cord.
- One (1) x Owner's/User Manual (Hardcopy).
- One (1) x Owner's/User Manual (CD-Rom).
- Two (2) x 64GB Secure Digital High Capacity (SDHC) Memory Cards.
- One (1) x manufacturer approved Lens Cloth.
- The following warranties MUST be included:
 - One (1) Year Limited Warranty on electronic components.
 - Five (5) Year Limited Warranty from the date of purchase on defects on material and workmanship.

3.2 ITEM 1.2 SINGLE-SERVO AUTO-FOCUS (AF-S) LENS: 18-300MM F/3.5-6.3 G ED DX VR, COMPATIBLE WITH PROPOSED CAMERA INCLUDED UNDER ITEM 1.1

NOTE: PHOTO INCLUDED FOR ILLUSTRATION PURPOSES ONLY AND DO NOT PRESCRIBE OR SUPPORT ANY SPECIFIC PRODUCT.

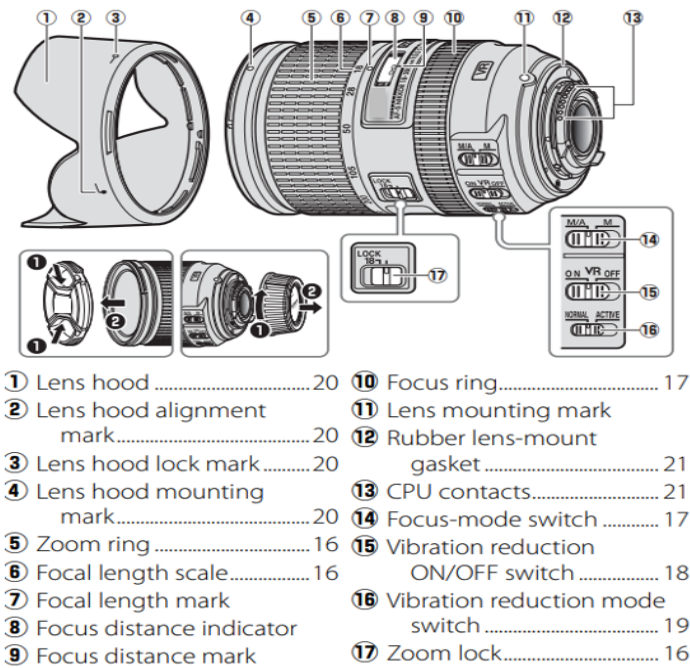

The proposed Single-Servo Auto-Focus (AF-S) Lens: 18-300mm f3.5-6.3G ED VR on offer must conform to and comply with the following minimum requirements:

- MUST be compatible with the Digital Single-Lens Reflex (SLR) professional camera on offer in Item 1.1.
- Must be a portable lens.
- Must be a F-Mount/DX Format metal mount lens.
- Must fall within the following parameters: 27-450mm (35mm Equivalent)
- Aperture Range: f/3.5 to 22.
- Lens Construction must consist of and include both:
 - Three (3) Aspherical Glass Elements.
 - Three (3) Rare Earth (ED) Glass Elements.
- Must include a Silent Wave Motor Auto-Focus (AF) & Internal Focusing.
- Must include Vibration Reduction Image Stabilization.
- Must have a Super Integrated Coating.
- Must provide for a rounded 7-Blade Circular Diaphragm.
- Filter Thread: 67mm

- Must have a lightweight body with an excellent level of optical performance for the taking of images/pictures and or video.
- Must have an innovative design such as the three Extra-Low Dispersion (Extra-low Dispersion), which refers to glass's unique characteristic that when combined with other glasses it minimizes the effects of the secondary spectrum in comparison with achromatic lenses and glass elements.

COMPLETE PACKAGE REQUIREMENTS

The proposed Single-Servo Auto-Focus (AF-S) LENS: 18-300mm f/3.5-6.3 G ED DX VR, compatible with proposed camera included under ITEM 1.1 on offer, MUST INCLUDE THE FOLLOWING as a complete package and be included in the unit price of the proposal:

- One (1) x manufacturer approved carry bag with shoulder strap.
- One (1) x manufacturer approved Front Lens Cap and Lens Cap Cord.
- One (1) manufacturer approved Rear Lens Cap.
- One (1) x manufacturer approved Bayonet Lens Hood.
- One (1) x Owner's/User Manual (Hardcopy).
- One (1) x Owner's/User Manual (CD-Rom).
- One (1) x manufacturer approved Lens Cloth.
- The following warranties MUST be included:
 - One (1) Year Limited Warranty on electronic components.
 - Five (5) Year Limited Warranty from the date of purchase on defects on material and workmanship.

3.3 ITEM 1.3 SINGLE-SERVO AUTO-FOCUS (AF-S) LENS: A 200-500MM F/5.6E ED VR, COMPATIBLE WITH PROPOSED CAMERA INCLUDED UNDER ITEM 1.1

NOTE: PHOTO INCLUDED FOR ILLUSTRATION PURPOSES ONLY AND DO NOT PRESCRIBE OR SUPPORT ANY SPECIFIC PRODUCT.

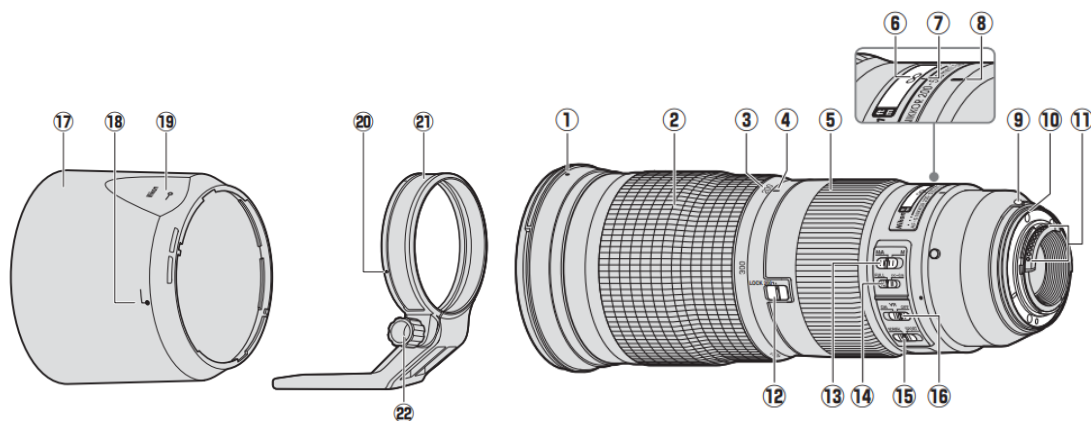

- | | |
|----------------------------|-----------------------------------|
| ① Lens hood mounting mark | ⑫ Zoom lock switch |
| ② Zoom ring | ⑬ Focus-mode switch |
| ③ Focal length scale | ⑭ Focus limit switch |
| ④ Focal length mark | ⑮ Vibration reduction mode switch |
| ⑤ Focus ring | ⑯ Vibration reduction switch |
| ⑥ Focus distance indicator | ⑰ Lens hood |
| ⑦ Focus distance mark | ⑱ Lens hood alignment mark |
| ⑧ Lens rotation index | ⑲ Lens hood lock mark |
| ⑨ Lens mounting mark | ⑳ Position indices (90°) |
| ⑩ Rubber lens-mount gasket | ㉑ Tripod collar |
| ⑪ CPU contacts | ㉒ Tripod collar lock screw |

The proposed Single-Servo Auto-Focus (AF-S) Lens: A 200-500mm f/5.6E ED VR on offer must conform to and comply with the following minimum requirements:

- MUST be compatible with the Digital Single-Lens Reflex (SLR) professional camera on offer in Item 1.1.
- Must be a portable lens.
- Must be a F-Mount/DX Format, metal mount lens.
- Type Telephoto Zoom.
- Image Circle: 35mm
- Focal Length: 200-500mm
- Advanced Photo System (APS) Equivalent: 300-750mm
- Maximum Aperture: f/5.6
- Minimum Aperture: f/32
- Must provide for a rounded nine (9) diaphragm openings.
- Diaphragm: Automatic electromagnetic aperture control.
- Lens Construction must consist of and include both:

- Nineteen (19) Aspherical Glass Elements in twelve (12) groups.
- Three (3) Rare Earth (ED) Glass Elements.
- Must have a Super Integrated Coating.
- Angle of View (based on image circle):
 - FX-format D-SLR cameras: 12° 20' to 5° 00'.
 - DX-format D-SLR cameras: 8° 00' to 3° 10'.
- Focus Details: Internal focusing with Single-Servo Auto-Focus (AF-S) (Silent Wave Motor).
- Focus Range Limiter.
- Minimum Focus Distance: 2.2 m (7.22 ft) from focal plane.
- Metering: Full aperture.
- Filter-attachment Size: 95 mm (P = 1.0 mm).
- Approximate Dimensions:
 - 108mm maximum diameter x 267.5 mm (distance from camera lens mount flange).
 - Weight:
 - 2300g (5 lb 1.2 oz), including tripod collar.
 - 2090g (4 lb 9.8 oz) without tripod collar.
- Autofocus: Yes
- Focus Modes:
 - Manual.
 - Manual/Auto.
 - Internal Focusing (IF) System with autofocus controlled by Silent Wave Motor and separate focus ring for manual focus.
- Focus Limit Switch: FULL, ∞ to 6 m
- Focus Distance Indicator: Yes
- Focal Length Scale: Graduated in millimetres (200, 300, 400, 500)
- Zoom: Manual zoom using independent zoom ring

COMPLETE PACKAGE REQUIREMENTS

The proposed Single-Servo Auto-Focus (AF-S) Lens: A 200-500mm f/5.6E ED VR, compatible with proposed camera included under ITEM 1.1 on offer, **MUST INCLUDE THE FOLLOWING** as a complete package and be included in the unit price of the proposal:

- One (1) x manufacturer approved One Lens Case.
- One (1) x manufacturer approved carry bag with shoulder strap.
- One (1) x manufacturer approved 95mm snap-on Front Lens Cap and Lens Cap Cord.
- One (1) manufacturer approved Rear Lens Cap.
- One (1) x manufacturer approved Bayonet Lens Hood.
- One (1) x Owner's/User Manual (Hardcopy).
- One (1) x Owner's/User Manual (CD-Rom).
- One (1) x manufacturer approved Lens Cloth.
- The following warranties MUST be included:
 - One (1) Year Limited Warranty on electronic components.
 - Five (5) Year Limited Warranty from the date of purchase on defects on material and workmanship.

3.4 ITEM 2. DIGITAL CAMERA SINGLE-LENS REFLEX (SLR) – STANDARD CAMERA - INCLUDING LENSES AND ACCESSORIES.

NOTE: PHOTO INCLUDED FOR ILLUSTRATION PURPOSES ONLY AND DO NOT PRESCRIBE OR SUPPORT ANY SPECIFIC PRODUCT.

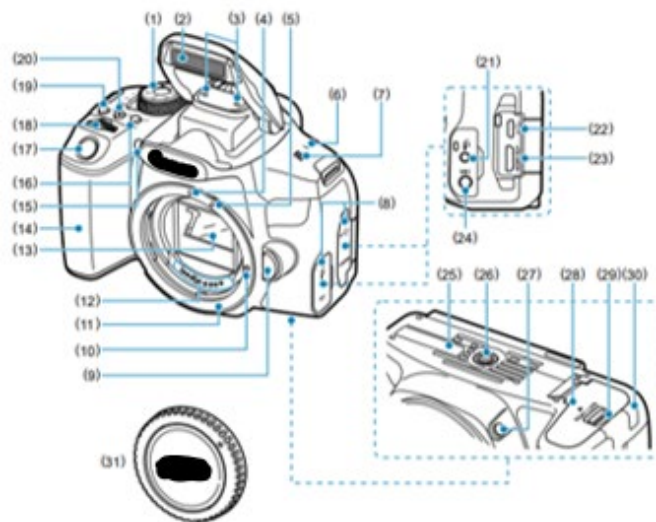

- (1) Mode dial
- (2) Built-in flash/AF-assist beam emitter
- (3) Microphone
- (4) EF lens mount index
- (5) EF-S lens mount index
- (6) < > Focal plane mark
- (7) Speaker
- (8) Terminal cover
- (9) Lens release button
- (10) Lens lock pin
- (11) Lens mount
- (12) Contacts
- (13) Mirror
- (14) Grip
- (15) Red-eye reduction/Self-timer lamp
- (16) < [] > AF area/AF method selection button
- (17) Shutter button
- (18) < [] > Main dial
- (19) < DISP > Display button
- (20) < ISO > ISO speed setting button
- (21) < [] > Remote control terminal
- (22) < [] > Digital terminal
- (23) < HDMI OUT > HDMI mini OUT terminal
- (24) < MIC > External microphone IN terminal
- (25) Serial number
- (26) Tripod socket
- (27) Depth-of-field preview button
- (28) Battery compartment cover
- (29) Battery compartment cover lock
- (30) DC cord hole
- (31) Body cap

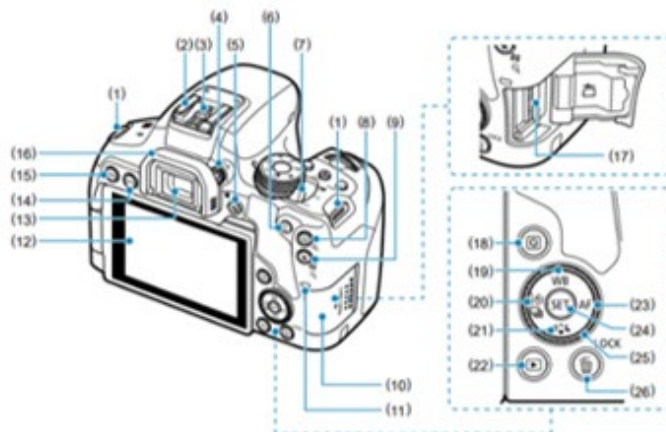

- (1) Strap mount
- (2) Hot shoe
- (3) Flash sync contacts
- (4) Diopter adjustment knob
- (5) < [] > Live View shooting/Movie shooting button
Switches from viewfinder display to Live View display. Recording is possible when the power switch is set to < [] >.
- (6) < [] > AF start button
- (7) Power switch
- (8) < [] > AF point selection/< [] > Magnify button
- (9) < [] > AE lock/FE lock/< [] > Index/Reduce button
- (10) Card slot cover
- (11) Access lamp
- (12) Screen
- (13) Viewfinder eyepiece
- (14) < INFO > Info button
- (15) < MENU > Menu button
- (16) Eyecup
- (17) Card slot
- (18) < [] > Quick Control button
- (19) < [] / WB > Up/White balance selection button
- (20) < [] / [] / [] > Left/Self-timer/Drive mode selection button
- (21) < [] / [] > Down/Picture Style selection button
- (22) < [] > Playback button
- (23) < [] / AF > Right/AF operation selection button
- (24) < [] > Setting button
- (25) < [] > Quick control dial
- (26) < [] > Erase/LOCK > Lock button

The Standard Digital Camera Single-Lens Reflex (SLR) Camera with Lenses and accessories must conform to and comply with the following minimum requirements:

SPECIFICATION

Image Sensor	
Type	22.3mm x 14.9 mm CMOS
Effective Pixels	Approximately 24.10 megapixels
Total Pixels	Approximately 25.80 megapixels
Aspect Ratio	3:2
Low-Pass Filter	Built-in/Fixed
Sensor Cleaning	EOS integrated cleaning system
Colour Filter Type	Primary Colour
Image Processor	
Type	DIGIC 8
Lens	
Lens Mount	EF/EF-S
Focal length	Equivalent to 1.6x the focal length of the lens
Image Stabilisation	Optical Image Stabilizer on compatible lens Movie: In-camera 5-axis Digital IS available. Further stabilisation enhancements from lenses compatible with Dynamic IS 1
Focusing	
Type	Via optical viewfinder: TTL secondary image-forming phase-difference detection system with AF-dedicated sensor Via liveview on LCD screen: Dual Pixel CMOS AF System. Phase detection pixels built onto imaging sensor 2
AF System / Points	Via optical viewfinder: <ul style="list-style-type: none"> 45 cross-type AF points. 45 f/5.6 cross-type AF points. 27 f/8 points (9 cross-type). Centre point is f/2.8 and f/5.6 dual cross-type 3 Via liveview on LCD screen:

	<p>Maximum 143 AF points via camera automatic selection 4</p> <p>Freely position 1 AF point/ 1 AF Zone (9 points, 3x3 grid) via manual selection 5</p>
AF working range	-4 - 18 EV
AF Point Selection	<p>Via optical viewfinder:</p> <p>Automatic selection: 45-point AF (with iTR Face Priority)</p> <p>Manual selection: Single point AF</p> <p>Manual selection: Zone AF</p> <p>Manual selection: Large Zone AF</p>
Selected AF point display	Indicated by a transmissive LCD in viewfinder and Quick Control screen
Predictive AF	Yes
AF Lock	Locked when shutter button is pressed halfway in One Shot AF mode or AF-ON Button is pressed
AF Assist Beam	Intermittent firing of built-in flash (effective range up to 4.0 m)
Manual Focus	Selected on lens
Exposure Control	
Metering modes	<p>Via optical viewfinder:</p> <p>220,000-pixel RGB+IR metering sensor</p> <p>Metering with the area divided into 216 segments (18 × 12)</p> <p>(1) Evaluative metering (linked to all AF points)</p> <p>(2) Partial metering (approximately 6.5 % of viewfinder)</p> <p>(3) Spot metering (approximately 2.0 % of viewfinder)</p> <p>(4) Center-weighted average metering</p> <p>Via liveview on LCD screen:</p> <p>(1) Evaluative metering (384 zones)</p> <p>(2) Partial metering (approximately 5.8 % of LCD screen)</p> <p>(3) Spot metering (approximately 2.9 % of LCD screen)</p> <p>(4) Center-weighted average metering</p>
Metering Range	Via optical viewfinder:

	<p>EV 1-20 (at 23 °C with 50mm f/1.4 lens ISO 100)</p> <p>Via liveview on LCD screen:</p> <p>EV -2-20 (at 23 °C, ISO 100, evaluative metering)</p> <p>Movie: EV 0-20 (at 23 °C, ISO 100, evaluative metering)</p>
AE Lock	<p>Auto: In One-shot AF mode with evaluative metering exposure is locked when focus is achieved.</p> <p>Manual: By AE Lock Button in creative zone modes.</p>
Exposure Compensation	+/-5 EV in 1/3 or 1/2 stop increments (can be combined with AEB).
AEB	3 shots +/-3 EV 1/3 or 1/2 stop increments
ISO Sensitivity	<p>Auto (100-25600), 100-25600 (in 1/3-stop or whole stop increments)</p> <p>ISO can be expanded to H: 51200</p> <p>During Movie shooting: Auto (100-12800), 100-12800 (in 1/3-stop or whole stop increments) ISO can be expanded to H: 25600</p>
Shutter	
Type	Electronically controlled focal-plane shutter
Speed	30-1/4000 sec (1/2 or 1/3 stop increments), Bulb (Total shutter speed range. Available range varies by shooting mode)
White Balance	
Settings	<p>AWB (Ambience priority, White priority), Daylight, Shade, Cloudy, Tungsten light, White</p> <p>Fluorescent light, Flash, Custom, Colour Temperature Setting.</p> <p>White balance compensation:</p> <ol style="list-style-type: none"> 1. Blue/Amber bias +/-9 levels 2. Magenta/ Green bias +/-9 levels
Custom White Balance	Yes, 1 setting can be registered
WB Bracketing	<p>+/-3 levels in single level increments</p> <p>3 bracketed images per shutter release.</p> <p>Selectable Blue/Amber bias or Magenta/ Green bias.</p>

Viewfinder	
Type	Pentamirror
Coverage (Vertical/Horizontal)	Approximately 95 %
Magnification	Approximately 0.82x ⁷
Eyepoint	Approximately 19 mm (from eyepiece lens centre)
Dioptre Correction	-3 to +1 m-1 (diopetre)
Focusing Screen	Fixed (Translucent LCD screen for information overlay)
Mirror	Quick-return half mirror (Transmission: reflection ratio of 40:60, no mirror cut-off with EF 600mm f/4 IS USM or shorter)
Viewfinder Information	<p>AF information: AF points, focus confirmation, AF area selection mode</p> <p>Exposure information: Shutter speed, aperture value, ISO speed (always displayed), AE lock, exposure level/compensation, spot metering circle, exposure warning, AEB.</p> <p>Flash information: Flash ready, high-speed sync, FE lock, flash exposure compensation, red-eye reduction light, AI Bounce mode active</p> <p>Image information: Card information, maximum burst (1 digit display), Highlight tone priority (D+).</p> <p>Composition information: Grid, Aspect Ratio</p> <p>Other information: Warning icon, Flicker Detection</p>
Depth of field preview	Yes, with Depth of Field preview button.
Eyepiece shutter	Not provided
LCD Monitor	
Type	Vari angle touchscreen 7.5 cm (3.0") 3:2 Clear View II TFT, approximately 1040 K sRGB dots

Coverage	Approximately 100%
Viewing Angle (horizontally/vertically)	Approximately 170°
Brightness Adjustment	Adjustable to one of seven levels
Display Options	<ul style="list-style-type: none"> - Quick Control Screen - Camera settings - Electronic Level
Flash	
Built-in Flash GN (ISO 100, meters)	Yes (12)
Built-in Flash Coverage	Up to 17mm focal length (35mm equivalent: approximately 28mm)
Built-in Flash recycle time	Approximately 5 seconds
Modes	Auto, Manual flash, Integrated Speedlight Transmitter
Red-Eye Reduction	Yes - with red-eye reduction lamp
X-sync	1/200 sec
Flash Exposure Compensation	+/- 2 EV in 1/2 or 1/3 increments
Flash Exposure Bracketing	Yes, with compatible External Flash
Flash Exposure Lock	Yes
Second Curtain Synchronisation	Yes
HotShoe / PC terminal	Yes/ No
External Flash Compatibility	E-TTL II with EX series Speedlites, wireless optical multi-flash support
External Flash Control	via camera menu screen
Shooting	
Modes	Scene Intelligent Auto (Stills and Movie), No Flash, Creative Auto, SCN(Portrait, Smooth Skin, Landscape, Close-up, Sports, Group Photo, Night Portrait, Handheld Night Scene, HDR Backlight Control, Food, Kids, Candlelight), Creative filters, Program AE, Shutter priority

	AE, Aperture priority AE, Manual (Stills and Movie), Self Portrait
Picture Styles	Auto, Standard, Portrait, Landscape, Fine Detail, Neutral, Faithful, Monochrome, User Defined (x3)
Colour Space	sRGB and Adobe RGB
Image Processing	<p>Highlight Tone Priority</p> <p>Auto Lighting Optimizer (4 settings)</p> <p>Long exposure noise reduction</p> <p>High ISO speed noise reduction (4 settings)</p> <p>Multi Shot Noise Reduction</p> <p>Auto Correction of Lens Peripheral illumination, Chromatic aberration correction, Distortion correction, Diffraction correction</p> <p>Creative filters (Grainy B/W, Soft focus, Fish-eye effect, Water painting effect, Toy camera effect, Miniature effect, HDR art standard, HDR art vivid, HDR art bold, HDR art embossed)</p> <p>Resize, Crop (JPEG only)</p>
Drive modes	Single, Continuous L, Continuous H, Self-timer (continuous, continuous panning, 2s+remote, 10s +remote)
Continuous Shooting	<p>Max. approximately 7fps via viewfinder.</p> <p>Max. approximately 7.5fps via Live View</p>
Live View Mode	
Coverage	Approximately 100% (horizontally and vertically)
Focusing	<p>Manual Focus (Magnify the image 5x or 10x at any point on screen)</p> <p>Autofocus: Dual Pixel CMOS AF (Face detection and Tracking AF, FlexiZone-Multi, FlexiZone-Single)</p> <p>One-shot AF and Servo AF selectable for Stills and Movie</p>
Metering	<p>Real-time evaluative metering with image sensor.</p> <p>Evaluative metering, partial metering, spot metering, center-weighted average metering.</p>

Display Options	Grid overlay (x3), Histogram
File Type	
Still Image Type	JPEG: Fine, Normal (Exif 2.31 compliant) / Design rule for Camera File system (2.0) RAW: RAW (CR3 14-bit), CRAW (Compact RAW) Digital Print Order Format [DPOF] Version 1.1 compliant
RAW+JPEG simultaneous recording	RAW, RAW + L possible.
Image Size	JPEG 3:2: (L) 6000 x 4000, (M) 3984 x 2656, (S1) 2976 x 1984, (S2) 2400x1600, JPEG 4:3: (L) 5328x4000, (M) 3552x2664, (S1) 2656x1992, (S2) 2112x1600, JPEG 16:9: (L) 6000x3368, (M) 3984x2240, (S1) 2976x1680, (S2) 2400x1344, JPEG 1:1: (L) 4000x4000, (M) 2656x2656, (S1) 1984x1984, (S2) 1600x1600, RAW: (RAW) 6000x4000
Movie Type	MP4 [Video: MPEG-4 AVC/H.264, Audio: AAC]
Movie Size	4K UHD 3840 x 2160 (25, 23.98 fps) inter-frame * 4K Time-lapse 3840 x 2160 (29.97, 25 fps) ALL-I Full HD 1920 x 1080 (59.94, 50 fps) inter-frame ** Full HD 1920 x 1080 (29.97, 25, 23.98 fps) inter-frame ** Full HD 1920 x 1080 (29.97, 25) lite inter-frame ** HD 1280 x 720 (59.94, 50 fps) inter-frame ** The image is cropped around the centre of the image sensor by 64%. When Digital Movie Image Stabilisation is enabled the stabilised image area is around 57% in case of 4K recording. When Digital Movie Image Stabilisation is set to enhanced the stabilised image area is around 44% in case of 4K recording. The image is cropped around the centre of the image sensor, when Digital Movie Image Stabilisation is

	enabled. The stabilised image area is around 90% in case of Full HD or HD recording. When Digital Movie Image Stabilisation is set to enhanced, the stabilised image area is around 70% in case of Full HD or HD recording.
Movie Length	Max duration of approximately 30 min.
Folders	New folders can be manually created and selected
File Numbering	<ul style="list-style-type: none"> - Consecutive numbering - Auto reset - Manual reset
Additional Features	
Custom Functions	Yes
Metadata Tag	User copyright information (can be set in camera) Image rating (0-5 stars)
Playback zoom	1.5x - 10x
Display Formats	<ul style="list-style-type: none"> - Single image with information on 2 levels - Single image - 4 image index - 9 image index - 36 image index - 100 image index - Jump Display
Slide Show	Choose images with Image Search Playback time: 1/2/3/5/10/20 seconds Repeat: On/Off Background music: On/Off Transition effect: Off, Slide in 1, Slide in 2, Fade 1, Fade 2, Fade 3
Histogram	Brightness: Yes RGB: Yes
Highlight Alert	Included
Image Erase/Protection	Erase: Select image, select range, all images in folder, all images on a card, all found images (during image search)

	Protection: Single image, select range, all images in folder, all images on a card, all found images (during image search)
Menu Categories	Menu interface adjustable by the user between standard and guided <ul style="list-style-type: none"> - Shooting menu - Playback menu - Wireless menu - Setup menu - Display Options menu - My Menu
Menu Languages	29 Languages including English
GPS	Compatible with GPS receiver GP-E2
Firmware Update	Update possible by the user.
Interface	
Computer	Hi-Speed USB
Wi-Fi	Wireless LAN (IEEE802.11b/g/n), (2.4 GHz only, 1-11 ch)
Wi-Fi Security	Camera Access Point: WPA2-PSK with AES encryption or open Infrastructure: Shared key, with WEP encryption, WPA-PSK/WPA2-PSK with TKIP/AES encryption or open
Bluetooth	Bluetooth® (Specification version 4.1, Bluetooth low energy technology) 8
Other	Video output (PAL/ NTSC) (integrated with USB terminal), HDMI mini output (HDMI-CEC compatible), External microphone (3.5mm Stereo mini jack)
Printing	
Printers	Compact Photo Printers and PIXMA Printers supporting PictBridge
Storage	
Type	SD, SDHC, SDXC (UHS Speed Class 1 compatible)
Supported Operating System	

PC & Macintosh	PC and Mac computers, see support pages for latest software requirements
Software	
Image Processing	Digital Photo Professional 4 (RAW Image Processing)
Other	EOS Utility EOS Lens Registration Tool EOS Web Service Registration Tool EOS Sample Music Picture Style Editor Camera Connect app available on iOS and Android devices
Power Source	
Batteries	Rechargeable Li-ion Battery LP-E17
Battery life	Viewfinder Shooting: Approximately 800 (at 23°C, AE 50%, FE 50%) 9 Approximately 730 (at 0°C, AE 50%, FE 50%) Live View Shooting: Approximately 310 (at 23°C, AE 50%, FE 50%) 10 Approximately 290 (at 0°C, AE 50%, FE 50%)
Battery Indicator	Yes – 5 level indicator.
Power saving	Power turns off after 10/30 (10 sec viewfinder/30 sec live view, functions, image playback etc.) sec, 30 sec, 1, 2, 4, 8, or 15 mins. Can be disabled.
Power Supply & Battery Chargers	AC Adapter AC-E6N, DC coupler: DR-E18, Battery charger LC-E17E

COMPLETE PACKAGE REQUIREMENTS: CAMERA & ACCESSORIES

The proposed Standard Digital Camera Single-Lens Reflex (SLR) Camera with entry level lenses and accessories on offer, MUST INCLUDE THE FOLLOWING as a complete package and be included in the unit price of the proposal:

- One (1) Standard Digital Camera Single-Lens Reflex (SLR) Camera.
- One (1) x Digital Camera Single-Lens Reflex (SLR), Lens: 18-55mm, compatible with camera on offer, with a manufacturer approved nylon carry case

- One (1) x Digital Camera Single-Lens Reflex (SLR), Lens: 70-300mm, compatible with camera on offer, with a manufacturer approved nylon carry case.
- One (1) x manufacturer approved carry bag with shoulder strap.
- One (1) x manufacturer approved camera charger (AC-5VX Alternating Current (AC) Adapter with Direct Current (DC) power connector coupler).
- Two (2) x manufacturer approved rechargeable Lithium-ion Batteries.
- One (1) x manufacturer approved power cable (minimum 1.5 meters).
- One (1) x manufacturer approved HDMI cable (minimum 1.5 meters).
- One (1) x manufacturer approved Lens Cap and Lens Cap Cord.
- One (1) x Owner's/User Manual (Hardcopy).
- One (1) x Owner's/User Manual (CD-Rom).
- Two (2) x 64GB Secure Digital High Capacity (SDHC) Memory Cards.
- One (1) x manufacturer approved Lens Cloth.
- The following warranties MUST be included:
 - One (1) Year Limited Warranty on electronic components.
 - Five (5) Year Limited Warranty from the date of purchase on defects on material and workmanship.

4. DELIVERABLES

There will be a COMPULSORY briefing session to be held at Tshwane Metro Police Department Main Hall at 118 WF Nkomo Street Pretoria West, to allow the bidders to ask technical and product specific questions.

5. CONDITIONS OF BOARD QUOTATION

Bidders should note that as part of their delivery, it is compulsory to submit a manufacturer's warranty of:

- One (1) Year Limited Warranty on electronic components.
- Five (5) Year Limited Warranty from the date of purchase on defects on material and workmanship.

No product will be accepted without such a warranty.

6. EVALUATION CRITERIA

The bid will be evaluated in the following stages:

STAGE 1: ADMINISTRATIVE COMPLIANCE

All the bids will be evaluated against the administrative responsiveness requirements as set out in the list of returnable documents.

STAGE 2: MANDATORY REQUIREMENTS

Mandatory requirements: Goods/Service(s) to be supplied as per specification

- Prospective bidder must as part of their submission submit brochures of the items/products on offer by the bidders. Failure to provide these brochures will result in immediate disqualification of bidder's submission.
- Bidders should note that on the acceptance of product that the successful bidder must supply the item/product on offer as per the attached brochure. Failure to adhere to this stipulation will result in cancelation of bid and appointing the next successful bidder.

STAGE 3: PREFERENCE POINTS SYSTEM

The preferential points to be used will be the 80/20 points system in terms of the Preferential Procurement Policy Framework Act, 2000 (Act 5 of 2000) Regulations 2017.

- 80 points for price
- 20 points for B-BBEE status (service provider to submit the certified copy of the B-BBEE level rating certificate).

7. VALIDITY PERIOD

The validity period for the quotation after closure is 90 days.

8. PRICING SCHEDULE

The price must be quoted per 1 unit requested as indicated within the Pricing Schedule.

The unit price must include delivery and offloading to the TMPD HQ (Address below)

All items must be quoted for as the QAR will be awarded per item.

Delivery must take place within 10 working days of receiving the purchase order.

Products must be delivered according to the products quoted and must be according to the attached brochure as submitted as part of the bid document. No deviations will be accepted.

Invoices can only be submitted once the goods have been received and the quantities have been verified.

The delivery address is TMPD HQ, 118 WF Nkomo Street Pretoria West

8.1 ITEM 1: DIGITAL CAMERA SINGLE-LENS REFLEX (SLR) – PROFESSIONAL CAMERA.

ITEM NO	DESCRIPTION	UNIT	UNIT PRICE (Excl. VAT)
1.1	<p>Digital Camera Single-Lens Reflex (SLR) Professional Camera.</p> <p>Complete packages consist of the following:</p> <ul style="list-style-type: none"> • One (1) x Professional Digital Camera, Single-Lens Reflex (SLR) Camera. • One (1) x manufacturer approved carry bag with shoulder strap. • One (1) x manufacturer approved camera charger (AC-5VX Alternating Current (AC) Adapter with Direct Current (DC) power connector coupler). • Two (2) x manufacturer approved rechargeable Lithium-ion Batteries. • One (1) x manufacturer approved power cable (minimum 1.5 meters). • One (1) x manufacturer approved HDMI cable (minimum 1.5 meters). • One (1) x manufacturer approved Lens Cap and Lens Cap Cord. • One (1) x Owner's/User Manual (Hardcopy). • One (1) x Owner's/User Manual (CD-Rom). • Two (2) x 64GB Secure Digital High Capacity (SDHC) Memory Cards. • One (1) x manufacturer approved Lens Cloth. • The following warranties MUST be included: 	1 Unit	R

	<ul style="list-style-type: none"> ○ One (1) Year Limited Warranty on electronic components. ○ Five (5) Year Limited Warranty from the date of purchase on defects on material and workmanship. 		
1.2	<p>Single-Servo Auto-Focus (AF-S) Lens: 18-300mm f/3.5-6.3 G ED DX VR, compatible with proposed camera included under Item 1.1.</p> <p>Complete packages consist of the following:</p> <ul style="list-style-type: none"> • One (1) x manufacturer approved carry bag with shoulder strap. • One (1) x manufacturer approved Front Lens Cap and Lens Cap Cord. • One (1) manufacturer approved Rear Lens Cap. • One (1) x manufacturer approved Bayonet Lens Hood. • One (1) x Owner's/User Manual (Hardcopy). • One (1) x Owner's/User Manual (CD-Rom). • One (1) x manufacturer approved Lens Cloth. • The following warranties MUST be included: <ul style="list-style-type: none"> ○ One (1) Year Limited Warranty on electronic components. ○ Five (5) Year Limited Warranty from the date of purchase on defects on material and workmanship. 	1 Unit	R
1.3	<p>Single-Servo Auto-Focus (AF-S) Lens: 200-500mm f/5.6E ED VR, compatible with proposed camera included under Item 1.1.</p> <p>Complete packages consist of the following:</p> <ul style="list-style-type: none"> • One (1) x manufacturer approved One Lens Case. • One (1) x manufacturer approved carry bag with shoulder strap. • One (1) x manufacturer approved 95mm snap-on Front Lens Cap and Lens Cap Cord. • One (1) manufacturer approved Rear Lens Cap. • One (1) x manufacturer approved Bayonet Lens Hood. • One (1) x Owner's/User Manual (Hardcopy). • One (1) x Owner's/User Manual (CD-Rom). • One (1) x manufacturer approved Lens Cloth. • The following warranties MUST be included: <ul style="list-style-type: none"> ○ One (1) Year Limited Warranty on electronic components. ○ Five (5) Year Limited Warranty from the date of purchase on defects on material and workmanship. 	1 Unit	R
ITEM	DESCRIPTION	UNIT	UNIT PRICE

NO			(Excl. VAT)
2	<p>Digital Camera Single-Lens Reflex (SLR) – Standard Camera – including lenses and accessories</p> <ul style="list-style-type: none"> • One (1) Standard Digital Camera Single-Lens Reflex (SLR) Camera. • One (1) x Digital Camera Single-Lens Reflex (SLR), Lens: 18-55mm, compatible with camera on offer, with a manufacturer approved nylon carry case • One (1) x Digital Camera Single-Lens Reflex (SLR), Lens: 70-300mm, compatible with camera on offer, with a manufacturer approved nylon carry case. • One (1) x manufacturer approved carry bag with shoulder strap. • One (1) x manufacturer approved camera charger (AC-5VX Alternating Current (AC) Adapter with Direct Current (DC) power connector coupler). • Two (2) x manufacturer approved rechargeable Lithium-ion Batteries. • One (1) x manufacturer approved power cable (minimum 1.5 meters). • One (1) x manufacturer approved HDMI cable (minimum 1.5 meters). • One (1) x manufacturer approved Lens Cap and Lens Cap Cord. • One (1) x Owner's/User Manual (Hardcopy). • One (1) x Owner's/User Manual (CD-Rom). • Two (2) x 64GB Secure Digital High Capacity (SDHC) Memory Cards. • One (1) x manufacturer approved Lens Cloth. • The following warranties MUST be included: <ul style="list-style-type: none"> ○ One (1) Year Limited Warranty on electronic components. ○ Five (5) Year Limited Warranty from the date of purchase on defects on material and workmanship. 	1 Unit	R
TOTAL PRICE EXCL VAT			R
15% VAT			R
TOTAL PRICE INCL VAT			R

IMPORTANT:

THE CITY OF TSHWANE RESERVES THE RIGHT TO INCREASE OR DECREASE QUANTITIES OF THESE ITEMS SUBJECT TO THE AVAILABILITY OF BUDGET

9. MARKET ANALYSIS

The City of Tshwane reserves the right to conduct market analysis. Should the city exercise this option, where a bidder offers a price that is deemed not to be viable to supply goods or services as required, written confirmation will be made with the tenderer if they will be able to deliver on the price, if a bidder confirm that they cannot, the bidder will be disqualified based on being non-responsive. If they confirm that they can deliver, a tight contract to mitigate the risk of non-performance will be entered into with the service provider. Further action on failures by the appointed supplier to deliver will be handled in terms of the contract including performance warnings and listing on the database of restricted suppliers.

The City further reserves the right to negotiate a market related price with a bidder scoring the highest points. If the tenderer does not agree to a market-related price, the city reserves the right to negotiate a market-related price with the bidder scoring the second highest points, if the bidder scoring the second highest points does not agree to a market-related price, negotiate a market-related price with the bidder scoring the third highest points. If a market-related price is not agreed, the city reserves the right to cancel the bid.

**MBD1
COMPULSORY
PART A
INVITATION TO BID**

YOU ARE HEREBY INVITED TO BID FOR REQUIREMENTS OF THE (NAME OF MUNICIPALITY/ MUNICIPAL ENTITY)					
QUOTATION NUMBER:	Q40-2022-23	CLOSING DATE:	9 November 2022	CLOSING TIME:	10:00
DESCRIPTION	ADVERTISEMENT: QUOTATION FOR THE SUPPLY, DELIVERY AND OFFLOADING OF DIGITAL CAMERAS (PROFESSIONAL AND STANDARD) WITH LENSES AND ACCESSORIES TO THE TSHWANE METRO POLICE DEPARTMENT FOR A 12-MONTH PERIOD, AS AND WHEN REQUIRED				
THE SUCCESSFUL BIDDER WILL BE REQUIRED TO FILL IN AND SIGN A WRITTEN CONTRACT FORM (MBD7).					
BID RESPONSE DOCUMENTS MAY BE DEPOSITED IN THE BID BOX SITUATED AT (STREET ADDRESS					
City of Tshwane Metropolitan Municipality					
Tshwane House					
320 Madiba Street					
Pretoria					
GPS coordinates: 25.750151°S, 28.173666°E					
SUPPLIER INFORMATION					
NAME OF BIDDER					
POSTAL ADDRESS					
STREET ADDRESS					
TELEPHONE NUMBER	CODE		NUMBER		
CELLPHONE NUMBER					
FACSIMILE NUMBER	CODE		NUMBER		
E-MAIL ADDRESS					
VAT REGISTRATION NUMBER					
TAX COMPLIANCE STATUS	TCS PIN:		OR	CSD No:	
B-BBEE STATUS LEVEL VERIFICATION CERTIFICATE [TICK APPLICABLE BOX]	<input type="checkbox"/> Yes <input type="checkbox"/> No		B-BBEE STATUS LEVEL SWORN AFFIDAVIT		<input type="checkbox"/> Yes <input type="checkbox"/> No
[A B-BBEE STATUS LEVEL VERIFICATION CERTIFICATE/ SWORN AFFIDAVIT (FOR EMES & QSEs) MUST BE SUBMITTED IN ORDER TO QUALIFY FOR PREFERENCE POINTS FOR B-BBEE]					
ARE YOU THE ACCREDITED REPRESENTATIVE IN SOUTH AFRICA FOR THE GOODS /SERVICES /WORKS OFFERED?	<input type="checkbox"/> Yes <input type="checkbox"/> No [IF YES ENCLOSE PROOF]		ARE YOU A FOREIGN BASED SUPPLIER FOR THE GOODS /SERVICES /WORKS OFFERED?		<input type="checkbox"/> Yes <input type="checkbox"/> No [IF YES, ANSWER PART B:3]
SIGNATURE OF BIDDER		DATE		
CAPACITY UNDER WHICH THIS BID IS SIGNED					
BIDDING PROCEDURE ENQUIRIES MAY BE DIRECTED TO:			TECHNICAL INFORMATION MAY BE DIRECTED TO:		
DEPARTMENT	Supply Chain Management		CONTACT PERSON	Willem Breedt	
CONTACT PERSON	Josia Masenya				
TELEPHONE NUMBER	012 358 0658		TELEPHONE NUMBER	012 358 0926	
			E-MAIL ADDRESS	willemb@tshwane.gov.za	
E-MAIL ADDRESS	josiasma@tshwane.gov.za				

**MBD1
COMPULSORY**

**PART B
TERMS AND CONDITIONS FOR BIDDING**

1. BID SUBMISSION:	
1.1	BIDS MUST BE DELIVERED BY THE STIPULATED TIME TO THE CORRECT ADDRESS. LATE BIDS WILL NOT BE ACCEPTED FOR CONSIDERATION.
1.2	ALL BIDS MUST BE SUBMITTED ON THE OFFICIAL FORMS PROVIDED–(NOT TO BE RE-TYPED) OR ONLINE
1.3	THIS BID IS SUBJECT TO THE PREFERENTIAL PROCUREMENT POLICY FRAMEWORK ACT AND THE PREFERENTIAL PROCUREMENT REGULATIONS, 2017, THE GENERAL CONDITIONS OF CONTRACT (GCC) AND, IF APPLICABLE, ANY OTHER SPECIAL CONDITIONS OF CONTRACT.
2. TAX COMPLIANCE REQUIREMENTS	
2.1	BIDDERS MUST ENSURE COMPLIANCE WITH THEIR TAX OBLIGATIONS.
2.2	BIDDERS ARE REQUIRED TO SUBMIT THEIR UNIQUE PERSONAL IDENTIFICATION NUMBER (PIN) ISSUED BY SARS TO ENABLE THE ORGAN OF STATE TO VIEW THE TAXPAYER'S PROFILE AND TAX STATUS.
2.3	APPLICATION FOR THE TAX COMPLIANCE STATUS (TCS) CERTIFICATE OR PIN MAY ALSO BE MADE VIA E-FILING. IN ORDER TO USE THIS PROVISION, TAXPAYERS WILL NEED TO REGISTER WITH SARS AS E-FILERS THROUGH THE WEBSITE WWW.SARS.GOV.ZA.
2.4	FOREIGN SUPPLIERS MUST COMPLETE THE PRE-AWARD QUESTIONNAIRE IN PART B:3.
2.5	BIDDERS MAY ALSO SUBMIT A PRINTED TCS CERTIFICATE TOGETHER WITH THE BID.
2.6	IN BIDS WHERE CONSORTIA / JOINT VENTURES / SUB-CONTRACTORS ARE INVOLVED; EACH PARTY MUST SUBMIT A SEPARATE TCS CERTIFICATE / PIN / CSD NUMBER.
2.7	WHERE NO TCS IS AVAILABLE BUT THE BIDDER IS REGISTERED ON THE CENTRAL SUPPLIER DATABASE (CSD), A CSD NUMBER MUST BE PROVIDED.
3. QUESTIONNAIRE TO BIDDING FOREIGN SUPPLIERS	
3.1	IS THE ENTITY A RESIDENT OF THE REPUBLIC OF SOUTH AFRICA (RSA)? <input type="checkbox"/> YES <input type="checkbox"/> NO
3.2	DOES THE ENTITY HAVE A BRANCH IN THE RSA? <input type="checkbox"/> YES <input type="checkbox"/> NO
3.3	DOES THE ENTITY HAVE A PERMANENT ESTABLISHMENT IN THE RSA? <input type="checkbox"/> YES <input type="checkbox"/> NO
3.4	DOES THE ENTITY HAVE ANY SOURCE OF INCOME IN THE RSA? <input type="checkbox"/> YES <input type="checkbox"/> NO
3.5	IS THE ENTITY LIABLE IN THE RSA FOR ANY FORM OF TAXATION? <input type="checkbox"/> YES <input type="checkbox"/> NO
IF THE ANSWER IS "NO" TO ALL OF THE ABOVE, THEN IT IS NOT A REQUIREMENT TO REGISTER FOR A TAX COMPLIANCE STATUS SYSTEM PIN CODE FROM THE SOUTH AFRICAN REVENUE SERVICE (SARS) AND IF NOT REGISTER AS PER 2.3 ABOVE.	

**NB: FAILURE TO PROVIDE ANY OF THE ABOVE PARTICULARS MAY RENDER THE BID INVALID.
NO BIDS WILL BE CONSIDERED FROM PERSONS IN THE SERVICE OF THE STATE.**

SIGNATURE OF BIDDER:

CAPACITY UNDER WHICH THIS BID IS SIGNED:

DATE:

**MBD 4
COMPULSORY**

DECLARATION OF INTEREST

1. No bid will be accepted from persons in the service of the state¹.
2. Any person, having a kinship with persons in the service of the state, including a blood relationship, may make an offer or offers in terms of this invitation to bid. In view of possible allegations of favouritism, should the resulting bid, or part thereof, be awarded to persons connected with or related to persons in service of the state, it is required that the bidder or their authorised representative declare their position in relation to the evaluating/adjudicating authority.
3. **In order to give effect to the above, the following questionnaire must be completed and submitted with the bid.**
 - 3.1 Full Name of bidder or his or her representative:
 - 3.2 Identity Number:
 - 3.3 Position occupied in the Company (director, trustee, hareholder²)
 - 3.4 Company Registration Number:
 - 3.5 Tax Reference Number:
 - 3.6 VAT Registration Number:
 - 3.7 The names of all directors / trustees / shareholders members, their individual identity numbers and state employee numbers must be indicated in paragraph 4 below.
 - 3.8 Are you presently in the service of the state? **YES / NO**
 - 3.8.1 If yes, furnish particulars.
.....
.....

¹ MSCM Regulations: "in the service of the state" means to be –

(a) a member of –

- (i) any municipal council;
 - (ii) any provincial legislature; or
 - (iii) the national Assembly or the national Council of provinces;
- (b) a member of the board of directors of any municipal entity;
- (c) an official of any municipality or municipal entity;
- (d) an employee of any national or provincial department, national or provincial public entity or constitutional institution within the meaning of the Public Finance Management Act, 1999 (Act No.1 of 1999);
- (e) a member of the accounting authority of any national or provincial public entity; or
- (f) an employee of Parliament or a provincial legislature.

² Shareholder" means a person who owns shares in the company and is actively involved in

the management of the company or business and exercises control over the company.

3.9 Have you been in the service of the state for the past twelve months? **YES/NO**

3.9.1 If yes, furnish particulars.

.....
.....

3.10 Do you have any relationship (family, friend, other) with persons in the service of the state and who may be involved with the evaluation and or adjudication of this bid?
YES / NO

3.10.1 If yes, furnish particulars.

.....
.....

3.11 Are you, aware of any relationship (family, friend, other) between any other bidder and any persons in the service of the state who may be involved with the evaluation and or adjudication of this bid?
YES / NO

3.11.1 If yes, furnish particulars.

.....
.....

3.12 Are any of the company's directors, trustees, managers, principle shareholders or stakeholders in service of the state?
YES / NO

3.12.1 If yes, furnish particulars.

.....
.....

3.13 Are any spouse, child or parent of the company's directors trustees, managers, principle shareholders or stakeholders in service of the state?
YES / NO

3.13.1 If yes, furnish particulars.

.....
.....

3.14 Do you or any of the directors, trustees, managers, principle shareholders, or stakeholders of this company have any interest in any other related companies or business whether or not they are bidding for this contract.
YES / NO

3.14.1 If yes, furnish particulars:

.....
.....

4. Full details of directors / trustees / members / shareholders.

Full Name	Identity Number	State Employee Number

.....
Signature

.....
Date

.....
Capacity

.....
Name of Bidder

COMPULSORY**PREFERENCE POINTS CLAIM FORM IN TERMS OF THE PREFERENTIAL
PROCUREMENT REGULATIONS 2017**

This preference form must form part of all bids invited. It contains general information and serves as a claim form for preference points for Broad-Based Black Economic Empowerment (B-BBEE) Status Level of Contribution

NB: BEFORE COMPLETING THIS FORM, BIDDERS MUST STUDY THE GENERAL CONDITIONS, DEFINITIONS AND DIRECTIVES APPLICABLE IN RESPECT OF B-BBEE, AS PRESCRIBED IN THE PREFERENTIAL PROCUREMENT REGULATIONS, 2017.

1. GENERAL CONDITIONS

- 1.1 The following preference point systems are applicable to all bids:
- the 80/20 system for requirements with a Rand value of up to R50 000 000 (all applicable taxes included); and
- 1.2 The value of this bid is estimated **not to exceed** R50 000 000 (all applicable taxes included) and therefore the **80/20** preference point system shall be applicable.
- 1.3 Preference points for this bid shall be awarded for:
- (a) Price; and
 - (b) B-BBEE Status Level of Contribution.
- 1.4 The maximum points for this bid are allocated as follows:

	POINTS
PRICE	80
B-BBEE STATUS LEVEL OF CONTRIBUTION	20
Total points for Price and B-BBEE must not exceed	100

- 1.5 Failure on the part of a bidder to submit a B-BBEE Verification Certificate from a Verification Agency accredited by the South African Accreditation System (SANAS), or a Registered Auditor approved by the Independent Regulatory Board of Auditors (IRBA) or a sworn affidavit confirming annual turnover and level of black ownership in case of an EME and QSE together with the bid, will be interpreted to mean that preference points for B-BBEE status level of contribution are not claimed.
- 1.6 The purchaser reserves the right to require of a bidder, either before a bid is adjudicated or at any time subsequently, to substantiate any claim in regard to preferences, in any manner required by the purchaser.

2. DEFINITIONS

- (a) **“all applicable taxes”** includes value-added tax, pay as you earn, income tax, unemployment insurance fund contributions and skills development levies;
- (b) **“B-BBEE”** means broad-based black economic empowerment as defined in section 1 of the Broad-Based Black Economic Empowerment Act;
- (c) **“B-BBEE status level of contributor”** means the B-BBEE status received by a measured entity based on its overall performance using the relevant scorecard contained in the Codes of Good Practice on Black Economic Empowerment, issued in terms of section 9(1) of the Broad-Based Black Economic Empowerment Act;
- (d) **“bid”** means a written offer in a prescribed or stipulated form in response to an

invitation by an organ of state for the provision of services, works or goods, through price quotations, advertised competitive bidding processes or proposals;

- (e) **“Broad-Based Black Economic Empowerment Act”** means the Broad-Based Black Economic Empowerment Act, 2003 (Act No. 53 of 2003) as amended by Act No 46 of 2013;
- (f) **“comparative price”** means the price after the factors of a non-firm price and all unconditional discounts that can be utilized have been taken into consideration;
- (g) **“consortium or joint venture”** means an association of persons for the purpose of combining their expertise, property, capital, efforts, skill and knowledge in an activity for the execution of a contract;
- (h) **“contract”**Error! Bookmark not defined. means the agreement that results from the acceptance of a bid by an organ of state;
- (i) **“EME”** means an Exempted Micro Enterprise as defines by Codes of Good Practice issued in terms of section 9 (1) of the Broad-Based Black Economic Empowerment Act, 2003 (Act No. 53 of 2003);
- (j) **“Firm price”** means the price that is only subject to adjustments in accordance with the actual increase or decrease resulting from the change, imposition, or abolition of customs or excise duty and any other duty, levy, or tax, which, in terms of the law or regulation, is binding on the contractor and demonstrably has an influence on the price of any supplies, or the rendering costs of any service, for the execution of the contract;
- (k) **“functionality”** means the measurement according to predetermined norms, as set out in the bid documents, of a service or commodity that is designed to be practical and useful, working or operating, taking into account, among other factors, the quality, reliability, viability and durability of a service and the technical capacity and ability of a bidder;
- (l) **“non-firm prices”** means all prices other than “firm” prices;
- (m) **“person”** includes a juristic person;
- (n) **“QSE”** means a Qualifying Small Enterprise as defines by Codes of Good Practice issued in terms of section 9 (1) of the Broad-Based Black Economic Empowerment Act, 2003 (Act No. 53 of 2003);
- (o) **“rand value”** means the total estimated value of a contract in South African currency, calculated at the time of bid invitations, and includes all applicable taxes and excise duties;
- (p) **“sub-contract”** means the primary contractor’s assigning, leasing, making out work to, or employing, another person to support such primary contractor in the execution of part of a project in terms of the contract;
- (q) **“total revenue”** bears the same meaning assigned to this expression in the Codes of Good Practice on Black Economic Empowerment, issued in terms of section 9(1) of the Broad-Based Black Economic Empowerment Act and promulgated in the *Government Gazette* on 9 February 2007;
- (r) **“trust”** means the arrangement through which the property of one person is made over or bequeathed to a trustee to administer such property for the benefit of another person; and
- (s) **“trustee”** means any person, including the founder of a trust, to whom property is bequeathed in order for such property to be administered for the benefit of another person.

3. ADJUDICATION USING A POINT SYSTEM

- 3.1 The bidder obtaining the highest number of total points will be awarded the contract.
- 3.2 Preference points shall be calculated after prices have been brought to a comparative basis taking into account all factors of non-firm prices and all unconditional discounts;.
- 3.3 Points scored must be rounded off to the nearest 2 decimal places.
- 3.4 In the event that two or more bids have scored equal total points, the successful bid must be the one scoring the highest number of preference points for B-BBEE.
- 3.5 However, when functionality is part of the evaluation process and two or more bids have scored equal points including equal preference points for B-BBEE, the successful bid must be the one scoring the highest score for functionality.
- 3.6 Should two or more bids be equal in all respects, the award shall be decided by the drawing of lots.

4. POINTS AWARDED FOR PRICE

4.1 THE 80/20 PREFERENCE POINT SYSTEMS

A maximum of 80 points is allocated for price on the following basis:

80/20

$$P_s = 80 \left(1 - \frac{P_t - P_{\min}}{P_{\min}} \right)$$

Where

P_s = Points scored for comparative price of bid under consideration

P_t = Comparative price of bid under consideration

P_{min} = Comparative price of lowest acceptable bid

5. POINTS AWARDED FOR B-BBEE STATUS LEVEL OF CONTRIBUTION

- 5.1 In terms of Regulation 5 (2) and 6 (2) of the Preferential Procurement Regulations, preference points must be awarded to a bidder for attaining the B-BBEE status level of contribution in accordance with the table below:

B-BBEE Status Level of Contributor	Number of points (80/20 system)
1	20
2	18
3	14
4	12
5	8
6	6
7	4
8	2
Non-compliant contributor	0

- 5.2 A bidder who qualifies as an EME in terms of the B-BBEE Act must submit a sworn affidavit confirming Annual Total Revenue and Level of Black Ownership.
- 5.3 A Bidder other than EME or QSE must submit their original and valid B-BBEE status level verification certificate or a certified copy thereof, substantiating their B-BBEE rating issued by a Registered Auditor approved by IRBA or a Verification Agency accredited by SANAS.

- 5.4 A trust, consortium or joint venture, will qualify for points for their B-BBEE status level as a legal entity, provided that the entity submits their B-BBEE status level certificate.
- 5.5 A trust, consortium or joint venture will qualify for points for their B-BBEE status level as an unincorporated entity, provided that the entity submits their consolidated B-BBEE scorecard as if they were a group structure and that such a consolidated B-BBEE scorecard is prepared for every separate bid.
- 5.6 Tertiary Institutions and Public Entities will be required to submit their B-BBEE status level certificates in terms of the specialized scorecard contained in the B-BBEE Codes of Good Practice.
- 5.7 A person will not be awarded points for B-BBEE status level if it is indicated in the bid documents that such a bidder intends sub-contracting more than 25% of the value of the contract to any other enterprise that does not qualify for at least the points that such a bidder qualifies for, unless the intended sub-contractor is an EME that has the capability and ability to execute the sub-contract.
- 5.8 A person awarded a contract may not sub-contract more than 25% of the value of the contract to any other enterprise that does not have an equal or higher B-BBEE status level than the person concerned, unless the contract is sub-contracted to an EME that has the capability and ability to execute the sub-contract.

6. BID DECLARATION

- 6.1 Bidders who claim points in respect of B-BBEE Status Level of Contribution must complete the following:

7. B-BBEE STATUS LEVEL OF CONTRIBUTION CLAIMED IN TERMS OF PARAGRAPHS 1.4 AND 5.1

- 7.1 B-BBEE Status Level of Contribution: = (maximum of 10 or 20 points)

(Points claimed in respect of paragraph 7.1 must be in accordance with the table reflected in paragraph 5.1 and must be substantiated by means of a B-BBEE certificate issued by a Verification Agency accredited by SANAS or a Registered Auditor approved by IRBA or a sworn affidavit.

Designated Group: An EME or QSE which is at least 51% owned by:	EME √	QSE √
Black people		
Black people who are youth		
Black people who are women		
Black people with disabilities		
Black people living in rural or underdeveloped areas or townships		
Cooperative owned by black people		
Black people who are military veterans		
OR		
Any EME		
Any QSE		

8. SUB-CONTRACTING

8.1 Will any portion of the contract be sub-contracted?

(Tick applicable box)

YES		NO	
-----	--	----	--

8.1.1 If yes, indicate:

- i) What percentage of the contract will be subcontracted%
- ii) The name of the sub-contractor
- iii) The B-BBEE status level of the sub-contractor.....
- iv) Whether the sub-contractor is an EME.

(Tick applicable box)

YES		NO	
-----	--	----	--

9. DECLARATION WITH REGARD TO COMPANY/FIRM

9.1 Name of company/firm:

9.2 VAT registration number:

9.3 Company registration number:

9.4 TYPE OF COMPANY/ FIRM

- ☐ Partnership/Joint Venture / Consortium
- ☐ One person business/sole propriety
- ☐ Close corporation
- ☐ Company
- ☐ (Pty) Limited

[TICK APPLICABLE BOX]

9.5 DESCRIBE PRINCIPAL BUSINESS ACTIVITIES

.....

.....

.....

.....

9.6 COMPANY CLASSIFICATION

- ☐ Manufacturer
- ☐ Supplier
- ☐ Professional service provider
- ☐ Other service providers, e.g. transporter, etc.

[TICK APPLICABLE BOX]

9.7 MUNICIPAL INFORMATION

Municipality where business is situated:

Registered Account Number:

Stand Number:

9.8 Total number of years the company/firm has been in business:

9.9 I/we, the undersigned, who is / are duly authorised to do so on behalf of the company/firm, certify that the points claimed, based on the B-BBE status level of contribution indicated in paragraph 7 of the foregoing certificate, qualifies the company/ firm for the preference(s) shown and I / we acknowledge that:

- i) The information furnished is true and correct;
- ii) The preference points claimed are in accordance with the General Conditions as indicated in paragraph 1 of this form;
- iii) In the event of a contract being awarded as a result of points claimed as shown in paragraph 7, the contractor may be required to furnish documentary proof to the satisfaction of the purchaser that the claims are correct;
- iv) If the B-BBEE status level of contribution has been claimed or obtained on a fraudulent basis or any of the conditions of contract have not been fulfilled, the purchaser may, in addition to any other remedy it may have –
 - (a) disqualify the person from the bidding process;
 - (b) recover costs, losses or damages it has incurred or suffered as a result of that person's conduct;
 - (c) cancel the contract and claim any damages which it has suffered as a result of having to make less favourable arrangements due to such cancellation;
 - (d) restrict the bidder or contractor, its shareholders and directors, or only the shareholders and directors who acted on a fraudulent basis, from obtaining business from any organ of state for a period not exceeding 10 years, after the *audi alteram partem* (hear the other side) rule has been applied; and
 - (e) forward the matter for criminal prosecution.

WITNESSES

- 1.
- 2.

.....
SIGNATURE(S) OF BIDDERS(S)

DATE:

ADDRESS

.....

.....

CONTRACT FORM - PURCHASE OF GOODS/WORKS

THIS FORM MUST BE FILLED IN DUPLICATE BY BOTH THE SUCCESSFUL BIDDER (PART 1) AND THE PURCHASER (PART 2). BOTH FORMS MUST BE SIGNED IN THE ORIGINAL SO THAT THE SUCCESSFUL BIDDER AND THE PURCHASER WOULD BE IN POSSESSION OF ORIGINALLY SIGNED CONTRACTS FOR THEIR RESPECTIVE RECORDS.

PART 1 (TO BE FILLED IN BY THE BIDDER)

1. I hereby undertake to supply all or any of the goods and/or works described in the attached bidding documents to (name of institution) in accordance with the requirements and specifications stipulated in bid number..... at the price/s quoted. My offer/s remain binding upon me and open for acceptance by the purchaser during the validity period indicated and calculated from the closing time of bid.
2. The following documents shall be deemed to form and be read and construed as part of this agreement:
 - (i) Bidding documents, viz
 - Invitation to bid;
 - Tax clearance certificate;
 - Pricing schedule(s);
 - Technical Specification(s);
 - Preference claims for Broad Based Black Economic Empowerment Status Level of Contribution in terms of the Preferential Procurement Regulations 2011;
 - Declaration of interest;
 - Declaration of bidder's past SCM practices;
 - Certificate of Independent Bid Determination;
 - Special Conditions of Contract;
 - (ii) General Conditions of Contract; and
 - (iii) Other (specify)
3. I confirm that I have satisfied myself as to the correctness and validity of my bid; that the price(s) and rate(s) quoted cover all the goods and/or works specified in the bidding documents; that the price(s) and rate(s) cover all my obligations and I accept that any mistakes regarding price(s) and rate(s) and calculations will be at my own risk.
4. I accept full responsibility for the proper execution and fulfilment of all obligations and conditions devolving on me under this agreement as the principal liable for the due fulfilment of this contract.
5. I declare that I have no participation in any collusive practices with any bidder or any other person regarding this or any other bid.
6. I confirm that I am duly authorised to sign this contract.

NAME (PRINT)
 CAPACITY
 SIGNATURE
 NAME OF FIRM
 DATE

WITNESSES

1.
 2.
 DATE:

CONTRACT FORM - PURCHASE OF GOODS/WORKS**PART 2 (TO BE FILLED IN BY THE PURCHASER)**

1. I..... in my capacity as..... accept your bid under reference numberdated.....for the supply of goods/works indicated hereunder and/or further specified in the annexure(s).
2. An official order indicating delivery instructions is forthcoming.
3. I undertake to make payment for the goods/works delivered in accordance with the terms and conditions of the contract, within 30 (thirty) days after receipt of an invoice accompanied by the delivery note.

ITEM NO.	PRICE (ALL APPLICABLE TAXES INCLUDED)	BRAND	DELIVERY PERIOD	B-BBEE STATUS LEVEL OF CONTRIBUTION	MINIMUM THRESHOLD FOR LOCAL PRODUCTION AND CONTENT (if applicable)

4. I confirm that I am duly authorized to sign this contract.

SIGNED ATON.....

NAME (PRINT)

SIGNATURE

OFFICIAL STAMP

WITNESSES

1.

2.

DATE:

COMPULSORY

DECLARATION OF BIDDER'S PAST SUPPLY CHAIN MANAGEMENT PRACTICES

- 1 This Municipal Bidding Document must form part of all bids invited.
- 2 It serves as a declaration to be used by municipalities and municipal entities in ensuring that when goods and services are being procured, all reasonable steps are taken to combat the abuse of the supply chain management system.
- 3 The bid of any bidder may be rejected if that bidder, or any of its directors have:
 - a. abused the municipality's / municipal entity's supply chain management system or committed any improper conduct in relation to such system;
 - b. been convicted for fraud or corruption during the past five years;
 - c. willfully neglected, reneged on or failed to comply with any government, municipal or other public sector contract during the past five years; or
 - d. been listed in the Register for Tender Defaulters in terms of section 29 of the Prevention and Combating of Corrupt Activities Act (No 12 of 2004).
- 4 **In order to give effect to the above, the following questionnaire must be completed and submitted with the bid.**

Item	Question	Yes	No
4.1	Is the bidder or any of its directors listed on the National Treasury's Database of Restricted Suppliers as companies or persons prohibited from doing business with the public sector? (Companies or persons who are listed on this Database were informed in writing of this restriction by the Accounting Officer/Authority of the institution that imposed the restriction after the <i>audi alteram partem</i> rule was applied). The Database of Restricted Suppliers now resides on the National Treasury's website (www.treasury.gov.za) and can be accessed by clicking on its link at the bottom of the home page.	Yes <input type="checkbox"/>	No <input type="checkbox"/>
4.1.1	If so, furnish particulars:		
4.2	Is the bidder or any of its directors listed on the Register for Tender Defaulters in terms of section 29 of the Prevention and Combating of Corrupt Activities Act (No 12 of 2004)? The Register for Tender Defaulters can be accessed on the National Treasury's website (www.treasury.gov.za) by clicking on its link at the bottom of the home page.	Yes <input type="checkbox"/>	No <input type="checkbox"/>

4.2.1	If so, furnish particulars:		
4.3	Was the bidder or any of its directors convicted by a court of law (including a court of law outside the Republic of South Africa) for fraud or corruption during the past five years?	Yes <input type="checkbox"/>	No <input type="checkbox"/>
4.3.1	If so, furnish particulars:		
4.4	Does the bidder or any of its directors owe any municipal rates and taxes or municipal charges to the municipality / municipal entity, or to any other municipality / municipal entity, that is in arrears for more than three months?	Yes <input type="checkbox"/>	No <input type="checkbox"/>
4.4.1	If so, furnish particulars:		
4.5	Was any contract between the bidder and the municipality / municipal entity or any other organ of state terminated during the past five years on account of failure to perform on or comply with the contract?	Yes <input type="checkbox"/>	No <input type="checkbox"/>
4.7.1	If so, furnish particulars:		

CERTIFICATION

**I, THE UNDERSIGNED (FULL NAME)
CERTIFY THAT THE INFORMATION FURNISHED ON THIS DECLARATION
FORM TRUE AND CORRECT.**

**I ACCEPT THAT, IN ADDITION TO CANCELLATION OF A CONTRACT, ACTION
MAY BE TAKEN AGAINST ME SHOULD THIS DECLARATION PROVE TO BE
FALSE.**

.....
Signature

.....
Date

.....
Position

.....
Name of Bidder

CERTIFICATE OF INDEPENDENT BID DETERMINATION

- 1 This Municipal Bidding Document (MBD) must form part of all bids¹ invited.
- 2 Section 4 (1) (b) (iii) of the Competition Act No. 89 of 1998, as amended, prohibits an agreement between, or concerted practice by, firms, or a decision by an association of firms, if it is between parties in a horizontal relationship and if it involves collusive bidding (or bid rigging).² Collusive bidding is a *pe se* prohibition meaning that it cannot be justified under any grounds.
- 3 Municipal Supply Regulation 38 (1) prescribes that a supply chain management policy must provide measures for the combating of abuse of the supply chain management system, and must enable the accounting officer, among others, to:
 - a. take all reasonable steps to prevent such abuse;
 - b. reject the bid of any bidder if that bidder or any of its directors has abused the supply chain management system of the municipality or municipal entity or has committed any improper conduct in relation to such system; and
 - c. cancel a contract awarded to a person if the person committed any corrupt or fraudulent act during the bidding process or the execution of the contract.
- 4 This MBD serves as a certificate of declaration that would be used by institutions to ensure that, when bids are considered, reasonable steps are taken to prevent any form of bid-rigging.
- 5 In order to give effect to the above, the attached Certificate of Bid Determination (MBD 9) must be completed and submitted with the bid:

¹ Includes price quotations, advertised competitive bids, limited bids and proposals.

² Bid rigging (or collusive bidding) occurs when businesses, that would otherwise be expected to compete, secretly conspire to raise prices or lower the quality of goods and / or services for purchasers who wish to acquire goods and / or services through a bidding process. Bid rigging is, therefore, an agreement between competitors not to compete.

CERTIFICATE OF INDEPENDENT BID DETERMINATION

I, the undersigned, in submitting the accompanying bid:

(Bid Number and Description)

in response to the invitation for the bid made by:

(Name of Municipality / Municipal Entity)

do hereby make the following statements that I certify to be true and complete in every respect:

I certify, on behalf of: _____ that:
(Name of Bidder)

1. I have read and I understand the contents of this Certificate;
2. I understand that the accompanying bid will be disqualified if this Certificate is found not to be true and complete in every respect;
3. I am authorized by the bidder to sign this Certificate, and to submit the accompanying bid, on behalf of the bidder;
4. Each person whose signature appears on the accompanying bid has been authorized by the bidder to determine the terms of, and to sign, the bid, on behalf of the bidder;
5. For the purposes of this Certificate and the accompanying bid, I understand that the word "competitor" shall include any individual or organization, other than the bidder, whether or not affiliated with the bidder, who:
 - (a) has been requested to submit a bid in response to this bid invitation;
 - (b) could potentially submit a bid in response to this bid invitation, based on their qualifications, abilities or experience; and
 - (c) provides the same goods and services as the bidder and/or is in the same line of business as the bidder

6. The bidder has arrived at the accompanying bid independently from, and without consultation, communication, agreement or arrangement with any competitor. However communication between partners in a joint venture or consortium³ will not be construed as collusive bidding.
7. In particular, without limiting the generality of paragraphs 6 above, there has been no consultation, communication, agreement or arrangement with any competitor regarding:
 - (a) prices;
 - (b) geographical area where product or service will be rendered (market allocation)
 - (c) methods, factors or formulas used to calculate prices;
 - (d) the intention or decision to submit or not to submit, a bid;
 - (e) the submission of a bid which does not meet the specifications and conditions of the bid; or
 - (f) bidding with the intention not to win the bid.
8. In addition, there have been no consultations, communications, agreements or arrangements with any competitor regarding the quality, quantity, specifications and conditions or delivery particulars of the products or services to which this bid invitation relates.
9. The terms of the accompanying bid have not been, and will not be, disclosed by the bidder, directly or indirectly, to any competitor, prior to the date and time of the official bid opening or of the awarding of the contract.

³ Joint venture or Consortium means an association of persons for the purpose of combining their expertise, property, capital, efforts, skill and knowledge in an activity for the execution of a contract.

10. I am aware that, in addition and without prejudice to any other remedy provided to combat any restrictive practices related to bids and contracts, bids that are suspicious will be reported to the Competition Commission for investigation and possible imposition of administrative penalties in terms of section 59 of the Competition Act No 89 of 1998 and or may be reported to the National Prosecuting Authority (NPA) for criminal investigation and or may be restricted from conducting business with the public sector for a period not exceeding ten (10) years in terms of the Prevention and Combating of Corrupt Activities Act No 12 of 2004 or any other applicable legislation.

.....
Signature

.....
Date

.....
Position

.....
Name of Bidder

Js9141w 4