

# SPECIFICATION FOR A REQUEST FOR INFORMATION

## Supply of Extruded Copper Rotor Bars

TRANSNET ENGINEERING  
PRODUCT DEVELOPMENT – R&D  
KOEDOESPOORT

**Compiler:**

**Surname & Name** Rossouw, CJ

**Signature** 

**Date** 19/10/2021

**Authorised:**

**Surname & Name** Boshoff, KRK

**Signature** 

**Date** 19/10/2021

# ***Specification for a Request for Information for the Supply of Extruded Copper Rotor Bars***

## **1 Background and General**

Transnet Engineering (TE) is in the process of the design and development of various products which requires extruded copper rotor bars. This is to ensure product quality, performance according to design and ease of assembly of the final product.

The aim of this specification is to provide the supplier with the necessary information to enable the provision of indicative pricing for the supply of extruded copper rotor bars according to the requirements provided by TE within this Request for Information (RFI).

## **2 Delivery Address**

- 2.1 All items quoted on within this specification shall include delivery to the following address:
- Bay 8, Koedoespoort Depot,  
Cnr. Lynette Street and Koedoespoort Road,  
Koedoespoort,  
Pretoria,  
0186

## **3 Scope of Work/Services**

- 3.1 The scope associated with this RFI is provided within Table 1. It is required that supplier provide either informational feedback or indicative pricing on each of the items detailed within Table 1.

*Table 1: Scope Associated with this RFI and Feedback Required.*

#	Scope Associated with RFI	Feedback Required
<b>1</b>	Provision of the extruded copper rotor bars from the material required as detailed in Section 4.	Information
<b>2</b>	Provision of the extruded copper rotor bars according to requirements for extruded copper rotor bars as detailed in Section 5.	Information
<b>3</b>	Extrusion of the copper rotor bars as per the drawing provided within Appendix A.	Information
<b>4</b>	Indicative pricing associated with the provision of the following quantities of extruded copper rotor bars:	Indicative Pricing
<b>4.1</b>	0 to 70 extruded copper rotor bars (incl. breakdown of cost associated with dies, raw material, extrusion, etc.).	Indicative Pricing
<b>4.2</b>	71 to 710 extruded copper rotor bars (incl. breakdown of cost associated with dies, raw material, extrusion, etc.).	Indicative Pricing
<b>5</b>	Delivery of extruded copper rotor bars to delivery address.	Indicative Pricing

# ***Specification for a Request for Information for the Supply of Extruded Copper Rotor Bars***

## **4 Material Requirements**

- 4.1 The physical and technical properties of the extruded copper rotor bars shall comply with all requirements detailed within Table 2 of this specification.

*Table 2: Required Electrical Steel Properties*

#	Item Description
1	<p><b><u>Extruded Copper Bar</u></b></p> <ul style="list-style-type: none"><li>Physical and Technical Properties:<ul style="list-style-type: none"><li>Grade:<ul style="list-style-type: none"><li>CDA Copper No. C101 (Cu-OF); or</li><li>CDA Copper No. C102 (Cu-OF); or</li><li>CDA Copper No. C110 (Cu-ETP, R240).</li></ul></li></ul></li></ul>

## **5 Requirements for Extruded Copper Rotor Bars**

- 5.1 It is required that the extruded copper rotor bars be manufactured accordingly to the drawings provided in Appendix A within this specification.
- 5.2 It is a strict requirement that all tolerancing requirements provided as part of the drawing in Appendix A are met.
- 5.3 TE shall service the supplier with all required files (.step, .dxf) upon request from the supplier.

## **6 General**

- 6.1 The supplier is at liberty to approach Transnet Engineering at any time for clarification of any requirement should any voids exist which impedes the supplier's ability to provide a response to this RFI. This is inclusive of any additional detail that may be required as a part of Appendix A of this RFI.
- 6.2 It is required that the supplier provide a response to items 1 to 5 as detailed within Table 1 of this RFI.

*Specification for a Request for Information for the Supply of Extruded Copper Rotor  
Bars*

**APPENDIX A**

FOR UNTOLERANCED DIMENSIONS SEE ISO 2768-1:  
FOR GENERAL TOLERANCE ON WELDED CONSTRUCTIONS SEE ISO 13920: CLASS

DESIGNATION

M

2D STATUS

IN WORK

// 0.05 B D

// 0.05 F E

⊥ 0.1 A B

⊥ 0.1 C D

— 0.05  
ALL LONGITUDINAL SURFACES

0.01  
ALL LONGITUDINAL SURFACES

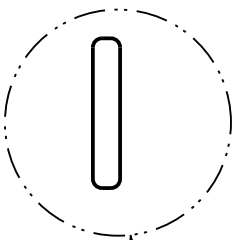

SEE DETAIL A

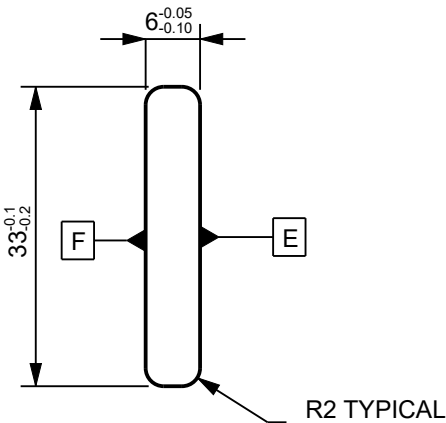

DETAIL A  
SCALE 6:5

-/A  
UPDATED TOLERANCES  
15-03-2021  
N.B.S

AMENDMENTS

MASS 0.75 Kg

**COPYRIGHT**  
THIS DRAWING TOGETHER WITH THE COPYRIGHT  
IS THE PROPERTY OF  
**TRANSNET**  
THIS DRAWING OR ANY PART THEREOF IS NOT  
TO BE COPIED OR OTHERWISE REPRODUCED  
OR USED FOR MANUFACTURE OR ANY OTHER  
PURPOSE WITHOUT THE WRITTEN PERMISSION  
FROM  
CHIEF EXECUTIVE,  
TRANSNET ENGINEERING

ASSEMBLY DRG No.

DRAWN

N.B.S

KILNERPARK

R&D

**MATERIAL**

**ROTOR BAR V2**

COPPER  
CDA 101  
COPPER BAR  
470 X 50 X 12

CLASS R&D

CHECKED

S.A

TYPE PROTOTYPE

APPROVED

K.B

**MACHINE DRAWING**

SHEET 1 OF 1

DATE

10/02/2021

SCALE

3:5

TRANSNET ENGINEERING

No.

**PELG\_177Z\_0211**

REV.

**A**

**A-3**

PROJECTION

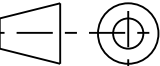

DOCUMENT REFERENCE No.