

| COMPONENT LOCATION | No. IN EACH | TYPE SIZE MARK | Total No. | LENGTH mm | SHAPE CODE | BENDING DIMENSIONS | | | | |
|--------------------|-------------|----------------|-----------|-----------|------------|--------------------|------|------|------|------|
| FLOOR SLAB | | Y12.01 | 30 | 2050 | 20 | 2050 | A mm | B mm | C mm | D mm |
| CONCRETE COVER - | | Y10.01 | 13 | 1800 | 37 | 90 | 1740 | | | |
| | | Y10.02 | 13 | 1800 | 37 | 80 | 1740 | | | |
| | | Y10.03 | 2 | 1475 | 37 | 750 | | | | |

| CONCRETE COVER | | FLOOR SLAB | | COVER TO ALL STEEL | | STRENGTH | |
|----------------|------|------------|-------|---------------------|--|-------------------|--|
| TYPE | MASS | TYPE | MASS | (STEEL TO SABS 920) | | 25 MPa at 28 days | |
| M.S | | M.S | | FLOOR SLAB : 50mm | | | |
| H.T | 30.8 | H.T | 56.00 | ROOF SLAB : 30mm | | | |

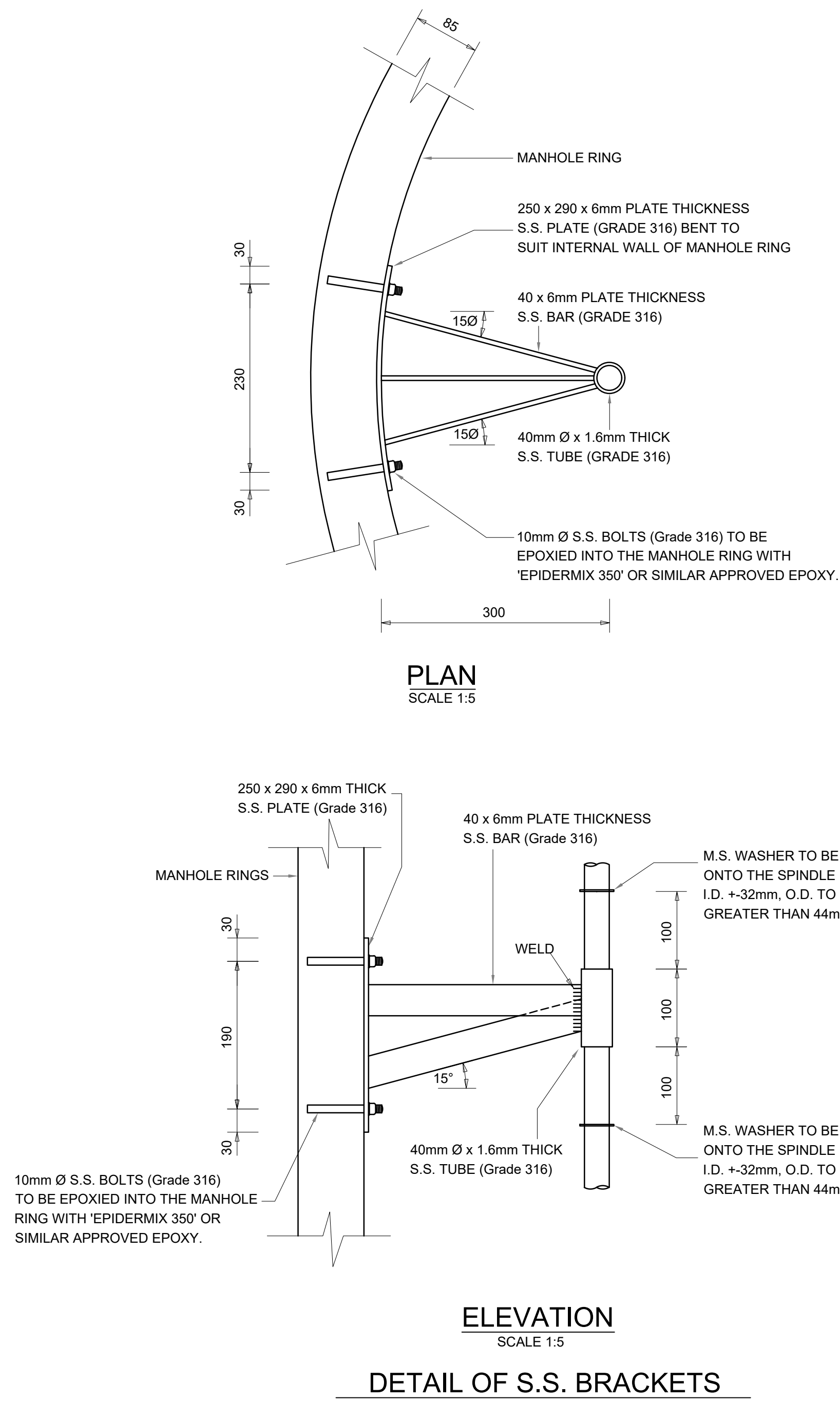

- NOTE:**
1. ROOF SLABS TO BE PRECAST ON SHUTTERS.
 2. CHAMBER TO BE FOUNDED ON INSITU MATERIAL OR ON REWORKED MATERIAL COMPACTED TO 95% Mod.A.A.S.H.T.O.
 3. FOUNDATIONS TO HAVE 50mm THICK BLINDING LAYER OF GRADE 15/26 CONCRETE BEFORE BASE REINFORCEMENT IS PLACED.
 4. ALL MILD STEEL AND STEEL PIPEWORK TO BE RILSAN LINED AND COATED OR SIMILAR APPROVED TO A MINIMUM DRY FILM THICKNESS OF 300 MICRONS.
 5. EXPOSED EXTERNAL SIDES OF CHAMBER & ROOF SLABS TO BE PAINTED WITH 2 COATS OF A PLASTICISED PAINT, 'IVORY PROTECOTE PAINT' OR SIMILAR APPROVED. COLOUR : CHAMBER - 'FOREST GREEN' ROOF SLAB - 'GOLDEN YELLOW'
 6. ALL JOINTS BETWEEN MANHOLE RINGS TO BE SEALED WITH 'EXPANDITE BUTYL 300' WITH ROOT INHIBITOR OR SIMILAR APPROVED.

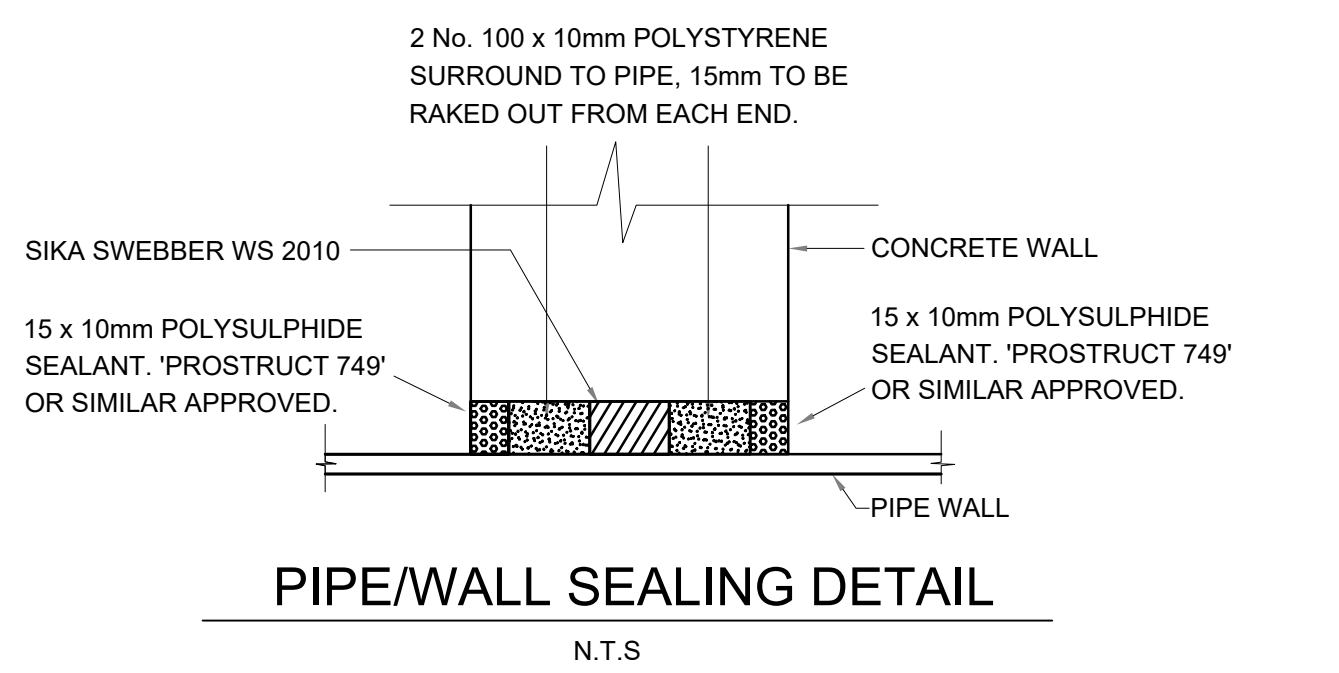
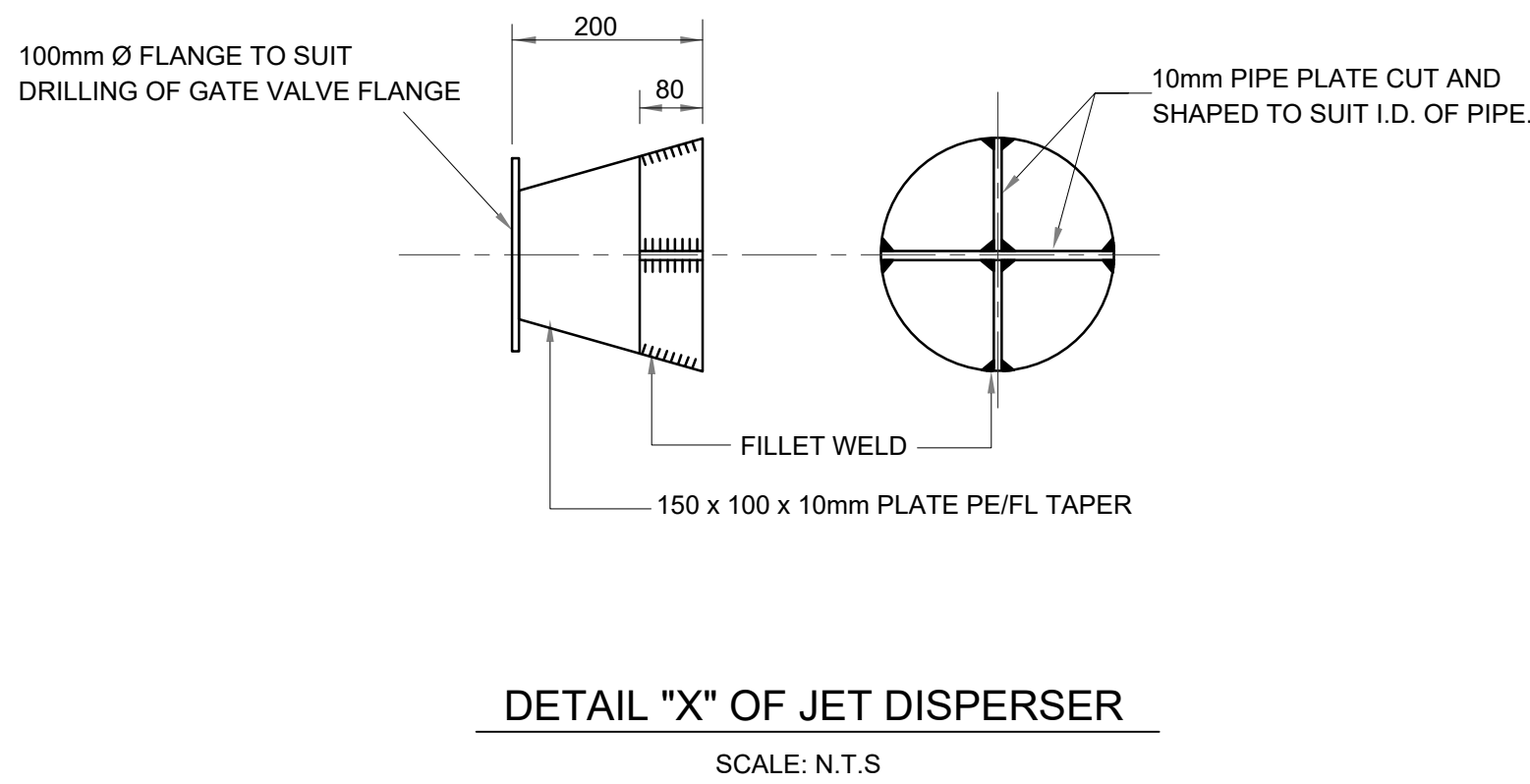
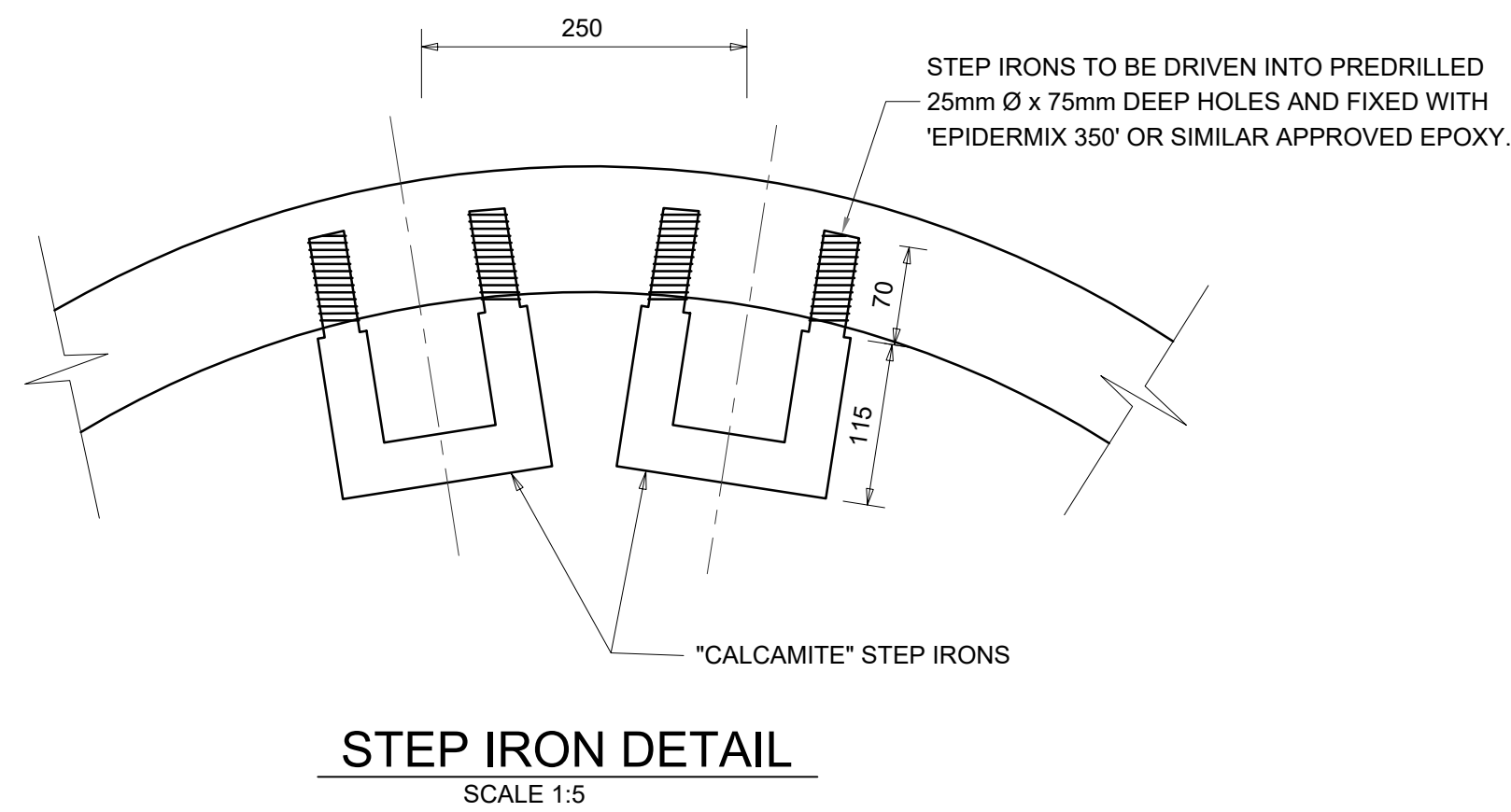

FOR TENDER PURPOSES

ETHEKWINI WATER AND SANITATION

eThekweni Municipality

WATER DESIGN BRANCH
REDUCED PLAN USE SCALE BELOW
0 10 20 30 40 50 60 70
70mm ON ORIGINAL PLAN

LEGEND
EXISTING UNDERGROUND SERVICES ARE AS SHOWN BELOW.
NEW INFRASTRUCTURE
EXISTING INFRASTRUCTURE

CONSTRUCTION INFORMATION
MAINLAYER
START DATE
FINISH DATE
W/O NUMBER
LEVEL OF SERVICE
SUPERVISOR NAME
CONTACT NUMBER
DATE SENT TO GIS
GIS INFORMATION
DATE RECEIVED
NAME

Revision
Date
Description
A
MAR 2023
ISSUED FOR TENDER

NOTE: No construction work to commence until land and servitude acquisitions have been completed.
Acquisitions completed:

Date
Engineer
NORTH
POINT

UNDERGROUND SERVICES CHECKED -
SERVICE
DATE
SIGNATURE

S.W. DRAWING
SEWERS
WATERMANS
TELKOM CABLES
ELECTRIC CABLES
S.A.R. CABLES
E.S.C. CABLES
OIL PIPE LINE

NOTE: Only underground services affected by new construction are shown. Care must be taken during excavations for road foundations, trenches etc. to avoid damage to underground services such as sewers, drains, cables, watermains and connections. Wherever possible these must be located before work begins.

Contract No.
WS 7589

Project No.
X6714

Planning Unit
WEST HAMMARSDALE - STERKSPRUIT
Ward No.
103 and 4

Project Title
HAMMARSDALE HIGH LEVEL RESERVOIR INLET (PHASE 2)

Drawing Title
SCOUR CHAMBER, DETAILS & REINFORCING DETAILS (H44, H50 & H54)

Scale : 1:20, 1:10 & 1:5
Designed : R.NHLUMAYO
Date : MAR 2023
Checked :
Drawn : S.ZULU

Area Engineer
Manager (Water Design)
Deputy Head (Engineering)

E. MSWELI - Head (W & S)
Drawing No.
56724
Sheet
17/24
Rev.
A