

ANNEXURE B

MULTIWALL

SPECIFICATION

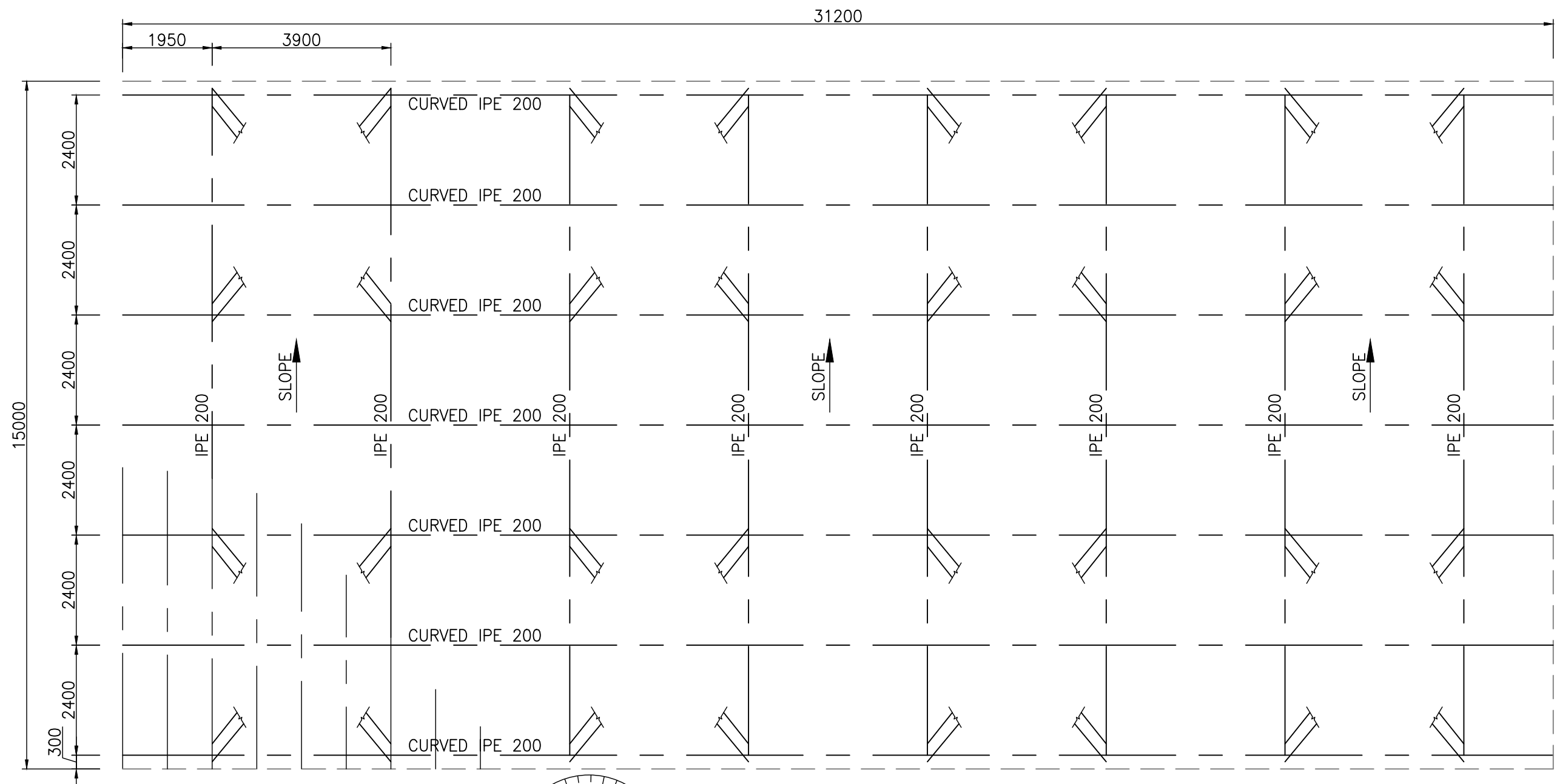

975 | 975 | 975 | 975 | 975 | 975 | 975 | 975 |
IPE 100AA PURLINS @ 975c/c

ROOF PLAN

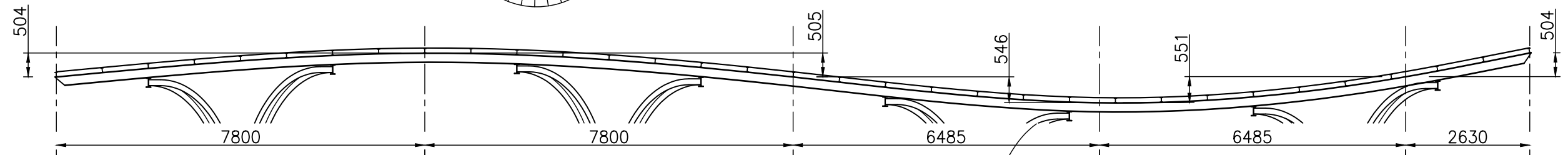
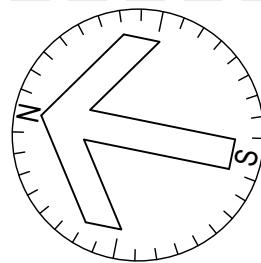

DAVID ELSTON & Associates

ENGINEERS

PROJECT MANAGERS

tel:(021) 683-0125

fax:(021) 683-5428

info@dea.co.za

Ownership and copyright of this drawing is reserved by David Elston & Associates.

CAPE ARCHEOLOGICAL SERVICES
FRANSCHHOEK SKUIFRAAM RUIN 1

STRUCTURAL LAYOUTS
ROOF STRUCTURE

REVISION

DESTROY
EARLIER
ISSUES

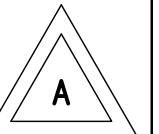

DESIGNED

CHECKED

DATE

SCALE
1:100

DRAWN
WBL

PROJECT
CAS1-02

DRAWING NO.
AP-101

Multiwall Installation Instructions

Safety Recommendations

- Never walk on or apply your weight directly to sheeting. Use walking boards along rafters at all times.
- Always exercise extreme care when walking on a roof & consider all safety requirements when working at heights.
- For safety precautions we recommend the use of safety mesh for installations above 3m.
- Use personal protective equipment such as safety footwear, safety glasses & gloves.
- We do not recommend the collection of drinking water from any roof without appropriate precautions & filtration (check with your local water authority for further advice).
- All installations & safety practices must comply with the applicable building &/or work cover codes.

Table 1.

Rafter Nominal Spacing (mm)

Sheet Thickness	Sheet Width	Rafter Spacing
10mm	700mm	720mm
10mm	1050mm	1070mm

For installation in high wind areas please contact your local Mulford Building Products office.

- 1** Install sheets with the ribs (flutes) running vertically in the direction of the fall on the roof with a minimum pitch of 5 degrees. Having sufficient fall allows natural weather action to assist in keeping the sheets clean and minimises leaking.

- 2** Check recommendation for rafter spacing in Table 1.

- 3** Multiwall sheets can be cut using a sharp knife, hand saw or circular saw with a fine tooth blade suitable for plastics. Sawdust (swarf) should be cleared from the channels with compressed air (or vacuumed) and edges should be free of notches.

If the width of the Multiwall sheets needs to be reduced, trim them as close as possible to the last rib so that optimum clamping action of the glazing bar is ensured.

- 4** Peel some of the masking back from the ends of the sheet and apply Breather Tape to the top and Sealing Tape to the bottom ends.

- 5** Place the first measured and cut Edge Bar down squarely on the structure (screw side up).

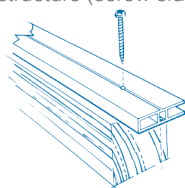

One Piece H-Bar System

Place the first measured and cut H-Bar down squarely on the structure (screw side up).

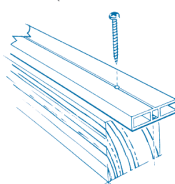

Two Piece H-bar System

Place the first measured and cut base glazing bar on the structure.

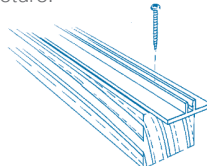

The maximum end overhang is 50mm.

- 6 One Piece H-Bar System**
Secure the H-Bar to the rafter with a screw (gauge not exceeding 12g) at no greater than 1200mm apart.

Two Piece H-bar System

Fasten the Base Glazing Bars to the rafter with Ripple Tek screws (10 gauge – 16 tpi) at no greater than 500mm apart by fixing through the center of the base glazing bar and securing it firmly onto the supporting structure. (Ripple Tek's for Wood are 30mm long; Ripple Tek's for Metal are 21mm in length)

- 7** Pull the masking back on the sides of the sheet and place the H-Bar gasket along the whole length of both sides of the sheet.

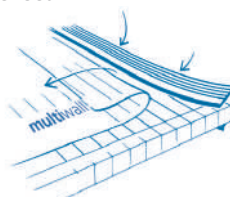

- 8 One Piece H-Bar System**
Place the next H-Bar on the other side and secure it to the support structure.

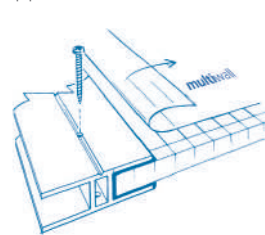

Two Piece H-bar System

Place the sheet between the secured glazing bars. Position the first top glazing bar in line with the base. Secure the two bars using a rubber mallet.

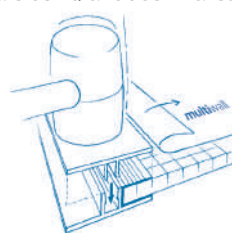

It is recommended that the top glazing bar is secured to the rafter with screws (gauge not exceeding 12g) at no greater than 1200mm apart. Once the next sheet is installed the second and subsequent top glazing bars can be fitted.

- 9** Repeat steps 6-8 until all sheets are in position.

- 10** When using Aluminium End Caps, place the end gasket along the end of the Multiwall sheet only, stopping at the H-Bar.

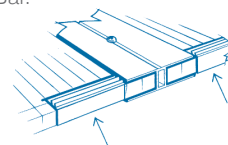

- 11** Fasten the Aluminium End Cap with a screw to the H-Bar. On the underneath of the Aluminium End Cap drill a small weep hole where it meets the H-Bar.

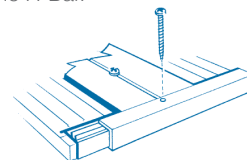

- 12** Use the Edge Bar to finish the assembly on the final rafter.

IMPORTANT

Sealants - These instructions are designed to prevent leaking and alleviate the requirement for sealants. Sealants, especially silicone, are incompatible with polycarbonate. They will damage the sheet, restrict expansion and contraction, and void the warranty. Use the appropriate Multiwall accessories to complete your project and help protect your structure, without the need for sealants.

Thermal Expansion - When inserting sheet into glazing sections allowance must be made for expansion.

* Full Warranty terms & conditions are available from www.laserlite.com.au or via a Mulford Building Products office. It is the responsibility of the purchaser to obtain a copy of the full Warranty terms & conditions. All lightweight Multiwall sheets are manufactured from high-tech, high quality Makrolon® polycarbonate resin for high impact resistance, excellent transparency, UV stability & excellent fire resistance.

New South Wales

T 02 9677 9900
F 02 9677 9500
E nswmbp@mulford.com.au

Newcastle

T 02 4940 8922
F 02 4940 8362
E ordersnewcastle@mulford.com.au

Queensland

T 07 3717 4700
F 07 3717 4777
E qldmbp@mulford.com.au

Victoria

T 03 8791 8000
F 03 8791 8088
E vicmbp@mulford.com.au

Tasmania

T 03 6288 6000
F 03 6288 6010
E tasmmbp@mulford.com.au

South Australia

T 08 8444 9666
F 08 8444 9600
E sambp@mulford.com.au

Western Australia

T 08 9240 6655
F 08 9240 8877
E wambp@mulford.com.au



MULFORD
BUILDING PRODUCTS
delivering solutions

Mulford Building Products

T +61 2 9911 8109
F +61 2 9911 8101
Unit 22, Slough Business Park,
Holker Street, Silverwater NSW 2128 Australia
ABN 86 000 057 170