

ROAD 1 and 2 ROAD MARKINGS
SCALE 1 : 500

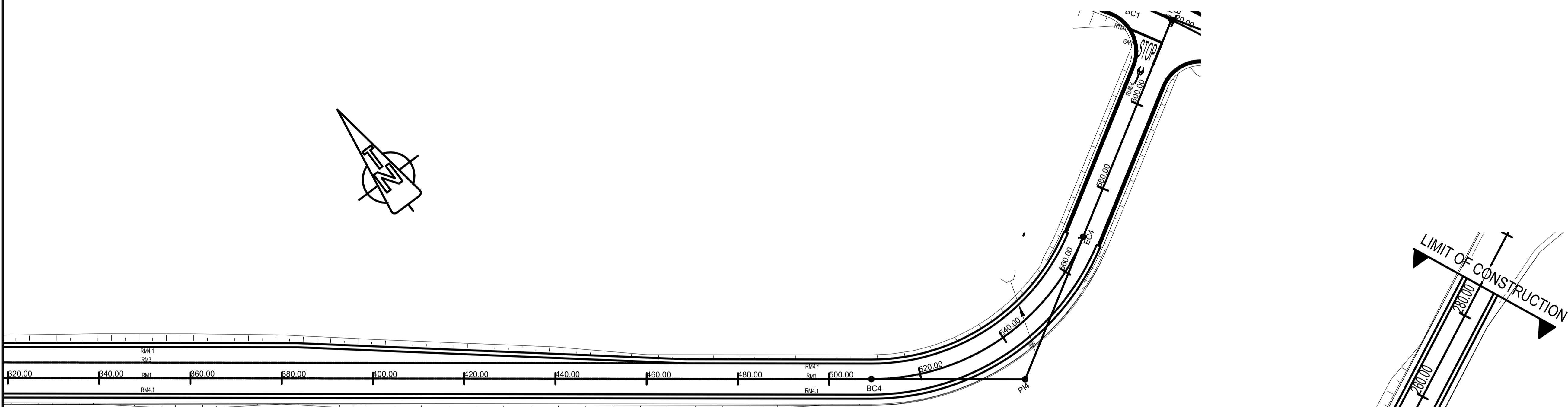

ROAD 2: CONTINUATION OF ROAD MARKINGS
SCALE 1 : 500

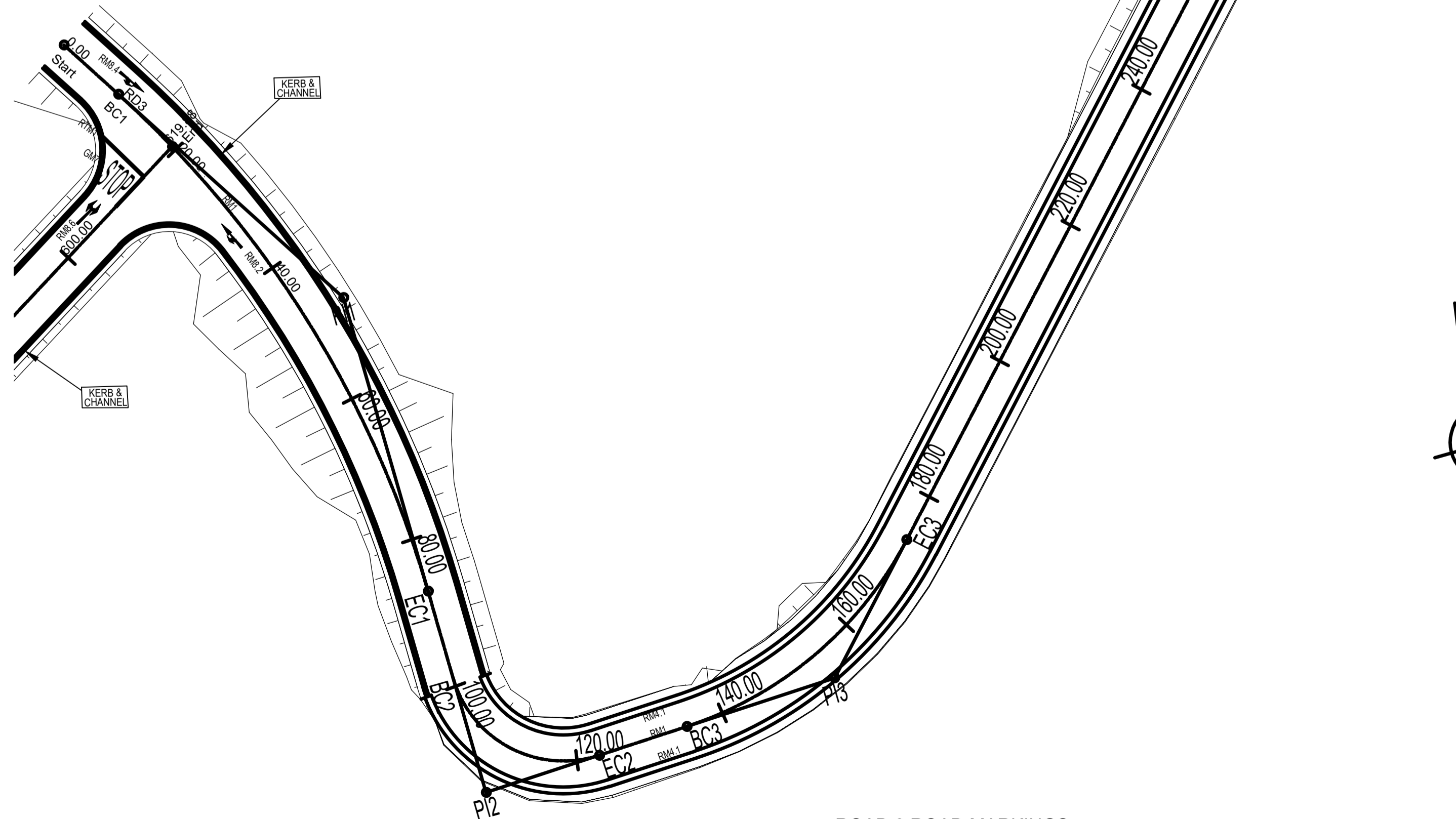

ROAD 3 ROAD MARKINGS
SCALE 1 : 500

NOTES:

- 1 SETTING OUT
 - 1.1 ALL SETTING OUT DATA LEVELS AND DIMENSIONS SHALL BE PROVIDED IN ELECTRONIC FORMAT AND VERIFIED BY CONTRACT ON SITE PRIOR OF CONSTRUCTION.
 - 1.2 ALL SURVEY AND SETTING OUT DATA SHALL BE PROVIDED ON WGS 84 (Lo27) CO-ORDINATE SYSTEM.
 - 1.3 NO DIMENSIONS SHALL BE SCALED ON SITE.
- 2 DESIGN STANDARD
 - 2.1 ALL WORK IS TO BE CARRIED OUT IN ACCORDANCE WITH THE COLTO SPECIFICATION FOR ROADS AND BRIDGE WORK FOR STATE ROAD AUTHORITIES.
- 3 DRAINAGE
 - 3.1 ALL PIPE CULVERTS SHALL BE CHECKED BY ACCURATE FIELD SURVEY AND THE DESIGN CONFIRMED ON SITE BEFORE CONSTRUCTION.
 - 3.2 FOR ALL TYPICAL DRAWINGS DETAILS REFER TO DRAWING No. XEL010-6001-00 / 190001-T-3301
- 4 GUARDRAILS
 - 4.1 GUARDRAILS TO BE ERECTED AS SHOWN ON THE DRAWINGS OR AS DIRECTED BY THE ENGINEER.
- 5 SERVICES
 - 5.1 EXISTING SERVICE TO BE IDENTIFIED AND PROTECTED OR RELOCATED PRIOR TO CONSTRUCTION OF THE ROAD WORKS.

LEGEND

- NEW V-DRAINS
- NEW STORMWATER PIPE
- NEW HEADWALL
- NEW GRID INLET
- KERB & CHANNEL

FOR TENDER

09	ISSUED FOR TENDER PACK	2020-09-18
No.	DESCRIPTION / REVISIONS	DATE



PROJECT / AREA / ASSET / SUBJECT

PORT OF EAST LONDON

**ROADS 1, 2 & 3 :
ROAD MARKINGS LAYOUT**

DATE	2020-09-18	ML - PROJECT MANAGER	08/10/2020
SCALE	AS SHOWN	ML - SURVEY ENGINEER	
DESIGNED BY	BM	ML - CIVIL ENGINEER	
CHECKED BY	SN	ML - CIVIL ENGINEER	
DRAWN BY	BM	ML - CIVIL ENGINEER	
CHECKED BY	SN	ML - CIVIL ENGINEER	

PAPER SIZE	A1	TRANSNET DRV. NO.	XEL010-4001-00	SHEET	REV.
		CONSULTANT / CONTRACTOR DRV. NO.	1900001-T-2701		

© Copyright vest in TNPFA Port of East London. No parts of this drawing may be copied, manipulated or used for personal gain without the permission of TNPFA Port of East London.