

Fire Equipment Amounts:	
Standpipe	- 1
5Kg CO ₂ Fire Extinguisher	- 1
Fire Hose Reel	- 1

Tuck Shop Fire Protection

Scale 1 : 50

- GENERAL FIRE NOTES: OCCUPANCY - A3**

1. QUICK RELEASE COUPLING FIRE HOSE OUTLET:
QUICK RELEASE COUPLING TO BE INSTALLED TO POSITION
AS INDICATED TO BE FED BY Ø32mm HDPE
UNDERGROUND PIPE.
2. PORTABLE FIRE EXTINGUISHERS
9.0 KG DRY CHEMICAL POWDER FIRE EXTINGUISHERS TO
BE INSTALLED AS PER PLAN SECURELY TO WALLS OR
PURPOSE MADE BOARDS OR FRAMES, ALL FIRE
EXTINGUISHERS TO BE INSTALLED IN ACCORDANCE WITH
SANS 0105 AND 4.37.
3. FIRE EXITS:
ESCAPE DOORS TO BE IN A PROMINENT POSITION AS
INDICATED ON PLAN. TIMBER FRAMED, LEDGED AND
BATTENED DOORS TO ALL EXTERNAL PARTS OF BUILDING
ESCAPE DOORS MAY ONLY BE FITTED WITH APPROVED
LOCKING DEVICES (NO KEYS).
4. SIGNAGE
ALL FIRE FIGHTING EQUIPMENT AND FIRE EXISTS TO BE
CLEARLY MARKED WITH PHOTOLUMINESCENCE SYMBOLIC
SIGNAGE, AND TO BE SECURELY MOUNTED WITH SUITABLE
FIXING METHODS (NO ADHESIVE) TO BE INSTALLED IN
ACCORDANCE WITH SANS 1186.
5. ALL WORK TO COMPLY AND TO BE CARRIED OUT TO
SANS 10400 OF 2011
6. BUILDING AND PROPERTY TO COMPLY WITH SANS
10400 4.55
7. ALL STRUCTURAL ELEMENTS AND COMPONENTS TO
COMPLY TO SANS 10400 4.7
8. FIRE HYDRANT TO COMPLY TO SANS 10400 AND
PIPE WORK TO COMPLY TO SANS 10400
PART W.
9. ALL FIRE WATER RETICULATION TO BE TESTED BY
THE FIRE DEPARTMENT AND WATER
DEPARTMENT
10. INSULATION TO COMPLY TO SANS 0428
11. VENTILATION TO COMPLY TO SANS 4.42
12. FIRE DOORS TO COMPLY WITH SANS 1253
13. FLOOR COVERING TO COMPLY WITH 4.14 AND TO
BE CLASS 3 OR LOWER
14. WALL COVERINGS TO COMPLY WITH 4.15 AND TO
BE CLASS 3 OR LOWER
15. MIN 1.5m ESCAPE ROUTE

[illegible]

Signage Note:

Any building that has emergency routes or escape routes shall be clearly marked and signposted to indicate the direction of travel in the case of an emergency.

All exits will be marked by an approved sign readily visible from any direction of exit access.

Sign placement will be such that that no point in the exit access is more than 30 meters from the nearest visible sign.

Such signs are to be minimum size of 190 x 190mm and are to be SABS approved photo luminescent signs. Signs to comply to SANS 101186.

Every sign will be located and of such size, distinctive colour and design as to be readily visible. All signage must stand out from the surroundings and be visible.

Externally and internally illuminated signs will be visible in both the normal and emergency lighting mode.

Every sign required will provide evenly illuminated letters having a minimum luminance of 0.21cd/m².

Exit signs will be illuminated by the emergency lighting facilities.

Signage Legend:

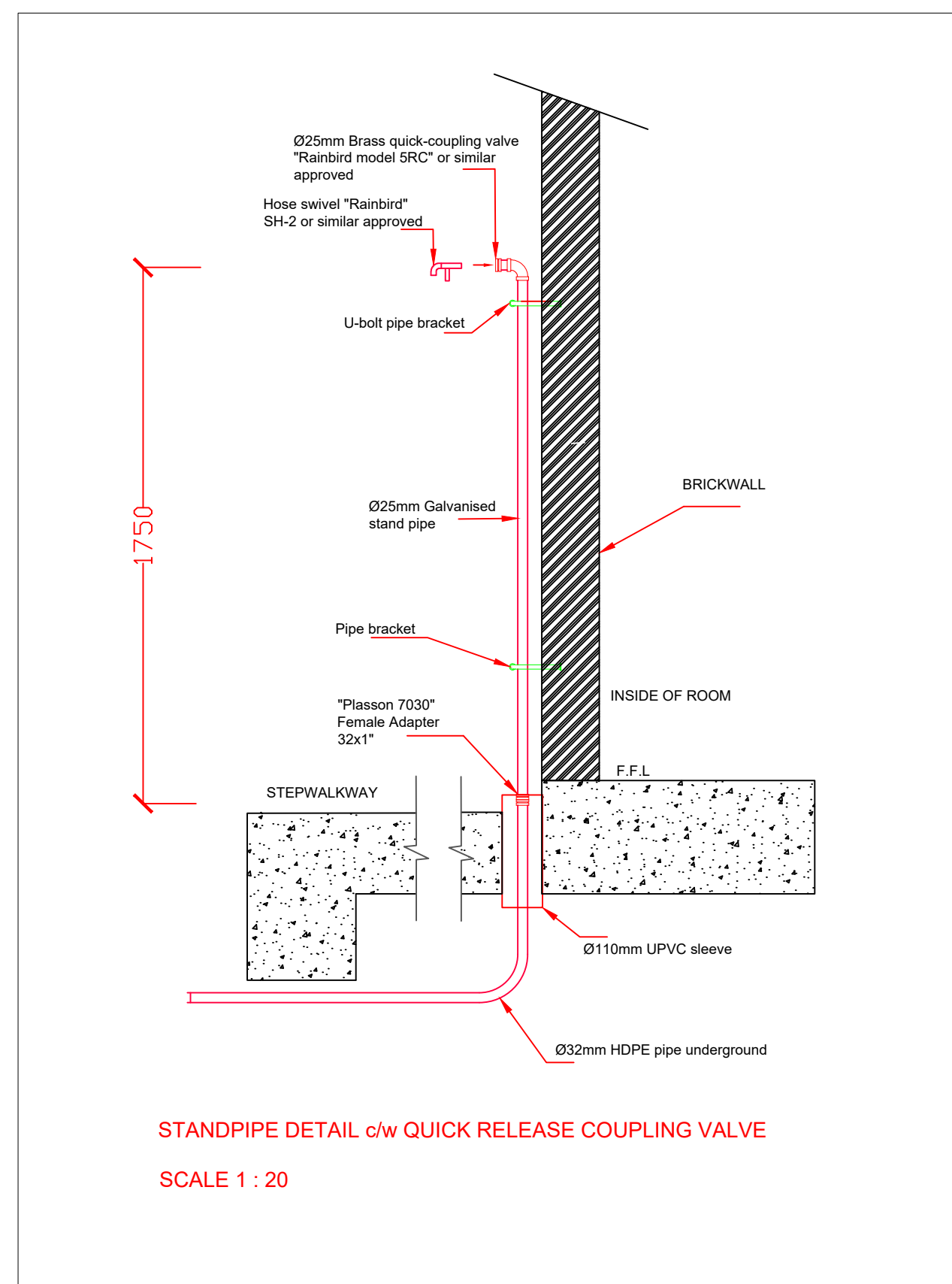
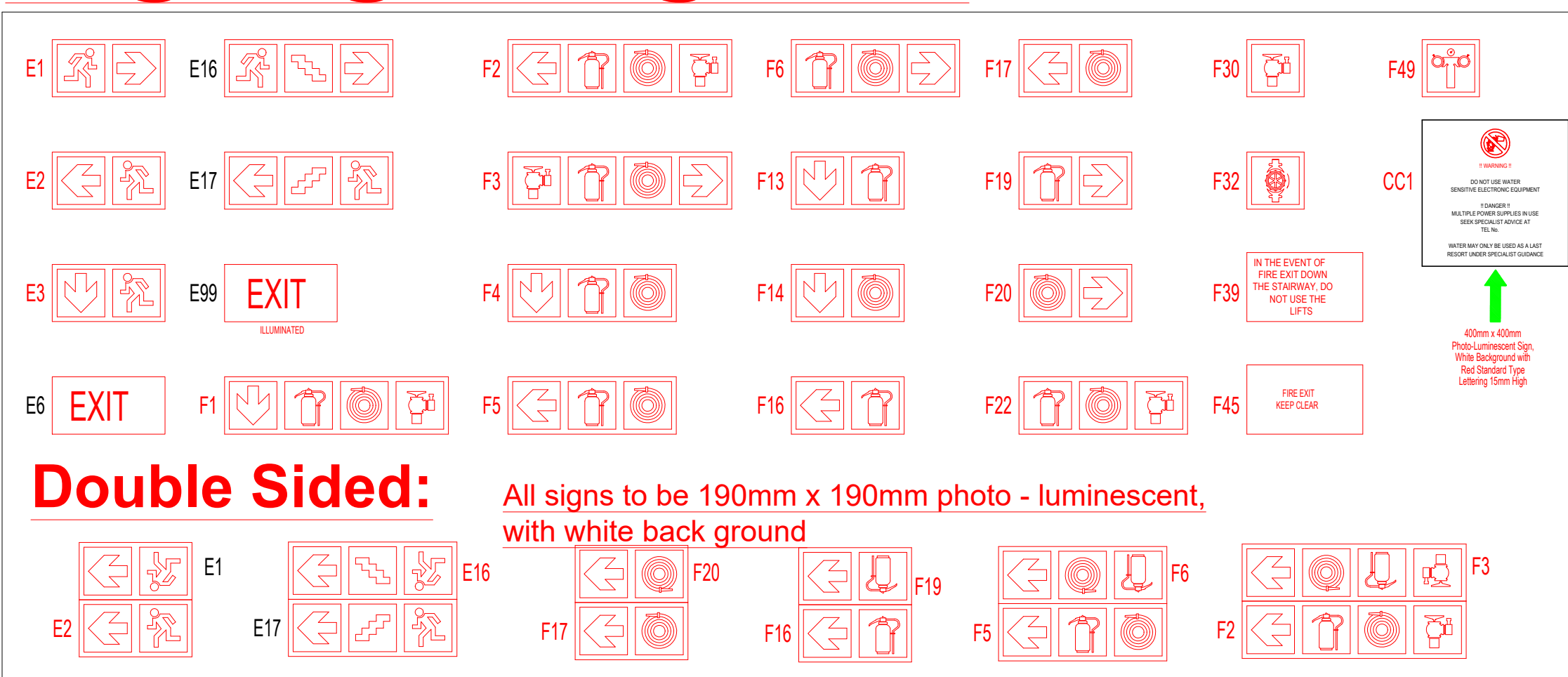

LEGEND

- UNDERGROUND FIRE PIPEWORK
- 30m FIRE HOSE REEL
- 4.5 kg DCP FIRE EXTINGUISHER
- 5 kg CO2 FIRE EXTINGUISHER
- 60min FIRE RATED WALL
- 30min FIRE RATED DOOR

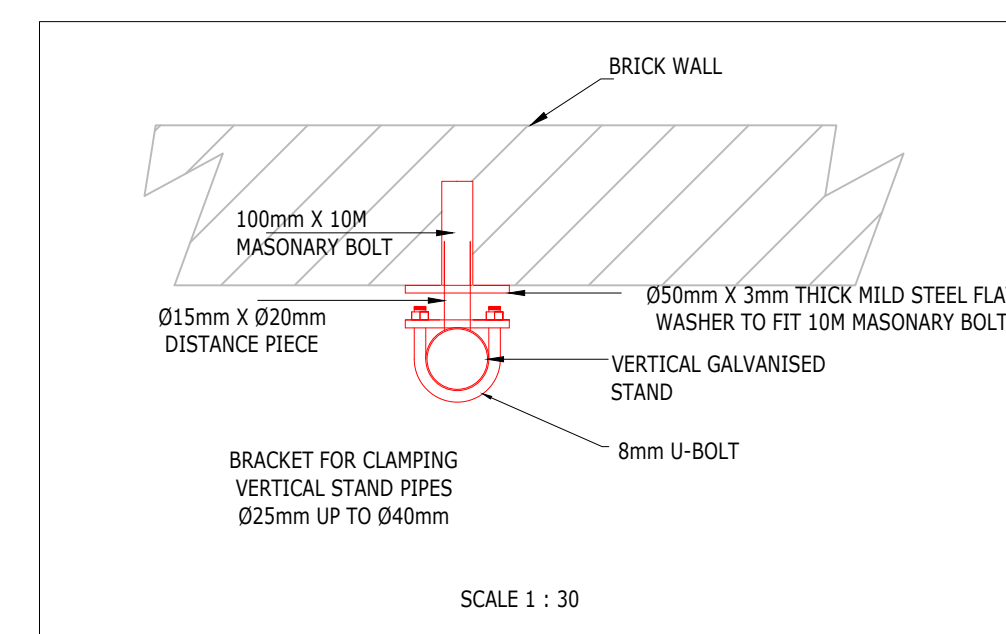

**FOR
TENDER**